

PHOTOMETRIC LIGHTING PLAN NOTES:  
 1. CALCULATIONS REPRESENT INITIAL FOOTCANDLE LEVELS AT GRADE.  
 2. CALCULATION STATISTICS:  
 PARKING 1 AVE 1.31 MAX 3.6 MIN 0.5 A.M. 2:62:1 X.M. 7:20:1  
 PARKING 2 AVE 2.50 MAX 4.4 MIN 0.6 A.M. 4:17:1 X.M. 7:33:1  
 PARKING 3 AVE 1.44 MAX 3.0 MIN 0.5 A.M. 2:88:1 X.M. 6:00:1  
 PARKING 4 AVE 1.30 MAX 3.6 MIN 0.5 A.M. 2:60:1 X.M. 7:20:1

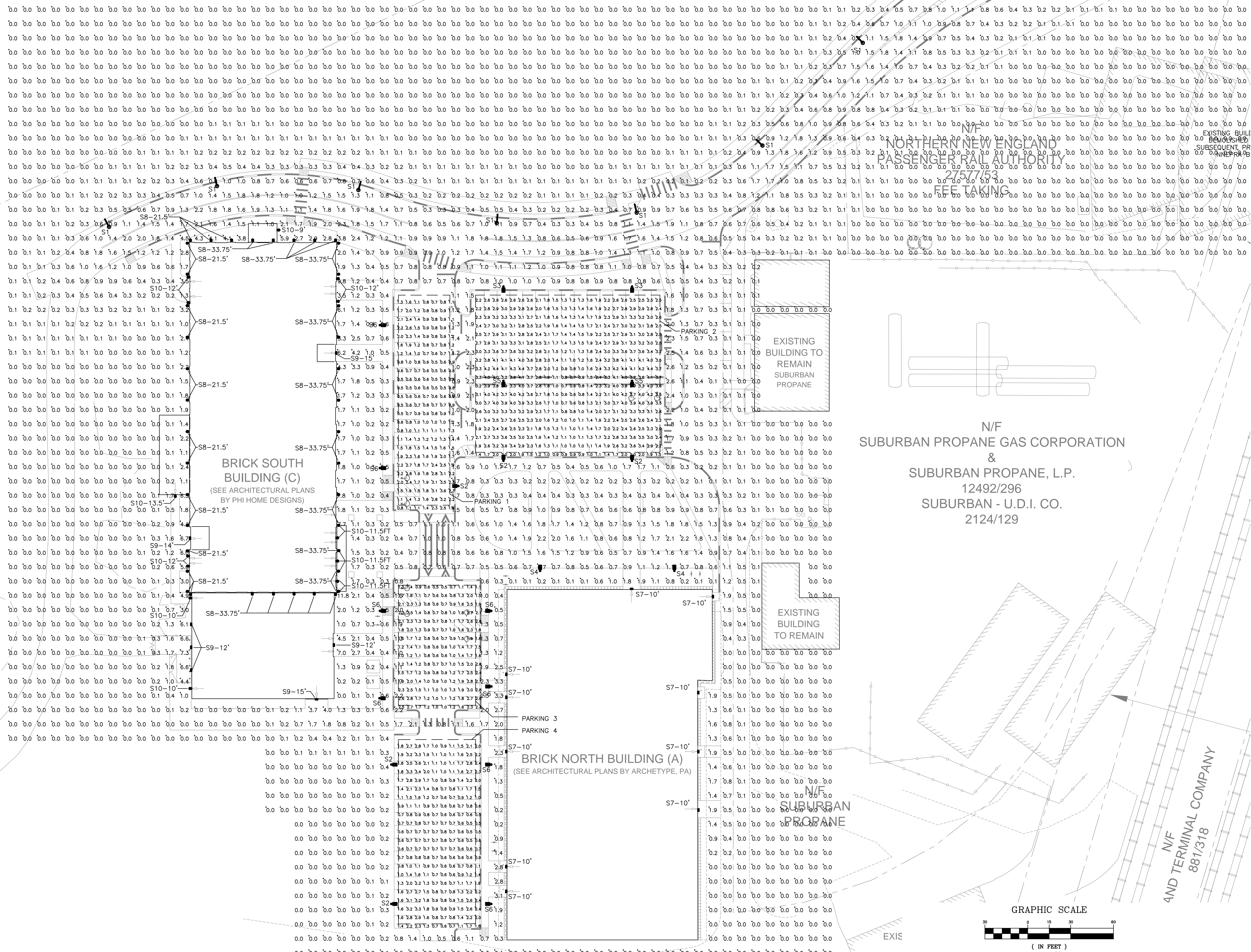

REV	DATE	DESCRIPTION	REVISIONS
3	09.03.15	REVISED LIGHTING	
2	07.22.14	SUBMITTED FOR UTILITY COMPANY REVIEW	
1	07.01.14	SUBMITTED FOR CLIENT REVIEW	

PROJECT	BRICK NORTH BUILDING AT THE FOREFRONT AT THOMPSON'S POINT
SHEET TITLE	PHOTOMETRIC LIGHTING PLAN
CLIENT	FOREFRONT PARTNERS I, LP

**Bartlett Design**  
 LIGHTING & ELECTRICAL ENGINEERING  
 942 WASHINGTON STREET, BATH, ME 04530  
 TEL (207) 443-5447 FAX (207) 443-5560

**FST**  
 FAY, SPOFFORD & THORNDIKE  
 ENGINEERS - PLANNERS - SCIENTISTS  
 778 MAIN ST, SUITE 8, SOUTH PORTLAND, ME 04106

DRAWN: JLC DATE: 07/01/2014  
 DESIGNED: LEB SCALE: 1" = 30'-0"  
 CHECKED: LEB JOB NO: 2982.05  
 SHEET: E0.0