

HOME DESIGNS

446 WEST STREET
ROCKPORT, ME 04856

TEL: 207 230 0034
FAX: 207 230 0274
PHIHOMEDESIGNS.COM

©PHI HOME DESIGNS LLC

BRICK SOUTH
THOMPSON'S POINT PORTLAND, MAINE
OWNER: FOREFRONT PARTNERS I, LP

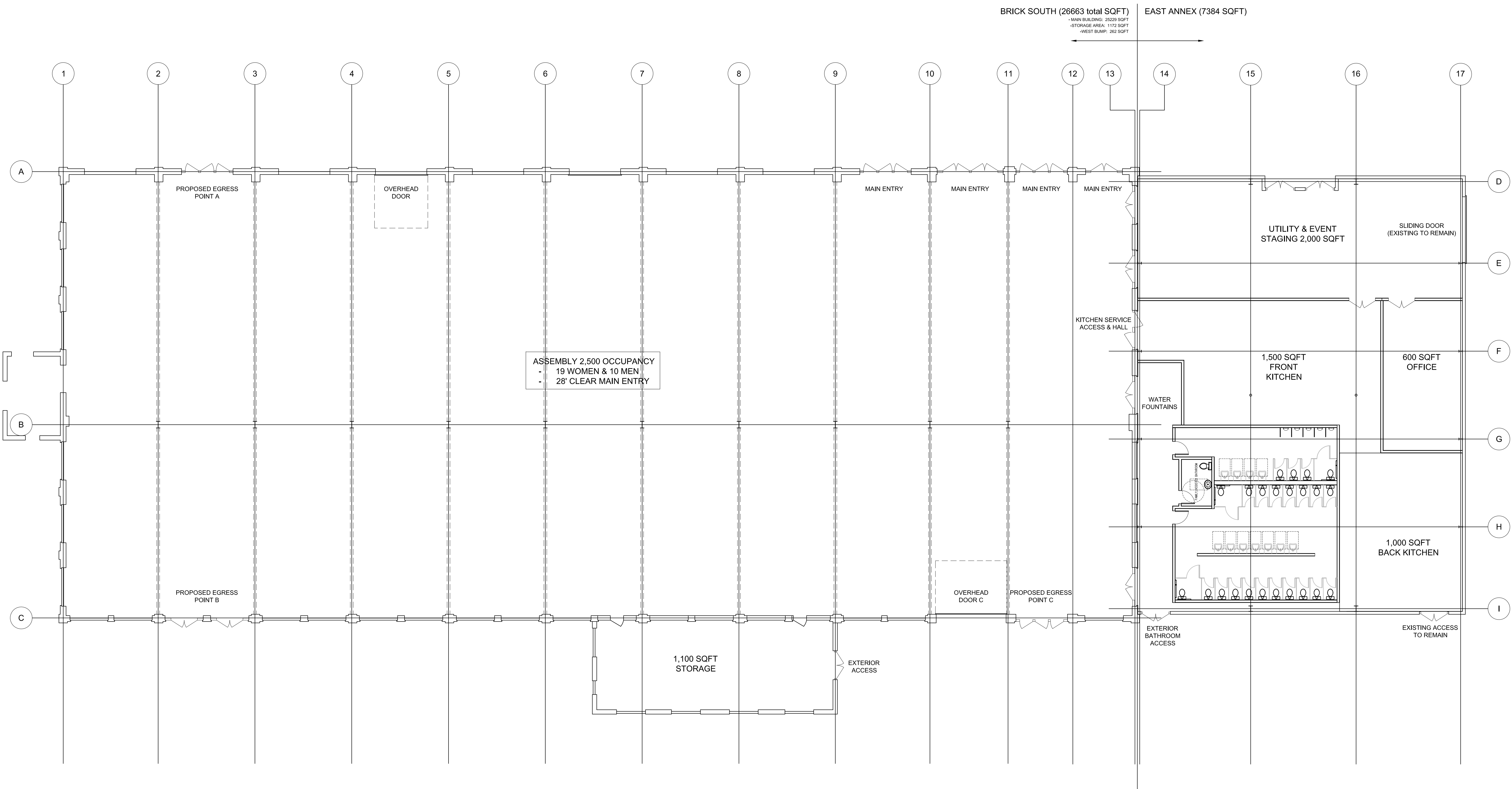

ASSEMBLY 2,500 OCCUPANCY
- 19 WOMEN & 10 MEN
- 28' CLEAR MAIN ENTRY

BRICK SOUTH (26663 total SQFT)
- MAIN BUILDING: 25229 SQFT
- STORAGE AREA: 1172 SQFT
- WEST BUMP: 262 SQFT

EAST ANNEX (7384 SQFT)

1
A101 BRICK SOUTH FLOOR PLAN
SCALE: 3/32" = 1'-0"

PRELIMINARY - NOT FOR CONSTRUCTION

DATE:
AUGUST 26, 2015
DRAWN BY:
CAG
CHECKED BY:
ECD

BRICK SOUTH
FLOOR PLAN

A101