

- LIGHTING FIXTURES:**
- TYPE S1 ROADWAY LIGHTING POLE
 HOTOPLANE #LENG 072 035 4K AS K L3 D PCLL P5 (FIXTURE)
 SIRELINK #SN 222221 HPL (RECEPT ARM) (POLE)
 SIRELINK #SLIDEVOC639720 (BASE)
 - TYPE S2 PARKING LOT LIGHTING POLE
 GARCOO #TRC-48-14-D1-BLP (POLE)
 PROVIDE A 3FT CONCRETE BASE
 - TYPE S3 PARKING LOT LIGHTING POLE
 GARCOO #P21-GM-A1-1-4-105LA-NW-UNV-BLP-PCG-PIN RECEPT-SFR (FIXTURE)
 PROVIDE A 3FT CONCRETE BASE
 - TYPE S4 PARKING LOT LIGHTING POLE
 GARCOO #TRC-48-17-D1-BLP (POLE)
 PROVIDE A 3FT CONCRETE BASE
 - TYPE S5 CAMPUS LIGHT
 STONOCO #SRSS02126H1B8808
 - TYPE S6 WALL MOUNTED LIGHT
 GARCOO #121-3-26A-NW-120-BLP-PCB120

STREET LIGHTING SERVICE METER DETAIL
 NOT TO SCALE

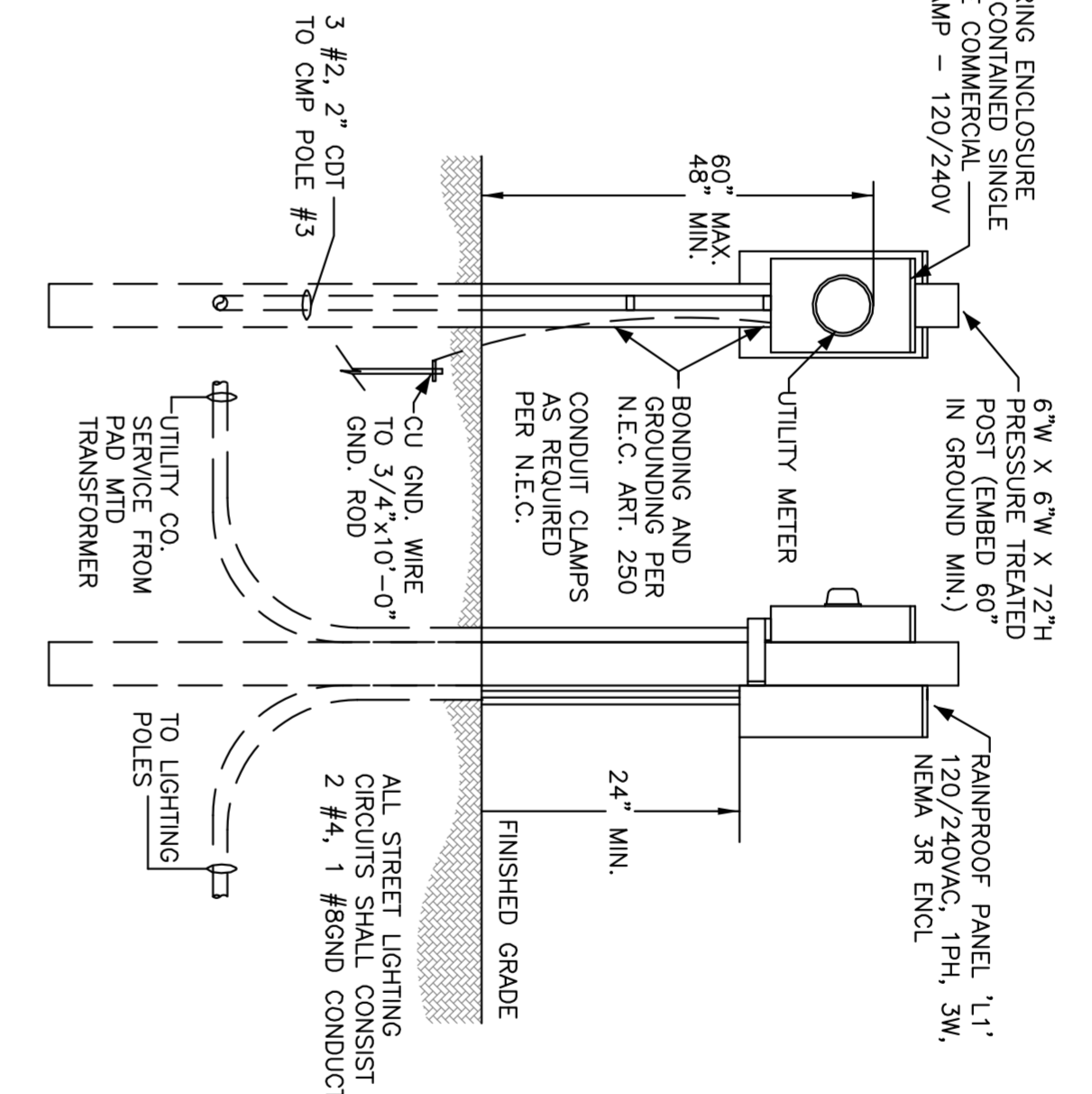

LIGHTING POLE BASE DETAIL
 NOT TO SCALE

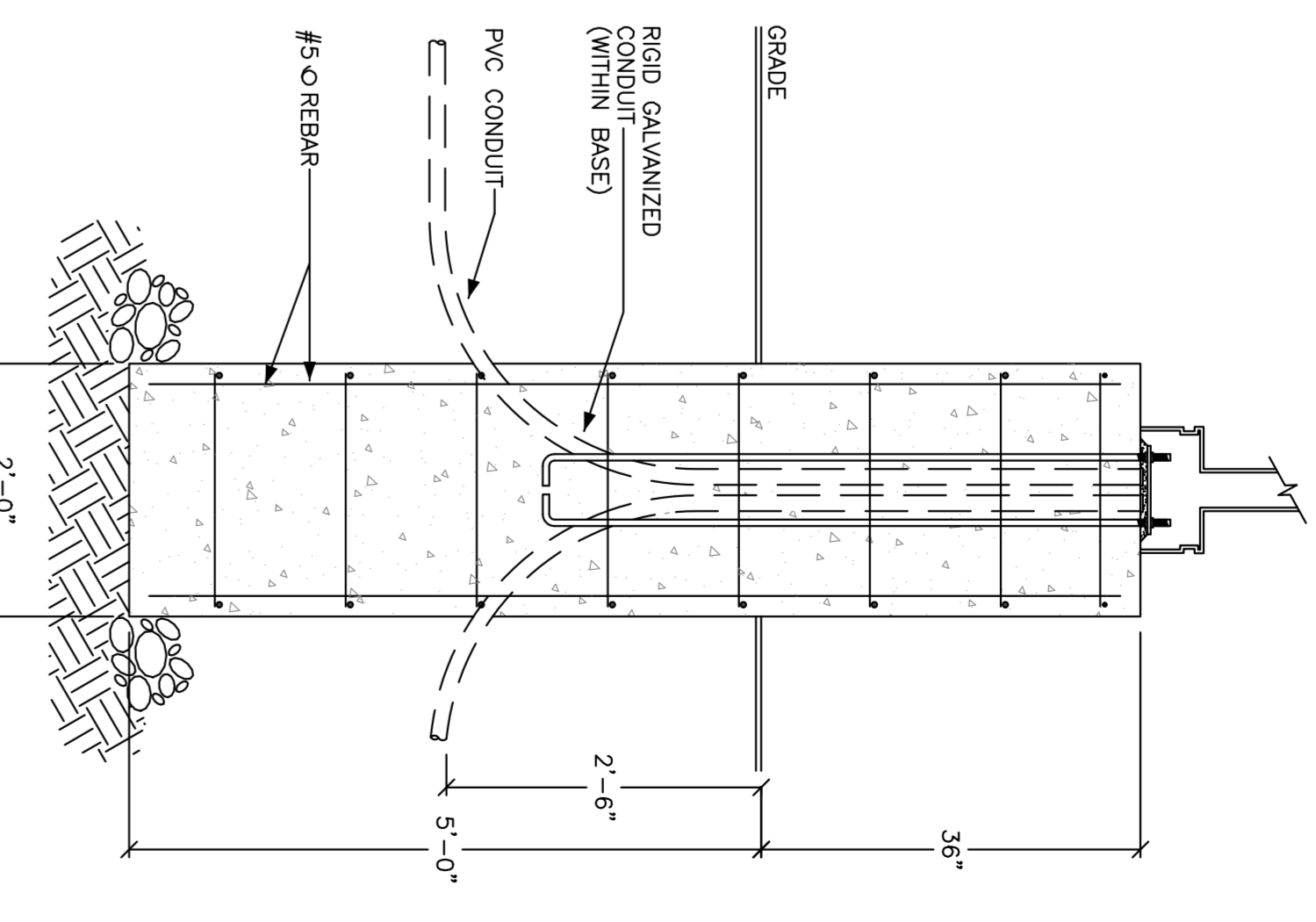

SITE LIGHTING PLAN - PART 1
 T = 30'

NOTES:
 1. SEE SHEET E1.1 FOR NOTES

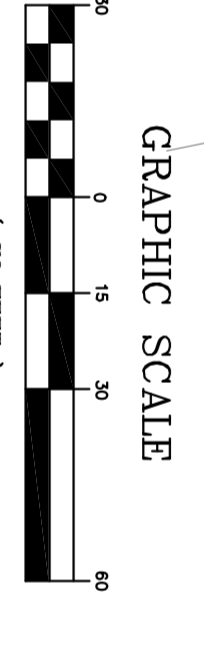

REV	DATE	DESCRIPTION	REVISIONS
2	07/23/14	SUBMITTED FOR UTILITY COMPANY REVIEW	
1	07/01/14	SUBMITTED FOR CLIENT REVIEW	

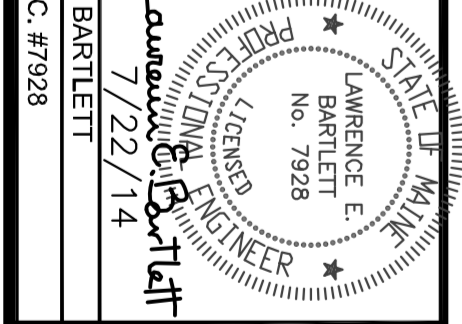

PROJECT: BRICK NORTH BUILDING AT THE FOREFRONT AT THOMPSON'S POINT
 SHEET TITLE: SITE LIGHTING PLAN
 CLIENT: FOREFRONT PARTNERS | LP

Bartlett Design
 Lighting & Electrical Engineering
 848 WASHINGTON STREET, BATH, ME 04500
 TEL (207) 448-3447 FAX (207) 448-3580

FST
 FAY, SPOFFORD & THORNDIKE
 ENGINEERS - PLANNERS - SCENARISTS
 718 MAIN ST SUITE B, SOUTH PORTLAND, ME 04106
 TEL (207) 448-3447 FAX (207) 448-3580

DRAWN: JLC DATE: 07/01/2014
 DESIGNED: LEB SCALE: 1" = 30'-0"
 FILE NAME: LEB JOB NO.: 282205
 SHEET: E2.1