

EXISTING PAVEMENT TO REMAIN AS TRACKING PAD. SWEEP CLEAN DAILY OR AS REQUIRED TO PREVENT TRACKING SEDIMENT ALONG THOMPSON'S POINT CONNECTOR ROAD. SHOULD SEDIMENT BE TRACKED OFFSITE CONTRACTOR IS RESPONSIBLE FOR SWEEPING / CLEARING PAVEMENT AS NECESSARY

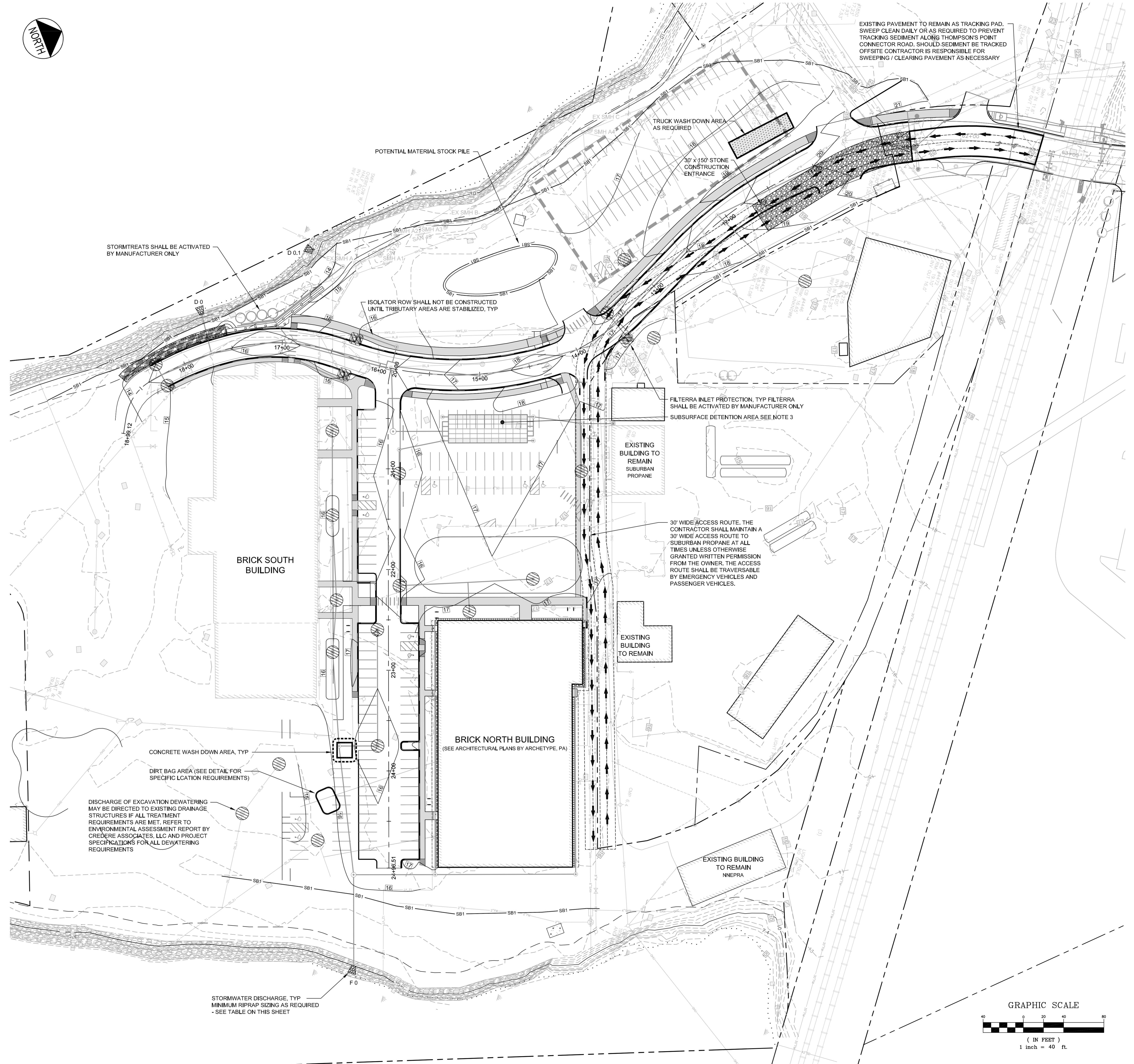

SCHEDULE OF SILT FENCE REQUIREMENTS

SILT FENCE	TYPE PURPOSE	TIME OF INSTALLATION
SB1	TYPE 1 SILT FENCE	AT INITIAL SITE PREPARATION: PRIOR TO OTHER WORK

- NOTES:
1. ALL RUNOFF FROM DISTURBED AREAS SHALL BE DIRECTED TO A FILTERING DEVICE DESIGNATED TO LIMIT TURBIDITY IN ALL DISCHARGE TO THE FORE RIVER. THE FILTERING DEVICE MAY BE BUT IS NOT LIMITED TO SAND FILTERS, EROSION CONTROL MIX, STRAW WHATTLES, FLOCCULATION CHEMICALS, DIRT GLUE AND SILT FENCE
 2. ALL CATCH BASINS TO HAVE 4" UNDERDRAIN PER DETAIL 'L' ON SHEET C-4.5
 3. ALL SUBSURFACE DETENTION AREAS ARE NOT TO BE PLACED "ON-LINE" UNTIL TRIBUTARY AREA IS STABILIZED WITH PAVEMENT OR 75% VEGETATION COVERAGE
 4. STOCKPILES TO BE TEMPORARILY SEEDED AND MULCHED AS REQUIRED BY THE PROJECT SPECIFICATIONS
 5. THE CONTRACTOR SHALL TREAT DISTURBED AREAS AND CONSTRUCTION HAUL PATH WITH DUST CONTROL BMPS TO LIMIT ALL FUGITIVE DUST

Discharge ID	Approximate Drainage Area (Ac)	Full Build Out 25 Yr Peak Flow (CFS)	Outlet Pipe Size (In)	Description	*Minimum Required Riprap D50 (In)
F0	1.88	9.6	36	RCP Flared End W/ Bar Rack, Riprap Slope Apron	12
D0	0.99	20.21	36	RCP Flared End W/ Bar Rack, Riprap Slope Apron	12
D0.1	1.4	0.018	12	HDPE Flared End, Riprap Slope Apron	Existing

* D50 is a median rock size. Riprap should be a well graded mix of angular rock from about 1.5 to 0.25 times the size of the D50. The contractor shall protect existing riprap slope or replace rock to the meet the minimum required D50 stone size.

	INLET PROTECTION (STONE OR HAY SEDIMENT BARRIER)
	FILTERRA INLET PROTECTION (PER MANUFACTURERS REQUIREMENTS)
	RIPRAP OUTLET PROTECTION
	CURLEX BLANKET
	EROSION CONTROL MESH
	30' WIDE ACCESS ROUTE
	WASH DOWN AREA
	STONE CONSTRUCTION ENTRANCE

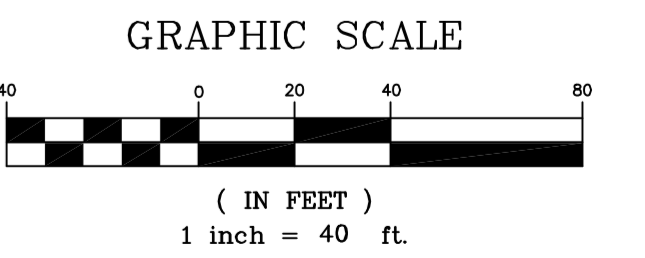

PRELIMINARY - NOT FOR CONSTRUCTION

REV	DATE	DESCRIPTION	REVISIONS
3	12.01.14	FINAL PHASE 1A SITE PLAN SUBMITTED TO CITY	
2	07.29.14	REVISED PHASE 1A SITE PLAN SUBMITTED TO CITY	
1	06.30.14	AMENDED PHASE 1A SITE PLAN SUBMITTED TO CITY	

P.E. BO KENNEDY
LIC. #11994

PROJECT: BRICK NORTH BUILDING AT THE FOREFRONT AT THOMPSON'S POINT

SHEET TITLE: STAND ALONE BRICK NORTH EROSION CONTROL PLAN

CLIENT: FOREFRONT PARTNERS | LP

DATE: JUNE 2014

SCALE: CITY OF PORTLAND

APPROVED SITE PLAN

Subject to Conditions of Approval and Standard Conditions

C-6.0 Dec 4, 2014

PLANNER: Christine Grimando

PROJECT NO.: 2014-120