

1
A1.02 FIRST FLOOR PLAN - LIFE SAFETY
1/8" = 1'-0"

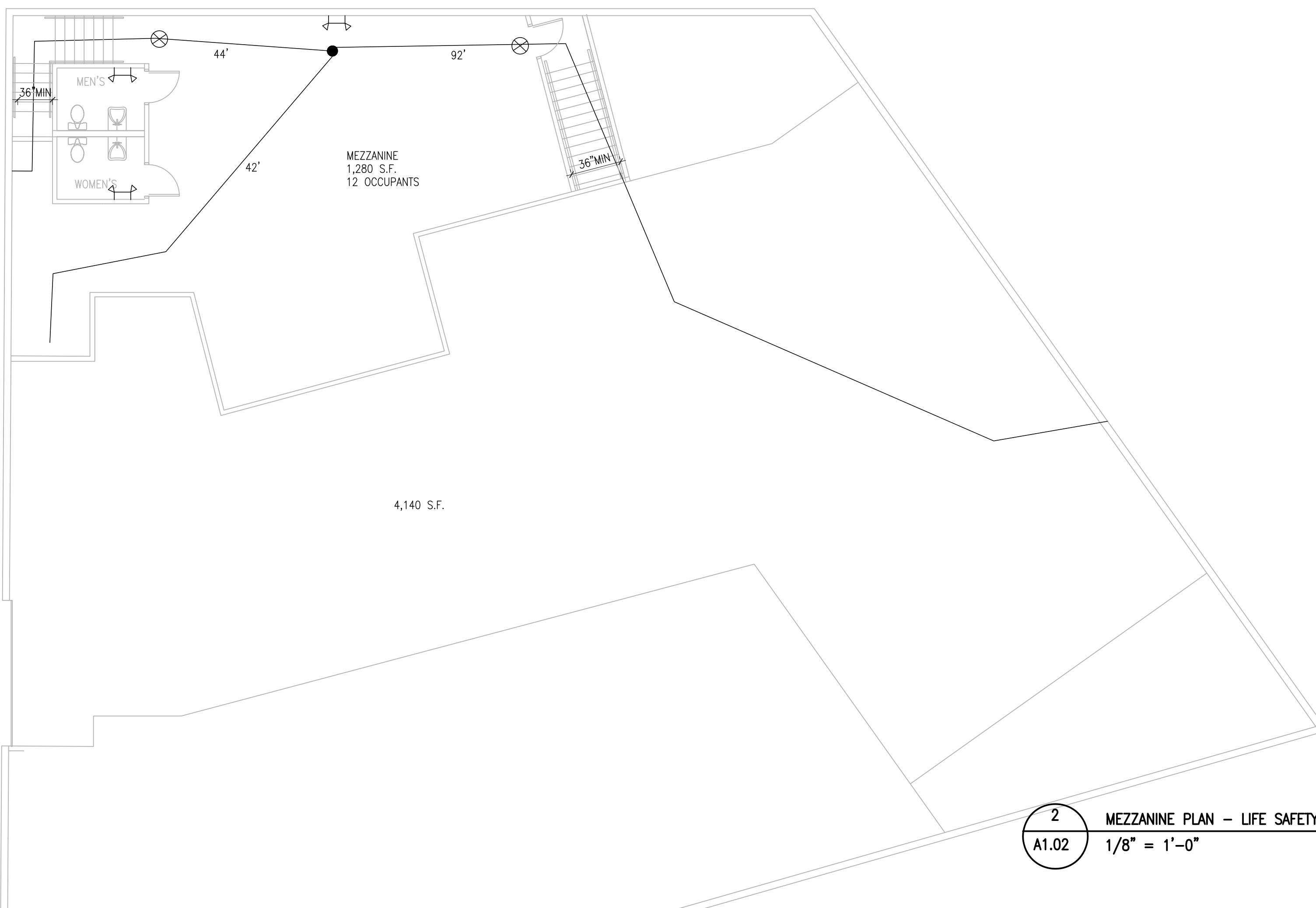

2
A1.02 MEZZANINE PLAN - LIFE SAFETY
1/8" = 1'-0"

NFPA 101 CODE ANALYSIS

OCCUPANCY TYPE - INDUSTRIAL	NFPA 101 40.1
W/ INCIDENTAL HIGH HAZARD INDUSTRIAL	NFPA 101 40.1.4.1.3 NOTE 2
ENCLOSE HIGH HAZARD AREA W/ 1 HR	NFPA 101 8.7.1.1 NOTE 1
WOOD PROCESSING - UNDER 2500 S.F.-NO SPRINKLER	NFPA 1 31.3.9
OCCUPANT LOAD -	
WORK STATION AREA - BY STATION - 13 OCCUPANTS	
WORKSHOP & LAB AREAS S.F./100	NFPA 101 TABLE 7.3.1.2
4+12+5 +1+17+4+4+12 = 59	
13 +60 = 72 OCCUPANTS	
36 MEN, 36 WOMEN	
NO MIN CONSTRUCTION REQUIREMENTS	NFPA 101 40.1.6
STAIRS TO MEZZ 36" MIN (OCCUPANT LOAD <50)	NFPA 101 7.2.2.2.1.2
2 MEANS OF EGRESS FROM HIGH HAZARD,	
TRAVEL DISTANCE <75'	NFPA 101 7.11.1
MIN 2 MEANS OF EGRESS PER STORY	NFPA 101 40.2.4.1.2
COMMON PATH <50' (UNSPRINKLED)	NFPA 101 TABLE 40.2.5
AREAS W/ INDUSTRIAL EQUIP OCCUPANCY <20	NFPA 101 40.2.5.2.2
TRAVEL DISTANCE <200' (UNSPRINKLED)	NFPA 101 TABLE 40.2.6
EMERGENCY LIGHTING REQUIRED	NFPA 101 7.9.1.1
EGRESS SIGNS REQUIRED	NFPA 101 40.2.10 7.10.1.2.1
INTERIOR FINISHES - CLASS A,B OR C IN OPERATING AREAS	NFPA 10140.3.3.2
EXIT ENCLOSURES CLASS A OR B	NFPA 101 7.1.4.1
FIRE ALARM SYSTEM TO BE INSTALLED PER REQUIREMENTS OF PORTLAND CITY FIRE	

NOTES:

1. CONFIRM LOCATION OF PORTABLE FIRE EXTINGUISHERS W/ CITY FIRE
2. HARDWARE ON ALL EXIT DOORS TO BE EXIT DEVICE
3. ALL PAINTS AND FLAMMABLE MATERIALS TO BE IN STORAGE AREAS/CABINETS



Prepared For:

Consultant:

Architect:

ARCHETYPE
48 Union Wharf Portland, Maine 04101
(207) 772-6022 Fax (207) 772-4056

Project:

OPEN BENCH
10 THOMPSON'S POINT
PORTLAND, ME

Revisions:

7-15-2016
SUBMISSION TO CITY

Scale: AS NOTED

Date: 6-22-2016

LIFE SAFETY PLAN

A1.02