

Prepared For:

Consultant:

Architect:

Project:

Revisions:

Date:

Scale:

Date:

THOMPSON'S POINT-
BRICK SOUTH
THOMPSON'S POINT,
PORTLAND ME

ARCHETYPE

8/22/2016 - RESPONSE TO CITY

8-5-2016

3/32" = 1'-0"

PLANS

A1.01

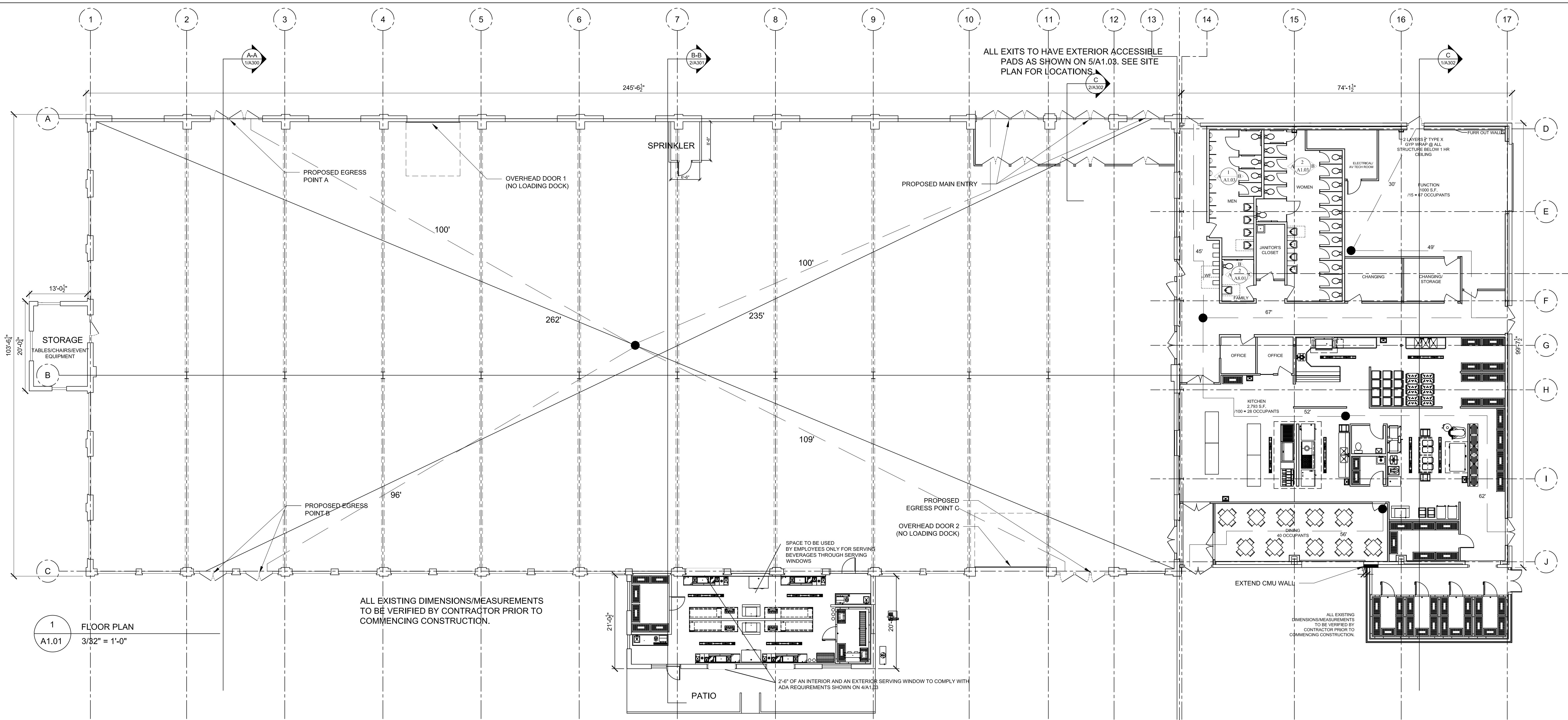

ALL EXITS TO HAVE EXTERIOR ACCESSIBLE PADS AS SHOWN ON 5/A1.03. SEE SITE PLAN FOR LOCATIONS.

ALL EXISTING DIMENSIONS/MEASUREMENTS TO BE VERIFIED BY CONTRACTOR PRIOR TO COMMENCING CONSTRUCTION.

1 FLOOR PLAN
A1.01
3/32" = 1'-0"

BUILDING 1 ← → BUILDING 2

BUILDING 1

IBC 2009
 3A CONSTRUCTION, 25,229 S.F.
 ALLOWABLE - 14,000(4) = 56,800 S.F.
 NEW ASSEMBLY OCCUPANCY - A2 OR A3
 OCCUPANCY - 2,500 - FOR BOTH BUILDINGS COMBINED (POSTED AND WRITTEN DOCUMENTATION)
 INDIVIDUAL OCCUPANCIES OF ROOMS IN EAST ANNEX NOTED ON PLAN
 (ACTUAL OCCUPANCY - ASSEMBLY - CONCENTRATED - 25,229 / 7 = 3,604 OCCUPANTS, UNCONCENTRATED - 25,229 / 7 = 1,882 OCCUPANTS)

LEVEL 3 ALTERATION
 FINISHES - EXITS (B), ENCLOSED SPACES (C)
 SPRINKLER REQUIRED
 NO FIRE EXTINGUISHER REQUIRED
 SPACES WITH OCCUPANCY < 50 ONLY 1 EXIT
 MEANS OF EGRESS ILLUMINATION REQUIRED
 ALL EXITS WILL HAVE ACCESSIBLE EXITING
 EXIT SIGNS REQUIRED
 COMMON PATH OF TRAVEL < 75'
 EXIT ACCESS TRAVEL DISTANCE < 250'

EXITS GROUPED
 TRAVEL DISTANCE < 250' (SPRINKLED)
 AT LEAST 1 ACCESSIBLE ENTRANCE
 SYSTEM INITIATED ALARM REQUIRED W/ VOICE/ALARM

TABLE 503, 506.3
 CONSTRUCTION TYPE 3A - PROTECTION THROUGH PERFORMANCE ANALYSIS AND SPRINKLER SYSTEM - DONE BY FIRE RISK MANAGEMENT IN COORDINATION WITH CITY FIRE.
 25,229 S.F.
 NEW ASSEMBLY OCCUPANCY
 OCCUPANCY - 2,500 (BOTH BUILDINGS, POSTED)
 DOES NOT EXCEED 1 PERSON IN 7'
 SPRINKLED
 CAPACITY FACTOR - LEVEL COMPONENTS - .2
 2,500(.2) = 500'
 500'/34' = 14.7 = 15 DOORS REQUIRED FOR EXITING (19 SHOWN)
 EXIT DOORS TO BE GROUPED
 COMMON PATH OF TRAVEL < 20'
 TRAVEL DISTANCE TO EXITS < 250'
 DEAD END CORRIDORS < 20'
 EMERGENCY LIGHTING REQUIRED
 SHOWN ON E102
 COOKING EQUIPMENT PROTECTED
 FIRE ALARM REQUIRED

IBC TABLE 803.9
 IBC 903.2.1.2
 IBC 903.2.1.3
 IBC 906.1 EX 1
 IBC 1006.1
 IBC 1007.1
 IBC 1011.1
 IBC 1014.3
 IBC TABLE 1016.1
 IBC 1028.2
 IBC 1028.7
 IBC 3411.4.2
 IBC 907.2.1.1

FIXTURE COUNT FOR BOTH BUILDINGS

PLUMBING CALCULATIONS BASED ON AN ASSEMBLY
 A-2 OCCUPANCY OF 2,500 (TOTAL FOR MAIN ASSEMBLY BUILDING & EAST ANNEX COMBINED)
 UPC

- MALES - 4 WC & 7 URINALS
- FEMALES - 18 WC (FAMILY TOILET TO COUNT)
- 1 FAMILY TOILET ROOM
- 6 DRINKING FOUNTAINS
- 1 SERVICE SINK

NFPA 12.7.9.3
 NFPA 12.1.7.1.2
 NFPA 12.3.5.2
 NFPA TABLE 7.3.3.1
 NFPA 12.2.3.6.2
 NFPA 12.2.5.1.2
 NFPA 12.2.6.2 EX.1
 NFPA 12.2.5.1.3
 NFPA 12.2.9.1
 NFPA 9.2.3
 NFPA 12.3.4.1.1

BUILDING 2

IBC 2009
 3A CONSTRUCTION, 7,384 S.F.
 ALLOWABLE - 9,500(4) = 38,000 S.F.
 NEW ASSEMBLY OCCUPANCY - A2 OR A3
 OCCUPANCY - 2,500 - FOR BOTH BUILDINGS COMBINED (POSTED AND WRITTEN DOCUMENTATION)
 INDIVIDUAL OCCUPANCIES OF ROOMS IN EAST ANNEX NOTED ON PLAN
 OCCUPANCIES MARKED BY SPACE ON PLAN

LEVEL 3 ALTERATION
 FINISHES - EXITS (B), ENCLOSED SPACES (C)
 SPRINKLER REQUIRED
 NO FIRE EXTINGUISHER REQUIRED
 SPACES WITH OCCUPANCY < 50 ONLY 1 EXIT
 MEANS OF EGRESS ILLUMINATION REQUIRED
 ALL EXITS WILL HAVE ACCESSIBLE EXITING
 EXIT SIGNS REQUIRED
 COMMON PATH OF TRAVEL < 75'
 EXIT ACCESS TRAVEL DISTANCE < 250'

TRAVEL DISTANCE < 250' (SPRINKLED)
 AT LEAST 1 ACCESSIBLE ENTRANCE
 FIRE EXTINGUISHER WITHIN 30' COMMERCIAL COOKING EQUIP
 SYSTEM INITIATED ALARM REQUIRED W/ VOICE/ALARM

TABLE 503, 506.3
 CONSTRUCTION TYPE 3A
 7,384 S.F.
 NEW ASSEMBLY OCCUPANCY
 OCCUPANCY - 2,500 (BOTH BUILDINGS, POSTED)
 EAST ANNEX OCCUPANCY PER SPACE, SEE PLAN
 SPRINKLED
 COMMON PATH OF TRAVEL < 75' (OCCUPANT LOAD < 50)
 TRAVEL DISTANCE TO EXITS < 250'
 DEAD END CORRIDORS < 20'
 EMERGENCY LIGHTING REQUIRED
 SHOWN ON E101
 COOKING EQUIPMENT PROTECTED
 FIRE ALARM REQUIRED

IBC TABLE 803.9
 IBC 903.2.1.2
 IBC 903.2.1.3
 IBC 906.1 EX 1
 IBC 1006.1
 IBC 1007.1
 IBC 1011.1
 IBC 1014.3
 IBC TABLE 1016.1
 IBC 1028.7
 IBC 3411.4.2
 IBC 906.1.2
 IBC 907.2.1.1

NFPA 12.7.9.3
 NFPA 12.1.7.1.2
 NFPA 12.3.5.2
 NFPA 12.2.5.1.2
 NFPA 12.2.6.2 EX.1
 NFPA 12.2.5.1.3
 NFPA 12.2.9.1
 NFPA 9.2.3
 NFPA 12.3.4.1.1