

PROPOSED USE GROUP A-3 GYMNASIUM
WITHOUT SPECTATORS

TOTAL SQUARE FOOTAGE
27,124 SQFT

AREA TO BE USED: 8,960 SQFT

CONSTRUCTION TYPE IIIB

MAX PROPOSED TEMPORARY OCCUPANCY = 49

EXISTING EXIT CAPACITY W DOOR
MODIFICATIONS
14 LN .FT. / .2" /PERSON = 840

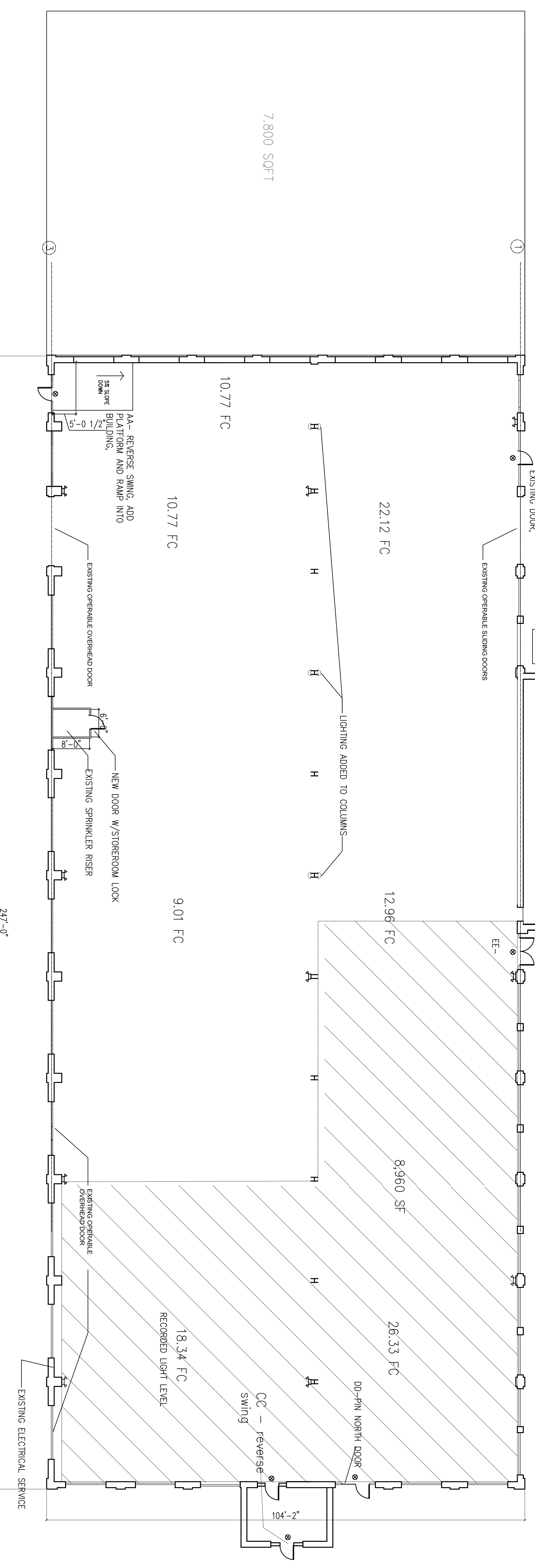

- SCOPE OF WORK
1. POWER WASH SLAB
 2. APPLY EPOXY TO ANY RUTS GREATER THAN 1/2" DEEP IN SLAB
 3. IN RUTS $\frac{1}{2}$" FLASH ANY TRIPPING EDGES
 4. REMOVE ANY PROTRUDING METAL IN SLAB
 5. ALL EXITS DOORS TO HAVE EXIT HARDWARE
 6. ELECTRICAL WORK IS LIMITED TO LIFE SAFETY AND AREA LIGHTING AS INDICATED BELOW

NOTE: THERE IS NO MECHANICAL OR PLUMBING WORK

AREA TO BE USED BY
CIRCUS (8,960 s.f.)
INSTALL LIGHTING TO A
LEVEL OF 10 ft /SF AT
3' off
PROVIDE PHOTOMETRIC
DATA WITH SHOP
DRAWING

A1.01	Date: 9-2-2014	Scale: 3/32" = 1'-0"	Revisions:	Project: THOMPSON'S POINT- BRICK SOUTH	Architect: ARCHETYPE	Consultant:	Prepared For:	
	FIRST FLOOR PLAN				THOMPSON'S POINT, PORTLAND ME	48 Union Wharf Portland, Maine 04101 (207) 772-6022 Fax (207) 772-4056		