

1  
FIRST FLOOR PLAN  
A1.01 1/8" = 1'-0"

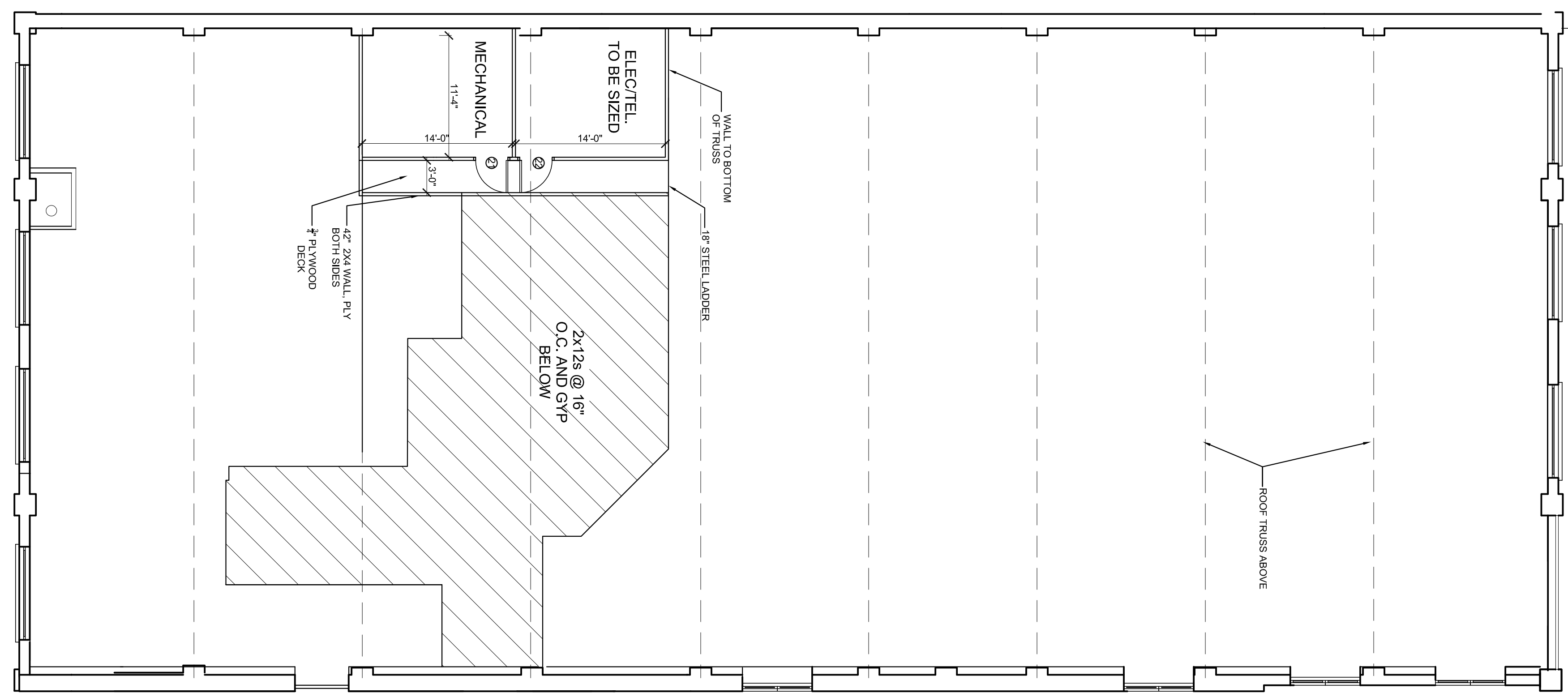

2  
SECOND FLOOR PLAN  
A1.01 1/8" = 1'-0"

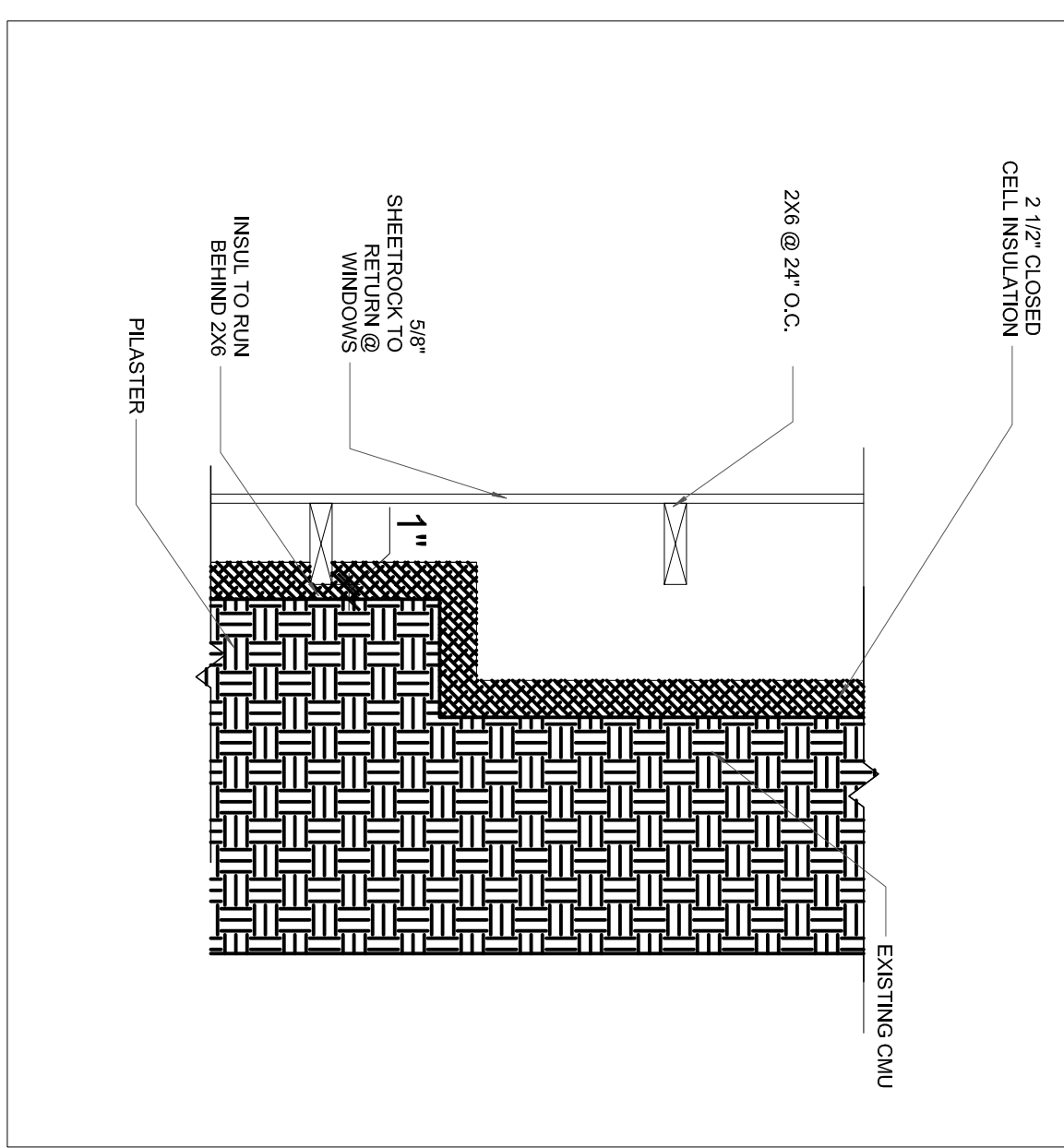

3  
WEST WALL DETAIL  
A1.01 1" = 1'-0"

<b>A1.01</b>	Date: 9-2-2014	Scale: 1/8" = 1'-0"	Revisions:	Project: <b>BRICK NORTH WEST WING PHASE I</b>	Architect: <b>ARCHETYPE</b>	Consultant:	Prepared For:	
	<b>FLOOR PLANS</b>			THOMPSON'S POINT, PORTLAND ME	48 Union Wharf Portland, Maine 04101 (207) 772-6022 Fax (207) 772-4056			