

West Wing
 1st Floor - 8,885 s.f.
 2nd Floor - 3,912 s.f.
 total - 12,797

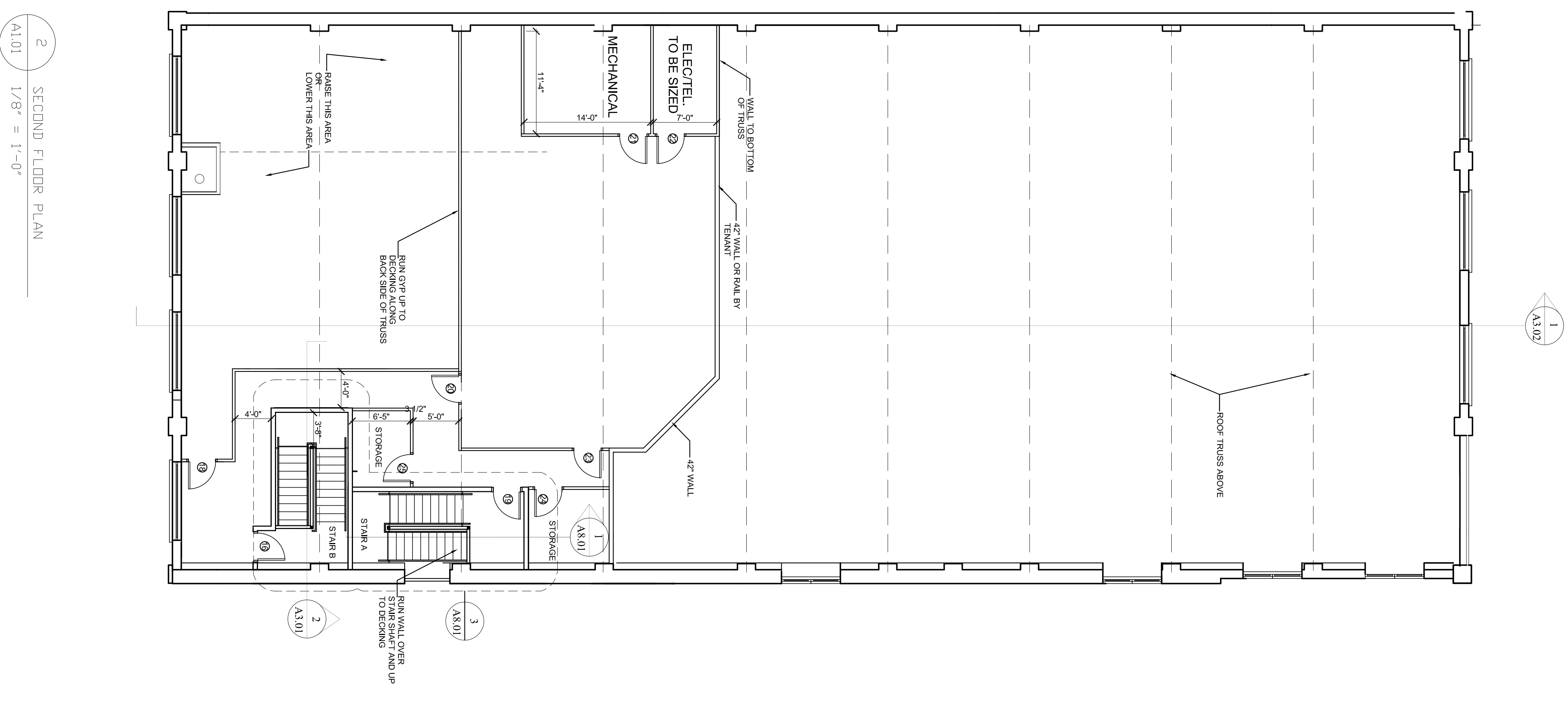

1 FIRST FLOOR PLAN
 A1.01 1/8" = 1'-0"

2 SECOND FLOOR PLAN
 A1.01 1/8" = 1'-0"

A1.01	Date: 8-13-2014	Scale: 1/8" = 1'-0"	Revisions: 8-13-14 ISSUED FOR PERMIT	Project: BRICK NORTH WEST WING	Architect: ARCHETYPE	Consultant:	Prepared For:
	FLOOR PLANS			THOMPSON'S POINT, PORTLAND ME	48 Union Wharf Portland, Maine 04101 (207) 772-6022 Fax (207) 772-4056		