

BRICK NORTH

Thompson's Point
Portland, ME

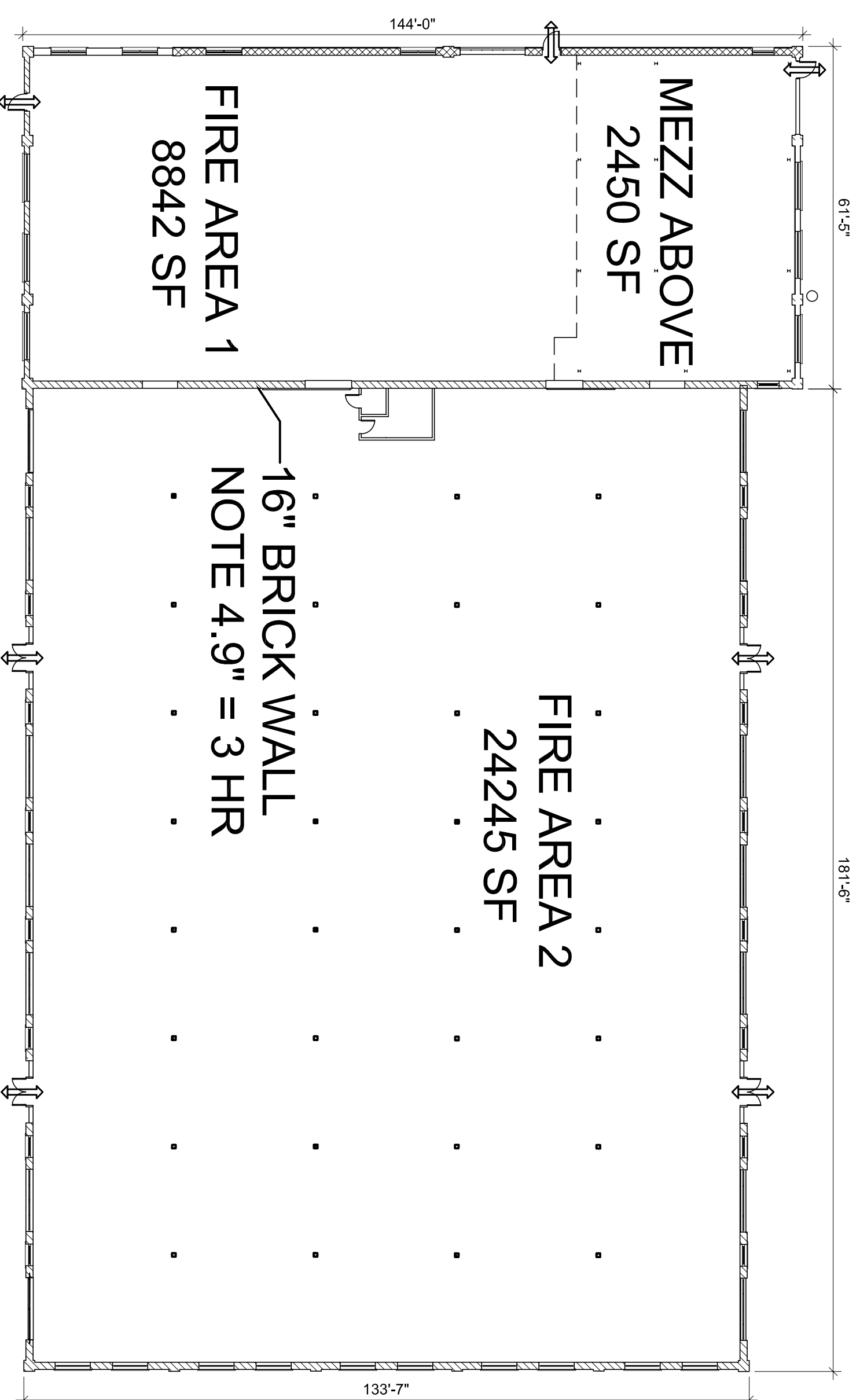
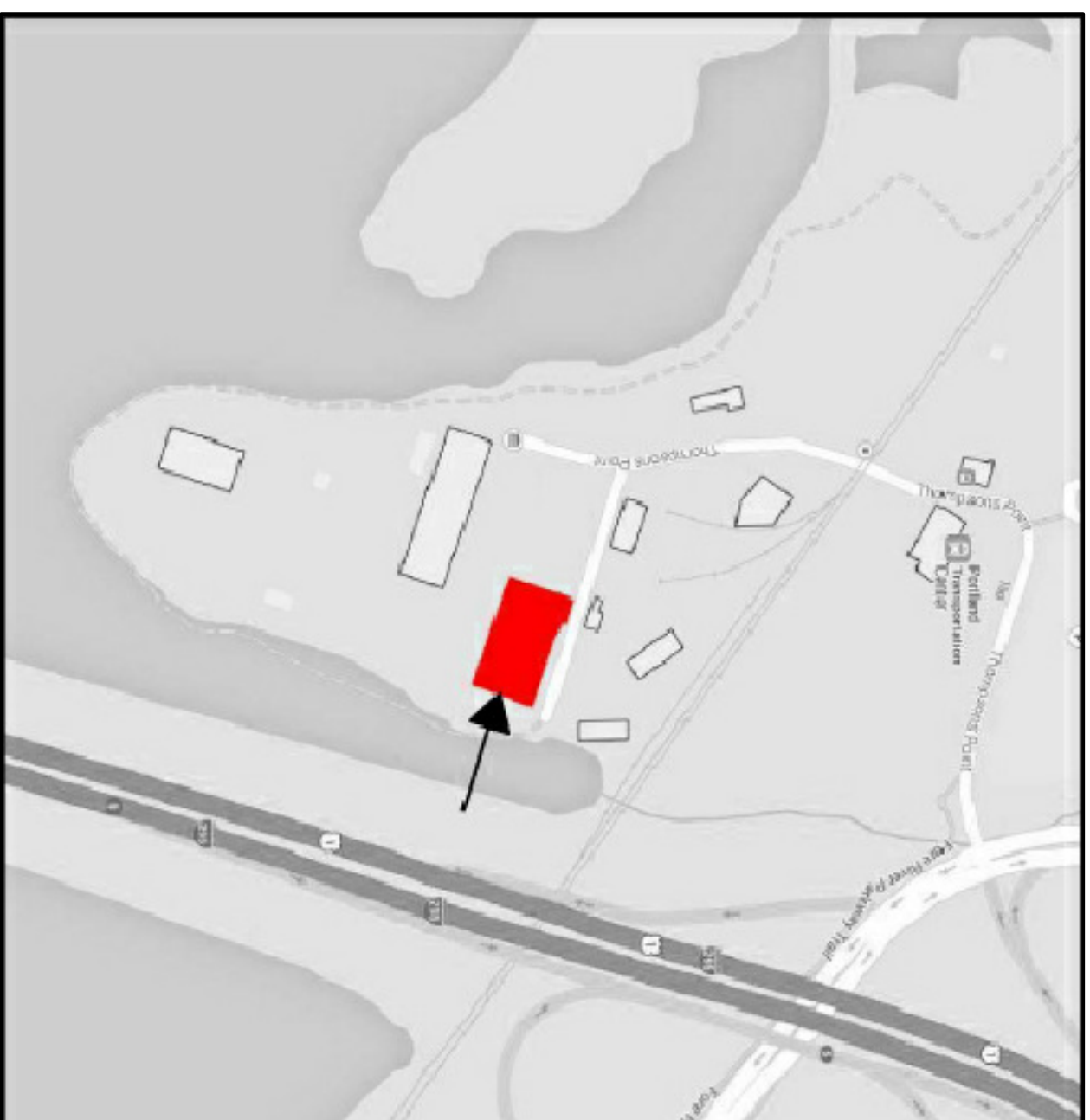

DRAWING LIST

- CIVIL DRAWINGS
- C1 Cover Sheet
- C2 Existing Conditions Demolition and Removals Plan
- C3 Site Layout and Utility Plan
- C4 Grading Drainage and Erosion Control Plan
- C5 Details
- C6 Fire Safety Compliance Plan
- STRUCTURAL DRAWINGS
- S102 Existing Roof Framing Plan
- S103 Existing Roof Framing Plan
- S201 Sections, Details and General Notes
- S202 Sections, Details and General Notes
- ARCHITECTURAL DRAWINGS
- A1.01 First Floor
- A1.02 Mezzanine
- A1.03 Roof Plan
- A2.01 Building Elevations
- A2.02 Building Elevations
- A3.01 Building Section & Window Types
- AD1.01 Demo Plan
- MECHANICAL
- M-101 NEW MECHANICAL LAYOUT

CONTACTS

Developer:
Thompson's Point
Development
55 Lisbon Street
Lewiston, ME
04240
(207) 347 1614

Structural Engineer:
Velias & Velias
639 Granite Street, Suite 101
Braithree, MA
02184
(781) 843 2863

Mechanical Engineer:

Sparthawk Group
81 Bridge Street, Suite 107
Yarmouth, ME
04096
(207) 846 7726

Architect:
Archetype Architects
48 Union Wharf
Portland, ME
04101
(207) 772 6022

Chill Engineer:
Fay, Spofford & Thornndike
778 Main Street, Suite 8
South Portland, ME
04100
(207) 775 1121

RELEVANT CODES

INTERNATIONAL BUILDING CODE
CONSTRUCTION TYPE 3B
EXISTING FOOTPRINT
SPRINKLED W/ NFPA 13

REFERENCE
310
T601
903.0.1.1

NFPA 101 - 2006
CONSTRUCTION TYPE III(000)
SPRINKLED W/NFPA 13
DEAD END CORRIDOR < 50 FT.
AREA OF REFUGE NOT REQUIRED
EXISTING HANDRAILS AND STAIRS

REFERENCE
NFPA 618
NFPA TABLE A.8.2.12
30.2.5.4.2
30.2.2.12.1
43.10.3.7.2

HEIGHT AND AREA
POTENTIAL OCCUPANCY USES ARE A-2, B, M, S-1
A-2 IS MOST RESTRICTIVE
A-2 = 9600 SF X 300% = 28,500 SF
NOTE: FIRE AREA 2 = 24,245 SF
NOTE: FIRE AREA 1 = 8,842 SF
ALLOWABLE HEIGHT = 55 FT, EXISTING = 40'-4" FT

FIRE RATINGS
FIRE RESISTANCE RATING STRUCTURAL FRAME (0 HOUR)
FIRE RESISTANCE RATING OF EXTERIOR BEARING WALLS 2 HOURS
FIRE RESISTANCE RATING NON-BEARING WALLS AND PARTITIONS (0 HOURS)
FIRE RESISTANCE RATING FLOOR CONSTRUCTION (0 HOUR)
FIRE RESISTANCE RATING ROOF CONSTRUCTION (0 HOUR)
CORRIDOR RATING (0 HOURS)

504.2
T601
T601
T601
T601
T601
1018.1

MEANS OF EGRESS
OCCUPANT CAPACITY FIRE AREA 1 = 2" PER OCC X 105" WIDTH = 525 OCCUPANTS
OCCUPANT CAPACITY FIRE AREA 2 = 2" PER OCC X 284" WIDTH = 1420 OCCUPANTS
MINIMUM REQUIRED CORRIDOR WIDTH - 44"
MINIMUM REQUIRED CORRIDOR WIDTH - 44"
ROOF ACCESS
DEAD END CORRIDORS < 20 FT.

1003
1005.1
1005.1.2
1018.2
1018.2
1018.4 EX. 2
1018.4 EX. 2
1018.1

DRAFT STOPPING OR SPRINKLE CONCEALED SPACES NA
SPRINKLE (20 FT ABOVE GRADE) NA
FIRE RISK ASSESSMENT REQUIRED
ALARM REQUIRED

717.3.2 (EX. 2)
903.2.1
903.2.1 (EX. 2)
907.2.9 (EX. 2)

REMOVE 1
REMOVE 1
REMOVE 1

1 - REVISED 2/4/2014