

Stantec Consulting Services Inc.
 5 Dartmouth Drive, Suite 101
 Auburn NH U.S.A.
 03032-3984
 Tel. 603.669.8672
 Fax. 603.669.7636
 www.stantec.com

Copyright Reserved
 The Contractor shall verify and be responsible for all dimensions. DO NOT scale the drawing - any errors or omissions shall be reported to Stantec without delay.
 The Copyrights to all designs and drawings are the property of Stantec. Reproduction or use for any purpose other than that authorized by Stantec is forbidden.

Consultants
 Legend

Notes

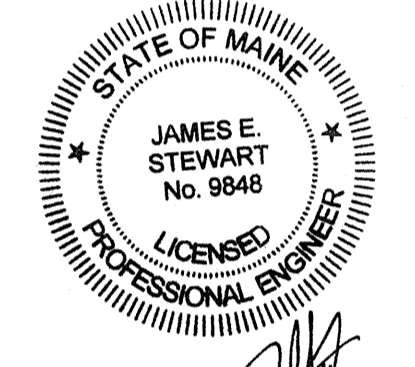

9-27-13

Revision	By	Appd.	YY.MM.DD

ISSUE FOR PERMIT	JES	JES	13.09.27
ISSUE FOR BID	JES	JES	13.09.10
Issued			

File Name: 01_191711186_FS.G.dwg JKM JSW/JES JKM 13.07.30
 Dwn. Chkd. Dsgn. YY.MM.DD



Client/Project
 THE HERTZ CORPORATION

ABOVEGROUND STORAGE TANK
 INSTALLATION AND RELATED WORK
 PORTLAND, ME

Title
 LOCUS MAP, AERIAL VIEW, ABBREVIATIONS & LEGENDS AND SITEKEY PLAN

Project No.	Scale	
191711186	AS NOTED	
Drawing No.	Sheet	Revision
FS.G.3	3	of 19

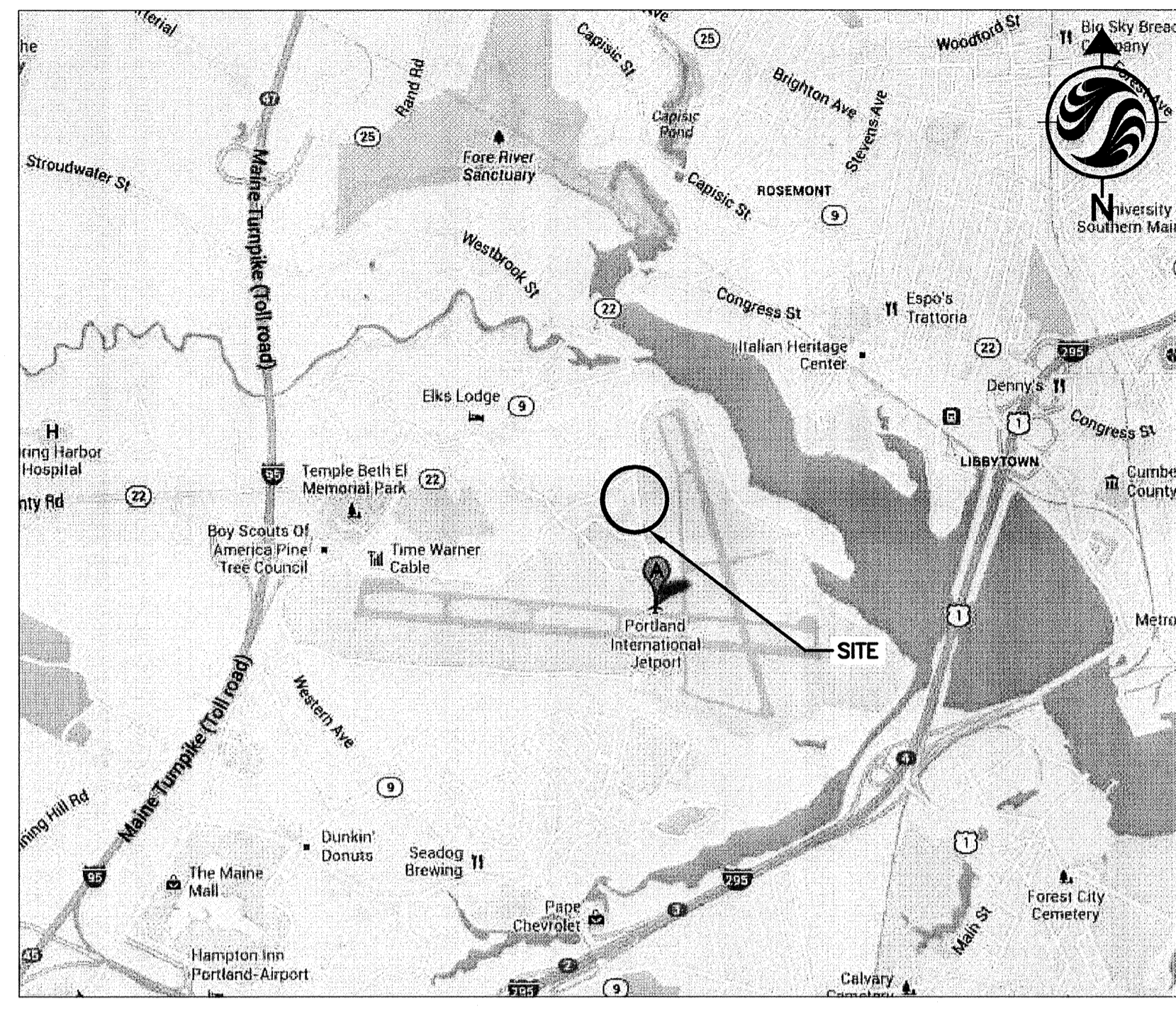

1 LOCUS MAP
 FS.G.3 SCALE: AS SHOWN



2 AERIAL VIEW
 FS.G.3 SCALE: AS SHOWN

ABBREVIATIONS

AG	ABOVEGROUND
AST	ABOVEGROUND STORAGE TANK
ATG	AUTOMATIC TANK GAUGE
BLK	BLACK
CONT	CONTINUATION
DIA.	DIAMETER
DW	DOUBLE WALL
EMT	ELECTRICAL METALLIC TUBING
E-STOP	EMERGENCY STOP
FRP	FIBERGLASS REINFORCED PLASTIC
GAP	GASOLINE ADVERTISING PRODUCTS
GLV	GALVANIZED
HLA	HIGH LEVEL ALARM
I.S.	INTRINSICALLY SAFE
MFR	MANUFACTURER
N.T.S.	NOT TO SCALE
O.C.	ON CENTER
PL	PROPERTY LINE
RC	RIGID CONDUIT
RMC	RIGID METAL CONDUIT
SCH	SCHEDULE
SS	STAINLESS STEEL
STP	SUBMERSIBLE TURBINE PUMP
SW	SINGLE WALL
TBD	TO BE DETERMINED
TYP	TYPICAL
UG	UNDERGROUND
UPP	UPP PIPING PRODUCTS
UST	UNDERGROUND STORAGE TANK
VR	VAPOR RECOVERY

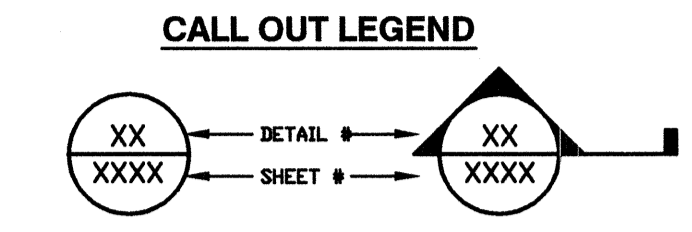

3 ABBREVIATIONS & LEGENDS
 FS.G.3 SCALE: N.T.S.

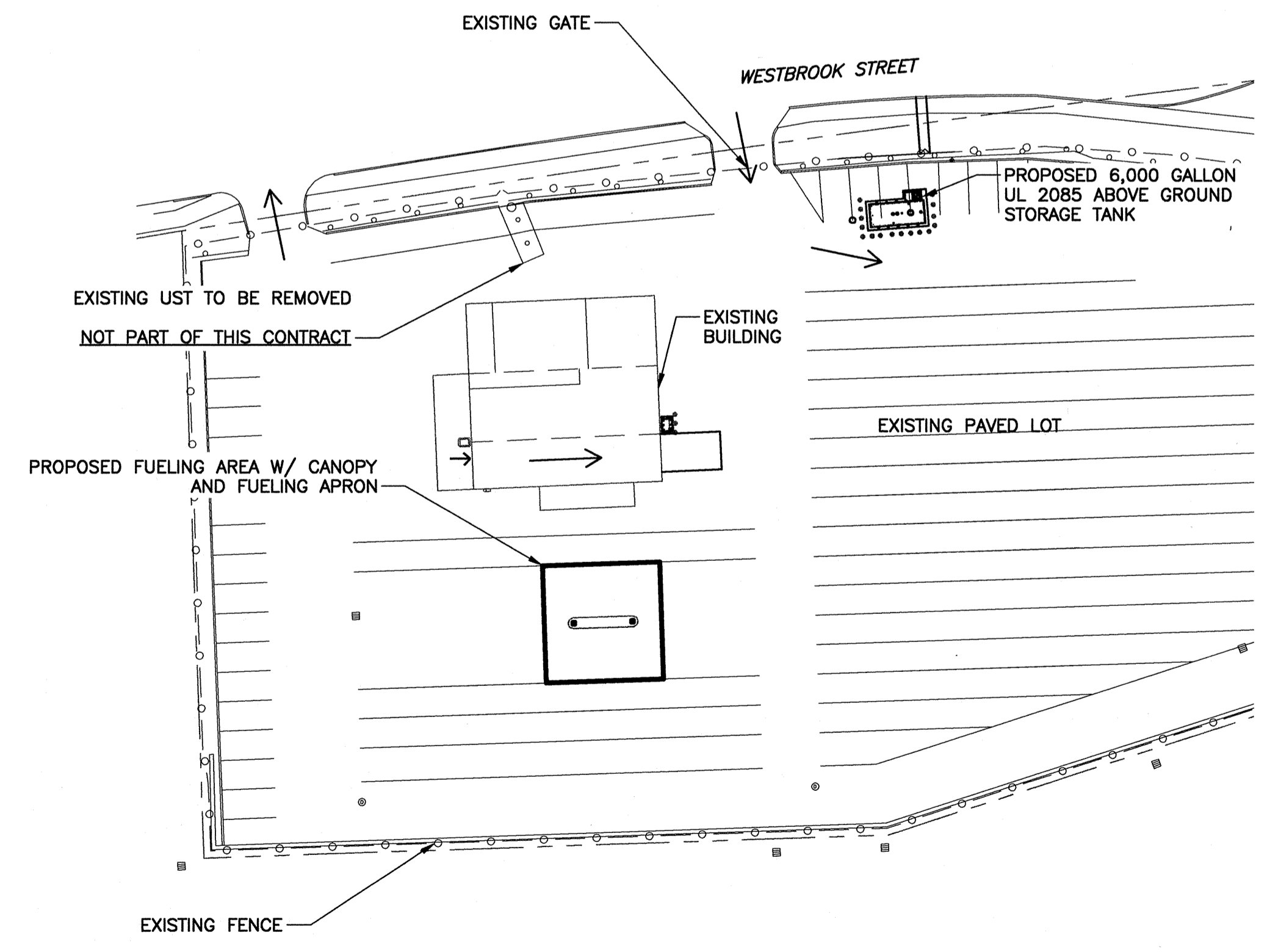

4 SITE KEY PLAN
 FS.G.3 SCALE: 1"=40'

1 6,000-gallon U/L 2085 Vaulted Aboveground Storage Tank - Includes:	
	Desert Sand Epoxy Finish
	Light Weight Concrete Insulation
	Primary and Secondary Working and Emergency Vents
	Pressure Vacuum Vent with 8ft. Steel Pipe Riser
	Overfill Prevention Valve - OPW Model #61S10p
	Tank Level Gauge - OPW Model #200TG
	Steps with handrails
	Two (2) inch Pressure/Vacuum Vent Cap (thread-on) - OPW #623V-2203
	Six (6) inch Tank Emergency Vent - OPW #201M-8081
	Red Jacket #P75U1RJ1 (70" - 98") Quickset 3/4 HP Submersible Pump
	Piping Transition Sump (fiberglass) - Bravo #B600-F3S-B
1 New Wayne Select Twin I - #3/G7247D/2GJK/K (Remote/Dual Hose/Single Product/Unleaded/Silver Panels/Mech. Totalizer)	
	1 Standard Fuel Filter - Petro Clear #PCL-40530P
	1 Mechanical Totalizer; Internal Filter
	2 3/4 inch dia./6" - 5" long Product Hose - VST-CP-078-058
	2 3/4 inch dia./6" - 0" long Product Hose - VST-CP-060-058
	2 3/4 inch Re-Connectable Safe-T-Break - OPW #66REC-1000
	2 Unleaded Dispenser Nozzle - OPW #11AP-0400
	2 45 Degree Hose Swivel - OPW #45-5060
	2 High Hose Retriever - Universal (includes flange base & upper pulley assembly) - #871
	2 3/4" Gasoline Hose Clamp - #CNI 8103
	1 Power Integrity 6-Circuit Surge Protec tor - Model #SMS-PS-06-06-15
	2 10 lb. 80:BC Fire Extinguisher - Potter #3010
	2 Fire Extinguisher Cabinet w. Decal - #7044-B
	2 Signage - CAS-HTZ1: In Case of Spill...
	2 Signage - CAS-HTZ7: Warning: No Smoking/Stop Motor/No Containers
	1 Signage - CAS-HTZ2: Driver Warning...
	1 Signage - CAS-HTZ3: Emergency Fuel Shut-Off Switch
	1 Signage - CAS-HTZ4: Veeder-Root High Level Alarm Sign - Remote Mount (18" x 8")
	2 Decal: Main Tank Label (Gasoline) - #CVD-HTZ15
	2 Decal: Vault Tank - No Smoking - #CVD-HTZ10
	2 Decal: Tank Content Label & Placard - #CVD-HTZ11
	1 Decal: Nozzle Operating Instructions & Overfill Warning - #D80
	2 NFPA Placard/Hazardous Materials Diamond Tank Label
	1 1/2" Emergency Shutoff Valve - OPW #10BFP5726
	1 Dispenser Base Form - Steel/Two Piece/6" Radius (3W x 4L x 13"H) - Morgan #MOIFE48613
	1 Dispenser Sump (single-walled fiberglass) - OPW Pisces #DSF-1630
	1 Stabilizer Bar Kit - OPW #SBK-1600
	1 Includes Rack Assembly - 3 Vent (including clamps and hardware) - Bravo #RS-500-JP-3S
	2 Containment/Dispenser Sump Sensor (Non-Discriminating Type) #794380-208
	1 Universal Mounting Kit (for containment/dispenser sump sensors) #330020-012
Veeder Root Equipment	
	1 Mag. Inventory Measurement Probe #846391-30X
	1 Mag. Probe Floats/Installation Kit (4-inch riser - 5-foot lead) #846400-000
	1 Mag. Probe Riser Cap and Ring Kit #312020-952
	1 Mag. Probe AST Installation Kit #312020-984
	1 Interstitial Leak Sensor #794390-420
	1 Interstitial Leak Sensor Cap and Adaptor #312020-928
	1 Overfill Alarm #790091-001
	1 Overfill Alarm Acknowledgement Switch #790095-001
	1 Simplex side-mounted fill assembly
	1 Vacuum Unit

5 OWNER SUPPLIED EQUIPMENT
 FS.G.3