

# NORTHEAST AIR-FIXED BASE OPERATOR

1011 WESTBROOK STREET  
 PORTLAND INTERNATIONAL JETPORT  
 PORTLAND, MAINE

**APPLICANT:**  
 NORTHEAST AIR  
 1011 WESTBROOK STREET  
 PORTLAND, MAINE 04102  
 TEL. 207-774-6318

**ENGINEER/SURVEYOR:**

**SEBAGO**  
 TECHNICS

WWW.SEBAGOTECHNICS.COM  
 75 John Roberts Rd. Suite 1A South Portland, ME 04106 Tel. 207-200-2100  
 250 Goddard Rd. Suite B Lewiston, ME 04240 Tel. 207-783-5656

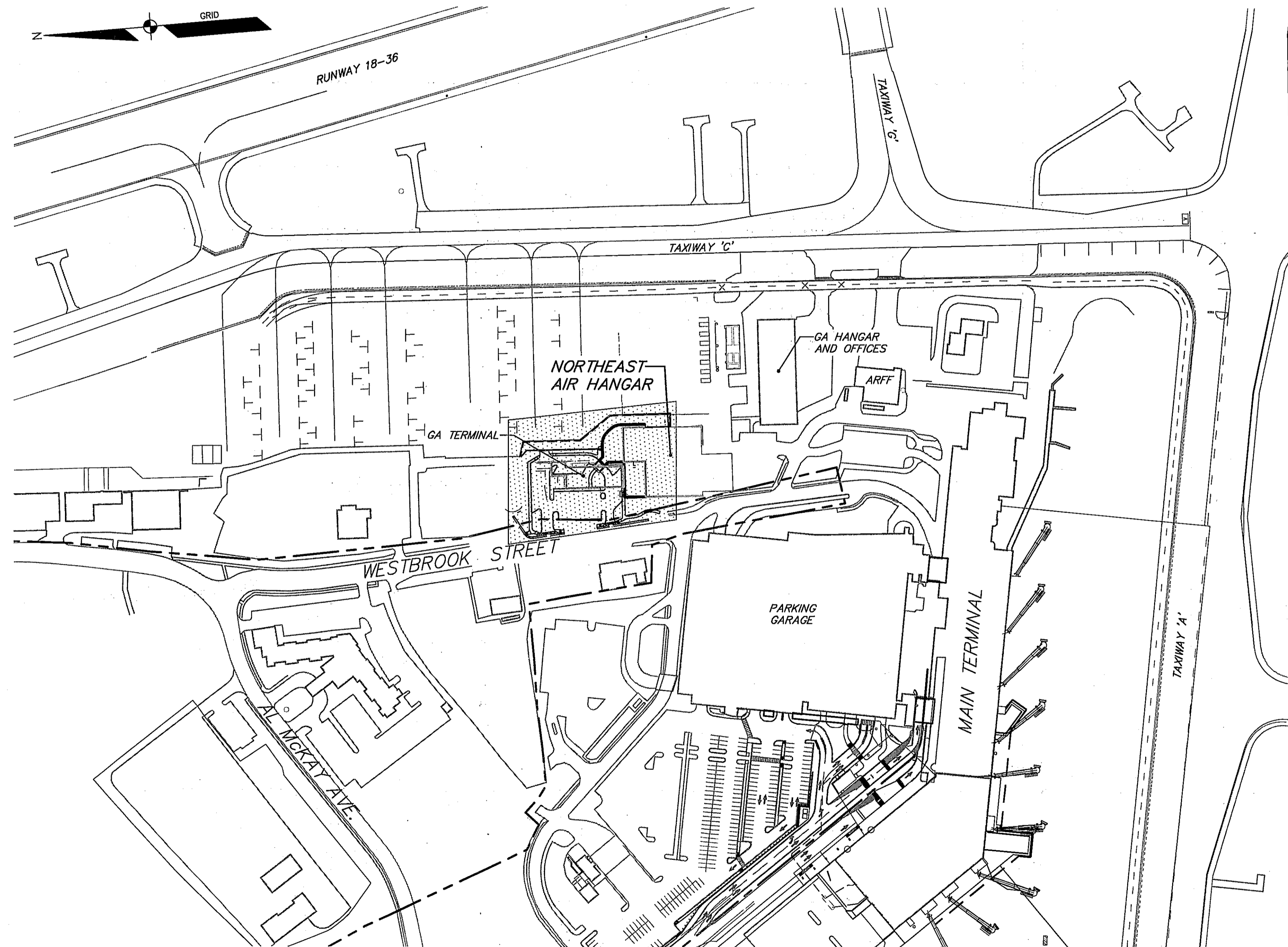

SCALE: 1" = 150'

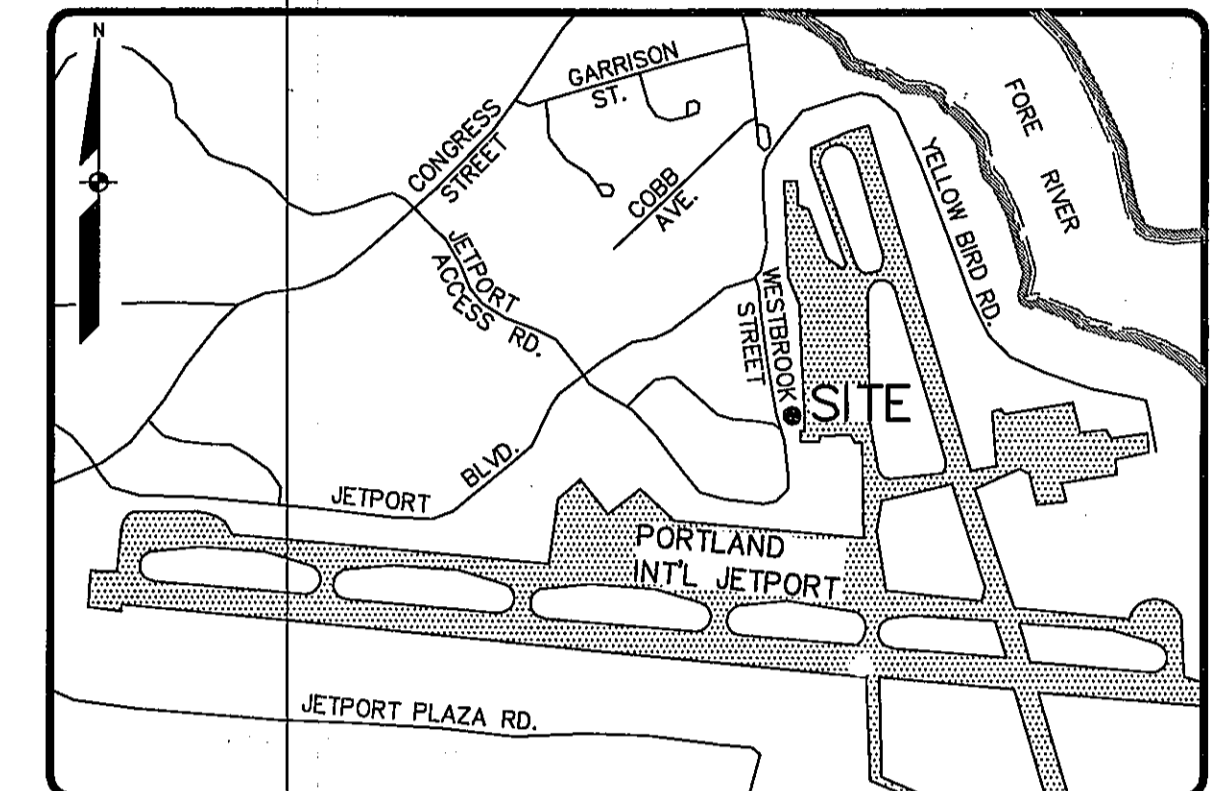

LOCATION MAP

NTS

## SHEET INDEX

SHEET	TITLE
1	COVER SHEET
2	EXISTING CONDITIONS PLAN
3	SITE PLAN
4	GRADING AND UTILITY PLAN
5	LANDSCAPE PLAN
6	DETAILS
7	DETAILS
8	DETAILS
9	DETAILS
10	POST DEVELOPMENT TREATMENT PLAN

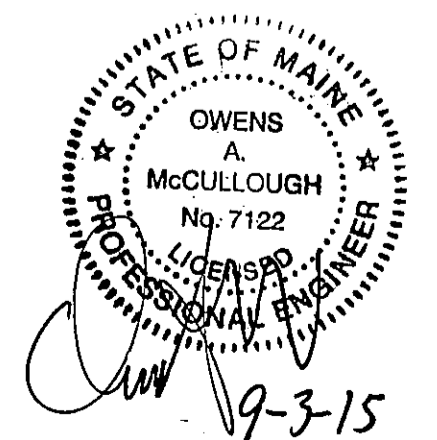

REVISED THROUGH 09-03-15

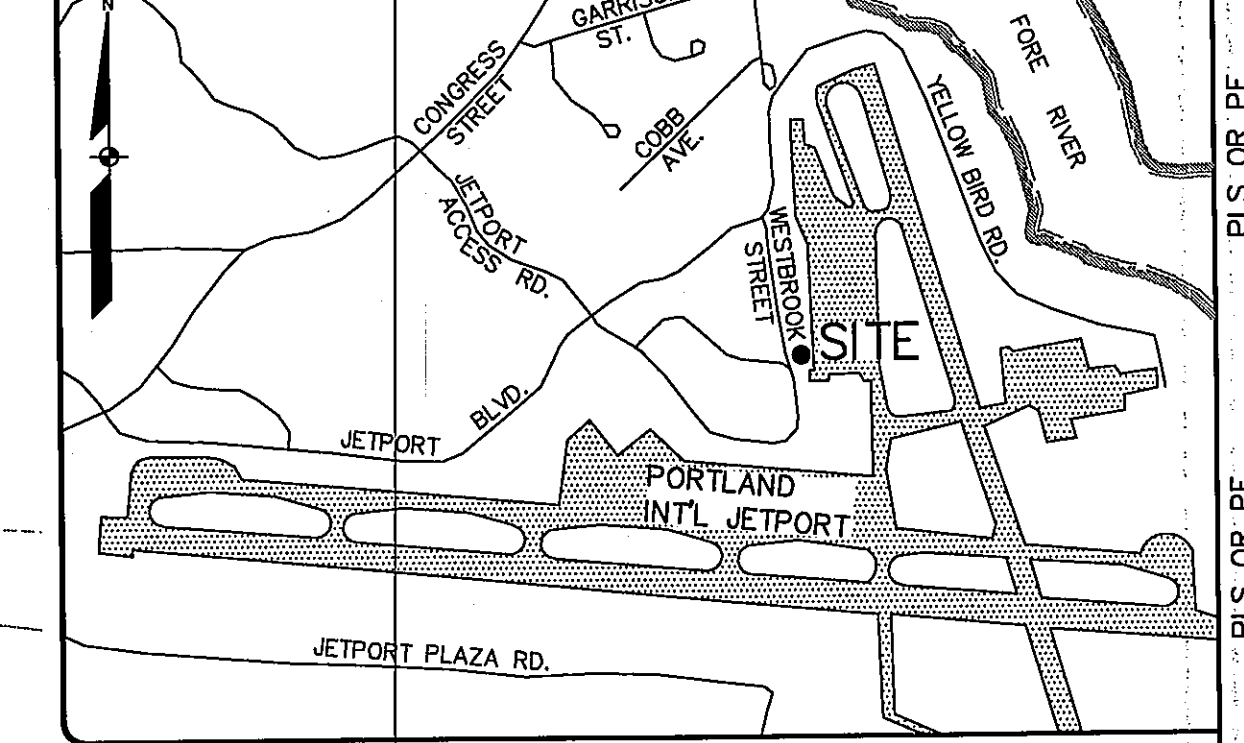
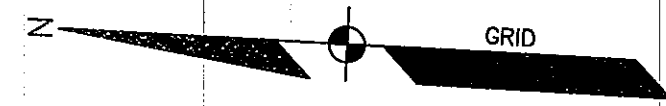

LOCATION MAP N.T.S.

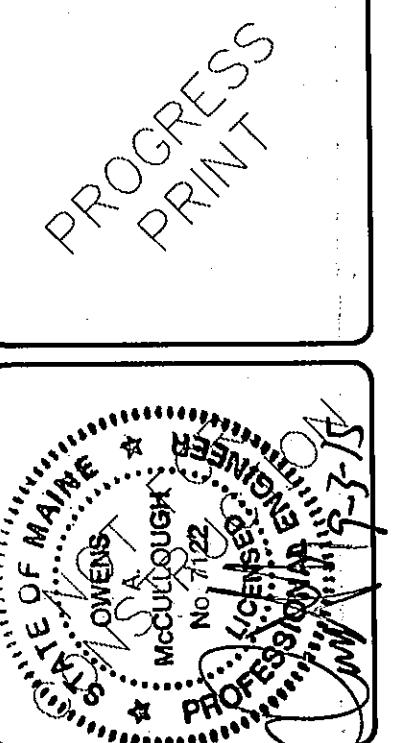

DESIGNED	CHECKED
SPP	SPP
SUBMITTED TO CITY FOR SITE PLAN REVIEW	
DATE:	STATUS:
REV: BY:	DATE:

THIS PLAN SHALL NOT BE MODIFIED WITHOUT WRITTEN PERMISSION FROM SEBAGO TECHNICS, INC. ANY ALTERATIONS, AUTHORIZED OR OTHERWISE, SHALL BE AT THE USER'S SOLE RISK AND WITHOUT LIABILITY TO SEBAGO TECHNICS, INC.

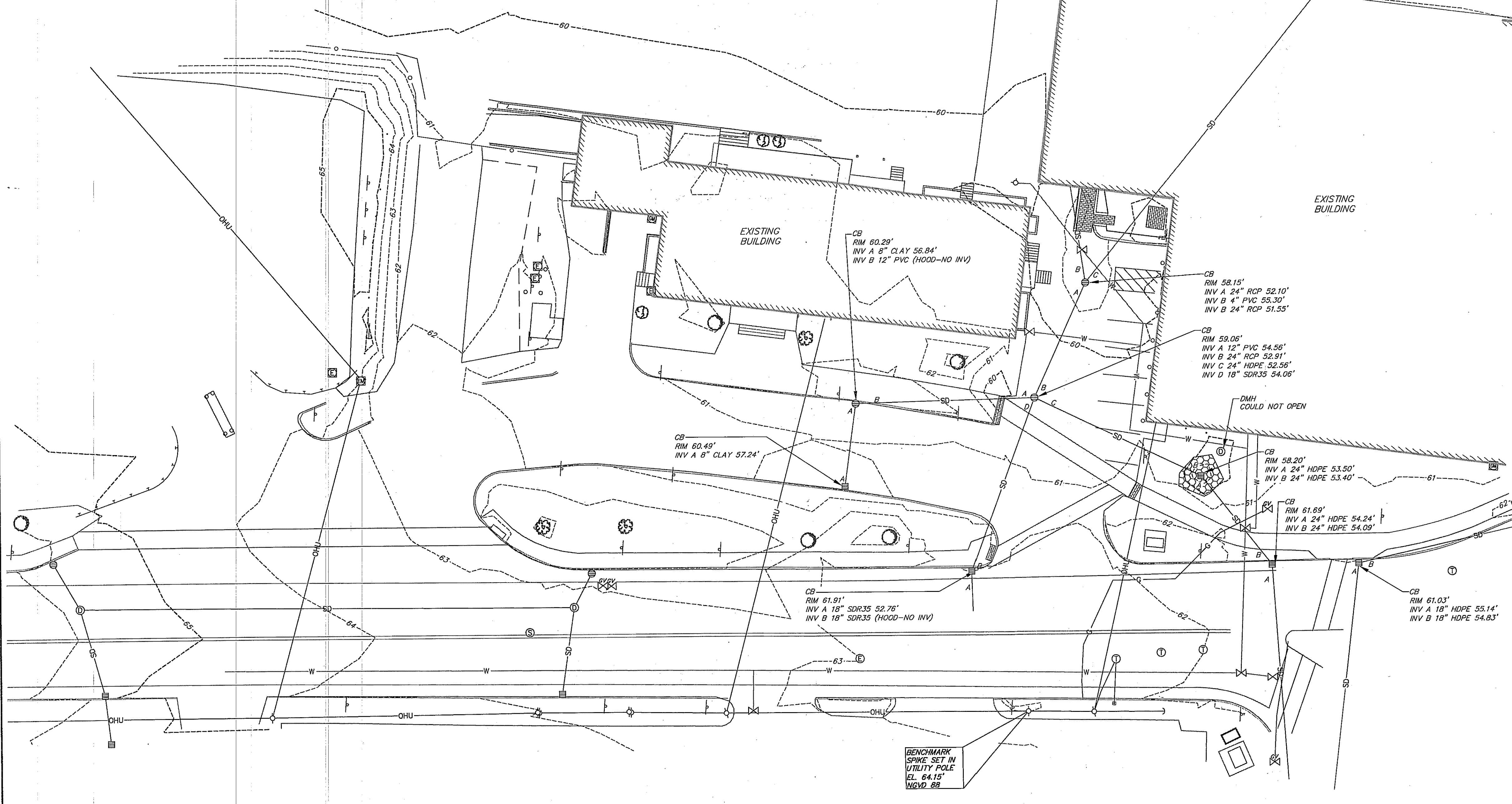

**GENERAL NOTES**

- THE RECORD OWNER OF THE LOT IS THE CITY OF PORTLAND BY DEED RECORDED IN THE CUMBERLAND COUNTY REGISTRY OF DEEDS.
- THE PROPERTY IS SHOWN ON THE CITY OF PORTLAND'S CHART BLOCK NO.199A001013.
- PLAN ORIENTATION IS BASED ON AN ASSUMED COORDINATE SYSTEM. TOPOGRAPHIC INFORMATION SHOWN IS REFERENCED TO THE NATIONAL VERTICAL GEODETIC DATUM OF 88 (NAVD 88), BASED ON USGS DISK J121 WITH A RECORD ELEVATION OF 62.87.
- PROPERTY IS LOCATED IN THE AIRPORT BUSINESS ZONE  
 MIN. LOT SIZE: 20,000 S.F.  
 MIN. FRONTAGE: 50 FEET  
 MIN. FRONT YARD: 20 FEET  
 MIN. SIDE YARD: NONE
- EXISTING AND INTENDED USE: GENERAL AVIATION FACILITY.
- ALL UTILITIES SHALL BE UNDERGROUND AND CONSTRUCTED TO THE CITY OF PORTLAND AND INDIVIDUAL UTILITY REQUIREMENTS.
- NORTHEAST AIR HAS A GROUND LEASE WITH THE CITY OF PORTLAND FOR THIS 45,160 SQUARE FOOT PARCEL AT THE PORTLAND INTERNATIONAL JETPORT - SHOWN AS PARCEL NO.7 ON THE ATTACHED EXHIBIT A.

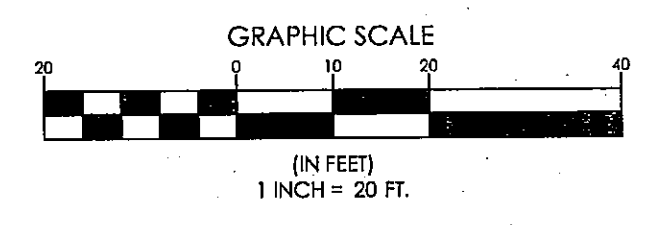

LEGEND	
<b>EXISTING</b>	<b>EXISTING</b>
— PROPERTY LINE/R.O.W.	— GUARD RAIL
— CENTERLINE	— RETAINING WALL
□ MONUMENT	○ DECIDUOUS TREE
● IRON PIPE/ROD	● CONIFEROUS TREE
<b>BENCHMARK DESCRIPTION WITH ELEVATION</b>	— SIGN
— BUILDING	— GAS
— DECK/STEPS/OVERHANG	— GAS GATE VALVE
— EDGE PAVEMENT	— WATER
— EDGE CONCRETE	— WATER GATE VALVE
— PAVEMENT PAINT	— SD STORM DRAIN
— CURB LINE	— ○ DRAINAGE MANHOLE
—120—118— CONTOURS	— □ CATCH BASIN
— ○ CHAIN LINK FENCE	— OHU OVERHEAD UTILITY
	— UGU UNDERGROUND UTILITY
	— ELECTRICAL MANHOLE
	— TELEPHONE MANHOLE
	— UTILITY POLE
	— GUY WIRE
	— TRANSFORMER PAD
	— RIPRAP

**SEBAGO**  
 TECHNICS  
 WWW.SEBAGOTECHNICS.COM  
 250 Goddard Rd.  
 Lewiston, ME 04240  
 Tel. 207-783-5656

EXISTING CONDITIONS PLAN  
 OF:  
 NORTHEAST AIR-FIXED BASE OPERATOR  
 PORTLAND INTERNATIONAL JETPORT  
 PORTLAND, MAINE  
 FOR:  
 NORTHEAST AIR  
 101 WESTBROOK STREET  
 PORTLAND, MAINE 04102



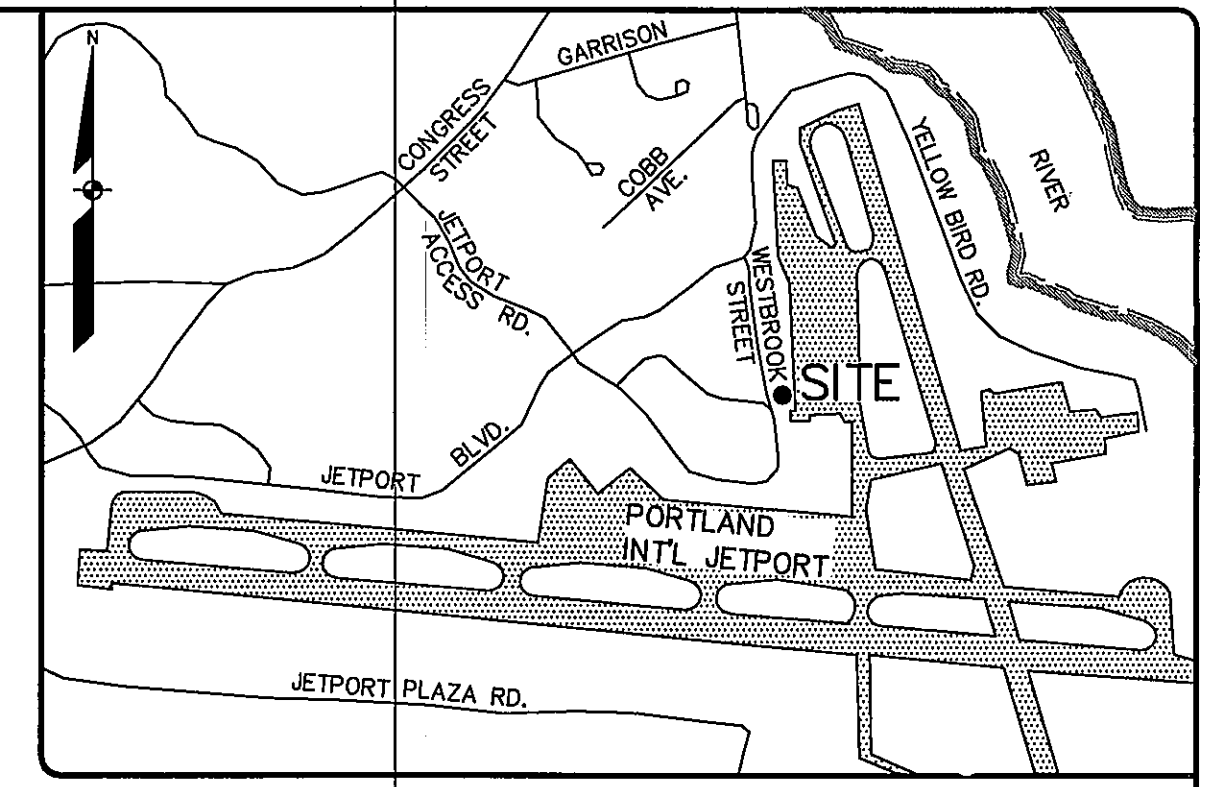
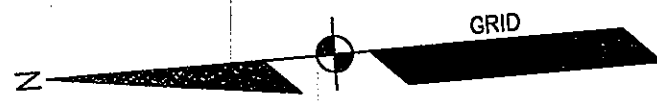

LOCATION MAP N.T.S.

PROGRESS PRINT

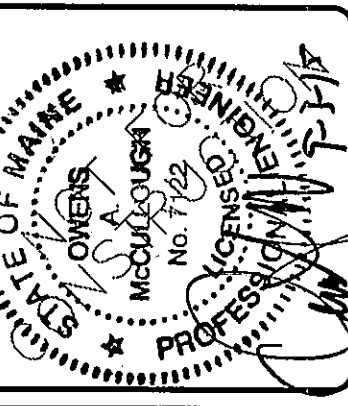

DESIGNED	CHECKED
ACH	OAM

SUBMITTED TO CITY FOR SITE PLAN REVIEW	
DATE:	9/03/15
BY:	OAM
THIS PLAN SHALL NOT BE MODIFIED WITHOUT WRITTEN PERMISSION FROM SEBAGO TECHNIQS, INC. ANY ALTERATIONS, AUTHORIZED OR OTHERWISE, SHALL BE AT THE USER'S SOLE RISK AND WITHOUT LIABILITY TO SEBAGO TECHNIQS, INC.	

**GENERAL NOTES**

- THE RECORD OWNER OF THE LOT IS THE CITY OF PORTLAND BY DEED RECORDED IN THE CUMBERLAND COUNTY REGISTRY OF DEEDS.
- THE PROPERTY IS SHOWN ON THE CITY OF PORTLAND'S CHART BLOCK NO.199A001013.
- PLAN ORIENTATION IS BASED ON AN ASSUMED COORDINATE SYSTEM. TOPOGRAPHIC INFORMATION SHOWN IS REFERENCED TO THE NATIONAL VERTICAL GEODETIC DATUM OF 88 (NAVD 88), BASED ON USGS DISK J121 WITH A RECORD ELEVATION OF 62.87.
- PROPERTY IS LOCATED IN THE AIRPORT BUSINESS ZONE
  - MIN. LOT SIZE: 20,000 S.F.
  - MIN. FRONTAGE: 50 FEET
  - MIN. FRONT YARD: 20 FEET
  - MIN. SIDE YARD: NONE
- EXISTING AND INTENDED USE: GENERAL AVIATION FACILITY.
- ALL UTILITIES SHALL BE UNDERGROUND AND CONSTRUCTED TO THE CITY OF PORTLAND AND INDIVIDUAL UTILITY REQUIREMENTS.
- AN APPROVED SET OF PLANS AND ALL APPLICABLE PERMITS MUST BE AVAILABLE AT THE CONSTRUCTION SITE. THE DEVELOPER, OR AN AUTHORIZED AGENT, MUST BE AVAILABLE AT ALL TIMES DURING CONSTRUCTION.
- WARNING SIGNS, MARKERS, BARRICADES OR FLAGON, APPROPRIATE FOR THE TYPE OF CONSTRUCTION MUST BE EMPLOYED TO REGULATE TRAFFIC.
- EXISTING STORM DRAIN SYSTEM MUST BE FLUSHED, SUMPS CLEANED AND MATERIAL REMOVED FROM CATCH BASIN INLETS AND ASSOCIATED DITCHES OF THE CONSTRUCTION WITHIN THE PROJECT LIMITS AND ON AVIATION BOULEVARD.
- PRIOR TO ANY SITE CONSTRUCTION ACTIVITIES THE CONTRACTOR SHALL CONTACT THE JETPORT OPERATIONS MANAGER AT 207-772-0466 AND ARRANGE FOR A PRE-CONSTRUCTION MEETING AT THE PROJECT SITE. THE CONTRACTOR SHALL HAVE A DETAILED SCHEDULE AND SHALL INCORPORATE ALL REQUIRED FAA AND JETPORT REGULATIONS TO INSURE SAFETY PROTOCOLS ARE MAINTAINED. THE CONTRACTOR OR CONTRACTOR'S PERSONAL AND EQUIPMENT ARE NOT ALLOWED WITHIN THE JETPORT SECURITY PERIMETER WITHOUT FIRST OBTAINING APPROPRIATE SECURITY CLEARANCE AND SUBMITTING A SECURITY PLAN AND CONSTRUCTION WORK SCHEDULE THAT MUST BE APPROVED BY THE JETPORT OPERATIONS MANAGER.
- ALL WORK REQUIRED BY PLAN NOTES AND NECESSARY TO COMPLETE THE PROJECT IN ITS ENTIRETY SHALL BE CONSIDERED INCIDENTAL TO CONSTRUCTION WHEN NOT IDENTIFIED IN CONTRACT DOCUMENTS AND PAY ITEMS. NO EXTRA PAYMENT WILL BE MADE TO THE CONTRACTOR.
- CONTRACTOR SHALL BE RESPONSIBLE FOR TEMPORARY SECURITY FENCING. THE CONTRACT DRAWINGS DEPICT PROPOSED LOCATIONS OF TEMPORARY AND PERMANENT SECURITY FENCING SUBJECT TO JETPORT AND TSA APPROVAL. PROPOSED TEMPORARY FENCING IS INTENDED TO ALLOW MOST, BUT NOT ALL WORK TO OCCUR OUTSIDE OF THE SECURE AREA. CONTRACTOR IS RESPONSIBLE FOR RELOCATING AND REMOVING FENCE AS NEEDED INCLUDING TEMPORARY AND PERMANENT FENCE LOCATIONS. CONTRACTOR MUST OBTAIN JETPORT/TSA APPROVAL PRIOR TO ANY FENCE REMOVAL OR RELOCATION, AND MUST COORDINATE WORK WITH OWNER AND JETPORT OPERATIONS MANAGER.

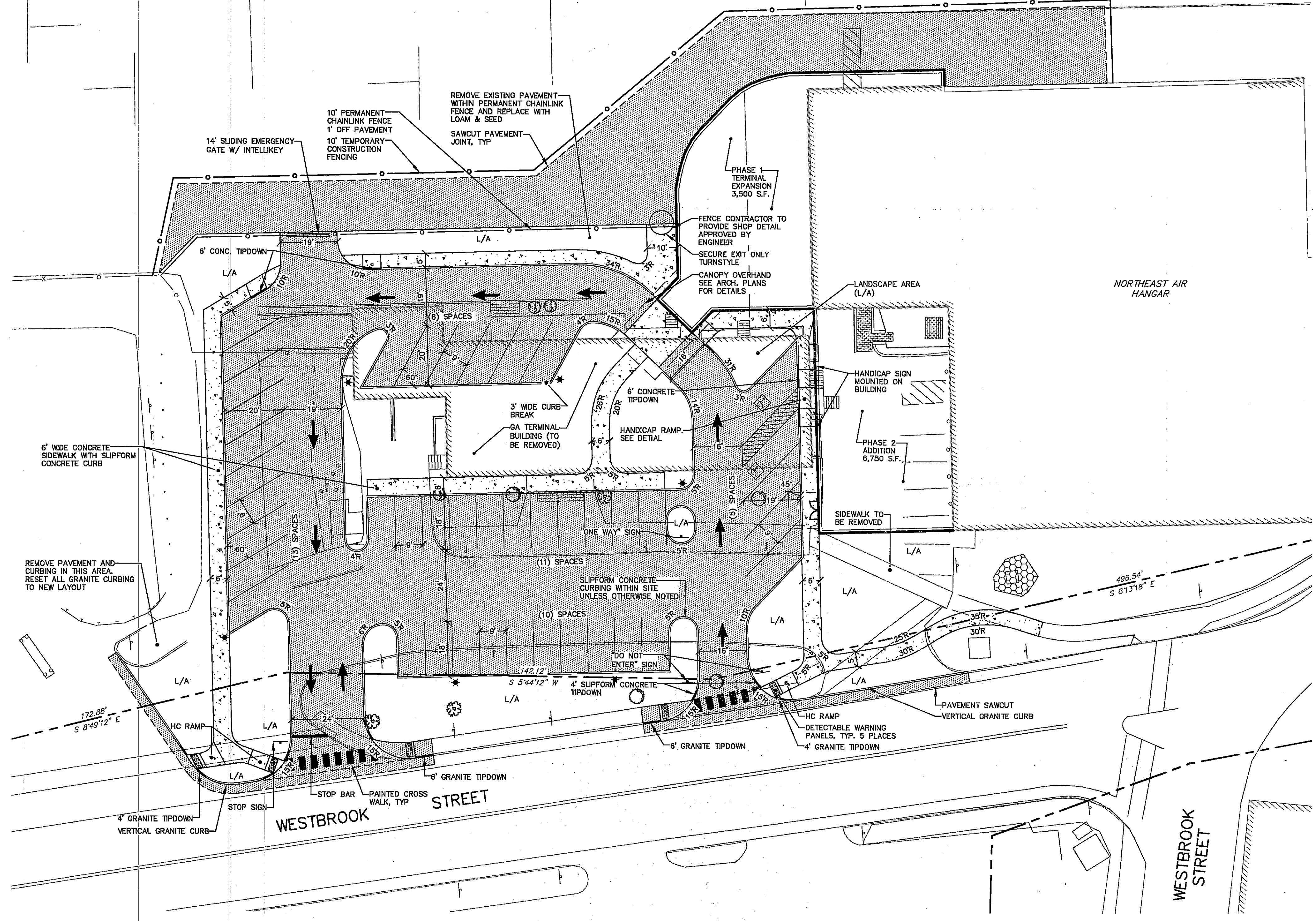

REMOVE PAVEMENT AND CURBING IN THIS AREA. RESET ALL GRANITE CURBING TO NEW LAYOUT

14' SLIDING EMERGENCY GATE W/ INTELLIKEY

10' PERMANENT CHAINLINK FENCE 1' OFF PAVEMENT  
10' TEMPORARY CONSTRUCTION FENCING

REMOVE EXISTING PAVEMENT WITHIN PERMANENT CHAINLINK FENCE AND REPLACE WITH LOAM & SEED  
SAWCUT PAVEMENT JOINT, TYP

PHASE 1 TERMINAL EXPANSION 3,500 S.F.

FENCE CONTRACTOR TO PROVIDE SHOP DETAIL APPROVED BY ENGINEER  
SECURE EXIT ONLY TURNSTYLE  
CANOPY OVERHAND SEE ARCH. PLANS FOR DETAILS

LANDSCAPE AREA (L/A)

NORTHEAST AIR HANGAR

HANDICAP SIGN MOUNTED ON BUILDING

PHASE 2 ADDITION 6,750 S.F.

SIDEWALK TO BE REMOVED

6' WIDE CONCRETE SIDEWALK WITH SLIPFORM CONCRETE CURB

3' WIDE CURB BREAK

GA TERMINAL BUILDING (TO BE REMOVED)

HANDICAP RAMP - SEE DETAIL

6' CONCRETE TIPDOWN

ONE WAY SIGN

SLIPFORM CONCRETE CURBING WITHIN SITE UNLESS OTHERWISE NOTED

(10) SPACES

(11) SPACES

DO NOT ENTER SIGN

4' SLIPFORM CONCRETE TIPDOWN

HC RAMP

DETECTABLE WARNING PANELS, TYP. 5 PLACES

4' GRANITE TIPDOWN

PAVEMENT SAWCUT

VERTICAL GRANITE CURB

172.88' S 8'49'12" E

HC RAMP

4' GRANITE TIPDOWN

VERTICAL GRANITE CURB

STOP SIGN

STOP BAR

PAINTED CROSS WALK, TYP

WESTBROOK STREET

6' GRANITE TIPDOWN

VERTICAL GRANITE CURB

STOP SIGN

WESTBROOK STREET

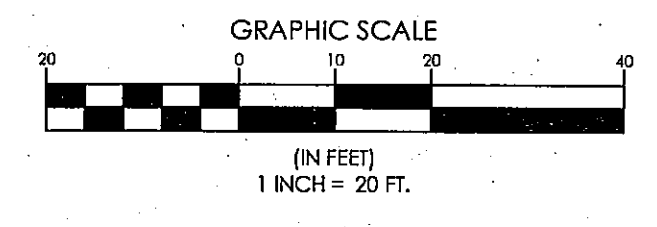

**LEGEND**

EXISTING	PROPOSED
PROPERTY LINE/R.O.W.	PROPERTY LINE/R.O.W.
CENTERLINE	CENTERLINE
BUILDING	BUILDING
DECK/STEPS/OVERHANG	DECK/STEPS/OVERHANG
EDGE PAVEMENT	EDGE PAVEMENT
PAVEMENT SAWCUT	PAVEMENT SAWCUT
EDGE CONCRETE	EDGE CONCRETE
PAVEMENT PAINT	PAVEMENT PAINT
CURB LINE	CURB LINE
CHAIN LINK FENCE	CHAIN LINK FENCE
GUARD RAIL	GUARD RAIL
RETAINING WALL	RETAINING WALL
DECIDUOUS TREE	DECIDUOUS TREE
CONIFEROUS TREE	CONIFEROUS TREE
SIGN	SIGN
RIPRAP	RIPRAP

SITE PLAN OF: NORTHEAST AIR-FIXED BASE OPERATOR PORTLAND INTERNATIONAL AIRPORT PORTLAND, MAINE FOR: NORTHEAST AIR 1011 WESTBROOK STREET PORTLAND, MAINE 04102

PROJECT NO.	SCALE
15149	1" = 20'

SHEET 3 OF 10





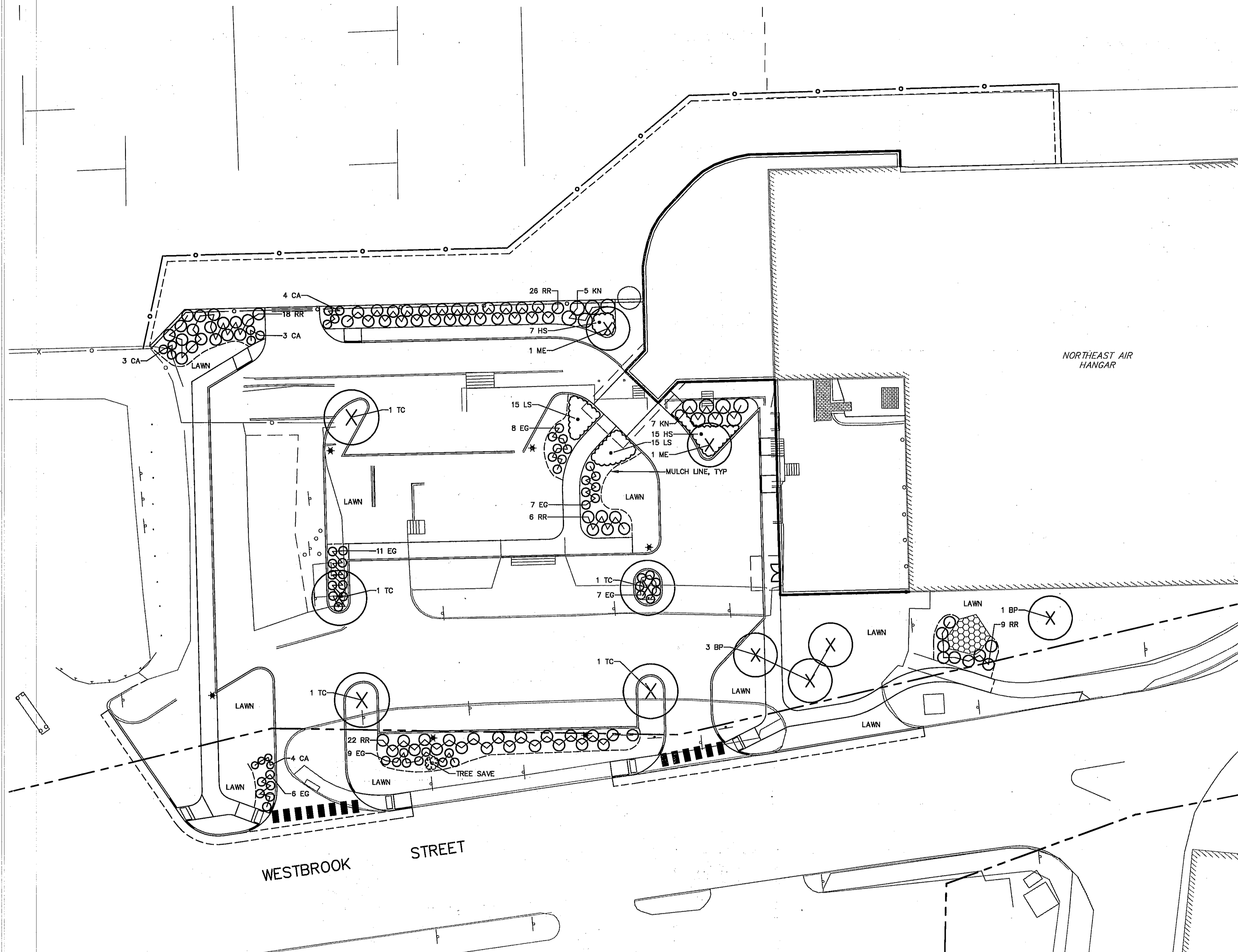

**LEGEND**

EXISTING	PROPOSED

**PLANT SCHEDULE:**

KEY	BOTANICAL NAME / COMMON NAME	SIZE / REMARKS
TC	TILIA CORDATA / LINDEN	3 INCH CALIPER
ME	MAGNOLIA X. ELIZABETH / YELLOW MAGNOLIA	6 FT. - 8 FT. MULTI
BP	BETULA NIGRA 'HERITAGE' / HERITAGE BIRCH	8 FT. - 10 FT. MULTI
RR	ROSA RUGOSA / SEA ROSE	NO. 5 CONTAINER
KN	KALMIA X. 'NATHAN HALE' / MT. LAUREL	NO. 5 CONTAINER
EG	EUONYMUS 'EMERALD GAIETY' / EUONYMUS	NO. 3 CONTAINER
CA	CALAMAGROSTIS A. 'KARL FOERSTER' / REED GRASS	NO. 1 CONTAINER
HS	HOSTA X. 'PATRIOT' / HOSTA	NO. 2 CONTAINER
LS	LEUCANTHEMUM S. 'BECKY' / SHASTA DAISY	NO. 1 CONTAINER

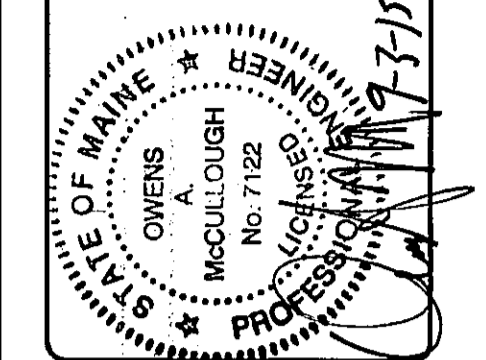
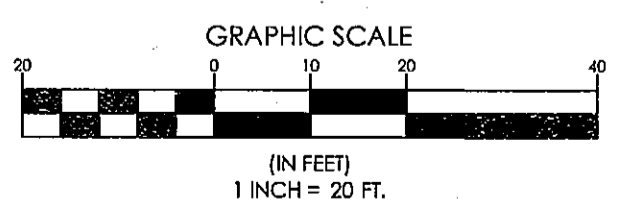

DESIGNED	CHECKED
WTC	WTC
A. OAM 9/03/15 SUBMITTED TO CITY FOR SITE PLAN REVIEW REV: BY: DATE: STATUS: AUTHORIZED OR OTHERWISE, SHALL BE AT THE USER'S SOLE RISK AND WITHOUT LIABILITY TO SEBAGO TECHNICS, INC.	

**SEBAGO TECHNICS**  
 WWW.SEBAGOTECHNICS.COM  
 75 John Roberts Rd. Suite 1A  
 South Portland, ME 04106  
 Tel. 207-200-2100

**LANDSCAPE PLAN**  
 OF:  
 NORTHEAST AIR-FIXED BASE OPERATOR  
 PORTLAND INTERNATIONAL AIRPORT  
 PORTLAND, MAINE

FOR:  
 NORTHEAST AIR  
 1011 WESTBROOK STREET  
 PORTLAND, MAINE 04102

PROJECT NO.	SCALE
15149	1" = 20'











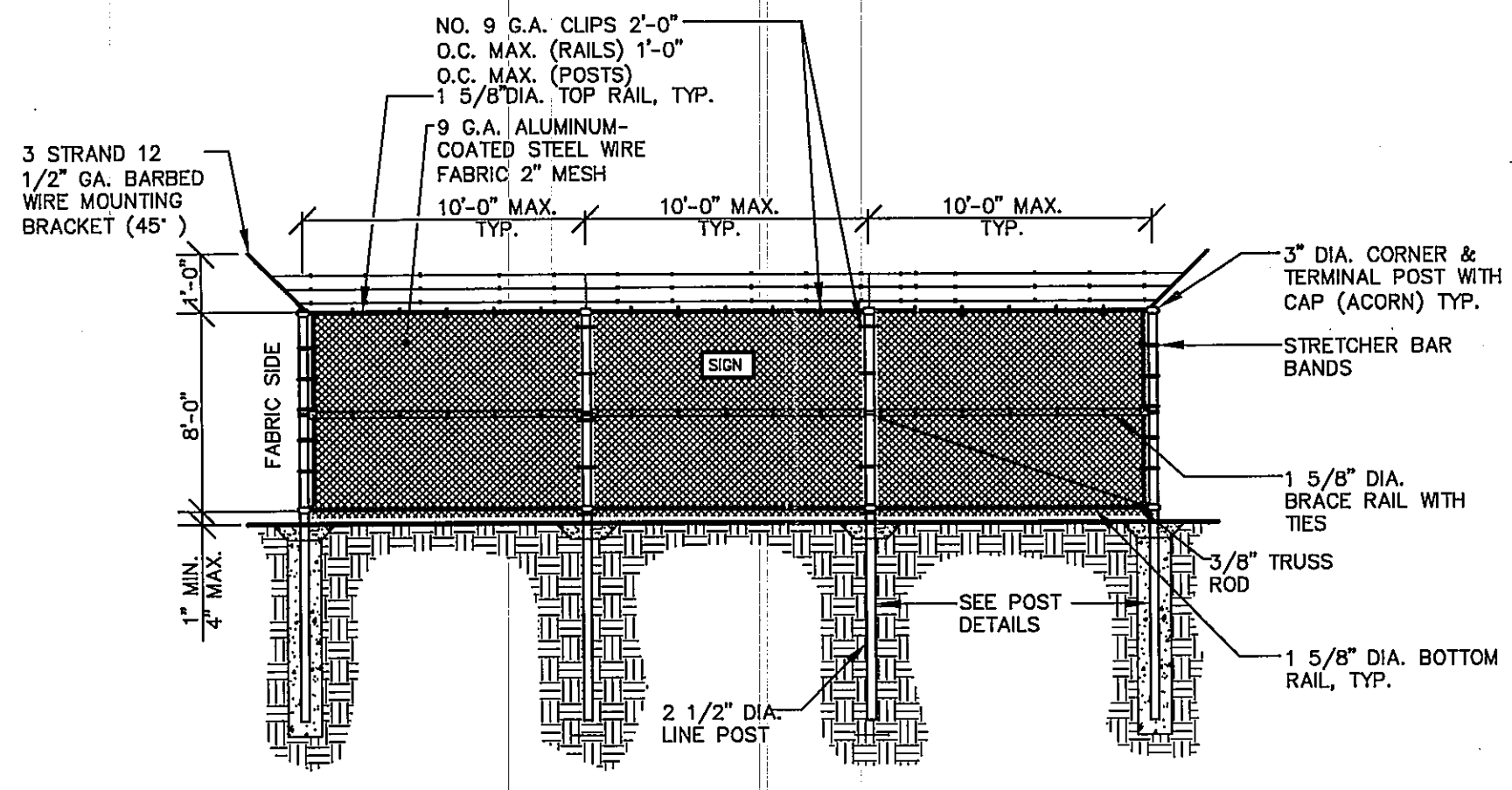

- NOTES:**
- SIGNS TO BE PLACED ON FENCE EVERY 200 FEET AND ONE ON EACH GATE. SIGNS WILL BE 10" X 14" AND SHALL READ AS FOLLOWS: NOTICE (WHITE LETTERS, BLUE BACKGROUND) NO TRESPASSING ON THIS PROPERTY UNDER PENALTY OF LAW (BLUE LETTERS, WHITE BACKGROUND)
  - SUBMIT SHOP DRAWINGS FOR OWNER'S/ENGINEER'S APPROVAL.
  - MAN GATES TO BE 3'-0" AT LOCATIONS SHOWN ON PLANS.

**10' CHAIN LINK FENCE DETAIL**  
N.T.S.

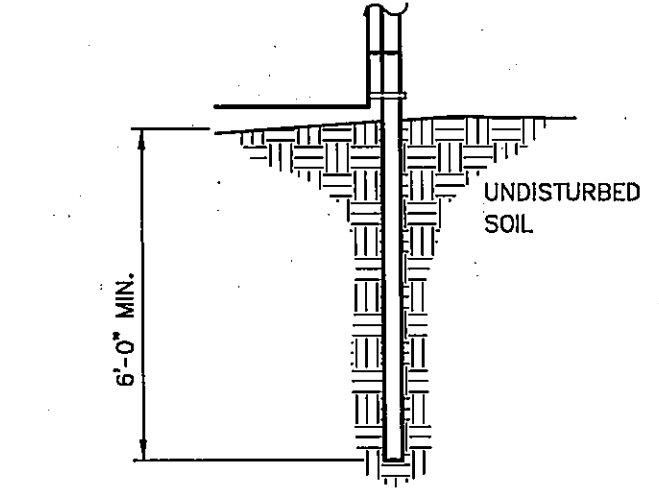

**INTERMEDIARY LINE POST DETAIL**  
N.T.S.

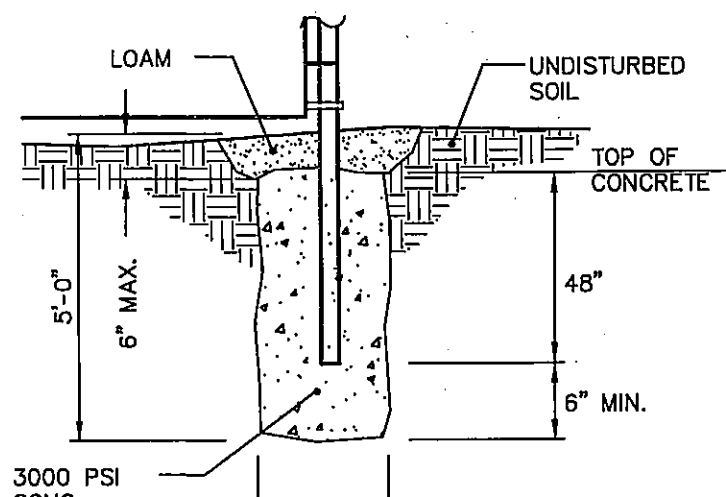

**CORNER & TERMINAL POST DETAIL**  
N.T.S.

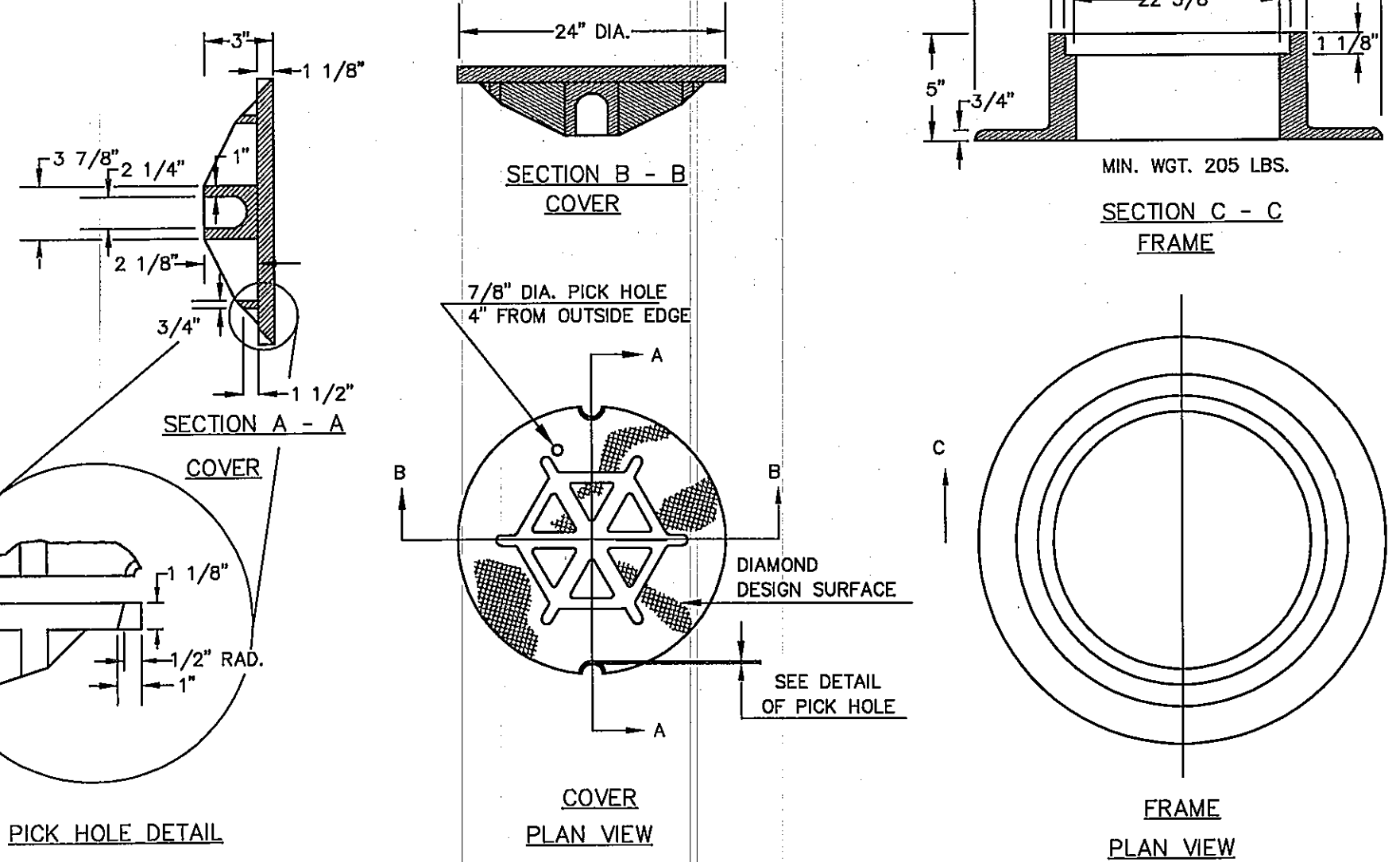

**TYPE "A" CAST IRON MANHOLE COVER AND FRAME**  
NOT TO SCALE

**PLASTIC MANHOLE STEPS**  
NOT TO SCALE

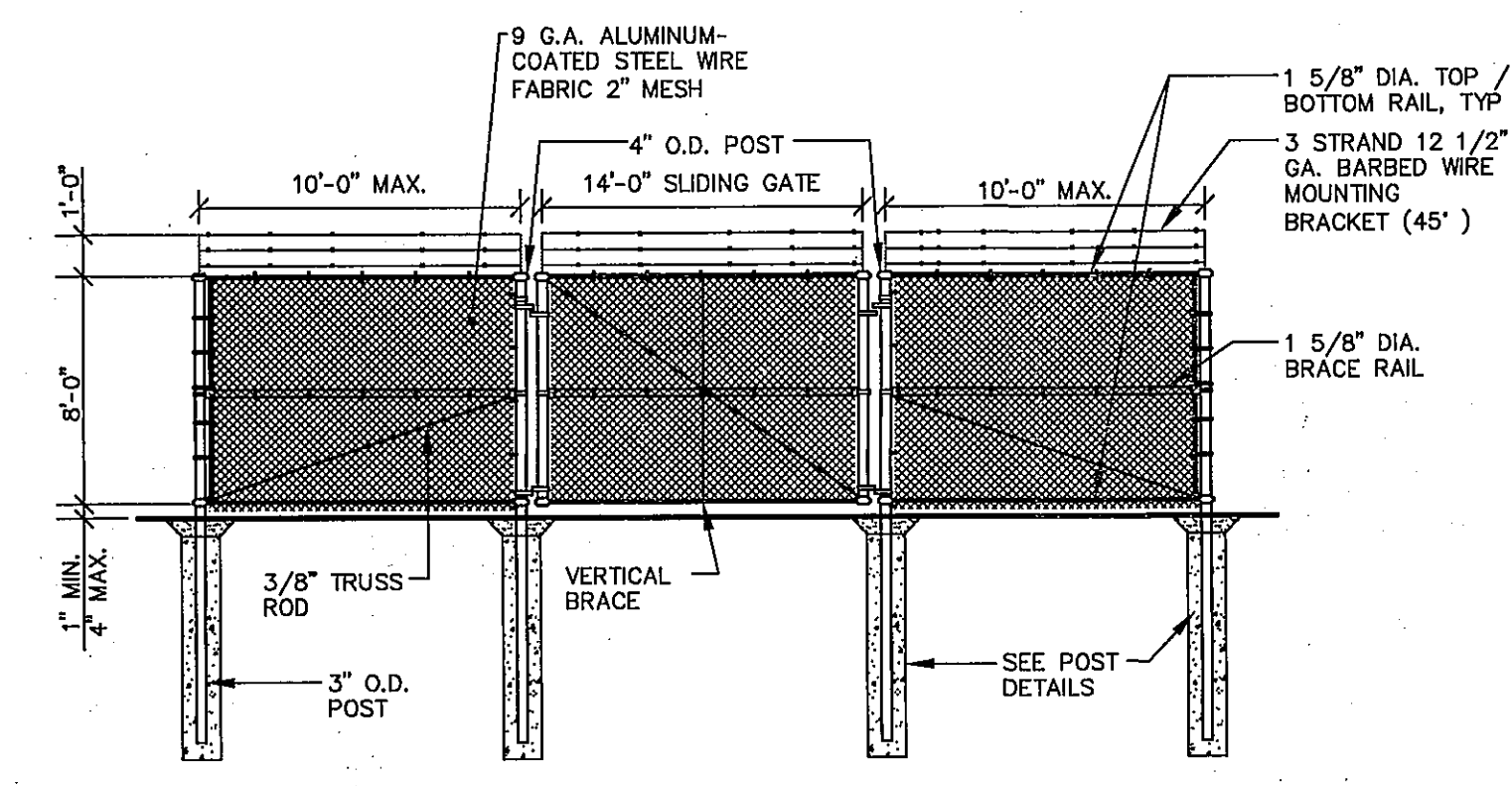

- NOTES:**
- SUBMIT SHOP DRAWINGS FOR OWNER / ENGINEER APPROVAL.
  - PROVIDE AND INSTALL INTELLIKEYE GATE LOCK SYSTEM AT ALL GATES (SLIDING & MAN GATES). ROLLING GATES SHALL HAVE 14' CLEAR PASSAGE AND SHALL BE EQUAL TO TYPICAL CORPORATION HEAVY DUTY FORTRESS COUNTERWEIGHT SLIDING GATES. PROVIDE SHOP DRAWINGS FOR ENGINEER AND JETPORT APPROVAL.

**14' SLIDING GATE**  
NOT TO SCALE

**GENERAL NOTES FOR MANHOLES**

- ALL CONCRETE SHALL BE CLASS "A" AND HAVE A MINIMUM ULTIMATE COMPRESSIVE STRENGTH OF 4000 LBS. PER SQ. INCH AT THE END OF 28 DAYS, UNLESS OTHERWISE NOTED.
- PRECAST REINFORCED CONE BARREL MANUFACTURED PER ASTM SPEC. C-478-67
- SEWER BRICK SHALL CONFORM TO ASTM SPEC. DESIGNATE ON C-32-63, GRADE MA AND SA.
- ALL MANHOLES SHALL HAVE A BITUMINOUS WATERPROOFING APPLIED TO THE EXTERIOR SURFACE. IF CONSTRUCTED OF BRICK MASONRY, SURFACE SHALL BE PLASTERED WITH A SMOOTH MORTAR FINISH 3/8" THICK. AFTER THE MORTAR HAS SET, THE SURFACE SHALL BE WATERPROOFED AS REQUIRED BY SUPPLEMENTAL SPECIFICATIONS SECTION 604.
- CASTINGS SHALL CONFORM TO ASTM DESIGNATION A48-CLASS 35. ALL PARTS OF CASTINGS, EXCEPT FINISHED SURFACE, SHALL RECEIVE A COAT OF COAL TAR PITCH VARNISH OR ASPHALTUM PAINT WHICH SHALL BE SMOOTH AND TOUGH BUT NOT BRITTLE.
- MANHOLES MAY BE CONSTRUCTED OF MASONRY, PRECAST REINFORCED CONCRETE, OR CAST IN PLACE.
- ALL PRECAST MANHOLES AND CATCH BASINS SHALL BE IDENTIFIED BY STATION AND OFFSET, PAINTED ON THE SIDE OF THE STRUCTURE BY THE MANUFACTURER.
- STORM AND SEWER MANHOLES SHALL HAVE SOLID COVERS WITH ONE DRILLED PICK HOLE.

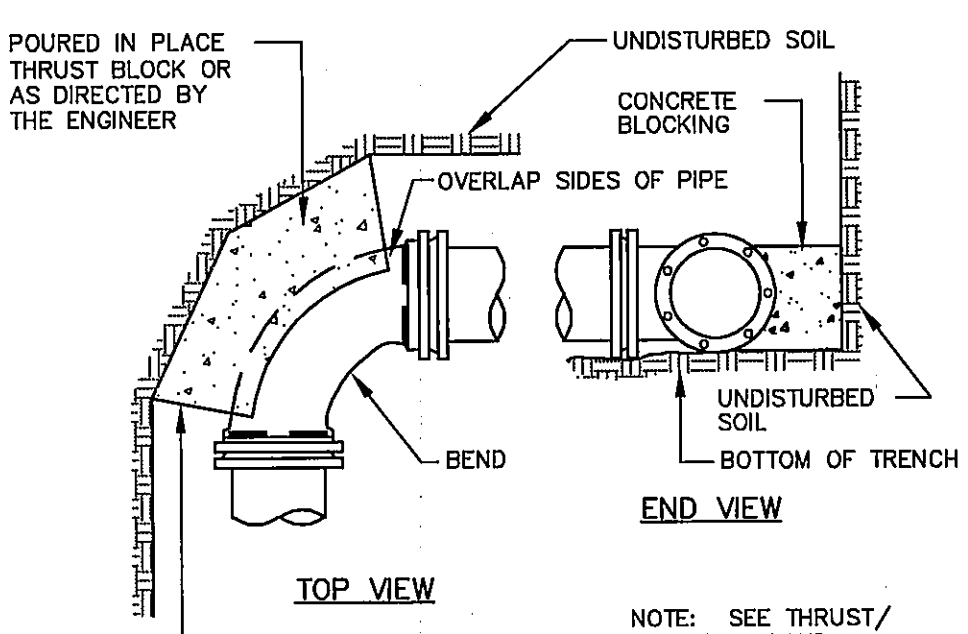

**STANDARD BEND BLOCKING**  
NOT TO SCALE

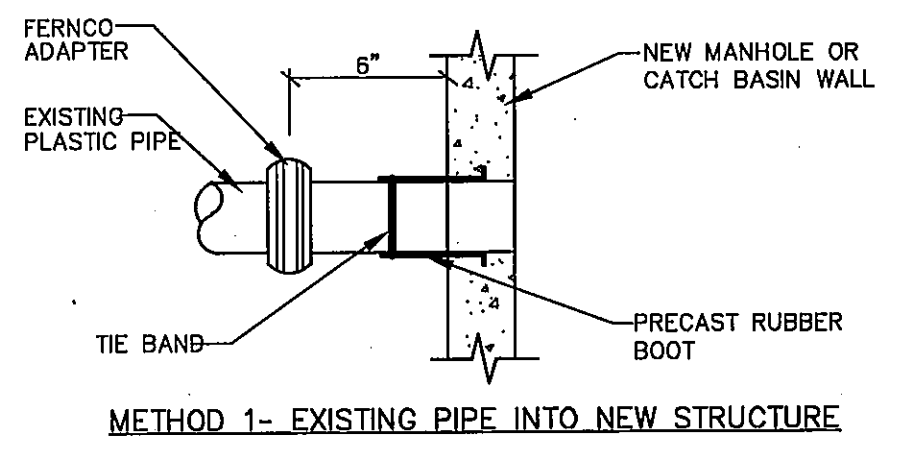

**METHOD 1- EXISTING PIPE INTO NEW STRUCTURE**

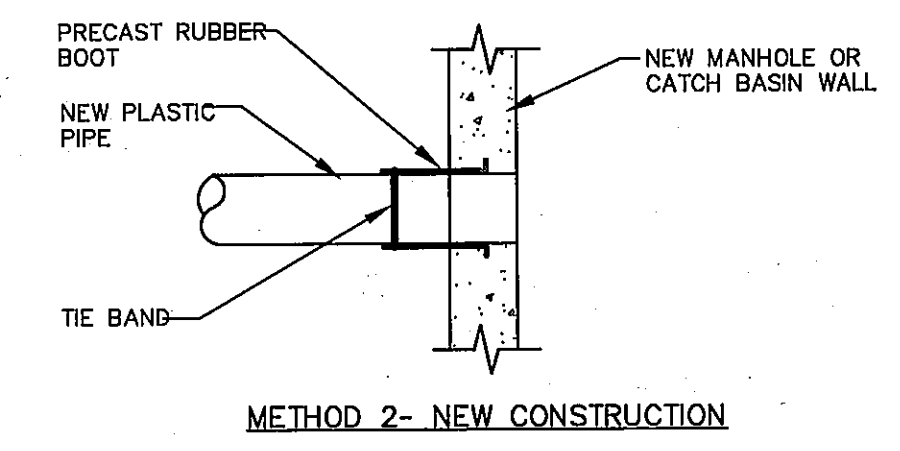

**METHOD 2- NEW CONSTRUCTION**

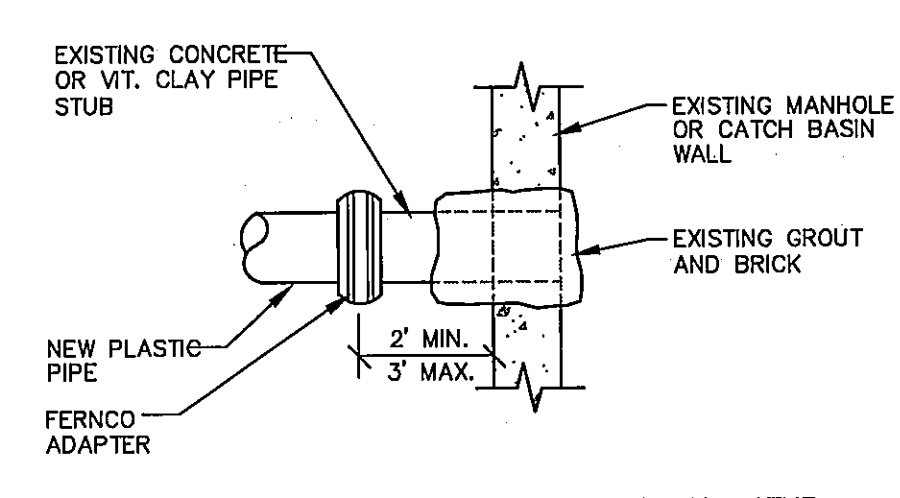

**METHOD 4- NEW PIPE INTO EXISTING STUB**

**PLASTIC PIPE CONNECTIONS**  
NOT TO SCALE

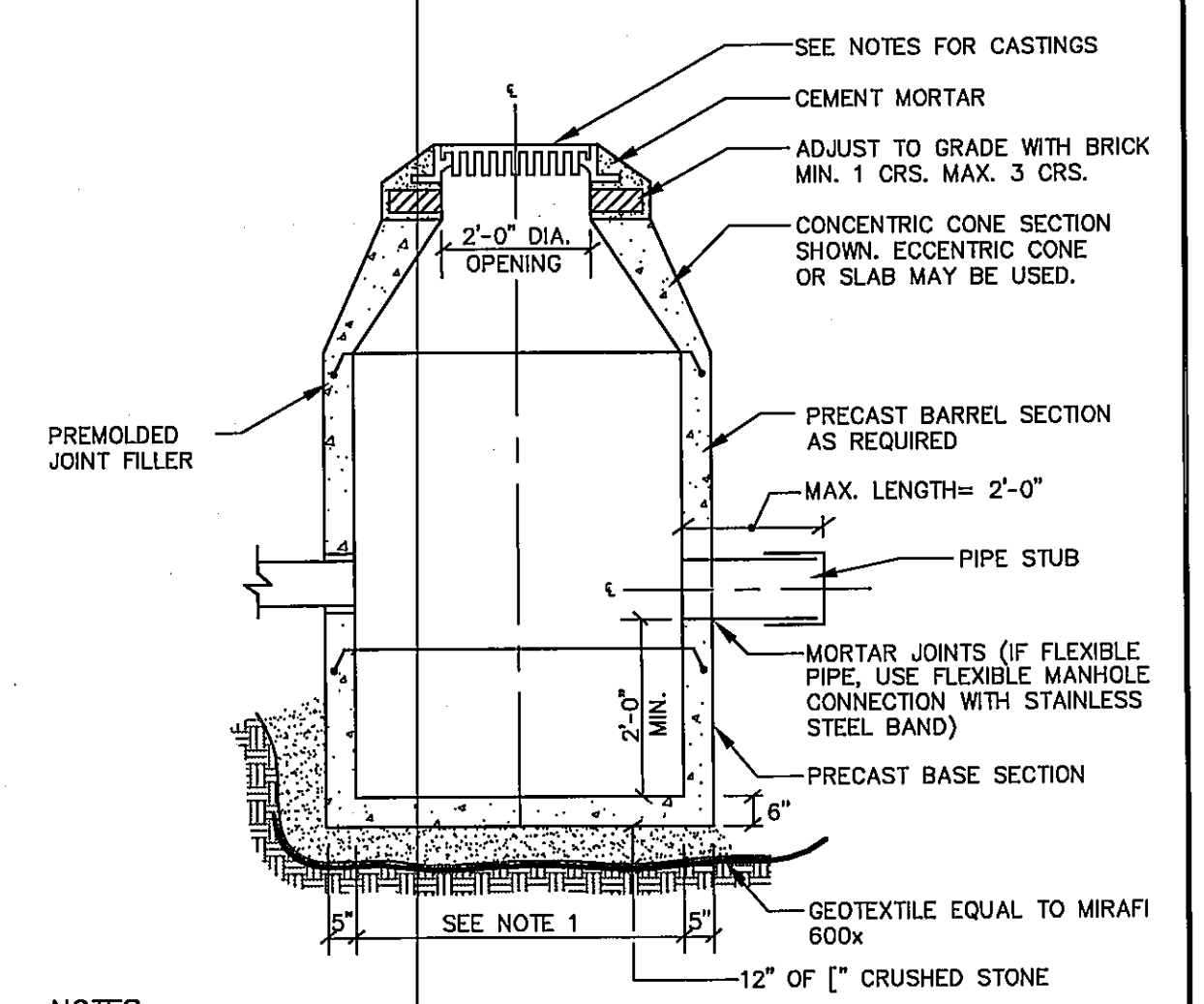

- NOTES:**
- 4'-0" I.D. TYPICAL. SOME STRUCTURES MAY REQUIRE LARGER I.D. PROVIDE SHOP DRAWINGS.
  - DRAINAGE STRUCTURES TO BE DESIGNED FOR H-20 LOADING.
  - PIPE SIZES AND INVERTS AS NOTED ON PLANS.
  - CATCH BASIN FRAME AND GRATE TO BE ETHERIDGE FOUNDRY SA248, TYPE M OR C OR APPROVED EQUAL.
  - DRAINAGE MANHOLE FRAME AND COVER TO BE ETHERIDGE FOUNDRY M248S OR APPROVED EQUAL. COVER SHALL BE MARKED "DRAIN".

**TYPICAL CATCH BASIN**  
NOT TO SCALE

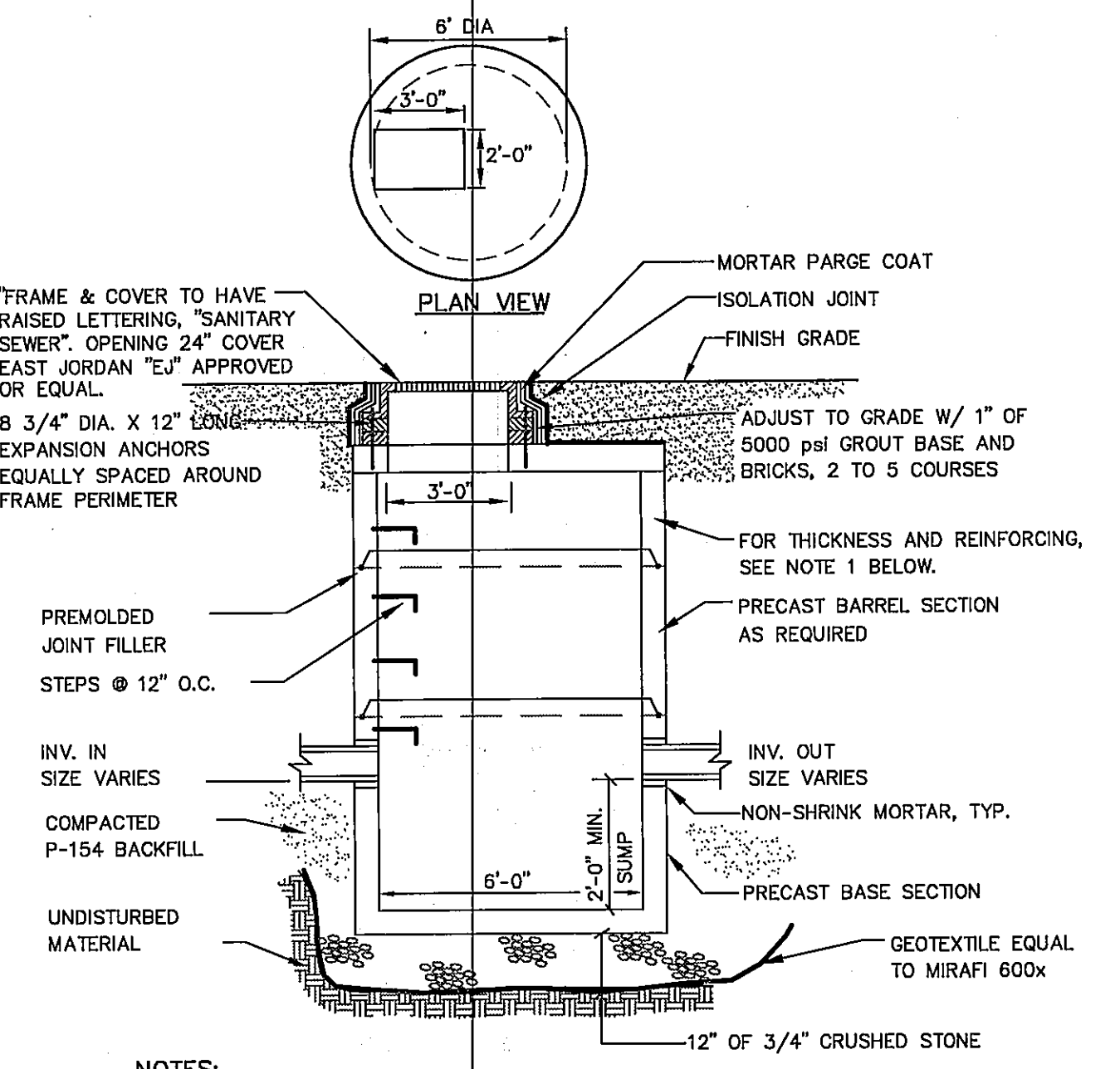

- NOTES:**
- THICKNESS AND REINFORCING OF CATCH BASIN TOP, WALLS AND FLOOR TO BE DESIGNED TO ACCOMMODATE H-80 LOADING. CONCRETE TO BE 5000 PSI @ 28 DAYS. STEEL TO BE ASTM A615 GRADE 60, 60000 PSI YIELD.
  - SUBMIT SHOP DRAWINGS FOR APPROVAL.
  - TYPICAL OF CATCH BASINS 17, 18, 19, 20, 21, 22 AND 23

**TYPICAL MANHOLE-AIRCRAFT APRON**  
NOT TO SCALE

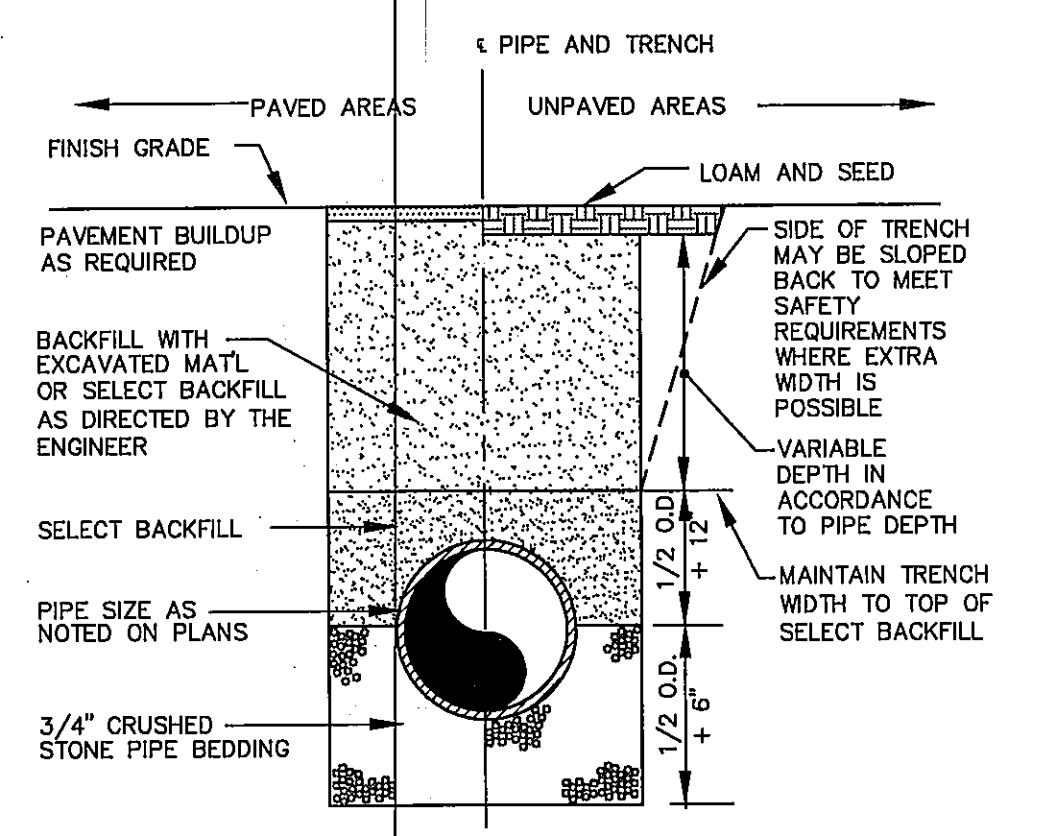

**TYPICAL TRENCH SECTION**  
NOT TO SCALE

PROGRESS PRINT

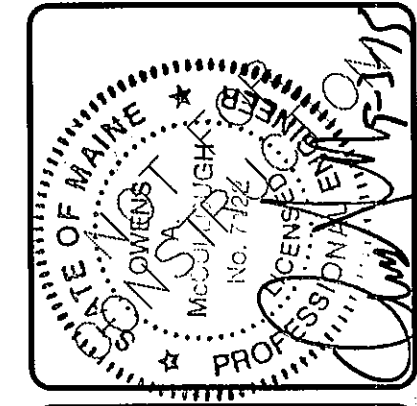

DESIGNED	CHECKED
OAM	OAM
SUBMITTED TO CITY FOR SITE PLAN REVIEW	
A OAM	9/03/15
REV. BY:	DATE:
STATUS:	
THIS PLAN SHALL NOT BE MODIFIED WITHOUT WRITTEN PERMISSION FROM SEBAGO TECHNICS, INC. ANY ALTERATIONS, AUTHORIZED OR OTHERWISE, SHALL BE AT THE USER'S SOLE RISK AND WITHOUT LIABILITY TO SEBAGO TECHNICS, INC.	

**SEBAGO TECHNICS**  
WWW.SEBOGOTECHNICS.COM  
250 Gaddard Rd., South Portland, ME 04106  
Tel: 207-753-5656

**DETAILS OF:** NORTHEAST AIR-FIXED BASE OPERATOR PORTLAND INTERNATIONAL JETPORT PORTLAND, MAINE  
**FOR:** NORTHEAST AIR 1011 WESTBROOK STREET PORTLAND, MAINE 04102

PROJECT NO.	SCALE
15149	NTS



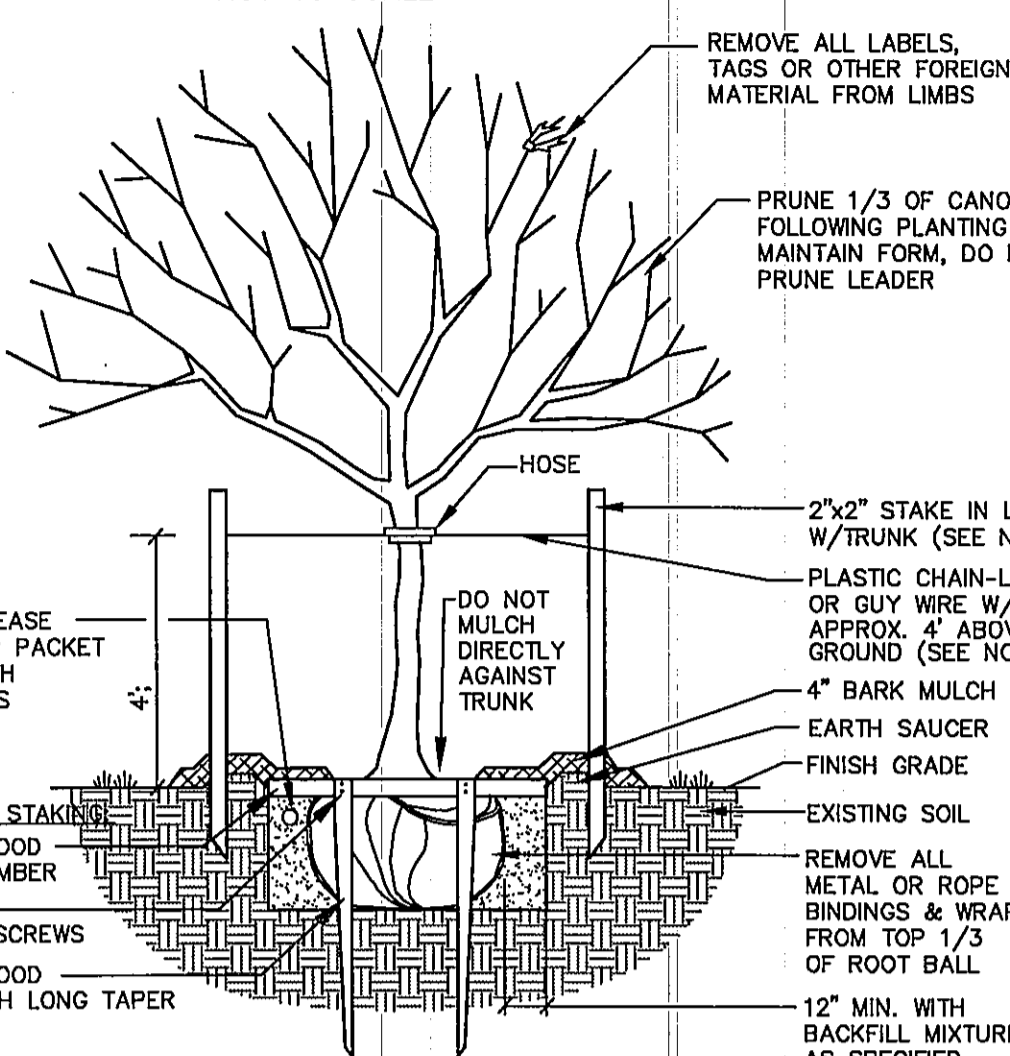
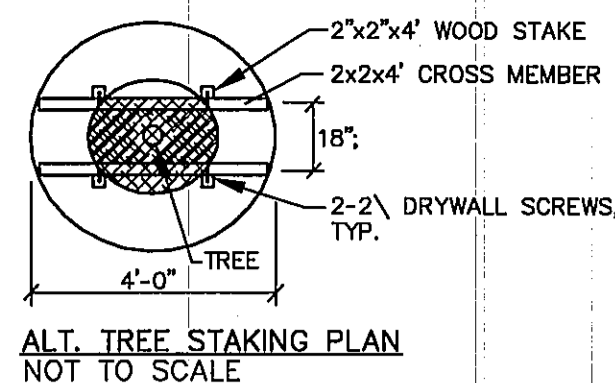

**NOTES:**

- INSTALL STAKES AND GUYS TO TREES IF THE FOLLOWING APPLY:
1. THE TREE IS OF SUBSTANTIAL SIZE.
  2. THE PLANTING LOCATION IS EXTREMELY WINDY, AS ON OPEN UNDEVELOPED SITES.
  3. THE PLANTING LOCATION IS COMPRISED OF SAND OR OTHER LOOSE TEXTURED SOILS.
  4. IF STAKES AND GUYS ARE REQUIRED, REMOVE AFTER ONE YEAR TIME.

**DECIDUOUS TREES 2" TO 4" CALIPER**  
NOT TO SCALE

**LANDSCAPE NOTES**

1. PLANT QUANTITIES SHOWN ON PLANT LISTS ARE FOR CONVENIENCE TO THE CONTRACTOR ONLY. THE CONTRACTOR IS RESPONSIBLE FOR ALL PLANT MATERIAL INSTALLATION AS SHOWN ON PLANS.
2. SIZE AND GRADING STANDARDS OF PLANT MATERIALS SHALL CONFORM TO THE LATEST EDITION OF "U.S.A. STANDARD FOR NURSERY STOCK," BY THE AMERICAN ASSOCIATION OF NURSERYMEN, INC.
3. ALL PLANT MATERIAL SHALL BE FREE FROM INSECTS AND DISEASE.
4. ALL PLANTING SHALL BE DONE IN ACCORDANCE WITH ACCEPTABLE HORTICULTURAL PRACTICES. THIS IS TO INCLUDE PROPER PLANTING MIX, PLANT BED AND TREE PIT PREPARATION, PRUNING, STAKING OR GUYING, WRAPPING, SPRAYING, FERTILIZATION, PLANTING AND ADEQUATE MAINTENANCE UNTIL ACCEPTANCE BY THE OWNER.
5. PLANT MATERIAL SHALL BE GUARANTEED FOR A PERIOD OF ONE YEAR BY THE CONTRACTOR AND A PERIOD OF TWO YEARS THEREAFTER BY THE OWNER FROM DATE OF INSTALLATION. DURING THE ONE YEAR GUARANTEE PERIOD, DEAD PLANT MATERIAL SHALL BE REPLACED AT NO COST TO THE OWNER. AT THE END OF THE ONE YEAR PERIOD, THE CONTRACTOR SHALL OBTAIN FINAL ACCEPTANCE FROM THE OWNER.
6. ALL GRASS, OTHER VEGETATION AND DEBRIS SHALL BE REMOVED FROM ALL PLANTING AREAS PRIOR TO PLANTING.
7. EXISTING TREES TO BE PRESERVED WILL BE PROTECTED DURING CONSTRUCTION AND SHALL BE THE RESPONSIBILITY OF THE GENERAL CONTRACTOR.
8. THE LANDSCAPE CONTRACTOR IS ADVISED OF THE PRESENCE OF THE UNDERGROUND UTILITIES AND SHALL VERIFY THE EXISTENCE AND LOCATION OF SAME BEFORE COMMENCING AND DIGGING OPERATIONS. THE LANDSCAPE CONTRACTOR SHALL REPLACE OR REPAIR UTILITIES, PAVING, WALKS, CURBING, ETC. DAMAGED IN PERFORMANCE OF THIS JOB AT NO ADDITIONAL COST TO THE OWNER.
9. ALL SHRUB BEDS SHALL BE MULCHED WITH 3" CLEAN SHREDDED BARK MULCH.
10. THE CONTRACTOR SHALL PROVIDE 4" LOAM FOR ALL AREAS TO BE SODDED OR SEEDED. PLANTING AREAS SHALL RECEIVE 12" ROLLED THICKNESS OF LOAM. THE LANDSCAPE CONTRACTOR SHALL COORDINATE SUBGRADE PREPARATION WITH THE GENERAL CONTRACTOR PRIOR TO PLACING LOAM.
11. ANY DEVIATION FROM THE LANDSCAPE PLAN, INCLUDING PLANT LOCATION, SELECTION, SIZE, QUANTITY OR CONDITION SHALL BE REVIEWED AND APPROVED BY THE OWNER AND LANDSCAPE ARCHITECT (AND MUNICIPAL AUTHORITY, IF APPLICABLE) PRIOR TO INSTALLATION ON SITE.
12. WHERE INDICATED ON PLAN, PLANTING SOIL MIXTURE FOR PERENNIAL AND ANNUAL FLOWER BED AREAS SHALL CONSIST OF FOUR PARTS TOPSOIL, TWO PARTS SPHAGNUM PEAT MOSS, AND ONE PART HORTICULTURAL PERLITE BY VOLUME. PEAT MOSS MAY BE SUBSTITUTED WITH WELL-ROTTED OR DEHYDRATED MANURE OR COMPOST. ROTOTILL BEDS TO A DEPTH OF 8 INCHES.

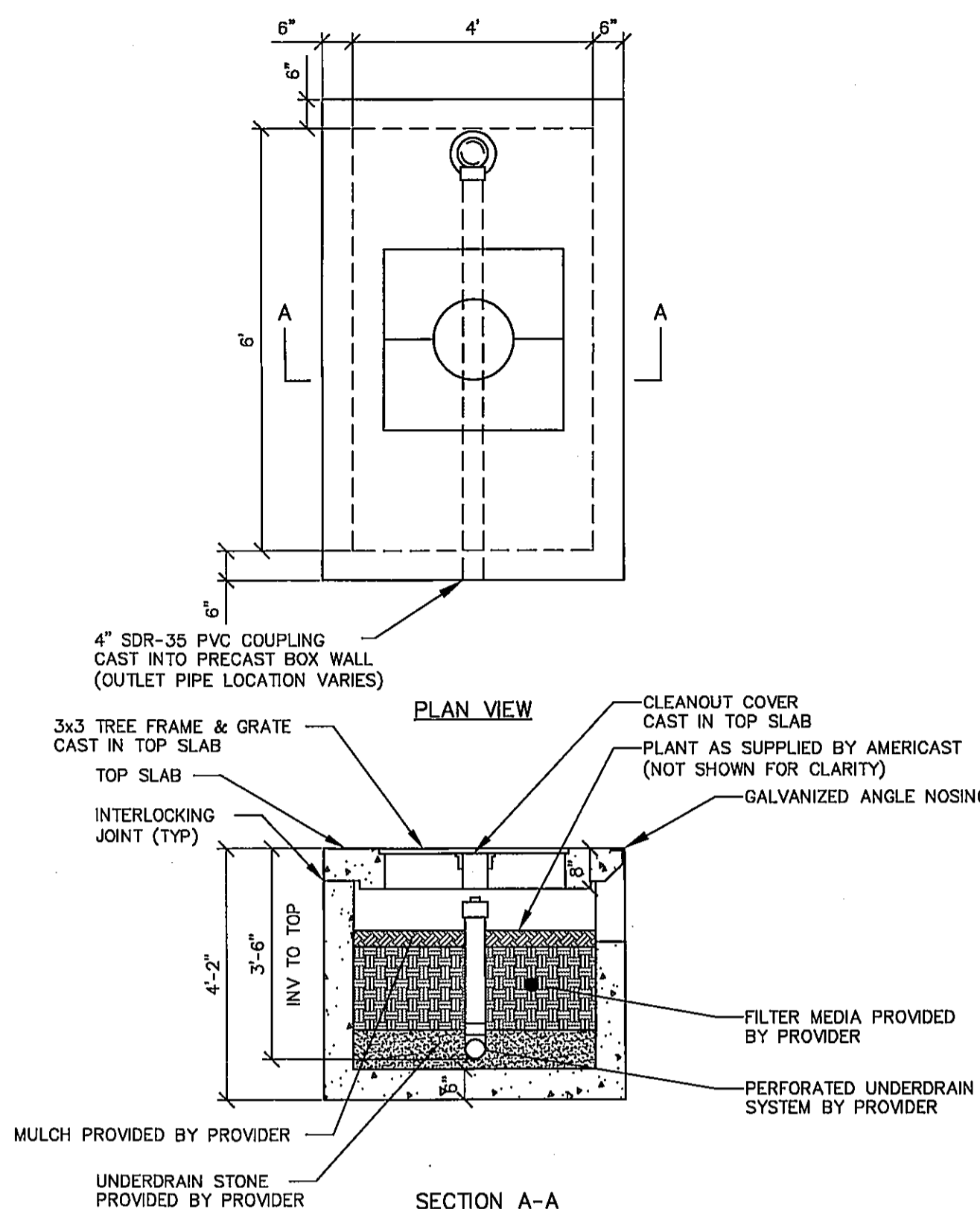

**PRECAST FILTERRA UNIT**  
NOT TO SCALE

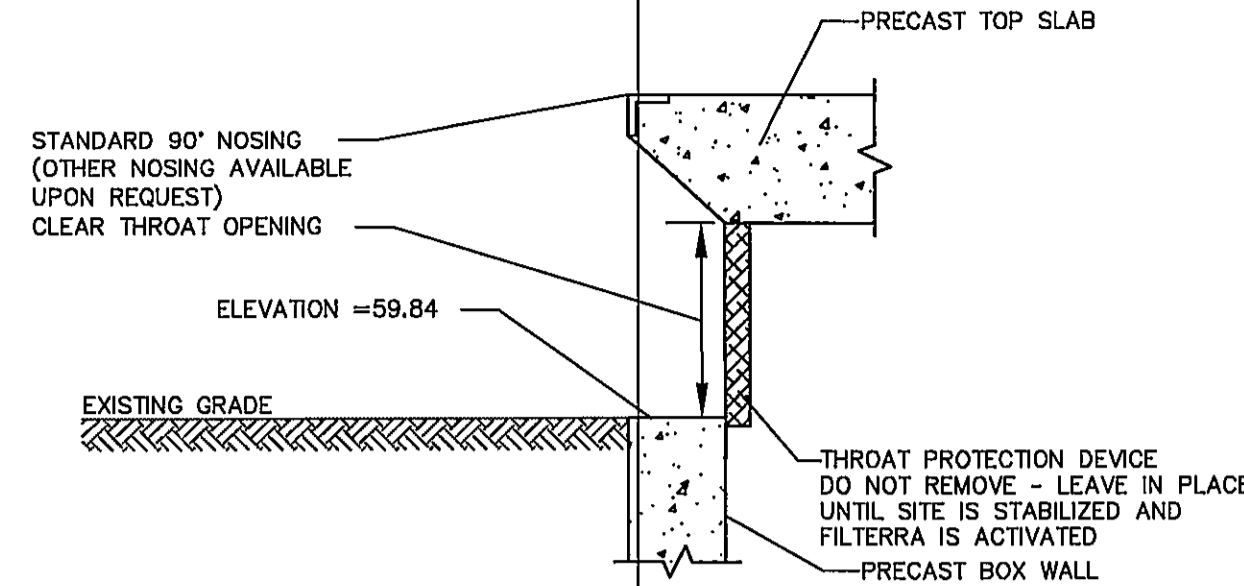

**SECTION VIEW**  
**FILTERRA THROAT OPENING**  
NOT TO SCALE

MODIFICATIONS OF DRAWINGS ARE ONLY PERMITTED BY WRITTEN AUTHORIZATION FROM FILTERRA

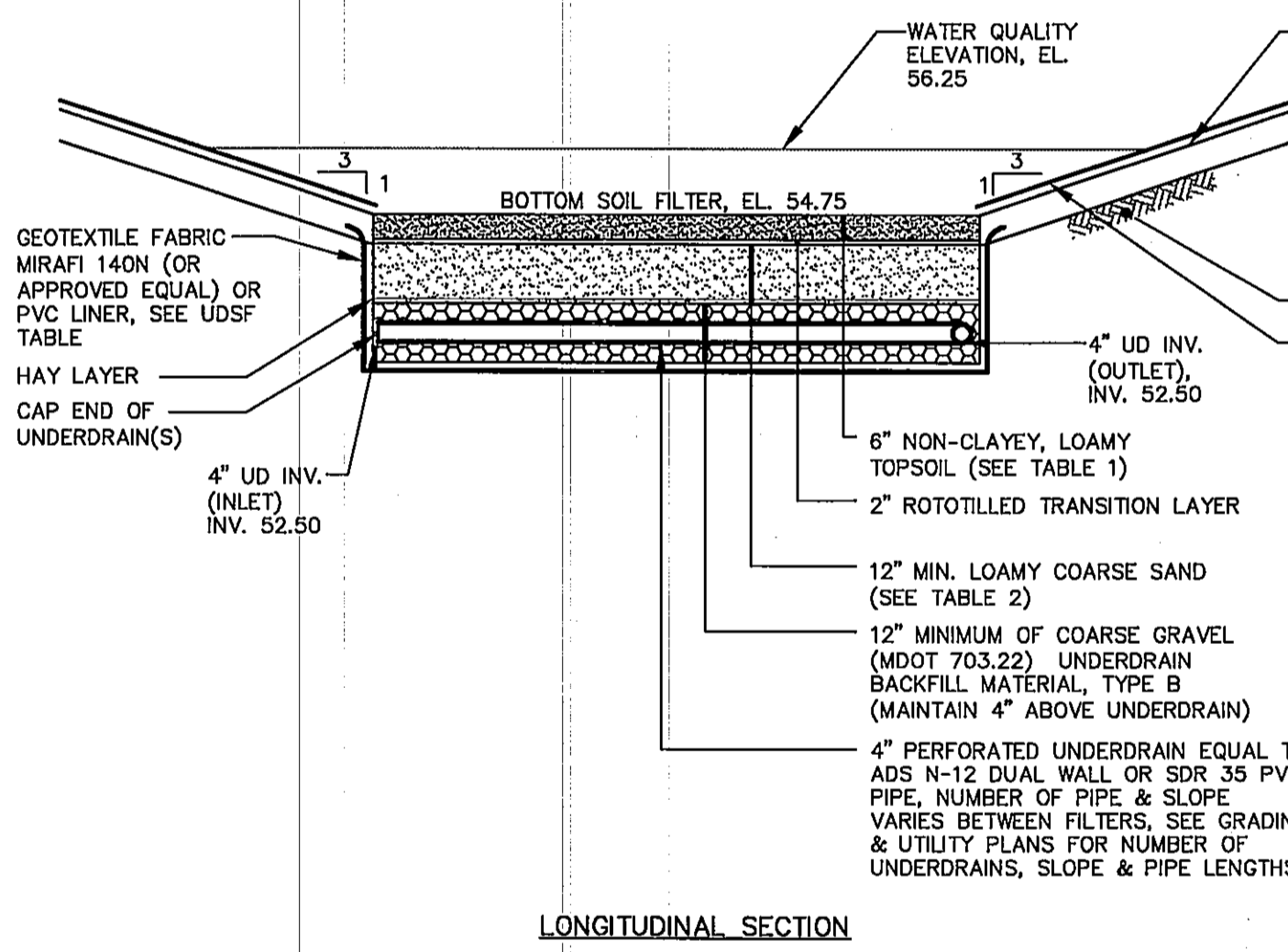

**TABLE 1**  
NON-CLAYEY, LOAMY TOPSOIL

SIEVE SIZE	% PASSING BY WEIGHT
#4	75-95
#10	60-90
#40	35-85
#200	20-70
CLAY FRACTION	0-2

**TABLE 2**  
LOAMY COARSE SAND LAYER

SIEVE SIZE	% PASSING BY WEIGHT
#10	85-100
#20	70-100
#60	15-50
#200	8-15
CLAY FRACTION	0-2

NOTE: SUPERHUMUS OR EQUIVALENT.

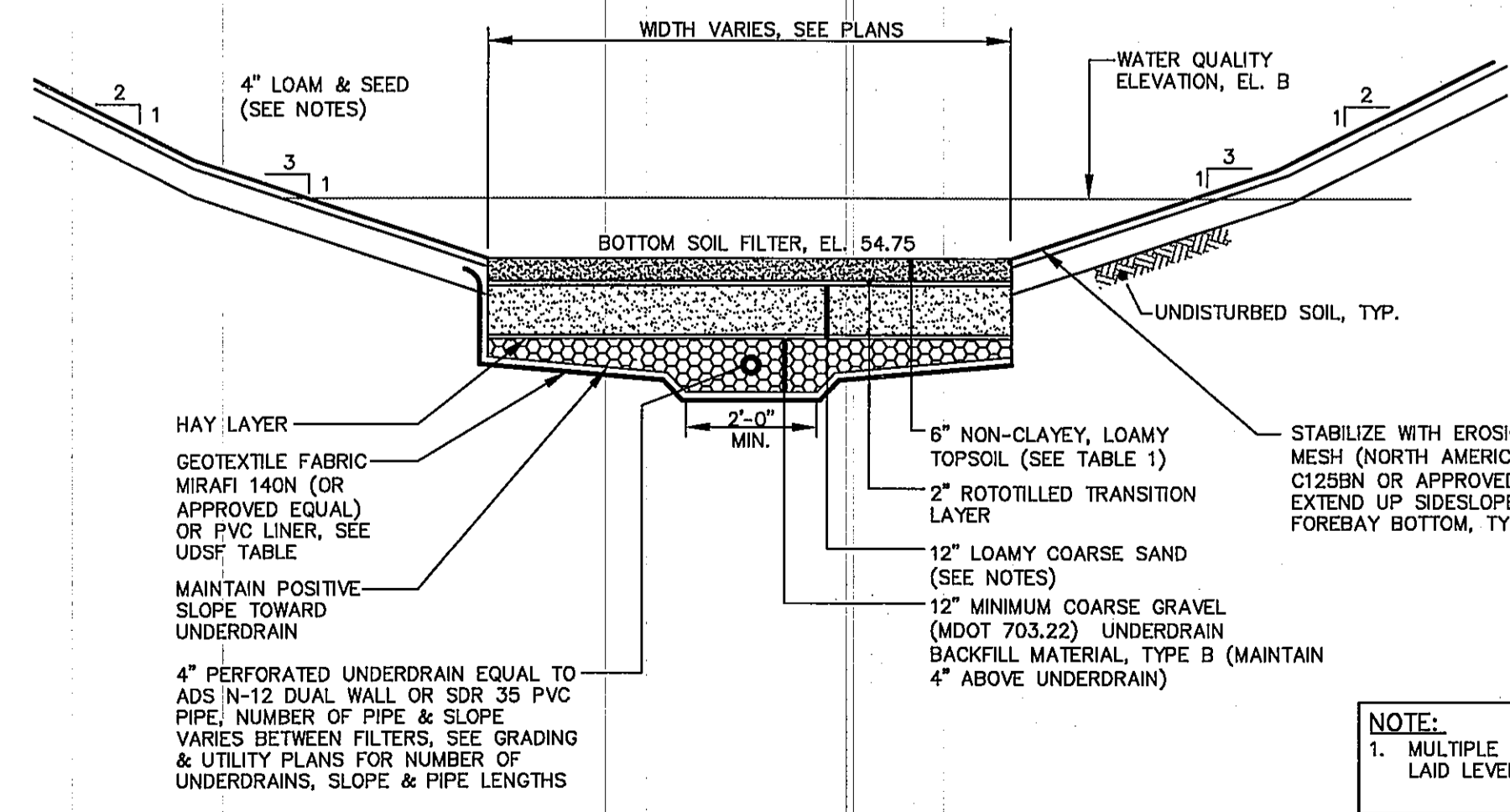

**SECTION**  
**UNDERDRAINED SOIL FILTER DETAIL**  
NOT TO SCALE

**NOTE:**  
1. MULTIPLE ROWS OF UNDERDRAIN SHALL CONNECT INTO A 6" HEADER LAID LEVEL PIPE UNLESS OTHERWISE SPECIFIED ON THE PLANS

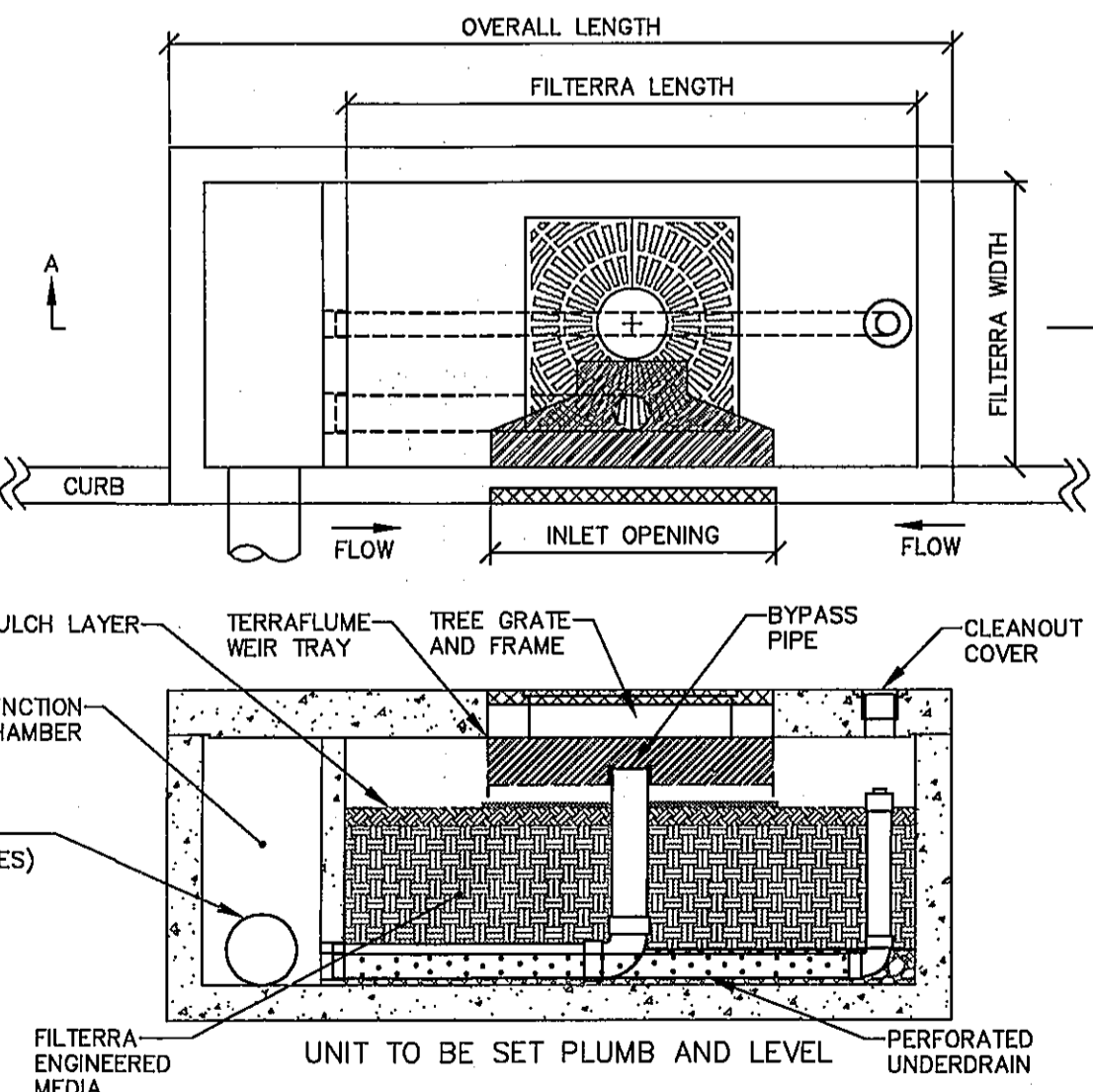

DESIGNATION (LENGTH x WIDTH)	INLET OPENING	MAX BYPASS PIPE SIZE	MAX BYPASS FLOW (GFS)	MAX OUTLET PIPE SIZE
6x12 or 12x6	4'-0" +	10" PVC	2.45	10" PVC

\* CONTACT FILTERRA FOR LARGER INLET OPENINGS OR DIFFERENT AVAILABLE CONFIGURATIONS

**FILTERRA DETAIL**  
NOT TO SCALE

**MAINTENANCE OVERSIGHT NOTES**  
ROUTINE CLEARING OF ACCUMULATED TRASH AND DEBRIS IS REQUIRED TO PREVENT CLOGGING OF THE INLET OPENING (JUST AS WITH ANY CATCH BASIN, INLET OR OTHER IN-CURB UNIT). AMERICAST INCLUDES A ONE-YEAR MAINTENANCE PLAN WITH EACH FILTERRA@SYSTEM TO ENSURE THE SYSTEMS ARE OPERATING PER SPECIFICATIONS. IN ADDITION, THE OWNER WILL PROVIDE AN EXECUTED 5 YEAR INSPECTION AND MAINTENANCE CONTRACT. SAID CONTRACT WILL BE WITH A PROFESSIONAL WITH KNOWLEDGE OF EROSION AND STORMWATER CONTROL, INCLUDING A DETAILED WORKING KNOWLEDGE OF THE PROPOSED BMP'S.

- THE COMPANY RECOMMENDS THAT LONG-TERM MAINTENANCE BE PERFORMED ON AT LEAST A SEMI-ANNUAL BASIS (GENERALLY SPRING AND FALL SERVICING) TO HELP PRESERVE FILTERRA@ FLOW THROUGH RATES AND TREATMENT PERFORMANCE ALSO FOUND IN THE FILTERRA@ IOM. EACH MAINTENANCE SESSION SHOULD INCLUDE, AT A MINIMUM, THE FOLLOWING:
1. INSPECTION OF THE SYSTEM STRUCTURE AND MEDIA;
  2. REMOVAL OF TRASH AND SILT FROM THE FILTER SURFACE;
  3. REPLACEMENT OF THE SURFACE MULCH LAYER. COMPLETE REPLACEMENT OF THE SOIL MEDIA IS GENERALLY REQUIRED ONLY AS PART OF A SPILL CLEAN-UP;
  4. PRUNING OF VEGETATION. IF THE VEGETATION IS IN DEAD OR IN POOR HEALTH, IT WILL REQUIRE REPLACEMENT; AND
  5. APPROPRIATE DISPOSAL OF ALL REFUSED ITEMS.

PROGRESS PRINT

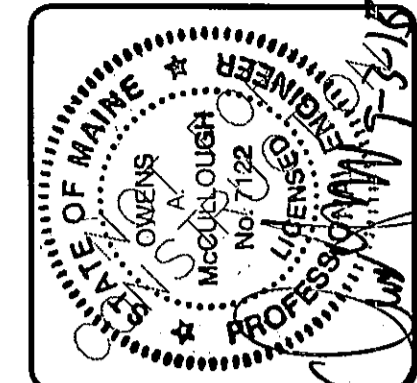

DESIGNED	CHECKED
OAM	OAM

REV. BY	DATE	STATUS	DESCRIPTION
A	OAM 9/03/15	SUBMITTED TO CITY FOR SITE PLAN REVIEW	

**SEBAGO TECHNICS**  
WWW.SEBAGO TECHNICS.COM  
250 Colford Rd. South Portland, ME 04106  
Tel. 207-200-2100

**DETAILS OF:** NORTHEAST AIR-FIXED BASE OPERATOR PORTLAND INTERNATIONAL AIRPORT, PORTLAND, MAINE  
**FOR:** NORTHEAST AIR 101 WESTBROOK STREET, PORTLAND, MAINE 04102



