

**LIGHTNING PROTECTION NOTES**

- AA ALL MATERIALS SHOWN ARE MANUFACTURED BY HEARY BROS. LIGHTNING PROTECTION CO., INC.
- BB THE LIGHTNING PROTECTION SYSTEMS AS SHOWN ON DRAWING HAS BEEN DESIGNED IN ACCORDANCE WITH UL96A & NFPA-780 LIGHTNING PROTECTION SYSTEM STANDARDS.
- CC CONDUCTORS SHALL MAINTAIN A HORIZONTAL OR DOWNWARD COURSE, FREE FROM "U" OR "V" (DOWN AND UP) POCKETS.
- DD NO BEND OF CONDUCTOR SHALL FORM AN ANGLE OF LESS THAN 90 DEGREES NOR SHALL HAVE A RADIUS OF BEND LESS THAN 8".
- EE AIR TERMINALS SHALL BE SPACED EVERY 20' MAX. AROUND THE ROOF PERIMETER AND/OR ALONG RIDGES. AIR TERMINALS SHALL BE LOCATED WITHIN 2'-0" OF OUTSIDE CORNERS.
- FF AIR TERMINALS SHALL BE SPACED EVERY 50'-0" MAX. IN CENTER ROOF AREA.
- GG ACTUAL JOB SITE CONDITIONS MAY REQUIRE SLIGHT ALTERATIONS IN AIR TERMINAL, DOWN CONDUCTORS AND GROUND ROD LOCATIONS.
- HH BARE COPPER MATERIALS SHALL NOT BE INSTALLED ON ALUMINUM OR GALVALUM SURFACES, AND ALUMINUM MATERIALS SHALL NOT BE INSTALLED ON COPPER SURFACES.
- II ALL LIGHTNING PROTECTION CONDUCTORS SHALL BE FASTENED EVERY 3'-0" MAX.
- JJ ALL BOLTS ON BOLT-PRESSURE CONNECTORS SHALL BE TORQUED AT 150 POUND-INCHES (17N-m).
- KK ALL CONNECTIONS MUST BE USED WITH UL LISTED CLASS 1 OR CLASS II CABLE OF SAME METAL TYPE.
- LL METALLIC BODIES OF INDUCTANCE SITUATED WITH 6'-0" OF A LIGHTNING CONDUCTOR OR ANOTHER BONDED METAL BODY SHALL BE INTERCONNECTED TO THE LIGHTNING CONDUCTOR SYSTEM, UNLESS INHERENTLY GROUNDED.
- MM BOND TO ALL METAL BODIES OF CONDUCTANCE WITHIN 6'-0" OF THE MAIN LIGHTNING CONDUCTOR SUCH AS EXHAUST FANS, ROOF VENTS, METAL COOLING TOWERS, H.V.A.C. UNITS, LADDERS, RAILINGS, ANTENNAS, SKYLIGHTS, METAL STACKS AND ANY OTHER LARGE METAL BODY WHOSE HEIGHT EXCEEDS THAT OF THE AIR TERMINAL IN USE, UNLESS PROTECTED BY HIGHER ROOF ELEVATIONS.
- NN CONNECTIONS TO GROUND RODS SHALL BE MADE AT A POINT NOT LESS THAN 1'-0" BELOW FINISHED GRADE AND 2'-0" AWAY FROM FOUNDATION WALL.
- OO BOND TO WATERLINES (DOMESTIC & FIRE).
- PP A LIGHTNING ARRESTOR, PROTECTOR OR ANTENNA DISCHARGE UNIT SHALL BE INSTALLED ON EACH ELECTRIC AND TELEPHONE SERVICE AND RADIO AND TELEVISION ANTENNA LEAD-IN BY THE ELECTRICAL CONTRACTOR, IN ACCORDANCE WITH NFPA-70.

**SHEET NOTES**

Portland International Jetport

1001 Westbrook Street  
Portland, Maine 04102

**Gensler**

2020 K Street, NW  
Suite 200  
Washington, DC 20006  
Telephone 202.721.5200  
Facsimile 202.872.8587

**oest ASSOCIATES, INC.**  
343 Gorham Road, South Portland, ME 04106 P: (207) 774-1770 F: (207) 774-1246 www.oest.com  
engineers - architects - surveyors - construction managers

**amec**  
343 Gorham Road, South Portland ME 04106  
P: (207) 761-1770 F: (207) 774-1246 www.amec.com

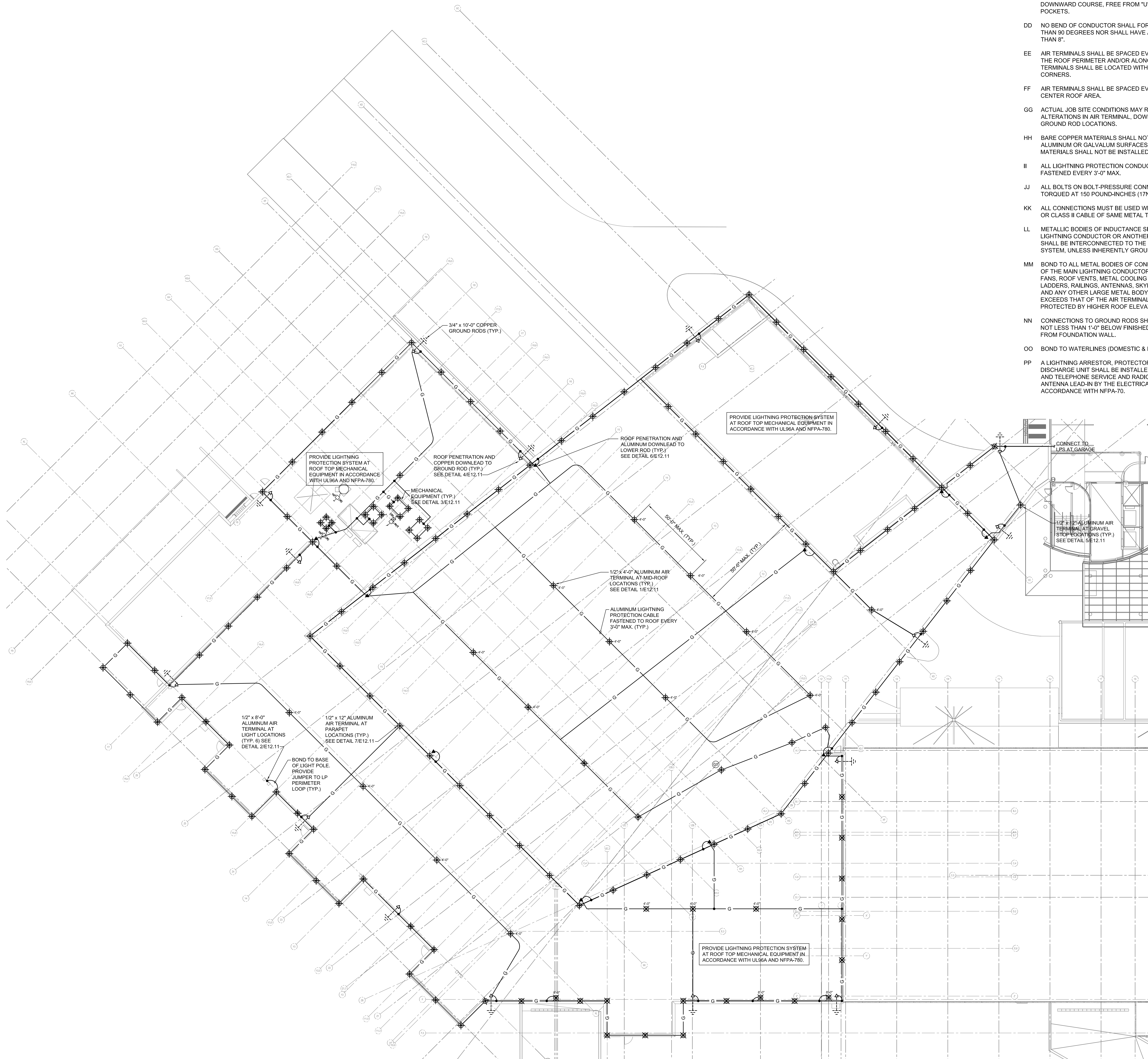

THESE DRAWINGS ARE ISSUED FOR CONSTRUCTION AND REFLECT ALL AMEC ISSUED BULLETINS AND SKETCHES.

Issue	Date & Issue Description	By	Check
01	12/03/08	LAM	BHG
02	01/23/09	LAM	BHG
03	10/26/09	LAM	BHG
04	11/02/09	LAM	BHG
05	11/20/09	LAM	BHG
06	09/01/11	LAM	BHG

**GENERAL NOTES**

- A SEE SHEET E00.00 FOR LEGEND AND GENERAL NOTES.
- B CONTRACTOR SHALL REFER TO FIRE ALARM, SECURITY, IT, AND PUBLIC ADDRESS SYSTEMS DRAWINGS FOR CONDUITS & WIRING REQUIREMENTS.
- C SEE SHEET E12.11 FOR LIGHTNING PROTECTION DETAILS.
- D ALL AIR TERMINALS SHALL BE 12" HIGH UNLESS OTHERWISE NOTED.

Project Name: PWM Terminal Enhancement  
 Project Number: 09-0395-000  
 CAD File Name: C:\AMEC\330101\E02.RP.10.dwg  
 Description: ELECTRICAL LIGHTNING PROTECTION PLAN - ROOF

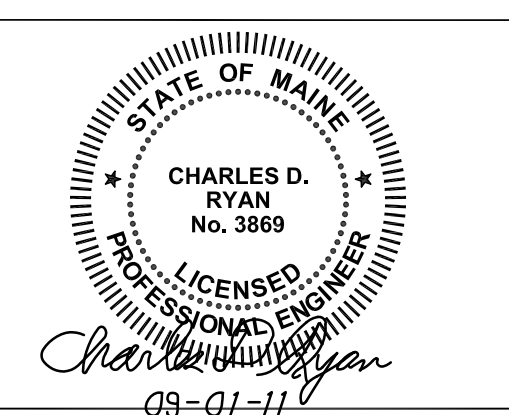

**KEY PLAN**

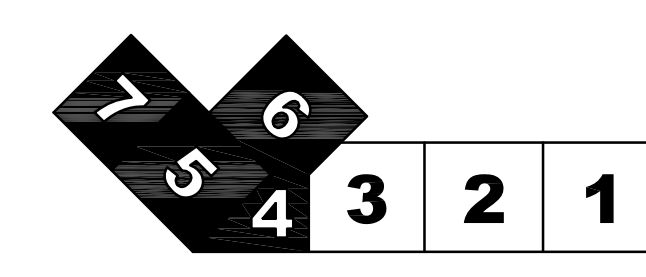

Scale: 1/16" = 1'-0"  
 Ref. North

**E02.RP.10**