

SHEET NOTES

**Portland International
Jetport**
1001 Westbrook Street
Portland, Maine 04102

Gensler
2020 K Street, Northwest
Suite 200 DC - 20006
Washington DC 20006
Tel: 202.872.8500
Fax: 202.872.8587

SM&W
3300 N. Fairfax Drive
Suite 302
Arlington, Virginia 22201
Tel: 703.546-6904
Fax: 703.546-6904
www.smwinc.com

SHEN MILSON WILKE

Issue	Date & Issue Description	By	Checked
1	12/20/08 CONSTRUCTION DOCUMENTS		
2	12/20/08 PROGRESS ISSUE		
3	01/22/09 95% CONSTRUCTION DOCUMENTS		
4	10/20/09 PROGRESS ISSUE		
5	08/17/10 ISSUED FOR PERMIT		
145	6/08/17/2011 ISSUED FOR CONSTRUCTION		

Project Name	PVI/TENNIS FACILITY EXPANSION
Project Number	
CAO File Name	
Description	AUDITORIUM FACILITY PLAN - LEVEL 4 - ZONE 4
Scale	As Indicated

AV02.04.04

©2008 Gensler

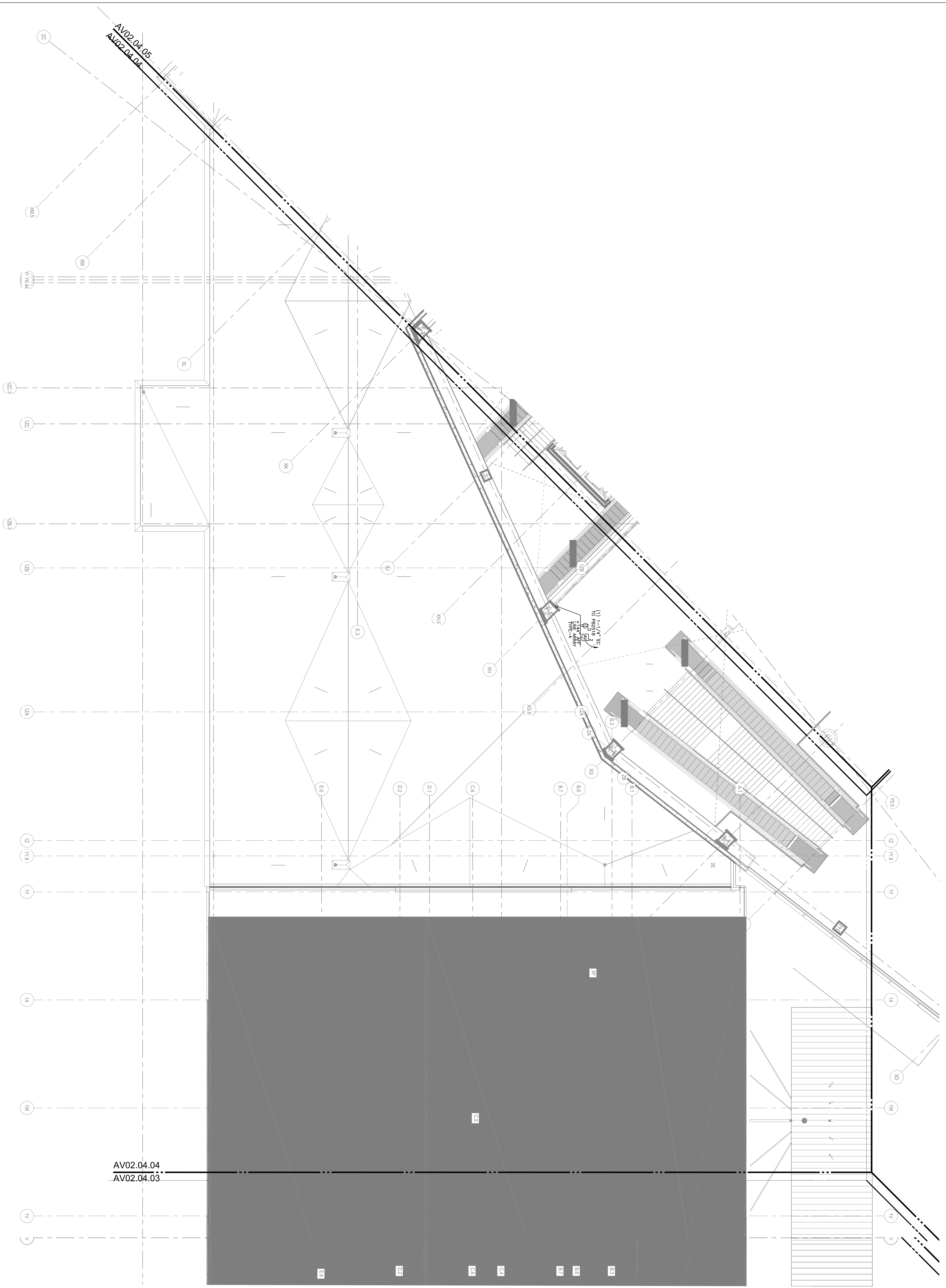

LEVEL 4 - ZONE 4
1/8" = 1'-0"

KEY PLAN

