

**SHEET NOTES**

- 01 REFER TO ENGINEERING DRAWINGS, E02.SERIES FOR ADDITIONAL INFORMATION
- 02 COORDINATE EXACT LOCATION AND POWER REQUIREMENTS. PLACE STUB UP WITHIN PYLON/MILLWORK. REFER TO DETAIL SHEET A07.12.01
- 03 REFER TO ENGINEERING DRAWINGS, SS02, AND TC.02 SERIES FOR ADDITIONAL INFORMATION
- 04 REFER TO FLIGHT INFORMATION DISPLAY DRAWINGS FOR ADDITIONAL INFORMATION
- 05 REFER TO CONCESSION DESIGN MATRIX FOR ELECTRICAL/ DATA REQUIREMENTS, TYP.
- 06 REFER TO GATE PODIUM MILLWORK DRAWINGS FOR RELATED ELECTRICAL/DATA REQUIREMENTS, TYP. PLACE STUB UP WITHIN MILLWORK. REFER TO A12.90 SHEET SERIES.
- 07 COORDINATE EXACT LOCATION AND POWER REQUIREMENTS. PLACE STUB WITHIN MILLWORK/PYLON REFER TO DETAIL SHEET XX.XX
- 08 RECEPTACLES TO BE TERMINATED ABOVE ADJACENT ACT CEILING AND NOT VISIBLE TO THE PUBLIC
- 09 RECEPTACLES TO BE TERMINATED ABOVE ACT. COORDINATE MOUNTING OF GID CPU. REFER TO TC.02 SERIES FOR ADDITIONAL INFORMATION
- 10 PROVIDE LINE ITEM ALLOWANCE FOR REMOVAL OF ELECTRICAL AND DATA FEEDS, DOGHOUSES AND STUB-UPS, ETC. AS REQUIRED IN THE SECURITY CHECKPOINT AREA OF THE EXISTING TERMINAL.

Portland International  
Jetport

1001 Westbrook Street  
Portland, Maine 04102

**Gensler**  
2020 K Street, Northwest  
Suite 200  
Washington DC 20006  
Telephone 202.721.5200  
Facsimile 202.872.8587

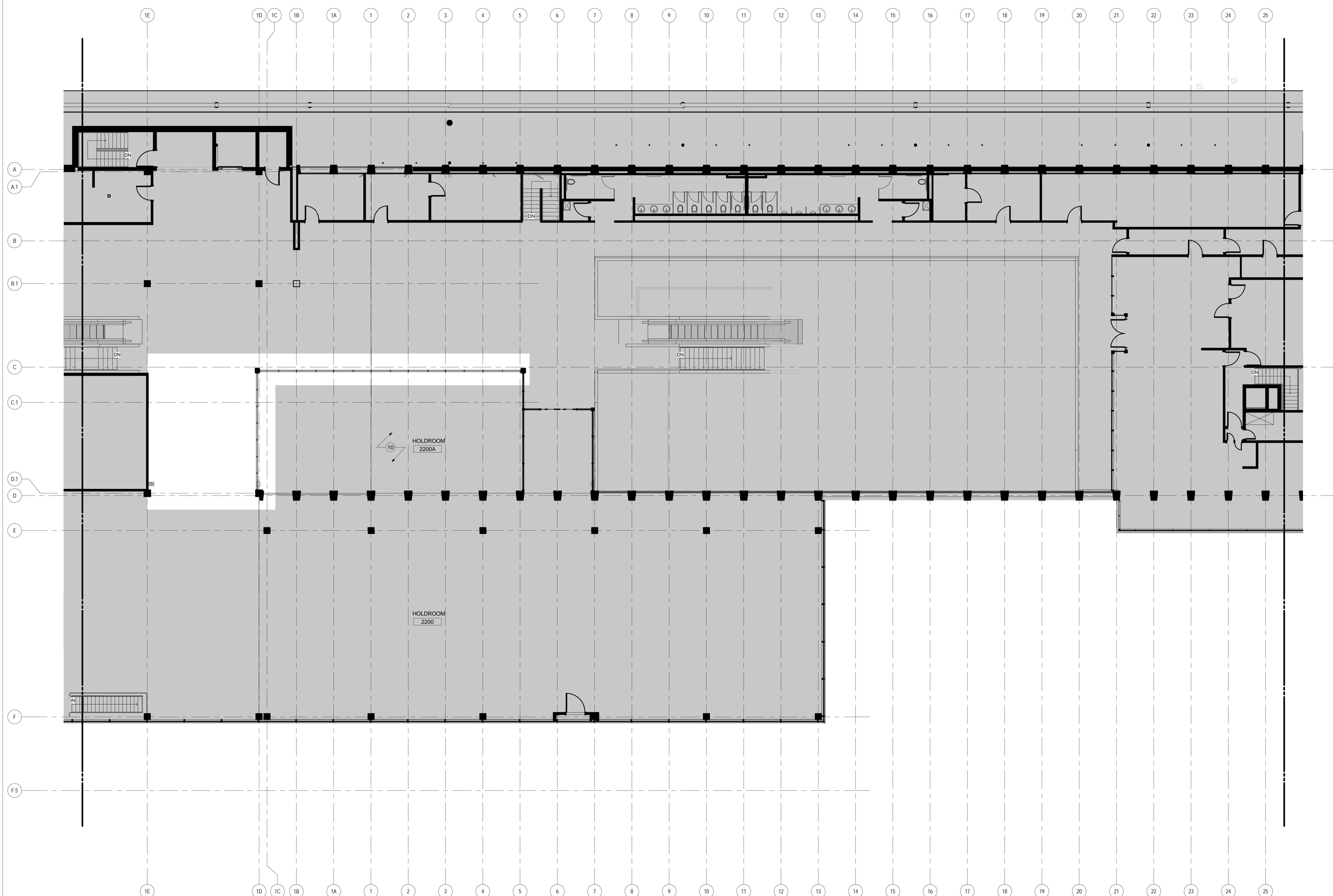

**GENERAL NOTES**

- A COORDINATE ALL WALL MOUNTED DEVICES WITH ASSOCIATED PARTITION TYPES AND FIRE RATING REQUIREMENTS. SEE ALIGNMENT LOCATIONS OF DEVICES ON SHEET A00.13.
- B COORDINATE ALL CEILING MOUNTED DEVICES WITH ASSOCIATED CEILING TYPES, LIGHT FIXTURE AND EQUIPMENT DEPTHS AND ALL REQUIRED SYSTEMS CLEARANCES
- C REFER TO EQUIPMENT SCHEDULE IN PROJECT MANUAL SECTION APPENDIX 'A'
- D REFER TO ELECTRICAL DRAWINGS FOR OUTLET TYPES.
- E REFER TO ELECTRICAL, FIRE ALARM, IT AND SECURITY DRAWINGS. PROJECT MANUAL FOR ADDITIONAL INFORMATION.
- F REFER TO MANUFACTURER AND LOCAL CODE REQUIREMENTS FOR ELEVATOR AND ESCALATOR INSTALLATIONS.
- G REFER TO ELECTRICAL DRAWINGS FOR GFI OUTLET LOCATIONS.
- H PROVIDE ELECTRICAL ROUTING AND IT STUB-UP AT TICKET COUNTERS. 1 SET OF STUB UP FOR EVERY 4 COUNTERS. REFER TO ELECTRICAL AND IT DRAWINGS FOR CABLE AND CIRCUIT INFORMATION. SIZE STUB UP ACCORDINGLY.
- I PROVIDE WEATHER PROOF DEVICES AT LOCATIONS WHERE REQUIRED.
- J COORDINATE POWER/DATA ROUTING REQUIREMENTS WITH DOOR HARDWARE. RELAY TIE IN WITH FIRE ALARM SYSTEM AS INDICATED OR REQUIRED BY CODE. ALSO REFER TO SECURITY DRAWINGS.
- K REFER TO PARTITION TYPES FOR ADDITIONAL INFORMATION ON FIRE RATED ASSEMBLIES. FIRESTOPPING SHALL BE PROVIDED AS REQUIRED BY CODE.
- L COORDINATE ALL FLOOR BOXES, CORE DRILLS AND STUB-UPS, ETC. WILL RADIANT FLOORING LAYOUT AND INSTALLATION. DO NOT RUN CONDUITS WITHIN SLAB.

| Date         | Description                |
|--------------|----------------------------|
| 09/22/08     | DESIGN DEVELOPMENT         |
| 12/03/08     | 75% CONSTRUCTION DOCUMENTS |
| 01/23/09     | 95% CONSTRUCTION DOCUMENTS |
| 10/26/09     | ISSUED FOR PERMIT          |
| 145 09/01/11 | ISSUED FOR CONSTRUCTION    |

Seal/Signature

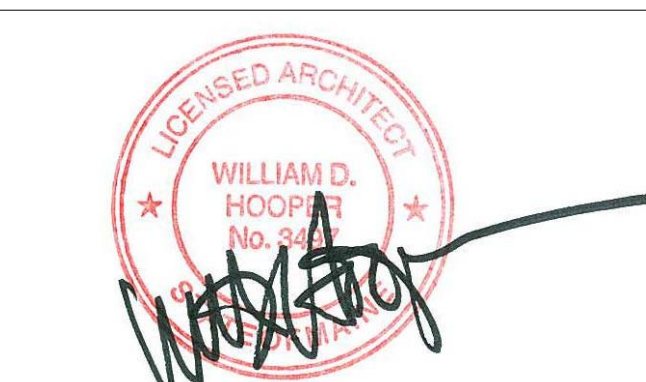

Project Name  
PWM Terminal Enhancement

Project Number  
09.6395.000

Description  
POWER & COMMUNICATION PLAN - LEVEL 3 - ZONE 2

Scale  
As indicated

**A03.03.02**

© 2009 Gensler

**KEY PLAN**

