

AVIATION ACRONYMS & ABBREV.

ACS	AIRLINE CUSTOMER SERVICE
ADGS	AIRCRAFT DOCKING GUIDANCE SYSTEM
AGT(S)	AUTOMATED GUIDEWAY TRANSIT (SYSTEM)
AI	APRON ILLUMINATION
ALP	AIRPORT LAYOUT PLAN
AMP	AIRPORT MASTER PLAN
AOA	AIRLINE OPERATING AREA
AOCNA	AIRPORT OPERATORS COUNCIL INTERNATIONAL-NORTH AMERICA
APHIS	ANIMAL PLANT HEALTH INSPECTION SERVICE
APU	AUXILIARY POWER UNIT
ARFF	AIRPORT RESCUE AND FIRE FIGHTING
BC	BABY CHANGE
BCUBCD	BAGGAGE CLAIM UNIT OR DEVICE
BHS	BAGGAGE HANDLING SYSTEM
BHS CR	BAGGAGE HANDLING SYSTEM CONTROL RM.
BHS MCP	BAGGAGE HANDLING SYSTEM MOTOR CONTROL PANEL
BIDS	BAGGAGE INFORMATION DISPLAY SYSTEM
BMS	BUILDING MANAGEMENT SYSTEM
BOS	BACK OF STAND ROADWAY
C COMM	COMMUNICATIONS SYSTEMS RM. (TELECOMMUNICATION)
CAS	CIVIL AERONAUTICS BOARD
CC	COMPANION CARE
CCTV	CLOSED CIRCUIT TELEVISION
CUTE	COMMON USE TERMINAL EQUIPMENT
DBH	DAY BAG HOLDROOM
DOT	DEPARTMENT OF TRANSPORTATION
ECs	ENVIRONMENTAL CONTROL SYSTEM
EFSD	EMERGENCY FUEL SHUT OFF
EMB	EMERGENCY REGIONAL JET (BRAND NAME TYPE)
EM GEN	EMERGENCY GENERATOR
FA	FAMILY ASSIST
FAA	FEDERAL AVIATION ADMINISTRATION
FIDS	FLIGHT INFORMATION DISPLAY SYSTEM
FIS	FEDERAL INSPECTION SERVICE
GIDS	GATE INFORMATION DISPLAY SYSTEM
GSE	GROUND SERVICE EQUIPMENT
HOS	HEAD OF STAND ROADWAY
HR	HOLDROOM
HZ	HERZ
400HZ	POWER SYSTEM FOR PARKED AIRCRAFT
ICAO	INTERNATIONAL CIVIL AVIATION ORGANIZATION
IE	INDEPENDENT ELECTRICAL
IGR	INTELLIGENT GATE READER (BOARDINGPASS VALIDATOR)
LOG	LOGISTICS
LOB	LEFT OVER BAGGAGE
MAINT	MAINTENANCE
MGR	MANAGER
ML ACS	MAINLINE AIRLINE CUSTOMER SERVICE
NFPA	NATIONAL FIRE PROTECTION ASSOCIATION
OL	OCCUPANT LOAD
OLF	OCCUPANT LOAD FACTOR
OPS	OPERATIONS
OSB	OVERSIZED BAGGAGE
PAX	PASSENGER(S)
PBB	PASSENGER BOARDING BRIDGE (AKA LOADING BRIDGES & JETWAYS)
PCA	PRECONDITIONED AIR
PHS	PUBLIC HEALTH SERVICE
PSA	PASSENGER SERVICE AGENTS
PWC	POTABLE WATER CABINET
RAC	RENTAL CAR FACILITIES
RAMP OPS	RAMP OPERATIONS
RCC	ROVER COMMAND CENTER
RIDS	RAMP INFORMATION DISPLAY SYSTEM
ROW	RIGHT OF WAY
SECY	SECRETARY
SIDA	SITE IDENTIFICATION DISPLAY AREA
SRCH	SEARCH RM.
SUPV	SUPERVISOR
SVC	SERVICE
TECH	TECHNOLOGY, TECHNICAL
TKT	TICKET
TKTG	TICKETING
TL	TAXILANE
TW	TAXIWAY
UPS	UNINTERRUPTED POWER SOURCE
USCS	UNITED STATES CUSTOM SERVICE
USPS	UNITED STATES POSTAL SERVICE
VSR	VEHICLE SERVICE ROAD

SHEET NUMBERING SYSTEM

A02.03.04

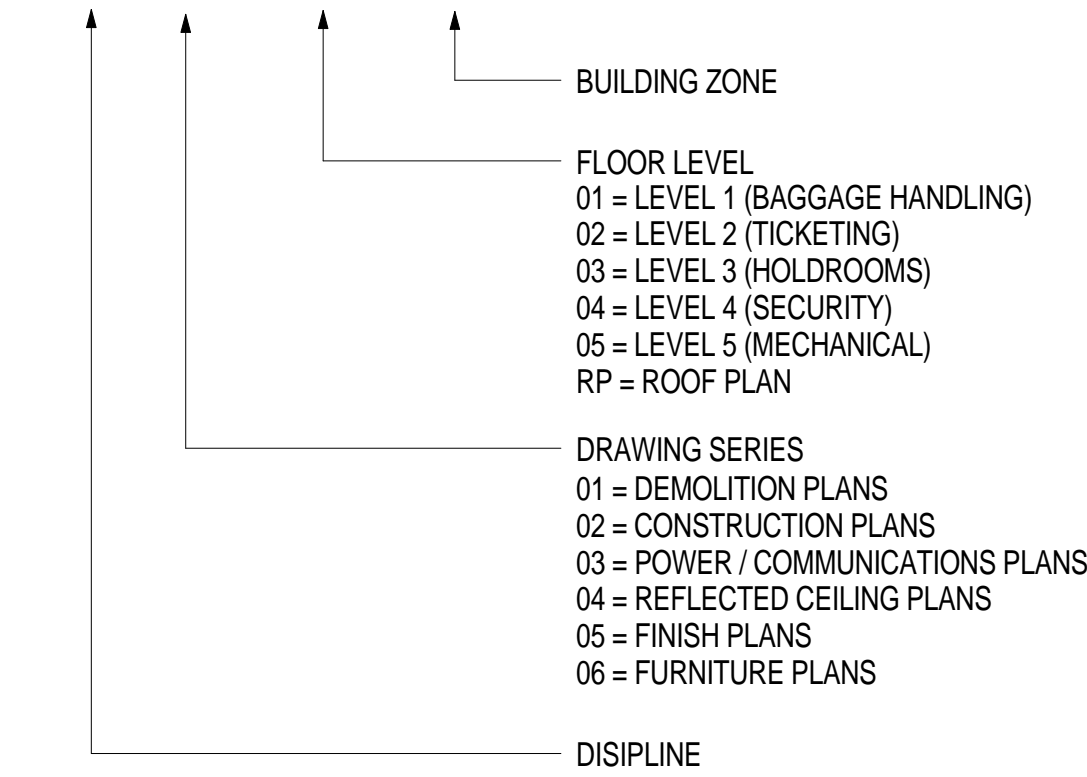

KEY PLAN

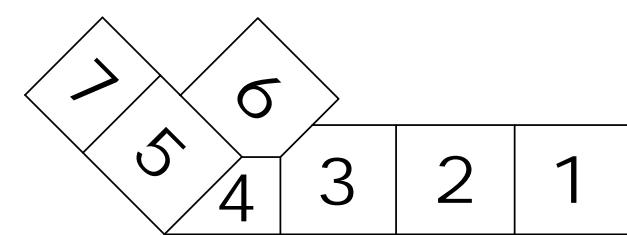

GRAPHIC SYMBOLS (CONT.)

ELEVATION INDICATIONS

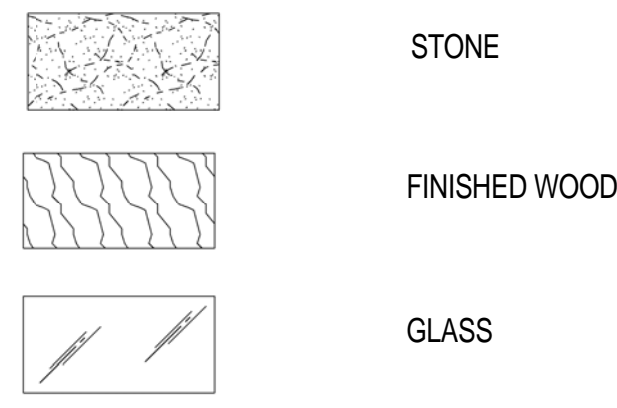

SECTION INDICATIONS

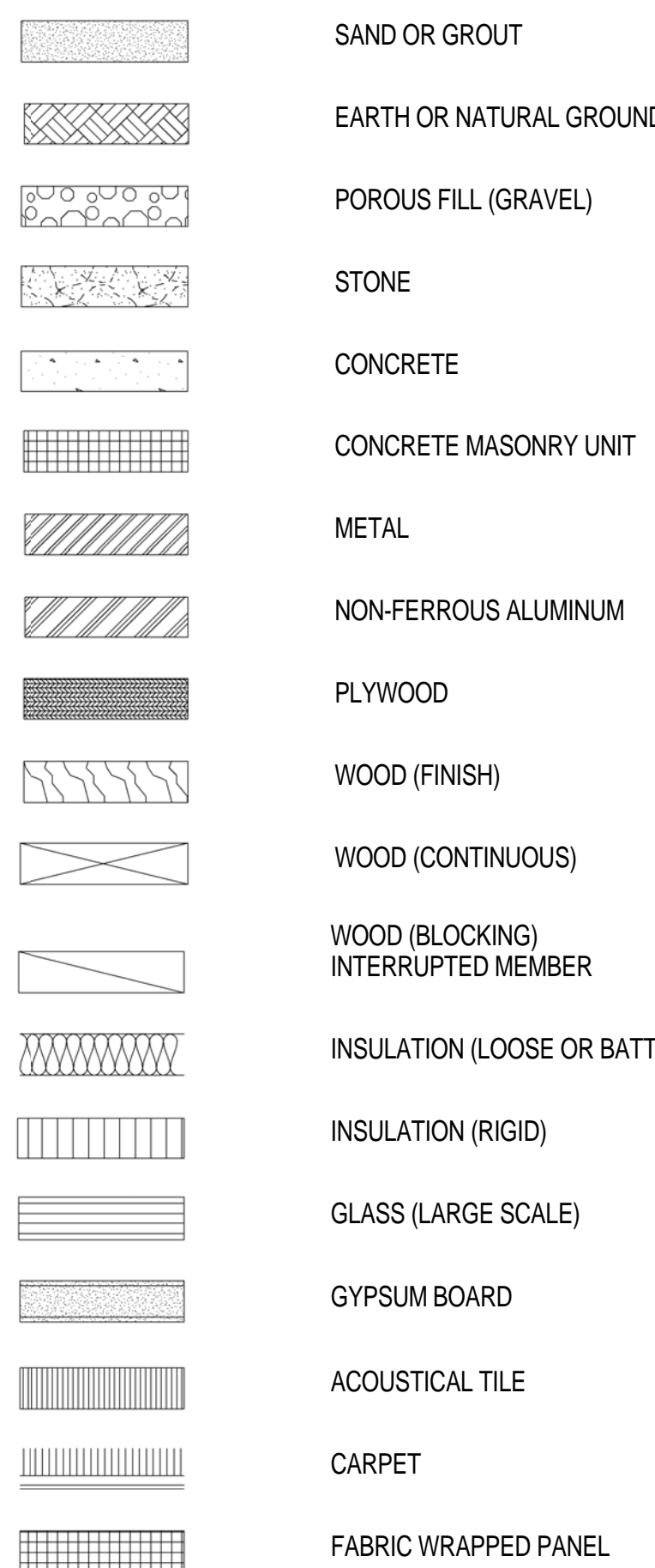

GRAPHIC SYMBOLS (CONT.)

POWER & COMMUNICATION CONT.

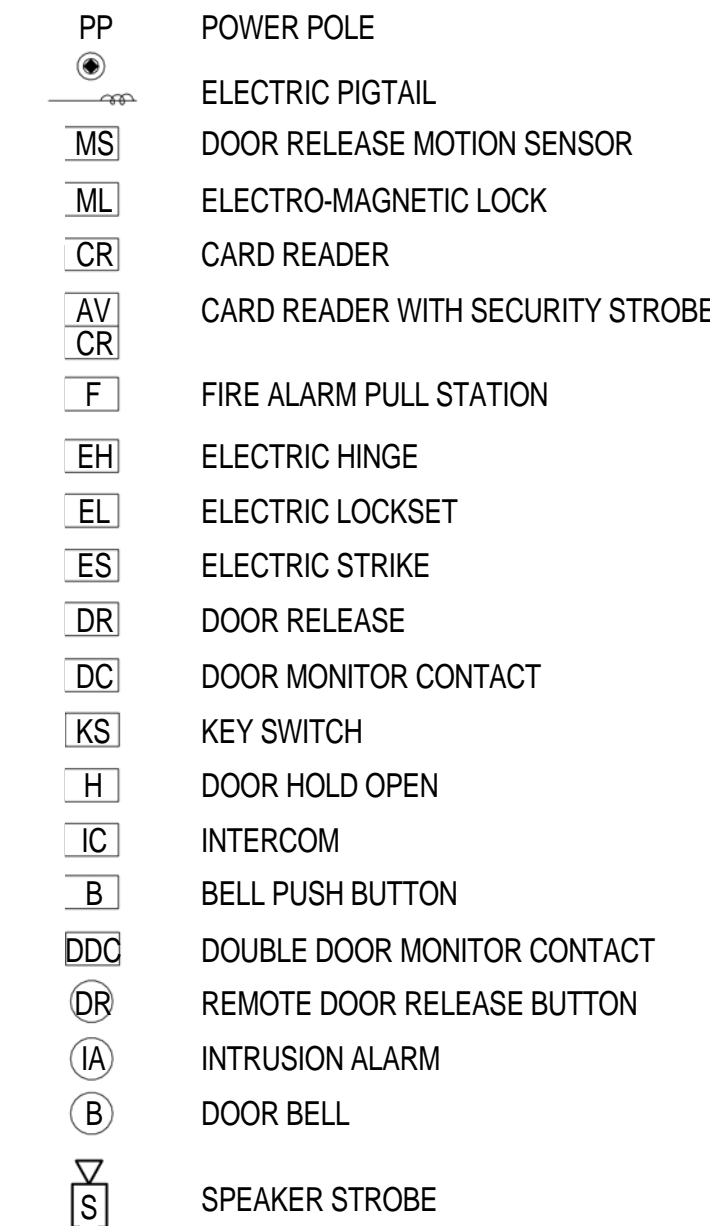

REFLECTED CEILING

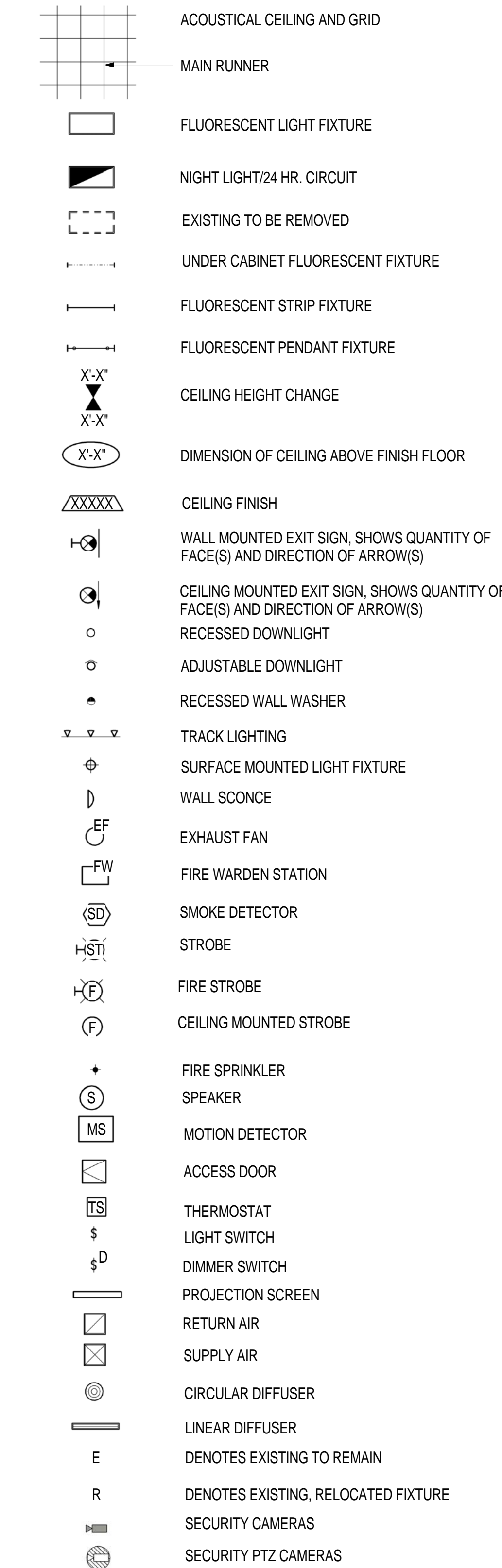

GRAPHIC SYMBOLS (CONT.)

POWER & COMMUNICATION

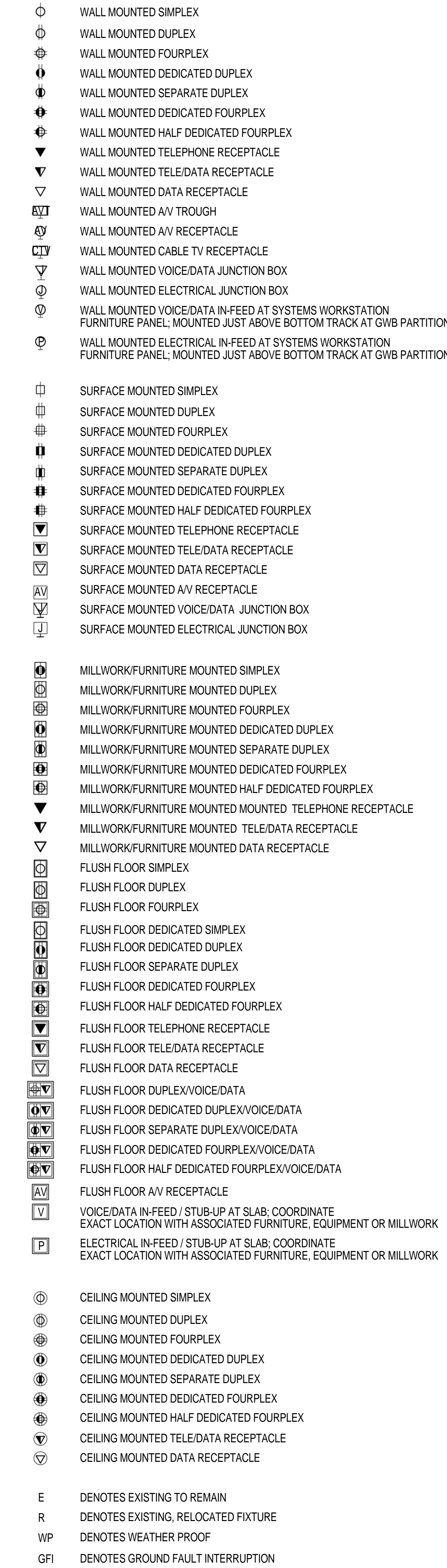

THESE SYMBOLS REPRESENT THE MOUNTING METHOD AND TYPE. REFER TO ENGINEERING DRAWINGS FOR EXACT CONFIGURATION AND ADDITIONAL INFORMATION.

GRAPHIC SYMBOLS

CONSTRUCTION

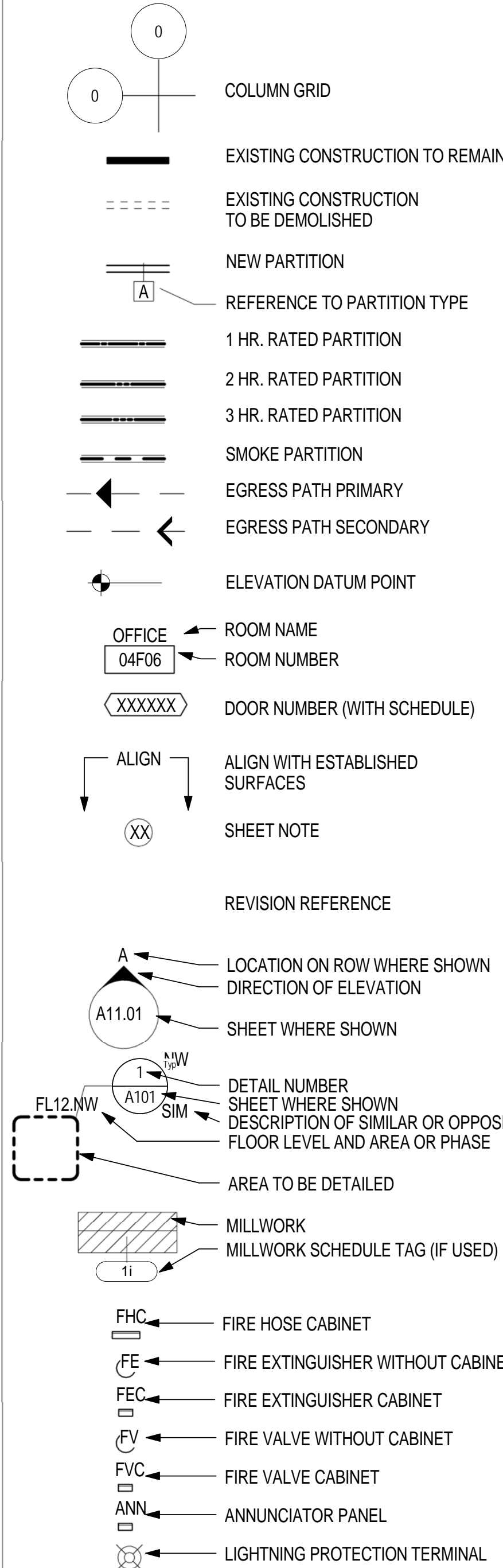

DEMOLITION

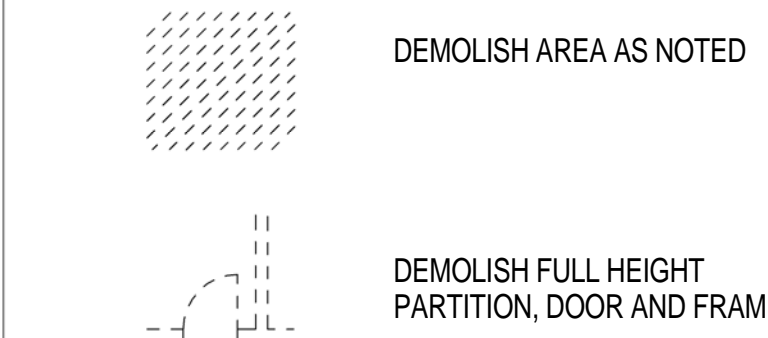

FINISH

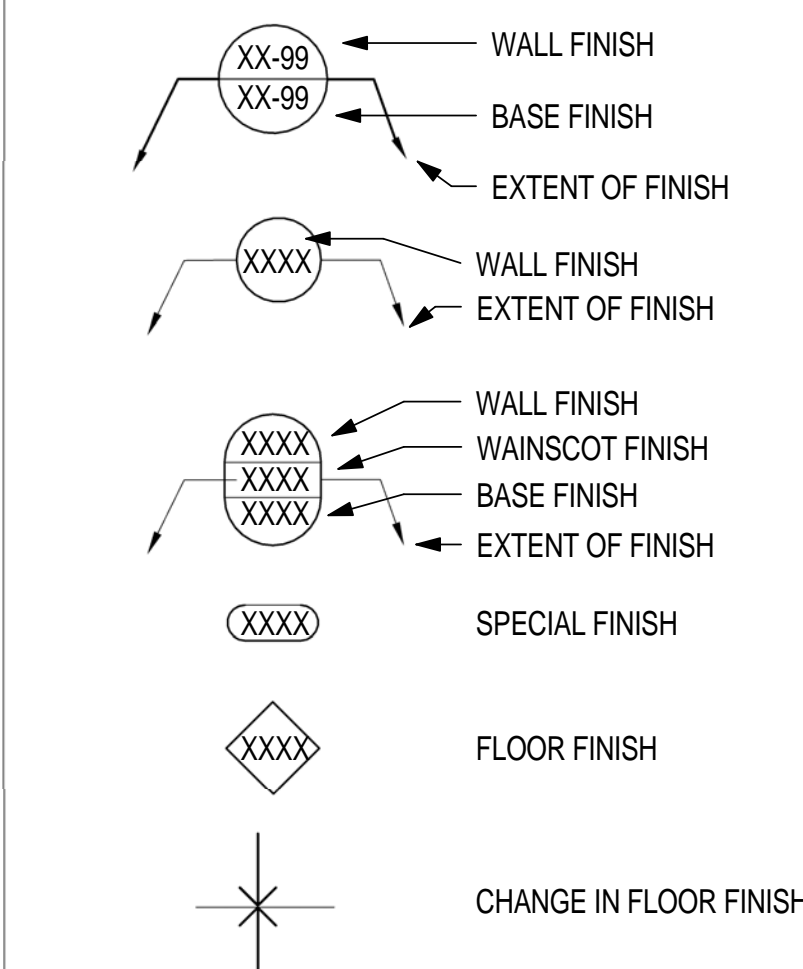

BUILDING ZONES

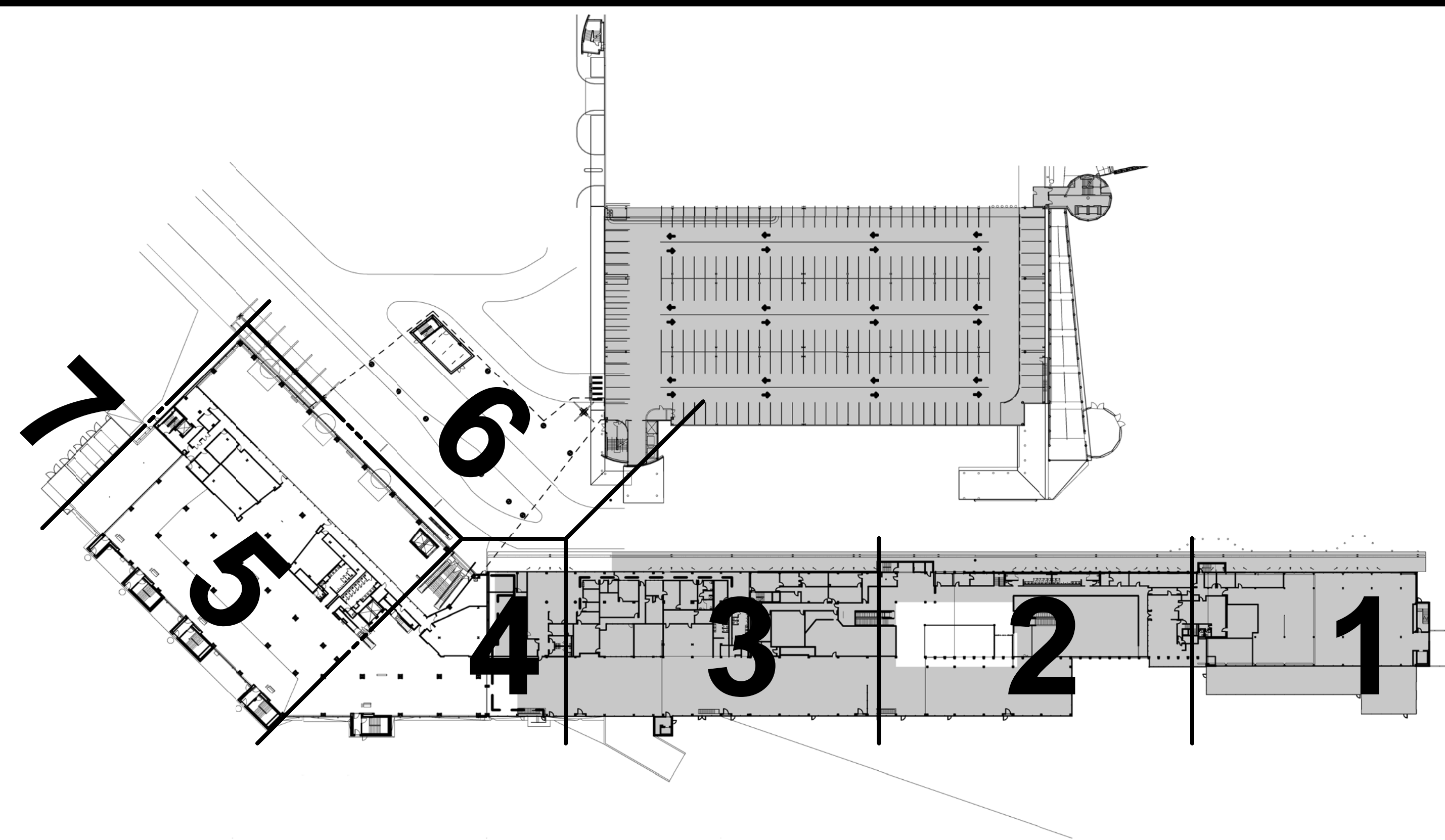

Portland International Jetport
1001 Westbrook Street
Portland, Maine 04102

Gensler

2020 K Street, Northwest
Suite 200
Washington DC 20006
Telephone 202.721.5200
Facsimile 202.872.8587

Date	Description
07/11/08	SCHEMATIC DESIGN
09/22/08	DESIGN DEVELOPMENT
12/03/08	75% CONSTRUCTION DOCUMENTS
01/23/09	95% CONSTRUCTION DOCUMENTS
10/26/09	ISSUED FOR PERMIT
11/12/09	ADDENDUM #2
145 09/01/11	ISSUED FOR CONSTRUCTION

Seal/Signature

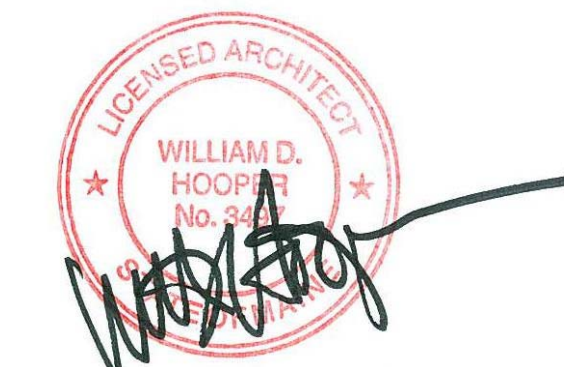

Project Name
PWM Terminal Enhancement

Project Number
09.6395.000

Description
GRAPHIC SYMBOLS

Scale
As indicated

A00.12

© 2009 Gensler