

R. W. Gillespie & Associates, Inc.

86 Industrial Park Road, Suite 4, Saco, ME 04072 207-286-8008
200 Int'l Drive, Suite 170, Portsmouth, NH 03801 603-427-0244

LETTER OF TRANSMITTAL

Date:	25 May 2011	Project No.:	557-14
Attention:	Mr. Cuyler Feagles (cmf@portlandmaine.gov)		
Re:	In-Place Density Testing Terminal Enhancement, Portland Int. Jetport Portland, Maine		

City of Portland, Portland Int. Jetport

1001 Westbrook Street

Portland, Maine 04102

We are sending you attached In-Place Density Test Results.

Date(s) Performed:

May 9, 11, 12, and 13, 2011

Test (s) Performed

In-Place Density Testing - Nuclear Method ASTM D2922

Meets Specification

Selected Tests Do Not Meet Specification - Noted with an *

Note: Materials descriptions and maximum laboratory dry density values were transmitted under separate cover and are referenced in the attached summaries by the material number.

Remarks:

Copy To: Roy Williams: rsw@portlandmaine.gov
 Jim Stanislaski: jim_stanislaski@gensler.com
 Cliff Takara: clifford_takara@gensler.com
 Lacey Fogg: Lacey.Fogg@amec.com
 Mike Fusco: mfusco@tcco.com
 Shaun Winner: swinner@tcco.com
 Elizabeth O'Toole: eotoole@tcco.com
 TMM@portlandmaine.gove
 ldobson@portlandmaine.gov
 bcybulski@tcco.com
 rdixon@tcco.com
 Geoff Mitchell: gemitchell@tcco.com

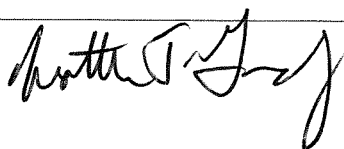
Signed: 

SUMMARY OF IN-PLACE DENSITIES - ASTM D6938
 TERMINAL ENHANCEMENT AT THE PORTLAND INTERNATIONAL JETPORT
 PORTLAND, MAINE
 RWG&A PROJECT NO. 557-14

Lab No.	Soil Description	ASTM D1557 Max Density	ASTM D1557 Opt. Moisture
11784	Type D Gravel	133.6	6.4

Client: City of Portland
 Test Date: 5/9/2011
 Technician: MJK
 Gauge Model/Serial Number: L 500

Report Issue Date:

Test No.	Location	Elevation	ASTM D6938 Dry Density (pcf)	ASTM D6938 Water Content (%)	Percent of Max. (%)	Lab. No.
1	XM+10'/Y6.5	FG		Not Performed		11784
2	XM+10'/Y4.5	FG		Not Performed		11784
3	XM+10'/Y2.5	FG	126.6	2	95	11784
4	Sidewalk - Upper Lot	FG	131.3	4	98	11784
5	Sidewalk - Upper Lot	FG	126.6	6	95	11784
6	XM.5+10'/Y2.5	FG-18"	129.7	3	97	11784
7	XM.5+10'/Y1	FG-18"	126.9	4	95	11784
8	XM+10'/ZC	FG	129.1	6	97	11784
9	Sidewalk - Upper Lot	FG	127.0	3	95	11784
10	XM.5+10'/Y3.5	FG-18"	130.8	3	98	11784
11	XM.5+10'/Y5.5	FG-18"	129.6	5	97	11784

Remarks:

- FG = Finish Grade
- FF = Finish Floor
- FGB = Finish Grade of Base
- FGSB = Finish Grade of Subbase
- FGSG = Finish Grade of Subgrade
- TOW = Top of Foundation Wall
- BOW = Bottom of Wall
- BOF = Bottom of Footing
- SG = Subgrade

Checked by:

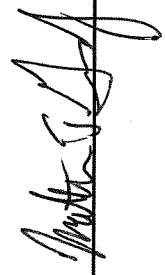

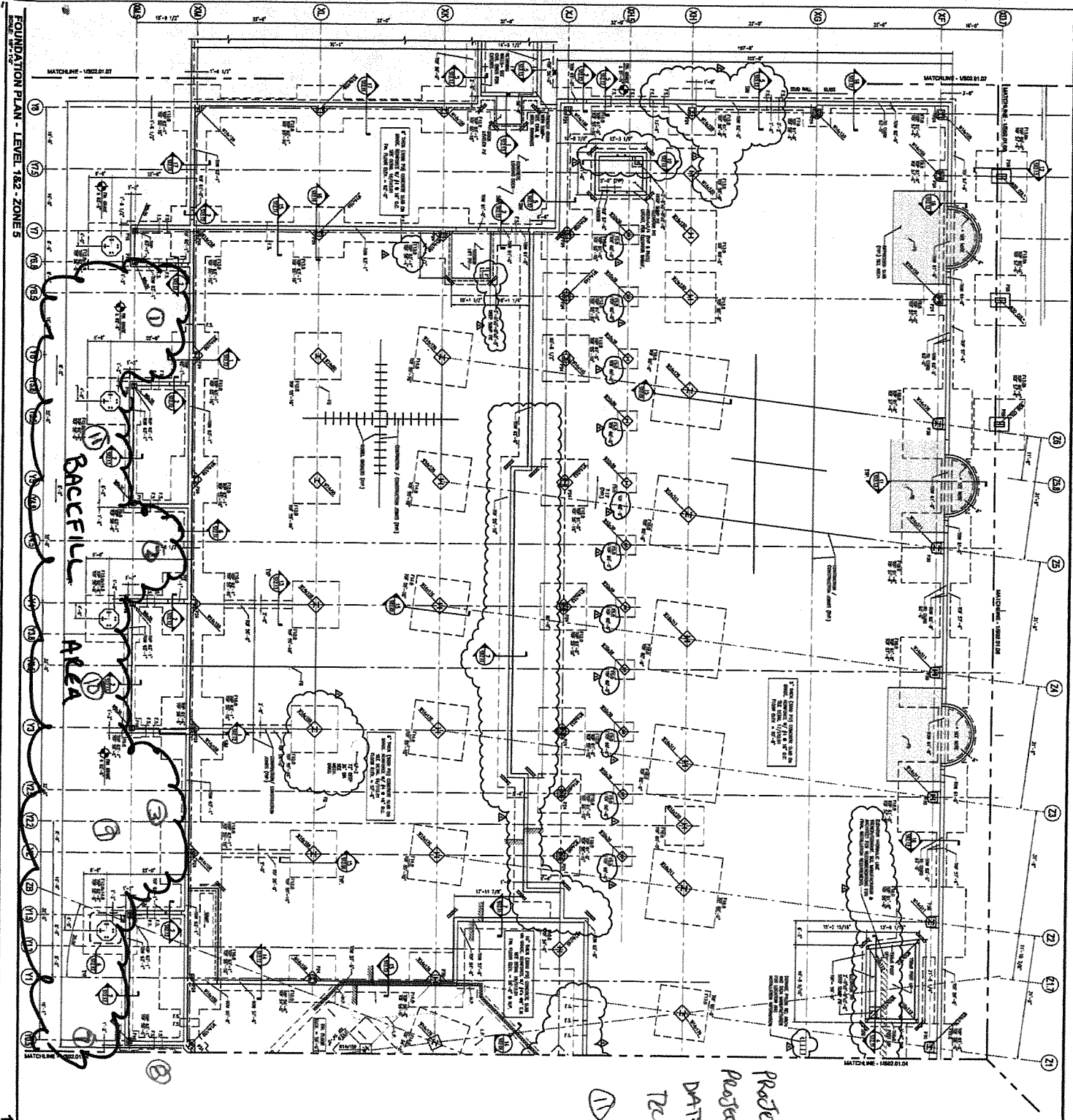

FOUNDATION PLAN - LEVEL 1&2 - ZONES 5

SHEET NOTES

1. ALL FOUNDATION ELEMENTS SHALL BE CONCRETE UNLESS OTHERWISE NOTED.
2. ALL FOUNDATION ELEMENTS SHALL BE CAST IN PLACE.
3. ALL FOUNDATION ELEMENTS SHALL BE CAST ON A 4" MINIMUM THICKNESS OF COMPACTED GRANULAR FILL.
4. ALL FOUNDATION ELEMENTS SHALL BE CAST WITH A MINIMUM 3" CLEARANCE FROM ALL ADJACENT FOUNDATION ELEMENTS.
5. ALL FOUNDATION ELEMENTS SHALL BE CAST WITH A MINIMUM 2" CLEARANCE FROM ALL ADJACENT WALLS.
6. ALL FOUNDATION ELEMENTS SHALL BE CAST WITH A MINIMUM 2" CLEARANCE FROM ALL ADJACENT BEAMS.
7. ALL FOUNDATION ELEMENTS SHALL BE CAST WITH A MINIMUM 2" CLEARANCE FROM ALL ADJACENT SLABS.
8. ALL FOUNDATION ELEMENTS SHALL BE CAST WITH A MINIMUM 2" CLEARANCE FROM ALL ADJACENT PARTITIONS.
9. ALL FOUNDATION ELEMENTS SHALL BE CAST WITH A MINIMUM 2" CLEARANCE FROM ALL ADJACENT MECHANICAL ROOMS.
10. ALL FOUNDATION ELEMENTS SHALL BE CAST WITH A MINIMUM 2" CLEARANCE FROM ALL ADJACENT ELEVATORS.
11. ALL FOUNDATION ELEMENTS SHALL BE CAST WITH A MINIMUM 2" CLEARANCE FROM ALL ADJACENT STAIRS.
12. ALL FOUNDATION ELEMENTS SHALL BE CAST WITH A MINIMUM 2" CLEARANCE FROM ALL ADJACENT ROOFS.
13. ALL FOUNDATION ELEMENTS SHALL BE CAST WITH A MINIMUM 2" CLEARANCE FROM ALL ADJACENT TERRACES.
14. ALL FOUNDATION ELEMENTS SHALL BE CAST WITH A MINIMUM 2" CLEARANCE FROM ALL ADJACENT PATIOS.
15. ALL FOUNDATION ELEMENTS SHALL BE CAST WITH A MINIMUM 2" CLEARANCE FROM ALL ADJACENT PORCHES.
16. ALL FOUNDATION ELEMENTS SHALL BE CAST WITH A MINIMUM 2" CLEARANCE FROM ALL ADJACENT BALCONIES.
17. ALL FOUNDATION ELEMENTS SHALL BE CAST WITH A MINIMUM 2" CLEARANCE FROM ALL ADJACENT DECKS.
18. ALL FOUNDATION ELEMENTS SHALL BE CAST WITH A MINIMUM 2" CLEARANCE FROM ALL ADJACENT PATIOES.
19. ALL FOUNDATION ELEMENTS SHALL BE CAST WITH A MINIMUM 2" CLEARANCE FROM ALL ADJACENT TERRAZZOS.
20. ALL FOUNDATION ELEMENTS SHALL BE CAST WITH A MINIMUM 2" CLEARANCE FROM ALL ADJACENT STAIRS.
21. ALL FOUNDATION ELEMENTS SHALL BE CAST WITH A MINIMUM 2" CLEARANCE FROM ALL ADJACENT ROOFS.
22. ALL FOUNDATION ELEMENTS SHALL BE CAST WITH A MINIMUM 2" CLEARANCE FROM ALL ADJACENT TERRACES.
23. ALL FOUNDATION ELEMENTS SHALL BE CAST WITH A MINIMUM 2" CLEARANCE FROM ALL ADJACENT PATIOS.
24. ALL FOUNDATION ELEMENTS SHALL BE CAST WITH A MINIMUM 2" CLEARANCE FROM ALL ADJACENT PORCHES.
25. ALL FOUNDATION ELEMENTS SHALL BE CAST WITH A MINIMUM 2" CLEARANCE FROM ALL ADJACENT BALCONIES.
26. ALL FOUNDATION ELEMENTS SHALL BE CAST WITH A MINIMUM 2" CLEARANCE FROM ALL ADJACENT DECKS.
27. ALL FOUNDATION ELEMENTS SHALL BE CAST WITH A MINIMUM 2" CLEARANCE FROM ALL ADJACENT PATIOES.
28. ALL FOUNDATION ELEMENTS SHALL BE CAST WITH A MINIMUM 2" CLEARANCE FROM ALL ADJACENT TERRAZZOS.

GENERAL NOTES

1. ALL FOUNDATION ELEMENTS SHALL BE CONCRETE UNLESS OTHERWISE NOTED.
2. ALL FOUNDATION ELEMENTS SHALL BE CAST IN PLACE.
3. ALL FOUNDATION ELEMENTS SHALL BE CAST ON A 4" MINIMUM THICKNESS OF COMPACTED GRANULAR FILL.
4. ALL FOUNDATION ELEMENTS SHALL BE CAST WITH A MINIMUM 3" CLEARANCE FROM ALL ADJACENT FOUNDATION ELEMENTS.
5. ALL FOUNDATION ELEMENTS SHALL BE CAST WITH A MINIMUM 2" CLEARANCE FROM ALL ADJACENT WALLS.
6. ALL FOUNDATION ELEMENTS SHALL BE CAST WITH A MINIMUM 2" CLEARANCE FROM ALL ADJACENT BEAMS.
7. ALL FOUNDATION ELEMENTS SHALL BE CAST WITH A MINIMUM 2" CLEARANCE FROM ALL ADJACENT SLABS.
8. ALL FOUNDATION ELEMENTS SHALL BE CAST WITH A MINIMUM 2" CLEARANCE FROM ALL ADJACENT PARTITIONS.
9. ALL FOUNDATION ELEMENTS SHALL BE CAST WITH A MINIMUM 2" CLEARANCE FROM ALL ADJACENT MECHANICAL ROOMS.
10. ALL FOUNDATION ELEMENTS SHALL BE CAST WITH A MINIMUM 2" CLEARANCE FROM ALL ADJACENT ELEVATORS.
11. ALL FOUNDATION ELEMENTS SHALL BE CAST WITH A MINIMUM 2" CLEARANCE FROM ALL ADJACENT STAIRS.
12. ALL FOUNDATION ELEMENTS SHALL BE CAST WITH A MINIMUM 2" CLEARANCE FROM ALL ADJACENT ROOFS.
13. ALL FOUNDATION ELEMENTS SHALL BE CAST WITH A MINIMUM 2" CLEARANCE FROM ALL ADJACENT TERRACES.
14. ALL FOUNDATION ELEMENTS SHALL BE CAST WITH A MINIMUM 2" CLEARANCE FROM ALL ADJACENT PATIOS.
15. ALL FOUNDATION ELEMENTS SHALL BE CAST WITH A MINIMUM 2" CLEARANCE FROM ALL ADJACENT PORCHES.
16. ALL FOUNDATION ELEMENTS SHALL BE CAST WITH A MINIMUM 2" CLEARANCE FROM ALL ADJACENT BALCONIES.
17. ALL FOUNDATION ELEMENTS SHALL BE CAST WITH A MINIMUM 2" CLEARANCE FROM ALL ADJACENT DECKS.
18. ALL FOUNDATION ELEMENTS SHALL BE CAST WITH A MINIMUM 2" CLEARANCE FROM ALL ADJACENT PATIOES.
19. ALL FOUNDATION ELEMENTS SHALL BE CAST WITH A MINIMUM 2" CLEARANCE FROM ALL ADJACENT TERRAZZOS.

KEY PLAN

1 2 3 4

PROJECT: Portland Jarport
DATE: 5/9/11
TECH: MSR

100 LOCATION

Portland International Jarport
 1001 Westbrook Street
 Portland, Maine 04102

Gensler
 2000 Bank of America Building
 1000 Broadway
 New York, NY 10018

WEST ASSOCIATES, INC.
 1000 Broadway
 New York, NY 10018

S02.01.05

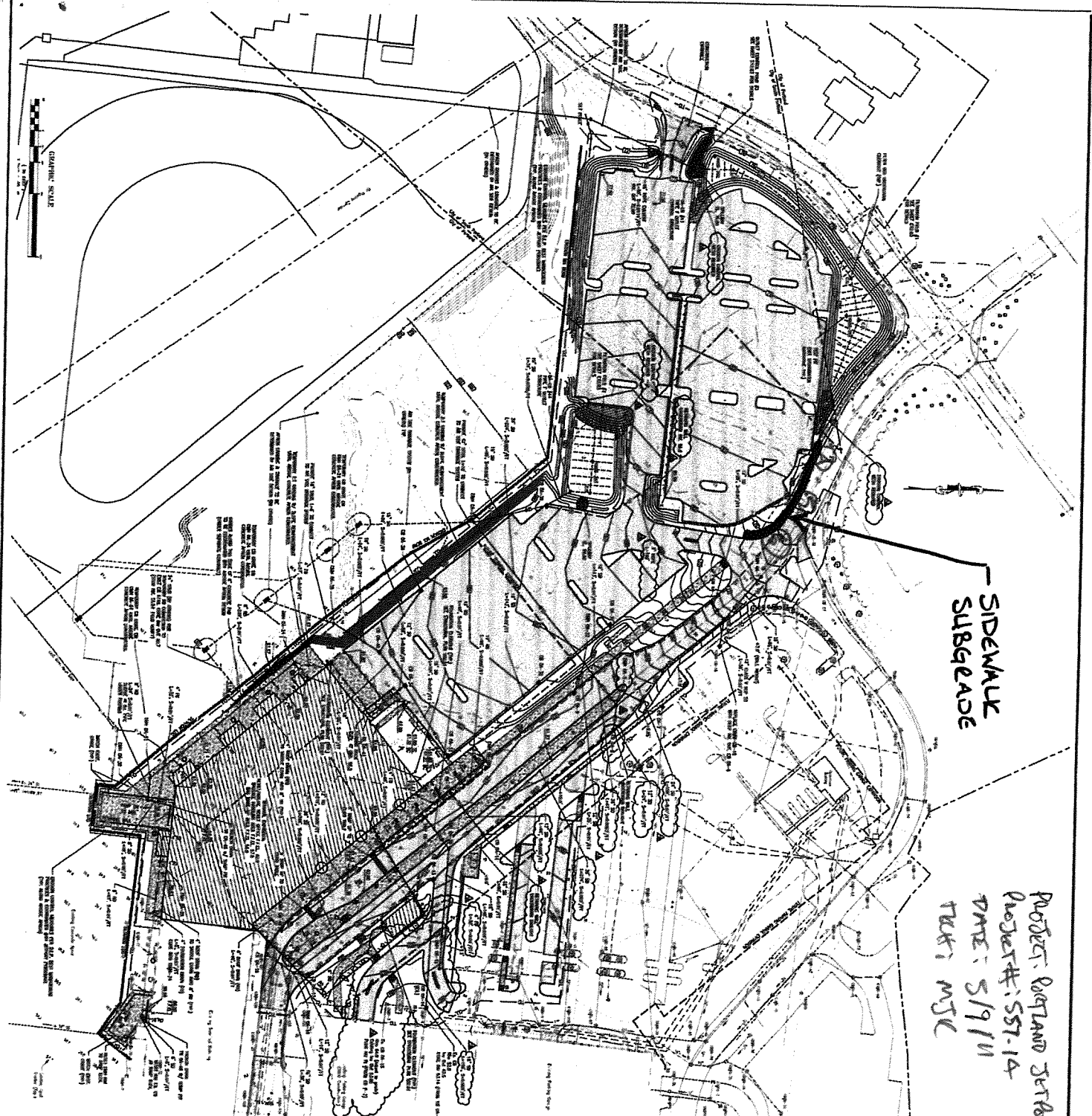

PROJECT: PORTLAND SEAFAR
 PROJECT #: SST-14
 DATE: 5/19/11
 TALK: MJC
 (1) NO LOCATION

SHEET NOTES

NO.	DESCRIPTION	DATE	BY	CHKD.
1
2
3
4
5
6
7
8
9
10
11
12
13
14
15
16
17
18
19
20
21
22
23
24
25
26
27
28
29
30
31
32
33
34
35
36
37
38
39
40
41
42
43
44
45
46
47
48
49
50

GENERAL NOTES

1. ALL WORK SHALL BE IN ACCORDANCE WITH THE LATEST EDITIONS OF THE STANDARD SPECIFICATIONS FOR HIGHWAY CONSTRUCTION, SEVENTH EDITION, 2003, WITH THE 2005 SUPPLEMENT, AND THE 2008 SUPPLEMENT, PUBLISHED BY THE PORTLAND DISTRICT OFFICE OF THE OREGON DEPARTMENT OF TRANSPORTATION.
2. THE CONTRACTOR SHALL BE RESPONSIBLE FOR OBTAINING ALL NECESSARY PERMITS AND APPROVALS FROM THE PORTLAND DISTRICT OFFICE OF THE OREGON DEPARTMENT OF TRANSPORTATION AND ANY OTHER AGENCIES THAT MAY BE INVOLVED.
3. THE CONTRACTOR SHALL MAINTAIN ACCESS TO ALL ADJACENT PROPERTIES AND UTILITIES AT ALL TIMES.
4. THE CONTRACTOR SHALL BE RESPONSIBLE FOR PROTECTING ALL EXISTING UTILITIES AND STRUCTURES.
5. THE CONTRACTOR SHALL MAINTAIN ADEQUATE DRAINAGE AND EROSION CONTROL MEASURES THROUGHOUT THE PROJECT.
6. THE CONTRACTOR SHALL BE RESPONSIBLE FOR OBTAINING ALL NECESSARY PERMITS AND APPROVALS FROM THE PORTLAND DISTRICT OFFICE OF THE OREGON DEPARTMENT OF TRANSPORTATION AND ANY OTHER AGENCIES THAT MAY BE INVOLVED.
7. THE CONTRACTOR SHALL MAINTAIN ACCESS TO ALL ADJACENT PROPERTIES AND UTILITIES AT ALL TIMES.
8. THE CONTRACTOR SHALL BE RESPONSIBLE FOR PROTECTING ALL EXISTING UTILITIES AND STRUCTURES.
9. THE CONTRACTOR SHALL MAINTAIN ADEQUATE DRAINAGE AND EROSION CONTROL MEASURES THROUGHOUT THE PROJECT.
10. THE CONTRACTOR SHALL BE RESPONSIBLE FOR OBTAINING ALL NECESSARY PERMITS AND APPROVALS FROM THE PORTLAND DISTRICT OFFICE OF THE OREGON DEPARTMENT OF TRANSPORTATION AND ANY OTHER AGENCIES THAT MAY BE INVOLVED.
11. THE CONTRACTOR SHALL MAINTAIN ACCESS TO ALL ADJACENT PROPERTIES AND UTILITIES AT ALL TIMES.
12. THE CONTRACTOR SHALL BE RESPONSIBLE FOR PROTECTING ALL EXISTING UTILITIES AND STRUCTURES.
13. THE CONTRACTOR SHALL MAINTAIN ADEQUATE DRAINAGE AND EROSION CONTROL MEASURES THROUGHOUT THE PROJECT.
14. THE CONTRACTOR SHALL BE RESPONSIBLE FOR OBTAINING ALL NECESSARY PERMITS AND APPROVALS FROM THE PORTLAND DISTRICT OFFICE OF THE OREGON DEPARTMENT OF TRANSPORTATION AND ANY OTHER AGENCIES THAT MAY BE INVOLVED.
15. THE CONTRACTOR SHALL MAINTAIN ACCESS TO ALL ADJACENT PROPERTIES AND UTILITIES AT ALL TIMES.
16. THE CONTRACTOR SHALL BE RESPONSIBLE FOR PROTECTING ALL EXISTING UTILITIES AND STRUCTURES.
17. THE CONTRACTOR SHALL MAINTAIN ADEQUATE DRAINAGE AND EROSION CONTROL MEASURES THROUGHOUT THE PROJECT.
18. THE CONTRACTOR SHALL BE RESPONSIBLE FOR OBTAINING ALL NECESSARY PERMITS AND APPROVALS FROM THE PORTLAND DISTRICT OFFICE OF THE OREGON DEPARTMENT OF TRANSPORTATION AND ANY OTHER AGENCIES THAT MAY BE INVOLVED.
19. THE CONTRACTOR SHALL MAINTAIN ACCESS TO ALL ADJACENT PROPERTIES AND UTILITIES AT ALL TIMES.
20. THE CONTRACTOR SHALL BE RESPONSIBLE FOR PROTECTING ALL EXISTING UTILITIES AND STRUCTURES.
21. THE CONTRACTOR SHALL MAINTAIN ADEQUATE DRAINAGE AND EROSION CONTROL MEASURES THROUGHOUT THE PROJECT.
22. THE CONTRACTOR SHALL BE RESPONSIBLE FOR OBTAINING ALL NECESSARY PERMITS AND APPROVALS FROM THE PORTLAND DISTRICT OFFICE OF THE OREGON DEPARTMENT OF TRANSPORTATION AND ANY OTHER AGENCIES THAT MAY BE INVOLVED.
23. THE CONTRACTOR SHALL MAINTAIN ACCESS TO ALL ADJACENT PROPERTIES AND UTILITIES AT ALL TIMES.
24. THE CONTRACTOR SHALL BE RESPONSIBLE FOR PROTECTING ALL EXISTING UTILITIES AND STRUCTURES.
25. THE CONTRACTOR SHALL MAINTAIN ADEQUATE DRAINAGE AND EROSION CONTROL MEASURES THROUGHOUT THE PROJECT.
26. THE CONTRACTOR SHALL BE RESPONSIBLE FOR OBTAINING ALL NECESSARY PERMITS AND APPROVALS FROM THE PORTLAND DISTRICT OFFICE OF THE OREGON DEPARTMENT OF TRANSPORTATION AND ANY OTHER AGENCIES THAT MAY BE INVOLVED.
27. THE CONTRACTOR SHALL MAINTAIN ACCESS TO ALL ADJACENT PROPERTIES AND UTILITIES AT ALL TIMES.
28. THE CONTRACTOR SHALL BE RESPONSIBLE FOR PROTECTING ALL EXISTING UTILITIES AND STRUCTURES.
29. THE CONTRACTOR SHALL MAINTAIN ADEQUATE DRAINAGE AND EROSION CONTROL MEASURES THROUGHOUT THE PROJECT.
30. THE CONTRACTOR SHALL BE RESPONSIBLE FOR OBTAINING ALL NECESSARY PERMITS AND APPROVALS FROM THE PORTLAND DISTRICT OFFICE OF THE OREGON DEPARTMENT OF TRANSPORTATION AND ANY OTHER AGENCIES THAT MAY BE INVOLVED.
31. THE CONTRACTOR SHALL MAINTAIN ACCESS TO ALL ADJACENT PROPERTIES AND UTILITIES AT ALL TIMES.
32. THE CONTRACTOR SHALL BE RESPONSIBLE FOR PROTECTING ALL EXISTING UTILITIES AND STRUCTURES.
33. THE CONTRACTOR SHALL MAINTAIN ADEQUATE DRAINAGE AND EROSION CONTROL MEASURES THROUGHOUT THE PROJECT.
34. THE CONTRACTOR SHALL BE RESPONSIBLE FOR OBTAINING ALL NECESSARY PERMITS AND APPROVALS FROM THE PORTLAND DISTRICT OFFICE OF THE OREGON DEPARTMENT OF TRANSPORTATION AND ANY OTHER AGENCIES THAT MAY BE INVOLVED.
35. THE CONTRACTOR SHALL MAINTAIN ACCESS TO ALL ADJACENT PROPERTIES AND UTILITIES AT ALL TIMES.
36. THE CONTRACTOR SHALL BE RESPONSIBLE FOR PROTECTING ALL EXISTING UTILITIES AND STRUCTURES.
37. THE CONTRACTOR SHALL MAINTAIN ADEQUATE DRAINAGE AND EROSION CONTROL MEASURES THROUGHOUT THE PROJECT.
38. THE CONTRACTOR SHALL BE RESPONSIBLE FOR OBTAINING ALL NECESSARY PERMITS AND APPROVALS FROM THE PORTLAND DISTRICT OFFICE OF THE OREGON DEPARTMENT OF TRANSPORTATION AND ANY OTHER AGENCIES THAT MAY BE INVOLVED.
39. THE CONTRACTOR SHALL MAINTAIN ACCESS TO ALL ADJACENT PROPERTIES AND UTILITIES AT ALL TIMES.
40. THE CONTRACTOR SHALL BE RESPONSIBLE FOR PROTECTING ALL EXISTING UTILITIES AND STRUCTURES.
41. THE CONTRACTOR SHALL MAINTAIN ADEQUATE DRAINAGE AND EROSION CONTROL MEASURES THROUGHOUT THE PROJECT.
42. THE CONTRACTOR SHALL BE RESPONSIBLE FOR OBTAINING ALL NECESSARY PERMITS AND APPROVALS FROM THE PORTLAND DISTRICT OFFICE OF THE OREGON DEPARTMENT OF TRANSPORTATION AND ANY OTHER AGENCIES THAT MAY BE INVOLVED.
43. THE CONTRACTOR SHALL MAINTAIN ACCESS TO ALL ADJACENT PROPERTIES AND UTILITIES AT ALL TIMES.
44. THE CONTRACTOR SHALL BE RESPONSIBLE FOR PROTECTING ALL EXISTING UTILITIES AND STRUCTURES.
45. THE CONTRACTOR SHALL MAINTAIN ADEQUATE DRAINAGE AND EROSION CONTROL MEASURES THROUGHOUT THE PROJECT.
46. THE CONTRACTOR SHALL BE RESPONSIBLE FOR OBTAINING ALL NECESSARY PERMITS AND APPROVALS FROM THE PORTLAND DISTRICT OFFICE OF THE OREGON DEPARTMENT OF TRANSPORTATION AND ANY OTHER AGENCIES THAT MAY BE INVOLVED.
47. THE CONTRACTOR SHALL MAINTAIN ACCESS TO ALL ADJACENT PROPERTIES AND UTILITIES AT ALL TIMES.
48. THE CONTRACTOR SHALL BE RESPONSIBLE FOR PROTECTING ALL EXISTING UTILITIES AND STRUCTURES.
49. THE CONTRACTOR SHALL MAINTAIN ADEQUATE DRAINAGE AND EROSION CONTROL MEASURES THROUGHOUT THE PROJECT.
50. THE CONTRACTOR SHALL BE RESPONSIBLE FOR OBTAINING ALL NECESSARY PERMITS AND APPROVALS FROM THE PORTLAND DISTRICT OFFICE OF THE OREGON DEPARTMENT OF TRANSPORTATION AND ANY OTHER AGENCIES THAT MAY BE INVOLVED.

Portland International
 Jetport
 1001 Westbank Street
 Portland, Maine 04112

Gensler
 ARCHITECTS
 1001 Westbank Street
 Portland, Maine 04112



C02.02

SUMMARY OF IN-PLACE DENSITIES - ASTM D6938
 TERMINAL ENHANCEMENT AT THE PORTLAND INTERNATIONAL JETPORT
 PORTLAND, MAINE
 RWG&A PROJECT NO. 557-14

Client: City of Portland
 Test Date: 5/11/2011
 Technician: MJK
 Gauge Model/Serial Number: L 500

Lab No.	Soil Description	ASTM D1557 Max Density	ASTM D1557 Opt. Moisture
11784	Type D Gravel	133.6	6.4

Report Issue Date:

Test No.	Location	Elevation	ASTM D6938 Dry Density (pcf)	ASTM D6938 Water Content (%)	Percent of Max. (%)	Lab. No.
1	XM+10'/Y4.5	FG	126.3	5	95	11784
2	IDEWALK - TOP OF ENTRY ROAD, WEST SID	FG	129.2	3	97	11784
3	IDEWALK - TOP OF ENTRY ROAD, WEST SID	FG	128.6	3	96	11784
4	XM.5+10'/Y1	FG-1'	126.8	6	95	11784
5	XM.5+10'/Y2.5	FG-1'	131.5	3	99	11784
6	XM.5+10'/Y3.5	FG-1'	128.6	4	96	11784
7	XM.5+10'/Y4.5	FG-1'	130.7	4	98	11784
8	XM.5+10'/Y1	FG	128.0	4	96	11784
9	XM.5+10'/Y2.5	FG	132.0	4	99	11784
10	XM.5+10'/Y3.5	FG	130.2	4	98	11784
11	XM.5+10'/Y4.5	FG	128.9	6	97	11784

Remarks:

FG = Finish Grade
 FF = Finish Floor
 FGB = Finish Grade of Base
 FGSB = Finish Grade of Subbase
 FGSG = Finish Grade of Subgrade

TOW = Top of Foundation Wall
 BOW = Bottom of Wall
 BOF = Bottom of Footing
 SG = Subgrade

Checked by:



Portland International
Jetport
1001 Westbrook Street
Portland, Maine 04112

Gensler

MEIST ASSOCIATES, INC.
1000 BROADWAY, PORTLAND, MAINE 04102
TEL: 603-876-1100

PROJECT: PORTLAND JETPORT
PROJECT#: 557-14
DATE: 8/11/74
TECH: MJK

- SHEET NOTES**
1. ALL FOUNDATION WORK SHALL BE IN ACCORDANCE WITH THE PORTLAND BUILDING CODE, AS AMENDED.
 2. ALL FOUNDATION WORK SHALL BE IN ACCORDANCE WITH THE PORTLAND ZONING ORDINANCE, AS AMENDED.
 3. ALL FOUNDATION WORK SHALL BE IN ACCORDANCE WITH THE PORTLAND HEALTH DEPARTMENT REGULATIONS, AS AMENDED.
 4. ALL FOUNDATION WORK SHALL BE IN ACCORDANCE WITH THE PORTLAND FIRE DEPARTMENT REGULATIONS, AS AMENDED.
 5. ALL FOUNDATION WORK SHALL BE IN ACCORDANCE WITH THE PORTLAND WATER DEPARTMENT REGULATIONS, AS AMENDED.
 6. ALL FOUNDATION WORK SHALL BE IN ACCORDANCE WITH THE PORTLAND PUBLIC WORKS DEPARTMENT REGULATIONS, AS AMENDED.
 7. ALL FOUNDATION WORK SHALL BE IN ACCORDANCE WITH THE PORTLAND POLICE DEPARTMENT REGULATIONS, AS AMENDED.
 8. ALL FOUNDATION WORK SHALL BE IN ACCORDANCE WITH THE PORTLAND SHERIFF DEPARTMENT REGULATIONS, AS AMENDED.
 9. ALL FOUNDATION WORK SHALL BE IN ACCORDANCE WITH THE PORTLAND JUDICIAL DEPARTMENT REGULATIONS, AS AMENDED.
 10. ALL FOUNDATION WORK SHALL BE IN ACCORDANCE WITH THE PORTLAND LEGISLATIVE DEPARTMENT REGULATIONS, AS AMENDED.

- GENERAL NOTES**
1. ALL FOUNDATION WORK SHALL BE IN ACCORDANCE WITH THE PORTLAND BUILDING CODE, AS AMENDED.
 2. ALL FOUNDATION WORK SHALL BE IN ACCORDANCE WITH THE PORTLAND ZONING ORDINANCE, AS AMENDED.
 3. ALL FOUNDATION WORK SHALL BE IN ACCORDANCE WITH THE PORTLAND HEALTH DEPARTMENT REGULATIONS, AS AMENDED.
 4. ALL FOUNDATION WORK SHALL BE IN ACCORDANCE WITH THE PORTLAND FIRE DEPARTMENT REGULATIONS, AS AMENDED.
 5. ALL FOUNDATION WORK SHALL BE IN ACCORDANCE WITH THE PORTLAND WATER DEPARTMENT REGULATIONS, AS AMENDED.
 6. ALL FOUNDATION WORK SHALL BE IN ACCORDANCE WITH THE PORTLAND PUBLIC WORKS DEPARTMENT REGULATIONS, AS AMENDED.
 7. ALL FOUNDATION WORK SHALL BE IN ACCORDANCE WITH THE PORTLAND POLICE DEPARTMENT REGULATIONS, AS AMENDED.
 8. ALL FOUNDATION WORK SHALL BE IN ACCORDANCE WITH THE PORTLAND SHERIFF DEPARTMENT REGULATIONS, AS AMENDED.
 9. ALL FOUNDATION WORK SHALL BE IN ACCORDANCE WITH THE PORTLAND JUDICIAL DEPARTMENT REGULATIONS, AS AMENDED.
 10. ALL FOUNDATION WORK SHALL BE IN ACCORDANCE WITH THE PORTLAND LEGISLATIVE DEPARTMENT REGULATIONS, AS AMENDED.

KEY PLAN

Scale: 1/8" = 1'-0"

S02.01.05

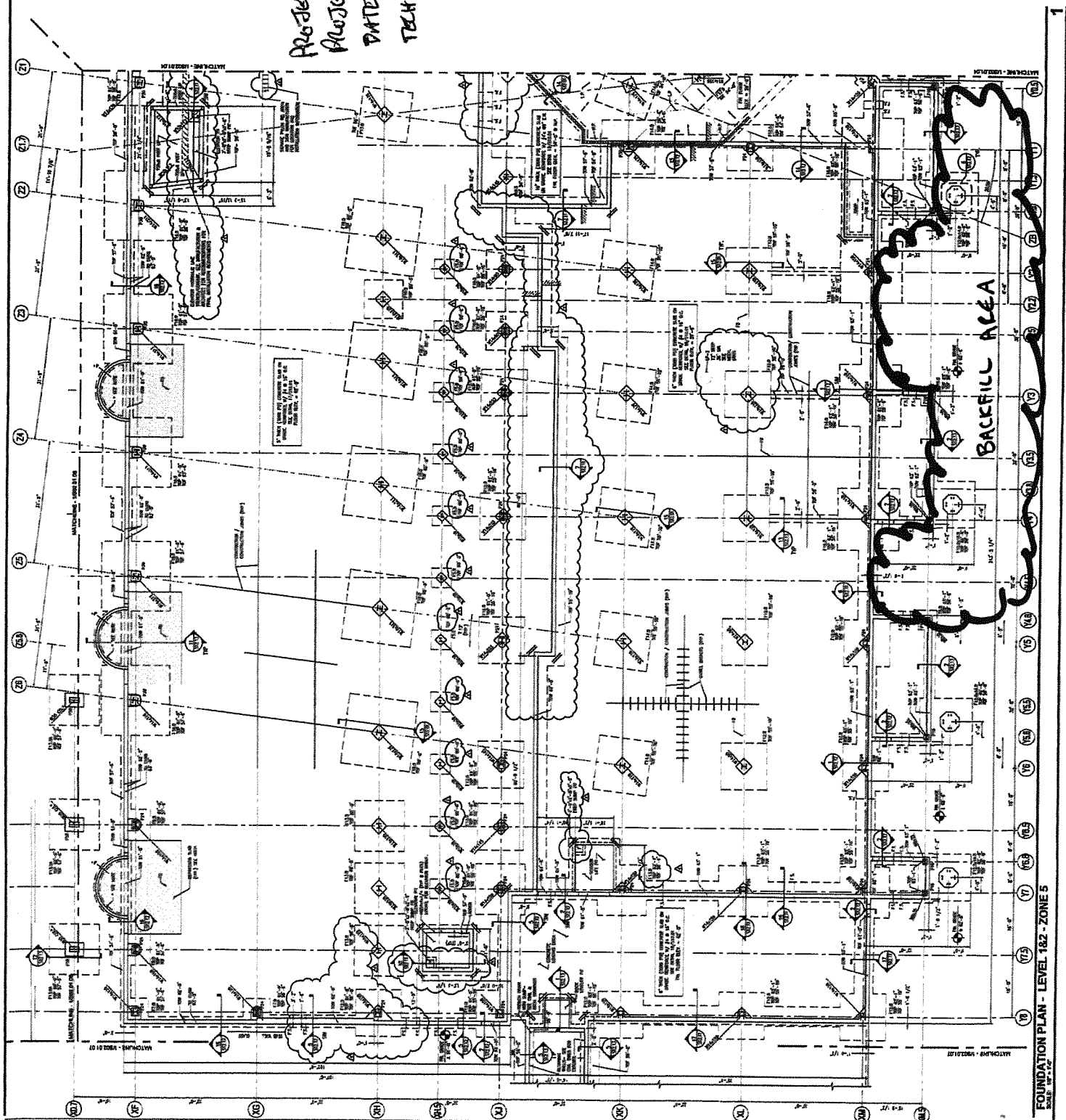

FOUNDATION PLAN - LEVEL 182 - ZONE 5
SCALE: 1/8" = 1'-0"

SHEET NOTES

PROJECT: PORTLAND JETPORT
PROJECT #: 557-14
DATE: 5/11/11
TEAM: MJEK

**SIDEWALK
SUBGRADE**

NO.	DESCRIPTION	DATE	BY	CHECKED
1	REVISION			
2	REVISION			
3	REVISION			
4	REVISION			
5	REVISION			
6	REVISION			
7	REVISION			
8	REVISION			
9	REVISION			
10	REVISION			
11	REVISION			
12	REVISION			
13	REVISION			
14	REVISION			
15	REVISION			
16	REVISION			
17	REVISION			
18	REVISION			
19	REVISION			
20	REVISION			
21	REVISION			
22	REVISION			
23	REVISION			
24	REVISION			
25	REVISION			
26	REVISION			
27	REVISION			
28	REVISION			
29	REVISION			
30	REVISION			
31	REVISION			
32	REVISION			
33	REVISION			
34	REVISION			
35	REVISION			
36	REVISION			
37	REVISION			
38	REVISION			
39	REVISION			
40	REVISION			
41	REVISION			
42	REVISION			
43	REVISION			
44	REVISION			
45	REVISION			
46	REVISION			
47	REVISION			
48	REVISION			
49	REVISION			
50	REVISION			

GENERAL NOTES

1. ALL WORK SHALL BE IN ACCORDANCE WITH THE PORTLAND JETPORT MASTER PLAN AND ALL APPLICABLE REGULATIONS.
2. THE CONTRACTOR SHALL BE RESPONSIBLE FOR OBTAINING ALL NECESSARY PERMITS AND APPROVALS FROM THE APPROPRIATE AGENCIES.
3. THE CONTRACTOR SHALL MAINTAIN ACCESS TO ALL ADJACENT PROPERTIES AND UTILITIES AT ALL TIMES.
4. ALL MATERIALS AND METHODS OF CONSTRUCTION SHALL BE APPROVED BY THE ENGINEER PRIOR TO INSTALLATION.
5. THE CONTRACTOR SHALL MAINTAIN RECORD DRAWINGS OF ALL CHANGES MADE TO THE ORIGINAL DESIGN.
6. ALL WORK SHALL BE COMPLETED WITHIN THE SPECIFIED TIME FRAME.
7. THE CONTRACTOR SHALL BE RESPONSIBLE FOR THE PROTECTION OF ALL EXISTING UTILITIES AND STRUCTURES.
8. ALL WORK SHALL BE COMPLETED IN ACCORDANCE WITH THE PORTLAND JETPORT MASTER PLAN AND ALL APPLICABLE REGULATIONS.
9. THE CONTRACTOR SHALL MAINTAIN ACCESS TO ALL ADJACENT PROPERTIES AND UTILITIES AT ALL TIMES.
10. ALL MATERIALS AND METHODS OF CONSTRUCTION SHALL BE APPROVED BY THE ENGINEER PRIOR TO INSTALLATION.
11. THE CONTRACTOR SHALL MAINTAIN RECORD DRAWINGS OF ALL CHANGES MADE TO THE ORIGINAL DESIGN.
12. ALL WORK SHALL BE COMPLETED WITHIN THE SPECIFIED TIME FRAME.
13. THE CONTRACTOR SHALL BE RESPONSIBLE FOR THE PROTECTION OF ALL EXISTING UTILITIES AND STRUCTURES.
14. ALL WORK SHALL BE COMPLETED IN ACCORDANCE WITH THE PORTLAND JETPORT MASTER PLAN AND ALL APPLICABLE REGULATIONS.
15. THE CONTRACTOR SHALL MAINTAIN ACCESS TO ALL ADJACENT PROPERTIES AND UTILITIES AT ALL TIMES.
16. ALL MATERIALS AND METHODS OF CONSTRUCTION SHALL BE APPROVED BY THE ENGINEER PRIOR TO INSTALLATION.
17. THE CONTRACTOR SHALL MAINTAIN RECORD DRAWINGS OF ALL CHANGES MADE TO THE ORIGINAL DESIGN.
18. ALL WORK SHALL BE COMPLETED WITHIN THE SPECIFIED TIME FRAME.
19. THE CONTRACTOR SHALL BE RESPONSIBLE FOR THE PROTECTION OF ALL EXISTING UTILITIES AND STRUCTURES.
20. ALL WORK SHALL BE COMPLETED IN ACCORDANCE WITH THE PORTLAND JETPORT MASTER PLAN AND ALL APPLICABLE REGULATIONS.

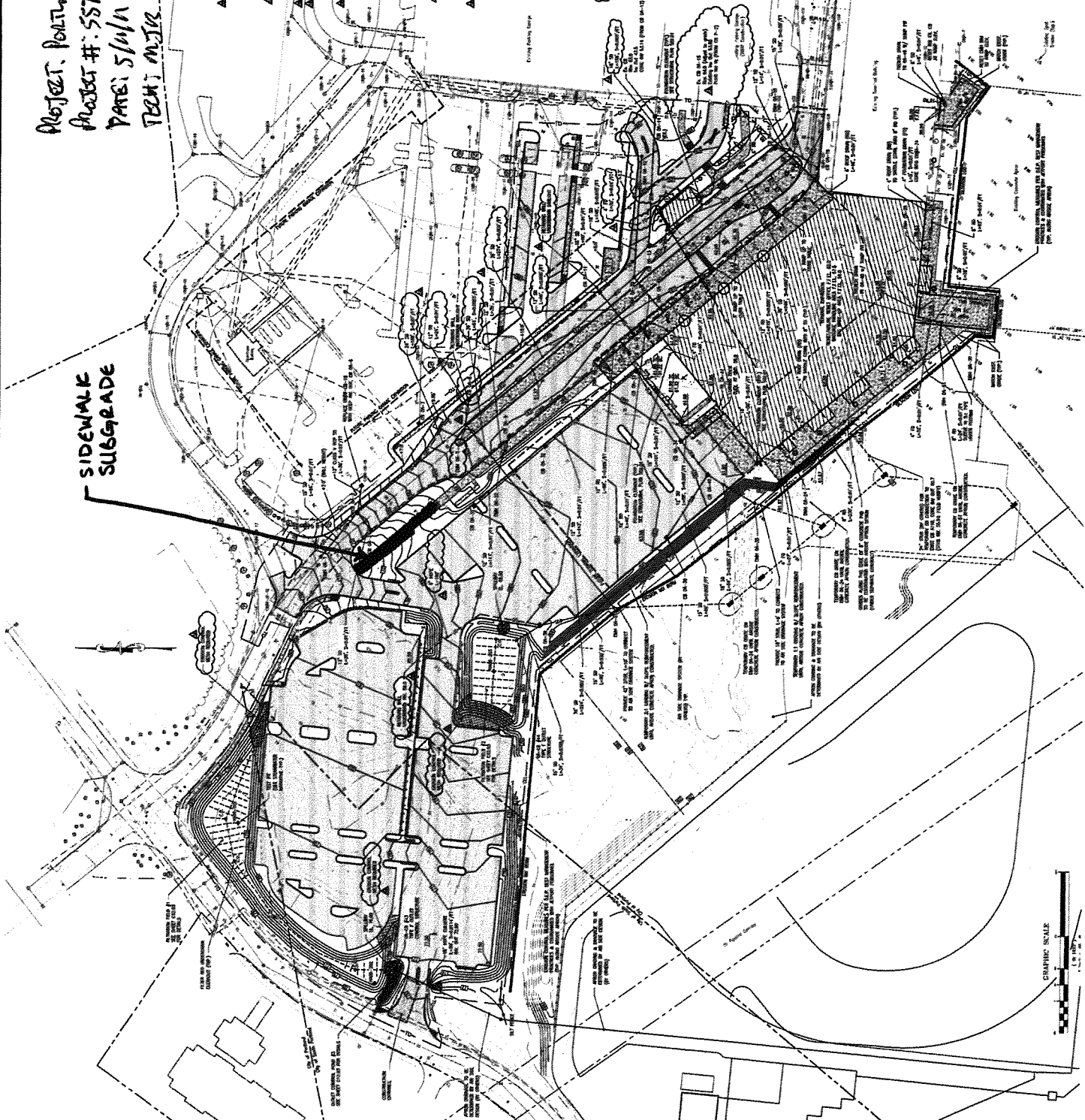



SHEET NOTES

1. SEE EXISTING DRAWINGS FOR DETAILS OF THE WORK.

NO.	DATE	REVISIONS	BY	CHKD.
1	02/02/02	ISSUED FOR PERMIT
2	02/02/02
3	02/02/02
4	02/02/02
5	02/02/02
6	02/02/02
7	02/02/02
8	02/02/02
9	02/02/02
10	02/02/02
11	02/02/02
12	02/02/02
13	02/02/02
14	02/02/02
15	02/02/02
16	02/02/02
17	02/02/02
18	02/02/02
19	02/02/02
20	02/02/02
21	02/02/02
22	02/02/02
23	02/02/02
24	02/02/02
25	02/02/02
26	02/02/02
27	02/02/02
28	02/02/02
29	02/02/02
30	02/02/02
31	02/02/02
32	02/02/02
33	02/02/02
34	02/02/02
35	02/02/02

1. SEE EXISTING DRAWINGS FOR DETAILS OF THE WORK.

GENERAL NOTES

1. ALL WORK SHALL BE IN ACCORDANCE WITH THE LATEST EDITIONS OF THE SPECIFICATIONS FOR CONSTRUCTION DOCUMENTS FOR AIRPORTS, 1995 EDITION, AND THE SPECIFICATIONS FOR CONSTRUCTION DOCUMENTS FOR AIRPORTS, 1995 EDITION, AS AMENDED.
2. THE CONTRACTOR SHALL BE RESPONSIBLE FOR OBTAINING ALL NECESSARY PERMITS AND APPROVALS FROM THE APPROPRIATE AGENCIES.
3. THE CONTRACTOR SHALL MAINTAIN ACCESS TO ALL ADJACENT PROPERTIES AND UTILITIES AT ALL TIMES.
4. THE CONTRACTOR SHALL BE RESPONSIBLE FOR PROTECTING ALL EXISTING UTILITIES AND STRUCTURES TO REMAIN.
5. THE CONTRACTOR SHALL MAINTAIN THE EXISTING GRADE AND ELEVATIONS UNLESS OTHERWISE SHOWN.
6. THE CONTRACTOR SHALL BE RESPONSIBLE FOR THE PROTECTION AND MAINTENANCE OF ALL EXISTING UTILITIES AND STRUCTURES TO REMAIN.
7. THE CONTRACTOR SHALL MAINTAIN ACCESS TO ALL ADJACENT PROPERTIES AND UTILITIES AT ALL TIMES.
8. THE CONTRACTOR SHALL BE RESPONSIBLE FOR OBTAINING ALL NECESSARY PERMITS AND APPROVALS FROM THE APPROPRIATE AGENCIES.
9. THE CONTRACTOR SHALL MAINTAIN ACCESS TO ALL ADJACENT PROPERTIES AND UTILITIES AT ALL TIMES.
10. THE CONTRACTOR SHALL BE RESPONSIBLE FOR PROTECTING ALL EXISTING UTILITIES AND STRUCTURES TO REMAIN.
11. THE CONTRACTOR SHALL MAINTAIN THE EXISTING GRADE AND ELEVATIONS UNLESS OTHERWISE SHOWN.
12. THE CONTRACTOR SHALL BE RESPONSIBLE FOR THE PROTECTION AND MAINTENANCE OF ALL EXISTING UTILITIES AND STRUCTURES TO REMAIN.

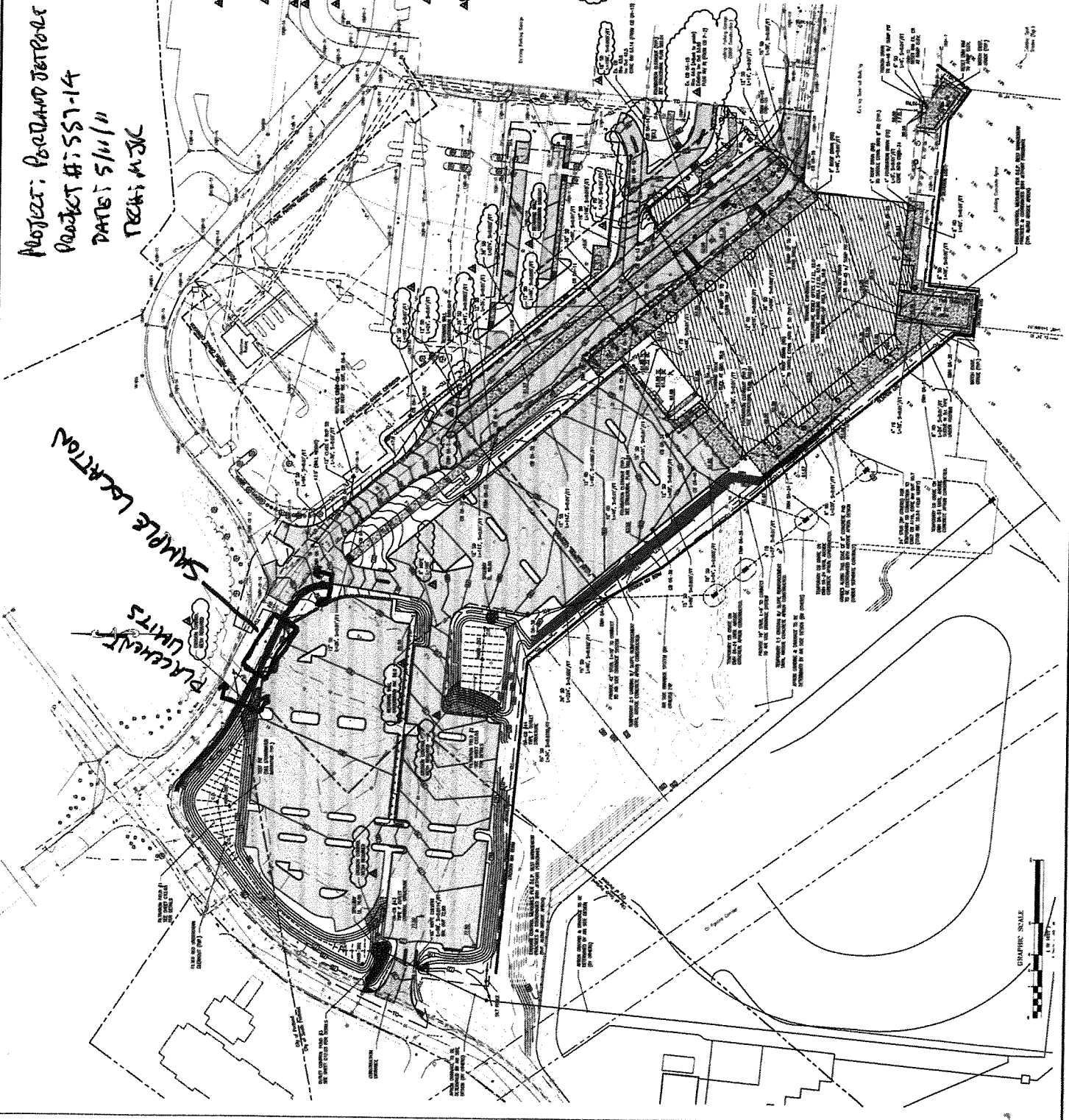

PROJECT: PORTLAND JETPORT
PROJECT #: 557-14
DATE: 5/11/11
TECH: MJC

SAMPLE LOCATION
PLACEMENT UNITS



SUMMARY OF IN-PLACE DENSITIES - ASTM D6938
 TERMINAL ENHANCEMENT AT THE PORTLAND INTERNATIONAL JETPORT
 PORTLAND, MAINE
 RWG&A PROJECT NO. 557-14

Client: City of Portland
 Test Date: 5/12/2011
 Technician: MJK
 Gauge Model/Serial Number: L 500

Lab No.	Soil Description	ASTM D1557 Max Density	ASTM D1557 Opt. Moisture
11784	Type D Gravel	133.6	6.4

Report Issue Date:

Test No.	Location	Elevation	ASTM D6938 Dry Density (pcf)	ASTM D6938 Water Content (%)	Percent of Max. (%)	Lab. No.
1	XM.5+10/Y1	FG-1'	127.8	4	96	11784
2	XM.5+10/Y2.5	FG-1'	131.2	5	98	11784
3	XM.5+10/Y3.5	FG-1'	127.2	4	95	11784
4	XM.5+10/Y4.5	FG-1'	135.6	4	100	11784
5	XM.5+10/Y1	FG	130.6	4	98	11784
6	XM.5+10/Y2.5	FG	131.2	4	98	11784
7	XM.5+10/Y3.5	FG	129.2	4	97	11784
8	XM.5+10/Y4.5	FG	128.0	4	96	11784

Remarks:

- FG = Finish Grade
- FF = Finish Floor
- FGB = Finish Grade of Base
- FGSB = Finish Grade of Subbase
- FGSG = Finish Grade of Subgrade

- TOW = Top of Foundation Wall
- BOW = Bottom of Wall
- BOF = Bottom of Footing
- SG = Subgrade

Checked by:

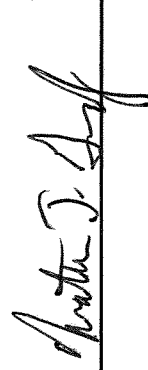

Portland International
Jetport
3101 Hawthorn Street
Portland, Maine 04112

Gensler

MESE ASSOCIATES, INC.
1000 BROADWAY, SUITE 1000
PORTLAND, MAINE 04102

JENPOL

PROJECT: PORTLAND
PROJECT #: 557-14
DATE: 8/2/11
TEAM: MJK

SHEET NOTES

1. REFER TO SHEET 182-1 FOR GENERAL NOTES AND SPECIFICATIONS.
2. ALL FOUNDATION WORK SHALL BE IN ACCORDANCE WITH THE LATEST EDITIONS OF THE INTERNATIONAL BUILDING CODE (IBC) AND THE INTERNATIONAL FOUNDATION CODE (IFC).
3. ALL FOUNDATION WORK SHALL BE IN ACCORDANCE WITH THE LATEST EDITIONS OF THE INTERNATIONAL BUILDING CODE (IBC) AND THE INTERNATIONAL FOUNDATION CODE (IFC).
4. ALL FOUNDATION WORK SHALL BE IN ACCORDANCE WITH THE LATEST EDITIONS OF THE INTERNATIONAL BUILDING CODE (IBC) AND THE INTERNATIONAL FOUNDATION CODE (IFC).
5. ALL FOUNDATION WORK SHALL BE IN ACCORDANCE WITH THE LATEST EDITIONS OF THE INTERNATIONAL BUILDING CODE (IBC) AND THE INTERNATIONAL FOUNDATION CODE (IFC).
6. ALL FOUNDATION WORK SHALL BE IN ACCORDANCE WITH THE LATEST EDITIONS OF THE INTERNATIONAL BUILDING CODE (IBC) AND THE INTERNATIONAL FOUNDATION CODE (IFC).
7. ALL FOUNDATION WORK SHALL BE IN ACCORDANCE WITH THE LATEST EDITIONS OF THE INTERNATIONAL BUILDING CODE (IBC) AND THE INTERNATIONAL FOUNDATION CODE (IFC).
8. ALL FOUNDATION WORK SHALL BE IN ACCORDANCE WITH THE LATEST EDITIONS OF THE INTERNATIONAL BUILDING CODE (IBC) AND THE INTERNATIONAL FOUNDATION CODE (IFC).
9. ALL FOUNDATION WORK SHALL BE IN ACCORDANCE WITH THE LATEST EDITIONS OF THE INTERNATIONAL BUILDING CODE (IBC) AND THE INTERNATIONAL FOUNDATION CODE (IFC).
10. ALL FOUNDATION WORK SHALL BE IN ACCORDANCE WITH THE LATEST EDITIONS OF THE INTERNATIONAL BUILDING CODE (IBC) AND THE INTERNATIONAL FOUNDATION CODE (IFC).
11. ALL FOUNDATION WORK SHALL BE IN ACCORDANCE WITH THE LATEST EDITIONS OF THE INTERNATIONAL BUILDING CODE (IBC) AND THE INTERNATIONAL FOUNDATION CODE (IFC).
12. ALL FOUNDATION WORK SHALL BE IN ACCORDANCE WITH THE LATEST EDITIONS OF THE INTERNATIONAL BUILDING CODE (IBC) AND THE INTERNATIONAL FOUNDATION CODE (IFC).
13. ALL FOUNDATION WORK SHALL BE IN ACCORDANCE WITH THE LATEST EDITIONS OF THE INTERNATIONAL BUILDING CODE (IBC) AND THE INTERNATIONAL FOUNDATION CODE (IFC).
14. ALL FOUNDATION WORK SHALL BE IN ACCORDANCE WITH THE LATEST EDITIONS OF THE INTERNATIONAL BUILDING CODE (IBC) AND THE INTERNATIONAL FOUNDATION CODE (IFC).
15. ALL FOUNDATION WORK SHALL BE IN ACCORDANCE WITH THE LATEST EDITIONS OF THE INTERNATIONAL BUILDING CODE (IBC) AND THE INTERNATIONAL FOUNDATION CODE (IFC).
16. ALL FOUNDATION WORK SHALL BE IN ACCORDANCE WITH THE LATEST EDITIONS OF THE INTERNATIONAL BUILDING CODE (IBC) AND THE INTERNATIONAL FOUNDATION CODE (IFC).
17. ALL FOUNDATION WORK SHALL BE IN ACCORDANCE WITH THE LATEST EDITIONS OF THE INTERNATIONAL BUILDING CODE (IBC) AND THE INTERNATIONAL FOUNDATION CODE (IFC).
18. ALL FOUNDATION WORK SHALL BE IN ACCORDANCE WITH THE LATEST EDITIONS OF THE INTERNATIONAL BUILDING CODE (IBC) AND THE INTERNATIONAL FOUNDATION CODE (IFC).
19. ALL FOUNDATION WORK SHALL BE IN ACCORDANCE WITH THE LATEST EDITIONS OF THE INTERNATIONAL BUILDING CODE (IBC) AND THE INTERNATIONAL FOUNDATION CODE (IFC).
20. ALL FOUNDATION WORK SHALL BE IN ACCORDANCE WITH THE LATEST EDITIONS OF THE INTERNATIONAL BUILDING CODE (IBC) AND THE INTERNATIONAL FOUNDATION CODE (IFC).

GENERAL NOTES

1. ALL FOUNDATION WORK SHALL BE IN ACCORDANCE WITH THE LATEST EDITIONS OF THE INTERNATIONAL BUILDING CODE (IBC) AND THE INTERNATIONAL FOUNDATION CODE (IFC).
2. ALL FOUNDATION WORK SHALL BE IN ACCORDANCE WITH THE LATEST EDITIONS OF THE INTERNATIONAL BUILDING CODE (IBC) AND THE INTERNATIONAL FOUNDATION CODE (IFC).
3. ALL FOUNDATION WORK SHALL BE IN ACCORDANCE WITH THE LATEST EDITIONS OF THE INTERNATIONAL BUILDING CODE (IBC) AND THE INTERNATIONAL FOUNDATION CODE (IFC).
4. ALL FOUNDATION WORK SHALL BE IN ACCORDANCE WITH THE LATEST EDITIONS OF THE INTERNATIONAL BUILDING CODE (IBC) AND THE INTERNATIONAL FOUNDATION CODE (IFC).
5. ALL FOUNDATION WORK SHALL BE IN ACCORDANCE WITH THE LATEST EDITIONS OF THE INTERNATIONAL BUILDING CODE (IBC) AND THE INTERNATIONAL FOUNDATION CODE (IFC).
6. ALL FOUNDATION WORK SHALL BE IN ACCORDANCE WITH THE LATEST EDITIONS OF THE INTERNATIONAL BUILDING CODE (IBC) AND THE INTERNATIONAL FOUNDATION CODE (IFC).
7. ALL FOUNDATION WORK SHALL BE IN ACCORDANCE WITH THE LATEST EDITIONS OF THE INTERNATIONAL BUILDING CODE (IBC) AND THE INTERNATIONAL FOUNDATION CODE (IFC).
8. ALL FOUNDATION WORK SHALL BE IN ACCORDANCE WITH THE LATEST EDITIONS OF THE INTERNATIONAL BUILDING CODE (IBC) AND THE INTERNATIONAL FOUNDATION CODE (IFC).
9. ALL FOUNDATION WORK SHALL BE IN ACCORDANCE WITH THE LATEST EDITIONS OF THE INTERNATIONAL BUILDING CODE (IBC) AND THE INTERNATIONAL FOUNDATION CODE (IFC).
10. ALL FOUNDATION WORK SHALL BE IN ACCORDANCE WITH THE LATEST EDITIONS OF THE INTERNATIONAL BUILDING CODE (IBC) AND THE INTERNATIONAL FOUNDATION CODE (IFC).
11. ALL FOUNDATION WORK SHALL BE IN ACCORDANCE WITH THE LATEST EDITIONS OF THE INTERNATIONAL BUILDING CODE (IBC) AND THE INTERNATIONAL FOUNDATION CODE (IFC).
12. ALL FOUNDATION WORK SHALL BE IN ACCORDANCE WITH THE LATEST EDITIONS OF THE INTERNATIONAL BUILDING CODE (IBC) AND THE INTERNATIONAL FOUNDATION CODE (IFC).
13. ALL FOUNDATION WORK SHALL BE IN ACCORDANCE WITH THE LATEST EDITIONS OF THE INTERNATIONAL BUILDING CODE (IBC) AND THE INTERNATIONAL FOUNDATION CODE (IFC).
14. ALL FOUNDATION WORK SHALL BE IN ACCORDANCE WITH THE LATEST EDITIONS OF THE INTERNATIONAL BUILDING CODE (IBC) AND THE INTERNATIONAL FOUNDATION CODE (IFC).
15. ALL FOUNDATION WORK SHALL BE IN ACCORDANCE WITH THE LATEST EDITIONS OF THE INTERNATIONAL BUILDING CODE (IBC) AND THE INTERNATIONAL FOUNDATION CODE (IFC).
16. ALL FOUNDATION WORK SHALL BE IN ACCORDANCE WITH THE LATEST EDITIONS OF THE INTERNATIONAL BUILDING CODE (IBC) AND THE INTERNATIONAL FOUNDATION CODE (IFC).
17. ALL FOUNDATION WORK SHALL BE IN ACCORDANCE WITH THE LATEST EDITIONS OF THE INTERNATIONAL BUILDING CODE (IBC) AND THE INTERNATIONAL FOUNDATION CODE (IFC).
18. ALL FOUNDATION WORK SHALL BE IN ACCORDANCE WITH THE LATEST EDITIONS OF THE INTERNATIONAL BUILDING CODE (IBC) AND THE INTERNATIONAL FOUNDATION CODE (IFC).
19. ALL FOUNDATION WORK SHALL BE IN ACCORDANCE WITH THE LATEST EDITIONS OF THE INTERNATIONAL BUILDING CODE (IBC) AND THE INTERNATIONAL FOUNDATION CODE (IFC).
20. ALL FOUNDATION WORK SHALL BE IN ACCORDANCE WITH THE LATEST EDITIONS OF THE INTERNATIONAL BUILDING CODE (IBC) AND THE INTERNATIONAL FOUNDATION CODE (IFC).



MESE ASSOCIATES, INC.
1000 BROADWAY, SUITE 1000
PORTLAND, MAINE 04102
PROJECT: PORTLAND
PROJECT #: 557-14
DATE: 8/2/11
TEAM: MJK

S02.01.05

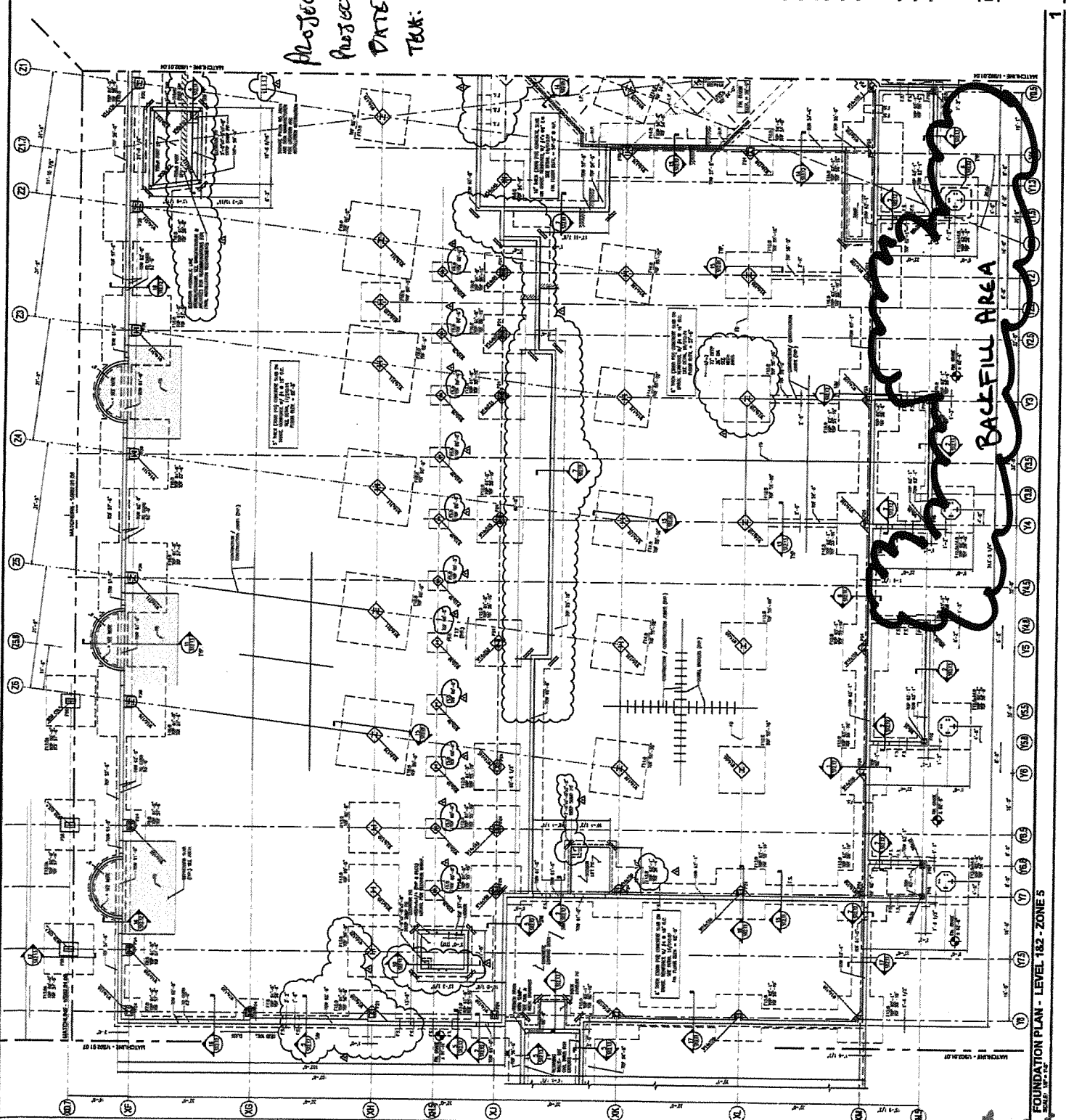

FOUNDATION PLAN - LEVEL 182 - ZONE 5
DATE: 8/2/11

SUMMARY OF IN-PLACE DENSITIES - ASTM D6938
 TERMINAL ENHANCEMENT AT THE PORTLAND INTERNATIONAL AIRPORT
 PORTLAND, MAINE
 RWG&A PROJECT NO. 557-14

Client: City of Portland
 Test Date: 5/13/2011
 Technician: MJK
 Gauge Model/Serial Number: L 500

Lab No.	Soil Description	ASTM D1557 Max Density	ASTM D1557 Opt. Moisture
11784	Type D Gravel	133.6	6.4

Report Issue Date:

Test No.	Location	Elevation	ASTM D6938 Dry Density (pcf)	ASTM D6938 Water Content (%)	Percent of Max. (%)	Lab. No.
1	XM.5+10'/Y5.5	FG-2'	127.7	3	96	11784
2	XM.5/Y6.5	FG-2'	132.0	4	99	11784
3	SIDEWALK - WEST SIDE OF ENTRY	FG	127.8	2	96	11784
4	SIDEWALK - WEST SIDE OF ENTRY	FG	128.4	3	96	11784
5	XM.5+10'/ZC	FG-1'	126.4	3	95	11784
6	XM.5+10'/ZC	FG	127.2	4	95	11784
7	XM.5+20'/ZC	FG	131.8	4	99	11784
8	XM.5+10'/Y5.5	FG-1'	129.6	4	97	11784
9	XM.5/Y6.5	FG-1'	128.6	4	96	11784
10	XM.5+10'/Y5.5	FG	127.5	3	96	11784
11	XM.5/Y6.5	FG	126.4	3	95	11784

Remarks:

- FG = Finish Grade
- FF = Finish Floor
- FGB = Finish Grade of Base
- FGSB = Finish Grade of Subbase
- FGSG = Finish Grade of Subgrade

- TOW = Top of Foundation Wall
- BOW = Bottom of Wall
- BOF = Bottom of Footing
- SG = Subgrade

Arnette S. Deaf

Checked by:

Portland International
Jetport
1001 Westbank Street
Portland, Maine 04112

Gensler

MBST ASSOCIATES, INC.
Engineers - Architects - Planners - Construction Managers

PROJECT: PORTLAND
JETPORT
PROJECT #1 557-14
DATE: 5/13/11
TECH: MJK

- SHEET NOTES**
1. GENERAL NOTES TO BE CONSULTED FOR ALL NOTES ON THIS SHEET.
 2. ALL NOTES TO BE CONSULTED FOR ALL NOTES ON THIS SHEET.
 3. ALL NOTES TO BE CONSULTED FOR ALL NOTES ON THIS SHEET.
 4. ALL NOTES TO BE CONSULTED FOR ALL NOTES ON THIS SHEET.
 5. ALL NOTES TO BE CONSULTED FOR ALL NOTES ON THIS SHEET.
 6. ALL NOTES TO BE CONSULTED FOR ALL NOTES ON THIS SHEET.
 7. ALL NOTES TO BE CONSULTED FOR ALL NOTES ON THIS SHEET.
 8. ALL NOTES TO BE CONSULTED FOR ALL NOTES ON THIS SHEET.
 9. ALL NOTES TO BE CONSULTED FOR ALL NOTES ON THIS SHEET.
 10. ALL NOTES TO BE CONSULTED FOR ALL NOTES ON THIS SHEET.

GENERAL NOTES

1. ALL NOTES TO BE CONSULTED FOR ALL NOTES ON THIS SHEET.
2. ALL NOTES TO BE CONSULTED FOR ALL NOTES ON THIS SHEET.
3. ALL NOTES TO BE CONSULTED FOR ALL NOTES ON THIS SHEET.
4. ALL NOTES TO BE CONSULTED FOR ALL NOTES ON THIS SHEET.
5. ALL NOTES TO BE CONSULTED FOR ALL NOTES ON THIS SHEET.
6. ALL NOTES TO BE CONSULTED FOR ALL NOTES ON THIS SHEET.
7. ALL NOTES TO BE CONSULTED FOR ALL NOTES ON THIS SHEET.
8. ALL NOTES TO BE CONSULTED FOR ALL NOTES ON THIS SHEET.
9. ALL NOTES TO BE CONSULTED FOR ALL NOTES ON THIS SHEET.
10. ALL NOTES TO BE CONSULTED FOR ALL NOTES ON THIS SHEET.

KEY PLAN



FOUNDATION PLAN - LEVEL 182 - ZONE 5
SCALE: 1/8" = 1'-0"

S02.01.05

