



**SITE WORK  
DAILY FIELD REPORT**

PROJECT: Terminal Enhancement at the Portland International Jetport

DATE: 5/9/2011

PROJECT LOCATION: Portland, Maine

PROJECT NO.: 0557-014

CLIENT: City of Portland

WEATHER: Sunny

CONTRACTOR: Turner Construction Co.

PREVIOUS DATE ON SITE: 5/6/2011

Time on-site at 9.75 hrs, 28 mi travel, Tolls: \$1.00

3 IPDs performed on sidewalk subgrade along NE side of upper parking lot. 8 IPDs performed along back side of Zone 5. All IPDs meet or exceed 95% compaction, per specification. IPDs performed on Type D Gravel, Lab No. 11784; 133.6 pcf @ 6.4% moisture.

*MJK*

\_\_\_\_\_  
Michael Kramlich

Prepared By

*MTG*

\_\_\_\_\_  
Matthew Grady

Reviewed By

\_\_\_\_\_  
R. W. Gillespie & Associates 86 industrial Park Rd., Suite 4, Saco, ME 04072- (207)286-8008

**SHEET NOTES**

1. REFER TO SHEET 182-1 FOR SHEET INDEX.
2. ALL DIMENSIONS UNLESS OTHERWISE NOTED ARE IN FEET AND INCHES (F'-INCHES).
3. ALL DIMENSIONS UNLESS OTHERWISE NOTED ARE IN FEET AND INCHES (F'-INCHES).
4. ALL DIMENSIONS UNLESS OTHERWISE NOTED ARE IN FEET AND INCHES (F'-INCHES).
5. ALL DIMENSIONS UNLESS OTHERWISE NOTED ARE IN FEET AND INCHES (F'-INCHES).
6. ALL DIMENSIONS UNLESS OTHERWISE NOTED ARE IN FEET AND INCHES (F'-INCHES).
7. ALL DIMENSIONS UNLESS OTHERWISE NOTED ARE IN FEET AND INCHES (F'-INCHES).
8. ALL DIMENSIONS UNLESS OTHERWISE NOTED ARE IN FEET AND INCHES (F'-INCHES).
9. ALL DIMENSIONS UNLESS OTHERWISE NOTED ARE IN FEET AND INCHES (F'-INCHES).
10. ALL DIMENSIONS UNLESS OTHERWISE NOTED ARE IN FEET AND INCHES (F'-INCHES).
11. ALL DIMENSIONS UNLESS OTHERWISE NOTED ARE IN FEET AND INCHES (F'-INCHES).
12. ALL DIMENSIONS UNLESS OTHERWISE NOTED ARE IN FEET AND INCHES (F'-INCHES).
13. ALL DIMENSIONS UNLESS OTHERWISE NOTED ARE IN FEET AND INCHES (F'-INCHES).
14. ALL DIMENSIONS UNLESS OTHERWISE NOTED ARE IN FEET AND INCHES (F'-INCHES).
15. ALL DIMENSIONS UNLESS OTHERWISE NOTED ARE IN FEET AND INCHES (F'-INCHES).
16. ALL DIMENSIONS UNLESS OTHERWISE NOTED ARE IN FEET AND INCHES (F'-INCHES).
17. ALL DIMENSIONS UNLESS OTHERWISE NOTED ARE IN FEET AND INCHES (F'-INCHES).
18. ALL DIMENSIONS UNLESS OTHERWISE NOTED ARE IN FEET AND INCHES (F'-INCHES).
19. ALL DIMENSIONS UNLESS OTHERWISE NOTED ARE IN FEET AND INCHES (F'-INCHES).
20. ALL DIMENSIONS UNLESS OTHERWISE NOTED ARE IN FEET AND INCHES (F'-INCHES).
21. ALL DIMENSIONS UNLESS OTHERWISE NOTED ARE IN FEET AND INCHES (F'-INCHES).
22. ALL DIMENSIONS UNLESS OTHERWISE NOTED ARE IN FEET AND INCHES (F'-INCHES).
23. ALL DIMENSIONS UNLESS OTHERWISE NOTED ARE IN FEET AND INCHES (F'-INCHES).
24. ALL DIMENSIONS UNLESS OTHERWISE NOTED ARE IN FEET AND INCHES (F'-INCHES).
25. ALL DIMENSIONS UNLESS OTHERWISE NOTED ARE IN FEET AND INCHES (F'-INCHES).
26. ALL DIMENSIONS UNLESS OTHERWISE NOTED ARE IN FEET AND INCHES (F'-INCHES).
27. ALL DIMENSIONS UNLESS OTHERWISE NOTED ARE IN FEET AND INCHES (F'-INCHES).
28. ALL DIMENSIONS UNLESS OTHERWISE NOTED ARE IN FEET AND INCHES (F'-INCHES).
29. ALL DIMENSIONS UNLESS OTHERWISE NOTED ARE IN FEET AND INCHES (F'-INCHES).
30. ALL DIMENSIONS UNLESS OTHERWISE NOTED ARE IN FEET AND INCHES (F'-INCHES).

PROJECT: PORTLAND JETPORT  
PROJECT #: 557-14  
DATE: 5/9/11  
TECH: MJK  
① 182 LOCATION

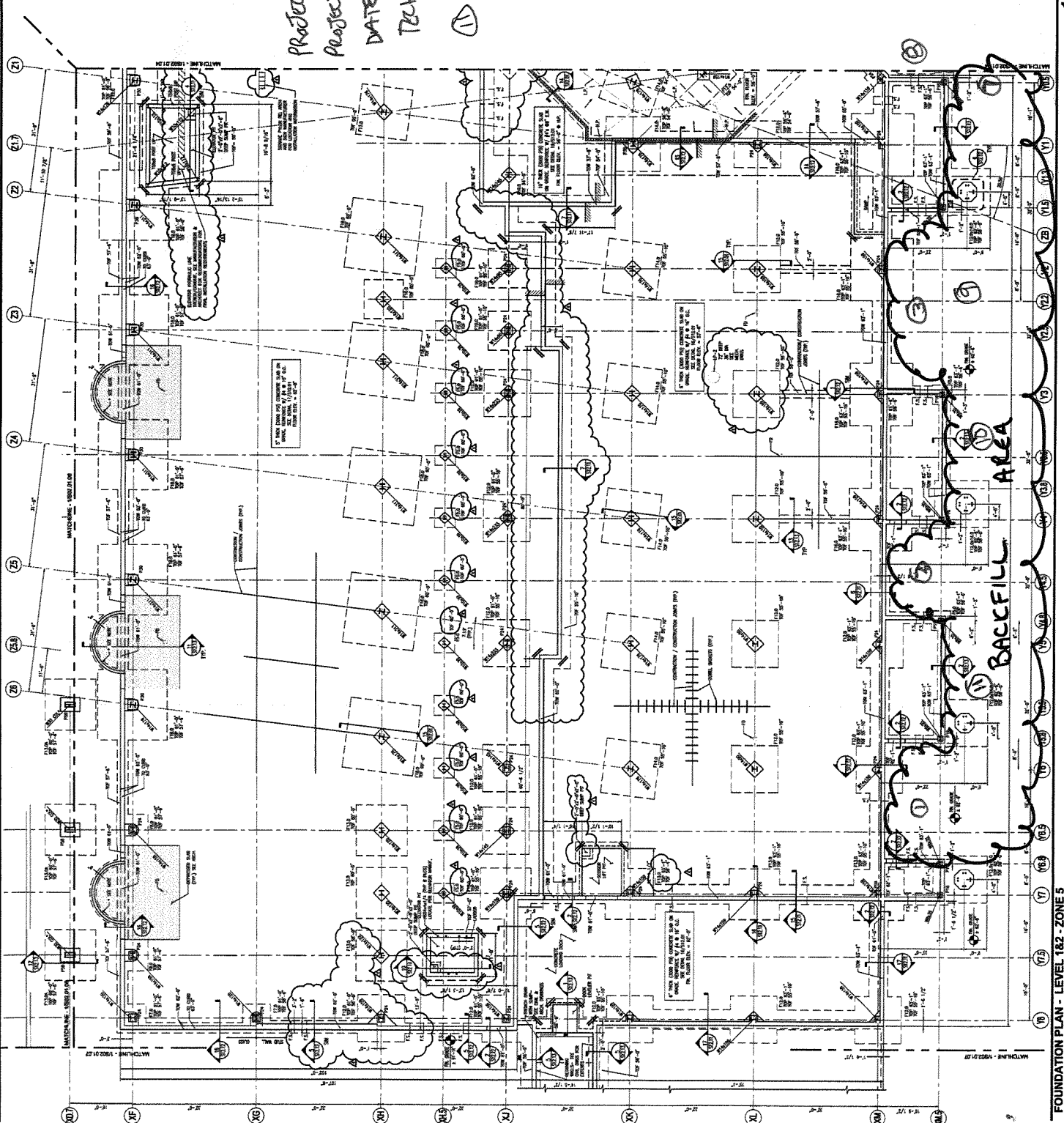

**GENERAL NOTES**

1. ALL DIMENSIONS UNLESS OTHERWISE NOTED ARE IN FEET AND INCHES (F'-INCHES).
2. ALL DIMENSIONS UNLESS OTHERWISE NOTED ARE IN FEET AND INCHES (F'-INCHES).
3. ALL DIMENSIONS UNLESS OTHERWISE NOTED ARE IN FEET AND INCHES (F'-INCHES).
4. ALL DIMENSIONS UNLESS OTHERWISE NOTED ARE IN FEET AND INCHES (F'-INCHES).
5. ALL DIMENSIONS UNLESS OTHERWISE NOTED ARE IN FEET AND INCHES (F'-INCHES).
6. ALL DIMENSIONS UNLESS OTHERWISE NOTED ARE IN FEET AND INCHES (F'-INCHES).
7. ALL DIMENSIONS UNLESS OTHERWISE NOTED ARE IN FEET AND INCHES (F'-INCHES).
8. ALL DIMENSIONS UNLESS OTHERWISE NOTED ARE IN FEET AND INCHES (F'-INCHES).
9. ALL DIMENSIONS UNLESS OTHERWISE NOTED ARE IN FEET AND INCHES (F'-INCHES).
10. ALL DIMENSIONS UNLESS OTHERWISE NOTED ARE IN FEET AND INCHES (F'-INCHES).
11. ALL DIMENSIONS UNLESS OTHERWISE NOTED ARE IN FEET AND INCHES (F'-INCHES).
12. ALL DIMENSIONS UNLESS OTHERWISE NOTED ARE IN FEET AND INCHES (F'-INCHES).
13. ALL DIMENSIONS UNLESS OTHERWISE NOTED ARE IN FEET AND INCHES (F'-INCHES).
14. ALL DIMENSIONS UNLESS OTHERWISE NOTED ARE IN FEET AND INCHES (F'-INCHES).
15. ALL DIMENSIONS UNLESS OTHERWISE NOTED ARE IN FEET AND INCHES (F'-INCHES).
16. ALL DIMENSIONS UNLESS OTHERWISE NOTED ARE IN FEET AND INCHES (F'-INCHES).
17. ALL DIMENSIONS UNLESS OTHERWISE NOTED ARE IN FEET AND INCHES (F'-INCHES).
18. ALL DIMENSIONS UNLESS OTHERWISE NOTED ARE IN FEET AND INCHES (F'-INCHES).
19. ALL DIMENSIONS UNLESS OTHERWISE NOTED ARE IN FEET AND INCHES (F'-INCHES).
20. ALL DIMENSIONS UNLESS OTHERWISE NOTED ARE IN FEET AND INCHES (F'-INCHES).
21. ALL DIMENSIONS UNLESS OTHERWISE NOTED ARE IN FEET AND INCHES (F'-INCHES).
22. ALL DIMENSIONS UNLESS OTHERWISE NOTED ARE IN FEET AND INCHES (F'-INCHES).
23. ALL DIMENSIONS UNLESS OTHERWISE NOTED ARE IN FEET AND INCHES (F'-INCHES).
24. ALL DIMENSIONS UNLESS OTHERWISE NOTED ARE IN FEET AND INCHES (F'-INCHES).
25. ALL DIMENSIONS UNLESS OTHERWISE NOTED ARE IN FEET AND INCHES (F'-INCHES).
26. ALL DIMENSIONS UNLESS OTHERWISE NOTED ARE IN FEET AND INCHES (F'-INCHES).
27. ALL DIMENSIONS UNLESS OTHERWISE NOTED ARE IN FEET AND INCHES (F'-INCHES).
28. ALL DIMENSIONS UNLESS OTHERWISE NOTED ARE IN FEET AND INCHES (F'-INCHES).
29. ALL DIMENSIONS UNLESS OTHERWISE NOTED ARE IN FEET AND INCHES (F'-INCHES).
30. ALL DIMENSIONS UNLESS OTHERWISE NOTED ARE IN FEET AND INCHES (F'-INCHES).

NO.	DATE	DESCRIPTION	BY	CHK.
1	11/11/88	PRELIMINARY	AL	AL
2	11/11/88	PRELIMINARY	AL	AL
3	11/11/88	PRELIMINARY	AL	AL
4	11/11/88	PRELIMINARY	AL	AL
5	11/11/88	PRELIMINARY	AL	AL
6	11/11/88	PRELIMINARY	AL	AL
7	11/11/88	PRELIMINARY	AL	AL
8	11/11/88	PRELIMINARY	AL	AL
9	11/11/88	PRELIMINARY	AL	AL
10	11/11/88	PRELIMINARY	AL	AL



PROJECT: PORTLAND JETPORT  
PROJECT # 1587-1A  
DATE: 5/9/88  
DRAWN: MJC

**SHEET NOTES**

- SEE EXISTING RECORDS FOR LINES OF ALL WORK.
- SEE EXISTING RECORDS FOR ALL UTILITIES.

NO.	DATE	DESCRIPTION	BY	CHK.
1	11/11/88	PRELIMINARY	AL	AL
2	11/11/88	PRELIMINARY	AL	AL
3	11/11/88	PRELIMINARY	AL	AL
4	11/11/88	PRELIMINARY	AL	AL
5	11/11/88	PRELIMINARY	AL	AL
6	11/11/88	PRELIMINARY	AL	AL
7	11/11/88	PRELIMINARY	AL	AL
8	11/11/88	PRELIMINARY	AL	AL
9	11/11/88	PRELIMINARY	AL	AL
10	11/11/88	PRELIMINARY	AL	AL

**GENERAL NOTES**

- ALL WORK SHALL BE ACCORDING TO THE LATEST EDITIONS OF THE STANDARD SPECIFICATIONS FOR HIGHWAY CONSTRUCTION, AS APPLICABLE.
- THE CONTRACTOR SHALL BE RESPONSIBLE FOR OBTAINING ALL NECESSARY PERMITS AND APPROVALS FROM THE APPROPRIATE AGENCIES.
- THE CONTRACTOR SHALL MAINTAIN ACCESS TO ALL ADJACENT PROPERTIES AND UTILITIES AT ALL TIMES.
- ALL UTILITIES SHALL BE PROTECTED AND DEEPER THAN THE PROPOSED CONSTRUCTION.
- THE CONTRACTOR SHALL MAINTAIN ADEQUATE DRAINAGE THROUGHOUT THE PROJECT.
- ALL WORK SHALL BE ACCORDING TO THE LATEST EDITIONS OF THE STANDARD SPECIFICATIONS FOR HIGHWAY CONSTRUCTION, AS APPLICABLE.
- THE CONTRACTOR SHALL BE RESPONSIBLE FOR OBTAINING ALL NECESSARY PERMITS AND APPROVALS FROM THE APPROPRIATE AGENCIES.
- THE CONTRACTOR SHALL MAINTAIN ACCESS TO ALL ADJACENT PROPERTIES AND UTILITIES AT ALL TIMES.
- ALL UTILITIES SHALL BE PROTECTED AND DEEPER THAN THE PROPOSED CONSTRUCTION.
- THE CONTRACTOR SHALL MAINTAIN ADEQUATE DRAINAGE THROUGHOUT THE PROJECT.

SIDEWALK  
SUBGRADE

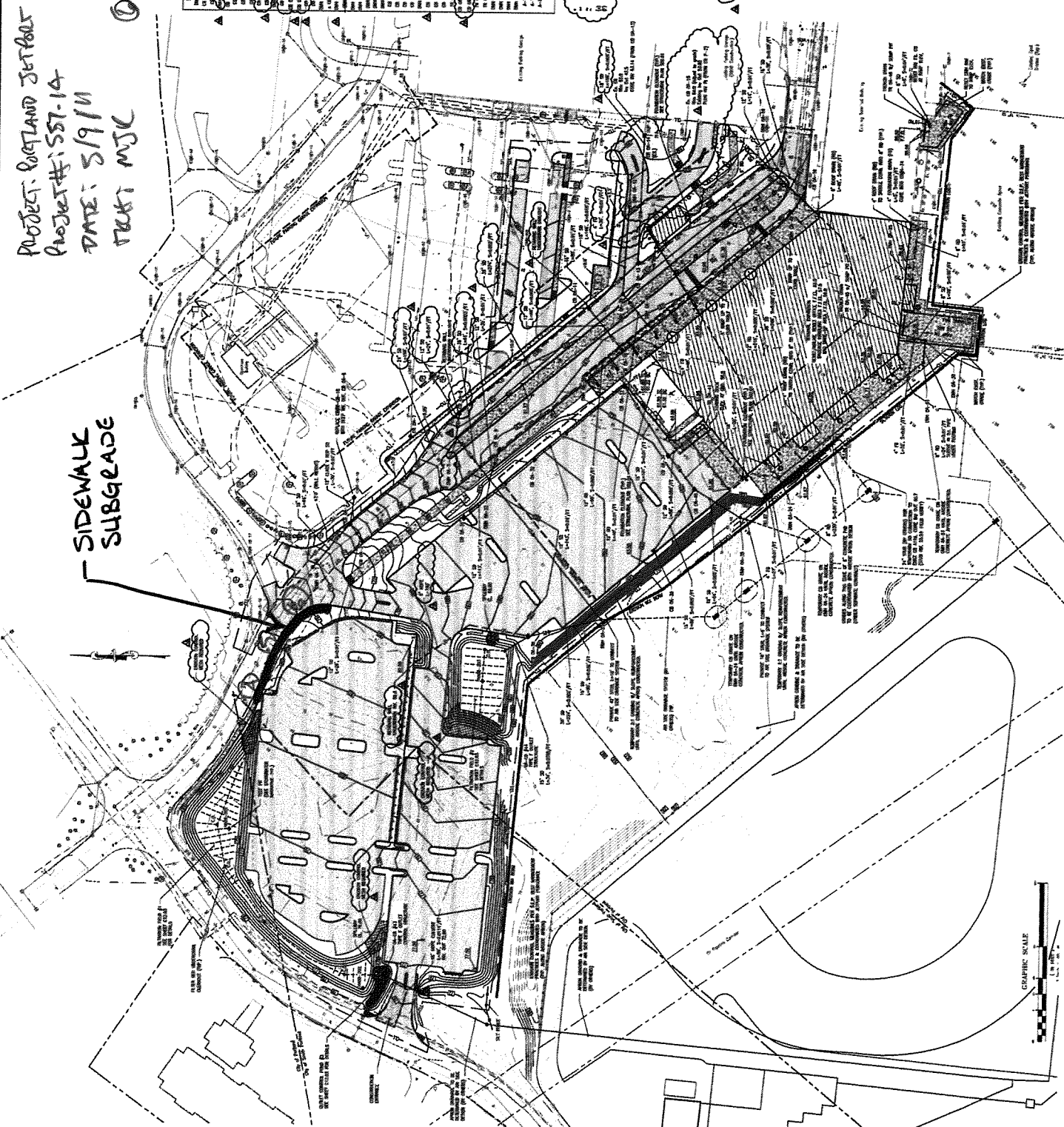



**SITE WORK  
DAILY FIELD REPORT**

PROJECT: Terminal Enhancement at the Portland International Jetport

DATE: 5/10/2011

PROJECT LOCATION: Portland, Maine

PROJECT NO.: 0557-014

CLIENT: City of Portland

WEATHER: Sunny

CONTRACTOR: Turner Construction Co.

PREVIOUS DATE ON SITE: 5/9/2011

Time on-site at 4 hrs, 28 mi travel, Tolls: \$1.00

Arrived on site at 7:30am for compaction testing. Pockets of blue clay were discovered and had to be excavated before backfilling could continue. Spot checked density of backfill in Phase III for Mark Nicklin of Gorham Sand & Gravel. Left site at 10:30am when it became clear that no density testing would be required today.

*MSK*

Michael Kramlich

Prepared By

*MTG*

Matthew Grady

Reviewed By

R. W. Gillespie & Associates 86 industrial Park Rd., Suite 4, Saco, ME 04072- (207)286-8008



**SITE WORK  
DAILY FIELD REPORT**

PROJECT: Terminal Enhancement at the Portland International Jetport

DATE: 5/11/2011

PROJECT LOCATION: Portland, Maine

PROJECT NO.: 0557-014

CLIENT: City of Portland

WEATHER: Sunny

CONTRACTOR: Turner Construction Co.

PREVIOUS DATE ON SITE: 5/10/2011

Time on-site at 10 hrs, 30 mi travel, Tolls: \$2.00

2 IPDs performed on sidewalk subgrade along west side of entry road. 9 IPDs performed on backfill along back side of Zone 5. All IPDs meet or exceed 95% compaction, per specification. IPDs performed on Type D Gravel, Lab No. 11784; 133.6 pcf @ 6.4% moisture. Compaction of sidewalk subgrade achieved through use of plate compactor. Compaction of backfill achieved through use of Ingersol-Rand drum roller in conjunction with plate compactor. Pockets of blue clay over excavated and impervious liner used under backfill material.

28 cubic yards of 4500psi concrete placed as sidewalk along NE side of upper lot. 2<sup>nd</sup> load tested and sampled for cylinders.

*MJK*

---

Michael Kramlich

Prepared By

*MB*

---

Matthew Grady

Reviewed By

---

R. W. Gillespie & Associates 86 industrial Park Rd., Suite 4, Saco, ME 04072- (207)286-8008

---





**SHEET NOTES**

PROJECT: PORTLAND JETPORT  
PROJECT #: 587-14  
DATE: 5/1/11  
TECH: MJR

NO.	DATE	DESCRIPTION
1	07/27/06	ISSUED FOR PERMIT
2	07/27/06	ISSUED FOR PERMIT
3	07/27/06	ISSUED FOR PERMIT
4	07/27/06	ISSUED FOR PERMIT
5	07/27/06	ISSUED FOR PERMIT
6	07/27/06	ISSUED FOR PERMIT
7	07/27/06	ISSUED FOR PERMIT
8	07/27/06	ISSUED FOR PERMIT
9	07/27/06	ISSUED FOR PERMIT
10	07/27/06	ISSUED FOR PERMIT

**GENERAL NOTES**

1. ALL DIMENSIONS UNLESS OTHERWISE NOTED ARE IN FEET AND INCHES.
2. THE 1" SCALE SHALL BE USED FOR ALL DIMENSIONS UNLESS OTHERWISE NOTED.
3. THE 1" SCALE SHALL BE USED FOR ALL DIMENSIONS UNLESS OTHERWISE NOTED.
4. THE 1" SCALE SHALL BE USED FOR ALL DIMENSIONS UNLESS OTHERWISE NOTED.
5. THE 1" SCALE SHALL BE USED FOR ALL DIMENSIONS UNLESS OTHERWISE NOTED.
6. THE 1" SCALE SHALL BE USED FOR ALL DIMENSIONS UNLESS OTHERWISE NOTED.
7. THE 1" SCALE SHALL BE USED FOR ALL DIMENSIONS UNLESS OTHERWISE NOTED.
8. THE 1" SCALE SHALL BE USED FOR ALL DIMENSIONS UNLESS OTHERWISE NOTED.
9. THE 1" SCALE SHALL BE USED FOR ALL DIMENSIONS UNLESS OTHERWISE NOTED.
10. THE 1" SCALE SHALL BE USED FOR ALL DIMENSIONS UNLESS OTHERWISE NOTED.
11. THE 1" SCALE SHALL BE USED FOR ALL DIMENSIONS UNLESS OTHERWISE NOTED.
12. THE 1" SCALE SHALL BE USED FOR ALL DIMENSIONS UNLESS OTHERWISE NOTED.
13. THE 1" SCALE SHALL BE USED FOR ALL DIMENSIONS UNLESS OTHERWISE NOTED.
14. THE 1" SCALE SHALL BE USED FOR ALL DIMENSIONS UNLESS OTHERWISE NOTED.
15. THE 1" SCALE SHALL BE USED FOR ALL DIMENSIONS UNLESS OTHERWISE NOTED.

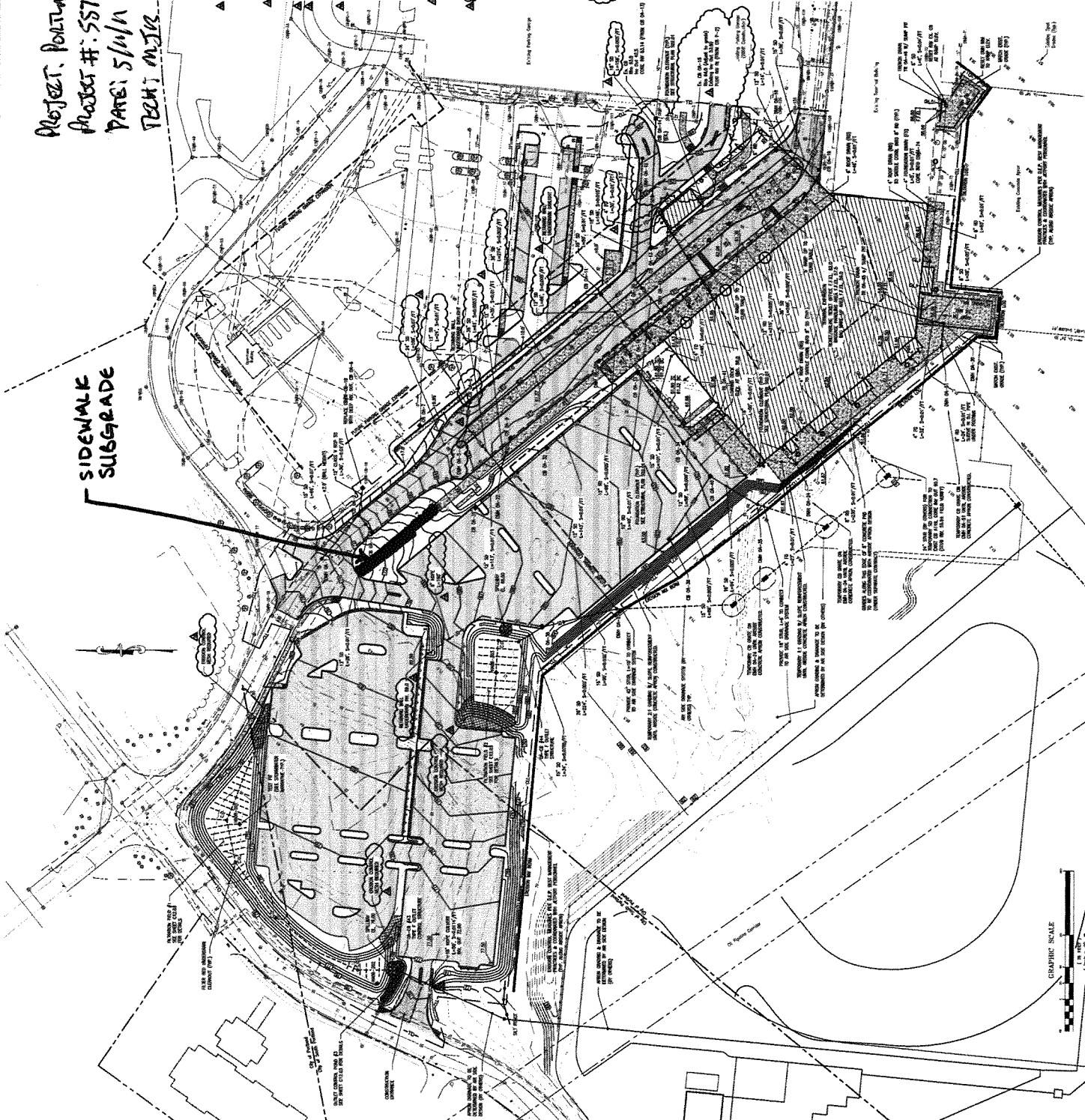

NO.	DATE	DESCRIPTION
1	07/21/04	ISSUE FOR PERMIT
2	08/27/04	REVISED PERMIT
3	09/15/04	REVISED PERMIT
4	10/01/04	REVISED PERMIT
5	11/02/04	REVISED PERMIT
6	12/01/04	REVISED PERMIT
7	01/01/05	REVISED PERMIT
8	02/01/05	REVISED PERMIT
9	03/01/05	REVISED PERMIT
10	04/01/05	REVISED PERMIT



PROJECT: PORTLAND JETPORT  
PROJECT #: 557-14  
DATE: 5/11/11  
PROJECT MGR: [Name]

SHEET NOTES

1. SEE SECTION DRAWING FOR DETAILS OF THE WORK.

NO.	DATE	DESCRIPTION
1	07/21/04	ISSUE FOR PERMIT
2	08/27/04	REVISED PERMIT
3	09/15/04	REVISED PERMIT
4	10/01/04	REVISED PERMIT
5	11/02/04	REVISED PERMIT
6	12/01/04	REVISED PERMIT
7	01/01/05	REVISED PERMIT
8	02/01/05	REVISED PERMIT
9	03/01/05	REVISED PERMIT
10	04/01/05	REVISED PERMIT

GENERAL NOTES

1. ALL WORK SHALL BE IN ACCORDANCE WITH THE LATEST EDITIONS OF THE SPECIFICATIONS FOR CONSTRUCTION DOCUMENTS, AS APPLICABLE.
2. THE CONTRACTOR SHALL BE RESPONSIBLE FOR OBTAINING ALL NECESSARY PERMITS AND APPROVALS FROM THE APPLICABLE AGENCIES.
3. THE CONTRACTOR SHALL BE RESPONSIBLE FOR OBTAINING ALL NECESSARY PERMITS AND APPROVALS FROM THE APPLICABLE AGENCIES.
4. THE CONTRACTOR SHALL BE RESPONSIBLE FOR OBTAINING ALL NECESSARY PERMITS AND APPROVALS FROM THE APPLICABLE AGENCIES.
5. THE CONTRACTOR SHALL BE RESPONSIBLE FOR OBTAINING ALL NECESSARY PERMITS AND APPROVALS FROM THE APPLICABLE AGENCIES.
6. THE CONTRACTOR SHALL BE RESPONSIBLE FOR OBTAINING ALL NECESSARY PERMITS AND APPROVALS FROM THE APPLICABLE AGENCIES.
7. THE CONTRACTOR SHALL BE RESPONSIBLE FOR OBTAINING ALL NECESSARY PERMITS AND APPROVALS FROM THE APPLICABLE AGENCIES.
8. THE CONTRACTOR SHALL BE RESPONSIBLE FOR OBTAINING ALL NECESSARY PERMITS AND APPROVALS FROM THE APPLICABLE AGENCIES.
9. THE CONTRACTOR SHALL BE RESPONSIBLE FOR OBTAINING ALL NECESSARY PERMITS AND APPROVALS FROM THE APPLICABLE AGENCIES.
10. THE CONTRACTOR SHALL BE RESPONSIBLE FOR OBTAINING ALL NECESSARY PERMITS AND APPROVALS FROM THE APPLICABLE AGENCIES.

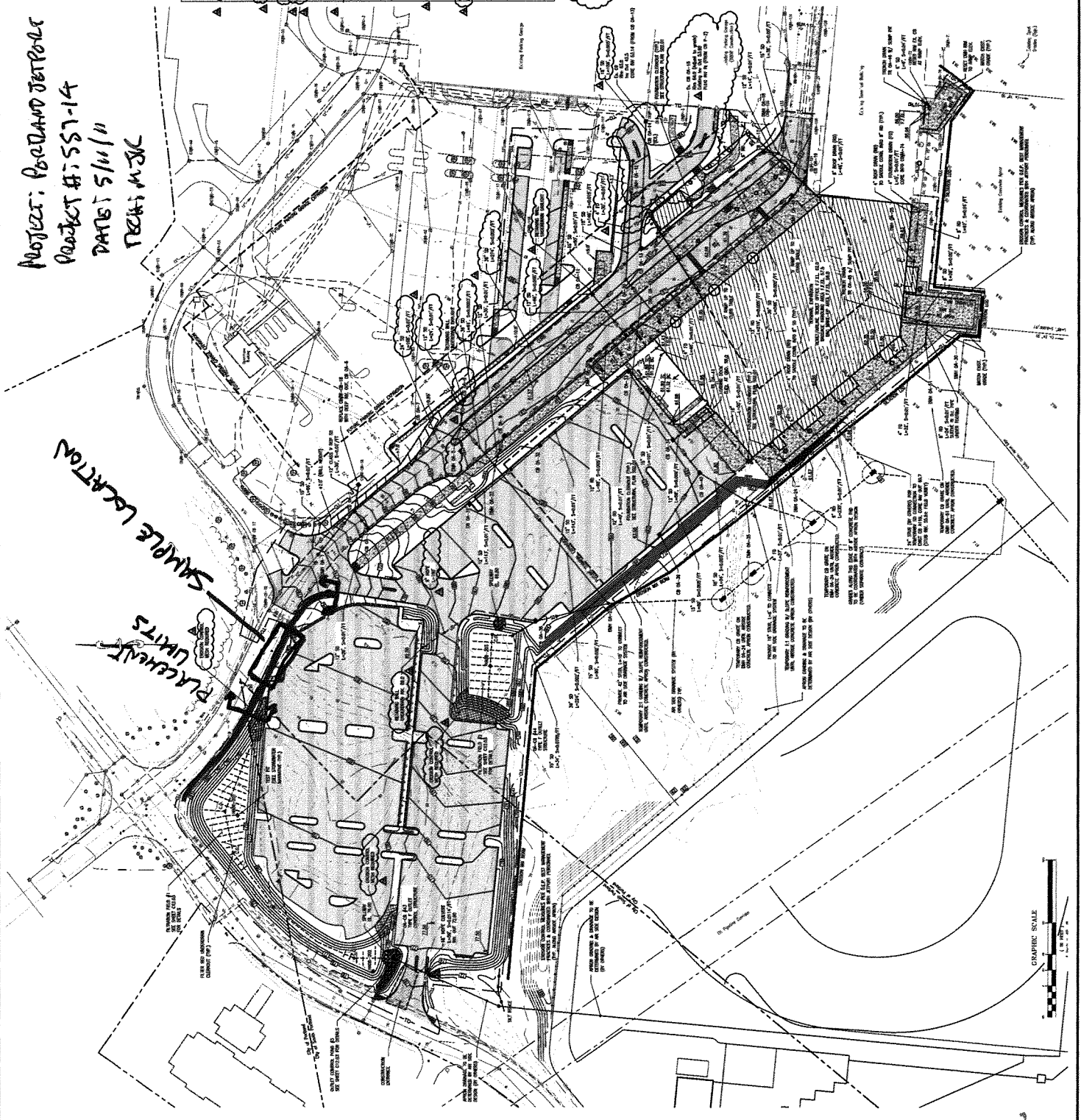





**SITE WORK  
DAILY FIELD REPORT**

PROJECT: Terminal Enhancement at the Portland International Jetport

DATE: 5/12/2011

PROJECT LOCATION: Portland, Maine

PROJECT NO.: 0557-014

CLIENT: City of Portland

WEATHER: Sunny

CONTRACTOR: Turner Construction Co.

PREVIOUS DATE ON SITE: 5/11/2011

Time on-site at 3.5 hrs, 28 mi travel, Tolls: \$0.00

8 IPDs performed on backfill along back side of Zone 5. All IPDs meet or exceed 95% compaction, per specification. IPDs performed on Type D Gravel, Lab No. 11784; 133.6 pcf @ 6.4% moisture. Compaction of backfill achieved through use of plate compactor.

Picked up cylinders made 5/11/2011.

*MJK*

Michael Kramlich

Prepared By

*MWG*

Matthew Grady

Reviewed By

JENPBL

PROJECT: PORTLAND  
PROJECT # : 557-14  
DATE : 8/2/11  
TEAM: MJK

**SHEET NOTES**  
1. ALL DIMENSIONS UNLESS OTHERWISE NOTED ARE IN FEET AND INCHES.  
2. ALL DIMENSIONS SHALL BE TO FACE UNLESS OTHERWISE NOTED.  
3. ALL DIMENSIONS SHALL BE TO CENTERLINE UNLESS OTHERWISE NOTED.  
4. ALL DIMENSIONS SHALL BE TO CENTERLINE UNLESS OTHERWISE NOTED.  
5. ALL DIMENSIONS SHALL BE TO CENTERLINE UNLESS OTHERWISE NOTED.  
6. ALL DIMENSIONS SHALL BE TO CENTERLINE UNLESS OTHERWISE NOTED.  
7. ALL DIMENSIONS SHALL BE TO CENTERLINE UNLESS OTHERWISE NOTED.  
8. ALL DIMENSIONS SHALL BE TO CENTERLINE UNLESS OTHERWISE NOTED.  
9. ALL DIMENSIONS SHALL BE TO CENTERLINE UNLESS OTHERWISE NOTED.  
10. ALL DIMENSIONS SHALL BE TO CENTERLINE UNLESS OTHERWISE NOTED.

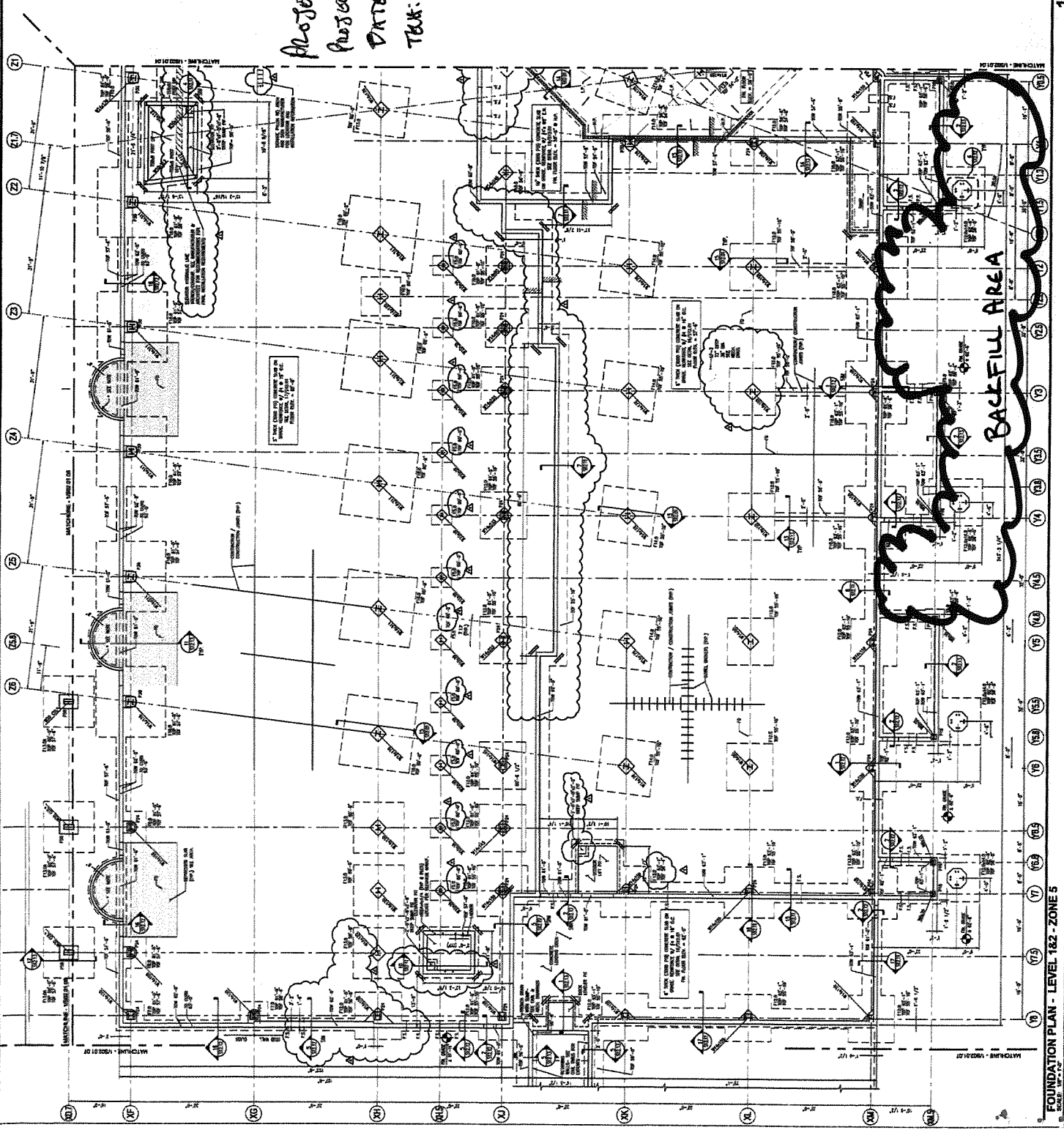

**GENERAL NOTES**

1. ALL DIMENSIONS UNLESS OTHERWISE NOTED ARE IN FEET AND INCHES.
2. ALL DIMENSIONS SHALL BE TO FACE UNLESS OTHERWISE NOTED.
3. ALL DIMENSIONS SHALL BE TO CENTERLINE UNLESS OTHERWISE NOTED.
4. ALL DIMENSIONS SHALL BE TO CENTERLINE UNLESS OTHERWISE NOTED.
5. ALL DIMENSIONS SHALL BE TO CENTERLINE UNLESS OTHERWISE NOTED.
6. ALL DIMENSIONS SHALL BE TO CENTERLINE UNLESS OTHERWISE NOTED.
7. ALL DIMENSIONS SHALL BE TO CENTERLINE UNLESS OTHERWISE NOTED.
8. ALL DIMENSIONS SHALL BE TO CENTERLINE UNLESS OTHERWISE NOTED.
9. ALL DIMENSIONS SHALL BE TO CENTERLINE UNLESS OTHERWISE NOTED.
10. ALL DIMENSIONS SHALL BE TO CENTERLINE UNLESS OTHERWISE NOTED.
11. ALL DIMENSIONS SHALL BE TO CENTERLINE UNLESS OTHERWISE NOTED.
12. ALL DIMENSIONS SHALL BE TO CENTERLINE UNLESS OTHERWISE NOTED.
13. ALL DIMENSIONS SHALL BE TO CENTERLINE UNLESS OTHERWISE NOTED.
14. ALL DIMENSIONS SHALL BE TO CENTERLINE UNLESS OTHERWISE NOTED.
15. ALL DIMENSIONS SHALL BE TO CENTERLINE UNLESS OTHERWISE NOTED.
16. ALL DIMENSIONS SHALL BE TO CENTERLINE UNLESS OTHERWISE NOTED.
17. ALL DIMENSIONS SHALL BE TO CENTERLINE UNLESS OTHERWISE NOTED.
18. ALL DIMENSIONS SHALL BE TO CENTERLINE UNLESS OTHERWISE NOTED.
19. ALL DIMENSIONS SHALL BE TO CENTERLINE UNLESS OTHERWISE NOTED.
20. ALL DIMENSIONS SHALL BE TO CENTERLINE UNLESS OTHERWISE NOTED.

MEEST ASSOCIATES, INC.  
100 STATE STREET, SUITE 200  
BOSTON, MASSACHUSETTS 02109  
PROJECT: PORTLAND  
PROJECT # : 557-14  
DATE : 8/2/11  
TEAM: MJK

**KEY PLAN**

7 6 5 4 3 2 1

1 2 3 4 5 6 7

SCALE: 1/8" = 1'-0"

S02.01.05



**SITE WORK  
DAILY FIELD REPORT**

PROJECT: Terminal Enhancement at the Portland International Jetport

DATE: 5/13/2011

PROJECT LOCATION: Portland, Maine

PROJECT NO.: 0557-014

CLIENT: City of Portland

WEATHER: Sunny

CONTRACTOR: Turner Construction Co.

PREVIOUS DATE ON SITE: 5/12/2011

Time on-site at 7.5 hrs, 28 mi travel, Tolls: \$0.00

2 IPDs performed on sidewalk subgrade along west side of entry road. 9 IPDs performed along back side of Zone 5. All IPDs meet or exceed 95% compaction, per specification. IPDs performed on Type D Gravel, Lab No. 11784; 133.6 pcf @ 6.4% moisture.

*MSK*

Michael Kramlich

Prepared By

*MTG*

Matthew Grady

Reviewed By

Portland International  
Jetport  
1001 Westbrook Street  
Portland, Maine 04102

Gensler

meaf ASSOCIATES, INC.  
MECHANICAL ENGINEERING ARCHITECTURE INTERIORS

Jordan

PROJECT: PORTLAND  
PROJECT #: 557-1A  
DATE: 5/13/11  
TECH: MJF

- SHEET NOTES**
1. REFER TO SHEET 182-ZONE 5 FOR GENERAL NOTES AND SPECIFICATIONS.
  2. ALL FOUNDATION ELEMENTS SHALL BE CONCRETE UNLESS OTHERWISE NOTED.
  3. ALL FOUNDATION ELEMENTS SHALL BE CAST IN PLACE CONCRETE.
  4. ALL FOUNDATION ELEMENTS SHALL BE CAST ON A 4" MIN. SAND BED.
  5. ALL FOUNDATION ELEMENTS SHALL BE CAST WITH A 3" MIN. AIR ENTRAINMENT.
  6. ALL FOUNDATION ELEMENTS SHALL BE CAST WITH A 1" MIN. FINISH.
  7. ALL FOUNDATION ELEMENTS SHALL BE CAST WITH A 1/2" MIN. TOLERANCE.
  8. ALL FOUNDATION ELEMENTS SHALL BE CAST WITH A 1/4" MIN. TOLERANCE.
  9. ALL FOUNDATION ELEMENTS SHALL BE CAST WITH A 1/8" MIN. TOLERANCE.
  10. ALL FOUNDATION ELEMENTS SHALL BE CAST WITH A 1/16" MIN. TOLERANCE.

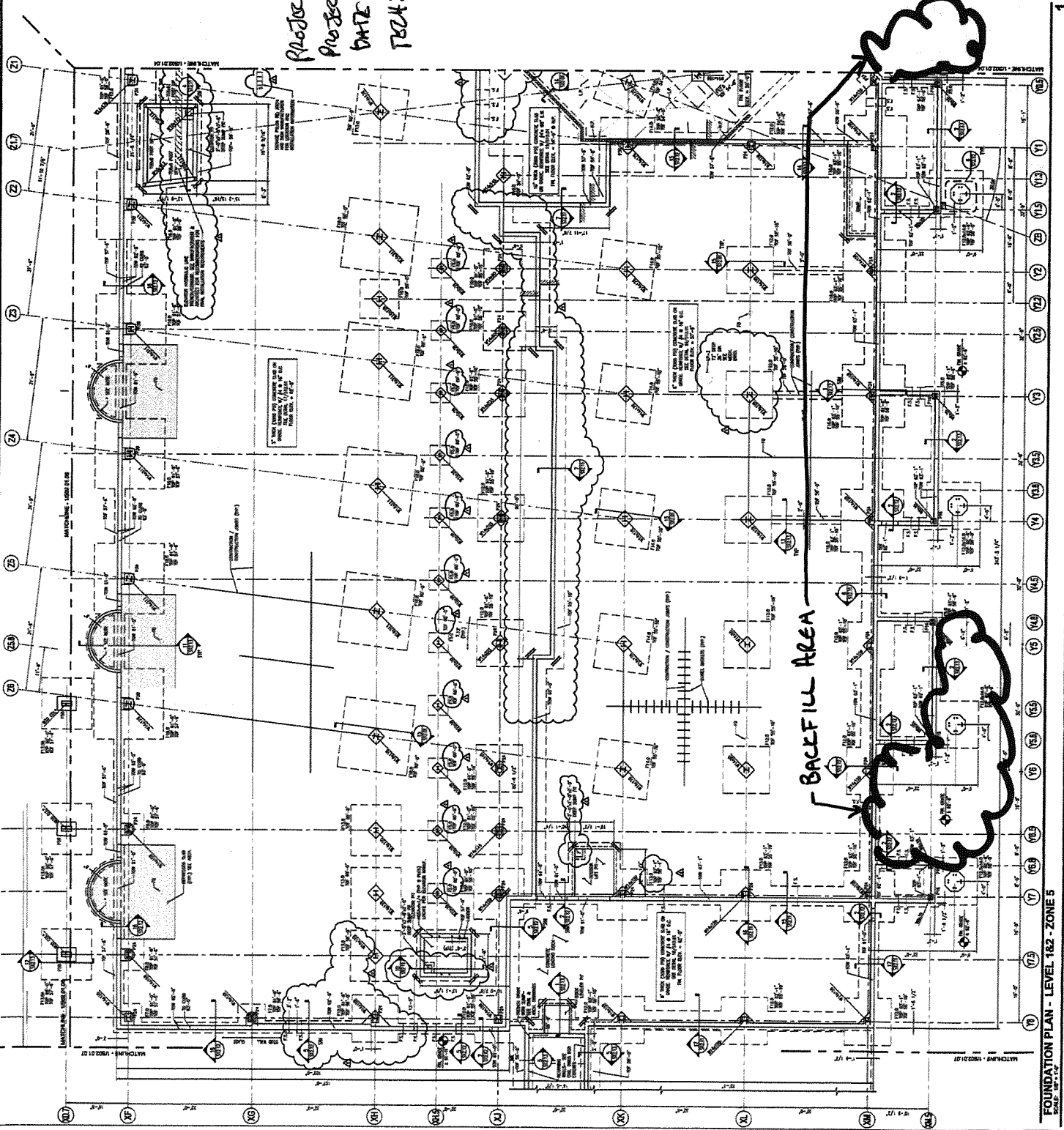

**GENERAL NOTES**

1. ALL FOUNDATION ELEMENTS SHALL BE CONCRETE UNLESS OTHERWISE NOTED.
2. ALL FOUNDATION ELEMENTS SHALL BE CAST IN PLACE CONCRETE.
3. ALL FOUNDATION ELEMENTS SHALL BE CAST ON A 4" MIN. SAND BED.
4. ALL FOUNDATION ELEMENTS SHALL BE CAST WITH A 3" MIN. AIR ENTRAINMENT.
5. ALL FOUNDATION ELEMENTS SHALL BE CAST WITH A 1" MIN. FINISH.
6. ALL FOUNDATION ELEMENTS SHALL BE CAST WITH A 1/2" MIN. TOLERANCE.
7. ALL FOUNDATION ELEMENTS SHALL BE CAST WITH A 1/4" MIN. TOLERANCE.
8. ALL FOUNDATION ELEMENTS SHALL BE CAST WITH A 1/8" MIN. TOLERANCE.
9. ALL FOUNDATION ELEMENTS SHALL BE CAST WITH A 1/16" MIN. TOLERANCE.
10. ALL FOUNDATION ELEMENTS SHALL BE CAST WITH A 1/32" MIN. TOLERANCE.

**KEY PLAN**

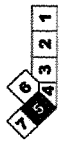

FOUNDATION PLAN - LEVEL 1&2 - ZONE 5

S02.01.05



PROJECT: PORTLAND INTERNATIONAL AIRPORT  
DATE: 05/11/11  
DRAWN BY: [Name]  
CHECKED BY: [Name]  
SCALE: AS SHOWN  
SHEET NO. C02.02

**SHEET NOTES**

1. SEE EXISTING DRAWINGS FOR DETAILS OF THE WORK.  
2. SEE GENERAL NOTES.

*PROJECT: PORTLAND JETPORT  
PROJECT #: 55714  
DATE: 5/11/11  
TRAC: MSJK*

**SIDEWALK  
SUBGRADE**

NO.	DATE	DESCRIPTION	BY	CHKD.
1	05/11/11	ISSUED FOR PERMITS	[Name]	[Name]
2	05/11/11	ISSUED FOR CONSTRUCTION	[Name]	[Name]
3	05/11/11	ISSUED FOR CONSTRUCTION	[Name]	[Name]
4	05/11/11	ISSUED FOR CONSTRUCTION	[Name]	[Name]
5	05/11/11	ISSUED FOR CONSTRUCTION	[Name]	[Name]
6	05/11/11	ISSUED FOR CONSTRUCTION	[Name]	[Name]
7	05/11/11	ISSUED FOR CONSTRUCTION	[Name]	[Name]
8	05/11/11	ISSUED FOR CONSTRUCTION	[Name]	[Name]
9	05/11/11	ISSUED FOR CONSTRUCTION	[Name]	[Name]
10	05/11/11	ISSUED FOR CONSTRUCTION	[Name]	[Name]
11	05/11/11	ISSUED FOR CONSTRUCTION	[Name]	[Name]
12	05/11/11	ISSUED FOR CONSTRUCTION	[Name]	[Name]
13	05/11/11	ISSUED FOR CONSTRUCTION	[Name]	[Name]
14	05/11/11	ISSUED FOR CONSTRUCTION	[Name]	[Name]
15	05/11/11	ISSUED FOR CONSTRUCTION	[Name]	[Name]
16	05/11/11	ISSUED FOR CONSTRUCTION	[Name]	[Name]
17	05/11/11	ISSUED FOR CONSTRUCTION	[Name]	[Name]
18	05/11/11	ISSUED FOR CONSTRUCTION	[Name]	[Name]
19	05/11/11	ISSUED FOR CONSTRUCTION	[Name]	[Name]
20	05/11/11	ISSUED FOR CONSTRUCTION	[Name]	[Name]
21	05/11/11	ISSUED FOR CONSTRUCTION	[Name]	[Name]
22	05/11/11	ISSUED FOR CONSTRUCTION	[Name]	[Name]
23	05/11/11	ISSUED FOR CONSTRUCTION	[Name]	[Name]
24	05/11/11	ISSUED FOR CONSTRUCTION	[Name]	[Name]
25	05/11/11	ISSUED FOR CONSTRUCTION	[Name]	[Name]
26	05/11/11	ISSUED FOR CONSTRUCTION	[Name]	[Name]
27	05/11/11	ISSUED FOR CONSTRUCTION	[Name]	[Name]
28	05/11/11	ISSUED FOR CONSTRUCTION	[Name]	[Name]
29	05/11/11	ISSUED FOR CONSTRUCTION	[Name]	[Name]
30	05/11/11	ISSUED FOR CONSTRUCTION	[Name]	[Name]

**GENERAL NOTES**

- ALL WORK SHALL BE IN ACCORDANCE WITH THE PORTLAND INTERNATIONAL AIRPORT CONSTRUCTION SPECIFICATIONS, 1st EDITION, 2008.
- ALL WORK SHALL BE IN ACCORDANCE WITH THE PORTLAND INTERNATIONAL AIRPORT CONSTRUCTION SPECIFICATIONS, 1st EDITION, 2008.
- ALL WORK SHALL BE IN ACCORDANCE WITH THE PORTLAND INTERNATIONAL AIRPORT CONSTRUCTION SPECIFICATIONS, 1st EDITION, 2008.
- ALL WORK SHALL BE IN ACCORDANCE WITH THE PORTLAND INTERNATIONAL AIRPORT CONSTRUCTION SPECIFICATIONS, 1st EDITION, 2008.
- ALL WORK SHALL BE IN ACCORDANCE WITH THE PORTLAND INTERNATIONAL AIRPORT CONSTRUCTION SPECIFICATIONS, 1st EDITION, 2008.
- ALL WORK SHALL BE IN ACCORDANCE WITH THE PORTLAND INTERNATIONAL AIRPORT CONSTRUCTION SPECIFICATIONS, 1st EDITION, 2008.
- ALL WORK SHALL BE IN ACCORDANCE WITH THE PORTLAND INTERNATIONAL AIRPORT CONSTRUCTION SPECIFICATIONS, 1st EDITION, 2008.
- ALL WORK SHALL BE IN ACCORDANCE WITH THE PORTLAND INTERNATIONAL AIRPORT CONSTRUCTION SPECIFICATIONS, 1st EDITION, 2008.
- ALL WORK SHALL BE IN ACCORDANCE WITH THE PORTLAND INTERNATIONAL AIRPORT CONSTRUCTION SPECIFICATIONS, 1st EDITION, 2008.
- ALL WORK SHALL BE IN ACCORDANCE WITH THE PORTLAND INTERNATIONAL AIRPORT CONSTRUCTION SPECIFICATIONS, 1st EDITION, 2008.
- ALL WORK SHALL BE IN ACCORDANCE WITH THE PORTLAND INTERNATIONAL AIRPORT CONSTRUCTION SPECIFICATIONS, 1st EDITION, 2008.
- ALL WORK SHALL BE IN ACCORDANCE WITH THE PORTLAND INTERNATIONAL AIRPORT CONSTRUCTION SPECIFICATIONS, 1st EDITION, 2008.
- ALL WORK SHALL BE IN ACCORDANCE WITH THE PORTLAND INTERNATIONAL AIRPORT CONSTRUCTION SPECIFICATIONS, 1st EDITION, 2008.
- ALL WORK SHALL BE IN ACCORDANCE WITH THE PORTLAND INTERNATIONAL AIRPORT CONSTRUCTION SPECIFICATIONS, 1st EDITION, 2008.
- ALL WORK SHALL BE IN ACCORDANCE WITH THE PORTLAND INTERNATIONAL AIRPORT CONSTRUCTION SPECIFICATIONS, 1st EDITION, 2008.

