



**SITE WORK
DAILY FIELD REPORT**

PROJECT: Terminal Enhancement at the Portland International Jetport

DATE: 5/2/2011

PROJECT LOCATION: Portland, Maine

PROJECT NO.: 0557-014

CLIENT: City of Portland

WEATHER: Partly Cloudy, cold

CONTRACTOR: Turner Construction Co.

PREVIOUS DATE ON SITE: 3/10/2011

Time on-site at 6.75 hrs, 56 mi travel, Tolls: \$0.00

13 yards lightweight, chocolate colored concrete placed in stairway and hallway in Level 2 @ line 1Y.8, from A.2 to B.3. One set of cylinders made.

3 IPDs taken on backfill behind Zone 5 along outside of building. Using the 135 pcf Proctor value given by Gorham Sand & Gravel, all 3 IPDs on new Type D material meet or exceed 95% compaction requirement. New Type D gravel sampled for lab testing. (IPDs still pass after back calculating using RWG&A lab data of 133.6 pcf)

Michael Kramlich

Prepared By

Matthew Grady

Reviewed By



Daily Observation Report

Project: <u>TERMINAL EXPANSION</u>		Time: _____ End Time _____	Mileage: _____ End _____
Project No.: <u>0557-014</u>	Tolls: <u>-</u>	✓ _____ Beg. Time _____	_____ Begin _____
Per Diem/Lodging: _____		✓ <u>6:15</u> Total Time	✓ <u>56</u> Total

Observations:

In-Place Densities Done 3 All IPDs meet Specifications Reported to GORHAM SAND + GRAVEL
 Not all IPDs meet Specifications Reported to _____

Phone Calls:

13 YARDS LIGHTWEIGHT, CHOCOLATE COLORED CONCRETE
 PLACED IN STAIRWAY/HALLWAY IN LEVEL 2 @ LINE
 14.8 FROM A.2 TO B.3. ONE SET OF CYLINDERS
 MADE.

3 IPDS TAKEN ON BACKFILL BEHIND ZONE 5
 ALONG OUTSIDE OF BUILDING. ALL 3 TESTS
 MEET 95% COMPACTION REQ. (AFTER BACK
 CALCULATING FOR NEW MATERIAL) NEW
 TYPE D GRAVEL USED + SAMPLED FOR
 PROCTOR.

Reviewed By:

Signed: 

<input type="checkbox"/> HNU _____ day	<input checked="" type="checkbox"/> Concrete Equipment	Monitoring Well Supplies
<input type="checkbox"/> Survey Level _____ day	<input checked="" type="checkbox"/> Nuc Densometer <u>1/2</u> day	_____ Bags of Bentonite _____ Locks
<input type="checkbox"/> Rebar Meter _____ day	<input type="checkbox"/> Coring Machine _____ Dia.	_____ 5 ft. Screen 2" PVC _____ Caps
_____ Bailers (Disposable)	_____ Inches Cored	_____ 10 ft. Screen 2" PVC _____ Points
<input type="checkbox"/> Water Level Ind. _____ day	<input type="checkbox"/> Generator <input type="checkbox"/> Taylor Rental	_____ 5 ft. Riser 2" PVC _____ Screw Caps
<input type="checkbox"/> Drill Rig _____ day	<input type="checkbox"/> Peristaltic Pump (note tubing used)	_____ 10 ft. Riser 2" PVC
<input type="checkbox"/> Backhoe _____ day	<input type="checkbox"/> Other	_____ Other _____

DATE: 05/11/09
BY: J. L. GENSNER
CHECKED: J. L. GENSNER
PROJECT: PORTLAND INTERNATIONAL
JETPORT
FOUNDATION PLAN - LEVEL 1B2 - ZONE 4



SCALE: 1/8" = 1'-0"
S02.01.04

SHEET NOTES

1. REFER TO SHEET S02.01.03 FOR SHEET NOTES.
2. ALL DIMENSIONS UNLESS OTHERWISE NOTED ARE IN FEET AND INCHES.
3. ALL DIMENSIONS UNLESS OTHERWISE NOTED ARE TO FACE UNLESS OTHERWISE NOTED.
4. ALL DIMENSIONS UNLESS OTHERWISE NOTED ARE TO CENTER UNLESS OTHERWISE NOTED.
5. ALL DIMENSIONS UNLESS OTHERWISE NOTED ARE TO CENTER UNLESS OTHERWISE NOTED.
6. ALL DIMENSIONS UNLESS OTHERWISE NOTED ARE TO CENTER UNLESS OTHERWISE NOTED.
7. ALL DIMENSIONS UNLESS OTHERWISE NOTED ARE TO CENTER UNLESS OTHERWISE NOTED.
8. ALL DIMENSIONS UNLESS OTHERWISE NOTED ARE TO CENTER UNLESS OTHERWISE NOTED.
9. ALL DIMENSIONS UNLESS OTHERWISE NOTED ARE TO CENTER UNLESS OTHERWISE NOTED.
10. ALL DIMENSIONS UNLESS OTHERWISE NOTED ARE TO CENTER UNLESS OTHERWISE NOTED.
11. ALL DIMENSIONS UNLESS OTHERWISE NOTED ARE TO CENTER UNLESS OTHERWISE NOTED.
12. ALL DIMENSIONS UNLESS OTHERWISE NOTED ARE TO CENTER UNLESS OTHERWISE NOTED.
13. ALL DIMENSIONS UNLESS OTHERWISE NOTED ARE TO CENTER UNLESS OTHERWISE NOTED.
14. ALL DIMENSIONS UNLESS OTHERWISE NOTED ARE TO CENTER UNLESS OTHERWISE NOTED.
15. ALL DIMENSIONS UNLESS OTHERWISE NOTED ARE TO CENTER UNLESS OTHERWISE NOTED.
16. ALL DIMENSIONS UNLESS OTHERWISE NOTED ARE TO CENTER UNLESS OTHERWISE NOTED.
17. ALL DIMENSIONS UNLESS OTHERWISE NOTED ARE TO CENTER UNLESS OTHERWISE NOTED.
18. ALL DIMENSIONS UNLESS OTHERWISE NOTED ARE TO CENTER UNLESS OTHERWISE NOTED.
19. ALL DIMENSIONS UNLESS OTHERWISE NOTED ARE TO CENTER UNLESS OTHERWISE NOTED.
20. ALL DIMENSIONS UNLESS OTHERWISE NOTED ARE TO CENTER UNLESS OTHERWISE NOTED.

TERMINAL EXPANSION
PORTLAND INT'L JETPORT
SS7-14
5/2/2011
MSK

13 yds CONC.
LIGHTWEIGHT

PIER TYPE	PIER DIMENSIONS	VERTICAL REINFORCING	YES
P1A	36" x 36"	NO	
P1B	36" x 36"	NO	
P1C	36" x 36"	NO	
P1D	36" x 36"	NO	
P1E	36" x 36"	NO	
P1F	36" x 36"	NO	
P1G	36" x 36"	NO	
P1H	36" x 36"	NO	
P1I	36" x 36"	NO	
P1J	36" x 36"	NO	
P1K	36" x 36"	NO	
P1L	36" x 36"	NO	
P1M	36" x 36"	NO	
P1N	36" x 36"	NO	
P1O	36" x 36"	NO	
P1P	36" x 36"	NO	
P1Q	36" x 36"	NO	
P1R	36" x 36"	NO	
P1S	36" x 36"	NO	
P1T	36" x 36"	NO	
P1U	36" x 36"	NO	
P1V	36" x 36"	NO	
P1W	36" x 36"	NO	
P1X	36" x 36"	NO	
P1Y	36" x 36"	NO	
P1Z	36" x 36"	NO	

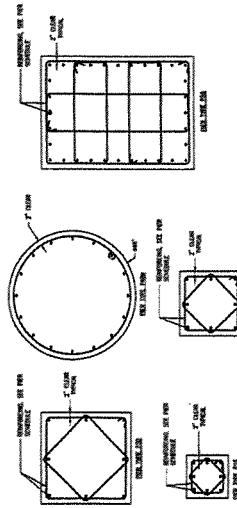

PIER SCHEDULE & DETAILS

PIER TYPE	PIER DIMENSIONS (L x W)	REINFORCING
P1A	36" x 36"	NO
P1B	36" x 36"	NO
P1C	36" x 36"	NO
P1D	36" x 36"	NO
P1E	36" x 36"	NO
P1F	36" x 36"	NO
P1G	36" x 36"	NO
P1H	36" x 36"	NO
P1I	36" x 36"	NO
P1J	36" x 36"	NO
P1K	36" x 36"	NO
P1L	36" x 36"	NO
P1M	36" x 36"	NO
P1N	36" x 36"	NO
P1O	36" x 36"	NO
P1P	36" x 36"	NO
P1Q	36" x 36"	NO
P1R	36" x 36"	NO
P1S	36" x 36"	NO
P1T	36" x 36"	NO
P1U	36" x 36"	NO
P1V	36" x 36"	NO
P1W	36" x 36"	NO
P1X	36" x 36"	NO
P1Y	36" x 36"	NO
P1Z	36" x 36"	NO

FOOTING SCHEDULE & DETAILS

FOOTING TYPE	FOOTING DIMENSIONS (L x W)	REINFORCING
F1A	36" x 36"	NO
F1B	36" x 36"	NO
F1C	36" x 36"	NO
F1D	36" x 36"	NO
F1E	36" x 36"	NO
F1F	36" x 36"	NO
F1G	36" x 36"	NO
F1H	36" x 36"	NO
F1I	36" x 36"	NO
F1J	36" x 36"	NO
F1K	36" x 36"	NO
F1L	36" x 36"	NO
F1M	36" x 36"	NO
F1N	36" x 36"	NO
F1O	36" x 36"	NO
F1P	36" x 36"	NO
F1Q	36" x 36"	NO
F1R	36" x 36"	NO
F1S	36" x 36"	NO
F1T	36" x 36"	NO
F1U	36" x 36"	NO
F1V	36" x 36"	NO
F1W	36" x 36"	NO
F1X	36" x 36"	NO
F1Y	36" x 36"	NO
F1Z	36" x 36"	NO

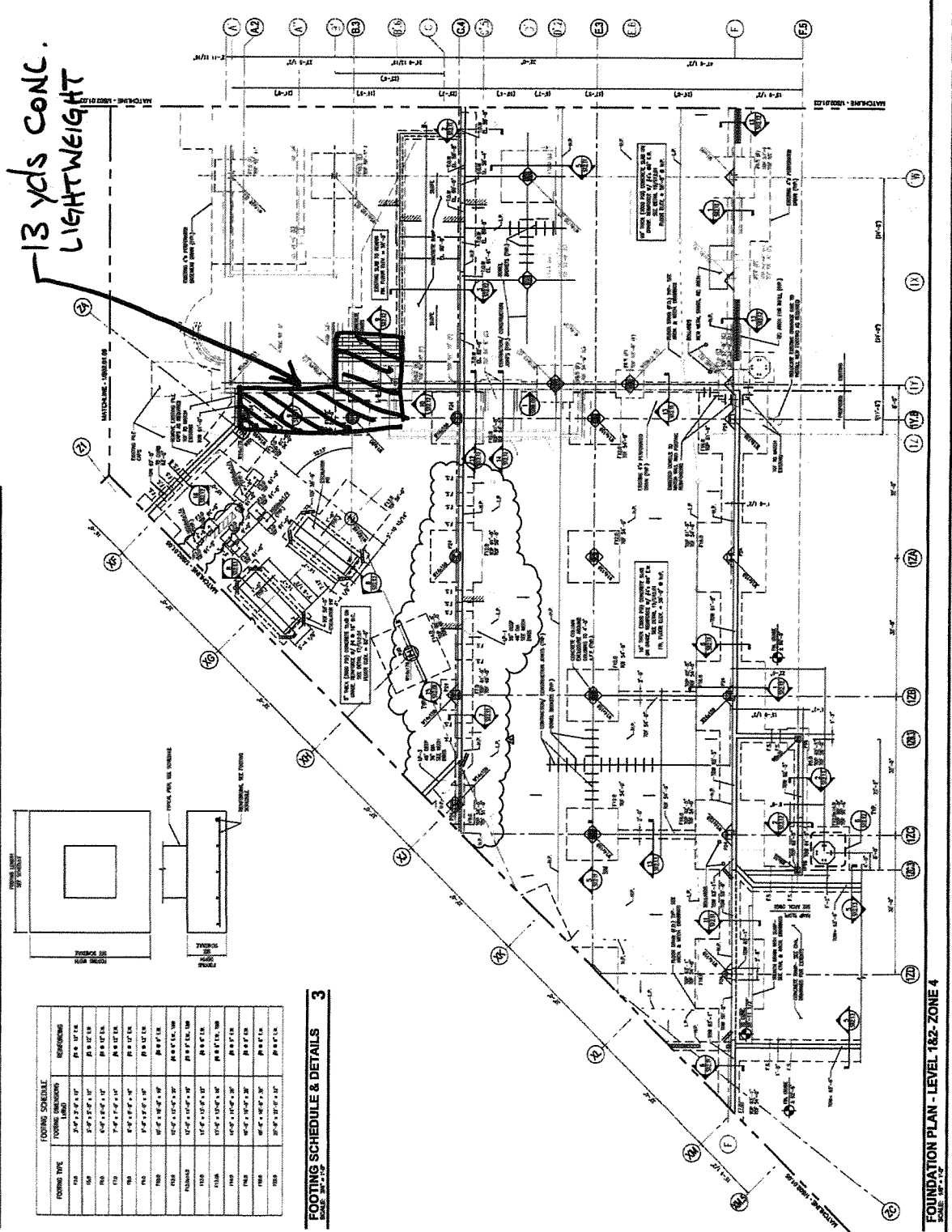

GENERAL NOTES

1. ALL DIMENSIONS UNLESS OTHERWISE NOTED ARE IN FEET AND INCHES.
2. ALL DIMENSIONS UNLESS OTHERWISE NOTED ARE TO FACE UNLESS OTHERWISE NOTED.
3. ALL DIMENSIONS UNLESS OTHERWISE NOTED ARE TO CENTER UNLESS OTHERWISE NOTED.
4. ALL DIMENSIONS UNLESS OTHERWISE NOTED ARE TO CENTER UNLESS OTHERWISE NOTED.
5. ALL DIMENSIONS UNLESS OTHERWISE NOTED ARE TO CENTER UNLESS OTHERWISE NOTED.
6. ALL DIMENSIONS UNLESS OTHERWISE NOTED ARE TO CENTER UNLESS OTHERWISE NOTED.
7. ALL DIMENSIONS UNLESS OTHERWISE NOTED ARE TO CENTER UNLESS OTHERWISE NOTED.
8. ALL DIMENSIONS UNLESS OTHERWISE NOTED ARE TO CENTER UNLESS OTHERWISE NOTED.
9. ALL DIMENSIONS UNLESS OTHERWISE NOTED ARE TO CENTER UNLESS OTHERWISE NOTED.
10. ALL DIMENSIONS UNLESS OTHERWISE NOTED ARE TO CENTER UNLESS OTHERWISE NOTED.
11. ALL DIMENSIONS UNLESS OTHERWISE NOTED ARE TO CENTER UNLESS OTHERWISE NOTED.
12. ALL DIMENSIONS UNLESS OTHERWISE NOTED ARE TO CENTER UNLESS OTHERWISE NOTED.
13. ALL DIMENSIONS UNLESS OTHERWISE NOTED ARE TO CENTER UNLESS OTHERWISE NOTED.
14. ALL DIMENSIONS UNLESS OTHERWISE NOTED ARE TO CENTER UNLESS OTHERWISE NOTED.
15. ALL DIMENSIONS UNLESS OTHERWISE NOTED ARE TO CENTER UNLESS OTHERWISE NOTED.
16. ALL DIMENSIONS UNLESS OTHERWISE NOTED ARE TO CENTER UNLESS OTHERWISE NOTED.
17. ALL DIMENSIONS UNLESS OTHERWISE NOTED ARE TO CENTER UNLESS OTHERWISE NOTED.
18. ALL DIMENSIONS UNLESS OTHERWISE NOTED ARE TO CENTER UNLESS OTHERWISE NOTED.
19. ALL DIMENSIONS UNLESS OTHERWISE NOTED ARE TO CENTER UNLESS OTHERWISE NOTED.
20. ALL DIMENSIONS UNLESS OTHERWISE NOTED ARE TO CENTER UNLESS OTHERWISE NOTED.

KEY PLAN





**SITE WORK
DAILY FIELD REPORT**

PROJECT: Terminal Enhancement at the Portland International Jetport

DATE: 5/3/2011

PROJECT LOCATION: Portland, Maine

PROJECT NO.: 0557-014

CLIENT: City of Portland

WEATHER: Partly Cloudy, cold

CONTRACTOR: Turner Construction Co.

PREVIOUS DATE ON SITE: 5/2/2011

Time on-site at 6.25 hrs, 28 mi travel, Tolls: \$0.00

6 IPDs taken on backfill materials behind Zone 5. RWG&A Lab Nos. 11175 and 11784 used. All IPDs meet or exceed 95% of their respective compactions.

MJK

Michael Kramlich

Prepared By

ME

Matthew Grady

Reviewed By

R. W. Gillespie & Associates 86 industrial Park Rd., Suite 4, Saco, ME 04072- (207)286-8008



Daily Observation Report

Project: <u>TERMINAL EXPANSION</u>	Time: _____ End Time _____	Mileage: _____ End _____
Project No.: <u>0557-014</u>	_____ Beg. Time _____	_____ Begin _____
Tolls: _____	✓ <u>6.25</u> Total Time	✓ <u>28</u> Total
Per Diem/Lodging: _____		

Observations:

In-Place Densities Done 6

All IPDs meet Specifications

Reported to GORHAM SAND + GRAVEL

Not all IPDs meet Specifications

Reported to _____

Phone Calls:

6 IPDs TAKEN ON BACKFILL ALONG OUTSIDE OF BLDG @ ZONE 5. TWO TYPE D GRAVELS USED. NEW GRAVEL PROCTOR BY GSG WAS 135.0 PCF. THIS VALUE WAS USED UNTIL RIDG+R LAB TESTING COULD BE COMPLETED. (RIDG+R VALUE = 133.6 PCF) ALL TESTS MEET 95% COMPACTION.

Reviewed By: MTR

Signed: [Signature]

<input type="checkbox"/> HNU _____ day	<input type="checkbox"/> Concrete Equipment	Monitoring Well Supplies
<input type="checkbox"/> Survey Level _____ day	<input checked="" type="checkbox"/> Nuc Densometer <u>1</u> day	_____ Bags of Bentonite _____ Locks
<input type="checkbox"/> Rebar Meter _____ day	<input type="checkbox"/> Coring Machine _____ Dia.	_____ 5 ft. Screen 2" PVC _____ Caps
_____ Bailers (Disposable)	_____ Inches Cored	_____ 10 ft. Screen 2" PVC _____ Points
<input type="checkbox"/> Water Level Ind. _____ day	<input type="checkbox"/> Generator <input type="checkbox"/> Taylor Rental	_____ 5 ft. Riser 2" PVC _____ Screw Caps
<input type="checkbox"/> Drill Rig _____ day	<input type="checkbox"/> Peristaltic Pump (note tubing used)	_____ 10 ft. Riser 2" PVC
<input type="checkbox"/> Backhoe _____ day	<input type="checkbox"/> Other	_____ Other _____



**SITE WORK
DAILY FIELD REPORT**

PROJECT: Terminal Enhancement at the Portland International Jetport

DATE: 5/6/2011

PROJECT LOCATION: Portland, Maine

PROJECT NO.: 0557-014

CLIENT: City of Portland

WEATHER: Partly Cloudy, cool

CONTRACTOR: Turner Construction Co.

PREVIOUS DATE ON SITE: 5/3/2011

Time on-site at 5 hrs, 28 mi travel, Tolls: \$0.00

2 IPDs taken on Type D gravel sidewalk sub base along NE side of upper parking lot. 3 IPDs taken on Type D gravel used to backfill behind Zone 5. 95% compaction met or exceeded on all IPDs.

MJK

Michael Kramlich

Prepared By

MJC

Matthew Grady

Reviewed By



Daily Observation Report

Project: <u>TERMINAL EXPANSION</u>	Time: _____ End Time _____	Mileage: _____ End _____
Project No.: <u>0557-014</u>	Tolls: <u>\$2</u>	Beg. Time _____ Begin _____
Per Diem/Lodging: _____	✓ <u>5</u> Total Time	✓ <u>20</u> Total

Observations:

In-Place Densities Done 5 All IPDs meet Specifications Reported to GORNAM SAND+GRAVEL

Not all IPDs meet Specifications Reported to _____

Phone Calls:

2 IPDs TAKEN ON TYPE D GRAVEL
SIDEWALK SUB BASE ALONG NE SIDE OF
UPPER LOT. 95% COMPACTION MET.

3 IPDs ON TYPE D BACKFILL BEHIND
ZONE 5. 95% COMPACTION MET.

Reviewed By: MRC

Signed:

<input type="checkbox"/> HNU _____ day	<input type="checkbox"/> Concrete Equipment	Monitoring Well Supplies	
<input type="checkbox"/> Survey Level _____ day	<input checked="" type="checkbox"/> Nuc Densometer <u>1</u> day	_____ Bags of Bentonite	_____ Locks
<input type="checkbox"/> Rebar Meter _____ day	<input type="checkbox"/> Coring Machine _____ Dia.	_____ 5 ft. Screen 2" PVC	_____ Caps
_____ Bailers (Disposable)	_____ Inches Cored	_____ 10 ft. Screen 2" PVC	_____ Points
<input type="checkbox"/> Water Level Ind. _____ day	<input type="checkbox"/> Generator <input type="checkbox"/> Taylor Rental	_____ 5 ft. Riser 2" PVC	_____ Screw Caps
<input type="checkbox"/> Drill Rig _____ day	<input type="checkbox"/> Peristaltic Pump (note tubing used)	_____ 10 ft. Riser 2" PVC	
<input type="checkbox"/> Backhoe _____ day	<input type="checkbox"/> Other	_____ Other _____	