

Daily Observation Report

Project: PORTLAND INT'L SETPORT	Time: 4 End Time	Mileage: 16971 End
Project No.: 0587-014	1:15 Beg. Time	16945 Begin
Tolls: \$2	2.75 Total Time	BL. TRUCK NO AC 26 Total
Per Diem/Lodging:		

Observations:

In-Place Densities Done _____ All IPDs meet Specifications Reported to _____
 Not all IPDs meet Specifications Reported to _____

Phone Calls:

30 yds CONC ARRIVED @ 2 PM.
 PLACEMENT LOCATION: SET BLUE LOADING RAMP
 1 SAMPLE TAKEN; LOAD NO. 2, 1 SET CYLINDERS MADE
 SAMPLED LOAD AIR CONTENT: 3.8% DISCUSSED
 W/ SHAUN WINNER W/ TURNER + LACEY FOGG W/ AMEC.
 UNSURE OF WHAT SPEC GOVERNS. FOLLOW UP W/
 SHAUN BEFORE TOMORROW'S PLACEMENT.

Reviewed By: MTR

Signed: 

<input type="checkbox"/> HNU _____ day	<input checked="" type="checkbox"/> Concrete Equipment	Monitoring Well Supplies	
<input type="checkbox"/> Survey Level _____ day	<input type="checkbox"/> Nuc Densometer _____ day	_____ Bags of Bentonite	_____ Locks
<input type="checkbox"/> Rebar Meter _____ day	<input type="checkbox"/> Coring Machine _____ Dia.	_____ 5 ft. Screen 2" PVC	_____ Caps
_____ Bailers (Disposable)	_____ Inches Cored	_____ 10 ft. Screen 2" PVC	_____ Points
<input type="checkbox"/> Water Level Ind. _____ day	<input type="checkbox"/> Generator <input type="checkbox"/> Taylor Rental	_____ 5 ft. Riser 2" PVC	_____ Screw Caps
<input type="checkbox"/> Drill Rig _____ day	<input type="checkbox"/> Peristaltic Pump (note tubing used)	_____ 10 ft. Riser 2" PVC	
<input type="checkbox"/> Backhoe _____ day	<input type="checkbox"/> Other	_____ Other _____	

PORTLAND INT'L AIRPORT
 TERMINAL EXPANSION
 PROJECT No. 0557-014
 DATE: 4/11/2011
 MSK

Portland International
 Jetport
 1301 Westwood Street
 Portland, Maine 04102

Gensler

MESE ASSOCIATES, INC.
 1000 BROADWAY
 PORTLAND, ME 04102

SHEET NOTES

1. REFER TO SHEET 182-ZONE 3 FOR THE LOCATION OF THE TERMINAL EXPANSION. THE FOUNDATION WALLS ARE TO BE CONSTRUCTED IN ACCORDANCE WITH THE REQUIREMENTS OF THE 2005 INTERNATIONAL BUILDING CODE (IBC) AND THE 2005 INTERNATIONAL MECHANICAL AND ELECTRICAL CODE (IMC).
2. THE FOUNDATION WALLS ARE TO BE CONSTRUCTED WITH A MINIMUM OF 12" THICK CONCRETE AND A MINIMUM OF 4" REINFORCING BARS PER FOOT.
3. THE FOUNDATION WALLS ARE TO BE CONSTRUCTED WITH A MINIMUM OF 12" THICK CONCRETE AND A MINIMUM OF 4" REINFORCING BARS PER FOOT.
4. THE FOUNDATION WALLS ARE TO BE CONSTRUCTED WITH A MINIMUM OF 12" THICK CONCRETE AND A MINIMUM OF 4" REINFORCING BARS PER FOOT.
5. THE FOUNDATION WALLS ARE TO BE CONSTRUCTED WITH A MINIMUM OF 12" THICK CONCRETE AND A MINIMUM OF 4" REINFORCING BARS PER FOOT.
6. THE FOUNDATION WALLS ARE TO BE CONSTRUCTED WITH A MINIMUM OF 12" THICK CONCRETE AND A MINIMUM OF 4" REINFORCING BARS PER FOOT.
7. THE FOUNDATION WALLS ARE TO BE CONSTRUCTED WITH A MINIMUM OF 12" THICK CONCRETE AND A MINIMUM OF 4" REINFORCING BARS PER FOOT.
8. THE FOUNDATION WALLS ARE TO BE CONSTRUCTED WITH A MINIMUM OF 12" THICK CONCRETE AND A MINIMUM OF 4" REINFORCING BARS PER FOOT.
9. THE FOUNDATION WALLS ARE TO BE CONSTRUCTED WITH A MINIMUM OF 12" THICK CONCRETE AND A MINIMUM OF 4" REINFORCING BARS PER FOOT.
10. THE FOUNDATION WALLS ARE TO BE CONSTRUCTED WITH A MINIMUM OF 12" THICK CONCRETE AND A MINIMUM OF 4" REINFORCING BARS PER FOOT.

GENERAL NOTES

1. ALL FOUNDATION WALLS SHALL BE CONSTRUCTED IN ACCORDANCE WITH THE REQUIREMENTS OF THE 2005 INTERNATIONAL BUILDING CODE (IBC) AND THE 2005 INTERNATIONAL MECHANICAL AND ELECTRICAL CODE (IMC).
2. THE FOUNDATION WALLS ARE TO BE CONSTRUCTED WITH A MINIMUM OF 12" THICK CONCRETE AND A MINIMUM OF 4" REINFORCING BARS PER FOOT.
3. THE FOUNDATION WALLS ARE TO BE CONSTRUCTED WITH A MINIMUM OF 12" THICK CONCRETE AND A MINIMUM OF 4" REINFORCING BARS PER FOOT.
4. THE FOUNDATION WALLS ARE TO BE CONSTRUCTED WITH A MINIMUM OF 12" THICK CONCRETE AND A MINIMUM OF 4" REINFORCING BARS PER FOOT.
5. THE FOUNDATION WALLS ARE TO BE CONSTRUCTED WITH A MINIMUM OF 12" THICK CONCRETE AND A MINIMUM OF 4" REINFORCING BARS PER FOOT.
6. THE FOUNDATION WALLS ARE TO BE CONSTRUCTED WITH A MINIMUM OF 12" THICK CONCRETE AND A MINIMUM OF 4" REINFORCING BARS PER FOOT.
7. THE FOUNDATION WALLS ARE TO BE CONSTRUCTED WITH A MINIMUM OF 12" THICK CONCRETE AND A MINIMUM OF 4" REINFORCING BARS PER FOOT.
8. THE FOUNDATION WALLS ARE TO BE CONSTRUCTED WITH A MINIMUM OF 12" THICK CONCRETE AND A MINIMUM OF 4" REINFORCING BARS PER FOOT.
9. THE FOUNDATION WALLS ARE TO BE CONSTRUCTED WITH A MINIMUM OF 12" THICK CONCRETE AND A MINIMUM OF 4" REINFORCING BARS PER FOOT.
10. THE FOUNDATION WALLS ARE TO BE CONSTRUCTED WITH A MINIMUM OF 12" THICK CONCRETE AND A MINIMUM OF 4" REINFORCING BARS PER FOOT.

KEY PLAN

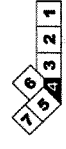

Scale: 1/8" = 1'-0"
 S02.01.04

PIER TYPE	PIER DIMENSIONS	PIER SCHEDULE	VERTICAL REINFORCING	YES
P1A	18" x 18"	BY PER FOUNDATION SCHEDULE	BY PER FOUNDATION SCHEDULE	BY PER FOUNDATION SCHEDULE
P1B	24" x 24"	BY PER FOUNDATION SCHEDULE	BY PER FOUNDATION SCHEDULE	BY PER FOUNDATION SCHEDULE
P1C	30" x 30"	BY PER FOUNDATION SCHEDULE	BY PER FOUNDATION SCHEDULE	BY PER FOUNDATION SCHEDULE
P1D	36" x 36"	BY PER FOUNDATION SCHEDULE	BY PER FOUNDATION SCHEDULE	BY PER FOUNDATION SCHEDULE
P1E	42" x 42"	BY PER FOUNDATION SCHEDULE	BY PER FOUNDATION SCHEDULE	BY PER FOUNDATION SCHEDULE
P1F	48" x 48"	BY PER FOUNDATION SCHEDULE	BY PER FOUNDATION SCHEDULE	BY PER FOUNDATION SCHEDULE
P1G	54" x 54"	BY PER FOUNDATION SCHEDULE	BY PER FOUNDATION SCHEDULE	BY PER FOUNDATION SCHEDULE
P1H	60" x 60"	BY PER FOUNDATION SCHEDULE	BY PER FOUNDATION SCHEDULE	BY PER FOUNDATION SCHEDULE
P1I	66" x 66"	BY PER FOUNDATION SCHEDULE	BY PER FOUNDATION SCHEDULE	BY PER FOUNDATION SCHEDULE
P1J	72" x 72"	BY PER FOUNDATION SCHEDULE	BY PER FOUNDATION SCHEDULE	BY PER FOUNDATION SCHEDULE

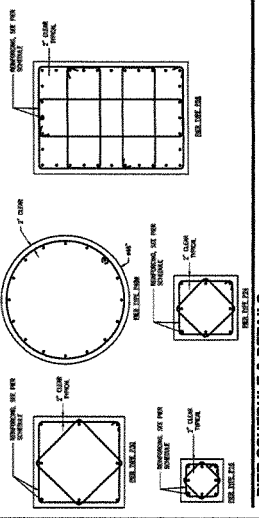

PIER SCHEDULE & DETAILS

FOOTING TYPE	FOOTING DIMENSIONS	REINFORCING
F1A	24" x 24" x 12"	4#4 @ 12" O.C.
F1B	30" x 30" x 12"	4#4 @ 12" O.C.
F1C	36" x 36" x 12"	4#4 @ 12" O.C.
F1D	42" x 42" x 12"	4#4 @ 12" O.C.
F1E	48" x 48" x 12"	4#4 @ 12" O.C.
F1F	54" x 54" x 12"	4#4 @ 12" O.C.
F1G	60" x 60" x 12"	4#4 @ 12" O.C.
F1H	66" x 66" x 12"	4#4 @ 12" O.C.
F1I	72" x 72" x 12"	4#4 @ 12" O.C.
F1J	78" x 78" x 12"	4#4 @ 12" O.C.
F1K	84" x 84" x 12"	4#4 @ 12" O.C.
F1L	90" x 90" x 12"	4#4 @ 12" O.C.
F1M	96" x 96" x 12"	4#4 @ 12" O.C.
F1N	102" x 102" x 12"	4#4 @ 12" O.C.
F1O	108" x 108" x 12"	4#4 @ 12" O.C.
F1P	114" x 114" x 12"	4#4 @ 12" O.C.
F1Q	120" x 120" x 12"	4#4 @ 12" O.C.

FOOTING SCHEDULE & DETAILS

30 yds 5000 PSI
 CONC. PLACED AS
 FOUNDATION
 WALLS

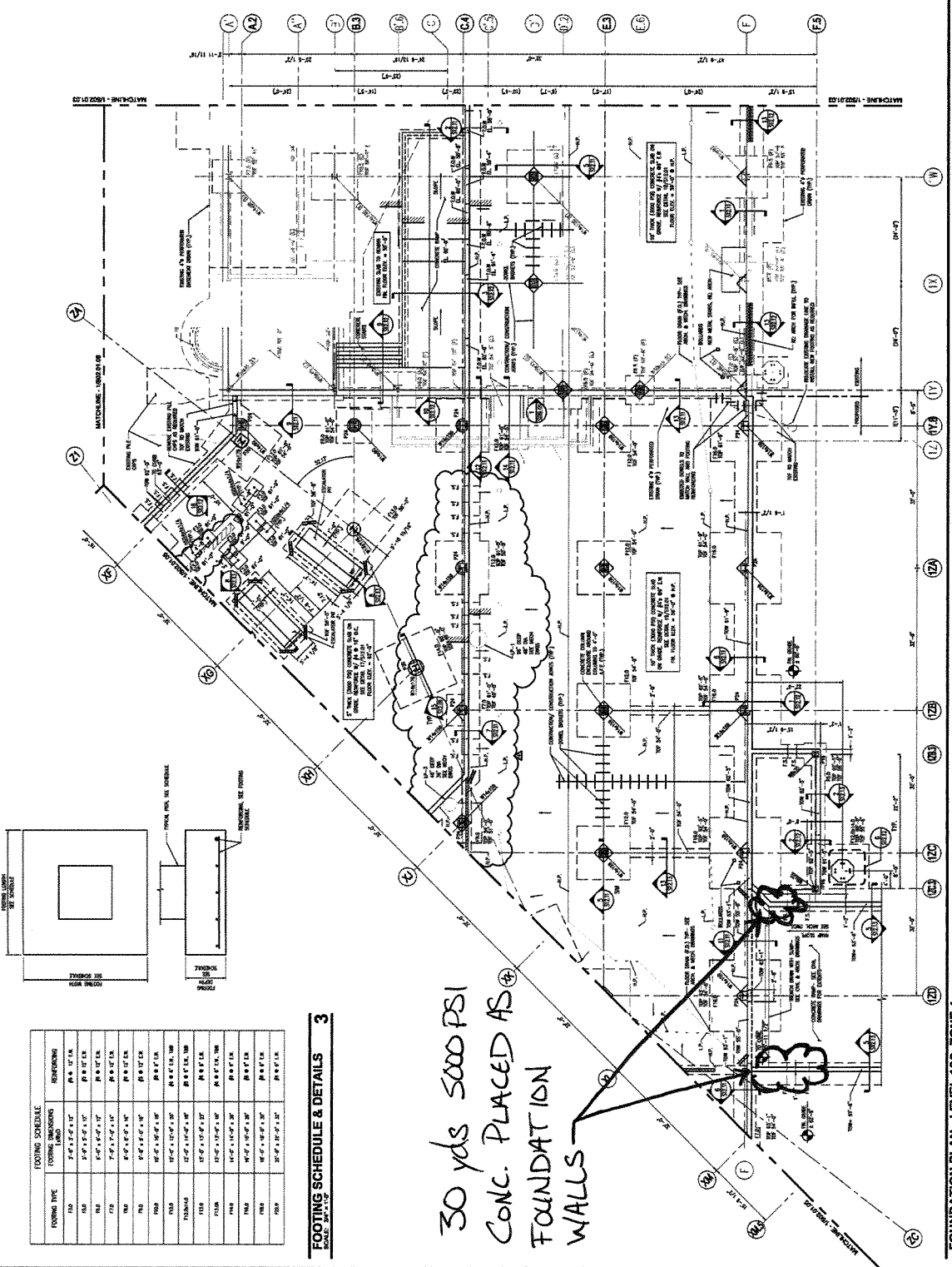

FOUNDATION PLAN - LEVEL 1&2 - ZONE 4



Daily Observation Report

Project: <u>TERMINAL EXPANSION</u>	Time: _____	End Time _____	Mileage: _____	End _____
Project No.: <u>0557-014</u>	Tolls: <u>\$2</u>	_____	_____	_____
Per Diem/Lodging: _____	_____	Beg. Time _____	_____	Begin _____
		✓ <u>3</u> Total Time	_____	_____
			✓ <u>27</u> Total	

Observations:

In-Place Densities Done _____ All IPDs meet Specifications Reported to _____
 Not all IPDs meet Specifications Reported to _____

Phone Calls:

10 yds OF CONC. PLACED AS
 FND. WALLS @ JET BLUE RAMP
 (5000 PSI CONC ~ 3000 PSI REQ. D)
 %AIR: 4.3% DISCUSSED W/ SHAUN
 WINNER; TTCO + LACEY FEGG; AMEC.
 NO ACTION TAKEN.
 1 SET CYL MADE

Reviewed By: MKG

Signed:

<input type="checkbox"/> HNU _____ day	<input checked="" type="checkbox"/> Concrete Equipment	Monitoring Well Supplies	
<input type="checkbox"/> Survey Level _____ day	<input type="checkbox"/> Nuc Densometer _____ day	_____ Bags of Bentonite	_____ Locks
<input type="checkbox"/> Rebar Meter _____ day	<input type="checkbox"/> Coring Machine _____ Dia.	_____ 5 ft. Screen 2" PVC	_____ Caps
_____ Bailers (Disposable)	_____ Inches Cored	_____ 10 ft. Screen 2" PVC	_____ Points
<input type="checkbox"/> Water Level Ind. _____ day	<input type="checkbox"/> Generator <input type="checkbox"/> Taylor Rental	_____ 5 ft. Riser 2" PVC	_____ Screw Caps
<input type="checkbox"/> Drill Rig _____ day	<input type="checkbox"/> Peristaltic Pump (note tubing used)	_____ 10 ft. Riser 2" PVC	
<input type="checkbox"/> Backhoe _____ day	<input type="checkbox"/> Other _____	_____ Other _____	

PORTLAND INT'L JETPORT
 TERMINAL EXPANSION
 PROJECT No.: OSS7-014
 DATE: 4/12/2011
 MSK

Portland International
 Jetport
 1001 Westbrook Street
 Portland, Maine 04102

Gensler
 1001 Westbrook Street
 Portland, Maine 04102

meaf ASSOCIATES, INC.
 1001 Westbrook Street
 Portland, Maine 04102

SHEET NOTES

1. ALL DIMENSIONS UNLESS OTHERWISE NOTED ARE IN FEET AND INCHES.
2. ALL DIMENSIONS UNLESS OTHERWISE NOTED ARE IN FEET AND INCHES.
3. ALL DIMENSIONS UNLESS OTHERWISE NOTED ARE IN FEET AND INCHES.
4. ALL DIMENSIONS UNLESS OTHERWISE NOTED ARE IN FEET AND INCHES.
5. ALL DIMENSIONS UNLESS OTHERWISE NOTED ARE IN FEET AND INCHES.
6. ALL DIMENSIONS UNLESS OTHERWISE NOTED ARE IN FEET AND INCHES.
7. ALL DIMENSIONS UNLESS OTHERWISE NOTED ARE IN FEET AND INCHES.
8. ALL DIMENSIONS UNLESS OTHERWISE NOTED ARE IN FEET AND INCHES.
9. ALL DIMENSIONS UNLESS OTHERWISE NOTED ARE IN FEET AND INCHES.
10. ALL DIMENSIONS UNLESS OTHERWISE NOTED ARE IN FEET AND INCHES.
11. ALL DIMENSIONS UNLESS OTHERWISE NOTED ARE IN FEET AND INCHES.
12. ALL DIMENSIONS UNLESS OTHERWISE NOTED ARE IN FEET AND INCHES.
13. ALL DIMENSIONS UNLESS OTHERWISE NOTED ARE IN FEET AND INCHES.
14. ALL DIMENSIONS UNLESS OTHERWISE NOTED ARE IN FEET AND INCHES.
15. ALL DIMENSIONS UNLESS OTHERWISE NOTED ARE IN FEET AND INCHES.
16. ALL DIMENSIONS UNLESS OTHERWISE NOTED ARE IN FEET AND INCHES.
17. ALL DIMENSIONS UNLESS OTHERWISE NOTED ARE IN FEET AND INCHES.
18. ALL DIMENSIONS UNLESS OTHERWISE NOTED ARE IN FEET AND INCHES.
19. ALL DIMENSIONS UNLESS OTHERWISE NOTED ARE IN FEET AND INCHES.
20. ALL DIMENSIONS UNLESS OTHERWISE NOTED ARE IN FEET AND INCHES.

GENERAL NOTES

1. ALL DIMENSIONS UNLESS OTHERWISE NOTED ARE IN FEET AND INCHES.
2. ALL DIMENSIONS UNLESS OTHERWISE NOTED ARE IN FEET AND INCHES.
3. ALL DIMENSIONS UNLESS OTHERWISE NOTED ARE IN FEET AND INCHES.
4. ALL DIMENSIONS UNLESS OTHERWISE NOTED ARE IN FEET AND INCHES.
5. ALL DIMENSIONS UNLESS OTHERWISE NOTED ARE IN FEET AND INCHES.
6. ALL DIMENSIONS UNLESS OTHERWISE NOTED ARE IN FEET AND INCHES.
7. ALL DIMENSIONS UNLESS OTHERWISE NOTED ARE IN FEET AND INCHES.
8. ALL DIMENSIONS UNLESS OTHERWISE NOTED ARE IN FEET AND INCHES.
9. ALL DIMENSIONS UNLESS OTHERWISE NOTED ARE IN FEET AND INCHES.
10. ALL DIMENSIONS UNLESS OTHERWISE NOTED ARE IN FEET AND INCHES.
11. ALL DIMENSIONS UNLESS OTHERWISE NOTED ARE IN FEET AND INCHES.
12. ALL DIMENSIONS UNLESS OTHERWISE NOTED ARE IN FEET AND INCHES.
13. ALL DIMENSIONS UNLESS OTHERWISE NOTED ARE IN FEET AND INCHES.
14. ALL DIMENSIONS UNLESS OTHERWISE NOTED ARE IN FEET AND INCHES.
15. ALL DIMENSIONS UNLESS OTHERWISE NOTED ARE IN FEET AND INCHES.
16. ALL DIMENSIONS UNLESS OTHERWISE NOTED ARE IN FEET AND INCHES.
17. ALL DIMENSIONS UNLESS OTHERWISE NOTED ARE IN FEET AND INCHES.
18. ALL DIMENSIONS UNLESS OTHERWISE NOTED ARE IN FEET AND INCHES.
19. ALL DIMENSIONS UNLESS OTHERWISE NOTED ARE IN FEET AND INCHES.
20. ALL DIMENSIONS UNLESS OTHERWISE NOTED ARE IN FEET AND INCHES.

KEY PLAN

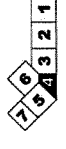

S02.01.04

PIER SCHEDULE & DETAILS

SCALE: 3/8" = 1'-0"

PIER TYPE	PIER DIMENSIONS	VERTICAL REINFORCEMENT	YES
P1A	14' x 14'	10 #5 @ 12" O.C.	YES
P1B	14' x 14'	10 #5 @ 12" O.C.	YES
P1C	14' x 14'	10 #5 @ 12" O.C.	YES
P1D	14' x 14'	10 #5 @ 12" O.C.	YES
P1E	14' x 14'	10 #5 @ 12" O.C.	YES
P1F	14' x 14'	10 #5 @ 12" O.C.	YES
P1G	14' x 14'	10 #5 @ 12" O.C.	YES
P1H	14' x 14'	10 #5 @ 12" O.C.	YES
P1I	14' x 14'	10 #5 @ 12" O.C.	YES
P1J	14' x 14'	10 #5 @ 12" O.C.	YES
P1K	14' x 14'	10 #5 @ 12" O.C.	YES
P1L	14' x 14'	10 #5 @ 12" O.C.	YES
P1M	14' x 14'	10 #5 @ 12" O.C.	YES
P1N	14' x 14'	10 #5 @ 12" O.C.	YES
P1O	14' x 14'	10 #5 @ 12" O.C.	YES
P1P	14' x 14'	10 #5 @ 12" O.C.	YES
P1Q	14' x 14'	10 #5 @ 12" O.C.	YES
P1R	14' x 14'	10 #5 @ 12" O.C.	YES
P1S	14' x 14'	10 #5 @ 12" O.C.	YES
P1T	14' x 14'	10 #5 @ 12" O.C.	YES
P1U	14' x 14'	10 #5 @ 12" O.C.	YES
P1V	14' x 14'	10 #5 @ 12" O.C.	YES
P1W	14' x 14'	10 #5 @ 12" O.C.	YES
P1X	14' x 14'	10 #5 @ 12" O.C.	YES
P1Y	14' x 14'	10 #5 @ 12" O.C.	YES
P1Z	14' x 14'	10 #5 @ 12" O.C.	YES

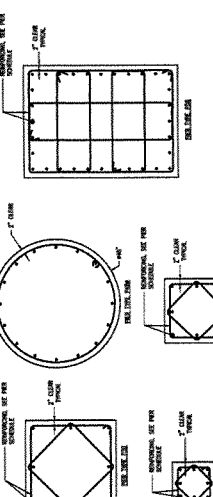

FOOTING TYPE	FOOTING DIMENSIONS	REINFORCEMENT
F1A	14' x 14'	10 #5 @ 12" O.C.
F1B	14' x 14'	10 #5 @ 12" O.C.
F1C	14' x 14'	10 #5 @ 12" O.C.
F1D	14' x 14'	10 #5 @ 12" O.C.
F1E	14' x 14'	10 #5 @ 12" O.C.
F1F	14' x 14'	10 #5 @ 12" O.C.
F1G	14' x 14'	10 #5 @ 12" O.C.
F1H	14' x 14'	10 #5 @ 12" O.C.
F1I	14' x 14'	10 #5 @ 12" O.C.
F1J	14' x 14'	10 #5 @ 12" O.C.
F1K	14' x 14'	10 #5 @ 12" O.C.
F1L	14' x 14'	10 #5 @ 12" O.C.
F1M	14' x 14'	10 #5 @ 12" O.C.
F1N	14' x 14'	10 #5 @ 12" O.C.
F1O	14' x 14'	10 #5 @ 12" O.C.
F1P	14' x 14'	10 #5 @ 12" O.C.
F1Q	14' x 14'	10 #5 @ 12" O.C.
F1R	14' x 14'	10 #5 @ 12" O.C.
F1S	14' x 14'	10 #5 @ 12" O.C.
F1T	14' x 14'	10 #5 @ 12" O.C.
F1U	14' x 14'	10 #5 @ 12" O.C.
F1V	14' x 14'	10 #5 @ 12" O.C.
F1W	14' x 14'	10 #5 @ 12" O.C.
F1X	14' x 14'	10 #5 @ 12" O.C.
F1Y	14' x 14'	10 #5 @ 12" O.C.
F1Z	14' x 14'	10 #5 @ 12" O.C.

FOOTING SCHEDULE & DETAILS

SCALE: 3/8" = 1'-0"

10 yds 5000 PSI
 CONC. PLACED AS
 FOUNDATION WALLS

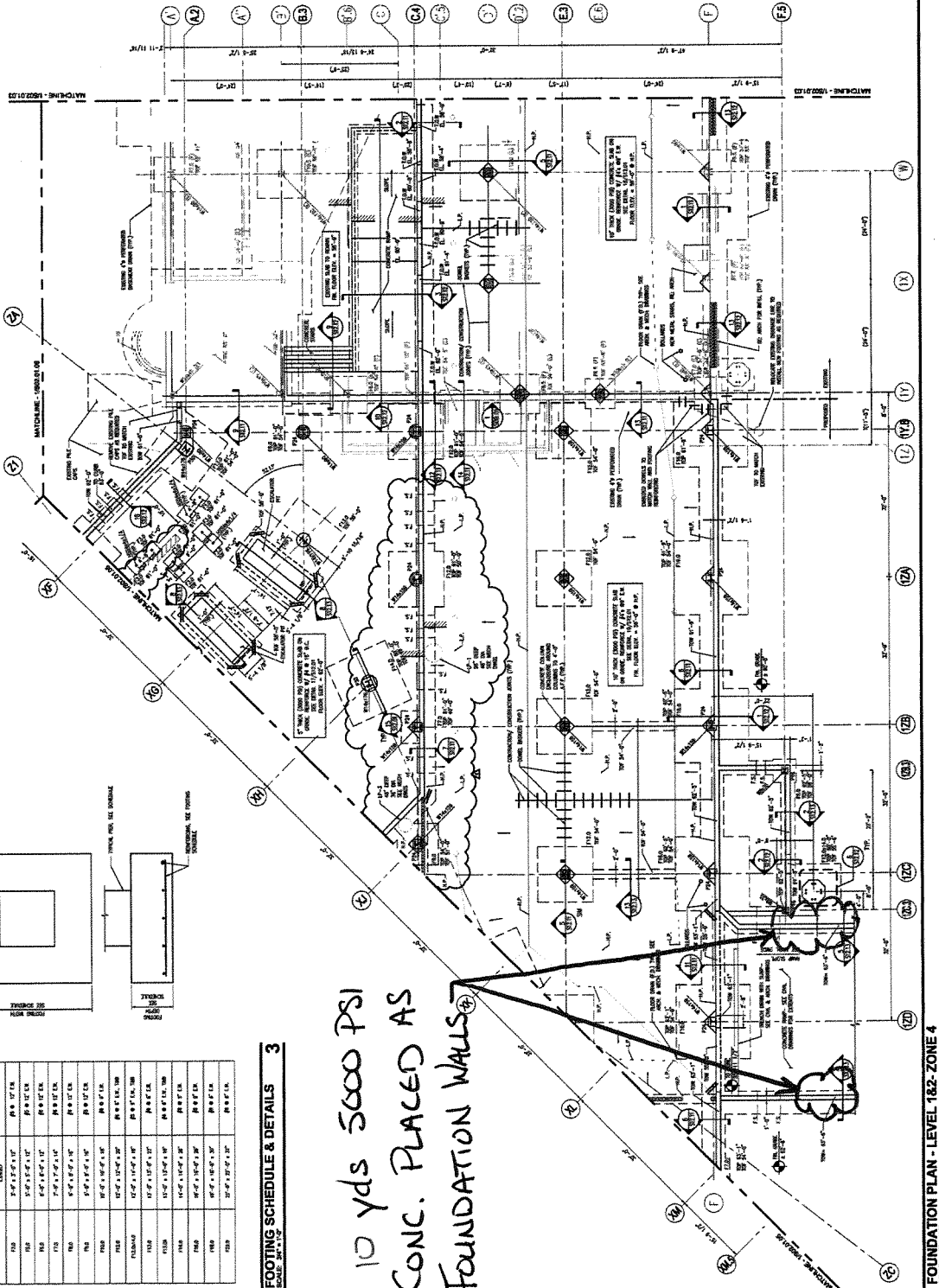

FOUNDATION PLAN - LEVEL 1&2 - ZONE 4

SCALE: 1/8" = 1'-0"



Daily Observation Report

Project: <u>TERMINAL EXPANSION</u>	Time: _____	End Time _____	Mileage: _____	End _____
Project No.: <u>0557-014</u>	Tolls: <u>\$1</u>	Beg. Time _____	Begin _____	
Per Diem/Lodging: _____	<input checked="" type="checkbox"/> <u>Y</u>	Total Time _____	<input checked="" type="checkbox"/> <u>26</u>	Total _____

Observations:

In-Place Densities Done 9

All IPDs meet Specifications

Reported to GORHAM SAND + GRAVEL

Not all IPDs meet Specifications

Reported to _____

Phone Calls:

ARRIVED @ 7:45 ~> 1st TEST 11 AN
 3" MINUS GRAVEL FROM WINSLOW
 ROAD PIT USED TO BACKFILL
 END. WALLS @ JET BLUE RAMP.
 ALL TESTS PASS 95% SPEC.

INSIDE WALLS TO BE BACKFILLED 4/15

Reviewed By: MTF

Signed: 

- | | |
|---|---|
| <input type="checkbox"/> HNU _____ day | <input type="checkbox"/> Concrete Equipment |
| <input type="checkbox"/> Survey Level _____ day | <input checked="" type="checkbox"/> Nuc Densometer <u>1</u> day |
| <input type="checkbox"/> Rebar Meter _____ day | <input type="checkbox"/> Coring Machine _____ Dia. |
| _____ Bailers (Disposable) | _____ Inches Cored |
| <input type="checkbox"/> Water Level Ind. _____ day | <input type="checkbox"/> Generator <input type="checkbox"/> Taylor Rental |
| <input type="checkbox"/> Drill Rig _____ day | <input type="checkbox"/> Peristaltic Pump (note tubing used) |
| <input type="checkbox"/> Backhoe _____ day | <input type="checkbox"/> Other _____ |

Monitoring Well Supplies

- | | |
|----------------------------|------------------|
| _____ Bags of Bentonite | _____ Locks |
| _____ 5 ft. Screen 2" PVC | _____ Caps |
| _____ 10 ft. Screen 2" PVC | _____ Points |
| _____ 5 ft. Riser 2" PVC | _____ Screw Caps |
| _____ 10 ft. Riser 2" PVC | |
| _____ Other _____ | |



4/15/2011

Daily Observation Report

Project: <u>TERMINAL EXPANSION</u>	Time: _____	End Time _____	Mileage: _____	End _____
Project No.: <u>0557-014</u>	Tolls: <input checked="" type="checkbox"/> \$ <u>2</u>	Beg. Time _____	Begin _____	
Per Diem/Lodging: _____	<input checked="" type="checkbox"/> <u>5</u>	Total Time _____	<input checked="" type="checkbox"/> <u>26</u>	Total _____

Observations:

In-Place Densities Done 9

All IPDs meet Specifications

Reported to ERIK HAN SAND & GRAVEL

Not all IPDs meet Specifications

Reported to _____

Phone Calls:

COMPLETED BACKFILL OF FND WALLS @
 SET BLUE RAMP. SAME 3" MATERIAL USED.
 ALL TESTS * MEET OR EXCEED 95% SPEC.

*#7 NOT TESTED DUE TO INSUFFICIENT
 LIFT THICKNESS

Reviewed By: MTB

Signed: 

- | | |
|---|---|
| <input type="checkbox"/> HNU _____ day | <input type="checkbox"/> Concrete Equipment |
| <input type="checkbox"/> Survey Level _____ day | <input checked="" type="checkbox"/> Nuc Densometer <u>1</u> day |
| <input type="checkbox"/> Rebar Meter _____ day | <input type="checkbox"/> Coring Machine _____ Dia. |
| _____ Bailers (Disposable) | _____ Inches Cored |
| <input type="checkbox"/> Water Level Ind. _____ day | <input type="checkbox"/> Generator <input type="checkbox"/> Taylor Rental |
| <input type="checkbox"/> Drill Rig _____ day | <input type="checkbox"/> Peristaltic Pump (note tubing used) |
| <input type="checkbox"/> Backhoe _____ day | <input type="checkbox"/> Other _____ |

Monitoring Well Supplies

- | | |
|----------------------------|------------------|
| _____ Bags of Bentonite | _____ Locks |
| _____ 5 ft. Screen 2" PVC | _____ Caps |
| _____ 10 ft. Screen 2" PVC | _____ Points |
| _____ 5 ft. Riser 2" PVC | _____ Screw Caps |
| _____ 10 ft. Riser 2" PVC | |
| _____ Other _____ | |