

ARCHITECTURE 144 Fore Street P.O. Box 618  
 Portland, Maine 04104  
 Tel: (207) 772-3846  
 Fax: (207) 772-1070  
 www.srmlinc.com

ENGINEERING  
 PLANNING  
 INTERIORS  
 ENERGY

PROJECT NO. 17033  
 PROJECT MGR JCDRAWN  
 Author  
 DFL  
 AE OF RECORD  
 Checker

|                | Gross Square Feet | SF/Occupant | Public Occupants | Employee Occupants | Total | Existing Fixtures Required | Existing Fixtures | Existing Fixtures Less Proposed Removals |
|----------------|-------------------|-------------|------------------|--------------------|-------|----------------------------|-------------------|--|
| Street Level   | 81,100            |             |                  |                    |       |                            |                   |  |
| Restaurant     | 1,700             | 15          | 114              |                    |       |                            |                   |  |
| Baggage Claim  | 11,400            | 20          | 570              |                    |       |                            |                   |  |
| Concourse      | 8,000             | 300         |                  | 27                 |       |                            |                   |  |
| Business       | 26,500            | 100         | 265              |                    |       |                            |                   |  |
|                | 33,500            | 100         |                  | 335                |       |                            |                   |  |
| Upper Level    | 86,200            |             |                  |                    |       |                            |                   |  |
| Mercantile     | 2,900             | 60          | 49               |                    |       |                            |                   |  |
| Concourse      | 10,600            | 100         | 106              |                    |       |                            |                   |  |
| Waiting        | 15,500            | 15          | 1,034            |                    |       |                            |                   |  |
| Business       | 44,900            | 100         |                  | 449                |       |                            |                   |  |
| Storage        | 1,100             | 300         |                  | 4                  |       |                            |                   |  |
| Warehouse      | 11,200            | 500         |                  | 23                 |       |                            |                   |  |
| Penthouses     |                   |             |                  |                    |       |                            |                   |  |
| Machine Rooms  | 11,400            | 300         |                  | 38                 |       |                            |                   |  |
| <b>Total</b>   | <b>167,300</b>    |             | <b>2,139</b>     | <b>878</b>         |       |                            |                   |  |
| <b>Males</b>   |                   |             |                  |                    |       |                            |                   |  |
| Water Closets  |                   |             | 5                | 5                  | 9     | 15                         | 15                | OK                                       |
| Urinals        |                   |             | 6                | 4                  | 10    | 17                         | 16                | OK                                       |
| Lavatories     |                   |             | 6                | 6                  | 11    | 18                         | 17                | OK                                       |
| <b>Females</b> |                   |             |                  |                    |       |                            |                   |  |
| Water Closets  |                   |             | 14               | 12                 | 26    | 23                         | 23                | OK                                       |
| Lavatories     |                   |             | 8                | 7                  | 15    | 20                         | 19                | OK                                       |

- Notes:
- Employee and public occupant loads were calculated utilizing 2009 IBC Table 1004.1.1. Spaces classified as "business", "warehouse", "airport terminal baggage handling", and "storage" were identified as employee areas. Spaces classified as "airport terminal concourse", "airport terminal waiting", "air port terminal baggage claim", "mercantile", and "assembly" (restaurant) were identified as public.
  - Fixture requirements were calculated utilizing 2015 Uniform Plumbing Code Table 422.1 under "B Business occupancy" for employee occupants and "A-3 Assembly occupancy" for public occupants.
  - The 2015 UPC fixture requirements apply to new structures, additions, and renovated facilities which involve a change in use or occupant load. Reference to Table 422.1 is made to demonstrate that the proposed removal of one urinal/one sink serving males and one sink serving females will not result in a change in compliance against the current code.

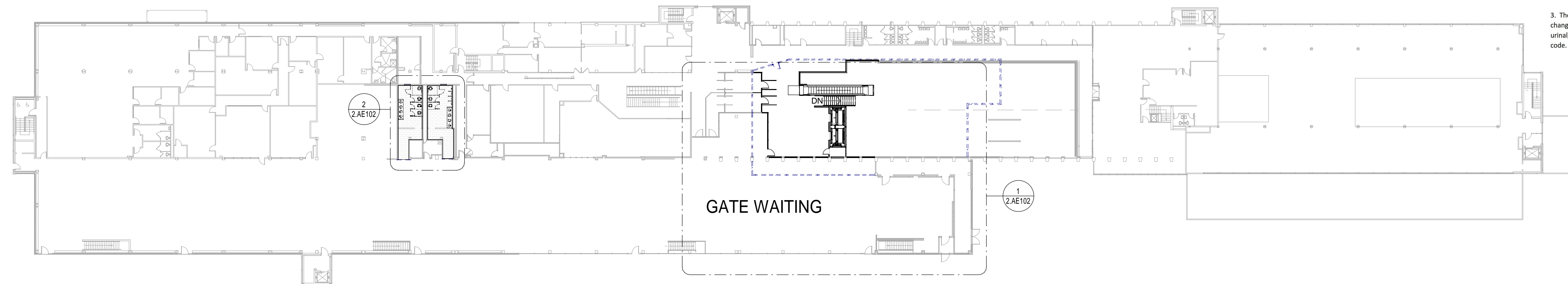

2 2ND FLOOR - FACILITY PLAN  
 1/32" = 1'-0"

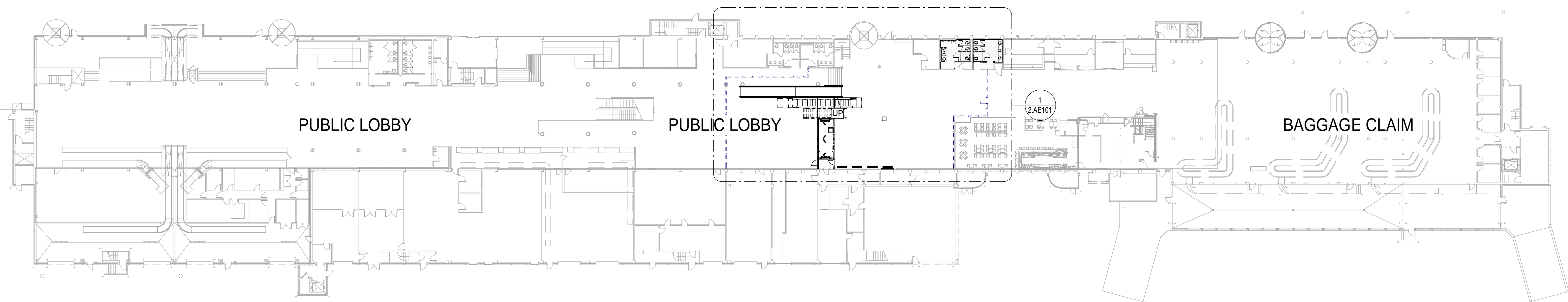

1 1ST FLOOR - FACILITY PLAN  
 1/32" = 1'-0"

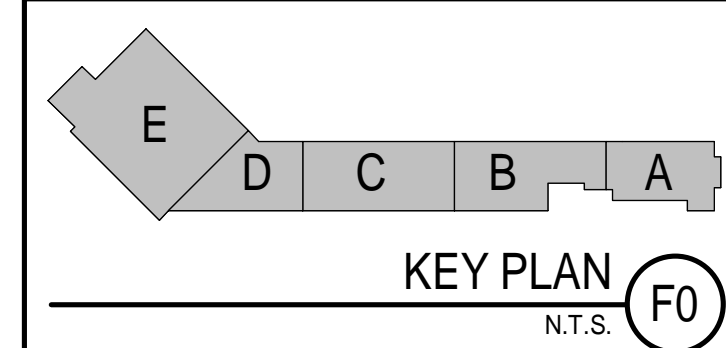
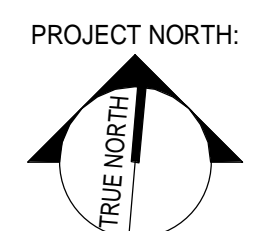

| REV. | BY: | DATE:    | ISSUED FOR CONSTRUCTION |
|------|-----|----------|-------------------------|
| 0    |     | 12/21/17 | STATUS:                 |

THIS PLAN SHALL NOT BE MODIFIED WITHOUT WRITTEN PERMISSION FROM SEBAGO TECHNICS, INC. ANY CHANGES SHALL BE AT THE USER'S SOLE RISK AND WITHOUT LIABILITY TO SEBAGO TECHNICS, INC.

SEBAGO TECHNICS  
 WWW.SEBAGOTECHNICS.COM  
 75 John Roberts Rd. - Suite 1A  
 South Portland, ME 04086  
 Tel: (207) 772-3846  
 Fax: (207) 772-1070

PROJECT NO. 17033  
 FIELD BOOK DESIGN CHKD DRAWN

FACILITY PLAN  
 OF:  
 PORTLAND INTERNATIONAL JETPORT  
 VERTICAL CIRCULATION IMPROVEMENTS  
 1001 WESTBROOK STREET  
 PORTLAND, MAINE 04102

| DATE     | SCALE         |
|----------|---------------|
| 12/21/17 | 1/32" = 1'-0" |

2.G1003