

**SECOND FLOOR FRAMING PLAN**

1/8"=1'-0"

- NOTES:**
- G.C. V.I.F. ALL EXISTING DIMENSIONS AND CONDITIONS. T/EXIST SLAB REF EL 15'-2 1/4" (G.C. V.I.F.)
  - ALIGN T/STEEL WITH EXISTING U.N.O.
  - ← INDICATES SPAN DIRECTION OF GALV 2VL18 COMPOSITE FLOOR DECK W/2 1/2" CONC (4 1/2" TOTAL THICKNESS, TO MATCH EXIST) W/W.W.F. 6x6-W1.4xW1.4 THROUGHOUT.
  - INDICATES MOMENT CONNECTION (SEE DETAILS S3.2).
  - E.O.S. INDICATES EDGE OF SLAB.

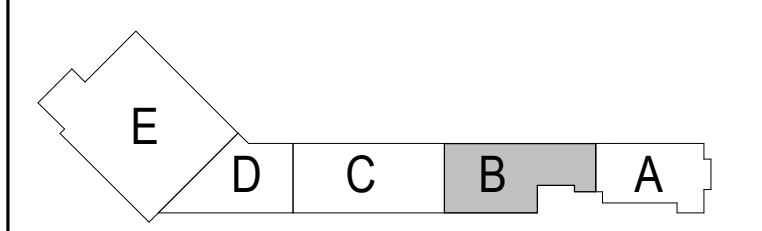
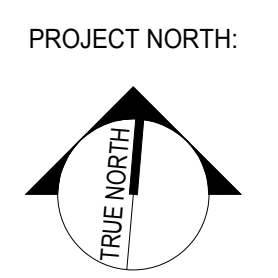

KEY PLAN  
N.T.S.

ISSUED FOR BID	12-22-17
STATUS:	DATE:
BY:	DATE:
REV: 0	DATE:

THIS PLAN SHALL NOT BE MODIFIED WITHOUT WRITTEN PERMISSION FROM SEBAGO TECHNICALS, INC. ALL CHANGES SHALL BE AT THE USER'S SOLE RISK AND WITHOUT LIABILITY TO SEBAGO TECHNICALS, INC.

PROJECT NO.	FIELD BOOK	DESIGN	CHKD	DRAWN
 WWW.SEBAGOTECHNICALS.COM 75 John Roberts Rd., Suite 1A South Portland, ME 04106 Tel: 207.202.2100 Fax: 207.783.5669				

SECOND FLOOR FRAMING PLANS  
OF:  
PORTLAND INTERNATIONAL JETPORT  
VERTICAL CIRCULATION IMPROVEMENTS  
1001 WESTBROOK STREET  
PORTLAND, MAINE 04102

DATE	SCALE
12/22/17	As Indicated
S1.2	