

Consultants

Revisions

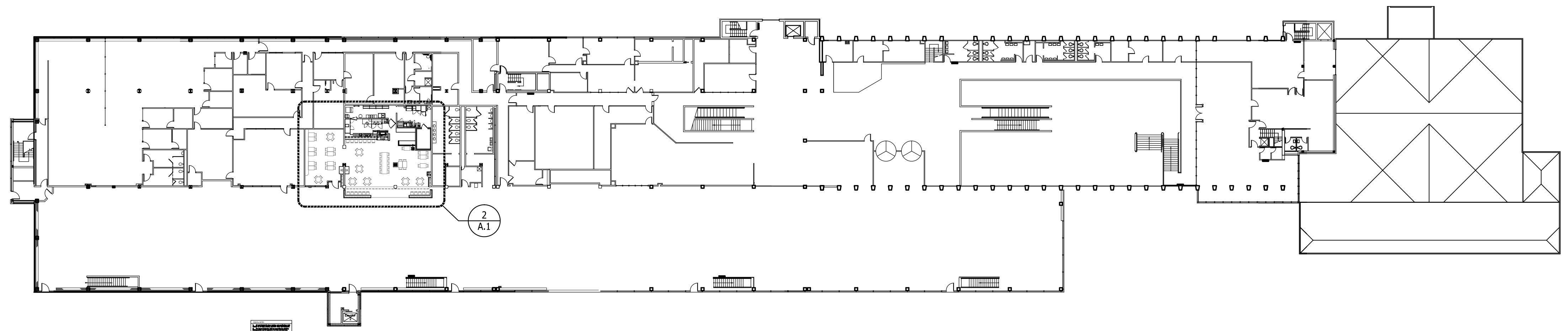

1 Second Floor Key Plan
Scale: 1/32" = 1'-0"

- GENERAL NOTES**
- All work included in these drawings and specifications shall conform to all state, national, and other codes and ordinances.
 - The General Contractor shall be responsible for obtaining building permits and for payment of all fees and hook-ups.
 - General contractor shall verify all dimensions and report any discrepancies to the architect before proceeding with work. Do not scale drawings, work from dimensions only.
 - The General Contractor shall obtain approval from the owner for staging areas and hours of allowable work times.
 - Provide appropriate reinforcing within partitions for support of all grab bars, shelving brackets, cabinets, door frames, water coolers, cubbies, fire extinguishers, lighting, and other wall mounted equipment or appliances indicated in documents.
 - Provide ADA insulation under sinks at exposed pipes.
 - All gypsum wall board within 3'-0" of plumbing fixtures shall be moisture resistant.
 - Before penetrating or otherwise modifying joists, beams, or other structural members, consult with the Architect on maximum size and location of penetrations.
 - Provide double studs at all door frames over 3'-0" wide.
 - All penetrations through rated walls and floor/ceiling assemblies shall be firestopped by specific subcontractor requiring penetration.
 - Location of every exit shall be clearly indicated by exit signs placed, if required, at an angle with the exit opening. Install directional signs to serve as guides from all portions of the corridor or floor.

- APPLICABLE CODES**
- City of So. Portland
International Building Code, 2009
NFPA 101, Life Safety Code, 2006
Maine State Internal Plumbing Code
NFPA 13 Sprinklers
ASHRAE 90.1 - 2007 Energy Standards for Buildings except Low-Rise Residential
ASHRAE 62.1 - 2007 Ventilation for Acceptable Indoor Air Quality
2009 International Energy Conservation Code
- Plumbing, Mechanical, Electrical, and Sprinkler system shall be design/build and shall meet all applicable codes.

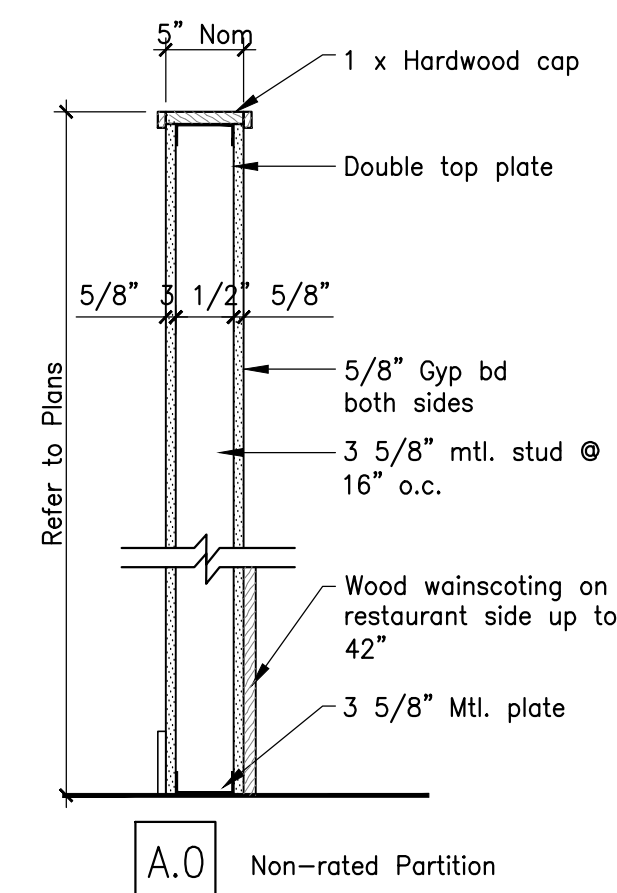

3 Partition Types
Scale: 1" = 1'-0"

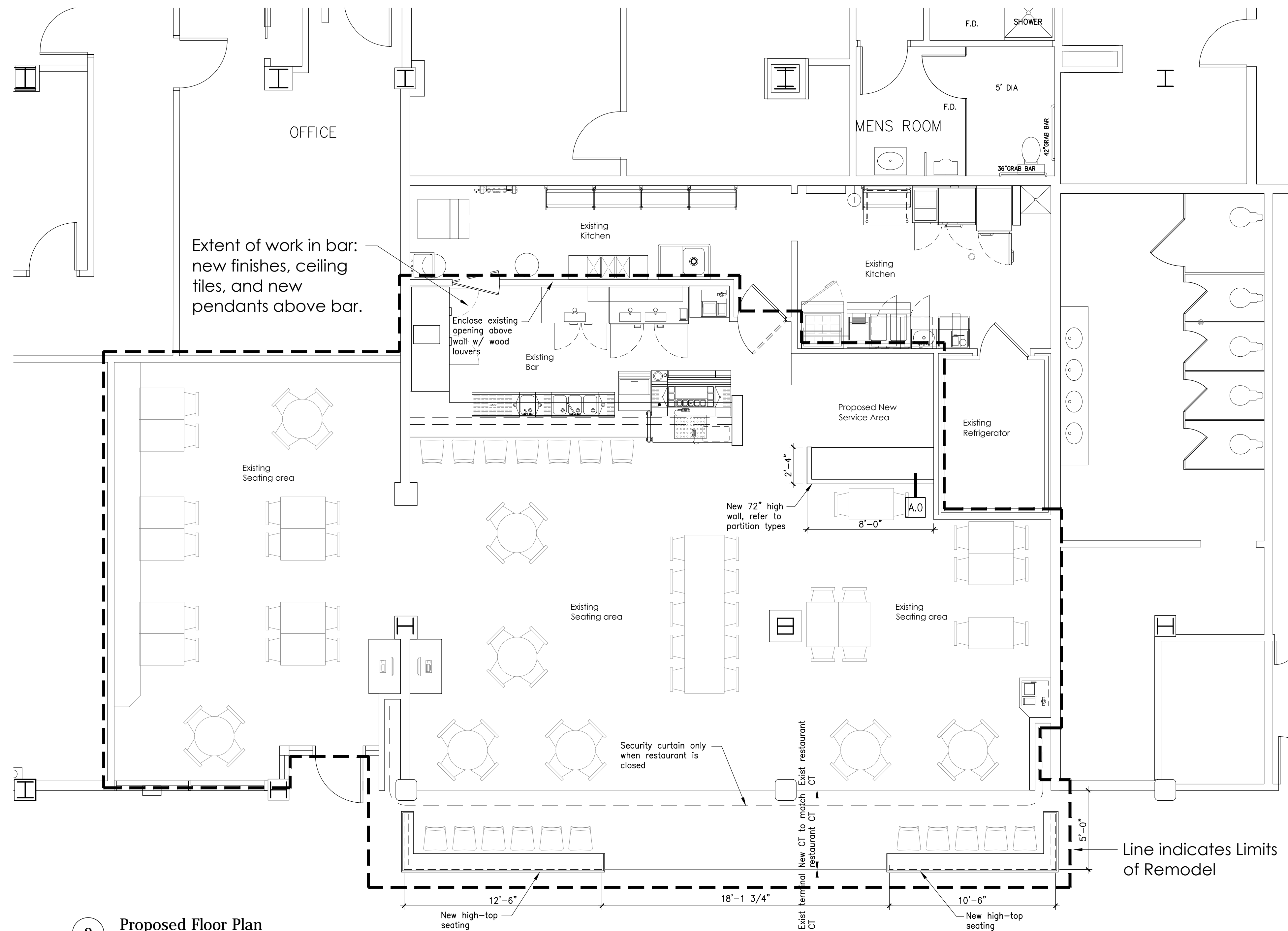

2 Proposed Floor Plan
Scale: 1/4" = 1'-0"

Portland
International
Jetport

1001 Westbrook St
So Portland, Maine 04102

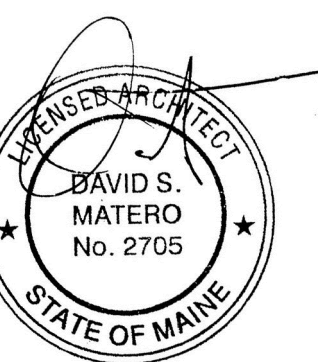

Job Number: 13.000
Date: 12.10.13
Scale: As Noted
Drawing Title:

Key Plan and
Proposed
Floor Plan

A.1
Issued for
Permit

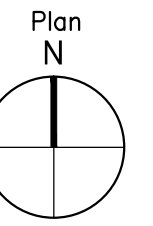

Consultants

Revisions

Portland
International
Jetport
1001 Westbrook St
So Portland, Maine 04102

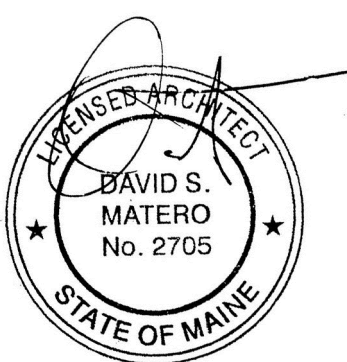

Job Number: 13.000
Date: 12.10.13
Scale:

Drawing Title:
Life Safety Plan

A.2
Issued for
Permit

EGRESS - IBC (Table 1004.1.1)			EGRESS - Life Safety (Table 7.3.1.2)		
Ground Floor			Ground Floor		
Assembly Space (Unconcentrated)	1,040 sf @ 15 sf net =	69 Occupants	Assembly Space (Unconcentrated)	1,040 sf @ 15 sf net =	69 Occupants
Bar Seating	18 Seats =	18 Occupants	Bar Seating	18 Seats =	18 Occupants
Kitchen	300 sf @ 200 gross sf =	2 Occupants	Kitchen	300 sf @ 100 gross sf =	3 Occupants
Total Occupants			Total Occupants		
89 Occupants			90 Occupants		

GENERAL NOTES - VISUAL NOTIFICATION

- Flash rate of strobe shall not exceed two flashes per second (2Hz) nor be less than one flash every second (1Hz) throughout the listed voltage range of the appliance.
- Maximum pulse duration shall be 0.2 seconds with a maximum duty cycle of 40%
- Wall mounted strobes shall be mounted such that the entire lens is not less than 80" and not greater than 96" above the finished floor or at mounting height specified using the performance-based alternative.
- If two groups of strobes are in the same room or visible, each group shall be synchronized, including if strobes are operated by separate systems.
- In square rooms w/ strobes not centered or in non-square rooms, the effective intensity from one strobe shall be determined by the max room size dimension by measuring the distance to the farthest wall or by doubling the distance to the farthest adjacent wall, whichever is greater.
- Strobes shall be located not more than 15' from the end of a corridor with a separation not greater than 100' and shall flash in synchronization. The effective intensity shall be rated not less than 15 cd.

GENERAL NOTES - VISUAL NOTIFICATION

- Audible sound level of fire alarm horns shall be at least 15 dB above the average ambient sound level or 5 dB above the maximum sound level having a duration of at least 60 seconds.
- An average ambient sound level greater than 105 dBA shall require the use of visible notification.
- The total sound pressure level produced by combining the ambient sounds pressure level with all audible notification appliances operating shall not exceed 110 dBA at the min hearing distance.

SYMBOL LEGEND

- ⊗ LED Exit Light (unswitched)
- ⊗ LED Exit Light w/ Directional Arrow (unswitched)
- ⊗ Self Contained, wall-mounted, Emergency Lighting Unit with 2 Heads and battery backup
- ⊗ Self Contained, ceiling-mounted, Emergency Lighting Unit with 2 Heads and battery backup
- ⊗ Single Head Remote Emergency Light
- ⊗ Fire Alarm Audio/Visual, mount 6"-8" AFF, dB Level in Field
- SD Fire Alarm Visual Strobe only, Flush mount 6"-8" AFF, set Candela Level in Field according to code
- ⊗ System connected Smoke Detector, photoelectric type w/ Sounder base
- F Fire Alarm pull station, mount 48" AFF
- FACP Fire Alarm Control Panel Station, location to be approved by Portland Fire Department
- KB Knox Box (location and type to be approved by Portland Fire Department)
- FEC-# Fire extinguisher cabinet and type
- ETR Existing to Remain
- MHO Magnetic Hold Open (requires smoke detectors located on each side of door and connected to sprinkler system)
- WP Exterior grade / waterproof

NOTES

- Life safety equipment and locations shall conform to all applicable codes.
- Provide pull station at each assembly door egress.
- Provide duct smoke detectors at each 2,000 CFM supply duct.
- Provide duct smoke detectors at each 15,000 CFM supply and exhaust duct.
- Integrate kitchen smoke/fire detection/suppression system with main fire panel. Provide automatic cooking fuel shut-off mechanism.
- Electrical outlets shall be provided for all plug-in equipment. All other outlets shall be located per all applicable codes.
- Provide laminated floor plan at each public room indicating direction to building exit.

Fire Extinguisher Cabinet

FEC Semi-recessed Fire Extinguisher Cabinet by Larsen of approved equivalent. Include Class K hazard in Kitchen

Portable Fire Extinguishers:

- Location of fire extinguishers and cabinets shall conform to NFPA 10 Standards for Fire Extinguisher Cabinets.
- Portable fire extinguisher rating shall be 2-A, spacing shall not exceed a maximum of 75' and 3,000 sf.
- Portable fire extinguisher rating in combustible cooking media exist shall be rated Class K, spacing shall not exceed a maximum travel distance of 30'

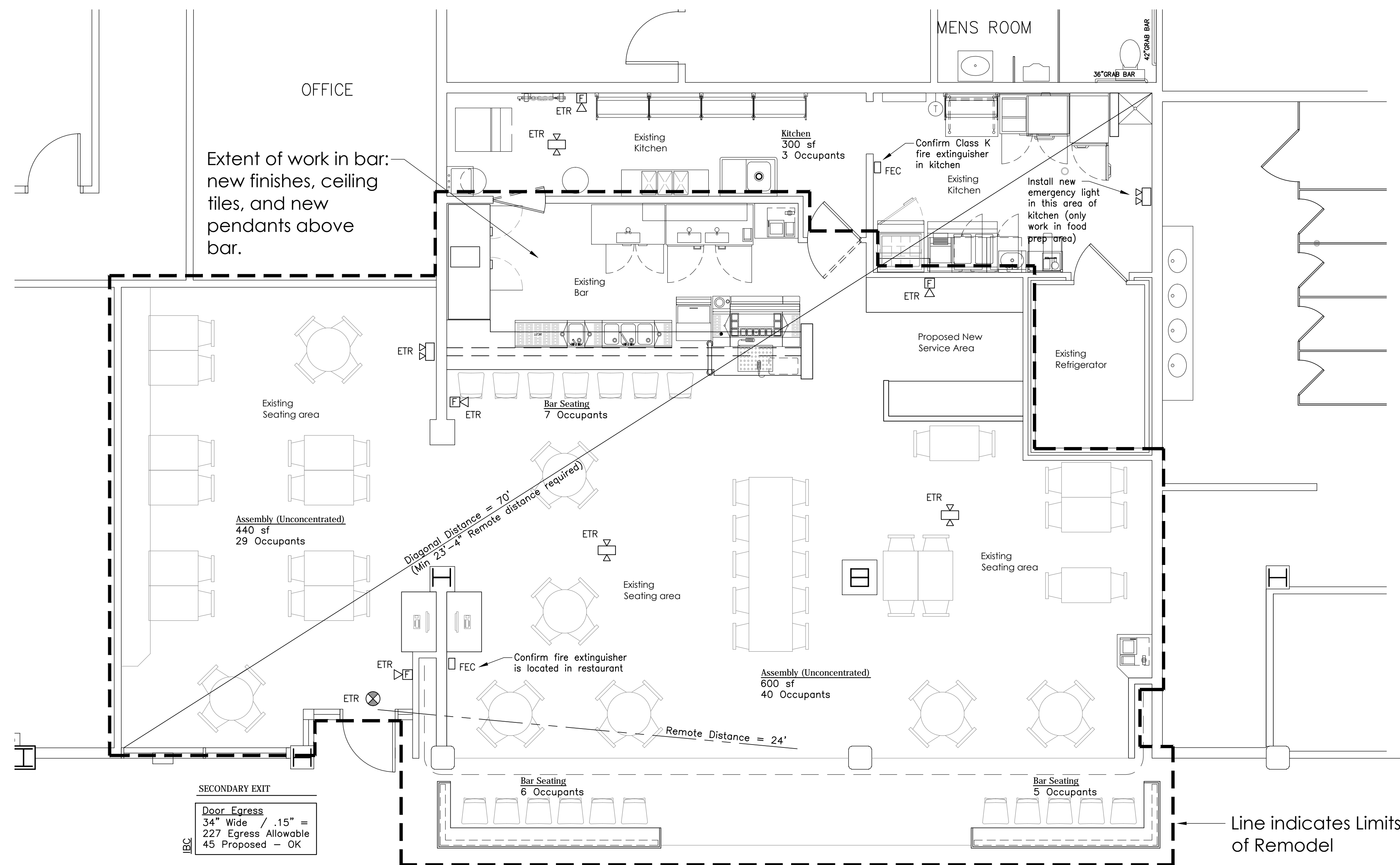

IBC	SECONDRARY EXIT
Door Egress	34" Wide / .15" = 227 Egress Allowable
	45 Proposed - OK
MEPA-101	Door Egress
	34" Opening / .2" = 170 Egress Allowable
	45 Proposed - OK

1 Life Safety Plan
Scale: 1/4" = 1'-0"

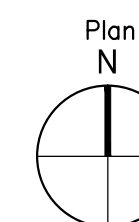

Consultants

Revisions

Portland
International
Jetport
1001 Westbrook St
So Portland, Maine 04102

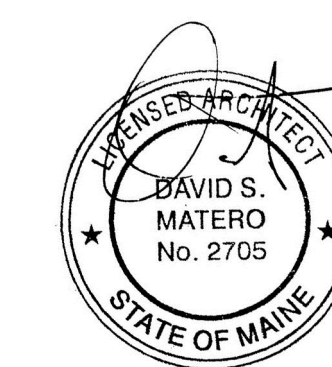

Job Number: 13.000
Date: 12.10.13
Scale:
Drawing Title:

Reflected
Ceiling and
Electrical
Plan

A.3
Issued for
Permit

W/HW SERIES

PREPARED BY: _____
TYPE: _____
JOB NAME: _____

MODEL#	A (Height in Inches)	B (Diameter in Inches)	Projection in Inches
W1	10/ CF 10 1/2	4/ CF 5 3/4	5/ CF 6 3/4
W2	12/ CF 12 1/2	5 1/4 / CF 5 3/4	5 3/4 / CF 7
HW1	10/ CF 10 1/2	8/ CF 8 3/4	7/ CF 8 3/4
HW2	12/ CF 12 1/2	10/ CF 10	9/ CF 11

FINISH-Five stage pretreatment process, coated with a lead free TGI C polyester powder coat finish. White is standard inside reflectors, Except #49-Galvanized, #62-Arnodized Bronze and #63-Iron Rust, Unless specified. Custom colors and Marine are available upon request.

LAMP HOLDERS- Accommodates **Incandescent** medium base porcelain socket, copper shell with nicked plate, rated 250V, 660W. **Compact Fluorescent** 4 pin heat resistant thermoplastic socket accommodates 26/32W (Gx24q-3 base) and 42W (Gx24q-4 base). Twist lock design provides for vibration and earthquake resistance, rated 75W, 600V. **High Intensity Discharge (H.I.D.)** medium base, 4KV pulse start socket, rated 660W/600V.

MOUNTING- 1/2" or 3/4" tapped hub is supplied. Top or side mount available. Fixtures are pre-wired with 48" or 96" leads. Available with cord or stem sets.

REFLECTOR- Spun from heavy gauge 1100-0 aluminum, ranging in thickness from .050 to .125. Galvanized is from 20 gauge sheets. Copper is spun from .040 gauge and 110 soft alloy.

MODEL#	FINISH	LIGHT SOURCE		
		INC	CF	HID(MH & HPS)
W1	40,41,42,43,44,45,	100W	26 OR 32W*	35,50,70, OR 100W*
W2	46,48,49,50,51,52,	200W	26,32, OR 42W*	35,50,70, OR 100W*
HW1	53,54,55	100W	26 OR 32W*	35,50,70,100,150W*
HW2		200W	26,32, OR 42W*	35,50,70,100,150W*

*FOR REMOTE BALLAST SEE MOUNTING SOURCE

GLASS:
MOUNTING SOURCE:
ACCESSORIES:

Barn Light Electric Company®
www.barnlightelectric.com
3405 South Washington Avenue
Troyville, IL 62708
Phone: 321.269.2299
Fax: 321.607.6979

A Type A Fixture
Scale: NTS

SERIES-P/HP

PREPARED BY: _____
TYPE: _____
JOB NAME: _____
CERTIFICATION: UL LISTED

FINISH-Five stage pretreatment process, coated with a lead free TGI C polyester powder coat finish. Custom colors and Marine are available upon request.

LAMP HOLDERS- Accommodates **Incandescent** medium base porcelain socket, copper shell with nicked plate, rated 250V, 660W. **Compact Fluorescent** 4 pin heat resistant thermoplastic socket accommodates 26/32W (Gx24q-3 base) and 42W (Gx24q-4 base). Twist lock design provides for vibration and earthquake resistance, rated 75W, 600V. **LED**. A minimum of 60,000 hours to 100,000 expected life depending on installation location and ambient temperature.

MOUNTING- 1/2" or 3/4" tapped hub is supplied. Top or side mount available. Fixtures are pre-wired with 48" or 96" leads. Available with cord or stem sets.

MATERIAL- Aluminum die cast

MODEL#	SIZE	GLASS	GUARD	FINISH	LIGHT SOURCE			MOUNTING	DIMENSION
					INC	CF ¹	LED ¹		
P	1	CL3-3" clear FR3-3" frosted PR3-3" prismatic RE3-3" red BL3-3" blue GR3-3" green AH3-3" amber Hyde	CG-cast	41-black	100W	26, 32 or 42W	10W	INC BLC-8" black cord STXX-18", 24", 36" or 48" stem STC- 1/2" stem mount canopy SLC 1/2- 1/2" slope ceiling canopy	10"H x 4 1/4"W
				42-dr. green					
				43-red					
				44-white					
				45-med. blue					
				46-yellow					
				48-polish alum.					
				49-galvanized					
				50-navy blue					
				51-arch.					
52-patina									
53-rust									
54-tauco									
55-sage									
59-coppertone									
60-canal green									
61-anod.									
62-anod. bronze									
63-iron rust									
P	2	CL4-4" clear FR4-4" frosted PR4-4" prismatic RE4-4" red BL4-4" blue GR4-4" green AH4-4" amber Hyde	WG-wire	41-black	200W	26,32 or 42W	20W	CF CFBLC-3" Black cord STXX 18",24", 36" or 48" stem CFSTC- 1/2" stem mount canopy CFSLC 1/2- 1/2" slope ceiling canopy	11 1/2"H x 5"W
				42-dr. green					
				43-red					
				44-white					
				45-med. blue					
				46-yellow					
				48-polish alum.					
				49-galvanized					
				50-navy blue					
				51-arch.					
52-patina									
53-rust									
54-tauco									
55-sage									
59-coppertone									
60-canal green									
61-anod.									
62-anod. bronze									
63-iron rust									

¹REMOTE BALLAST

PHONE: 877-999-1990
FAX: 877-999-1955
12260 EAST END AVE, CHINO, CA 91710

B Type B Fixture
Scale: NTS

Electrical Notes

- All lighting equipment and associated electrical systems and their installation must conform to all applicable local, state and national codes.
- Outlets or junction boxes mounted back to back shall be prohibited
- Final location of all fixtures and devices to be approved in the field by owner prior to rough-in.
- Existing light fixtures shall remain as indicated, except above bar area where existing pendants shall be switched as noted.
- Ceiling grid and soffits, existing to remain.

Lighting Fixture Schedule

Type	Description	Total
A	Wall mounted sconce light - Barn Light Electric, W1, clear glass, size 10 1/2" h x 5 3/4" w	10 total
B	Ceiling mounted pendant light, series P by Baselite, size 10" h x 4 1/2" w	8 total

Lighting Symbol Legend

2x4 Recessed fixture (2x2 shown half size)

Wall Mounted Light Fixture

Recessed Light Fixture

Surface Mounted Light Fixture

Pendant Light Fixture

Track lighting

Duplex Outlet

ETR Existing to Remain

24" x 24" Suspended acoustical panel ceiling

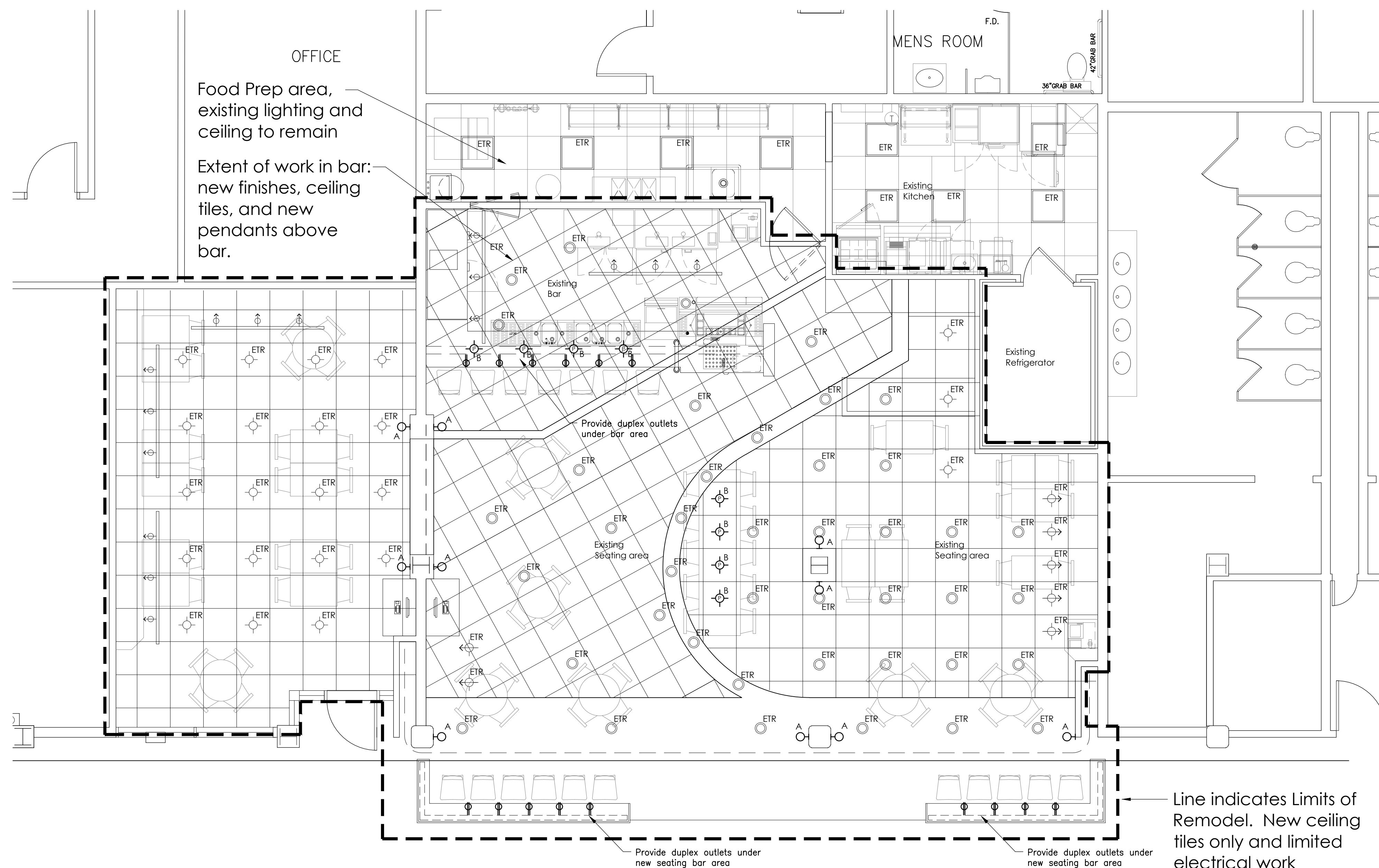

1 Reflected Ceiling and Electrical Plan
Scale: 1/4" = 1'-0"