

PORTLAND INTERNATIONAL JETPORT: TAXI SHELTER ADDITION

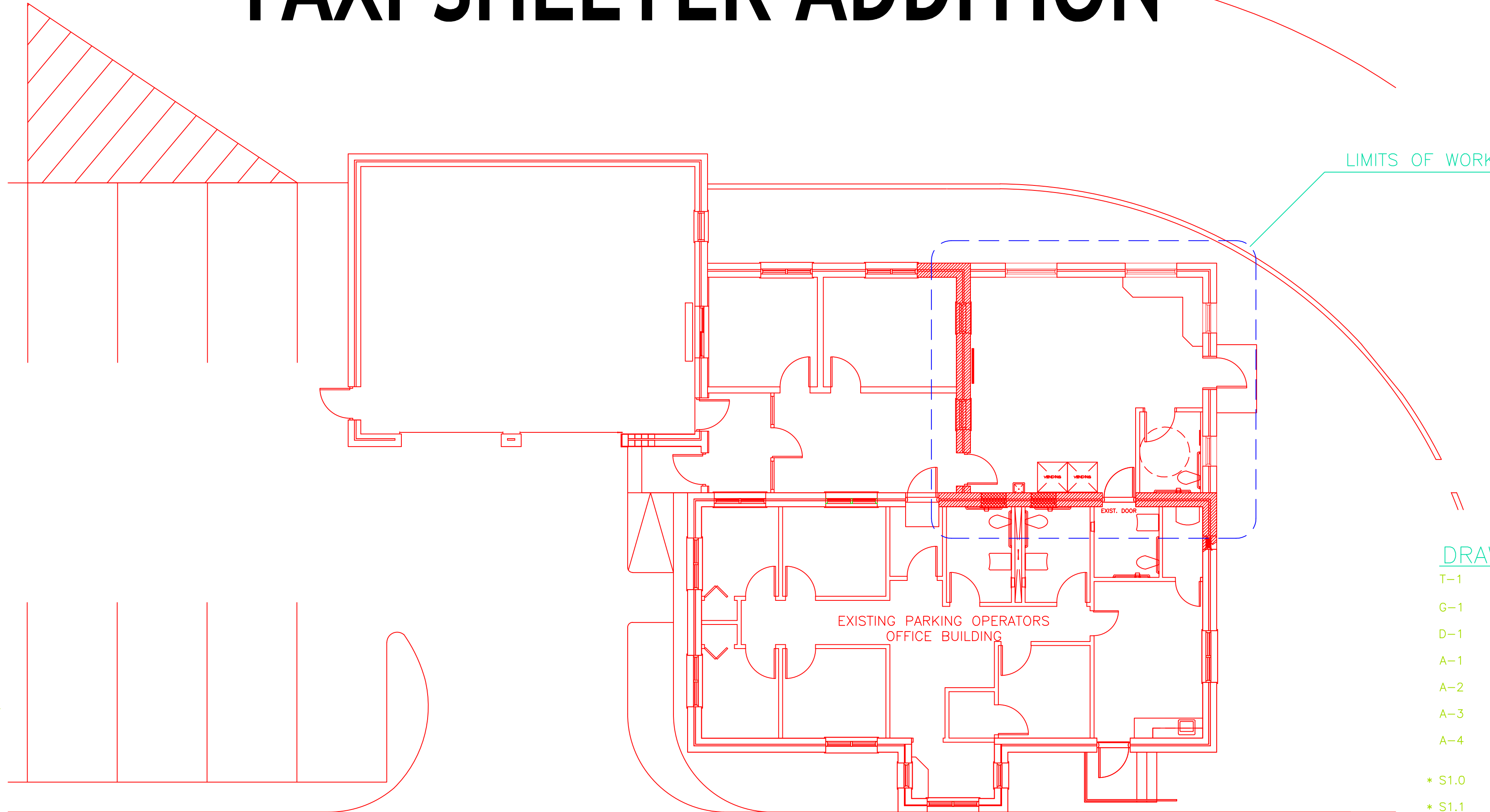
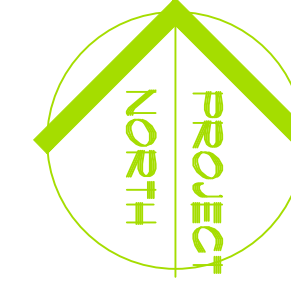

LIMITS OF WORK

DRAWING LIST

- T-1 TITLE SHEET
- G-1 GENERAL INFORMATION, ADD/ALT INFORMATION
- D-1 DEMOLITION PLAN: For reference ONLY
- A-1 FLOOR PLAN, ROOF PLAN, RCP
- A-2 EXTERIOR ELEVATIONS, EXTERIOR WALL SECTION
- A-3 SECTIONS, DETAILS, WALL TYPES
- A-4 ROOM FINISH SCHEDULE, DOOR SCHEDULE, DOOR ELEVATIONS, DOOR DETAILS, WINDOW ELEVATIONS, MISCELLANEOUS DETAILS
- * S1.0 GENERAL NOTES & TYPICAL DETAILS
- * S1.1 PLANS & DETAILS
- M-0 HVAC SCHEDULES, LEGEND & SPECIFICATIONS
- M-1 HVAC PLANS
- P-0 PLUMBING LEGEND, SCHEDULES & SPECIFICATIONS
- P-1 PLUMBING PLANS & DETAILS
- E-0 ELECTRICAL SCHEDULES, LEGEND & SPECIFICATIONS
- E-1 ELECTRICAL PLANS

* REFERENCE STRUCTURAL NOTES ON G-1

CODE COMPLIANCE

I.O PRINCIPLE CODES, STANDARDS, AND REVIEW AUTHORITIES APPLICABLE TO PROJECT

FIRE:
NFPA INCLUDING 101 LIFE SAFETY CODE, 2009 EDITION
STATE FIRE MARSHAL'S OFFICE, RICHARD MCCARTHY
PHONE: (207)624-8744 FAX: (207)626-3886

PORTLAND FIRE DEPARTMENT, FIRE CHIEF,
Captain Chris Pirone
PHONE: (207)874-8405 FAX: (207)874-8400

BUILDING:
IBC BUILDING CODE, 2009 EDITION
PORTLAND CODE ENFORCEMENT OFFICER,
Tammy Munson
PHONE: (207)874-8706

ACCESSIBILITY:
ADA, ACCESSIBILITY GUIDELINES FOR BUILDINGS AND FACILITIES.

MAINE HUMAN RIGHTS ACT, ANSI A117.1 - 1986
STATE FIRE MARSHAL'S OFFICE, RICH MCCARTHY
PHONE: (207)624-8744 FAX: (207) 626-3886

MECHANICAL:
ASHRAE 62.1 2007

PLUMBING:
N.A.

AUTOMATIC SPRINKLER SYSTEM:
n.a.

ENERGY:
N.A.

ELECTRICAL:
NEC 2011

AREA LOCATION PLAN

SCALE: NTS

General Notes

ISSUED FOR
CONSTRUCTION
4/18/2013

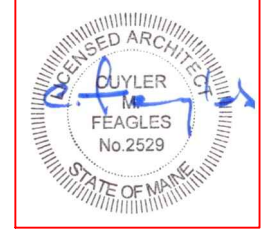

No.	Revision/Issue	Date

Facilities & Engineering
1001 Westbrook ST
Portland, ME 04102
207-874-8877

Project Name and Address

TAXI CAB
WAITING ROOM
AT PJM

Sheet Title

TITLE SHEET

Project Number: 13-103	Sheet: T-1
Date Issued For Construction: 4/18/2013	
Scale: Reference Individual Drawings	