



711 N. FIELDER RD.  
ARLINGTON, TX 76012  
PH: (817) 635-5696  
FAX: (817) 635-5699

DRAWING ISSUE	DATE
75% SUBMITTAL	01.28.10
95% AIRPORT REVIEW	02.12.10
SUBMIT FOR PERMIT	02.26.10

**CNBC NEWS**  
Portland International Jetport  
1001 Westbrook Street  
Portland, Maine



THE PARADISE SHOPS

SEAL:  
REVIEWED & APPROVED BY: \_\_\_\_\_  
PROJECT MANAGER INITIALS: T.L.  
DATE: \_\_\_\_\_

NOTE:  
THIS DOCUMENT CONTAINS COPYRIGHTED MATERIAL BELONGING EXCLUSIVELY TO PARADISE SHOPS ARCHITECTURE, LLC. UNAUTHORIZED USE, DISCLOSURE, REPRODUCTION OR DUPLICATION OF ANY OF THE INFORMATION CONTAINED HEREIN MAY RESULT IN LIABILITY APPLICABLE BY LAW. IT IS THE RESPONSIBILITY OF THE USER TO VERIFY THAT ALL DOCUMENTS ARE APPROVED BY AND FORWARDED BY THE ISSUING AGENCY. WE DO NOT ASSUME ANY RESPONSIBILITY OR LIABILITY FROM ANY PERSON, OR COMPANY, THAT REPRODUCES OR TRANSMITS THIS DOCUMENT WITHOUT OUR WRITTEN PERMISSION.

PROJECT NUMBER:  
**2777**

DRAWING NAME:  
**Ceiling Sections & Detail**

DRAWING NUMBER:  
**A-501**

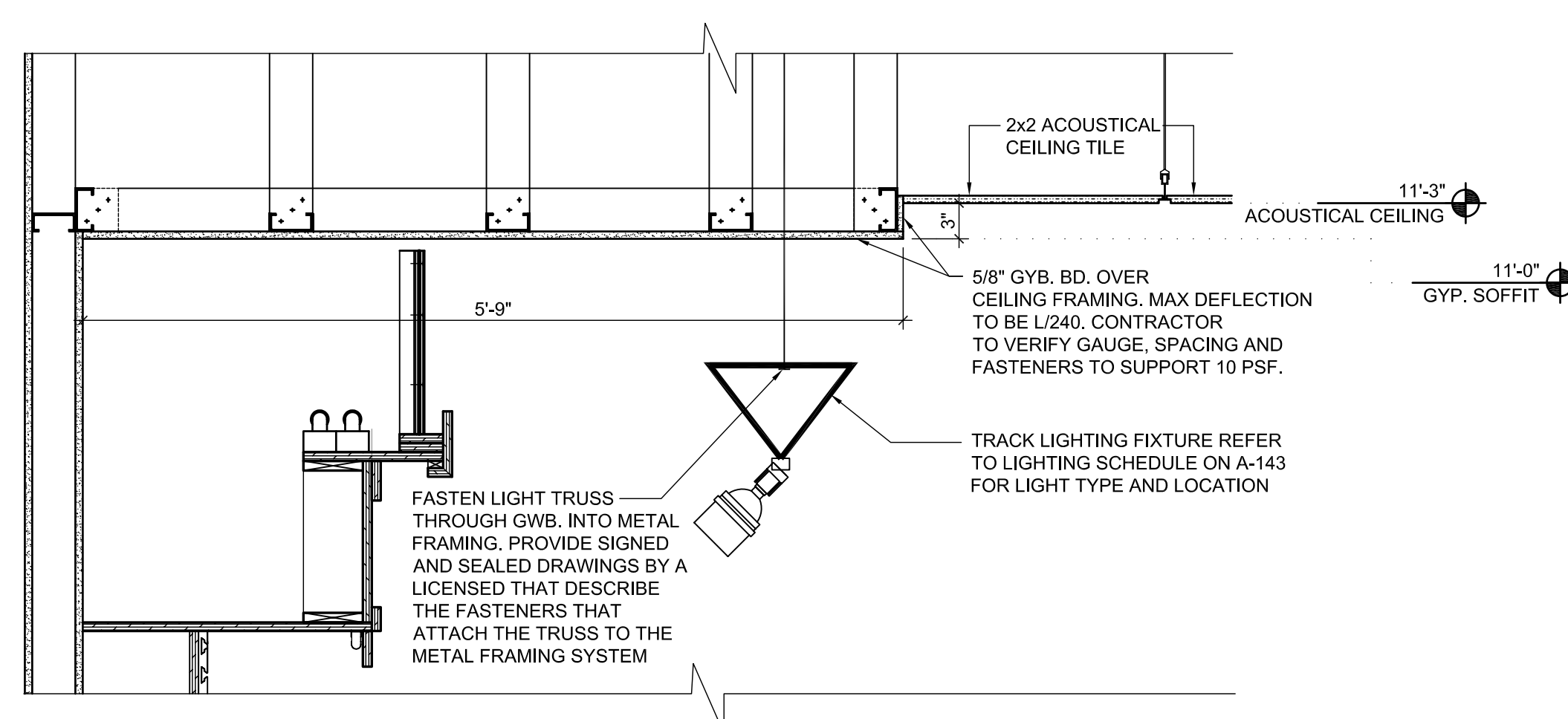

CEILING SECTION 1" = 1'-0" 3

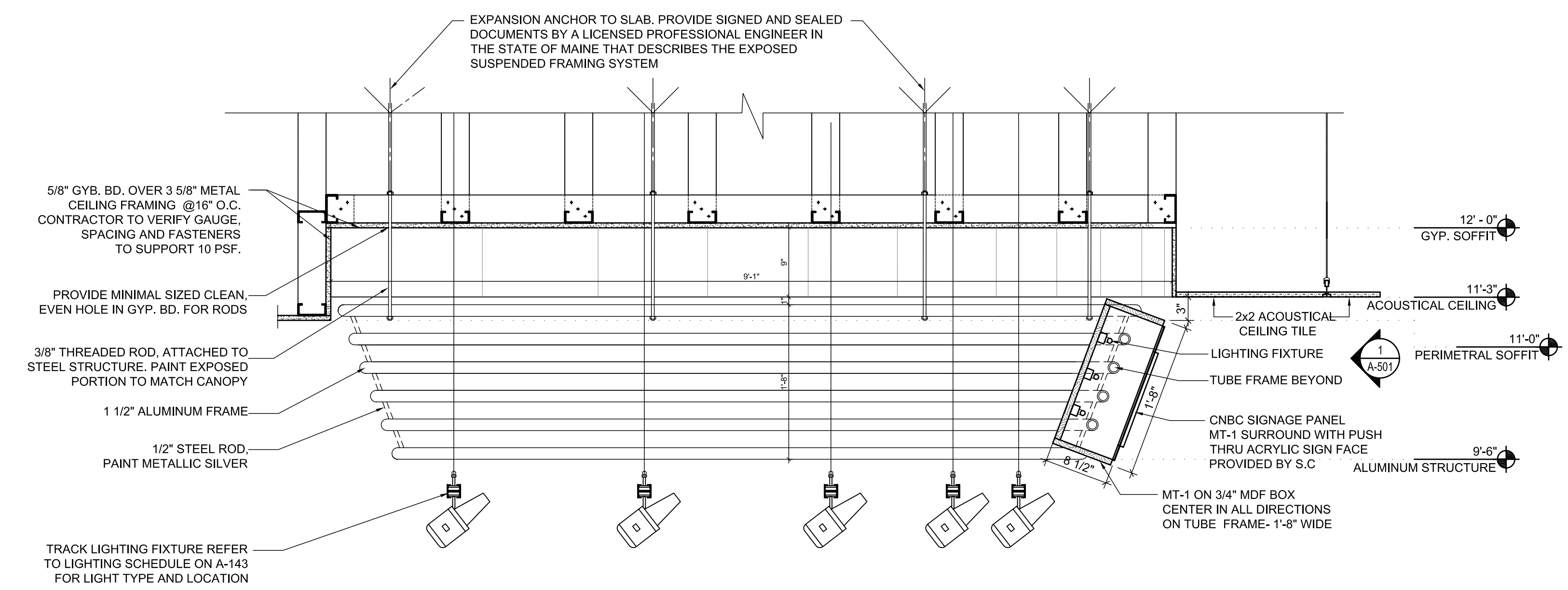

CEILING SECTION 1" = 1'-0" 2

NOTE:  
PROVIDE SIGNED AND SEALED DOCUMENTS BY A LICENSED PROFESSIONAL ENGINEER IN THE STATE OF MAINE THAT DESCRIBES THE EXPOSED SUSPENDED FRAMING SYSTEM

NOTE:  
G.C. TO PROVIDE AND INSTALL ALL MATERIALS AND FRAMING TO CEILINGS. TENANT TO PROVIDE ALL CEILING FIXTURES AND G.C. TO INSTALL.

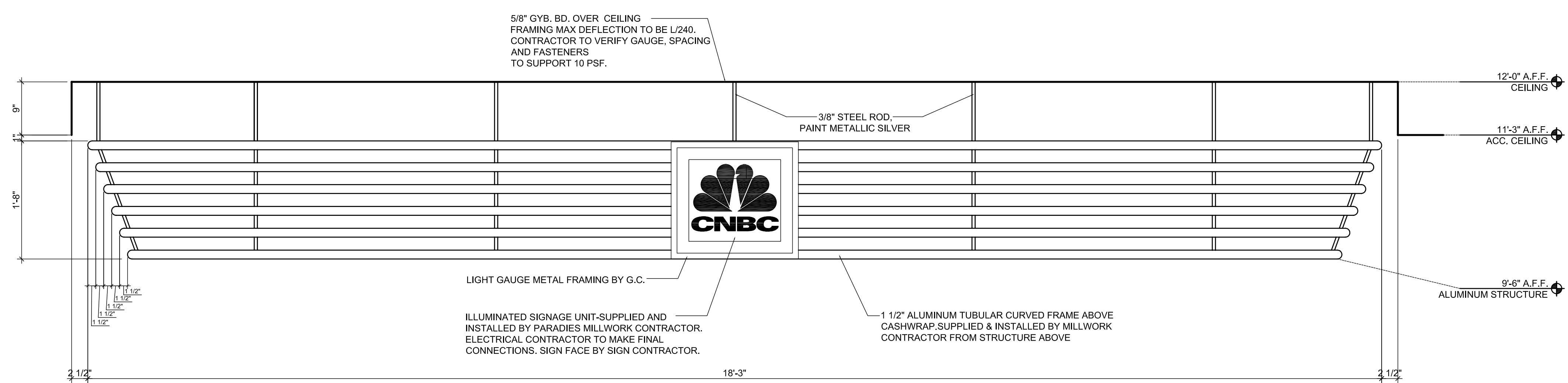

CEILING ELEVATION AT METAL CANOPY 1" = 1'-0" 1