



711 N. FIELDER RD.
ARLINGTON, TX 76012
PH: (817) 635-5696
FAX: (817) 635-5699

DRAWING ISSUE	DATE
75% SUBMITTAL	02.12.10
95% PERMIT SUBMITTAL - LL REVIEW	02.24.10

EXHAUST FAN SCHEDULE								
FAN NO.	SERVICE	MANUF. & MODEL	CFM	POWER	S.P.	MAX. SONES	VOLTS - PH	NOTES
EF-1	VENDING AREA	PANASONIC FV-30VQ3	300	62W	0.125"	2.0	120 - 1Ø	SEE BELOW
EF-2	VENDING AREA	PANASONIC FV-30VQ3	300	62W	0.125"	2.0	120 - 1Ø	SEE BELOW

- NOTES:
1. CEILING MOUNT
 2. BACKDRAFT DAMPER
 3. OPEN ENDED TO PLENUM
 4. INTEGRAL ELECTRICAL DISCONNECT
 5. SPEED CONTROL
 6. TO RUN CONTINUOUSLY

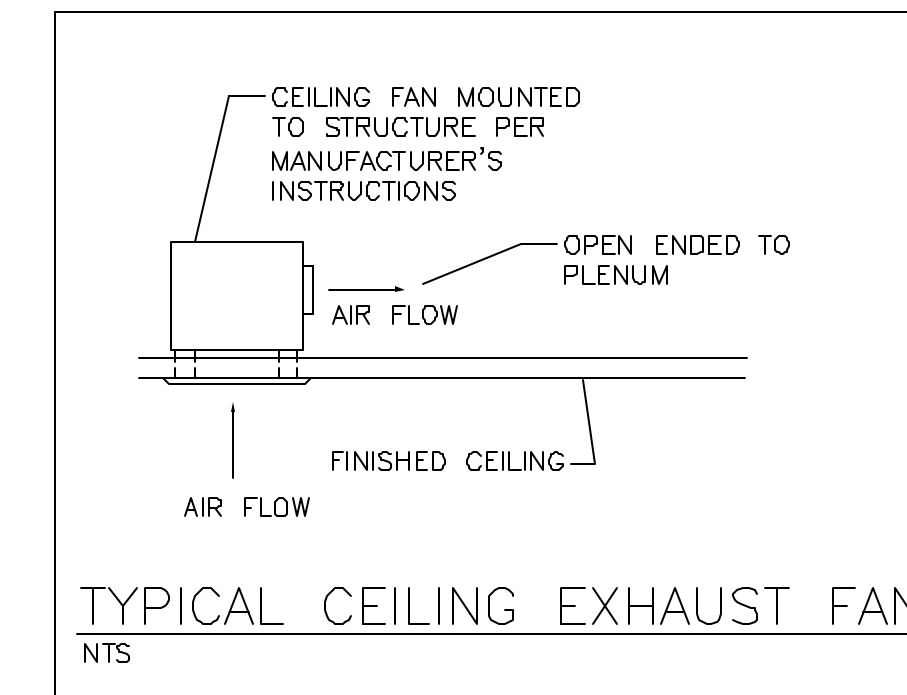

HVAC SYMBOLS AND ABBREVIATIONS	
EF-*	EXHAUST FAN
CFM	CUBIC FEET PER MINUTE
DIA.	DIAMETER

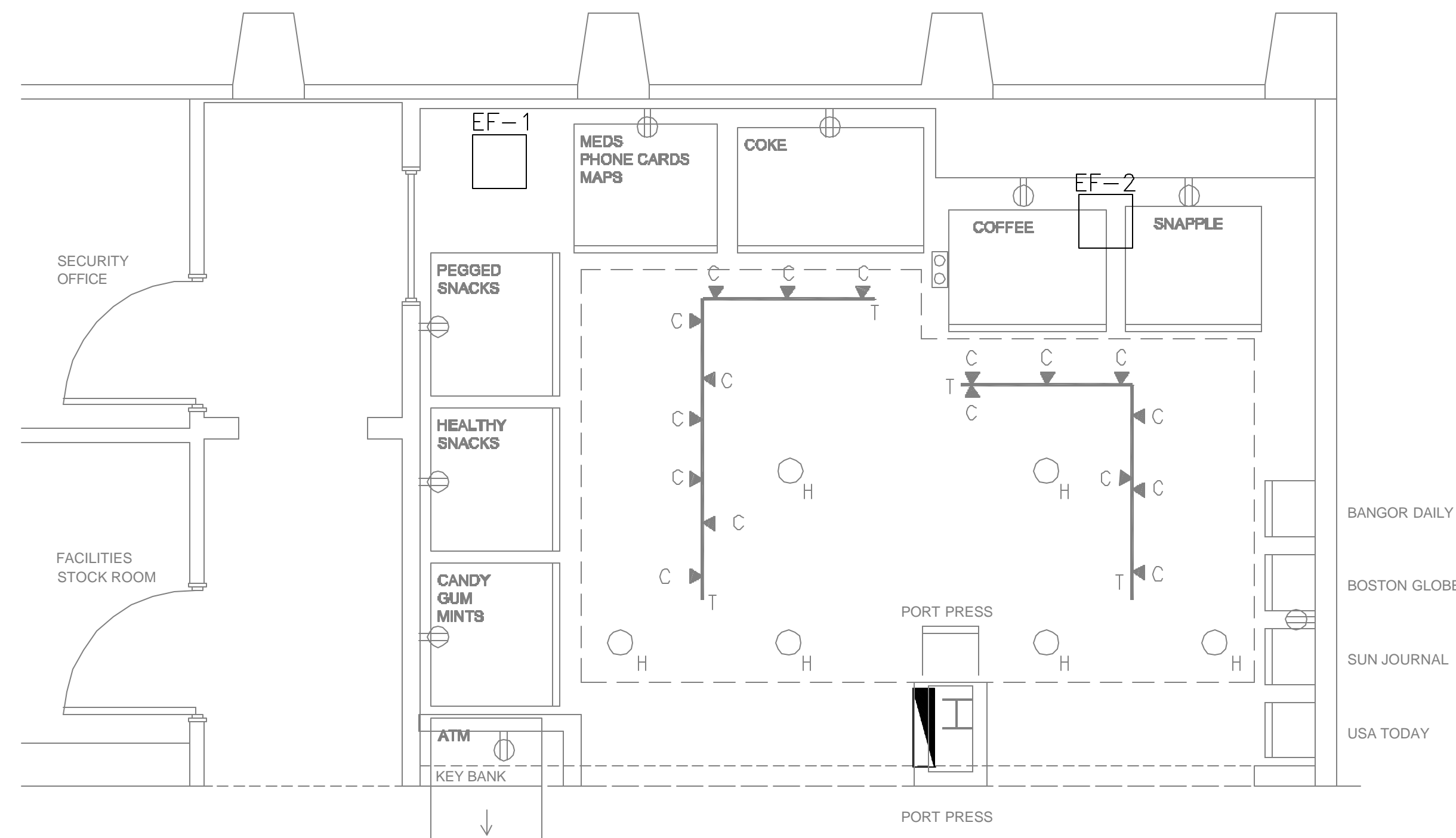

1 MECHANICAL FLOOR PLAN
M-1 SCALE: 3/8" = 1'-0"

PLENUM NOTES:
THIS BUILDING USES THE CEILING SPACE AS AN RETURN AIR PLENUM. MATERIALS ABOVE THE CEILING SHALL HAVE A FLAME-SPREAD INDEX OF NOT MORE THAN 25. AND A SMOKE DEVELOPED INDEX OF NOT MORE THAN 50, AS DETERMINED PER ASTM E84.

RENOVATION NOTES:

1. VISIT THE SITE AND CAREFULLY EXAMINE THE EXISTING CONDITIONS BEFORE SUBMITTING BIDS, AS NO ALLOWANCE WILL BE MADE FOR LACK OF KNOWLEDGE OF EXISTING CONDITIONS WHERE SUCH CONDITIONS MAY REASONABLY BE DETERMINED BY OBSERVATION.
2. THE EXISTING INSTALLATION IS TO REMAIN IN PLACE AND IN SERVICE EXCEPT AS OTHERWISE INDICATED OR SPECIFIED. ALL WORK NECESSARY TO PROPERLY TIE IN THE NEW WORK WITH THE EXISTING WORK AND ADAPT THE EXISTING INSTALLATION TO THE CHANGES IN THE BUILDING AND IN THE SYSTEMS SHALL BE PERFORMED.
3. EXPOSED DUCTWORK, PIPING AND CONTROLS RENDERED USELESS DUE TO CHANGES IN THE BUILDING SHALL BE REMOVED.
4. CONCEALED DUCTWORK, PIPING AND CONTROLS EXPOSED BY THE REMOVAL OF WALLS, PARTITIONS, ETC., SHALL BE REMOVED OR RECONNECTED AS REQUIRED.
5. OPENINGS IN DUCTWORK SHALL BE BLANKED OFF AND MADE AIR TIGHT.
6. ALL EQUIPMENT WHICH IS TO REMAIN IN SERVICE, BUT TEMPORARILY DISCONNECTED DUE TO THE ALTERATIONS TO THE BUILDING OR SYSTEMS, SHALL BE RECONNECTED AND RESTORED TO ITS ORIGINAL OPERATING CONDITION.
7. THE SIZE AND LOCATION OF EXISTING EQUIPMENT AND DUCTWORK SHOWN ON THE DRAWINGS SHALL BE VERIFIED AT THE SITE.
8. EXISTING MATERIAL THAT IS REMOVED AND NOT REUSED SHALL BECOME THE PROPERTY OF THE CONTRACTOR AND SHALL BE REMOVED FROM THE PREMISES.
9. WHERE EXISTING INSULATION IS DAMAGED DUE TO NEW WORK, IT SHALL BE REPLACED WITH INSULATION OF THE TYPE SPECIFIED FOR THE NEW WORK.
10. SPRINKLER HEADS ARE EXISTING. CONTRACTOR SHALL RELOCATE HEADS AS REQUIRED TO MEET THE NEW ARCHITECTURAL LAYOUT AND CEILING HEIGHTS. ALL NEW SPRINKLER HEADS AND PIPING SHALL BE IN ACCORDANCE WITH THE LOCAL FIRE MARSHALL, CODES AND PER THE LANDLORD INSURANCE UNDERWRITERS. CONTRACTOR SHALL SUBMIT DRAWINGS AS REQUIRED TO THE FIRE MARSHALL FOR APPROVAL.

GENERAL MECHANICAL NOTES:

1. MOUNT REMOTE SENSORS AT 60" ABOVE FINISH FLOOR. COORDINATE LOCATION WITH THE ARCHITECT & INTERIOR DESIGNER.
2. DUCTWORK AND EQUIPMENT SHOWN IS DIAGRAMMATIC. COORDINATE AND ROUTE DUCTWORK TO MEET JOB REQUIREMENTS. LOCATION OF EQUIPMENT MUST BE COORDINATED WITH ALL DISCIPLINES BEFORE FINAL LOCATIONS ARE SELECTED. WEIGHTS OF EQUIPMENT MUST BE VERIFIED AND COORDINATED WITH STRUCTURAL SYSTEMS BEFORE EQUIPMENT CAN BE INSTALLED AT JOBSITE.
3. SPACE ALLOCATED FOR MECHANICAL AND OTHER WORK ABOVE THE SUSPENDED CEILING IS CRITICAL. LIGHT FIXTURES AND AIR DIFFUSERS HAVE BEEN LOCATED TO ACHIEVE A DEFINITE ARCHITECTURAL EFFECT AND MAY NOT BE CHANGED WITHOUT THE CONSENT OF THE ARCHITECT. BECOME FAMILIAR WITH THE ARCHITECTURAL, STRUCTURAL, MECHANICAL AND ELECTRICAL DRAWINGS PRIOR TO FABRICATING AND INSTALLING ANY MATERIALS. HANG DUCTWORK AS CLOSE AS POSSIBLE TO THE STRUCTURE ABOVE, UNLESS INDICATED OTHERWISE.
4. WHERE THE SPACE ABOVE THE SUSPENDED CEILING IS USED AS A RETURN AIR PLENUM, COORDINATE THE WORK OF OTHER TRADES TO PROVIDE ADEQUATE SPACE FOR THE FLOW OF RETURN AIR (250 FPM MAXIMUM VELOCITY). WHERE PARTITIONS ARE EXTENDED TO THE STRUCTURE ABOVE, PROVIDE OPENINGS IN THE PARTITIONS ABOVE THE CEILING.
6. COORDINATE THE LOCATION OF CEILING DIFFUSERS, REGISTERS AND GRILLES WITH THE ARCHITECTURAL REFLECTED CEILING PLANS.

PRE-SECURITY VENDING SHOP
Portland International Jetport
1001 Westbrook Street
Portland, Maine

THE PARADISE SHOPS

SEAL:
REVIEWED & APPROVED BY: _____
PROJECT MANAGER INITIALS: _____
DATE: _____

NOTE: THE DOCUMENT CONTAINS COPYRIGHTED MATERIAL BELONGING EXCLUSIVELY TO PARADISE SHOPS ARCHITECTURE, LLC. UNAUTHORIZED REPRODUCTION, DISSEMINATION, OR DISTRIBUTION OF ANY OF THE INFORMATION CONTAINED HEREIN IS STRICTLY PROHIBITED. THE USER SHALL BE RESPONSIBLE FOR OBTAINING ALL NECESSARY PERMISSIONS FROM THE ORIGINAL OWNER TO ACT ON BEHALF OF ANY OTHER PARTY. PARADISE SHOPS ARCHITECTURE, LLC DOES NOT ASSUME ANY RESPONSIBILITY OR LIABILITY FROM ANY PERSON OR ENTITY, THAT REPRODUCES OR TRANSMITS THIS INFORMATION WITHOUT OUR WRITTEN PERMISSION.

PROJECT NUMBER:
2780

DRAWING NAME:
MECHANICAL FLOORPLAN, SCHEDULES, DETAILS, & NOTES

DRAWING NUMBER:
M-1