



711 N. FIELDER RD.  
 ARLINGTON, TX 76012  
 PH: (817) 635-5696  
 FAX: (817) 635-5699

DRAWING ISSUE	DATE
75% SUBMITTAL	02.12.10
95% PERMIT SUBMITTAL - LL REVIEW	02.24.10

**PRE-SECURITY  
 VENDING SHOP**  
 Portland International Jetport  
 1001 Westbrook Street  
 Portland, Maine



THE PARADISE SHOPS

SEAL:

REVIEWED & APPROVED BY: \_\_\_\_\_  
 PROJECT MANAGER INITIALS: T.L.  
 DATE: \_\_\_\_\_

NOTE: THIS DOCUMENT CONTAINS CONFIDENTIAL MATERIAL BELONGING EXCLUSIVELY TO PARADISE SHOPS ARCHITECTURE, LLC. UNAUTHORIZED REPRODUCTION, DISSEMINATION, OR DUPLICATION OF ANY OF THE INFORMATION CONTAINED HEREIN MAY RESULT IN LIABILITY APPLICABLE BY LAW. IT IS THE RESPONSIBILITY OF THE USER AND USER'S CLIENT TO ACT ON BEHALF OF THE CLIENT TO ENSURE THAT ALL DOCUMENTS ARE APPROVED BY AND FORWARDED TO THE RELEVANT GOVERNMENT. WE DO NOT ASSUME ANY RESPONSIBILITY OR LIABILITY FROM ANY PERSON, OR COMPANY, THAT REPRODUCES OR TRANSMITS THIS DOCUMENT WITHOUT OBTAINING A RELEASE.

PROJECT NUMBER:  
 2780

DRAWING NAME:  
**Barricade  
 Plan &  
 Details**

DRAWING NUMBER:  
**A-112**

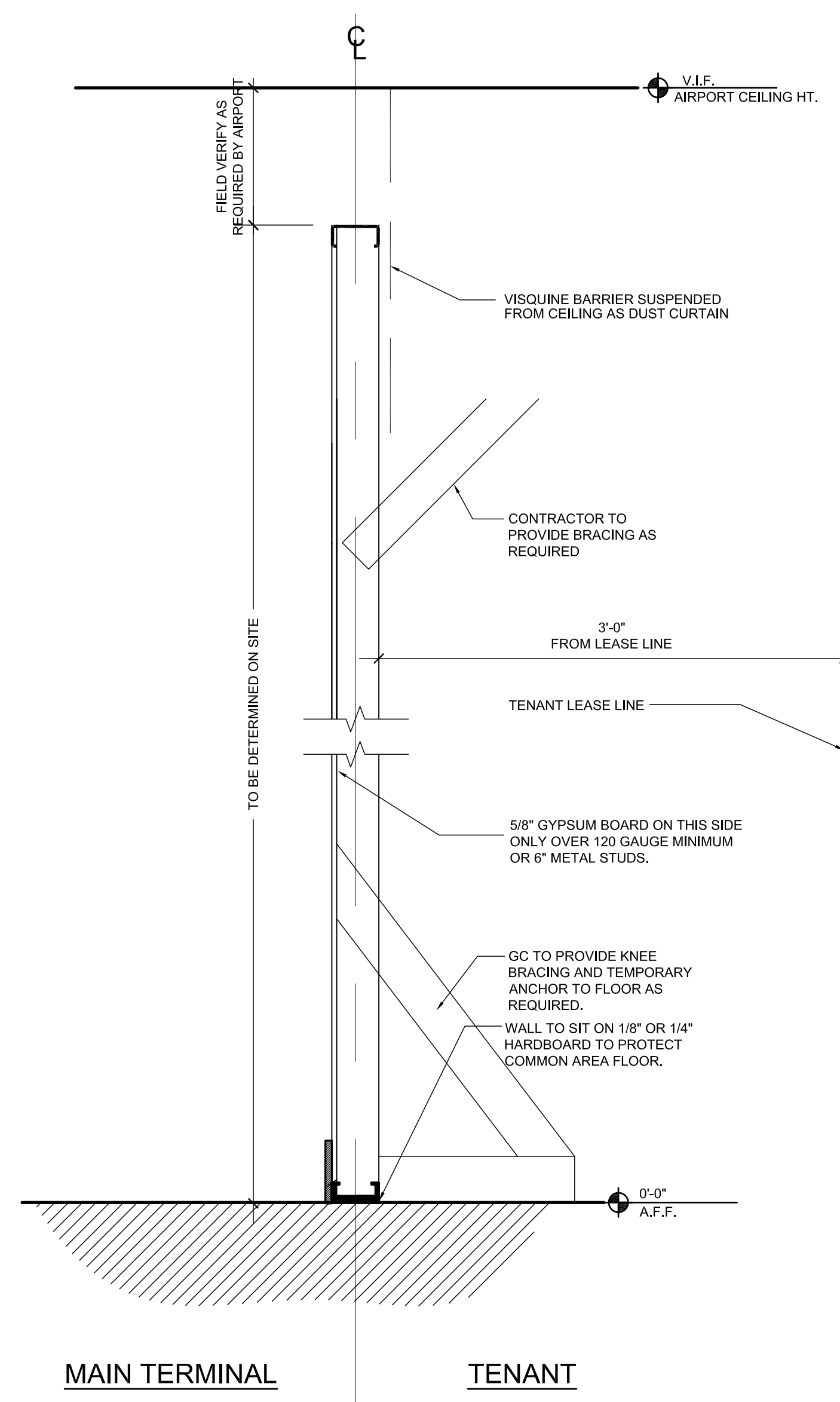

**NON RATED WALL**

TEMPORARY BARRICADE WALLS TO BE BRACED AS REQUIRED. CONTRACTOR TO CONFIRM GAUGE AND SPACING TO ENSURE PARTITIONS SUPPORT A LIVE LOAD OF 5 PSF.

**NOTE:**

1. CONTRACTOR TO PROVIDE ADDITIONAL BRACING IF REQUIRED.
2. JOINTS AND CORNERS TO BE FINISHED WITH MUD AND TAPE PRIOR PAINTING.

SECTION THRU TEMPORARY BARRICADE | 1 1/2" = 1'-0" | 3

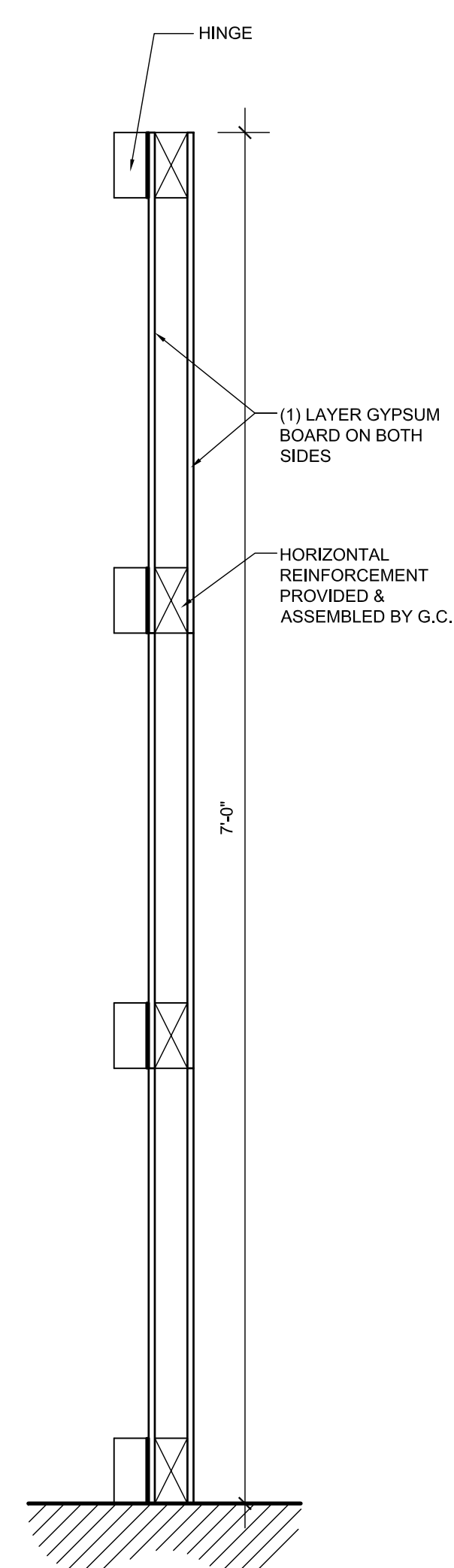

DOOR SECTION | 1 1/2" = 1'-0" | 2

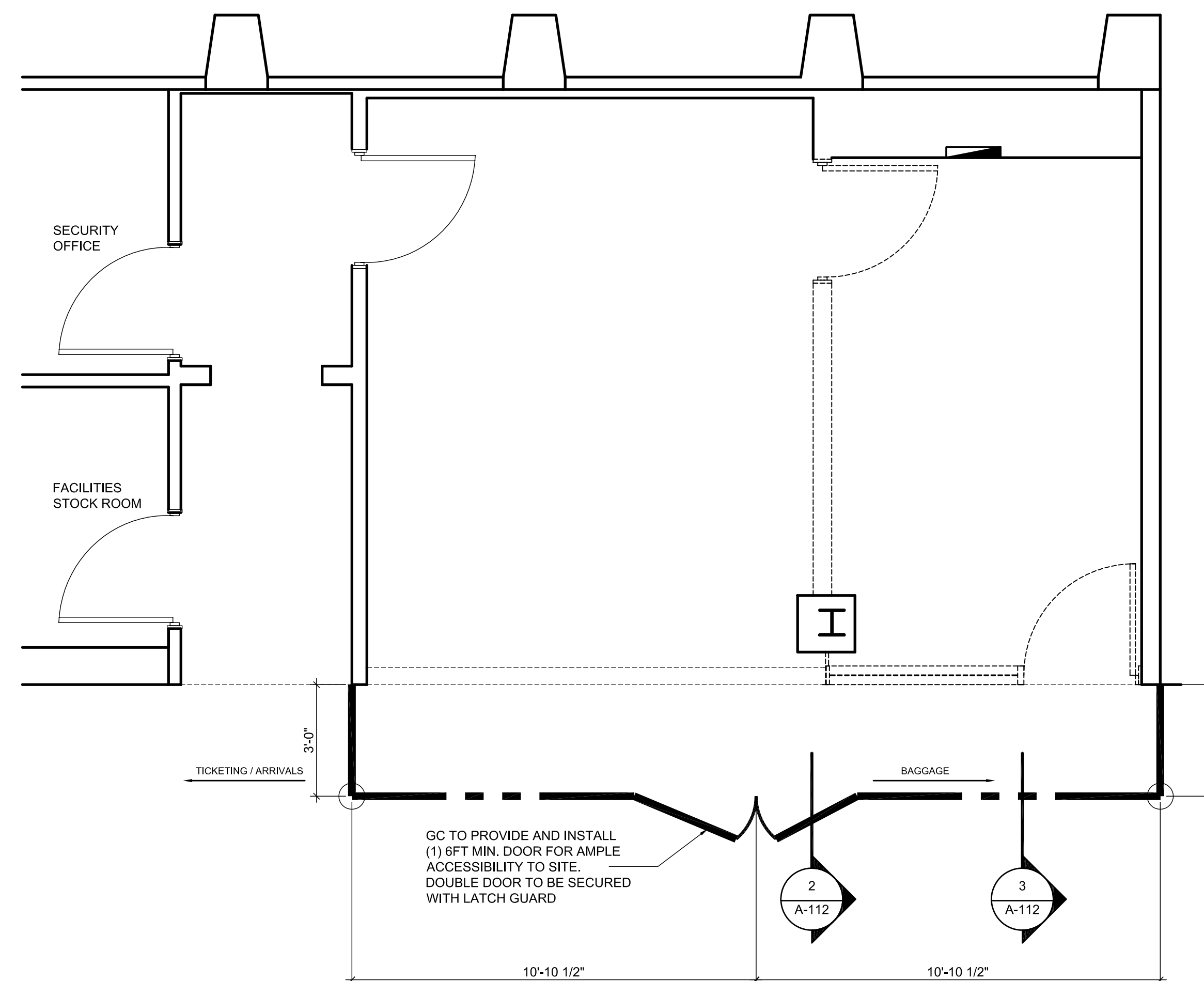

BARRICADE PLAN | 3/8" = 1'-0" | 1