

MAIN TERMINAL
LOWER LEVEL
SCOPE OF WORK
AREA 320.72 SQ. FT.

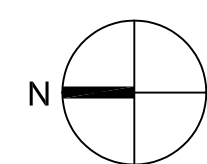
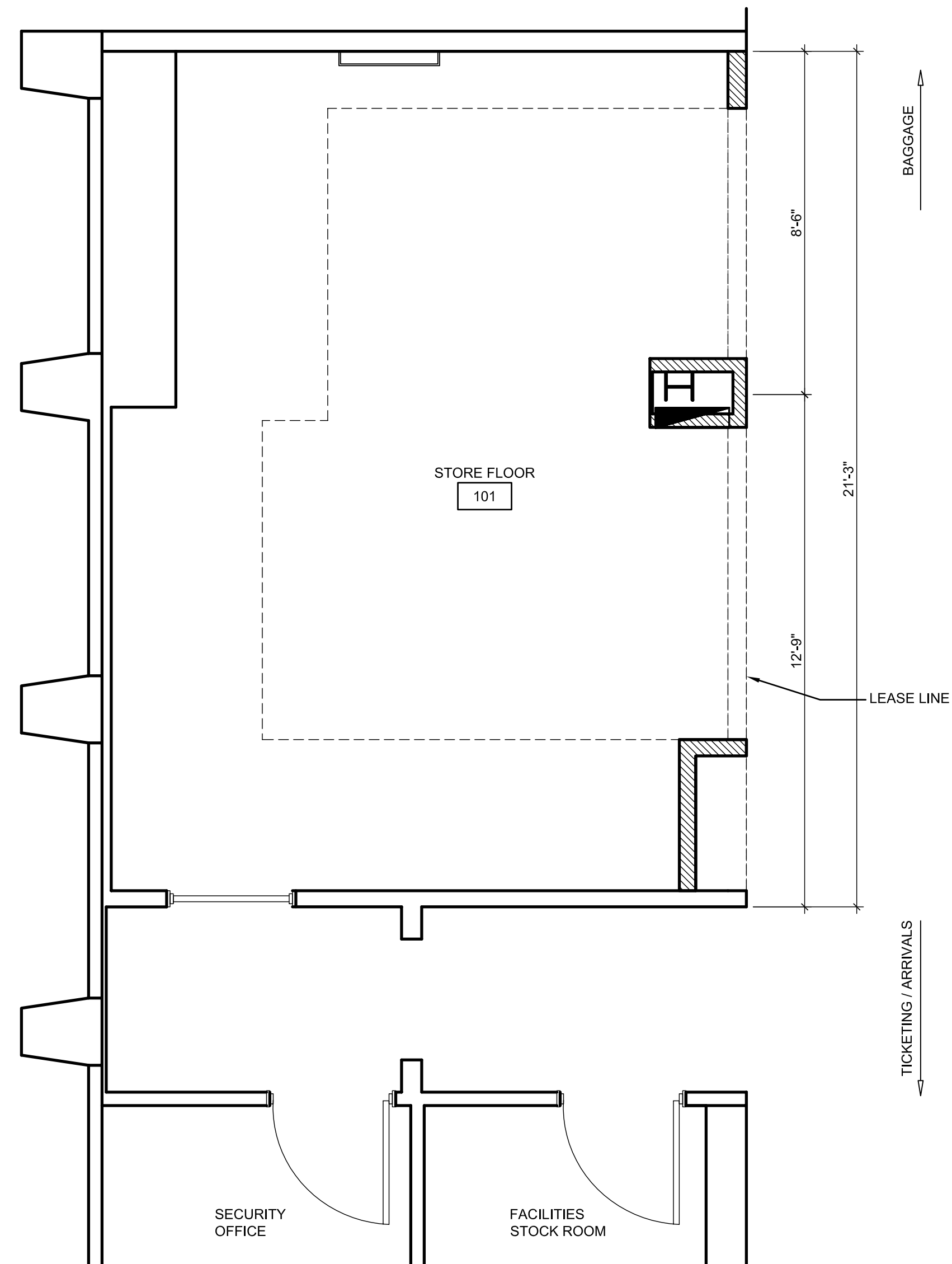
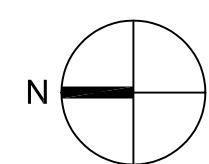
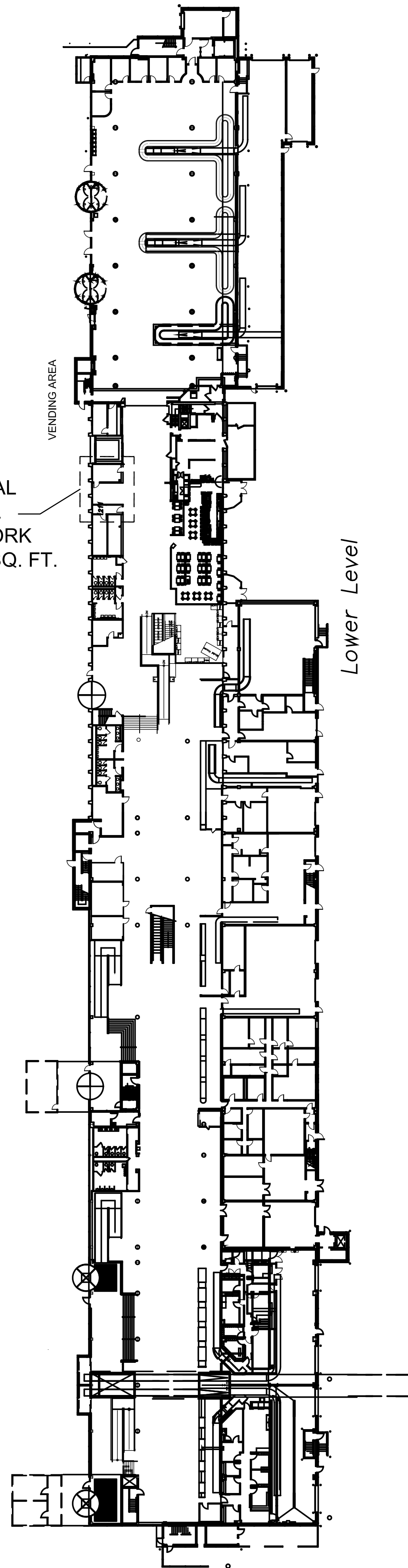

711 N. FIELDER RD.
ARLINGTON, TX 76012
PH: (817) 635-5696
FAX: (817) 635-5699

DRAWING ISSUE	DATE
75% SUBMITTAL	02.12.10
85% PERMIT SUBMITTAL - LL REVIEW	02.24.10

**PRE-SECURITY
VENDING SHOP**
Portland International Jetport
1001 Westbrook Street
Portland, Maine



THE PARADIES SHOPS

SEAL:

REVIEWED & APPROVED BY: _____

PROJECT MANAGER INITIALS: T.L.

DATE: _____

NOTE: THIS DOCUMENT CONTAINS CONFIDENTIAL MATERIAL BELONGING EXCLUSIVELY TO PARADISE SHOPS ARCHITECTURE, LLC. UNAUTHORIZED REPRODUCTION, DISSEMINATION, OR DUPLICATION OF ANY OF THE INFORMATION CONTAINED HEREIN MAY RESULT IN LIABILITY APPLICABLE BY LAW. IT IS THE RESPONSIBILITY OF THE USER AND USER'S CLIENT TO ACT ON HIS BEHALF TO ENSURE THAT ALL DOCUMENTS ARE APPROVED BY AND FORWARDED TO THE RELEVANT GOVERNMENT. WE DO NOT ASSUME ANY RESPONSIBILITY OR LIABILITY FROM ANY PERSON, OR COMPANY, THAT REPRODUCES OR OTHERWISE FILES WITHOUT OBTAINING A RELEASE.

PROJECT NUMBER:

2780

DRAWING NAME:

Site
Location
Plan

DRAWING NUMBER:

A-101