

DISPLAY THIS CARD ON PRINCIPAL FRONTAGE OF WORK

CITY OF PORTLAND

BUILDING DEPARTMENT

PERMIT

Permit Number: 100807

PERMIT ISSUED

JUL - 9 2010

Please Read Application And Notes, If Any, Attached

This is to certify that CITY OF PORTLAND / City of Portland has permission to install a 12,000 inground storage tank #2 oil AT 947 WESTBROOK ST

provided that the person or persons, firm or corporation accepting this permit shall comply with all of the provisions of the Statutes of Maine and of the Ordinances of the City of Portland regulating the construction, maintenance and use of buildings and structures, and of the application on file in this department.

Apply to Public Works for street line and grade if nature of work requires such information.

Notification of inspection must be given and written permission procured before this building or part thereof is lath or other work is set-in. 2 HOUR NOTICE IS REQUIRED.

A certificate of occupancy must be procured by owner before this building or part thereof is occupied.

OTHER REQUIRED APPROVALS

Fire Dept. CAPT. R. Lambert Health Dept. Appeal Board Other Department Name

Director - Building & Inspection Services

PENALTY FOR REMOVING THIS CARD

City of Portland, Maine - Building or Use Permit Application

389 Congress Street, 04101 Tel: (207) 874-8703, Fax: (207) 874-8716

Permit No: 10-0807	Issue Date:	CBL: 199 A001002
-----------------------	-------------	---------------------

Location of Construction: 947 WESTBROOK ST	Owner Name: CITY OF PORTLAND	Owner Address: 389 CONGRESS ST	Phone:
Business Name:	Contractor Name: City of Portland	Contractor Address: 389 Congress Street Portland	Phone 2078748300
Lessee/Buyer's Name	Phone:	Permit Type: Tanks - Commercial	Zone: AB

Past Use: Portland Jetport	Proposed Use: Portland Jetport - install a 12,000 inground storage tank #2 Fuel oil	Permit Fee: \$35.00	Cost of Work: \$35.00	CEO District: 3
-------------------------------	--	------------------------	--------------------------	--------------------

Proposed Project Description: install a 12,000 inground storage tank #2 Fuel oil	FIRE DEPT: <input checked="" type="checkbox"/> Approved <input type="checkbox"/> Denied <i>*See Conditions</i>	INSPECTION: Use Group: <i>Tanks</i> Type:
	Signature: <i>(Signature)</i>	Signature: <i>(Signature)</i>

PEDESTRIAN ACTIVITIES DISTRICT (P.A.D.)		
Action: <input type="checkbox"/> Approved <input type="checkbox"/> Approved w/Conditions <input type="checkbox"/> Denied	Signature:	Date:

Permit Taken By: Idobson	Date Applied For: 07/08/2010	Zoning Approval
-----------------------------	---------------------------------	------------------------

<ol style="list-style-type: none"> This permit application does not preclude the Applicant(s) from meeting applicable State and Federal Rules. Building permits do not include plumbing, septic or electrical work. Building permits are void if work is not started within six (6) months of the date of issuance. False information may invalidate a building permit and stop all work.. 	Special Zone or Reviews <input type="checkbox"/> Shoreland <input type="checkbox"/> Wetland <input type="checkbox"/> Flood Zone <input type="checkbox"/> Subdivision <input type="checkbox"/> Site Plan Maj <input type="checkbox"/> Minor <input type="checkbox"/> MMT <input type="checkbox"/>	Zoning Appeal <input type="checkbox"/> Variance <input type="checkbox"/> Miscellaneous <input type="checkbox"/> Conditional Use <input type="checkbox"/> Interpretation <input type="checkbox"/> Approved <input type="checkbox"/> Denied	Historic Preservation <input checked="" type="checkbox"/> Not in District or Landmark <input type="checkbox"/> Does Not Require Review <input type="checkbox"/> Requires Review <input type="checkbox"/> Approved <input type="checkbox"/> Approved w/Conditions <input type="checkbox"/> Denied
	Date: <i>7/8/10</i>	Date:	Date:

PERMIT ISSUED

JUL - 9 2010

City of Portland

CERTIFICATION

I hereby certify that I am the owner of record of the named property, or that the proposed work is authorized by the owner of record and that I have been authorized by the owner to make this application as his authorized agent and I agree to conform to all applicable laws of this jurisdiction. In addition, if a permit for work described in the application is issued, I certify that the code official's authorized representative shall have the authority to enter all areas covered by such permit at any reasonable hour to enforce the provision of the code(s) applicable to such permit.

SIGNATURE OF APPLICANT	ADDRESS	DATE	PHONE
RESPONSIBLE PERSON IN CHARGE OF WORK, TITLE		DATE	PHONE

City of Portland, Maine - Building or Use Permit

389 Congress Street, 04101 Tel: (207) 874-8703, Fax: (207) 874-8716

Permit No: 10-0807	Date Applied For: 07/08/2010	CBL: 199 A001002
------------------------------	--	----------------------------

Location of Construction: 947 WESTBROOK ST	Owner Name: CITY OF PORTLAND	Owner Address: 389 CONGRESS ST	Phone:
Business Name:	Contractor Name: City of Portland	Contractor Address: 389 Congress Street Portland	Phone (207) 874-8300
Lessee/Buyer's Name	Phone:	Permit Type: Tanks - Commercial	

Proposed Use: Portland Jetport - install a 12,000 inground storage tank #2 Fuel oil	Proposed Project Description: install a 12,000 inground storage tank #2 Fuel oil
---	--

Dept: Zoning Note:	Status: Approved with Conditions	Reviewer: Marge Schmuckal	Approval Date: 07/08/2010 Ok to Issue: ✓
Dept: Building Note:	Status: Approved	Reviewer: Tammy Munson	Approval Date: 07/09/2010 Ok to Issue: ✓
Dept: Fire Note:	Status: Approved with Conditions	Reviewer: Capt Keith Gautreau	Approval Date: 07/09/2010 Ok to Issue: ✓

1) Tank removal shall comply with NFPA # 1 chapter 66.2.5.5 and NFPA 30.
A copy is available upon request.

Comments: 7/7/2010-ldobson: Fee's will be from interoffice transfer

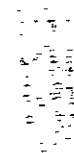
PERMIT ISSUED

JUL - 9 2010

City of Portland



General Building Permit Application

If you or the property owner owes real estate or personal property taxes or user charges on any property within the City, payment arrangements must be made before permits of any kind are accepted.

PORTLAND INTERNATIONAL AIRPORT

Location/Address of Construction: <u>1001 WESTBROOK ST. PORTLAND ME</u>		
Total Square Footage of Proposed Structure/Area <u>168,523 SF</u>	Square Footage of Lot <u>750 ACRES</u>	Number of Stories <u>3</u>
Tax Assessor's Chart, Block & Lot Chart# <u>199</u> Block# <u>A</u> Lot# <u>00/002</u>	Applicant *must be owner, Lessee or Buyer* Name <u>CITY OF PORTLAND</u> Address <u>389 CONGRESS ST</u> City, State & Zip <u>PORTLAND</u>	Telephone: <u>1-207-874-8877</u> <u>PAUL BRADSHAW</u>
Lessee/DBA (If Applicable)	Owner (if different from Applicant) Name Address City, State & Zip	Cost Of Work: \$ _____ C of O Fee: \$ _____ Total Fee: \$ <u>35.-</u>
Current legal use (i.e. single family) <u>COMMERCIAL</u> Number of Residential Units _____ If vacant, what was the previous use? _____ Proposed Specific use: <u>COMMERCIAL AIRPORT TERMINAL</u> Is property part of a subdivision? <u>NO</u> If yes, please name _____ Project description: <u>EXPANSION OF EXISTING BUILDING</u> <u>INSTALLATION OF UNDERGROUND FUEL TANK</u>		
Contractor's name: _____ Address: _____ City, State & Zip _____ Telephone: _____ Who should we contact when the permit is ready: <u>Cuyler</u> Telephone: <u>232-2310</u> Mailing address: _____		

Please submit all of the information outlined on the applicable Checklist. Failure to do so will result in the automatic denial of your permit.

In order to be sure the City fully understands the full scope of the project, the Planning and Development Department may request additional information prior to the issuance of a permit. For further information or to download copies of this form and other applications visit the Inspections Division on-line at www.portlandmaine.gov, or stop by the Inspections Division office, room 315 City Hall or call 874-8703.

I hereby certify that I am the Owner of record of the named property, or that the owner of record authorizes the proposed work and that I have been authorized by the owner to make this application as his/her authorized agent. I agree to conform to all applicable laws of this jurisdiction. In addition, if a permit for work described in this application is issued, I certify that the Code Official's authorized representative shall have the authority to enter all areas covered by this permit at any reasonable hour to enforce the provisions of the codes applicable to this permit.

Signature: Cuyler Date: 7/7/10

This is not a permit; you may not commence ANY work until the permit is issued

Department of Environmental Protection
17 State House Station
Augusta, ME 04333-0017
(207) 287-2651

**GENERAL INFORMATION FOR
REGISTRATION OF UNDERGROUND OIL STORAGE TANKS**

The purpose of this registration is to gather information on underground tanks that store or have stored petroleum products. Registration is required for all underground oil storage facilities regardless of tank size or type of petroleum product stored and regardless of whether the tanks are in service or out of service. The information you provide should be accurate and based upon reasonably available records, or, in the absence of such records, to the best of your knowledge or belief.

IMPORTANT: If applicable, Department policy requires the applicant's name on the registration to match the corporate name on file with the Secretary of State's office (Division of Corporations). Please submit a copy of your Information Summary sheet from the Division of Corporations with your application. This information can be found here: www.maine.gov/sos/cec/corp/index.html

1. Who must register an underground oil storage tank?

The tank owner is responsible for registering all tanks. Completed registration forms for new and replacement underground oil storage facilities and tanks must be submitted to the Department of Environmental Protection (DEP) at least ten (10) business days prior to installation. If the ownership of an existing tank is uncertain or in dispute, the current owner of the property where the tank(s) are located must register the tank(s). The registration requirements are set forth in Title 38, § 563, of the Maine Revised Statutes Annotated (MRSA) and in 06-096 CMR 691 § 4 of DEP rules.

2. What tanks must be registered?

All tanks that meet the state definition of underground oil storage tank must be registered. State law at 38 MRSA section 562-A, subsection 22 defines a tank as "any container, 10% or more of which is beneath the surface of the ground and which is used, or intended to be used, for the storage, use, treatment, collection, capture or supply of oil". The term does not include "any tanks situated in an underground area if these tanks or containers are situated upon or above the surface of a floor and in such a manner that they may be readily inspected". Underground piping must also be registered. Oil means "petroleum products and their by-products of any kind and in any form including, but not limited to, petroleum, fuel oil, motor oil, sludge, oil refuse, oil mixed with other waste, crude oil, and waste oil and all other liquid hydrocarbons regardless of specific gravity".

The following categories of tanks are exempt from the underground oil storage facility registration requirements of DEP rules. Tanks and piping located

aboveground where less than ten percent (10%) of the tank is located below ground septic tanks; pipeline facilities (including gathering lines) regulated under the Federal Natural Gas Pipeline Safety Act of 1968, or the Federal Hazardous Liquid Pipeline Safety Act of 1979; instate pipeline facilities regulated under State laws (38 MRSA § 563); surface impoundment's, pits, ponds or lagoons; surface water or waste water collection systems; flow-through process tanks except where used for treatment; liquid traps or associated gathering lines directly related to oil or gas production and gathering operations; and storage tanks situated in an underground area (such as a basement, cellar, mineworking, drift, shaft, or tunnel) if the storage tank is situated or above the surface of the floor and fully inspectable. Underground piping must be registered.

If you are in doubt as to whether you are the owner of an underground storage tank, you are encouraged to register the tank using this form.

3. What substances are covered in the term oil?

All liquid petroleum and petroleum products except propane are included by state law.

4. Where should I register?

Please send the registration form to: MDEP-BRWM, 17 State House Station, Augusta, ME 04333-0017 ATTN: Tank Registration section. A copy must also be filed with the local fire department, or if the facility is located in an unorganized township, with the Land Use Regulation Commission. Remember to keep a copy for your own records.

5. When should I register my tank?

Owners of underground oil storage tanks existing as of March 1, 1985 should have registered by February 1, 1986. Tanks proposed for installation after March 1, 1985 must be registered ten (10) days before installation.

6. Restrictions on tank location.

Maine law, 38 MRSA § 1391 and 06-096 CMR 692, Sections 3 and 4 may prohibit the siting of a new underground oil storage facility near drinking water supplies or on significant sand and gravel aquifers.

A. After September 30, 2001, a person may not register, install, or cause to be installed a new underground oil storage facility, referred to in this section as a "facility," that is:

- i. Within the source water protection area of a public drinking water supply mapped by the Department of Human Services (DHS) prior to the registration or installation of the facility, or within 1,000 feet of the public water supply, whichever is greater; or
- ii. Within 300 feet of a private water supply in existence at the time the facility owner applied to register the facility.

"Source Water Protection Area" means an area that contributes recharge water to a public water supply well for a public drinking water supply that is mapped by DHS. *The maps can be obtained at local town offices, or through the Maine Bureau of Health drinking water program at (207) 287-2070, or are available on the Maine Drinking Water Program website at www.maine.gov/dhs/eng/water/index.htm.*

- B. 06-096 CMR 692, Section 4 Prohibition on facilities in sand and gravel aquifers. A person may not install or cause to be installed an oil storage facility within a significant sand and gravel aquifer (herein "aquifer") mapped by the Maine Geologic Survey. This prohibition applies regardless of proximity to a public or private drinking water well.

NOTE: Significant Sand and Gravel Aquifer maps are available for inspection in most municipal offices and from the Maine Geological Survey, (207) 287-2801. Electronic versions are available from the Maine Office of Geographic Information System, <http://megis.maine.gov>.

7. Exemptions.

The siting prohibitions listed above in 6 A and B do not apply to:

- A. Replacement or expansion of a underground facility registered and installed on or before September 30, 2001, provided the replacement or expansion occurs on the same property and the owner or operator continues to pay the annual registration fee as required by 38 MRSA § 563(4). Failure to pay the annual fee disqualifies a facility from being considered exempt under this section.
- B. Conversion of an aboveground oil storage facility registered and installed on or before September 30, 2001, to an underground oil storage facility, provided the conversion occurs on the same property;
- C. A facility used solely for the storage of heating oil that is consumed on site;
- D. Underground piping associated with an aboveground oil storage facility; or
- E. A well located on the same property as a facility and serving only users on that property.

8. Variance.

The commissioner may grant a variance from the siting prohibition under some circumstances. See 38 MRSA, § 1394 and 06-096 CMR 692, Section 3 (B) and 4 (B) through (E) of the Departments' Rules. **A variance application can be obtained by contacting the DEP tanks licensing unit at (207) 287-2651.**

9. Penalties.

The registration of all underground oil storage tanks is critical to developing a sound environmental program for managing and locating these tanks. For this

reason, the Legislature has required that late fees and penalties be assessed to owners who neglect to properly register their tanks. Tank owners who knowingly fail to notify or who submit false information to the Department may be subject to a civil penalty of up to \$10,000 for each tank for which notification is not given or false information is submitted.

10. Questions and assistance.

For assistance in completing the registration form or answering questions about the rules for underground oil storage facilities, please call (207) 287-2651 and ask for someone in the Underground Storage Tank Program.

11. Amended registration.

Owners must amend the tank registration in writing to the DEP if:

- A. The facility is sold or otherwise transferred;
- B. The facility is modified, e.g., new tanks or piping, change of product stored; retrofitting of or changes in leak detection or overfill prevention equipment; etc.

Registration must be amended within ten (10) business days of the date of the change. For a change in ownership, the new owner is responsible for notifying the commissioner of the change. A person who has not submitted an amended registration as required must pay a late fee of \$100.

12. What registration fees are required?

A registration fee of \$100 is required for each tank [except for tank(s) serving single family residences] located at the facility beginning January 1, 2009 and every three (3) years thereafter upon receipt of a bill from the department.

The department will bill the underground oil storage tank owner after receiving and reviewing the registration materials. The department may prorate the fee for new installations to put all tank owners and operators on the same billing cycle.

Attach a check for the applicable registration fee, made payable to the State of Maine Groundwater Fund, and return this form to Attn: Tank Registration, Maine Department of Environmental Protection, 17 State House Station, Augusta, ME 04333-0017.

MAINE DEPARTMENT OF ENVIRONMENTAL PROTECTION

**REGISTRATION FORM
FOR UNDERGROUND OIL AND PETROLEUM PRODUCTS
STORAGE TANKS**

(Pursuant to 38 M.R.S.A. Section 563, 40 CFR Part 280)

STATE USE ONLY
DATE OF REGIST. / /

Instructions: Please complete both section A and B of this form. The first part of section A will help you determine if the Maine laws limiting the siting of new underground oil tanks applies to your facility. Section A-2 provides guidance for new facilities located near wells and water supplies and must be completed if you answered "no" to all of the questions in A-1. Section B covers the information necessary for all tank registrations regardless of where the facility is located.

SECTION A

**IF YOU ANSWER YES TO ANY OF THE QUESTIONS BELOW, THEN
YOUR FACILITY IS EXEMPT FROM THE SITING RESTRICTIONS.
CONTINUE TO SECTION B OF THE TANK REGISTRATION FORM.**

Recent legislation limits where new underground oil tanks maybe installed. (See 38 M.R.S.A. § 1391 & 06-096 CMR 692). The purpose of the legislation is to protect wells and water supplies from contamination. To determine if this law applies to your tank installation, please fill out section A of the tank registration form.

Section A-1

To determine if the Maine law governing siting of new underground oil tanks applies to your tank(s), please answer yes or no to the following questions:

1. Were all of the tanks you are registering installed before September 30, 2001?
 YES: **NO:**
2. Will the new facility be used solely to store heating oil that is consumed on site (not re-sold)?
 YES: **NO:**
3. Is the facility replacing an aboveground oil storage facility registered and installed before September 30, 2001 and presently on the same property?
 (If yes, please enter registration # here _____)
 YES: **NO:**
4. Is the facility replacing or expanding an underground oil storage facility presently on the same property and registered and installed on or before September 30, 2001?
 (If yes, please enter registration # here _____)
 YES: **NO:**

**IF YOU ANSWERED NO TO ALL OF THE QUESTIONS ABOVE THEN COMPLETE
SECTION A-2 [SEE NEXT PAGE].**

SECTION A-2

You must supply map coordinates of the corners of the fuel containing portions of the facility, and groundwater monitoring wells. All coordinates must be in UTM (Universal Transverse Mercator), North American Datum 1983 (NAD 83), Zone 19 North standards and must be sub-meter accuracy & precision. Map coordinate units for UTM are in **meters**.
(NOTE: Please do not submit state plane coordinates which are in feet.)

Based on your response to the questions in section A-1, you are preparing to register a facility that may be subject to the siting restrictions of 38 MRSA § 1391 & 06-096 CMR 692. To determine if and how these restrictions apply, please answer the following questions. **Please be sure your answers are accurate. Failure to provide accurate answers could result in delays of the installation of your underground oil storage facility.**

1. *Will any portion of the underground oil storage facility be installed after September 30, 2001?* If no, then Section A-2 does not apply to the tank(s) you are registering – go to Section B.
YES: NO:

2. *Will any portion of the facility be located within 300' of a private well or water supply?*
This does not include a private well located on the same lot as the facility and serving only users living on that property. The term "facility" includes tanks, product piping, dispensing facilities, vent piping and stage II vapor recovery piping (if required).
YES: NO:

3. *Will any portion of the facility be located within the source water protection area of a public drinking water supply mapped by the Department of Human Services or within 1000' of a public water supply, whichever is greater?* Maps of source water protection areas are available on the web at www.maine.gov/dhs/eng/water/index.htm. Public water supplies are defined as any well or water supply where water is obtained for, sold, furnished or distributed to the public for human consumption. To be a public water supply, the well or water supply must meet one or more of the following requirements:
YES: NO:
 - Serve more than 15 connections OR
 - Regularly serve at least 25 individuals daily for at least 60 days of the year OR
 - Provide bottled water for sale where the water is pumped from on site.

4. *Does the public well or water supply serve a school or community water supply system?* (A school is an institution for the formal classroom instruction of children in grades K-16. A community water system is a public water system that serves at least 15 service connections used by year-round residents or regularly serves at least 25 year-round residents.)
YES: NO:

5. *Will any portion of the facility be located within a mapped significant sand & gravel aquifer?*
YES: NO:

Maine law prohibits installation of USTs within significant sand and gravel aquifers mapped by the Maine Geological Survey unless a variance is obtain from the Department

of Environmental Protection (DEP). See 38 MRSA § 1394 and 06-096 CMR 692, section (3) (B) and (4) (B) through (E) of the Department's rules to determine if you are eligible to apply for a variance. In considering whether to grant a variance, the Commissioner may consider the importance of the groundwater resource, any engineering or monitoring measures proposed by the applicant, the geology of the site and other relevant factors.

If the answer to #2 or #4 above is YES then a new underground oil storage facility may not be installed unless the applicant proves there is no hydro-geologic connection between the proposed facility and the water supply at issue. Contact the DEP at (207)287-2651 to obtain information on the procedures to follow to determine if a hydrogeologic connection exists.

If the answer to #3 is YES (and the answer to #4 is NO) then a **variance from the siting restriction** may be granted upon written application if the DEP determines that the proposed installation is designed to exceed minimum regulatory requirements and will effectively minimize releases of oil and the likelihood of drinking water contamination. **PLEASE CONTACT THE DEPARTMENT FOR A VARIANCE APPLICATION.**

If the answer to #5 is YES Please review Chapter 692, Section (4)-(B) through (E) to determine if a variance may be applicable for the proposed site.

The commissioner shall not grant a variance from the prohibition in Chapter 692, section 3-B or section (4)(B) through (E) of the Department's Rules if any part of the proposed facility site overlies a mapped aquifer that has high potential as a future Public drinking water resource.

Department of Environmental Protection
17 State House Station
Augusta, ME 04333-0017
(207)287-2651

SECTION B

1. **REGISTRATION NUMBER:** 6743
(Complete only if a registration number has been previously assigned by the Maine Department of Environmental Protection.)

2. **FACILITY INFORMATION:**

Facility Name ,Corp. Name on file with the Secretary of State: Portland International Jetport

911 Street Address to Facility: 1001 Westbrook Street
911 Street Address *Apartment/Unit #*
Portland ME 04102
City *State* *Zip Code*

Mail Address to Facility: 1001 Westbrook Street
Street Address *Apartment/Unit #*
Portland ME 04102
City *State* *Zip Code*

Facility Phone Number: (207) 874-8877

Directions to Facility: The facility is the Portland International Jetport

3. TANK OWNER:

Current Owner: Portland International Jetport

Owner Mailing Address: 1001 Westbrook Street
Street Address *Apartment/Unit #*
Portland ME 04102
City *State* *Zip/Postal*

Current Owner Phone and Fax Number: (207) 874-8877 (207) 774-7740
Phone Number *Fax Number*

4. TANK OPERATOR (if different from owner):

Current Operator: _____

Owner Mailing Address: _____
Street Address *Apartment/Unit #*

City *State* *Zip/Postal*

Current Owner Phone and Fax Number: _____
Phone Number *Fax Number*

5. CONTACT PERSON: Roy Williams (207) 756-8026
Name *Phone Number*

6. FACILITY SITING:

- | | YES | NO |
|--|--------------------------|-------------------------------------|
| A. Are any planned or existing tank(s) (including piping and pumps) within 1000 feet of a public water supply source? | <input type="checkbox"/> | <input checked="" type="checkbox"/> |
| B. Are any planned or existing tank(s) (including piping and pumps) within 300 feet of a private water supply source? | <input type="checkbox"/> | <input checked="" type="checkbox"/> |
| C. (Complete if the answer to "B" above is YES.) Is the water supply which is located within 300 feet of the tank(s) owned by someone other than the facility owner or operator? | <input type="checkbox"/> | <input type="checkbox"/> |
| D. Is the facility located on a sand and gravel aquifer or recharge area as mapped by the Maine Geological Survey? | <input type="checkbox"/> | <input checked="" type="checkbox"/> |
| E. Is the facility located within a 100 year floor plain? Federal Emergency Management Agency (FEMA) maps showing floodplain locations are available at most municipal offices. | <input type="checkbox"/> | <input checked="" type="checkbox"/> |

NOTE: If you wish assistance in answering items (D) and (E), please call the Department at (207) 287-2651 and ask for staff within the tanks registration program. Sand and gravel aquifer maps can be reviewed at any of the Department's offices or purchased

for a nominal fee from the Maine Geological Survey, 22 State House Station, Augusta,
ME 04333 (207) 287-2801

7. FACILITY USE (check one):

- | | |
|--|---|
| <input type="checkbox"/> Wholesale Distribution of Oil | <input type="checkbox"/> Oil Storage at a Multi-family Residence |
| <input type="checkbox"/> Retail Distribution of Oil | <input type="checkbox"/> Oil Storage/Public Facility |
| <input type="checkbox"/> Oil Storage at a Commercial Establishment
for On-site Consumption | <input type="checkbox"/> Oil Storage at a Single Family Residence |
| <input type="checkbox"/> Oil Storage at an Industrial Establishment
for On-site Consumption | <input checked="" type="checkbox"/> Oil Storage/Municipal or Public School Facility |
| <input type="checkbox"/> Oil Storage/Federal Facility | <input type="checkbox"/> Oil Storage/State facility |
| <input type="checkbox"/> Oil Storage/Farm | |

8. ADDITIONAL INFORMATION:

The following information is required for all new and replacement facility registrations or piping upgrades/extensions. Additional information will be required if the facility may be subject to siting restrictions.

- A. A scale drawing of the proposed facility tied to a property marker or other permanent structure. The drawing must show the proposed location of all the tanks, piping and dispensers and other facility components intended to contain product (either as a liquid or vapor) relative to other site features, including existing buildings monitoring wells and adjacent roads. If this is a replacement or upgrade installation, then the drawing must show the location of the new tank or piping relative to existing tanks, piping and dispensers. For new or replacement motor fuel facilities or piping upgrades, the proposed location of the tank pad, piping runs and dispensers should be marked onsite.

See Attached

- B. For new or replacement motor fuel storage facility, a sketch showing distances and bearings to private wells within 400 feet and public water supplies within 1200 feet. See Attachment "A" for example.

See Attached

SHEET NOTES

Legend: Dimensions, Schedule

1. DIMENSIONS	2. SCHEDULE
3. DIMENSIONS	4. SCHEDULE
5. DIMENSIONS	6. SCHEDULE
7. DIMENSIONS	8. SCHEDULE
9. DIMENSIONS	10. SCHEDULE
11. DIMENSIONS	12. SCHEDULE
13. DIMENSIONS	14. SCHEDULE
15. DIMENSIONS	16. SCHEDULE
17. DIMENSIONS	18. SCHEDULE
19. DIMENSIONS	20. SCHEDULE
21. DIMENSIONS	22. SCHEDULE
23. DIMENSIONS	24. SCHEDULE
25. DIMENSIONS	26. SCHEDULE
27. DIMENSIONS	28. SCHEDULE
29. DIMENSIONS	30. SCHEDULE
31. DIMENSIONS	32. SCHEDULE
33. DIMENSIONS	34. SCHEDULE
35. DIMENSIONS	36. SCHEDULE
37. DIMENSIONS	38. SCHEDULE
39. DIMENSIONS	40. SCHEDULE
41. DIMENSIONS	42. SCHEDULE
43. DIMENSIONS	44. SCHEDULE
45. DIMENSIONS	46. SCHEDULE
47. DIMENSIONS	48. SCHEDULE
49. DIMENSIONS	50. SCHEDULE
51. DIMENSIONS	52. SCHEDULE
53. DIMENSIONS	54. SCHEDULE
55. DIMENSIONS	56. SCHEDULE
57. DIMENSIONS	58. SCHEDULE
59. DIMENSIONS	60. SCHEDULE
61. DIMENSIONS	62. SCHEDULE
63. DIMENSIONS	64. SCHEDULE
65. DIMENSIONS	66. SCHEDULE
67. DIMENSIONS	68. SCHEDULE
69. DIMENSIONS	70. SCHEDULE
71. DIMENSIONS	72. SCHEDULE
73. DIMENSIONS	74. SCHEDULE
75. DIMENSIONS	76. SCHEDULE
77. DIMENSIONS	78. SCHEDULE
79. DIMENSIONS	80. SCHEDULE
81. DIMENSIONS	82. SCHEDULE
83. DIMENSIONS	84. SCHEDULE
85. DIMENSIONS	86. SCHEDULE
87. DIMENSIONS	88. SCHEDULE
89. DIMENSIONS	90. SCHEDULE
91. DIMENSIONS	92. SCHEDULE
93. DIMENSIONS	94. SCHEDULE
95. DIMENSIONS	96. SCHEDULE
97. DIMENSIONS	98. SCHEDULE
99. DIMENSIONS	100. SCHEDULE

GENERAL NOTES

1. ALL DIMENSIONS UNLESS OTHERWISE NOTED ARE IN FEET AND INCHES.
2. ALL DIMENSIONS UNLESS OTHERWISE NOTED ARE TO FACE UNLESS OTHERWISE NOTED.
3. ALL DIMENSIONS UNLESS OTHERWISE NOTED ARE TO FACE UNLESS OTHERWISE NOTED.
4. ALL DIMENSIONS UNLESS OTHERWISE NOTED ARE TO FACE UNLESS OTHERWISE NOTED.
5. ALL DIMENSIONS UNLESS OTHERWISE NOTED ARE TO FACE UNLESS OTHERWISE NOTED.
6. ALL DIMENSIONS UNLESS OTHERWISE NOTED ARE TO FACE UNLESS OTHERWISE NOTED.
7. ALL DIMENSIONS UNLESS OTHERWISE NOTED ARE TO FACE UNLESS OTHERWISE NOTED.

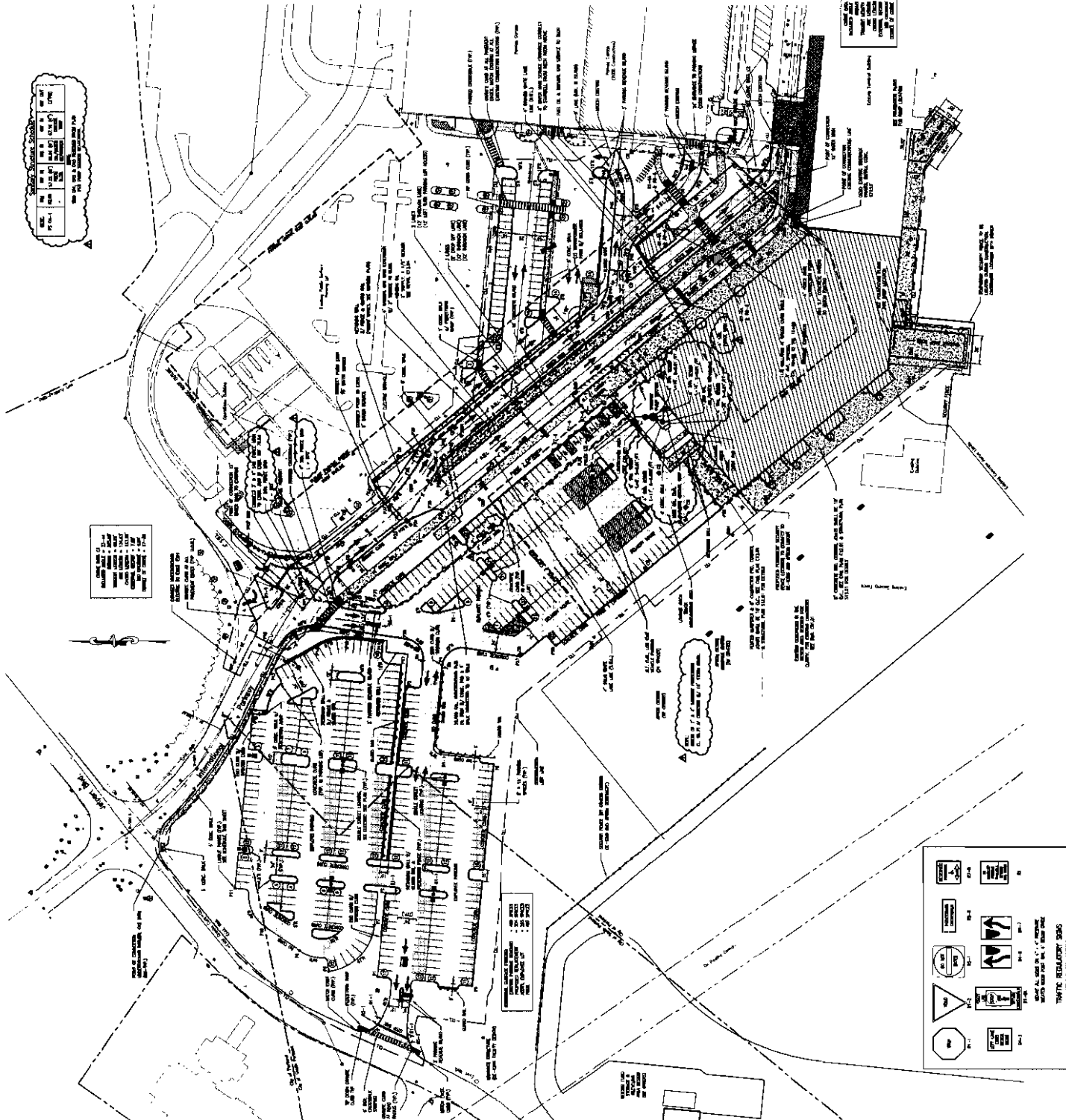

TRAFFIC REGULATORY SIGNS
SEE CITY CODE

	1		2
	3		4
	5		6
	7		8
	9		10
	11		12
	13		14
	15		16
	17		18
	19		20
	21		22
	23		24
	25		26
	27		28
	29		30
	31		32
	33		34
	35		36
	37		38
	39		40
	41		42
	43		44
	45		46
	47		48
	49		50



Sketch Number CSK-010 R1 Sheet Reference: C02.01 - RFI #0164

Project	PWM Terminal Enhancement	Project Number	533.01.32
Description	Relocate Pump Station	Issue/Rev	
Prepared by	WJW	Scale	1" = 20'
		Date	6/2/10

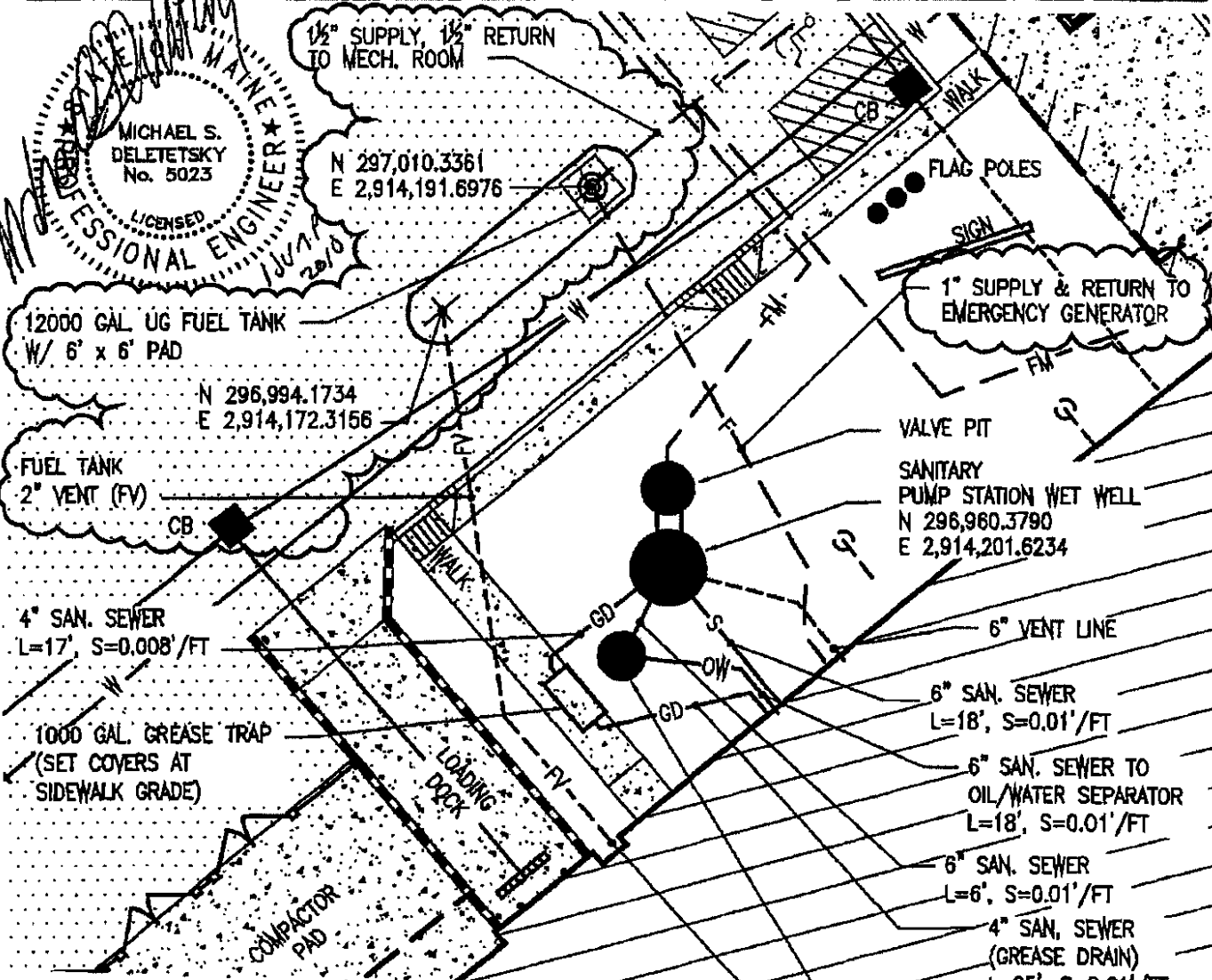

Sanitary Structure Schedule

DESC.	RIM	INV. IN	INV. IN	INV. IN	INV. OUT
PS OA-1	62.50	56.64 (6") FROM BLDG.	56.58 (6") OIL/WATER SEPARATOR	58.86 (4") GREASE TRAP	(3"FM) 55.25

RELOCATE PUMP STATION

SCALE: 1" = 20'

REFERENCE FROM C02.01

1

9. INDIVIDUAL TANK DATA: Complete for each tank

<p>A. Tank Type A.= Steel - bare or asphalt coated C.= Cathodic-Single Wall E.= Fiberglass-Single Wall G.= Fiberglass-Double Wall V.= Jacketed - Double Wall W.= Cathodic Steel - Double Wall N.= Other _____</p>	<p>D. Tank Leak Detection 0.=Unknown 4.=Manual Groundwater Sampling 5.=Automatic Tank Gauge 7.=Secondary Containment-Continuous Electronic 8.=Secondary Containment - Manual Monitoring 9.=SIA Statistical Inventory Analysis 10.=None</p>	<p>F. Tank Status A.=Planned B.=Active C.=Out of Service D.=Abandoned in Place (Filled) E.=Planned for Removal F.=Removed (Date)</p>
<p>B. Piping Type (same codes as tank) or D.=Steel w/ secondary O.=Copper X.=Flexible Single Wall Y.=Flexible-Double Wall Z.=Copper w/secondary</p>	<p>E. Product Stored 1.=Kerosene 2.=#2 Fuel Oil 5.=#5 Fuel Oil 19.=Unleaded Plus 23.=Unleaded Regular 24.=Aviation 25.=Jet Fuel 28.=Unleaded Premium 29.=Diesel 81.=Waste Oil 99.=Other (please specify)</p>	<p>G. Pump Type: (1) Suction (2) Pressure (3) Suction & Return (10)= None</p>
<p>C. Tank Size Size of Tank in gallons</p>		<p>H. Pipe Leak Detection (Use same Codes as Tank except): 6.= In-Line Leak Detector 11.= Conforming Suction System</p>
		<p>I. Dispenser Leak Detection 1.= Dispenser Sump 2.= Dispenser Sump & Continuous Electronic Monitoring 3.= n/a</p>
		<p>J. Overfill & Spill 2.=Electronic 90% Cap 5.=Automatic Shutoff (95% capacity) 6.=Automatic Alarm (90% Capacity) 7.=Vent Whistle</p>
		<p>K. Date Installed</p>

	A.	B.	C.	D.	E.	F.	G.	H.	I.	J.	K.
TANK #1											
TANK #2	G	Y	12,000	7	2	A	3	7	3	2 & 5	7/2010
TANK #3											
TANK #4											

10. **MAKE TWO (2) COPIES OF THIS FORM.** Submit the original to Attn: Tank Registration, Maine Department of Environmental Protection, 17 State House Station, Augusta, ME 04333-0017. Send one (1) copy to the local Fire Department having jurisdiction. Retain the third copy for your records. For new and replacement tank(s), the registration form is due at least ten (10) business days prior to installation.

Attach a check for the applicable registration fee, made payable to the State of Maine Groundwater Fund, and return this form to Attn: Tank Registration, Maine Department of Environmental Protection, 17 State House Station, Augusta, ME 04333-0017.

11. Your registration shall not be considered complete and will be returned to you if both Sections A and B are not completed.

12. **IF NEW, REPLACEMENT OR RETROFITTING EXISTING TANKS OR PIPING ARE INCLUDED WITH THIS REGISTRATION, PLEASE PROVIDE:**

Name of Installer: Arthur Grant Installer ID Number: 021

Date of Planned Installation: July 2010

13. **CERTIFY THIS FORM BY SIGNING.** By signing this form, I, the tank registrant, certify that all information is accurate and complete to the best of my knowledge, and that I will comply with all applicable federal, state, and local laws and regulations concerning the underground storage of petroleum products. The owner or operator is required by Maine statutes to file an amendment to this registration with the Department of Environmental Protection immediately upon any change of information contained in this form.

Owner or Authorized Employee of Owner Signature 6.22.2010
Roy S. Williams P.E. LEED AP, Deputy Director
Engineering and Facilities 6.22.2010
Title (Please Print or Type) Date



STATE OF MAINE
DEPARTMENT OF ENVIRONMENTAL PROTECTION

JOHN ELIAS BALDACCI
GOVERNOR

DAVID P. LITTELL
COMMISSIONER

June 24, 2010

Portland International Airport
1001 Westbrook Street
Portland, ME. 04102
Attn: Roy Williams

RE: Portland International Jetport

Dear Mr. Williams:

This letter is to acknowledge the Department's receipt of your registration materials on June 23, 2010 for either a new tank and piping or the replacement of ancillary equipment at Portland International Airport, Portland, Maine. Maine Statute dictates that the installation may take place ten (10) business days following Department notification (38 M.R.S.A., Section 563 1. A.). This installation may begin on June 29, 2010. Have a copy of your registration and display this letter in a prominent place during the construction or replacement activities.

NOTE: Please note it is the owners responsibility to ensure that the installer complete and submit the Certification of Proper Installation to the Department within thirty (30) days of completing the project (Chapter 691, Section 5 B. (4) (g).

If you have any questions or concerns, I can be reached at (207) 287- 2651.

Sincerely,

John M Dunlap
Division of Oil and Hazardous Waste Facilities Regulation
Bureau of Remediation and Waste Management

P.c. Arthur Grant # 021

AUGUSTA
17 STATE HOUSE STATION
AUGUSTA, MAINE 04333-0017
(207) 287-7688 FAX: (207) 287-7826
RAY BLDG., HOSPITAL ST.

BANGOR
106 HOGAN ROAD
BANGOR, MAINE 04401
(207) 941-4570 FAX: (207) 941-4584

PORTLAND
312 CANCO ROAD
PORTLAND, MAINE 04103
(207) 822-6300 FAX: (207) 822-6303

PRESQUE ISLE
1235 CENTRAL DRIVE, SKYWAY PARK
PRESQUE ISLE, MAINE 04769-2094
(207) 764-0477 FAX: (207) 760-3143



STATE OF MAINE

Date of Certificate:

06/24/2010

DEPARTMENT OF ENVIRONMENTAL PROTECTION

FACILITY REGISTRATION CERTIFICATE FOR
Above Ground and Underground Storage Tanks

Please display this certificate in a visible location at the registered facility.

Facility:

PORTLAND INTERNATIONAL JETPORT
1001 WESTBROOK ST
PORTLAND

Facility Registration Number:

6743

Date of Registration:

September 25, 1986

Facility Phone:

207-772-0690

Operator:

PORTLAND CITY OF
1001 WESTBROOK ST
PORTLAND
ME 04102

207-772-0466

Sensitive Area Status:

Facility Use:

Town "&" School

Owner:

PORTLAND CITY OF
1001 WESTBROOK ST
PORTLAND
ME 04102

207-772-0466

Above Ground and Underground Storage Tanks

Number of Active Aboveground Tanks: 1

Number of Active Underground Tanks: 1

If the information on this form is accurate and complete, please retain for your records.

The Maine Department of Environmental Protection must be notified of any errors or changes in the information on this form. To accomplish this, please draw a line through the incorrect or outdated information, insert the correct information, and return this form to:

Department of Environmental Protection Bureau of Remediation and Waste Management
State House Station # 17 Augusta, ME 04333

Attn: Underground Tanks Program

If you have any questions concerning this process, please call (207)287-2651 and ask for the administrator of the Underground Storage Tanks program.

INDIVIDUAL TANK DATA FOR SITE NUMBER: 6743

Tank	Tank Under/ Above ground	Tank Type	Tank Size	Tank Monitoring	Date Tank Installed	Tank Status	Tank Status Date
1	Underground	Steel - bare or asphalt coated.	8000	Unknown	01/01/1978	Removed	09/11/1995

Chamber	Chamber Size	Product Stored	Pipe Under/ Above ground	Date Installed	Pipe Monitoring	Piping Type	Overfill Protection
1	8000	#2 Fuel Oil	Underground	01/01/1978	Unknown	Copper	Unknown

INDIVIDUAL TANK DATA FOR SITE NUMBER: 6743

Tank	Tank Under/ Above ground	Tank Type	Tank Size	Tank Monitoring	Date Tank Installed	Tank Status	Tank Status Date
2	Underground	Steel - bare or asphalt coated.	10000	Unknown	01/01/1980	Removed	11/01/1994

Chamber	Chamber Size	Product Stored	Pipe Under/ Above ground	Date Installed	Pipe Monitoring	Piping Type	Overfill Protection
1	10000	#2 Fuel Oil	Underground	01/01/1980	Unknown	Copper	Unknown

INDIVIDUAL TANK DATA FOR SITE NUMBER: 6743

Tank	Tank Under/ Above ground	Tank Type	Tank Size	Tank Monitoring	Date Tank Installed	Tank Status	Tank Status Date
3	Underground	Steel - bare or asphalt coated.	2000	Unknown	01/01/1975	Removed	09/01/1991

Chamber	Chamber Size	Product Stored	Pipe Under/ Above ground	Date Installed	Pipe Monitoring	Piping Type	Overfill Protection
1	2000	#2 Fuel Oil	Underground	01/01/1975	Unknown	Copper	Unknown

INDIVIDUAL TANK DATA FOR SITE NUMBER: 6743

Tank	Tank Under/ Above ground	Tank Type	Tank Size	Tank Monitoring	Date Tank Installed	Tank Status	Tank Status Date
4	Underground	Steel - bare or asphalt coated.	2000	Unknown	01/01/1978	Removed	12/05/1996

Chamber	Chamber Size	Product Stored	Pipe Under/ Above ground	Date Installed	Pipe Monitoring	Piping Type	Overfill Protection
1	2000	#2 Fuel Oil	Underground	01/01/1978	Unknown	Copper	Unknown

INDIVIDUAL TANK DATA FOR SITE NUMBER: 6743

Tank	Tank Under/ Above ground	Tank Type	Tank Size	Tank Monitoring	Date Tank Installed	Tank Status	Tank Status Date
5	Underground	Steel with cathodic protection.	6000	SIA Statistical Inventory Analysis	11/01/1987	Removed	10/07/1999

Chamber	Chamber Size	Product Stored	Pipe Under/ Above ground	Date Installed	Pipe Monitoring	Piping Type	Overfill Protection
1	6000	Diesel	Underground	11/01/1987	SIA Statistical Inventory Analysis	Steel with cathodic protection.	Unknown

INDIVIDUAL TANK DATA FOR SITE NUMBER: 6743

Tank	Tank Under/ Above ground	Tank Type	Tank Size	Tank Monitoring	Date Tank Installed	Tank Status	Tank Status Date
6	Underground	Steel with cathodic protection.	4000	SIA Statistical Inventory Analysis	11/01/1987	Removed	10/07/1999

Chamber	Chamber Size	Product Stored	Pipe Under/ Above ground	Date Installed	Pipe Monitoring	Piping Type	Overfill Protection
1	4000	Unleaded Gasoline	Underground	11/01/1987	SIA Statistical Inventory Analysis	Steel with cathodic protection.	Unknown

INDIVIDUAL TANK DATA FOR SITE NUMBER: 6743

Tank	Tank Under/ Above ground	Tank Type	Tank Size	Tank Monitoring	Date Tank Installed	Tank Status	Tank Status Date
7	Underground	Steel - bare or asphalt coated.	5000	Unknown	10/01/1969	Removed	10/01/1987

Chamber	Chamber Size	Product Stored	Pipe Under/ Above ground	Date Installed	Pipe Monitoring	Piping Type	Overfill Protection
1	5000	Unknown Substance	Underground	10/01/1969	Unknown	Other	Unknown

INDIVIDUAL TANK DATA FOR SITE NUMBER: 6743

Tank	Tank Under/ Above ground	Tank Type	Tank Size	Tank Monitoring	Date Tank Installed	Tank Status	Tank Status Date
8	Underground	Steel - bare or asphalt coated.	4000	Unknown	10/01/1969	Removed	10/01/1987

Chamber	Chamber Size	Product Stored	Pipe Under/ Above ground	Date Installed	Pipe Monitoring	Piping Type	Overfill Protection
1	4000	Diesel	Underground	10/01/1989	Unknown	Other	Unknown

INDIVIDUAL TANK DATA FOR SITE NUMBER: 6743

Tank	Tank Under/ Above ground	Tank Type	Tank Size	Tank Monitoring	Date Tank Installed	Tank Status	Tank Status Date
9	Underground	Steel - bare or asphalt coated.	4000	Unknown	10/01/1989	Removed	10/01/1987

Chamber	Chamber Size	Product Stored	Pipe Under/ Above ground	Date Installed	Pipe Monitoring	Piping Type	Overfill Protection
1	4000	Diesel	Underground	10/01/1989	Unknown	Other	Unknown

INDIVIDUAL TANK DATA FOR SITE NUMBER: 6743

Tank	Tank Under/ Above ground	Tank Type	Tank Size	Tank Monitoring	Date Tank Installed	Tank Status	Tank Status Date
10	Underground	F/glass - sec contain - petro & alcohol	10000	Secondary Containment / Cont Elec Mon	10/20/1995	Active	10/20/1995

Chamber	Chamber Size	Product Stored	Pipe Under/ Above ground	Date Installed	Pipe Monitoring	Piping Type	Overfill Protection
1	10000	#2 Fuel Oil	Underground	04/06/2006	Secondary Containment / Cont Elec Mon	Flexible double-walled	Electronic

INDIVIDUAL TANK DATA FOR SITE NUMBER: 6743

Tank	Tank Under/ Above ground	Tank Type	Tank Size	Tank Monitoring	Date Tank Installed	Tank Status	Tank Status Date
11	Aboveground	Steel with secondary containment.	10000	Secondary Containment / Cont Elec Mon	11/01/1999	Active In Service	12/12/2006

Chamber	Chamber Size	Product Stored	Pipe Under/ Above ground	Date Installed	Pipe Monitoring	Piping Type	Overfill Protection
1	4000	Unleaded Gasoline	Underground	11/01/1999	Secondary Containment / Cont Elec Mon	Flexible double-walled	Unknown
2	6000	Diesel	Underground	11/01/1999	Secondary Containment / Cont Elec Mon	Flexible double-walled	Unknown

INDIVIDUAL TANK DATA FOR SITE NUMBER: 6743

Tank	Tank Under/ Above ground	Tank Type	Tank Size	Tank Monitoring	Date Tank Installed	Tank Status	Tank Status Date
12	Underground	F/glass - sec containment - petro only	12000	Secondary Containment / Cont Elec Mon	08/23/2010	planned for installation	08/23/2010

Chamber	Chamber Size	Product Stored	Pipe Under/ Above ground	Date Installed	Pipe Monitoring	Piping Type	Overfill Protection
1	12000	#2 Fuel Oil	Underground	08/23/2010	Secondary Containment / Cont Elec Mon	Flexible double-walled	Drop Tube