

Sanitary Structure Schedule

DESC.	RIM	INV. IN	INV. IN	INV. IN	INV. OUT
PS DA-1	62.50	56.54 (6')	56.58 (6')	56.66 (6')	55.29

Layout Coordinate Schedule

Symbol	North	East
P1	297322.37022913503	1698
P2	297311.8652913610	1677
P3	297298.1852913613	1661
P4	297241.27542913501	1721
P5	297175.219652913775	1470
P6	297202.53912913491	1484
P7	297255.02012913549	656
P8	297384.6742913529	2270
P9	297420.5322913535	9138
P10	297463.81522913545	5383
P11	297502.24272913616	6040
P12	297480.54022913638	1418
P13	297452.22892913694	3531
P14	297398.35322913625	8652
P15	297358.0562913634	6865
P16	297316.8312913630	6140
P17	297293.51582913601	2507
P18	297463.81522913610	1526
P19	297384.6742914027	7209
P20	297248.5682914139	4235
P21	296838.6242914443	2027
P22	296818.9072914497	8773
P23	296808.23462914528	0050
P24	296805.382914528	5679
P25	297395.77462913651	0271
P26	297285.3252913634	8086
P27	297141.8442913612	4516
P28	297097.24362913626	2555
P29	296886.8172914102	0366
P30	297003.12802914035	7411
P31	297252.46012913685	5222
P32	297312.14652914016	6668
P33	297302.39882914074	2370
P34	297276.41162914088	9125
P35	297251.88442914100	5778
P36	297240.62202914098	3013
P37	297311.81962914107	9558
P38	297283.38252914139	1261
P39	297262.03122914188	1185
P40	297243.92122914189	8987
P41	297243.10872914155	5881
P42	297227.8082914172	1205
P43	297049.39512914350	5263
P44	297031.46362914384	2176
P45	297011.1827914488	2924
P46	297031.24262914527	3495
P47	297008.24292914535	5252
P48	297006.5292914147	2276
P49	296988.42252914450	3326
P50	296958.63912914443	8237
P51	296910.24262914544	4563
P52	296902.0142914419	5164
P53	296859.30662914443	0018
P54	296833.58552914461	2515

AS-BUILT SEWER SCHEDULE

STRUCTURE	RIM EL.	INV. IN	INV. IN	INV. IN	INV. OUT	REMARKS
SMH 1	74.79	67.98 (3'FM)	67.89 (4'FM)	67.70 (8')	67.70 (8')	EXIST. SMH
PUMP STATION 1	62.47	55.97 (4')	56.08 (6')	56.27 (6')	55.51 (3'FM)	
VALVE PIT 1	62.28	55.55 (3'FM)	55.55 (3')	55.58 (3'FM)	55.58 (3'FM)	
OIL/WATER SEP.	62.12	56.52 (6')		56.33 (6')		
GREASE TRAP	61.92	56.78 (4')		56.59 (4')		

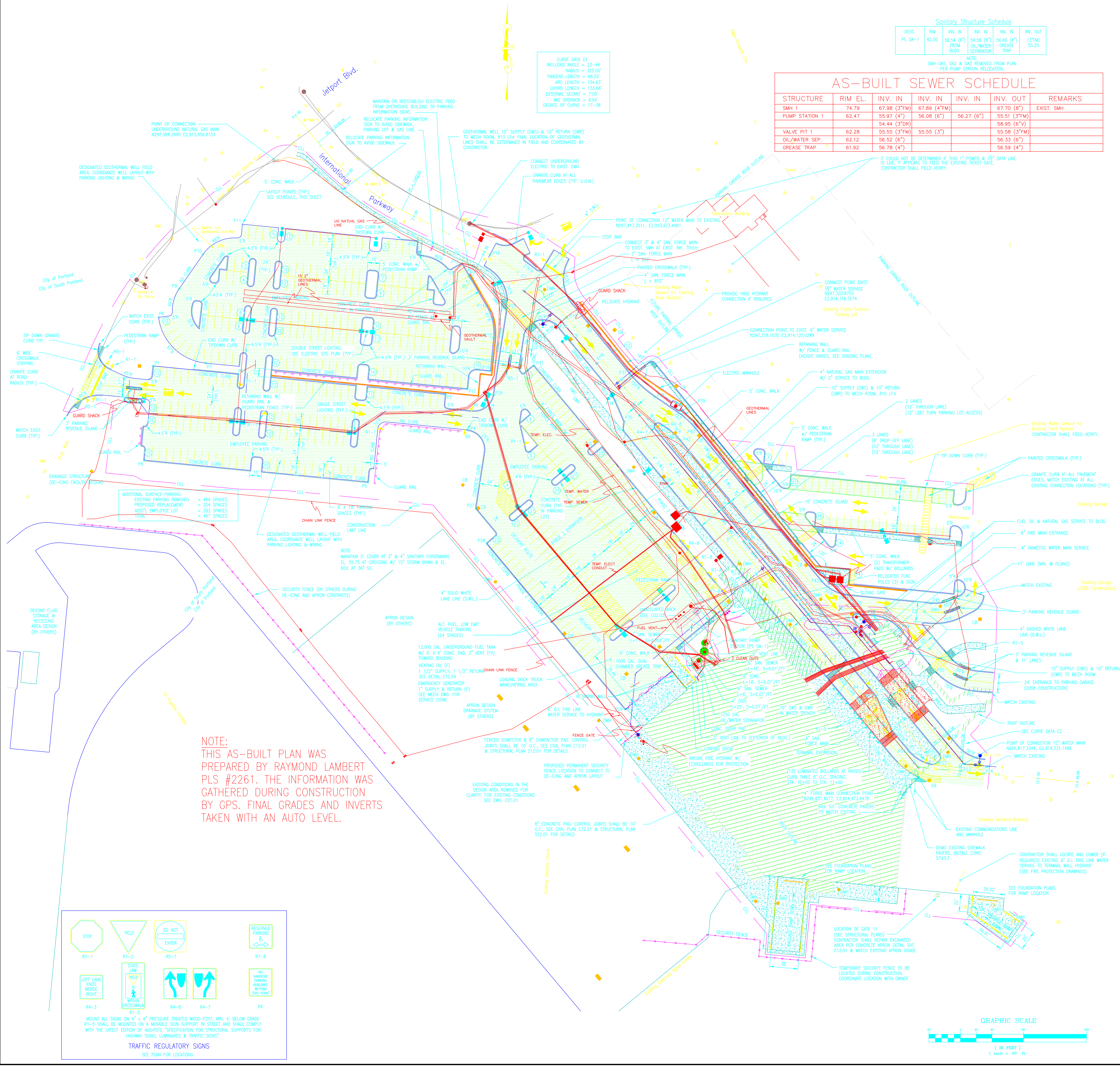

CURVE DATA C1
 INCLUDED ANGLE = 23-44
 RADIUS = 329.00'
 TANGENT LENGTH = 68.29'
 ARC LENGTH = 134.63'
 CHORD LENGTH = 133.60'
 EXTERNAL SCANT = 7.09'
 MID ORDNATE = 6.94'
 DEGREE OF CURVE = 17-38

NOTE:
 SMH, DAT, GAS & DAT REMOVED FROM PLAN PER PUMP STATION RELOCATION.

IT COULD NOT BE DETERMINED IF THIS 1" POWER & 1/2" DATA LINE IS LINE. IT APPEARS TO FEED THE EXISTING TICKET GATE. CONTRACTOR SHALL FIELD VERIFY.

ADDITIONAL SURFACE PARKING
 EXISTING PARKING REMOVED = 489 SPACES
 PROPOSED REPLACEMENT = 204 SPACES
 KEVIN'S EMPLOYEE LOT = 283 SPACES
 TOTAL = 497 SPACES

NOTE:
 THIS AS-BUILT PLAN WAS PREPARED BY RAYMOND LAMBERT PLS #2261. THE INFORMATION WAS GATHERED DURING CONSTRUCTION BY GPS. FINAL GRADES AND INVERTS TAKEN WITH AN AUTO LEVEL.

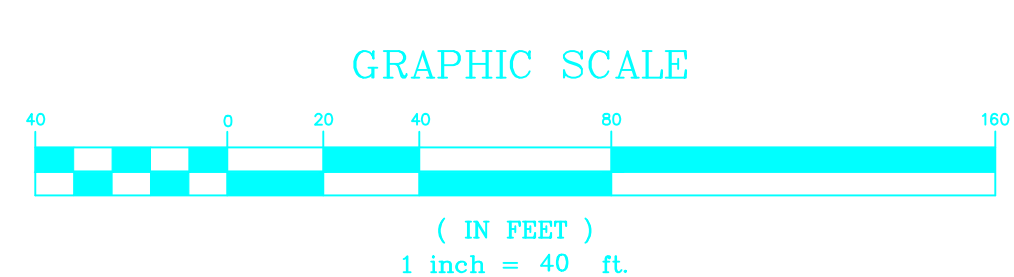
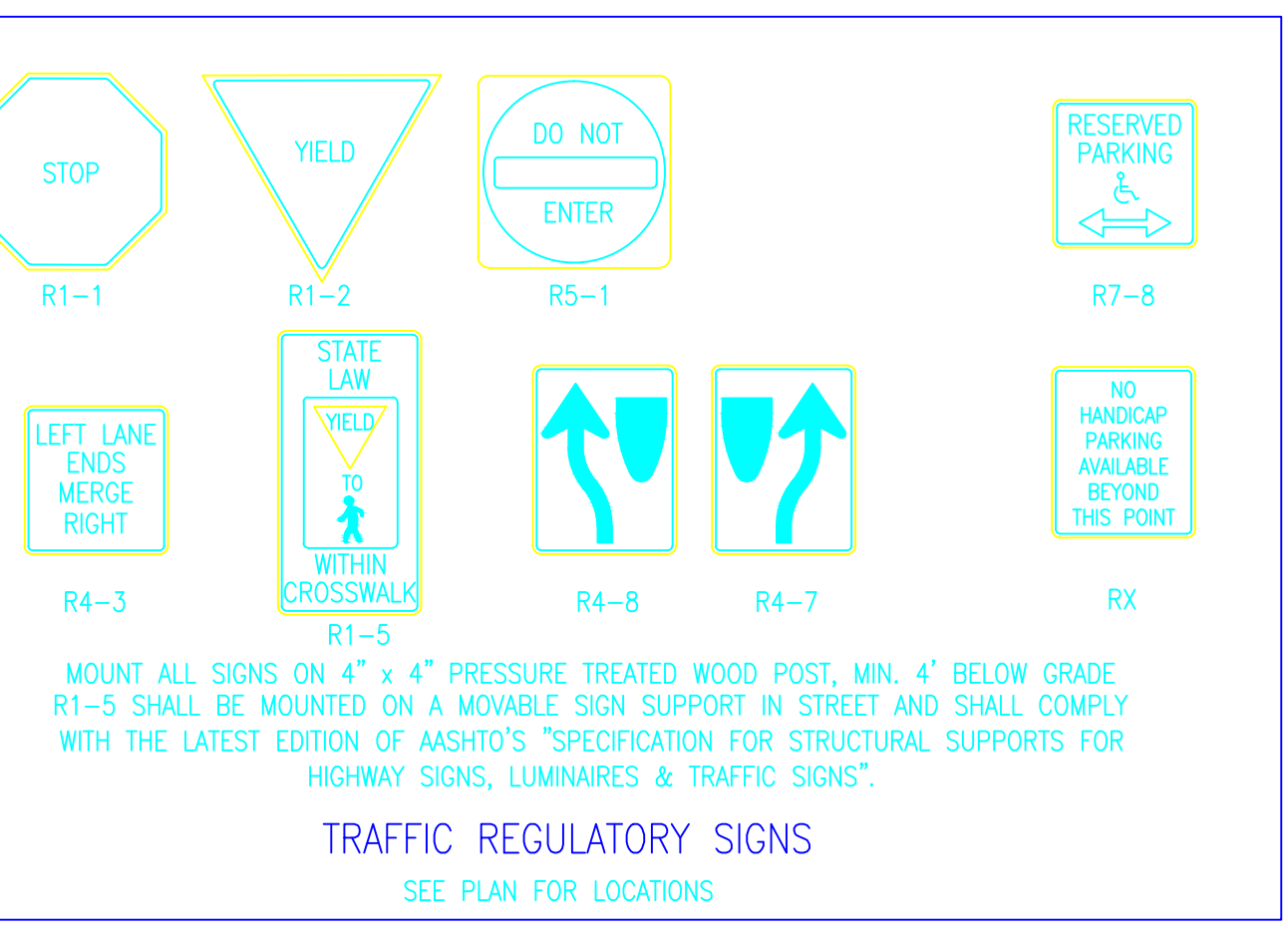

SCOPE DELINEATION AND GENERAL WORK SEQUENCING

1. SITE CONTRACTOR (SC) CLEARS, GRUBS AND STOCKPILES TOPSOIL
2. SC INSTALLS RETENTION POND AND CONSTRUCTS RETAINING WALL
3. SC INSTALLS SILT FENCE/HAY BALES TO PROTECT RETENTION POND
4. SC EXCAVATES EXISTING SOIL (WEST AND CENTRAL PORTION OF WELL FIELD) AND PLACES FILL (EAST PORTION OF WELL FIELD) TO A LEVEL 2 FEET BELOW FINISH PAVEMENT GRADE
5. SC TURNS WELL FIELD/PARKING LOT AREA OVER TO GEOTHERMAL SUBCONTRACTOR (GSC)
6. GSC INSTALLS WELLS, MANAGES DRILLWATER AND MANAGES DRILL CUTTINGS
7. GSC EXCAVATE TRENCHES, INSTALLS PIPE CURBS, TESTS, BACKFILLS AND COMPACTS TRENCH BACKFILL TO A LEVEL 2 FEET BELOW FINISH PAVEMENT GRADE
8. GSC TURNS WELL FIELD/PARKING LOT AREA BACK OVER TO SC
9. SC INSTALLS ELECTRICAL FEEDS
10. SC PROFFROLLS SUBGRADE
11. SC PLACES AND COMPACTS SUBBASE AND BASE MATERIALS, SETS CURBS
12. SC PLACES PAVEMENT BINDER AND TOP COURSES, TEMPORARY STRIPPING

--	1	07/11/08	W/W	AWL
--	2	09/22/08	W/W	AWL
--	3	12/03/08	W/W	AWL
--	4	01/23/09	W/W	AWL
--	5	10/26/09	W/W	FEM
		11/12/09	W/W	FEM
		01/12/10	W/W	TM
		02/05/10	W/W	MSD
		05/03/10	W/W	MSD
		05/03/10	W/W	MSD
		05-21-10	W/W	MSD
X	11	--/--/10	CSK-0121	revised geothermal lines

CURVE DATA C2
 INCLUDED ANGLE = 45-03
 RADIUS = 66.00'
 TANGENT LENGTH = 27.37'
 ARC LENGTH = 51.90'
 CHORD LENGTH = 50.57'
 EXTERNAL SCANT = 5.45'
 MID ORDNATE = 5.03'
 DEGREE OF CURVE = 86-49

GORHAM SAND AND GRAVEL
 939 PARKER FARM ROAD
 BUXTON, MAINE 04093
 (207)-839-2442