

SHEET NOTES

01 REMOVE AND RE-USE LIGHTING IN THIS AREA TO ACCOMMODATE THE REMOVAL AND REPLACEMENT OF CEILING GRID. NOTE ELECTRICAL CIRCUITS, CLEAN FIXTURES, RELAMP AS NECESSARY AND REFER TO THE ARCHITECTURAL DRAWINGS FOR EXACT EXTENT OF REMOVED CEILING SPACE.

Portland International Jetport

1001 Westbrook Street
Portland, Maine 04102

Gensler
2020 K Street, NW
Suite 200
Washington, DC 20006
Telephone 202.721.5200
Facsimile 202.872.8587

nest ASSOCIATES, INC.
343 Gorham Road, South Portland, ME 04106
P: (207) 761-1770 F: (207) 774-1246 www.nest.com
engineers - architects - surveyors - construction managers

amec
343 Gorham Road, South Portland ME 04106
P: (207) 761-1770 F: (207) 774-1246 www.amec.com

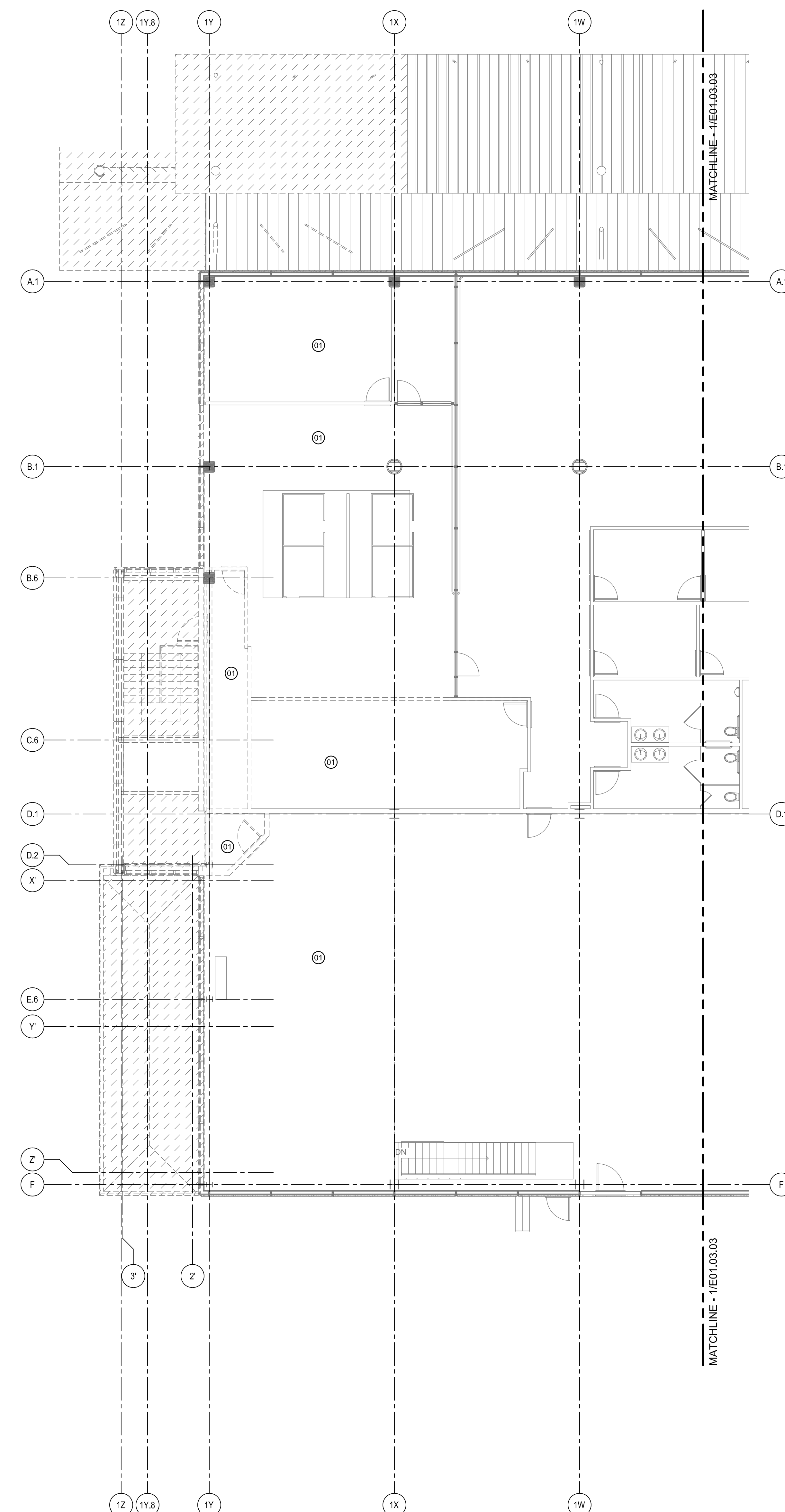

THESE DRAWINGS ARE ISSUED FOR CONSTRUCTION AND REFLECT ALL AMEC ISSUED BULLETINS AND SKETCHES.

| Issue | Date & Issue Description | By | Check |
|-------|--------------------------|-----|-------|
| 01 | 12/03/08 | LAM | BHG |
| 02 | 01/23/09 | LAM | BHG |
| 03 | 10/26/09 | LAM | BHG |
| 04 | 11/02/09 | LAM | BHG |
| 05 | 09/01/11 | LAM | BHG |

GENERAL NOTES

- A. SEE SHEET E00.00 FOR LEGEND AND GENERAL NOTES.
- B. ALL DEVICES BEING REMOVED SHALL HAVE ALL ASSOCIATED CONDUIT & WIRING REMOVED BACK TO SOURCE.

Seal/Signature

Project Name
PJM Terminal Enhancement

Project Number
09-0395-000

CAD File Name
C:\AMEC\330111\E1.03.04.dwg

Description
ELECTRICAL DEMOLITION PLAN - LEVEL 3 - ZONE 4

Scale
1/8" = 1'-0"

Ref. North

KEY PLAN

