

ELEV 8 - SIDE ELEVATION  
SCALE: 1/2" = 1'-0" A10.32

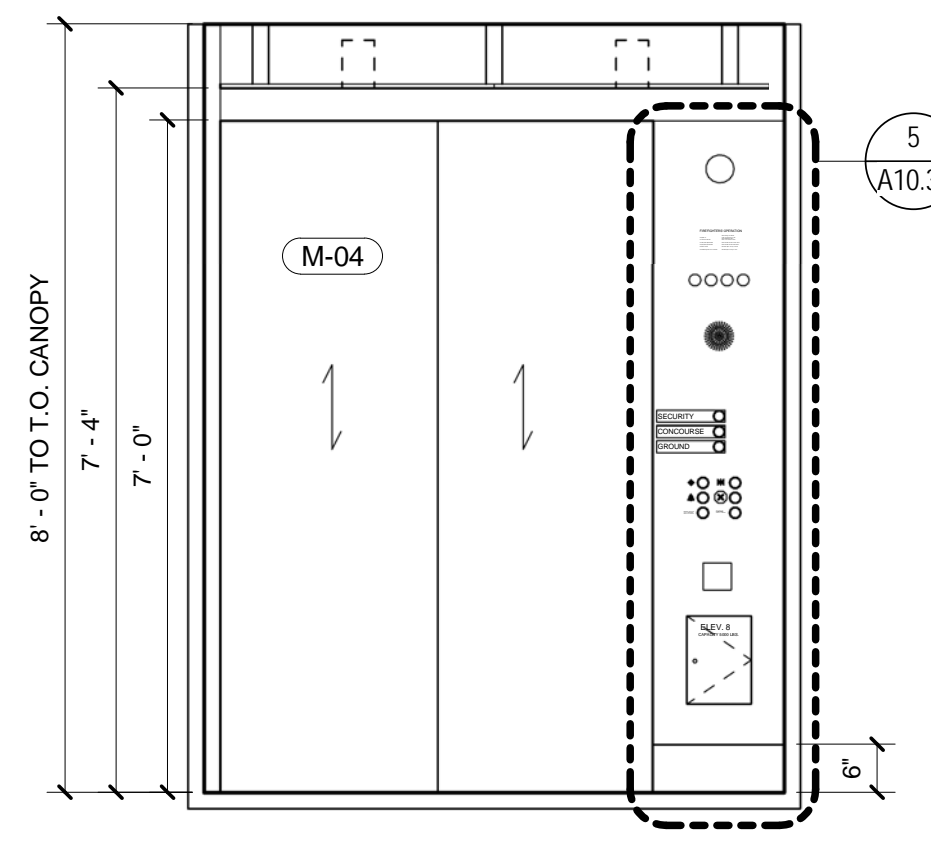

ELEV 8 - FRONT/REAR ELEVATION  
SCALE: 1/2" = 1'-0" A10.32

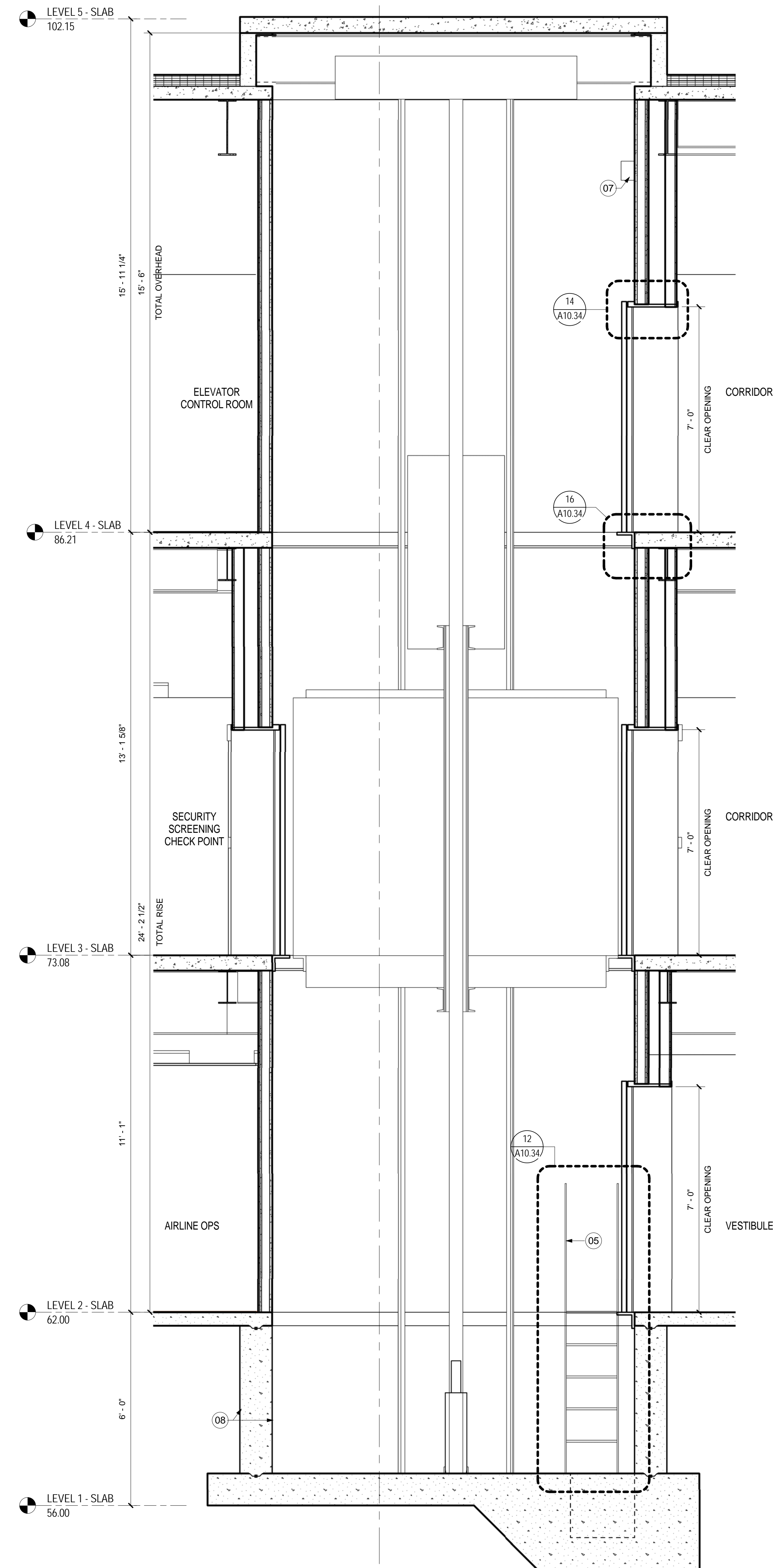

ELEVATOR 8 - SECTION  
SCALE: 1/2" = 1'-0" A10.32

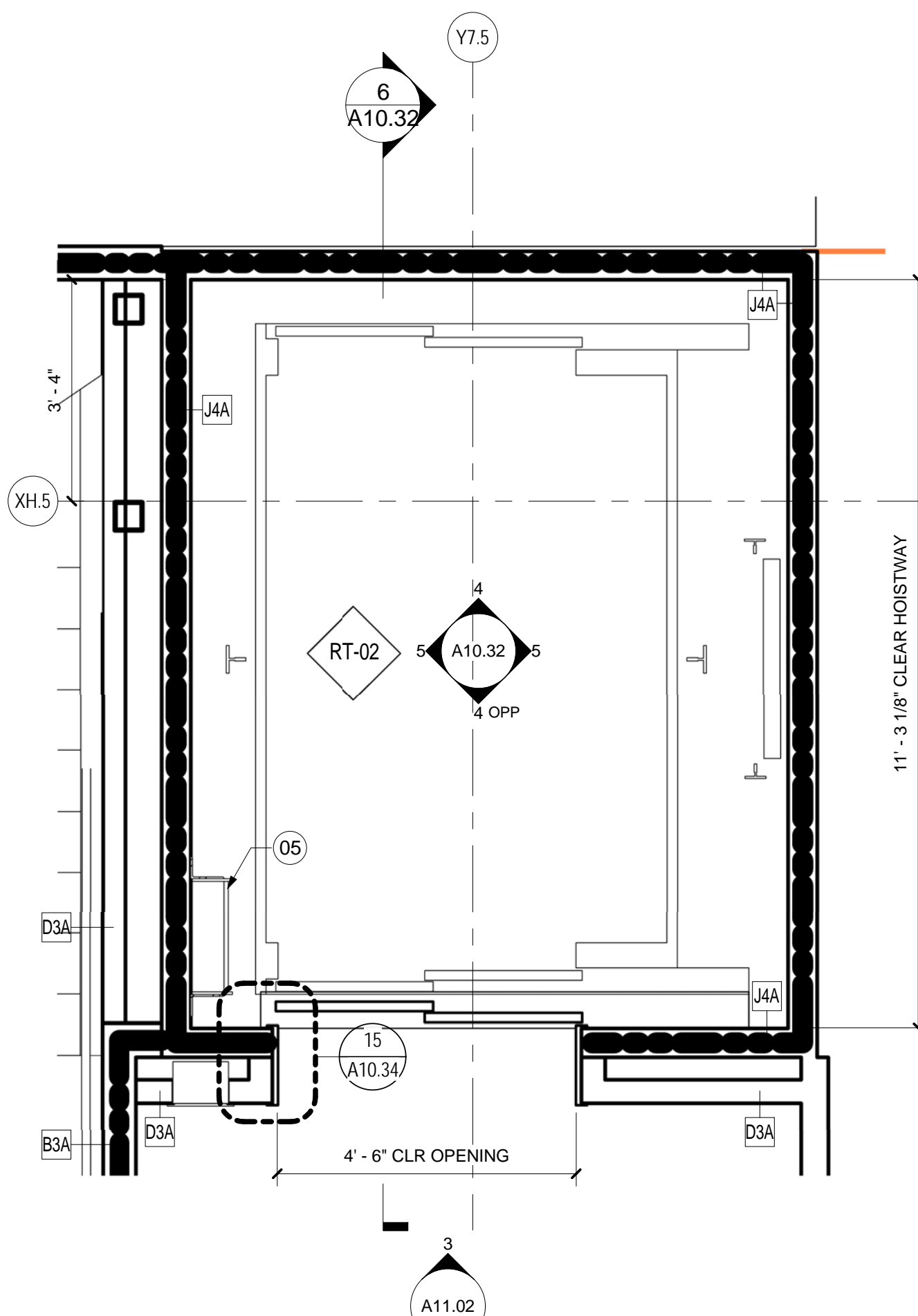

ELEV 8 - PLAN LVL 2 (LVL 4 SIM)  
SCALE: 1/2" = 1'-0" A02.02.05

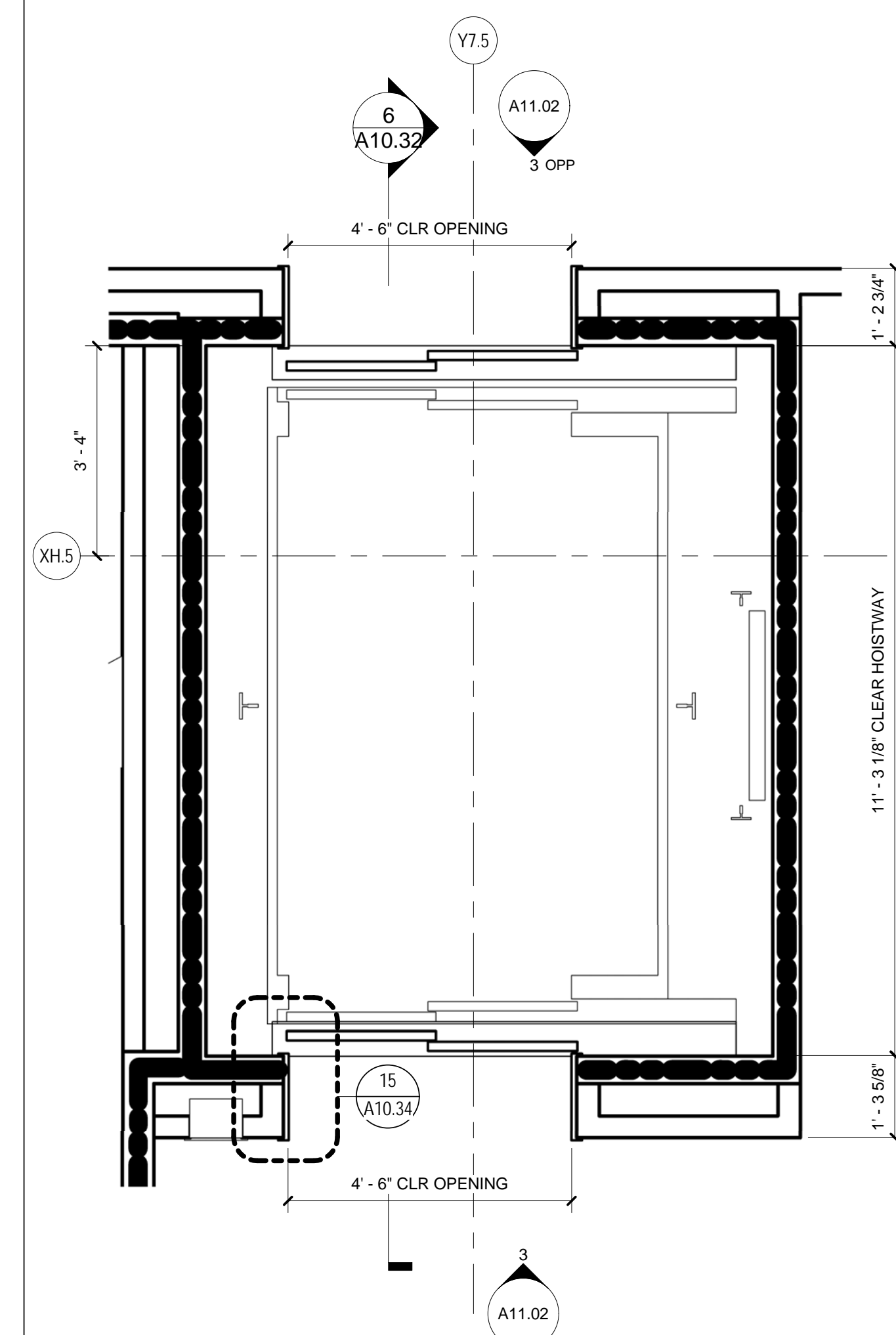

ELEVATOR 8 - PLAN LEVEL 3  
SCALE: 1/2" = 1'-0" A02.03.05

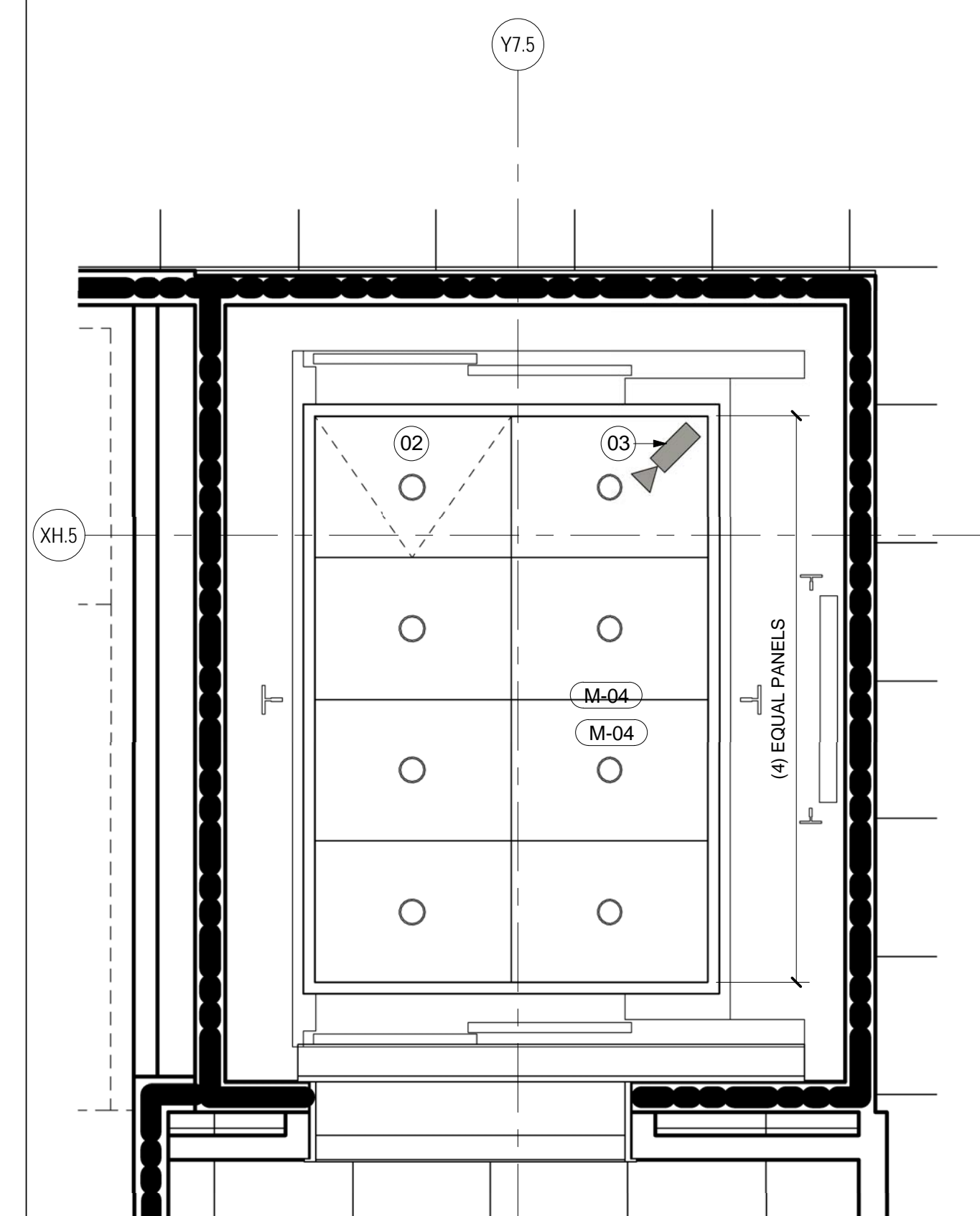

ELEVATOR 8 RCP  
SCALE: 1/2" = 1'-0" A04.02.05

**SHEET NOTES**

- 01 SIDE WALLS OF ELEVATOR CAB IS CLEAR GLASS. COORDINATE WITH ELEVATOR MANUFACTURER.
- 02 EMERGENCY ACCESS PANEL
- 03 CCTV SECURITY CAMERA
- 04 1 1/2" DIAMETER STAINLESS STEEL HANDRAIL
- 05 PIT LADDER
- 06 ALL EXPOSED STEEL AND WALLS WITH IN SHAFT TO BE PAINTED. RE: FINISH PLAN FOR FINISH
- 07 HOISTWAY LIGHT FIXTURE WITH WIRE GUARD. MOUNTED PER ELEVATOR MANUFACTURERS REQUIREMENTS.
- 08 PROVIDED METAL OXIDE WATER PROOFING AND WATER STOPS IN AND AROUND PIT. RE: SECTION 07 16 19 IN THE PROJECT MANUAL FOR MORE INFORMATION.
- 09 LINE OF SILL BELOW
- 10 STRUCTURAL STEEL. RE: STRUCTURAL DRAWINGS FOR ADDITIONAL INFORMATION.
- 11 PROVIDE STAINLESS STEEL FASCIA TO COVER CAB EXTERIOR ON GLASS SIDE ONLY

**GENERAL NOTES**

- A ALL PIT DIMENSIONS AND CAB SIZES TO BE COORDINATED WITH SELECTED MANUFACTURER UPON PROCUREMENT
- B MANUFACTURER TO PROVIDE ALL ELEMENTS TO COMPLY WITH ALL GOVERNING CODES.
- C GLASS SIDE WALL ELEVATORS TO BE PER ELEVATOR MANUFACTURERS DRAWINGS. ELEVATIONS AND DETAILS ARE FOR DESIGN INTENT ONLY.

Portland International  
Jetport  
1001 Westbrook Street  
Portland, Maine 04102

**Gensler**  
2020 K Street, Northwest  
Suite 200  
Washington, DC 20006  
Telephone: 202.721.5200  
Facsimile: 202.872.8587

Date	Description
09/22/08	DESIGN DEVELOPMENT
12/03/08	75% CONSTRUCTION DOCUMENTS
01/23/09	95% CONSTRUCTION DOCUMENTS
10/26/09	ISSUED FOR PERMIT
145 09/01/11	ISSUED FOR CONSTRUCTION

Seal/Signature

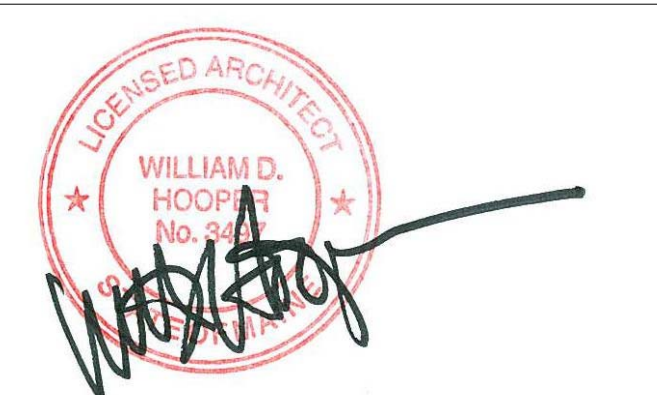

Project Name  
PWM Terminal Enhancement

Project Number  
09.6395.000

Description  
VERTICAL CIRCULATION - ELEVATOR #8

Scale  
As indicated

**A10.32**

© 2009 Gensler