

1 / A04.04.06

1 / A04.04.06

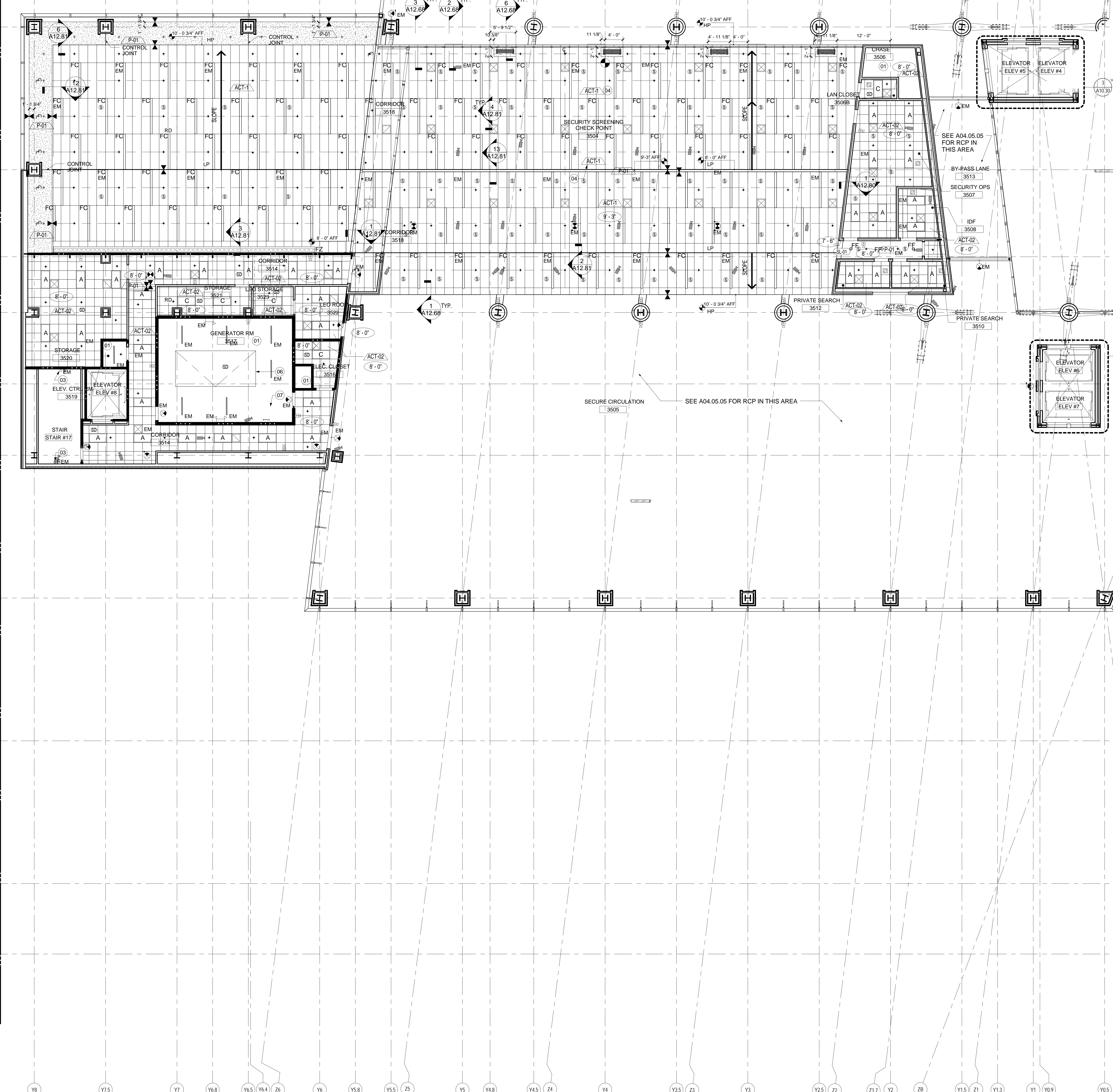

SHEET NOTES

- 01 NO CEILING
- 02 CONTROL JOINT. REFER TO 06/A12.80
- 03 PROVIDE LIGHT FIXTURE AT EVERY STAIR LANDING U.O.N. REFER TO ELECTRICAL ENGINEER DRAWINGS FOR MORE INFORMATION.
- 04 RE: ELEVATION SHEET A11.22-23 FOR GEOMETRY AT SECURITY SCREENING METAL PAN CEILING ACT-04
- 06 8'x18' ROOF HATCH FOR GENERATOR MAINTENANCE
- 07 3'x3' ROOF HATCH FOR ROOF ACCESS

Portland International Jetport
 1001 Westbrook Street
 Portland, Maine 04102

Gensler
 2020 K Street, Northwest
 Suite 200
 Washington DC 20006
 Telephone 202.721.5200
 Facsimile 202.872.8587

Date	Description
07/11/08	SCHEMATIC DESIGN
09/22/08	DESIGN DEVELOPMENT
12/03/08	75% CONSTRUCTION DOCUMENTS
01/23/09	95% CONSTRUCTION DOCUMENTS
10/26/09	ISSUED FOR PERMIT
2 11/12/09	ADDENDUM #2
145 09/01/11	ISSUED FOR CONSTRUCTION

GENERAL NOTES

- A FOR LIGHTING TYPES, DETAILS AND INFORMATION REFER TO PROJECT MANUAL.
- B FOR DIFFUSER INFORMATION AND QUANTITY, REFER TO PROJECT MANUAL.
- C ALL GWD CEILINGS TO BE PAINTED P-01 U.O.N.
- D SPRINKLER HEADS ARE SHOWN FOR DESIGN INTENT ONLY. REFER TO FIRE PROTECTION DRAWINGS FOR ADDITIONAL INFORMATION.
- E FOR CAMERA LOCATION AND MOUNTING DETAILS RE: TO IT AND COMMUNICATION ENGINEERS DRAWINGS.
- F ACT-01 CONTINUOUS OVER TKT LOBBY AT ELEVATION 94.15
- G ACT CEILINGS TO BE CENTERED IN EACH ROOM U.O.N.

Seal/Signature

 Project Name
 PWM Terminal Enhancement

Project Number
 09.6395.000
 Description
 REFLECTED CEILING PLAN - LEVEL 4 - ZONE 5

Scale
 As indicated

A04.04.05
 © 2009 Gensler

KEY PLAN

