

R. W. Gillespie & Associates, Inc.

86 Industrial Park Road, Suite 4, Saco, ME 04072 207-286-8008
200 Int'l Drive, Suite 170, Portsmouth, NH 03801 603-427-0244

LETTER OF TRANSMITTAL

Date:	09 Nov 2010	Project No.:	557-14
Attention: Mr. Cuyler Feagles (cmf@portlandmaine.gov)			
Re: In-Place Density Testing Terminal Enhancement, Portland Int. Jetport Portland, Maine			

City of Portland, Portland Int. Jetport

1001 Westbrook Street

Portland, Maine 04102

We are sending you attached In-Place Density Test Results.

Date(s) Performed:

11553
11590
11602

Test (s) Performed

Asphalt Core Results
Asphalt TMD Results
Asphalt Core Results

- Meets Specification
- Selected Tests Do Not Meet Specification - Noted with an *

Note: Materials descriptions and maximum laboratory dry density values were transmitted under separate cover and are referenced in the attached summaries by the material number.

Remarks:

Copy To: Roy Williams: rsw@portlandmaine.gov
 Jim Stanislaski: jim_stanislaski@gensler.com
 Cliff Takara: clifford_takara@gensler.com
 Lacey Fogg: Lacey.Fogg@amec.com
 Mike Fusco: mfusco@tcco.com
 Shaun Winner: swinner@tcco.com
 Elizabeth O'Toole: eotoole@tcco.com
 TMM@portlandmaine.gove
 Idobson@portlandmaine.gov
 bcybulski@tcco.com
 rdixon@tcco.com
 Geoff Mitchell: gemitchell@tcco.com

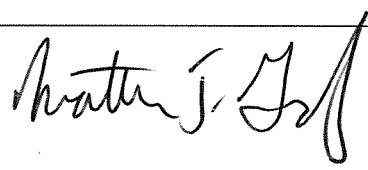
Signed: 

Asphalt Core Results

Project:	Terminal Enhancement
Project No:	557-14
Date Paved:	September 24 & 28, 2010
Date Cut:	September 30, 2010
Date Tested:	October 1, 2010

Lab No.:	11553
Mix Type:	19 mm Binder (Mix #491)
Supplier:	Pike Ind.
Tested by:	GSM
Cores Cut by:	MJK

9/24 Theoretical Maximum Density (G_{mm}): 2.518
 9/28 Theoretical Maximum Density (G_{mm}): 2.522

Core Number	Location	Bulk Specific Gravity (G_{mb})	Density (pcf)	Percent Compaction (G_{mb}/G_{mm}) x 100	Thickness (inches)
C-1	Entrance Rd. Sta. 11+50, Rt	2.351	146.7	93%	3 9/16"
C-2	Entrance to Parking Garage	2.384	148.8	95%	2 1/2"

Notes: Minimum required thickness is 2 1/2" for entrance road base pavement, +/- 1/2".
 Density requirement = 90% to 96% of TMD. Cores meet specification requirements.

MTC

R.W. GILLESPIE & ASSOCIATES, INC.

86 Industrial Park Rd., Suite 4, Saco ME 04072, 207-286-8008 / 200 Int'l Dr., Suite 170, Portsmouth NH 03801, 603-427-0244

9/30/10 ROONEY COLLARD ASPHALT CORING

PAVE DATE 9/24/10

SHEET NOTES

Portland International Jetport
1001 Westbrook Street
Portland, Maine 04102

Gensler
PORTLAND INTERNATIONAL JETPORT
CONSTRUCTION DOCUMENTS

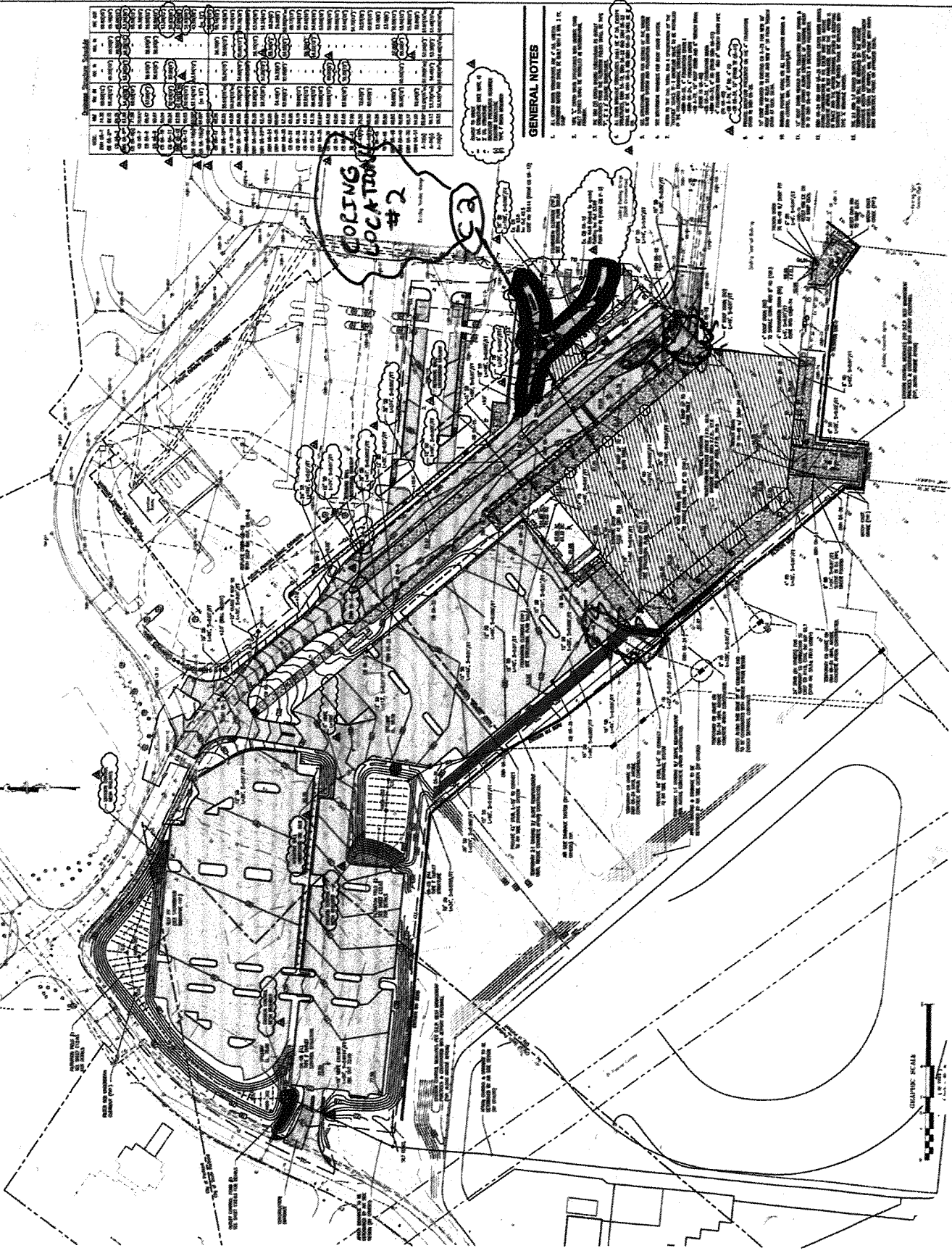

NO.	DESCRIPTION	QTY	UNIT	PRICE	TOTAL
1	ASPHALT CORING	100	YD	1.00	100.00
2
3
4
5
6
7
8
9
10

GENERAL NOTES

1. ALL WORK SHALL BE DONE IN ACCORDANCE WITH THE SPECIFICATIONS AND DRAWINGS.
2. THE CONTRACTOR SHALL BE RESPONSIBLE FOR OBTAINING ALL NECESSARY PERMITS AND APPROVALS.
3. THE CONTRACTOR SHALL MAINTAIN ACCESS TO ALL ADJACENT AREAS AT ALL TIMES.
4. THE CONTRACTOR SHALL BE RESPONSIBLE FOR PROTECTING ALL EXISTING UTILITIES AND STRUCTURES.
5. THE CONTRACTOR SHALL MAINTAIN ADEQUATE SAFETY BARRIERS AND SIGNAGE THROUGHOUT THE PROJECT.
6. THE CONTRACTOR SHALL BE RESPONSIBLE FOR THE REMOVAL AND DISPOSAL OF ALL DEBRIS AND EXCESS MATERIAL.
7. THE CONTRACTOR SHALL MAINTAIN RECORDS OF ALL WORK DONE AND MATERIALS USED.
8. THE CONTRACTOR SHALL BE RESPONSIBLE FOR THE PROTECTION AND RESTORATION OF ALL ENVIRONMENTAL FEATURES.
9. THE CONTRACTOR SHALL BE RESPONSIBLE FOR THE PROTECTION AND RESTORATION OF ALL HISTORIC FEATURES.
10. THE CONTRACTOR SHALL BE RESPONSIBLE FOR THE PROTECTION AND RESTORATION OF ALL CULTURAL RESOURCES.

C02.02

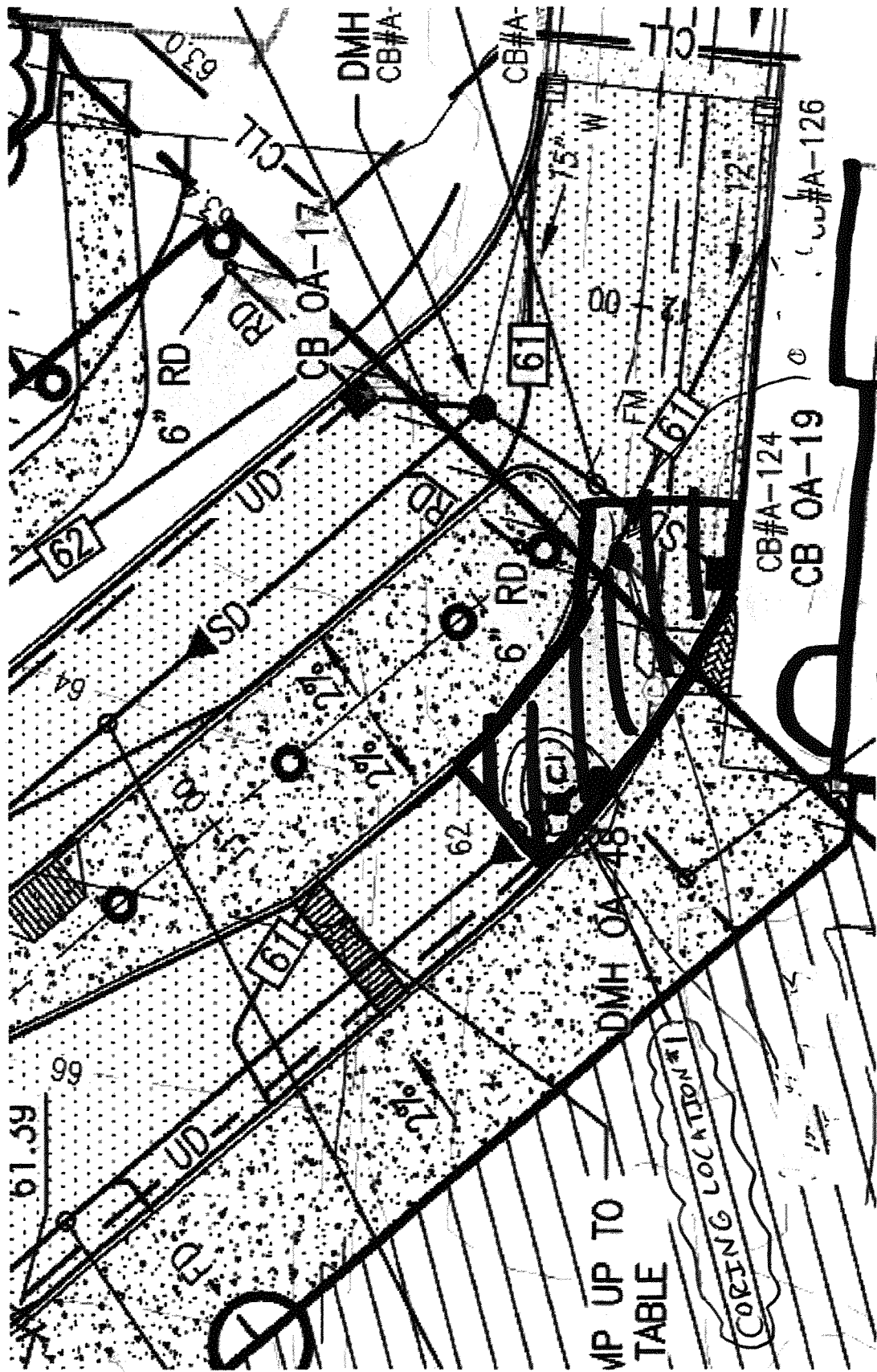

EXISTING BLDG

**STEEL DECK OVERHANGING
NEW PAVED AREA**

*PLANS DATE
9/20/10*

MP UP TO
TABLE

(CORING LOCATION)

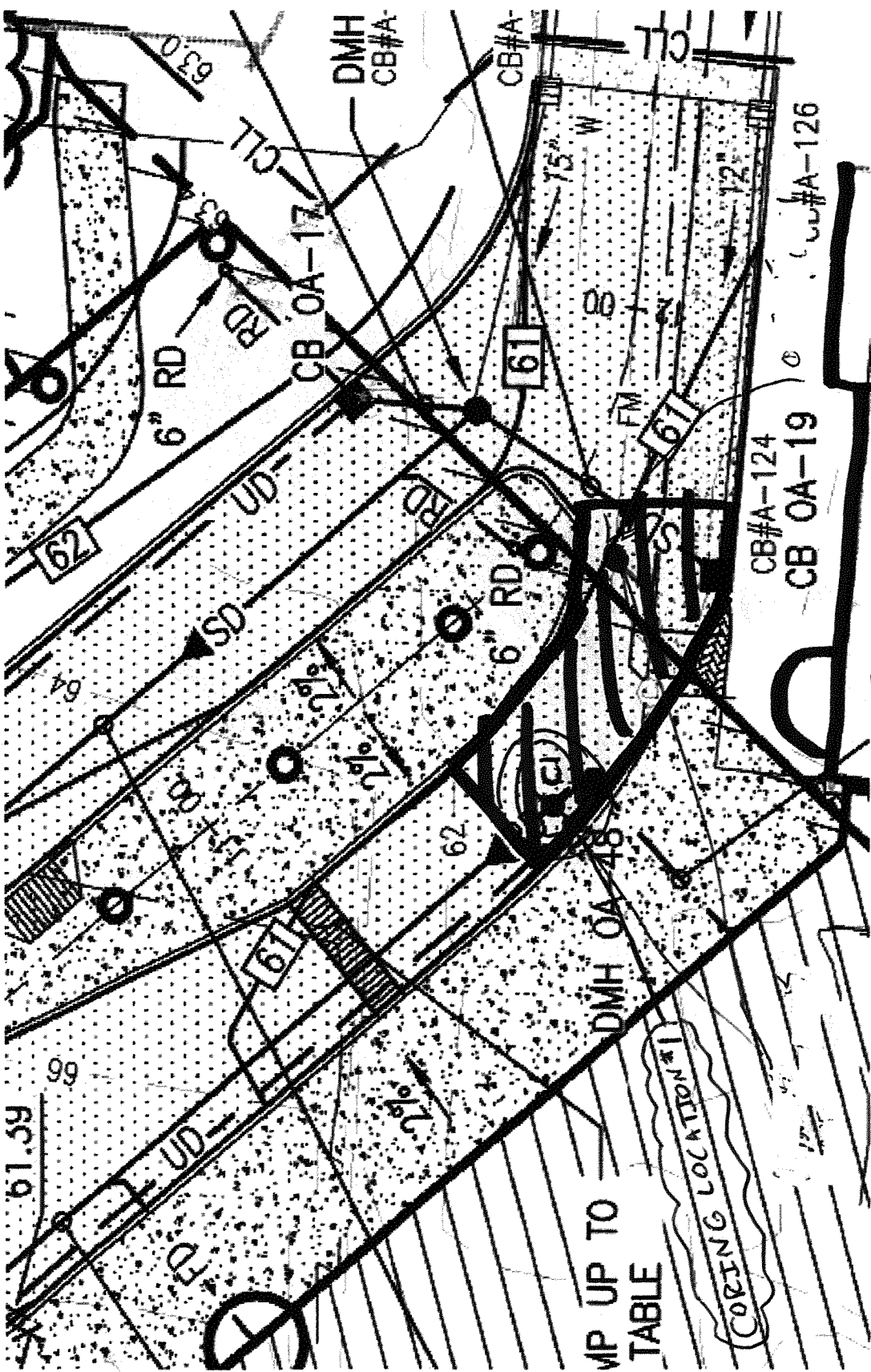

Asphalt TMD Results

Project:	Terminal Enhancement		
Project No:	557-14	Supplier:	Pike Ind.
Date Paved:	October 25, 2010	Mix Type:	19 mm
Date Tested:	October 25, 2010	Mix Design No.:	491
Lab No.:	11590	Sampled by:	MJK
		Tested by:	TDT

Sample	Location	Mass in Air (grams)	Mass in Water (grams)	Calibration (grams)	Theoretical Maximum Density (G _{mm}):
1	Upper Parking Lot	2067.6	2607.6	1363.6	2.510
					156.7

R.W. GILLESPIE & ASSOCIATES, INC.

86 Industrial Park Rd., Suite 4, Saco ME 04072, 207-286-8008 / 200 Int'l Dr., Suite 170, Portsmouth NH 03801, 603-427-0244

MJK

Asphalt Core Results

Project:	Terminal Enhancement
Project No:	557-14
Date Paved:	October 25 & 26, 2010
Date Cut:	October 28, 2010
Date Tested:	October 29, 2010

Lab No.:	11602
Mix Type:	19 mm Base (Mix # 491)
Supplier:	Pike Ind.
Tested by:	TDT
Cores Cut by:	MJK

Theoretical Maximum Density (G_{mm}): 2.510

Core Number	Location	Bulk Specific Gravity (G_{mb})	Density (pcf)	Percent Compaction (G_{mb}/G_{mm}) x 100	Thickness (inches)
C-1	Parking Lot - See Sketch	2.379	148.4	95%	1 1/2"
C-2	Parking Lot - See Sketch	2.379	148.4	95%	2 1/4"
C-3	Parking Lot - See Sketch	2.347	146.5	94%	2 1/4"
C-4	Parking Lot - See Sketch	2.344	146.3	93%	2"

Notes: Minimum required thickness for parking lot base pavement is 2" +/- 1/2".
Density requirement is 90% to 96% of TMD. Cores meet specification requirement.

R.W. GILLESPIE & ASSOCIATES, INC.

86 Industrial Park Rd., Suite 4, Saco ME 04072, 207-286-8008 / 200 Int'l Dr., Suite 170, Portsmouth NH 03801, 603-427-0244

MJK

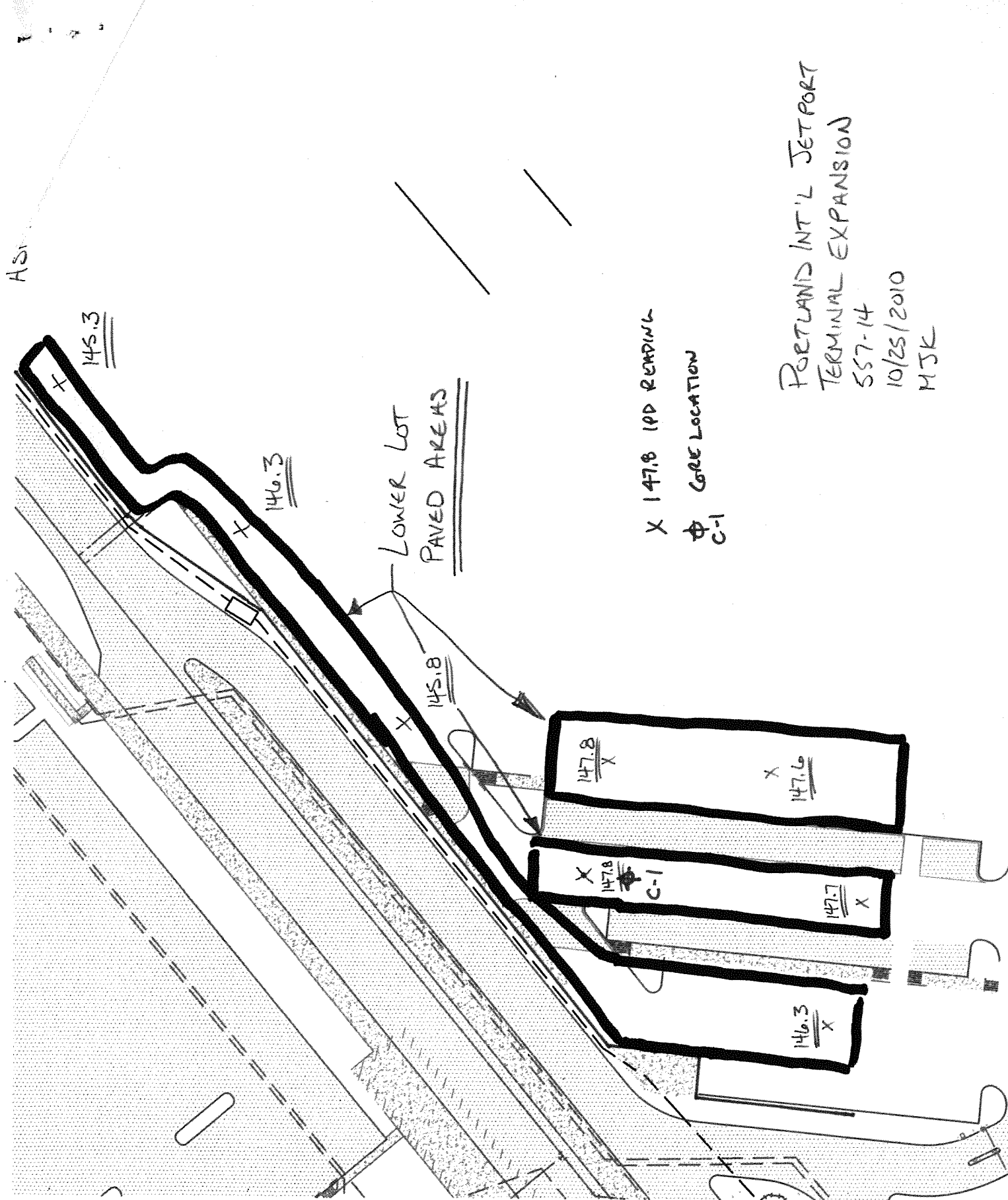

X 147.8 10D READING
 Φ CORE LOCATION
 C-1

PORTLAND INT'L JETPORT
 TERMINAL EXPANSION
 557-14
 10/25/2010
 HJK

DAVID M. MOORE

TERMINAL 7

ASPHALT + IPD's

UPPER LOT
~ 200 yds²

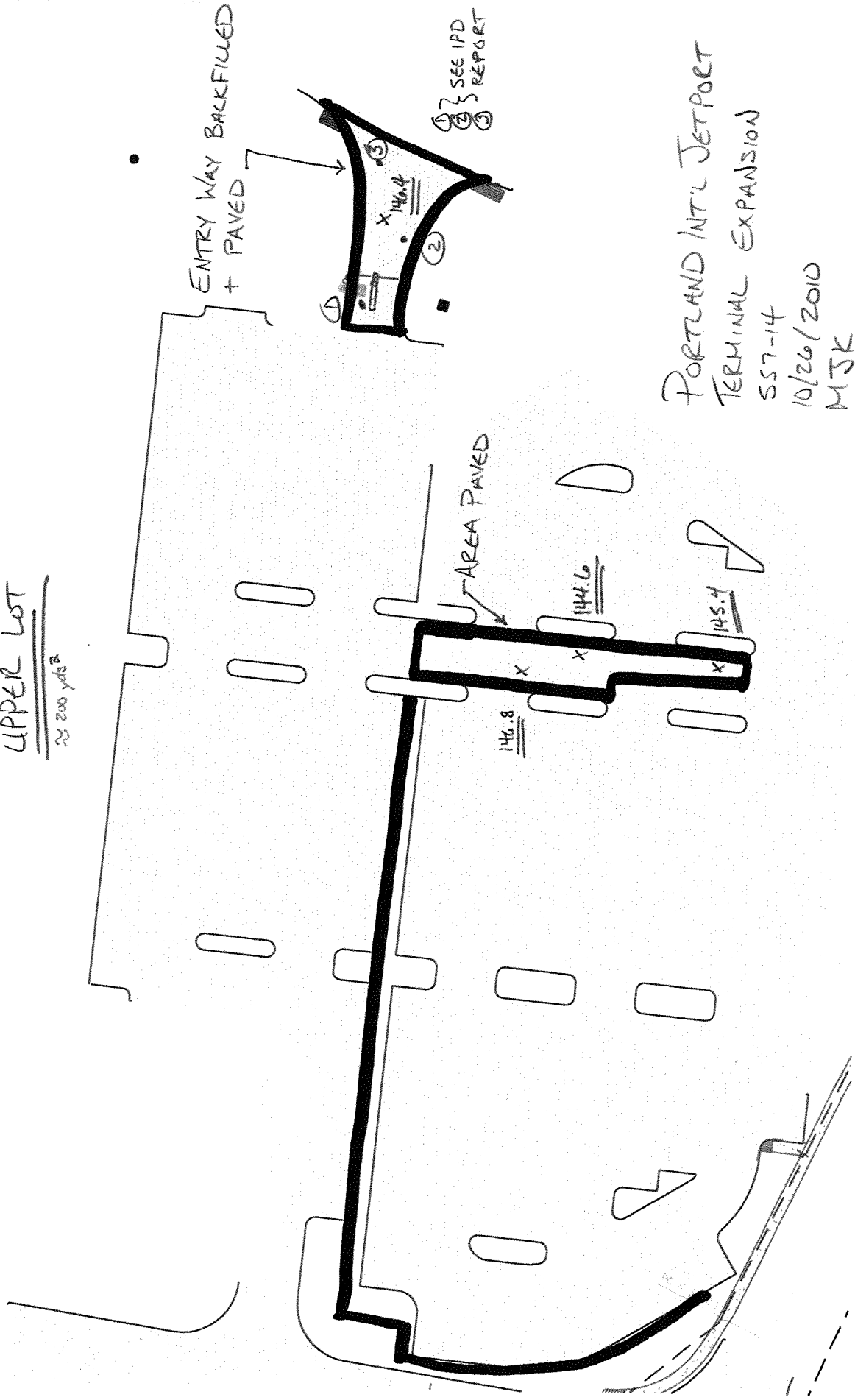

PORTLAND INT'L AIRPORT
TERMINAL EXPANSION
557-14
10/26/2010
MSK