

Daily Observation Report

Project: <u>JETPORT EXPANSION</u>		Time: _____ End Time _____	Mileage: _____ End _____
Project No.: <u>557-14</u>	Tolls: <u>-</u>	✓ _____ Beg. Time _____	_____ Begin _____
Per Diem/Lodging: _____		✓ <u>1.5</u> Total Time	✓ <u>20</u> Total

Observations:

In-Place Densities Done \_\_\_\_\_ All IPDs meet Specifications Reported to \_\_\_\_\_  
 \_\_\_\_\_ Not all IPDs meet Specifications Reported to \_\_\_\_\_

Phone Calls:

- CONCRETE CYLINDER PICK UP.  
 - CONFIRMED AMOUNT OF CONCRETE PLACED ON FRIDAY WITH  
 BARRETT FROM TURNER - 310 YARDS

Reviewed By: MTG

Signed: [Signature] EEC

<input type="checkbox"/> HNU _____ day	<input type="checkbox"/> Concrete Equipment	Monitoring Well Supplies	
<input type="checkbox"/> Survey Level _____ day	<input type="checkbox"/> Nuc Densometer _____ day	_____ Bags of Bentonite	_____ Locks
<input type="checkbox"/> Rebar Meter _____ day	<input type="checkbox"/> Coring Machine _____ Dia.	_____ 5 ft. Screen 2" PVC	_____ Caps
_____ Bailers (Disposable)	_____ Inches Cored	_____ 10 ft. Screen 2" PVC	_____ Points
<input type="checkbox"/> Water Level Ind. _____ day	<input type="checkbox"/> Generator <input type="checkbox"/> Taylor Rental	_____ 5 ft. Riser 2" PVC	_____ Screw Caps
<input type="checkbox"/> Drill Rig _____ day	<input type="checkbox"/> Peristaltic Pump (note tubing used)	_____ 10 ft. Riser 2" PVC	
<input type="checkbox"/> Backhoe _____ day	<input type="checkbox"/> Other _____	_____ Other _____	



**SITE WORK  
DAILY FIELD REPORT**

PROJECT: Terminal Enhancement at the Portland International Jetport

DATE: 11/2/10

PROJECT LOCATION: Portland, Maine

PROJECT NO.: 557-14

CLIENT: City of Portland

WEATHER: Overcast to sunny

CONTRACTOR: Turner Construction Co.

PREVIOUS DATE ON SITE: 10/29/10

Time on-site at 11 hrs, 24 mi travel, Tolls: \$0.00

Nuc. Densometer – NA

Slab-on-Deck 4-8, portion of parapet wall and diamond sections around columns (see sketch) placed today. 140+ cy lightweight concrete used for slab, 35 cy normal weight concrete used for parapet wall and diamonds around columns.

3 sets of cylinders made for lightweight placement. 1 set made for parapet wall placement. Any tests producing out of specification results were immediately reported to Turner representative on site and Lacey Fogg of Amec via telephone.

1<sup>st</sup> load of normal weight concrete (sampled load) placed in parapet wall exceeded 90 minute time limit (110 minutes± total). Ryan Dixon of Turner Construction notified prior to 90 minutes that time limit was going to be exceeded. Notified Lacey Fogg at 90 minutes. According to Turner Construction, if the truck is discharging into the hopper prior to the 90 minute mark, entire load may be placed.

*MSK*

Michael Kramlich

Prepared By

*Matthew J. Grady*

Matthew Grady

Reviewed By

CONCRETE

PLACED  
SLAB 4-8

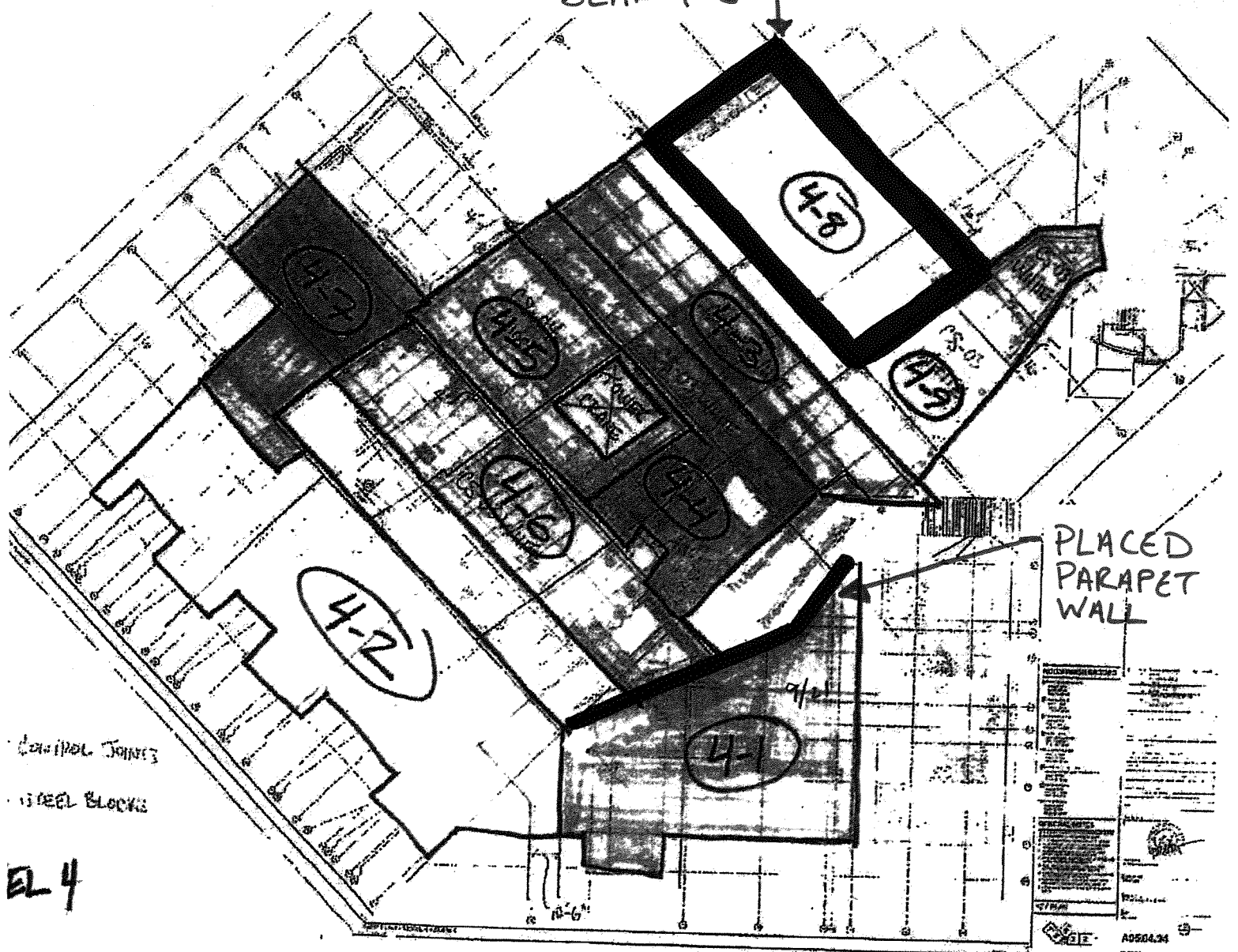

PLACED  
PARAPET  
WALL

CONCRETE JOINTS  
STEEL BLOCKS

EL 4

PORTLAND INT'L JETPORT  
 TERMINAL EXPANSION  
 557-14  
 11/2/2010  
 MSK

Daily Observation Report

Project: <u>PORTLAND JETPORT</u>		Time: _____	End Time _____	Mileage: _____	End _____
Project No.: <u>557-14</u>	Tolls: <u>-</u>	✓ <u>2.5</u> Total Time		✓ _____	Begin _____
Per Diem/Lodging: _____				_____	Total <u>25</u>

Observations:

In-Place Densities Done \_\_\_\_\_ All IPDs meet Specifications Reported to \_\_\_\_\_  
 Not all IPDs meet Specifications Reported to \_\_\_\_\_

Phone Calls: MJK  
 ✓ - HELPED MJK PUT CYLINDERS INTO CURING BOX THAT / BROU-GHT TO SITE  
 - TOOK PQI READINGS AROUND CORES THAT WERE CUT BY RRC + EEC

IN SEPTEMBER

- WAS UNABLE TO TAKE TESTS AROUND CORE BY PARKING GARAGE BECAUSE PUMP TRUCK AND CONCRETE TRUCKS WERE PARKED OVER IT

Reviewed By: MT

Signed: EPL

<input type="checkbox"/> HNU _____ day	<input type="checkbox"/> Concrete Equipment	Monitoring Well Supplies	
<input type="checkbox"/> Survey Level _____ day	<input type="checkbox"/> New Densometer <u>PQI</u> <u>1/2</u> day	_____ Bags of Bentonite	_____ Locks
<input type="checkbox"/> Rebar Meter _____ day	<input type="checkbox"/> Coring Machine _____ Dia.	_____ 5 ft. Screen 2" PVC	_____ Caps
_____ Bailers (Disposable)	_____ Inches Cored	_____ 10 ft. Screen 2" PVC	_____ Points
<input type="checkbox"/> Water Level Ind. _____ day	<input type="checkbox"/> Generator <input type="checkbox"/> Taylor Rental	_____ 5 ft. Riser 2" PVC	_____ Screw Caps
<input type="checkbox"/> Drill Rig _____ day	<input type="checkbox"/> Peristaltic Pump (note tubing used)	_____ 10 ft. Riser 2" PVC	
<input type="checkbox"/> Backhoe _____ day	<input type="checkbox"/> Other _____	_____ Other _____	



**SITE WORK  
DAILY FIELD REPORT**

PROJECT: Terminal Enhancement at the Portland International Jetport  
DATE: 11/3/10  
PROJECT LOCATION: Portland, Maine      PROJECT NO.: 557-14  
CLIENT: City of Portland                      WEATHER: sunny  
CONTRACTOR: Turner Construction Co.  
PREVIOUS DATE ON SITE: 11/2/10

Time on-site at 1.5 hrs, 24 mi travel, Tolls: \$0.00  
Nuc. Densometer – NA

CPU 4 sets of cylinders made 11/2.

*MJK*

\_\_\_\_\_  
Michael Kramlich

Prepared By

*Matthew J. Grady*

\_\_\_\_\_  
Matthew Grady

Reviewed By

Daily Observation Report

Project: <u>Portland Seaport Terminal</u>		Time: _____ End Time _____	Mileage: _____ End _____
Project No.: <u>557-14</u>	Tolls: <u>7.0</u>	_____ Beg. Time _____	_____ Begin _____
Per Diem/Lodging: _____		✓ <u>1.5</u> Total Time	✓ <u>24</u> Total

Observations:

In-Place Densities Done \_\_\_\_\_ All IPDs meet Specifications Reported to \_\_\_\_\_

Not all IPDs meet Specifications Reported to \_\_\_\_\_

Phone Calls:

Showered up onsite to get ~~familiarized~~<sup>all</sup> with fire proofing what was done and what needed more work. Went over specs and all documentations for the fire proofing. Met up with the fire proofing contractor. He gave me a walk around, ~~show~~ helping me with ~~the~~ building levels, etc. He showed me where he needed testing and we went over the areas where touch up needed to be done. I checked a couple of thicknesses and had to go to another job.

Reviewed By: MTC

Signed: Joe Richman

<input type="checkbox"/> HNU _____ day	<input type="checkbox"/> Concrete Equipment	Monitoring Well Supplies	
<input type="checkbox"/> Survey Level _____ day	<input type="checkbox"/> Nuc Densometer _____ day	_____ Bags of Bentonite	_____ Locks
<input type="checkbox"/> Rebar Meter _____ day	<input type="checkbox"/> Coring Machine _____ Dia.	_____ 5 ft. Screen 2" PVC	_____ Caps
_____ Bailers (Disposable)	_____ Inches Cored	_____ 10 ft. Screen 2" PVC	_____ Points
<input type="checkbox"/> Water Level Ind. _____ day	<input type="checkbox"/> Generator <input type="checkbox"/> Taylor Rental	_____ 5 ft. Riser 2" PVC	_____ Screw Caps
<input type="checkbox"/> Drill Rig _____ day	<input type="checkbox"/> Peristaltic Pump (note tubing used)	_____ 10 ft. Riser 2" PVC	
<input type="checkbox"/> Backhoe _____ day	<input type="checkbox"/> Other	_____ Other _____	



Daily Observation Report

Project: <u>Setport Terminal expansion</u>		Time: _____	End Time _____	Mileage: _____	End _____
Project No.: <u>557-14</u>	Tolls: <u>70</u>	✓ _____		Beg. Time _____	Begin _____
Per Diem/Lodging: _____		✓ <u>2-0</u> Total Time		✓ _____	<u>24</u> Total

Observations:

In-Place Densities Done \_\_\_\_\_ All IPDs meet Specifications Reported to \_\_\_\_\_  
 Not all IPDs meet Specifications Reported to \_\_\_\_\_

Phone Calls:

I showed up on-site and met with Mike Kramlich to show him how to do fine proofing. We went over the way to take thickness and density test. I also stayed and took more thickness tests on columns and ceiling beams...

Reviewed By: MTC

Signed: Dale Anderson

<input type="checkbox"/> HNU _____ day	<input type="checkbox"/> Concrete Equipment	Monitoring Well Supplies	
<input type="checkbox"/> Survey Level _____ day	<input type="checkbox"/> Nuc Densometer _____ day	_____ Bags of Bentonite	_____ Locks
<input type="checkbox"/> Rebar Meter _____ day	<input type="checkbox"/> Coring Machine _____ Dia.	_____ 5 ft. Screen 2" PVC	_____ Caps
_____ Bailers (Disposable)	_____ Inches Cored	_____ 10 ft. Screen 2" PVC	_____ Points
<input type="checkbox"/> Water Level Ind. _____ day	<input type="checkbox"/> Generator <input type="checkbox"/> Taylor Rental	_____ 5 ft. Riser 2" PVC	_____ Screw Caps
<input type="checkbox"/> Drill Rig _____ day	<input type="checkbox"/> Peristaltic Pump (note tubing used)	_____ 10 ft. Riser 2" PVC	
<input type="checkbox"/> Backhoe _____ day	<input type="checkbox"/> Other	_____ Other _____	