



**SITE WORK  
DAILY FIELD REPORT**

PROJECT: Terminal Enhancement at the Portland International Jetport

DATE: 10/11/10

PROJECT LOCATION: Portland, Maine

PROJECT NO.: 557-14

CLIENT: City of Portland

WEATHER: Sunny

CONTRACTOR: Turner Construction Co.

PREVIOUS DATE ON SITE: 10/08/10

Time on-site at 7.25 hrs, 24 mi travel, Tolls: \$0.00

✓Nuc. Densometer – L-500

IPDs taken on parking lot fill material placed in main geothermal trench below what will be the upper parking lot in Area A (see sketch). 8 IPDs taken, all meeting or exceeding specification.

*MSK*

\_\_\_\_\_  
Michael Kramlich

Prepared By

*Matthew Grady*

\_\_\_\_\_  
Matthew Grady

Reviewed By

PORTLAND INT'L AIRPORT  
TERMINAL EXPANSION

SS7-14

MSK

10-11-10

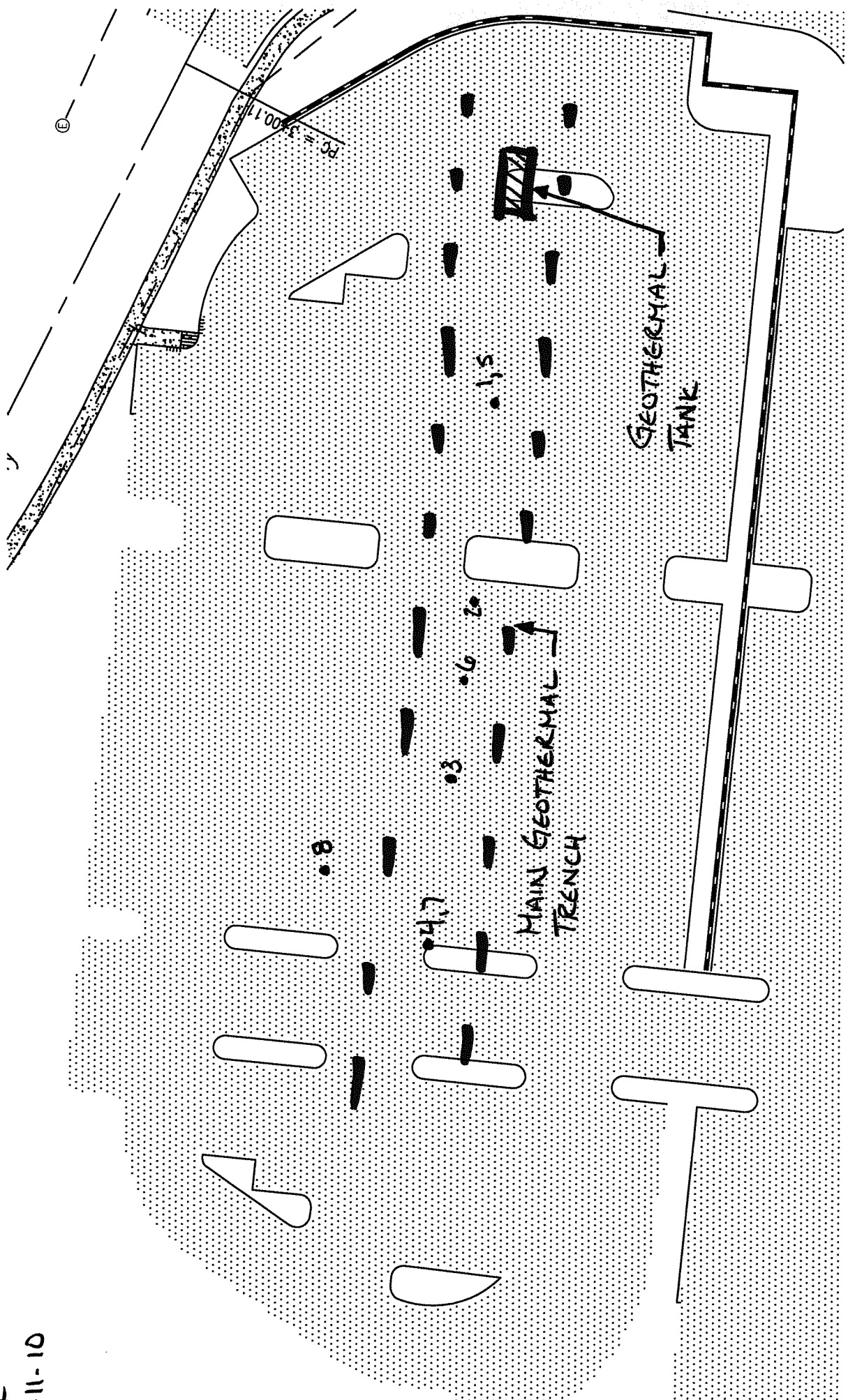

**R. W. GILLESPIE & ASSOCIATES, INC.**  
 Geotechnical Engineering · Geohydrology · Materials Testing Services

200 International Dr., Ste 170  
 Portsmouth, NH 03801  
 603-427-0244 · Fax 603-430-2041

**Corporate Office**  
 86 Industrial Park Rd, Ste 4  
 Saco, ME 04072  
 207-286-8008 · Fax 207-286-2882

P.O. Box 289  
 Augusta, ME 04344  
 207-623-4914 · Fax 207-623-3429

**ULTRASONIC EXAMINATION REPORT**

Project Name: TERMINAL ENLARGEMENT @ JETPORT  
 Client/Project #: 557-1A  
 General Contractor: TURNER CONSTRUCTION  
 Welding Contractor: JF STERNS

Date: 10-11-10  
 Time on Site: 5.0  
 Mileage: (26)  
 Tolls: 2.0

Weld Process: FCW  
 Weld Designation (AWS): TC-4AA-F

Location: ZONE 5, LEVEL 4  
ZONE 7 LEVEL 3

Weld Identification Area	Transducer Angle	Form Face	Leg	Decibels				Discontinuity				Remarks	
				Indication Level	Reference Level	Attenuation Factor	Indication Rating	Length	Angular Distance (Sound Path)	Depth from "A" Surface	Distance		
											From X		From Y
A	B	C	D										
XD.7-Y8.5	70	A			79.9								TOP & BOTTOM ACCEPT
XD.7-Y8													
XH-Y8													
XJ-Y8													
XL-Y8													
XM-Y8													
XK-Y8													
XG.6-Z5													
XG.6-Z4													
XG.6-Z3													
XG.6-Z2													

Weld Identification Area	Transducer Angle	Form Face	Leg	Decibels				Discontinuity				Remarks	
				Indication Level	Reference Level	Attenuation Factor	Indication Rating	Length	Angular Distance (Sound Path)	Depth from "A" Surface	Distance		
											From X		From Y
A	B	C	D										
XF-Z6	70	A			79.9							TOP & BOTTOM ACCEPT	
XF-Z5													
XF-Z4													
XF-Z3													
XF-Z2													
XK-Y5													
XK-Y4													

<p>RWG&amp;A personnel are represented on site solely to observe work of the identified contractors, to form opinions about the adequacy of those operations, and to report those opinions to RWG&amp;A's client. The presence and activities of our field representative do not relieve any contractor from their obligations to meet contractual requirements. The contractor retains sole responsibility of site safety and the methods, operations, and sequences of construction.</p>	Observations were verbally reported to:
	RYAN DIXON, TURNER
	Construction Technologist/CWI:
	George S Morrell
	Print Name/Title
Certification #:	 George S Morrell CWI 04050311 QC1 EXP. 5/1/2013

MTG

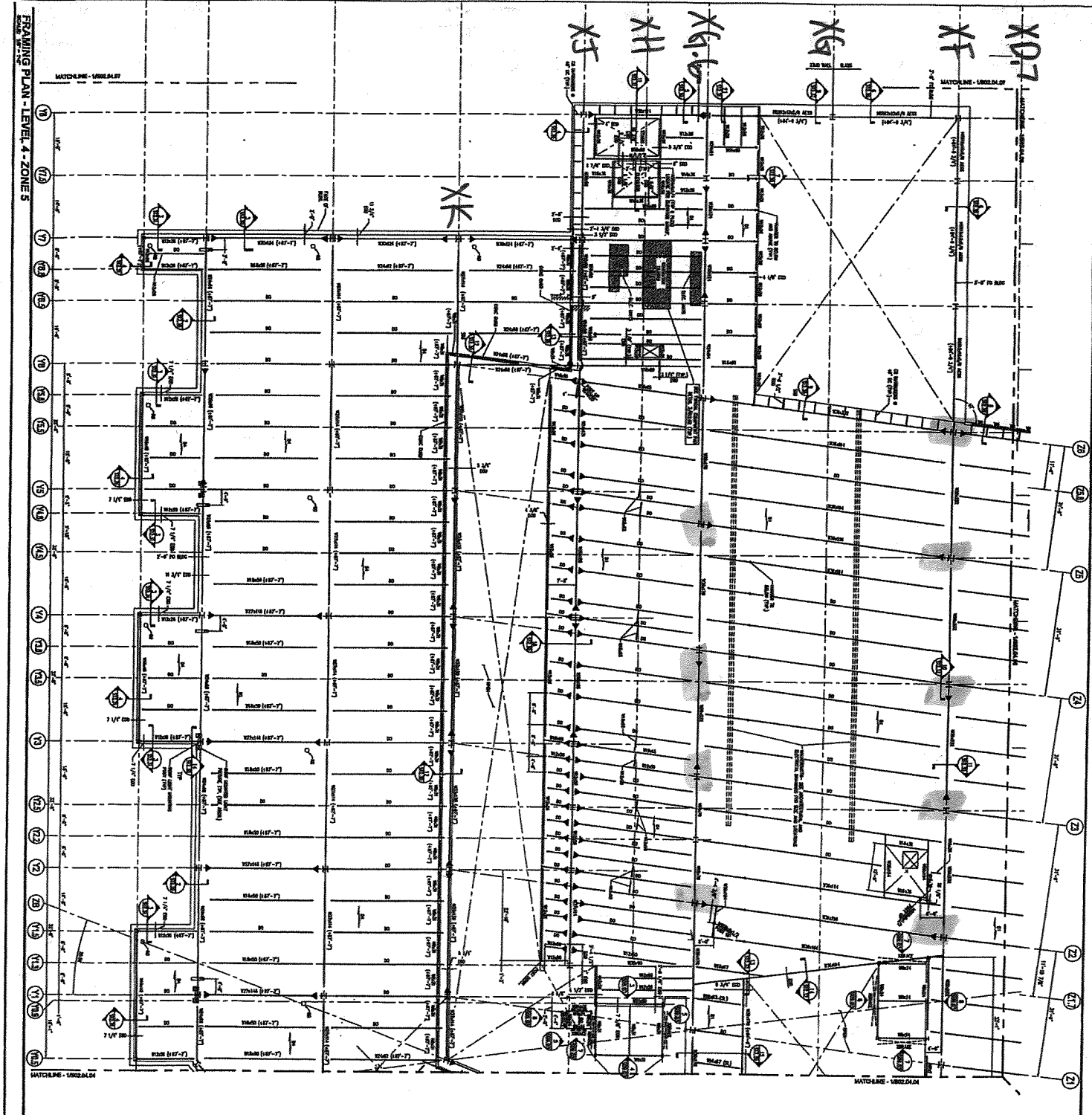

Project: Terminal Enhancement – Portland International Jetport  
 Project No.: 557-14  
 Date: 10-11-10  
 Technologist: GSM

- SHEET NOTES**
1. REFER TO THE GENERAL NOTES FOR THE PROJECT.
  2. ALL DIMENSIONS ARE IN FEET AND INCHES UNLESS OTHERWISE NOTED.
  3. ALL DIMENSIONS ARE TO FACE UNLESS OTHERWISE NOTED.
  4. ALL DIMENSIONS ARE TO CENTERLINE UNLESS OTHERWISE NOTED.
  5. ALL DIMENSIONS ARE TO CENTERLINE UNLESS OTHERWISE NOTED.
  6. ALL DIMENSIONS ARE TO CENTERLINE UNLESS OTHERWISE NOTED.
  7. ALL DIMENSIONS ARE TO CENTERLINE UNLESS OTHERWISE NOTED.
  8. ALL DIMENSIONS ARE TO CENTERLINE UNLESS OTHERWISE NOTED.
  9. ALL DIMENSIONS ARE TO CENTERLINE UNLESS OTHERWISE NOTED.
  10. ALL DIMENSIONS ARE TO CENTERLINE UNLESS OTHERWISE NOTED.

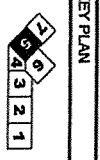

KEY PLAN

S02.04.05



**Portland International Jetport**  
 1001 Westbank Street  
 Portland, Maine 04102

**Gensler**  
 1000 Boylston Street  
 Boston, MA 02116

**nest ASSOCIATES, INC.**  
 1000 Boylston Street  
 Boston, MA 02116

Project: Terminal Enhancement – Portland International Jetport

Project No.: 557-14

Date: 10-11-10

Technologist: GSM

**Portland International Jetport**  
1001 Westbank Street  
Portland, Maine 04112

**Gensler**  
**OP&A ASSOCIATES INC.**  
engineers - architects - interior - construction managers

**SHEET NOTES**

1. ALL WORK SHALL BE IN ACCORDANCE WITH THE LATEST EDITIONS OF THE AIA, ASHRAE, AND IBC CODES.
2. ALL WORK SHALL BE IN ACCORDANCE WITH THE LATEST EDITIONS OF THE AIA, ASHRAE, AND IBC CODES.
3. ALL WORK SHALL BE IN ACCORDANCE WITH THE LATEST EDITIONS OF THE AIA, ASHRAE, AND IBC CODES.
4. ALL WORK SHALL BE IN ACCORDANCE WITH THE LATEST EDITIONS OF THE AIA, ASHRAE, AND IBC CODES.
5. ALL WORK SHALL BE IN ACCORDANCE WITH THE LATEST EDITIONS OF THE AIA, ASHRAE, AND IBC CODES.
6. ALL WORK SHALL BE IN ACCORDANCE WITH THE LATEST EDITIONS OF THE AIA, ASHRAE, AND IBC CODES.
7. ALL WORK SHALL BE IN ACCORDANCE WITH THE LATEST EDITIONS OF THE AIA, ASHRAE, AND IBC CODES.
8. ALL WORK SHALL BE IN ACCORDANCE WITH THE LATEST EDITIONS OF THE AIA, ASHRAE, AND IBC CODES.
9. ALL WORK SHALL BE IN ACCORDANCE WITH THE LATEST EDITIONS OF THE AIA, ASHRAE, AND IBC CODES.
10. ALL WORK SHALL BE IN ACCORDANCE WITH THE LATEST EDITIONS OF THE AIA, ASHRAE, AND IBC CODES.
11. ALL WORK SHALL BE IN ACCORDANCE WITH THE LATEST EDITIONS OF THE AIA, ASHRAE, AND IBC CODES.
12. ALL WORK SHALL BE IN ACCORDANCE WITH THE LATEST EDITIONS OF THE AIA, ASHRAE, AND IBC CODES.
13. ALL WORK SHALL BE IN ACCORDANCE WITH THE LATEST EDITIONS OF THE AIA, ASHRAE, AND IBC CODES.
14. ALL WORK SHALL BE IN ACCORDANCE WITH THE LATEST EDITIONS OF THE AIA, ASHRAE, AND IBC CODES.
15. ALL WORK SHALL BE IN ACCORDANCE WITH THE LATEST EDITIONS OF THE AIA, ASHRAE, AND IBC CODES.
16. ALL WORK SHALL BE IN ACCORDANCE WITH THE LATEST EDITIONS OF THE AIA, ASHRAE, AND IBC CODES.
17. ALL WORK SHALL BE IN ACCORDANCE WITH THE LATEST EDITIONS OF THE AIA, ASHRAE, AND IBC CODES.
18. ALL WORK SHALL BE IN ACCORDANCE WITH THE LATEST EDITIONS OF THE AIA, ASHRAE, AND IBC CODES.
19. ALL WORK SHALL BE IN ACCORDANCE WITH THE LATEST EDITIONS OF THE AIA, ASHRAE, AND IBC CODES.
20. ALL WORK SHALL BE IN ACCORDANCE WITH THE LATEST EDITIONS OF THE AIA, ASHRAE, AND IBC CODES.

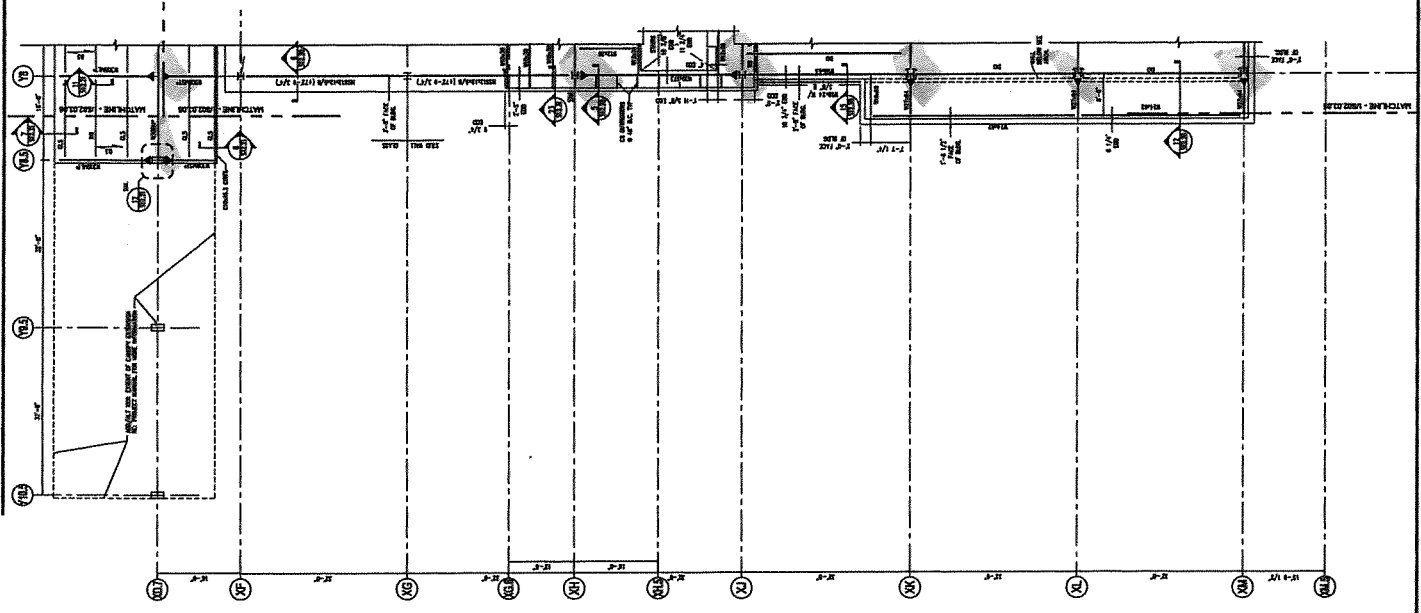

**GENERAL NOTES**

1. ALL WORK SHALL BE IN ACCORDANCE WITH THE LATEST EDITIONS OF THE AIA, ASHRAE, AND IBC CODES.
2. ALL WORK SHALL BE IN ACCORDANCE WITH THE LATEST EDITIONS OF THE AIA, ASHRAE, AND IBC CODES.
3. ALL WORK SHALL BE IN ACCORDANCE WITH THE LATEST EDITIONS OF THE AIA, ASHRAE, AND IBC CODES.
4. ALL WORK SHALL BE IN ACCORDANCE WITH THE LATEST EDITIONS OF THE AIA, ASHRAE, AND IBC CODES.
5. ALL WORK SHALL BE IN ACCORDANCE WITH THE LATEST EDITIONS OF THE AIA, ASHRAE, AND IBC CODES.
6. ALL WORK SHALL BE IN ACCORDANCE WITH THE LATEST EDITIONS OF THE AIA, ASHRAE, AND IBC CODES.
7. ALL WORK SHALL BE IN ACCORDANCE WITH THE LATEST EDITIONS OF THE AIA, ASHRAE, AND IBC CODES.
8. ALL WORK SHALL BE IN ACCORDANCE WITH THE LATEST EDITIONS OF THE AIA, ASHRAE, AND IBC CODES.
9. ALL WORK SHALL BE IN ACCORDANCE WITH THE LATEST EDITIONS OF THE AIA, ASHRAE, AND IBC CODES.
10. ALL WORK SHALL BE IN ACCORDANCE WITH THE LATEST EDITIONS OF THE AIA, ASHRAE, AND IBC CODES.
11. ALL WORK SHALL BE IN ACCORDANCE WITH THE LATEST EDITIONS OF THE AIA, ASHRAE, AND IBC CODES.
12. ALL WORK SHALL BE IN ACCORDANCE WITH THE LATEST EDITIONS OF THE AIA, ASHRAE, AND IBC CODES.
13. ALL WORK SHALL BE IN ACCORDANCE WITH THE LATEST EDITIONS OF THE AIA, ASHRAE, AND IBC CODES.
14. ALL WORK SHALL BE IN ACCORDANCE WITH THE LATEST EDITIONS OF THE AIA, ASHRAE, AND IBC CODES.
15. ALL WORK SHALL BE IN ACCORDANCE WITH THE LATEST EDITIONS OF THE AIA, ASHRAE, AND IBC CODES.
16. ALL WORK SHALL BE IN ACCORDANCE WITH THE LATEST EDITIONS OF THE AIA, ASHRAE, AND IBC CODES.
17. ALL WORK SHALL BE IN ACCORDANCE WITH THE LATEST EDITIONS OF THE AIA, ASHRAE, AND IBC CODES.
18. ALL WORK SHALL BE IN ACCORDANCE WITH THE LATEST EDITIONS OF THE AIA, ASHRAE, AND IBC CODES.
19. ALL WORK SHALL BE IN ACCORDANCE WITH THE LATEST EDITIONS OF THE AIA, ASHRAE, AND IBC CODES.
20. ALL WORK SHALL BE IN ACCORDANCE WITH THE LATEST EDITIONS OF THE AIA, ASHRAE, AND IBC CODES.



PROJECT: Terminal Enhancement  
SHEET: 557-14-10  
DATE: 10-11-10  
SCALE: 1/8" = 1'-0"  
S02.03.07

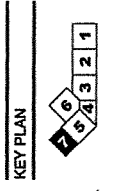

**R. W. GILLESPIE & ASSOCIATES, INC.**  
Geotechnical Engineering · Geohydrology · Materials Testing Services

200 International Dr., Ste 170  
Portsmouth, NH 03801  
603-427-0244 · Fax 603-430-2041

**Corporate Office**  
86 Industrial Park Rd, Ste 4  
Saco, ME 04072  
207-286-8008 · Fax 207-286-2882

P.O. Box 289  
Augusta, ME 04344  
207-623-4914 · Fax 207-623-3429

**ULTRASONIC EXAMINATION REPORT**

Project Name: TERMINAL ENHANCEMENT PORTLAND JETPORT  
Client/Project #: 557-14  
General Contractor: TURNER CONSTRUCTION  
Welding Contractor: JF STERNS

Date: 10-12-10  
Time on Site: 5.0  
Mileage: 26  
Tolls: 2.00

Weld Process: FCAW  
Weld Designation (AWS): TC-44A-F

Location: LEVEL 4 ZONE 6, 5

Weld Identification Area	Transducer Angle	Form Face	Leg	Decibels				Discontinuity			Remarks		
				Indication Level	Reference Level	Attenuation Factor	Indication Rating	Length	Angular Distance (Sound Path)	Depth from "A" Surface		Distance	
												From X	From Y
A	B	C	D										
XH-Y7.5	70	A			79.9							TOP & BOTTOM ACCEPT	
XH-Y7													
XH-Y6.5													
XH-Y6													
XC-Z6													
XC-Z5													
XC-Z4													
XC-Z3													
XC-Z2													
XC-Z1													





Portland International  
Jetport  
1001 Westbrook Street  
Portland, Maine 04102

Gensler  
neef ASSOCIATES, INC.  
ARCHITECTS - INTERIORS - PLANNING - CONSTRUCTION MANAGEMENT

**SHEET NOTES**

1. REFER TO THE GENERAL NOTES OF THIS PROJECT.
2. ALL DIMENSIONS ARE UNLESS OTHERWISE NOTED.
3. ALL DIMENSIONS ARE TO FACE UNLESS OTHERWISE NOTED.
4. ALL DIMENSIONS ARE TO CENTERLINE UNLESS OTHERWISE NOTED.
5. ALL DIMENSIONS ARE TO CENTERLINE UNLESS OTHERWISE NOTED.
6. ALL DIMENSIONS ARE TO CENTERLINE UNLESS OTHERWISE NOTED.
7. ALL DIMENSIONS ARE TO CENTERLINE UNLESS OTHERWISE NOTED.
8. ALL DIMENSIONS ARE TO CENTERLINE UNLESS OTHERWISE NOTED.
9. ALL DIMENSIONS ARE TO CENTERLINE UNLESS OTHERWISE NOTED.
10. ALL DIMENSIONS ARE TO CENTERLINE UNLESS OTHERWISE NOTED.

**GENERAL NOTES**

1. ALL DIMENSIONS ARE TO FACE UNLESS OTHERWISE NOTED.
2. ALL DIMENSIONS ARE TO FACE UNLESS OTHERWISE NOTED.
3. ALL DIMENSIONS ARE TO FACE UNLESS OTHERWISE NOTED.
4. ALL DIMENSIONS ARE TO FACE UNLESS OTHERWISE NOTED.
5. ALL DIMENSIONS ARE TO FACE UNLESS OTHERWISE NOTED.
6. ALL DIMENSIONS ARE TO FACE UNLESS OTHERWISE NOTED.
7. ALL DIMENSIONS ARE TO FACE UNLESS OTHERWISE NOTED.
8. ALL DIMENSIONS ARE TO FACE UNLESS OTHERWISE NOTED.
9. ALL DIMENSIONS ARE TO FACE UNLESS OTHERWISE NOTED.
10. ALL DIMENSIONS ARE TO FACE UNLESS OTHERWISE NOTED.

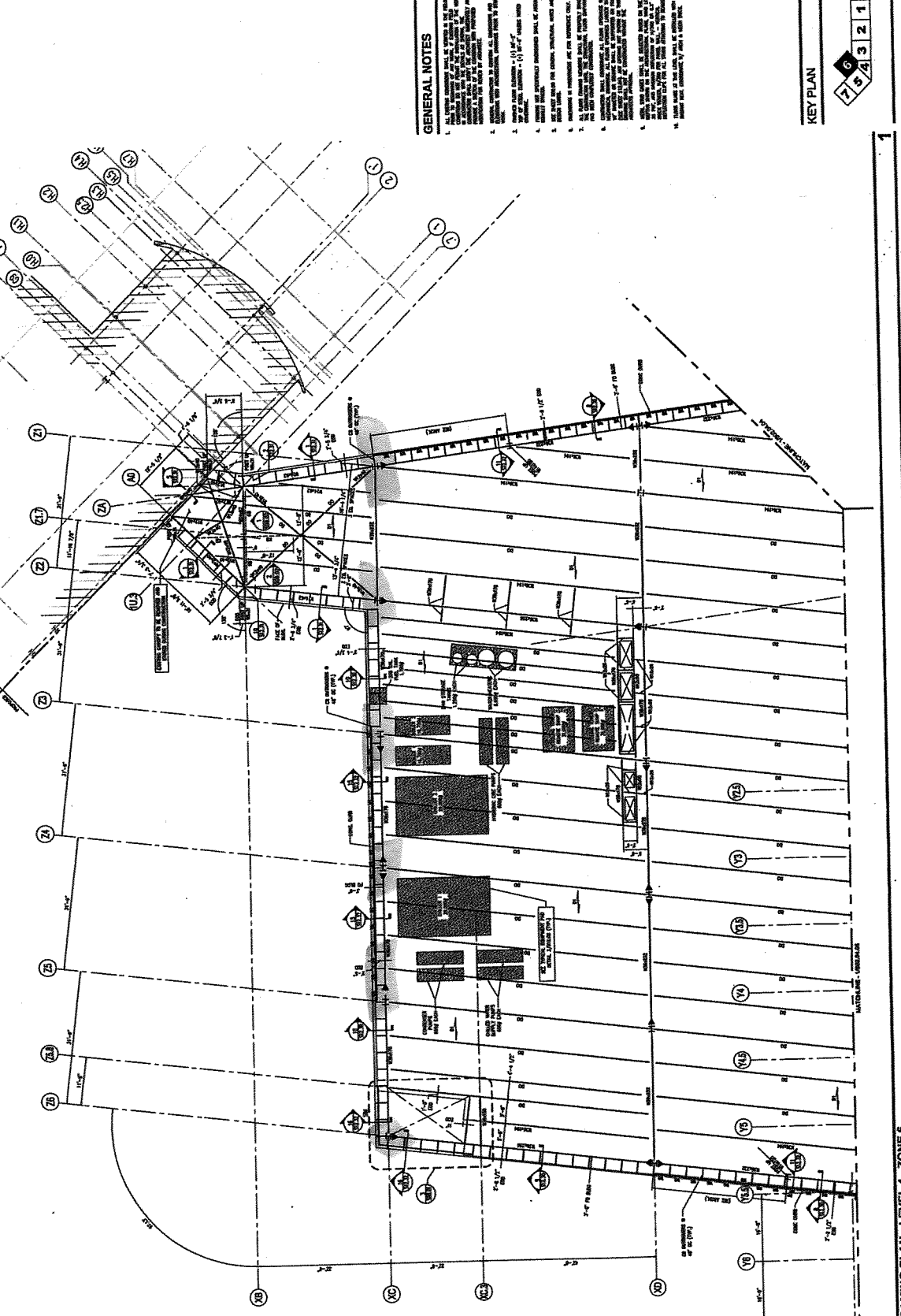

Project: Terminal Enhancement - Portland International Jetport  
 Project No.: 557-14  
 Date: 10-12-10  
 Technologist: GJM

FRAMING PLAN - LEVEL 4 - ZONE 6  
 SCALE: 1/8" = 1'-0"

KEY PLAN

7 6 3 2 1

S02.04.06



DATE	BY	REVISION
02/11/10	AE	ISSUED FOR PERMIT
02/11/10	AE	ISSUED FOR PERMIT
02/11/10	AE	ISSUED FOR PERMIT
02/11/10	AE	ISSUED FOR PERMIT
02/11/10	AE	ISSUED FOR PERMIT
02/11/10	AE	ISSUED FOR PERMIT
02/11/10	AE	ISSUED FOR PERMIT
02/11/10	AE	ISSUED FOR PERMIT
02/11/10	AE	ISSUED FOR PERMIT
02/11/10	AE	ISSUED FOR PERMIT

PROJECT: PORTLAND INTERNATIONAL JETPORT  
 SHEET: S02.04.06  
 DATE: 10-12-10  
 SCALE: 1/8" = 1'-0"

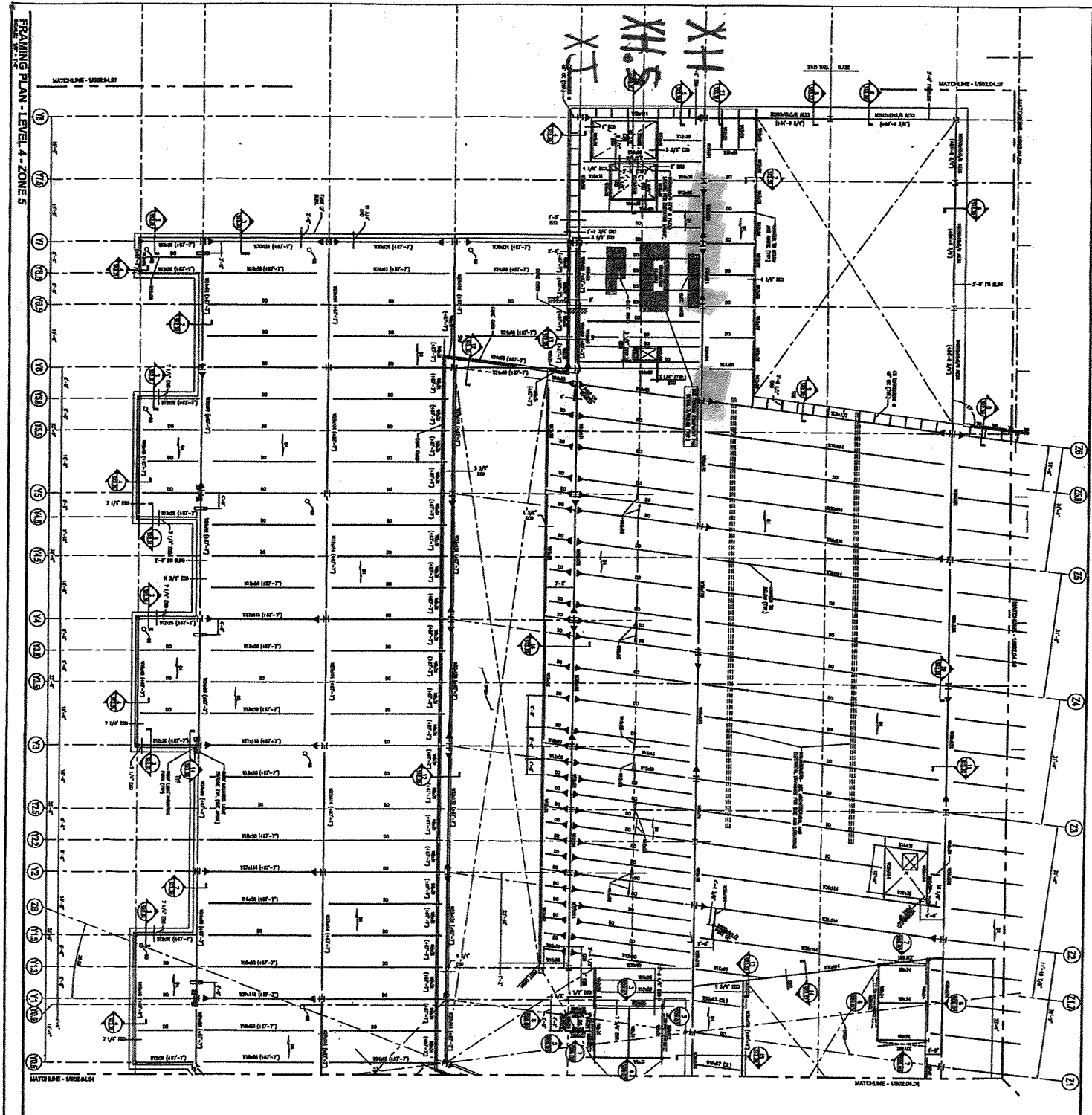

Project: Terminal Enhancement - Portland International Jetport  
 Project No.: 557-14  
 Date: 10-12-10  
 Technologist: GSM

- SHEET NOTES**
1. GENERAL NOTES TO BE REFERRED TO AS SHOWN ON SHEET 0101.
  2. ALL DIMENSIONS ARE IN FEET AND INCHES UNLESS OTHERWISE NOTED.
  3. ALL DIMENSIONS ARE TO FACE UNLESS OTHERWISE NOTED.
  4. ALL DIMENSIONS ARE TO CENTERLINE UNLESS OTHERWISE NOTED.
  5. ALL DIMENSIONS ARE TO CENTERLINE UNLESS OTHERWISE NOTED.
  6. ALL DIMENSIONS ARE TO CENTERLINE UNLESS OTHERWISE NOTED.
  7. ALL DIMENSIONS ARE TO CENTERLINE UNLESS OTHERWISE NOTED.
  8. ALL DIMENSIONS ARE TO CENTERLINE UNLESS OTHERWISE NOTED.
  9. ALL DIMENSIONS ARE TO CENTERLINE UNLESS OTHERWISE NOTED.
  10. ALL DIMENSIONS ARE TO CENTERLINE UNLESS OTHERWISE NOTED.

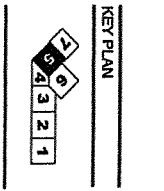

**Portland International Jetport**  
 1001 Westbank Street  
 Portland, Maine 04102

**Gensler**  
 1000 Massachusetts Avenue  
 Boston, MA 02110

**nest ASSOCIATES, INC.**  
 1000 Massachusetts Avenue  
 Boston, MA 02110

**S02.04.05**

DATE: 10/12/10

PROJECT: PORTLAND INTERNATIONAL JETPORT  
 SHEET: S02.04.05  
 TITLE: TERMINAL ENHANCEMENT - PORTLAND INTERNATIONAL JETPORT  
 LEVEL: 4 - ZONES

DESIGNED BY: [Signature]  
 CHECKED BY: [Signature]  
 APPROVED BY: [Signature]

Daily Observation Report

Project: <u>PORTLAND INTERIOR</u>	Time: <u>7:00</u> End Time	Mileage: _____ End
Project No.: <u>557-1A</u>	Tolls: <u>0.80</u> <u>EL PASS</u>	<u>12:50</u> Beg. Time
Per Diem/Lodging:	<u>1.25</u> Total Time	<u>ZS</u> Total

Observations:

In-Place Densities Done \_\_\_\_\_ All IPDs meet Specifications Reported to \_\_\_\_\_

Not all IPDs meet Specifications Reported to \_\_\_\_\_

Phone Calls:

- MET W/ CYCLOR FENGLIS OF CITY OF PORTLAND & GORF MITCHELL OF TURNER CONSTRUCTION
- DISCUSSED REMAINING SLAB PLACEMENTS & FLOOR FLATNESS

TESTING

- IT WAS AGREED THAT THE COLORED SLABS WOULD BE THE MOST CRITICAL FOR FLOOR FLATNESS TESTING
- REMAINING COLORED SLABS WILL BE (2) ON LEVEL 2, (1) ON LEVEL (3) AND 1 ON LEVEL FOUR.
- I ALSO BROUGHT TO CYCLOR'S ATTENTION THE CURRENT WITH TESTING & PLACING. WE DIFFERENT FROM PROPOSAL. COST OF MOBILIZING FOR A SECOND TEST WAS OK (SAFER MONEY BASED ON IMPORTANCE) & THIRD TEST WAS AUTHORIZED.
- ARCHITECT IS TO FOLLOW UP W/ FREQUENCY OF FIRE PROOF TESTING & MASSURY FREQUENCY

LEFT SITE AT 1:40 PM

Reviewed By: MRL Signed: Matthew J. [Signature]

<input type="checkbox"/> HNU _____ day	<input type="checkbox"/> Concrete Equipment	Monitoring Well Supplies
<input type="checkbox"/> Survey Level _____ day	<input type="checkbox"/> Nuc Densometer _____ day	_____ Bags of Bentonite
<input type="checkbox"/> Rebar Meter _____ day	<input type="checkbox"/> Coring Machine _____ Dia.	_____ 5 ft. Screen 2" PVC
_____ Bailers (Disposable)	_____ Inches Cored	_____ 10 ft. Screen 2" PVC
<input type="checkbox"/> Water Level Ind. _____ day	<input type="checkbox"/> Generator <input type="checkbox"/> Taylor Rental	_____ 5 ft. Riser 2" PVC
<input type="checkbox"/> Drill Rig _____ day	<input type="checkbox"/> Peristaltic Pump (note tubing used)	_____ 10 ft. Riser 2" PVC
<input type="checkbox"/> Backhoe _____ day	<input type="checkbox"/> Other	_____ Other _____
		_____ Locks
		_____ Caps
		_____ Points
		_____ Screw Caps



**SITE WORK  
DAILY FIELD REPORT**

PROJECT: Terminal Enhancement at the Portland International Jetport  
DATE: 10/13/10  
PROJECT LOCATION: Portland, Maine      PROJECT NO.: 557-14  
CLIENT: City of Portland                      WEATHER: Sunny  
CONTRACTOR: Turner Construction Co.  
PREVIOUS DATE ON SITE: 10/11/10

Time on-site at 8.75 hrs, 24 mi travel, Tolls: \$0.00  
Nuc. Densometer – NA

212 cy white colored lightweight concrete placed as slab-on-deck (slabs 4-3 and some of 4-4, see sketch). 4 sets of cylinders made. Air content consistently within spec. Slumps consistently higher than the specified  $5'' \pm 1''$  (8", 8", 7", 7.75"). After each out of spec test, both Lacey Fogg of Amec and a representative of Turner Construction were notified.

*MSK*

\_\_\_\_\_  
Michael Kramlich  
Prepared By

*Matthew J. Grady*  
\_\_\_\_\_  
Matthew Grady  
Reviewed By

CONC

WHITE, LIGHTWEIGHT  
SLABS 4-3 AND SOME OF 4-4  
APPROX 212 CY PLACED

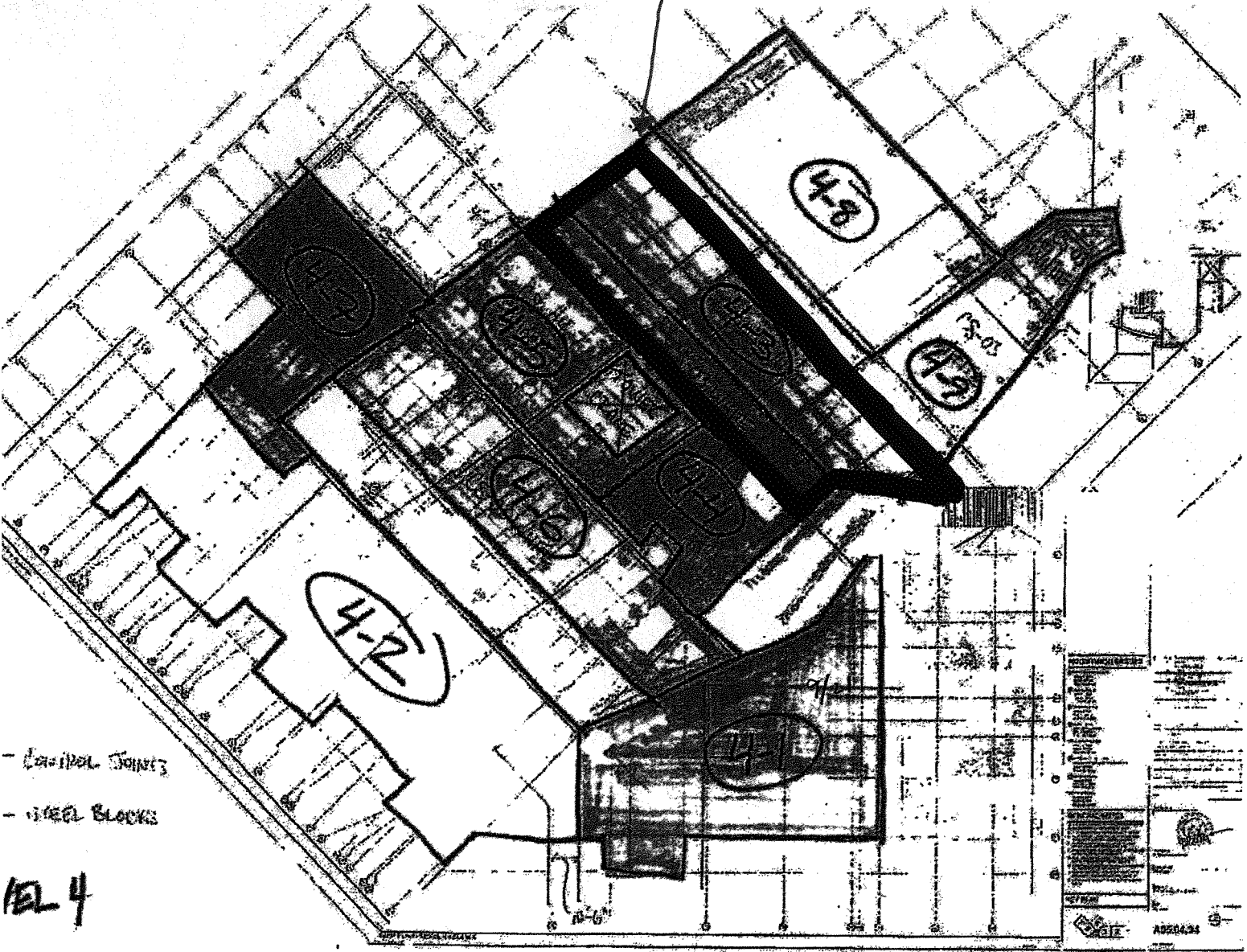

- CONTROL JOINTS
- STEEL BLOCKS

12L 4

PORTLAND INT'L AIRPORT  
TERMINAL EXPANSION  
557-14  
10-13-10  
MJK

**R. W. GILLESPIE & ASSOCIATES, INC.**  
 Geotechnical Engineering · Geohydrology · Materials Testing Services

200 International Dr., Ste 170  
 Portsmouth, NH 03801  
 603-427-0244 · Fax 603-430-2041

**Corporate Office**  
 86 Industrial Park Rd, Ste 4  
 Saco, ME 04072  
 207-286-8008 · Fax 207-286-2882

P.O. Box 289  
 Augusta, ME 04344  
 207-623-4914 · Fax 207-623-3429

**ULTRASONIC EXAMINATION REPORT**

Project Name: TERMINAL ENHANCEMENT @ PORTLAND JETPORT  
 Client/Project #: 557-14  
 General Contractor: TURNER CONSTRUCTION  
 Welding Contractor: JF SPERNS

Date: 10-13-10  
 Time on Site: 5.0  
 Mileage: 26  
 Tolls: 2.00

Weld Process: FCAW Location: LEVEL 1, ZONES  
 Weld Designation (AWS): TC-4AA-F

Weld Identification Area	Transducer Angle	Form Face	Leg	Decibels				Discontinuity			Remarks		
				Indication Level	Reference Level	Attenuation Factor	Indication Rating	Length	Angular Distance (Sound Path)	Depth from "A" Surface		Distance	
												From X	From Y
A	B	C	D										
XJ-26	70	A			79.9						TOP ACCEPT		
XJ 26+8'													
XJ 26+16'													
XJ 26+24'													
XJ 26+28'											TOP & BOTTOM ACCEPT		
XJ 25											TOP ACCEPT		
XJ 25+8'													



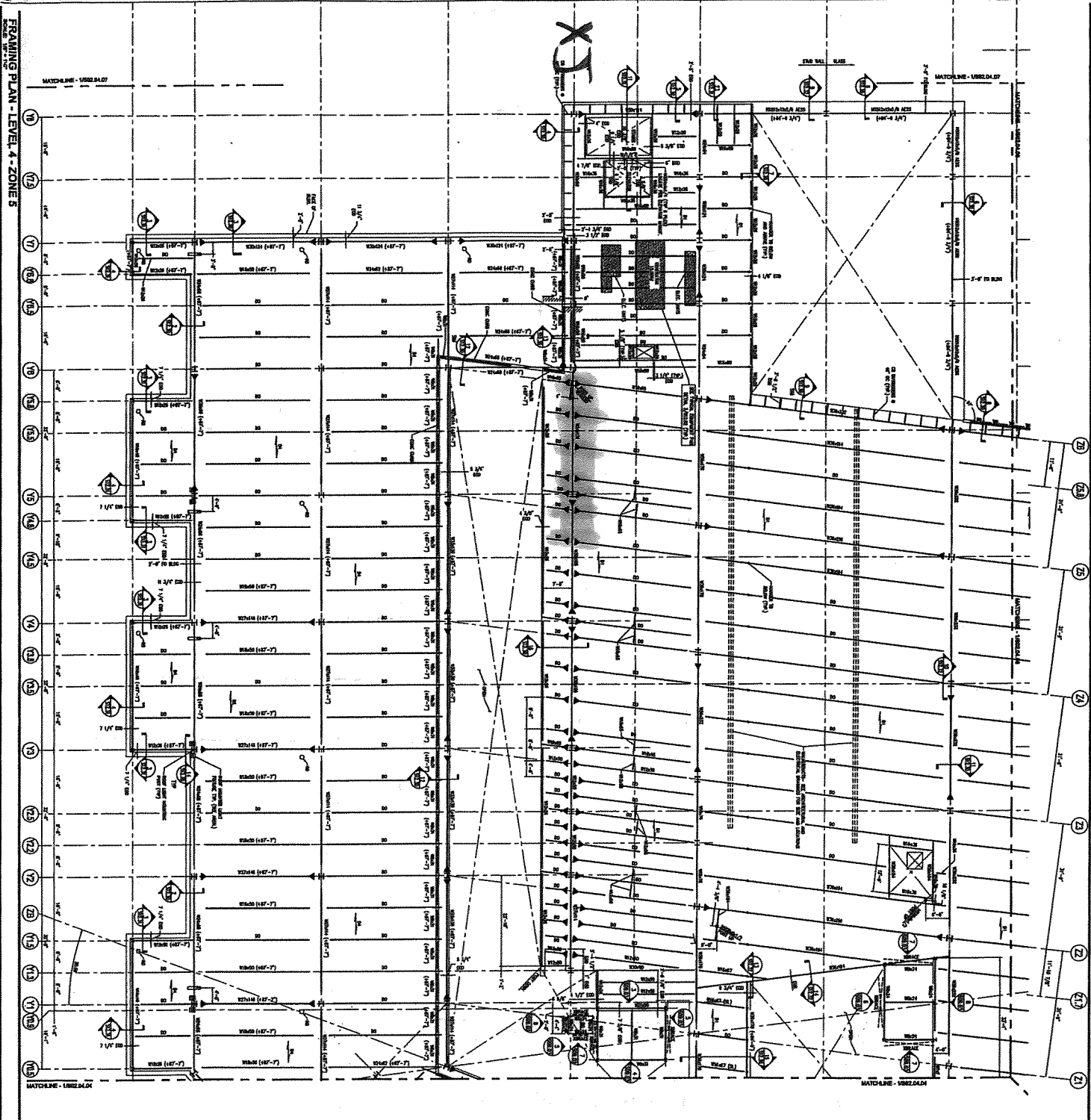

FRAMING PLAN - LEVEL 4 - ZONE 5

Project: Terminal Enhancement – Portland International Jetport  
 Project No.: 557-14  
 Date: 10-13-10  
 Technologist: GSW



KEY PLAN

- SHEET NOTES**
1. GENERAL NOTES TO BE REFERRED TO AS SHOWN ON SHEET 1001.01.
  2. ALL DIMENSIONS ARE IN FEET AND INCHES UNLESS OTHERWISE NOTED.
  3. ALL DIMENSIONS ARE TO FACE UNLESS OTHERWISE NOTED.
  4. ALL DIMENSIONS ARE TO CENTERLINE UNLESS OTHERWISE NOTED.
  5. ALL DIMENSIONS ARE TO CENTERLINE UNLESS OTHERWISE NOTED.
  6. ALL DIMENSIONS ARE TO CENTERLINE UNLESS OTHERWISE NOTED.
  7. ALL DIMENSIONS ARE TO CENTERLINE UNLESS OTHERWISE NOTED.
  8. ALL DIMENSIONS ARE TO CENTERLINE UNLESS OTHERWISE NOTED.
  9. ALL DIMENSIONS ARE TO CENTERLINE UNLESS OTHERWISE NOTED.
  10. ALL DIMENSIONS ARE TO CENTERLINE UNLESS OTHERWISE NOTED.
  11. ALL DIMENSIONS ARE TO CENTERLINE UNLESS OTHERWISE NOTED.
  12. ALL DIMENSIONS ARE TO CENTERLINE UNLESS OTHERWISE NOTED.
  13. ALL DIMENSIONS ARE TO CENTERLINE UNLESS OTHERWISE NOTED.
  14. ALL DIMENSIONS ARE TO CENTERLINE UNLESS OTHERWISE NOTED.
  15. ALL DIMENSIONS ARE TO CENTERLINE UNLESS OTHERWISE NOTED.
  16. ALL DIMENSIONS ARE TO CENTERLINE UNLESS OTHERWISE NOTED.
  17. ALL DIMENSIONS ARE TO CENTERLINE UNLESS OTHERWISE NOTED.
  18. ALL DIMENSIONS ARE TO CENTERLINE UNLESS OTHERWISE NOTED.
  19. ALL DIMENSIONS ARE TO CENTERLINE UNLESS OTHERWISE NOTED.
  20. ALL DIMENSIONS ARE TO CENTERLINE UNLESS OTHERWISE NOTED.

S02.04.05



NO.	DATE	DESCRIPTION
1	10/13/10	ISSUED FOR PERMITTING
2		
3		
4		
5		
6		
7		
8		
9		
10		

**Portland International Jetport**  
 1001 Westbrook Street  
 Portland, Maine 04102

**Gensler**  
 300 Lake Street  
 Portland, Maine 04102

**west ASSOCIATES, INC.**  
 1001 Westbrook Street  
 Portland, Maine 04102



Daily Observation Report

Project: <u>PORTLAND JETPORT</u>	Time: _____ End Time	Mileage: _____ End
Project No.: <u>557-14</u>	Tolls: <u>-</u>	_____ Beg. Time
Per Diem/Lodging: _____	✓ <u>5H</u> Total Time	✓ <u>25</u> Total

Observations:

In-Place Densities Done \_\_\_\_\_ All IPDs meet Specifications Reported to \_\_\_\_\_  
 \_\_\_\_\_ Not all IPDs meet Specifications Reported to \_\_\_\_\_

Phone Calls:

- ASSISTED NJK WITH LIGHTWEIGHT CONCRETE TESTING

Reviewed By: MAG

Signed: [Signature] EEL

<input type="checkbox"/> HNU _____ day	<input type="checkbox"/> Concrete Equipment	Monitoring Well Supplies
<input type="checkbox"/> Survey Level _____ day	<input type="checkbox"/> Nuc Densometer _____ day	_____ Bags of Bentonite
<input type="checkbox"/> Rebar Meter _____ day	<input type="checkbox"/> Coring Machine _____ Dia.	_____ 5 ft. Screen 2" PVC
_____ Bailers (Disposable)	_____ Inches Cored	_____ 10 ft. Screen 2" PVC
<input type="checkbox"/> Water Level Ind. _____ day	<input type="checkbox"/> Generator <input type="checkbox"/> Taylor Rental	_____ 5 ft. Riser 2" PVC
<input type="checkbox"/> Drill Rig _____ day	<input type="checkbox"/> Peristaltic Pump (note tubing used)	_____ 10 ft. Riser 2" PVC
<input type="checkbox"/> Backhoe _____ day	<input type="checkbox"/> Other	_____ Other _____
		_____ Locks
		_____ Caps
		_____ Points
		_____ Screw Caps



## SITE WORK DAILY FIELD REPORT

PROJECT: Terminal Enhancement at the Portland International Jetport  
DATE: 10/14/10  
PROJECT LOCATION: Portland, Maine      PROJECT NO.: 557-14  
CLIENT: City of Portland      WEATHER: Sunny  
CONTRACTOR: Turner Construction Co.  
PREVIOUS DATE ON SITE: 10/13/10

Time on-site at 2.75 hrs, 24 mi travel, Tolls: \$0.00  
Nuc. Densometer – NA

Received call from Lacey Fogg of Amec regarding an ongoing concrete placement this morning. Both Turner Construction and Francis Harvey had indicated yesterday that the next placement would be Monday of next week at the earliest. Placement was under 5cy, and therefore we were not required to be present for testing per the project specifications.

CPU 4 sets of cylinders made 10/13. Curing box had been moved from original location at unknown time.

*MJK*

---

Michael Kramlich

Prepared By

*Matthew Grady*

---

Matthew Grady

Reviewed By