



## SITE WORK DAILY FIELD REPORT

PROJECT: Terminal Enhancement at the Portland International Jetport

DATE: 07/06/2010

PROJECT LOCATION: Portland, Maine

PROJECT NO.: 557-14

CLIENT: City of Portland

WEATHER: Sun: 91°F +

CONTRACTOR: Turner Construction Co.

PREVIOUS DATE ON SITE: 07/02/2010

Time on-site at 5 1/2 hrs, 43 mi travel, Tolls: \$0.00  
Nuc. Densometer – 1/2 day (L 500)

### AREA 'A'

Upper lot: No work observed.

### AREA 'B'

Gorham Sand & Gravel installed 1 foot of 3" material inside foundation at roadway STA 10+00. 1 passing test recorded at the site.

### AREA 'C'

33 yd. concrete placed in footings from XJ/Y0.5 to Y1.5 and XJ to about 5' North of XK/between lines Z1 and Z2 and foundation walls from Y1/5' North of XK to XM. Sample was taken from 1<sup>st</sup> load and tested with representatives from Turner and Auburn on hand. According to the concrete contractor and checked with Jeff from Turner, the concrete was allowed to exceed 90°F if it remained workable and kept a consistent slump. This was incorrect, and was only identified as a problem after checking the temperature of the 3<sup>rd</sup> load at Turner's request, which measured 91°F, as had the 1<sup>st</sup> load. The 3<sup>rd</sup> truck was sent away after having placed about 5 yd. into the wall form. An additional truck was sent from Auburn containing 10 bags of ice, which cooled the concrete to 87°F.

Michael Kramlich

Prepared By

Matthew Grady

Reviewed By

CONC

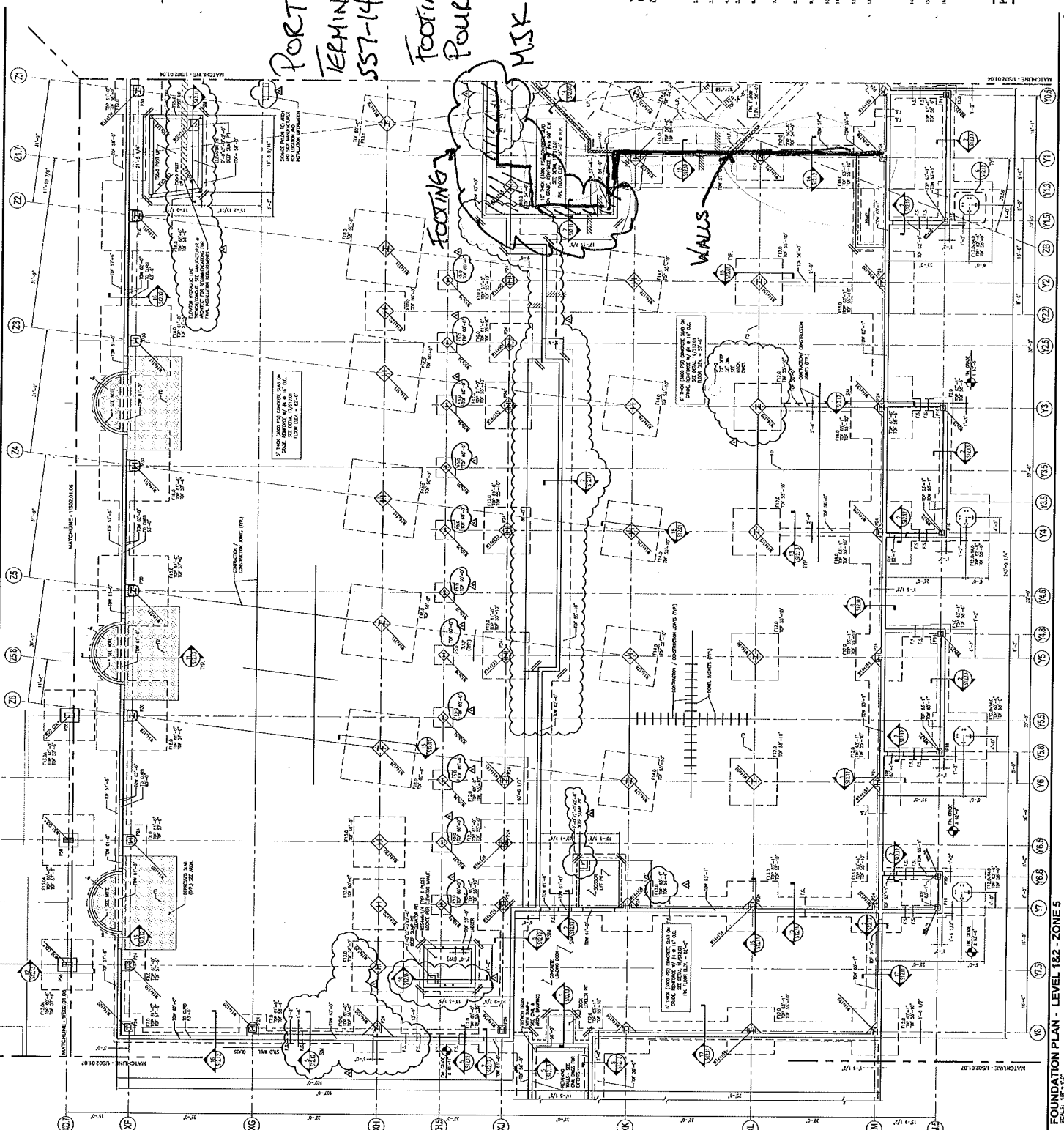

PORTLAND INT'L AIRPORT  
 TERMINAL EXPANSION  
 557-14  
 FOOTINGS + WALLS  
 POURED 7/6/10  
 MSK

Portland International  
 Jetport  
 1001 Westbrook Street  
 Portland, Maine 04102

Gensler  
 nest ASSOCIATES, INC.  
 ARCHITECTS

**SHEET NOTES**

1. ALL DIMENSIONS UNLESS OTHERWISE NOTED ARE IN FEET AND INCHES.
2. FOUNDATION SHALL BE CONSTRUCTED TO SUPPORT ALL LOADS INCLUDING FUTURE CONSTRUCTION.
3. ALL FOUNDATION SHALL BE CONSTRUCTED TO MEET ALL LOCAL AND STATE REQUIREMENTS.
4. ALL FOUNDATION SHALL BE CONSTRUCTED TO MEET ALL DESIGN REQUIREMENTS.
5. ALL FOUNDATION SHALL BE CONSTRUCTED TO MEET ALL CONTRACT REQUIREMENTS.
6. ALL FOUNDATION SHALL BE CONSTRUCTED TO MEET ALL SPECIFICATION REQUIREMENTS.
7. ALL FOUNDATION SHALL BE CONSTRUCTED TO MEET ALL DRAWING REQUIREMENTS.
8. ALL FOUNDATION SHALL BE CONSTRUCTED TO MEET ALL PROJECT REQUIREMENTS.
9. ALL FOUNDATION SHALL BE CONSTRUCTED TO MEET ALL CLIENT REQUIREMENTS.
10. ALL FOUNDATION SHALL BE CONSTRUCTED TO MEET ALL OWNER REQUIREMENTS.

**GENERAL NOTES**

1. ALL FOUNDATION SHALL BE CONSTRUCTED TO MEET ALL DESIGN REQUIREMENTS.
2. ALL FOUNDATION SHALL BE CONSTRUCTED TO MEET ALL CONTRACT REQUIREMENTS.
3. ALL FOUNDATION SHALL BE CONSTRUCTED TO MEET ALL SPECIFICATION REQUIREMENTS.
4. ALL FOUNDATION SHALL BE CONSTRUCTED TO MEET ALL DRAWING REQUIREMENTS.
5. ALL FOUNDATION SHALL BE CONSTRUCTED TO MEET ALL PROJECT REQUIREMENTS.
6. ALL FOUNDATION SHALL BE CONSTRUCTED TO MEET ALL CLIENT REQUIREMENTS.
7. ALL FOUNDATION SHALL BE CONSTRUCTED TO MEET ALL OWNER REQUIREMENTS.
8. ALL FOUNDATION SHALL BE CONSTRUCTED TO MEET ALL LOCAL AND STATE REQUIREMENTS.
9. ALL FOUNDATION SHALL BE CONSTRUCTED TO MEET ALL DESIGN REQUIREMENTS.
10. ALL FOUNDATION SHALL BE CONSTRUCTED TO MEET ALL CONTRACT REQUIREMENTS.
11. ALL FOUNDATION SHALL BE CONSTRUCTED TO MEET ALL SPECIFICATION REQUIREMENTS.
12. ALL FOUNDATION SHALL BE CONSTRUCTED TO MEET ALL DRAWING REQUIREMENTS.
13. ALL FOUNDATION SHALL BE CONSTRUCTED TO MEET ALL PROJECT REQUIREMENTS.
14. ALL FOUNDATION SHALL BE CONSTRUCTED TO MEET ALL CLIENT REQUIREMENTS.
15. ALL FOUNDATION SHALL BE CONSTRUCTED TO MEET ALL OWNER REQUIREMENTS.

**KEY PLAN**

1  
2  
3  
4  
5

FOUNDATION PLAN - LEVEL 1&2 - ZONE 5

S02.01.05

IPD

SHEET NOTES

Local Coordinate Schedule

Point	North	East
1	29135.00	10500.00
2	29135.00	10500.00
3	29135.00	10500.00
4	29135.00	10500.00
5	29135.00	10500.00
6	29135.00	10500.00
7	29135.00	10500.00
8	29135.00	10500.00
9	29135.00	10500.00
10	29135.00	10500.00
11	29135.00	10500.00
12	29135.00	10500.00
13	29135.00	10500.00
14	29135.00	10500.00
15	29135.00	10500.00
16	29135.00	10500.00
17	29135.00	10500.00
18	29135.00	10500.00
19	29135.00	10500.00
20	29135.00	10500.00
21	29135.00	10500.00
22	29135.00	10500.00
23	29135.00	10500.00
24	29135.00	10500.00
25	29135.00	10500.00
26	29135.00	10500.00
27	29135.00	10500.00
28	29135.00	10500.00
29	29135.00	10500.00
30	29135.00	10500.00
31	29135.00	10500.00
32	29135.00	10500.00
33	29135.00	10500.00
34	29135.00	10500.00
35	29135.00	10500.00
36	29135.00	10500.00
37	29135.00	10500.00
38	29135.00	10500.00
39	29135.00	10500.00
40	29135.00	10500.00
41	29135.00	10500.00
42	29135.00	10500.00
43	29135.00	10500.00
44	29135.00	10500.00
45	29135.00	10500.00
46	29135.00	10500.00
47	29135.00	10500.00
48	29135.00	10500.00
49	29135.00	10500.00
50	29135.00	10500.00
51	29135.00	10500.00
52	29135.00	10500.00
53	29135.00	10500.00
54	29135.00	10500.00
55	29135.00	10500.00
56	29135.00	10500.00
57	29135.00	10500.00
58	29135.00	10500.00
59	29135.00	10500.00
60	29135.00	10500.00
61	29135.00	10500.00
62	29135.00	10500.00
63	29135.00	10500.00
64	29135.00	10500.00
65	29135.00	10500.00
66	29135.00	10500.00
67	29135.00	10500.00
68	29135.00	10500.00
69	29135.00	10500.00
70	29135.00	10500.00
71	29135.00	10500.00
72	29135.00	10500.00
73	29135.00	10500.00
74	29135.00	10500.00
75	29135.00	10500.00
76	29135.00	10500.00
77	29135.00	10500.00
78	29135.00	10500.00
79	29135.00	10500.00
80	29135.00	10500.00
81	29135.00	10500.00
82	29135.00	10500.00
83	29135.00	10500.00
84	29135.00	10500.00
85	29135.00	10500.00
86	29135.00	10500.00
87	29135.00	10500.00
88	29135.00	10500.00
89	29135.00	10500.00
90	29135.00	10500.00
91	29135.00	10500.00
92	29135.00	10500.00
93	29135.00	10500.00
94	29135.00	10500.00
95	29135.00	10500.00
96	29135.00	10500.00
97	29135.00	10500.00
98	29135.00	10500.00
99	29135.00	10500.00
100	29135.00	10500.00

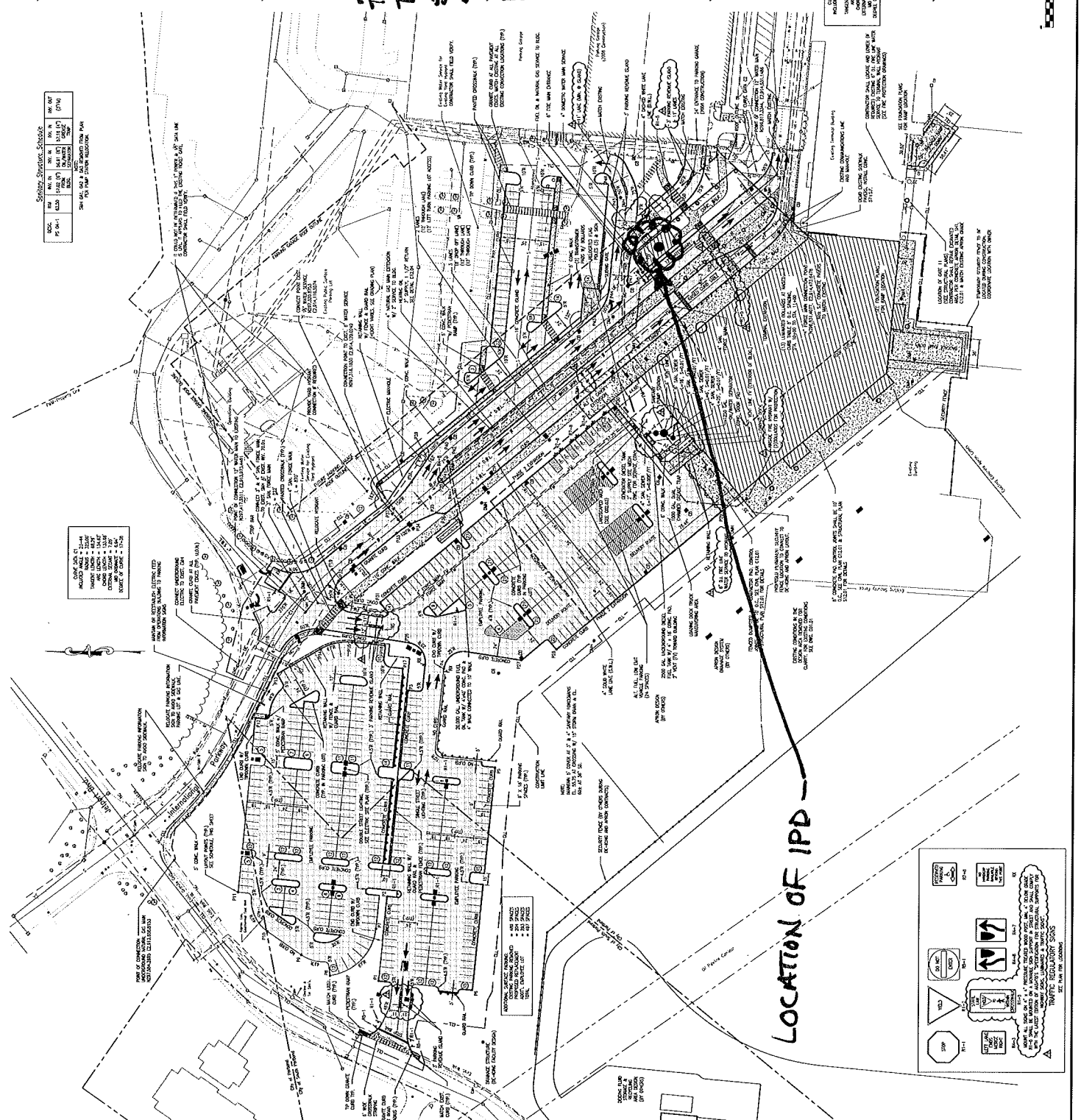

Portland International Jetport  
1001 Westbank Street  
Portland, Maine 04102

**Gensler**

**BEST ASSOCIATES, INC.**  
Engineering, Construction Services, Construction Management

PORTLAND INT'L JETPORT  
TERMINAL EXPANSION  
SS7-N  
7/16/2010  
MSK

GENERAL NOTES

1. ALL DIMENSIONS SHOWN UNLESS OTHERWISE NOTED.
2. THE CONSTRUCTION DOCUMENTS SHALL BE THE AUTHORITY IN THE EVENT OF A DISCREPANCY.
3. CONTRACTOR SHALL BE RESPONSIBLE FOR OBTAINING ALL NECESSARY PERMITS AND APPROVALS FROM THE CITY OF PORTLAND.
4. THE CONTRACTOR SHALL BE RESPONSIBLE FOR OBTAINING ALL NECESSARY PERMITS AND APPROVALS FROM THE CITY OF PORTLAND.
5. THE CONTRACTOR SHALL BE RESPONSIBLE FOR OBTAINING ALL NECESSARY PERMITS AND APPROVALS FROM THE CITY OF PORTLAND.
6. THE CONTRACTOR SHALL BE RESPONSIBLE FOR OBTAINING ALL NECESSARY PERMITS AND APPROVALS FROM THE CITY OF PORTLAND.
7. THE CONTRACTOR SHALL BE RESPONSIBLE FOR OBTAINING ALL NECESSARY PERMITS AND APPROVALS FROM THE CITY OF PORTLAND.
8. THE CONTRACTOR SHALL BE RESPONSIBLE FOR OBTAINING ALL NECESSARY PERMITS AND APPROVALS FROM THE CITY OF PORTLAND.
9. THE CONTRACTOR SHALL BE RESPONSIBLE FOR OBTAINING ALL NECESSARY PERMITS AND APPROVALS FROM THE CITY OF PORTLAND.
10. THE CONTRACTOR SHALL BE RESPONSIBLE FOR OBTAINING ALL NECESSARY PERMITS AND APPROVALS FROM THE CITY OF PORTLAND.

PORTLAND INTERNATIONAL JETPORT  
7/16/2010  
SS7-N  
C02.01

**TRAFFIC REGULATORY SIGN**

SEE PLAN FOR LOCATION

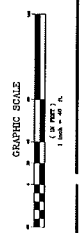



**SITE WORK  
DAILY FIELD REPORT**

PROJECT: Terminal Enhancement at the Portland International Jetport  
DATE: 07/07/2010  
PROJECT LOCATION: Portland, Maine      PROJECT NO.: 557-14  
CLIENT: City of Portland      WEATHER: Sun: 83°F  
CONTRACTOR: Turner Construction Co.  
PREVIOUS DATE ON SITE: 07/06/2010

Time on-site at 4 hrs, 28 mi travel, Tolls: \$1.00  
Nuc. Densometer – N/A

**AREA 'A'**

Upper lot: No work observed.

**AREA 'B'**

38 yd. concrete placed in footings at ( ) and piers at ( ). Temperature readings were taken at the beginning of each load. Second load delivered was sampled with Turner representative on hand, and was found to be out of spec in regards to air entrainment (4% measured, 6% ± 1½% specified). 4<sup>th</sup> load was tested for slump due to visual inspection and measured 7¼" before placing. Instead of rejecting the load, it was decided by the Turner rep to let the truck spin for a few minutes, since there was plenty of time before the 90 minute limit. After about 20 minutes of spinning, slump was reduced to 6" and load was placed.

*XF, Y7, 5B, 25*  
*XJ, Y7, 46.5*

**AREA 'C'**

No work observed.

*MSK*

Michael Kramlich

Prepared By

*Matthew J. Grady*

Matthew Grady

Reviewed By

Conc.

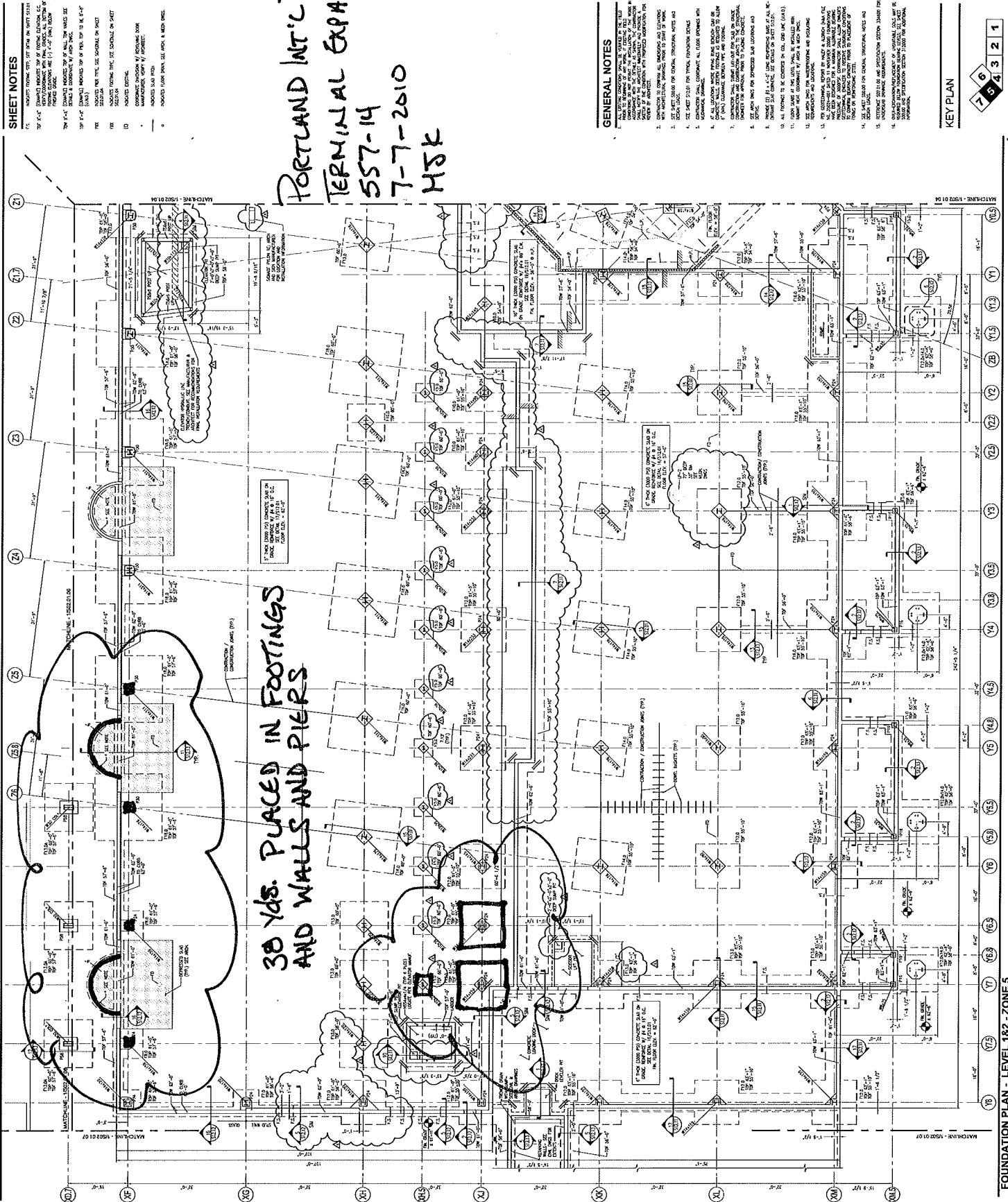

**Portland International Jetport**  
 1001 Westbrook Street  
 Portland, Maine 04102

**Genster**

**ME&T ASSOCIATES, INC.**  
 ENGINEERS ARCHITECTS INTERIORS CONSTRUCTION MANAGEMENT

2013 © Genster, Inc.  
 Main Building, 15022 010  
 Foundation Plan - Level 1&2 - Zone 5  
 February 22, 2010

**SHEET NOTES**

1. MATCHLINE TO THE RIGHT OF THIS SHEET IS 15022 010.
2. ALL DIMENSIONS ARE UNLESS OTHERWISE NOTED.
3. ALL DIMENSIONS ARE UNLESS OTHERWISE NOTED.
4. ALL DIMENSIONS ARE UNLESS OTHERWISE NOTED.
5. ALL DIMENSIONS ARE UNLESS OTHERWISE NOTED.
6. ALL DIMENSIONS ARE UNLESS OTHERWISE NOTED.
7. ALL DIMENSIONS ARE UNLESS OTHERWISE NOTED.
8. ALL DIMENSIONS ARE UNLESS OTHERWISE NOTED.
9. ALL DIMENSIONS ARE UNLESS OTHERWISE NOTED.
10. ALL DIMENSIONS ARE UNLESS OTHERWISE NOTED.
11. ALL DIMENSIONS ARE UNLESS OTHERWISE NOTED.
12. ALL DIMENSIONS ARE UNLESS OTHERWISE NOTED.
13. ALL DIMENSIONS ARE UNLESS OTHERWISE NOTED.
14. ALL DIMENSIONS ARE UNLESS OTHERWISE NOTED.
15. ALL DIMENSIONS ARE UNLESS OTHERWISE NOTED.
16. ALL DIMENSIONS ARE UNLESS OTHERWISE NOTED.
17. ALL DIMENSIONS ARE UNLESS OTHERWISE NOTED.
18. ALL DIMENSIONS ARE UNLESS OTHERWISE NOTED.

**GENERAL NOTES**

1. ALL DIMENSIONS ARE UNLESS OTHERWISE NOTED.
2. ALL DIMENSIONS ARE UNLESS OTHERWISE NOTED.
3. ALL DIMENSIONS ARE UNLESS OTHERWISE NOTED.
4. ALL DIMENSIONS ARE UNLESS OTHERWISE NOTED.
5. ALL DIMENSIONS ARE UNLESS OTHERWISE NOTED.
6. ALL DIMENSIONS ARE UNLESS OTHERWISE NOTED.
7. ALL DIMENSIONS ARE UNLESS OTHERWISE NOTED.
8. ALL DIMENSIONS ARE UNLESS OTHERWISE NOTED.
9. ALL DIMENSIONS ARE UNLESS OTHERWISE NOTED.
10. ALL DIMENSIONS ARE UNLESS OTHERWISE NOTED.
11. ALL DIMENSIONS ARE UNLESS OTHERWISE NOTED.
12. ALL DIMENSIONS ARE UNLESS OTHERWISE NOTED.
13. ALL DIMENSIONS ARE UNLESS OTHERWISE NOTED.
14. ALL DIMENSIONS ARE UNLESS OTHERWISE NOTED.
15. ALL DIMENSIONS ARE UNLESS OTHERWISE NOTED.
16. ALL DIMENSIONS ARE UNLESS OTHERWISE NOTED.
17. ALL DIMENSIONS ARE UNLESS OTHERWISE NOTED.
18. ALL DIMENSIONS ARE UNLESS OTHERWISE NOTED.

**KEY PLAN**

FOUNDATION PLAN - LEVEL 1&2 - ZONE 5

**S02.01.05**



**SITE WORK  
DAILY FIELD REPORT**

PROJECT: Terminal Enhancement at the Portland International Jetport

DATE: 07/8/2010

PROJECT LOCATION: Portland, Maine

PROJECT NO.: 557-14

CLIENT: City of Portland

WEATHER: Sun

CONTRACTOR: Turner Construction Co.

PREVIOUS DATE ON SITE: 07/2/2010

Time on-site at 4.5 hrs, 40 mi travel, Tolls: \$2.00  
Nuc. Densometer – 1/2 day (L 244)

**AREA 'A'**

Upper lot: No work observed.

**AREA 'B'**

Gorham Sand & Gravel backfilled over a natural gas line, around the sanitary pump station, and over a 12" drainage pipe using a vibratory plate compactor. Eight in-place densities (IPD's) were taken on poorly graded sand (sample #11194) material. IPD's met specification of 90% of maximum density in landscaped areas and 95% within 3 feet of finished grade. Refer to attached IPD report and sketch for test locations.

**AREA 'C'**

No work observed

  
\_\_\_\_\_  
Rodney Collard

Prepared By

  
\_\_\_\_\_  
Matthew Grady

Reviewed By

\_\_\_\_\_  
R. W. Gillespie & Associates 86 industrial Park Rd., Suite 4, Saco, ME 04072- (207)286-8008

Kodney Collard

Portland Jetport  
557-14 7/8/10

**CONCRETE**  
 CLASS OF CONCRETE = 4000 PSI  
 FINISH = EXPOSED AGGREGATE  
 FINISH OF CURVE = 1:10  
 FINISH OF STRAIGHT = 1:40  
 FINISH OF JOINT = 1:40

**Structural Schedule**

DESC.	REQ.	QTY	UNIT	UNIT PRICE	TOTAL
PC ON-1	62.50	1.00	EA	62.50	62.50
REINFORCING BAR	15.00	10.00	LB	150.00	150.00
FORMWORK	1.00	100.00	SQ YD	100.00	100.00
SEWER	1.00	1.00	EA	1.00	1.00
TOTAL					313.50

SEE SHEET 424 FOR DIMENSIONS FROM PLAN  
 PER PUMP STATION RESPONSE.

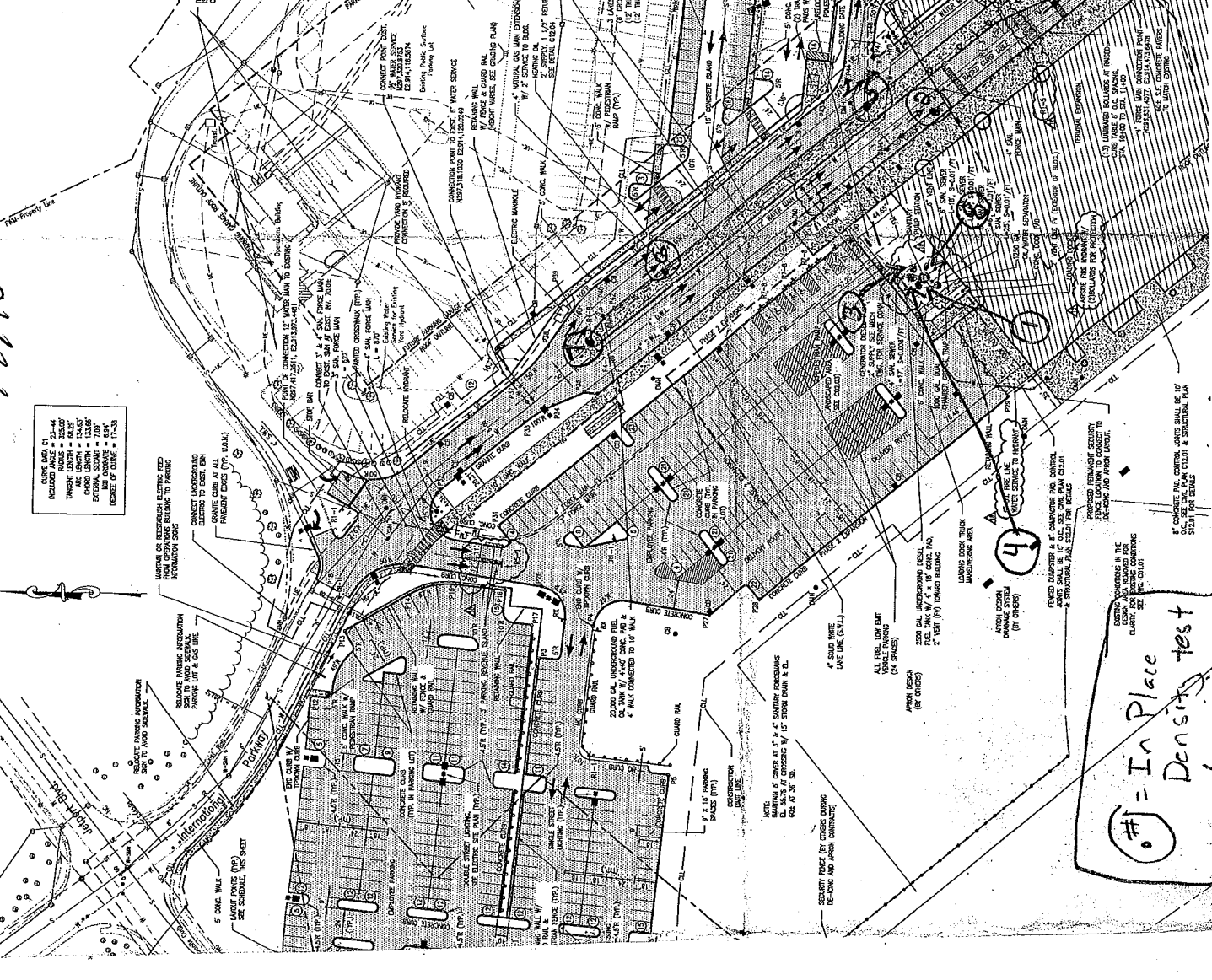

# = In Place  
 Density Test

CONCRETE FINISH SHALL BE 1\"/>

PROPOSED REINFORCEMENT SECURITY  
 FENCE SOLUTION TO CONNECT TO  
 FENCE AND WITH LAYOUT.

4

REMOVE EXISTING 6\"/>

REMOVE EXISTING 6\"/>

REMOVE EXISTING 6\"/>

REMOVE EXISTING 6\"/>

REMOVE EXISTING 6\"/>

REMOVE EXISTING 6\"/>

REMOVE EXISTING 6\"/>

REMOVE EXISTING 6\"/>

REMOVE EXISTING 6\"/>

REMOVE EXISTING 6\"/>

REMOVE EXISTING 6\"/>

REMOVE EXISTING 6\"/>

REMOVE EXISTING 6\"/>

REMOVE EXISTING 6\"/>

REMOVE EXISTING 6\"/>

Kodney Collard  
 Portland Jetport  
 557-14 7/8/10

ITEM NO.	DESCRIPTION	QTY	UNIT	DATE	BY
1001	12" DIA. SAND	100	CU YD	10/10/07	JK
1002	12" DIA. SAND	100	CU YD	10/10/07	JK
1003	12" DIA. SAND	100	CU YD	10/10/07	JK
1004	12" DIA. SAND	100	CU YD	10/10/07	JK
1005	12" DIA. SAND	100	CU YD	10/10/07	JK
1006	12" DIA. SAND	100	CU YD	10/10/07	JK
1007	12" DIA. SAND	100	CU YD	10/10/07	JK
1008	12" DIA. SAND	100	CU YD	10/10/07	JK
1009	12" DIA. SAND	100	CU YD	10/10/07	JK
1010	12" DIA. SAND	100	CU YD	10/10/07	JK

NO.	DESCRIPTION	QTY	UNIT
1	12" DIA. SAND	100	CU YD
2	12" DIA. SAND	100	CU YD
3	12" DIA. SAND	100	CU YD
4	12" DIA. SAND	100	CU YD
5	12" DIA. SAND	100	CU YD
6	12" DIA. SAND	100	CU YD
7	12" DIA. SAND	100	CU YD
8	12" DIA. SAND	100	CU YD
9	12" DIA. SAND	100	CU YD
10	12" DIA. SAND	100	CU YD

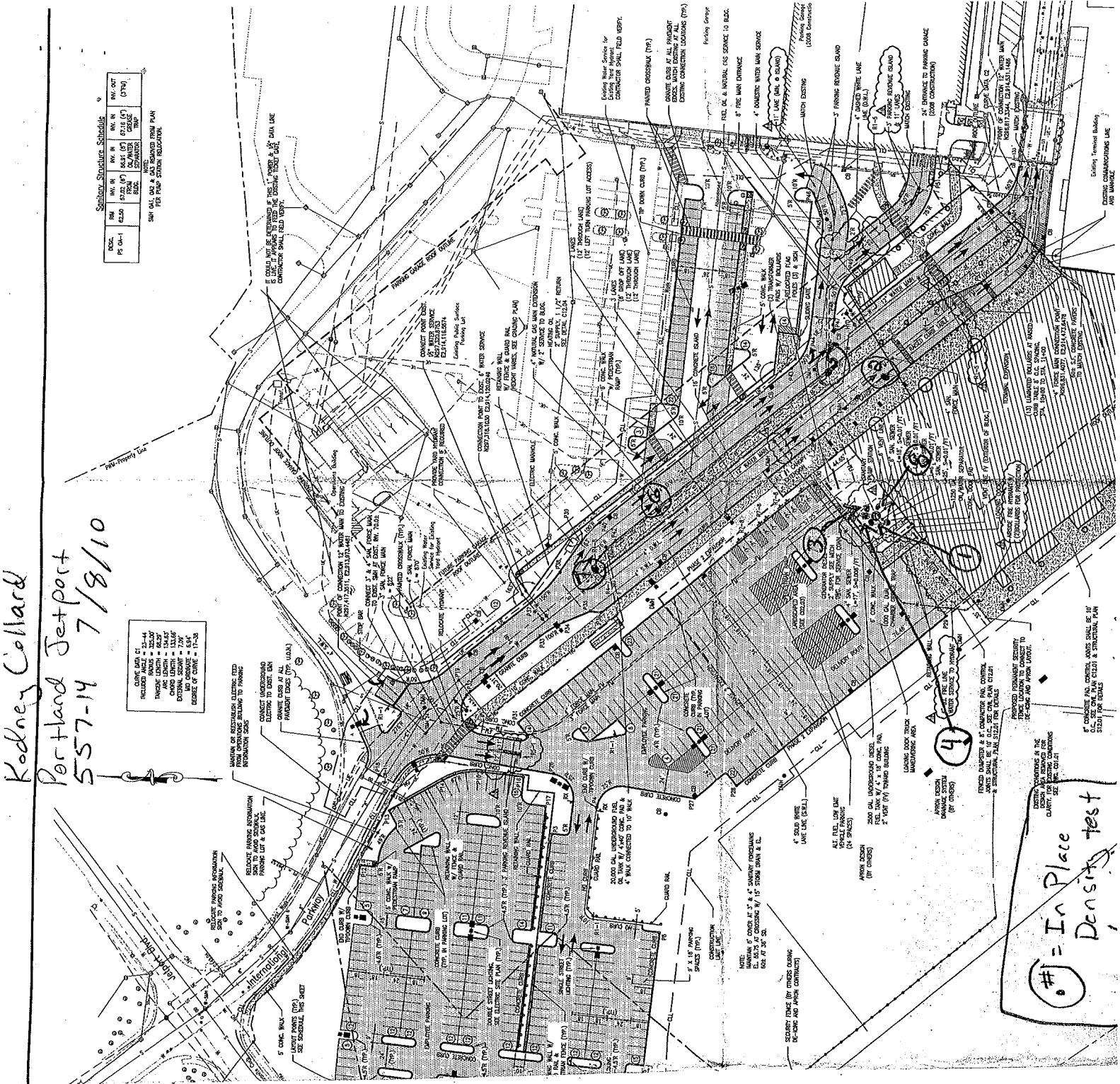

# = In Place  
 Density test

4

1

2

3





## SITE WORK DAILY FIELD REPORT

PROJECT: Terminal Enhancement at the Portland International Jetport  
DATE: 07/9/2010  
PROJECT LOCATION: Portland, Maine      PROJECT NO.: 557-14  
CLIENT: City of Portland      WEATHER: Sun  
CONTRACTOR: Turner Construction Co.  
PREVIOUS DATE ON SITE: 07/8/2010

Time on-site at 9 hrs, 10 mi travel, Tolls: \$0.00  
Nuc. Densometer - 1 day (L 500)

### AREA 'A'

Upper lot: No work observed.

### AREA 'B'

Gorham Sand & Gravel backfilled fuel line, drain line, and around drainage and electrical structures. 20 yd. of concrete was placed in footings at ( ). 3 excavators observed working on site excavating for footings and pipe trenches or backfilling at various times. 2 dozers observed cutting banks for common fill or grading roadway. Loader hauling sand or 3/4" stone for backfill purposes.

### AREA 'C'

27 yd. concrete placed in walls at ( ) in Zone 5.

*MJK*

Michael Kramlich

Prepared By

*Matthew J. Grady*

Matthew Grady

Reviewed By

CONC

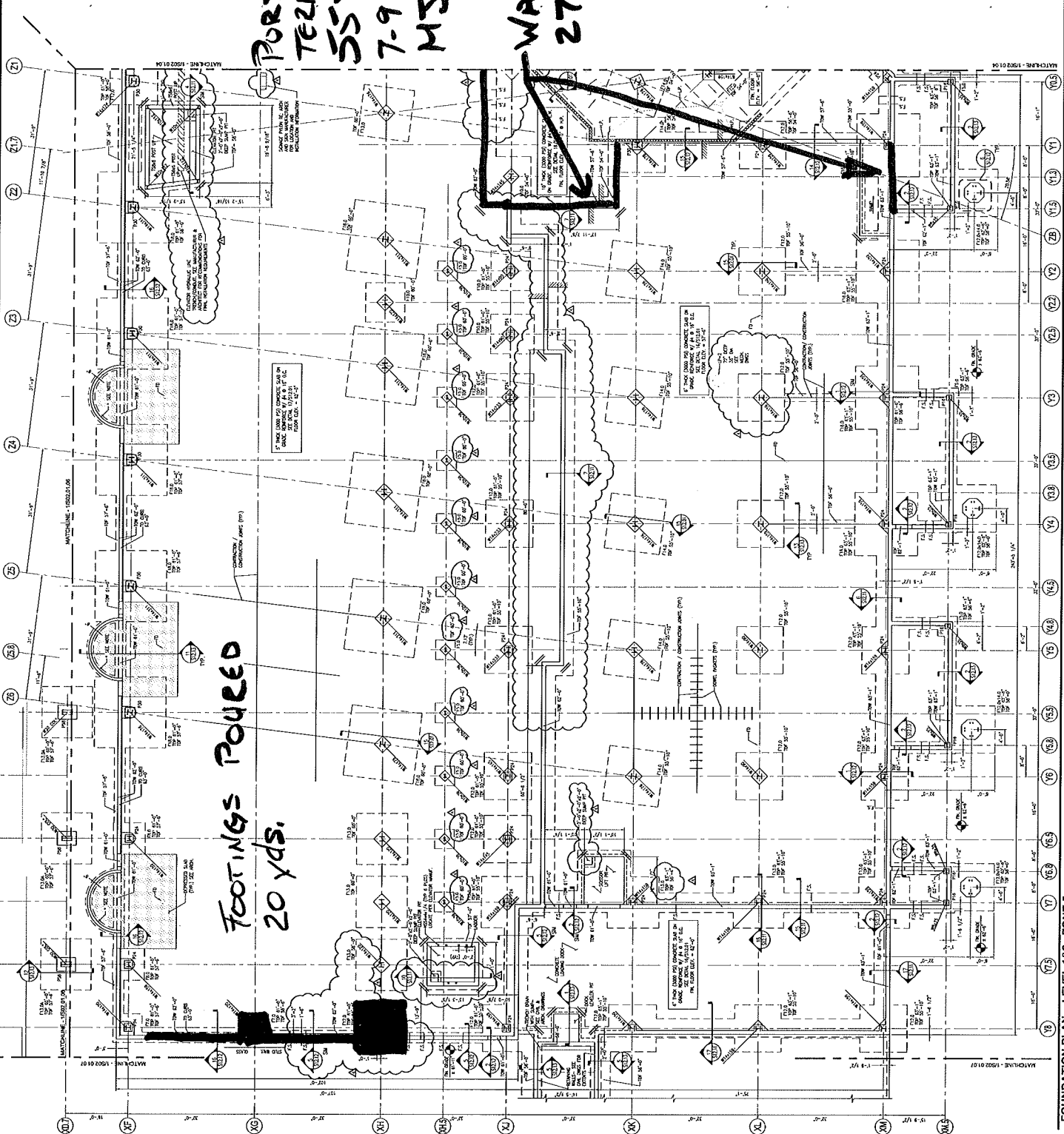

FOOTINGS POURED  
20 yds.

WALLS PLACED  
27 yds.

PORTLAND INT'L AIRPORT  
TERMINAL EXPANSION  
SS7-14  
7-9-2010  
MSK

Portland International  
Jetport  
1001 Westbrook Street  
Portland, Maine 04102

**Genler**

**DESI ASSOCIATES, INC.**  
GENERAL CONTRACTORS / AIRPORT CONSTRUCTION SPECIALISTS

2024 S. DEWEE, NW  
SUITE 100  
PORTLAND, ME 04106  
PHONE 207 233 2227  
FAX 207 233 2228

- SHEET NOTES**
1. ALL DIMENSIONS UNLESS OTHERWISE NOTED ARE IN FEET AND INCHES.
  2. ALL DIMENSIONS TO FACE UNLESS OTHERWISE NOTED.
  3. ALL DIMENSIONS TO CENTERLINE UNLESS OTHERWISE NOTED.
  4. ALL DIMENSIONS TO OUTSIDE EDGE UNLESS OTHERWISE NOTED.
  5. ALL DIMENSIONS TO INSIDE EDGE UNLESS OTHERWISE NOTED.
  6. ALL DIMENSIONS TO CENTERLINE OF WALL UNLESS OTHERWISE NOTED.
  7. ALL DIMENSIONS TO CENTERLINE OF COLUMN UNLESS OTHERWISE NOTED.
  8. ALL DIMENSIONS TO CENTERLINE OF BEAM UNLESS OTHERWISE NOTED.
  9. ALL DIMENSIONS TO CENTERLINE OF SLAB UNLESS OTHERWISE NOTED.
  10. ALL DIMENSIONS TO CENTERLINE OF FOOTING UNLESS OTHERWISE NOTED.
  11. ALL DIMENSIONS TO CENTERLINE OF WALL UNLESS OTHERWISE NOTED.
  12. ALL DIMENSIONS TO CENTERLINE OF COLUMN UNLESS OTHERWISE NOTED.
  13. ALL DIMENSIONS TO CENTERLINE OF BEAM UNLESS OTHERWISE NOTED.
  14. ALL DIMENSIONS TO CENTERLINE OF SLAB UNLESS OTHERWISE NOTED.
  15. ALL DIMENSIONS TO CENTERLINE OF FOOTING UNLESS OTHERWISE NOTED.
  16. ALL DIMENSIONS TO CENTERLINE OF WALL UNLESS OTHERWISE NOTED.
  17. ALL DIMENSIONS TO CENTERLINE OF COLUMN UNLESS OTHERWISE NOTED.
  18. ALL DIMENSIONS TO CENTERLINE OF BEAM UNLESS OTHERWISE NOTED.
  19. ALL DIMENSIONS TO CENTERLINE OF SLAB UNLESS OTHERWISE NOTED.
  20. ALL DIMENSIONS TO CENTERLINE OF FOOTING UNLESS OTHERWISE NOTED.

**GENERAL NOTES**

1. ALL DIMENSIONS UNLESS OTHERWISE NOTED ARE IN FEET AND INCHES.
2. ALL DIMENSIONS TO FACE UNLESS OTHERWISE NOTED.
3. ALL DIMENSIONS TO CENTERLINE UNLESS OTHERWISE NOTED.
4. ALL DIMENSIONS TO OUTSIDE EDGE UNLESS OTHERWISE NOTED.
5. ALL DIMENSIONS TO INSIDE EDGE UNLESS OTHERWISE NOTED.
6. ALL DIMENSIONS TO CENTERLINE OF WALL UNLESS OTHERWISE NOTED.
7. ALL DIMENSIONS TO CENTERLINE OF COLUMN UNLESS OTHERWISE NOTED.
8. ALL DIMENSIONS TO CENTERLINE OF BEAM UNLESS OTHERWISE NOTED.
9. ALL DIMENSIONS TO CENTERLINE OF SLAB UNLESS OTHERWISE NOTED.
10. ALL DIMENSIONS TO CENTERLINE OF FOOTING UNLESS OTHERWISE NOTED.
11. ALL DIMENSIONS TO CENTERLINE OF WALL UNLESS OTHERWISE NOTED.
12. ALL DIMENSIONS TO CENTERLINE OF COLUMN UNLESS OTHERWISE NOTED.
13. ALL DIMENSIONS TO CENTERLINE OF BEAM UNLESS OTHERWISE NOTED.
14. ALL DIMENSIONS TO CENTERLINE OF SLAB UNLESS OTHERWISE NOTED.
15. ALL DIMENSIONS TO CENTERLINE OF FOOTING UNLESS OTHERWISE NOTED.
16. ALL DIMENSIONS TO CENTERLINE OF WALL UNLESS OTHERWISE NOTED.
17. ALL DIMENSIONS TO CENTERLINE OF COLUMN UNLESS OTHERWISE NOTED.
18. ALL DIMENSIONS TO CENTERLINE OF BEAM UNLESS OTHERWISE NOTED.
19. ALL DIMENSIONS TO CENTERLINE OF SLAB UNLESS OTHERWISE NOTED.
20. ALL DIMENSIONS TO CENTERLINE OF FOOTING UNLESS OTHERWISE NOTED.

FOUNDATION PLAN - LEVEL 1&2 - ZONE 5  
SCALE: 1/8" = 1'-0"

KEY PLAN

S02.01.05