



**SITE WORK
DAILY FIELD REPORT**

PROJECT: Terminal Enhancement at the Portland International Jetport
DATE: 06/01/2010
PROJECT LOCATION: Portland, Maine PROJECT NO.: 557-14
CLIENT: City of Portland WEATHER: Sun
CONTRACTOR: Turner Construction Co. 65°F
PREVIOUS DATE ON SITE: 05/28/2010

Time on-site 10.5 hrs, 10 mi travel, Tolls: \$1.00
Nuc. Densometer - 1/2 Day

AREA 'A'

Upper lot: Gorham Sand & Gravel (GSG) stockpiled materials.

AREA 'B'

Gorham Sand & Gravel continued backfilling footings in section 6 along line XC. Footings located at XD.7/Y5.5, Y6.5 and Y7.5 were framed. Using the Cat 325B, the footing at XD.7/Y8.5 was excavated. Volvo ECE330B excavating existing material under parking lot.

Concrete arrived at 12:50. Footings at XD.7/Y5.5, 6.5 and 7.5 placed.

AREA 'C'

Cat 320C excavating footings at C4/1Y.8 and 1ZA.

MJK

Michael Kramlich

Prepared By

Matthew P. Grady

Matthew Grady

Reviewed By

PORTLAND INT'L JETPORT
 TERMINAL EXPANSION
 JOB # 557-14
 6/1/2010
 MSE

PIER TYPE	PIER DIMENSIONS	PIER SCHEDULE	TIES
PIA	18'-0" x 18'-0"	PIA 18'-0" x 18'-0"	PIA 18'-0" x 18'-0"
PIC	36'-0" x 36'-0"	PIC 36'-0" x 36'-0"	PIC 36'-0" x 36'-0"
PIE	36'-0" x 36'-0"	PIE 36'-0" x 36'-0"	PIE 36'-0" x 36'-0"
PIF	36'-0" x 36'-0"	PIF 36'-0" x 36'-0"	PIF 36'-0" x 36'-0"
PIG	36'-0" x 36'-0"	PIG 36'-0" x 36'-0"	PIG 36'-0" x 36'-0"
PIH	36'-0" x 36'-0"	PIH 36'-0" x 36'-0"	PIH 36'-0" x 36'-0"
PII	36'-0" x 36'-0"	PII 36'-0" x 36'-0"	PII 36'-0" x 36'-0"
PIJ	36'-0" x 36'-0"	PIJ 36'-0" x 36'-0"	PIJ 36'-0" x 36'-0"
PIK	36'-0" x 36'-0"	PIK 36'-0" x 36'-0"	PIK 36'-0" x 36'-0"
PLA	36'-0" x 36'-0"	PLA 36'-0" x 36'-0"	PLA 36'-0" x 36'-0"
PLB	36'-0" x 36'-0"	PLB 36'-0" x 36'-0"	PLB 36'-0" x 36'-0"
PLC	36'-0" x 36'-0"	PLC 36'-0" x 36'-0"	PLC 36'-0" x 36'-0"
PLD	36'-0" x 36'-0"	PLD 36'-0" x 36'-0"	PLD 36'-0" x 36'-0"
PLE	36'-0" x 36'-0"	PLE 36'-0" x 36'-0"	PLE 36'-0" x 36'-0"
PLF	36'-0" x 36'-0"	PLF 36'-0" x 36'-0"	PLF 36'-0" x 36'-0"
PLG	36'-0" x 36'-0"	PLG 36'-0" x 36'-0"	PLG 36'-0" x 36'-0"
PLH	36'-0" x 36'-0"	PLH 36'-0" x 36'-0"	PLH 36'-0" x 36'-0"
PLI	36'-0" x 36'-0"	PLI 36'-0" x 36'-0"	PLI 36'-0" x 36'-0"
PLJ	36'-0" x 36'-0"	PLJ 36'-0" x 36'-0"	PLJ 36'-0" x 36'-0"
PLK	36'-0" x 36'-0"	PLK 36'-0" x 36'-0"	PLK 36'-0" x 36'-0"
PLL	36'-0" x 36'-0"	PLL 36'-0" x 36'-0"	PLL 36'-0" x 36'-0"
PLM	36'-0" x 36'-0"	PLM 36'-0" x 36'-0"	PLM 36'-0" x 36'-0"
PLN	36'-0" x 36'-0"	PLN 36'-0" x 36'-0"	PLN 36'-0" x 36'-0"
PLO	36'-0" x 36'-0"	PLO 36'-0" x 36'-0"	PLO 36'-0" x 36'-0"
PLP	36'-0" x 36'-0"	PLP 36'-0" x 36'-0"	PLP 36'-0" x 36'-0"
PLQ	36'-0" x 36'-0"	PLQ 36'-0" x 36'-0"	PLQ 36'-0" x 36'-0"
PLR	36'-0" x 36'-0"	PLR 36'-0" x 36'-0"	PLR 36'-0" x 36'-0"
PLS	36'-0" x 36'-0"	PLS 36'-0" x 36'-0"	PLS 36'-0" x 36'-0"
PLT	36'-0" x 36'-0"	PLT 36'-0" x 36'-0"	PLT 36'-0" x 36'-0"
PLU	36'-0" x 36'-0"	PLU 36'-0" x 36'-0"	PLU 36'-0" x 36'-0"
PLV	36'-0" x 36'-0"	PLV 36'-0" x 36'-0"	PLV 36'-0" x 36'-0"
PLW	36'-0" x 36'-0"	PLW 36'-0" x 36'-0"	PLW 36'-0" x 36'-0"
PLX	36'-0" x 36'-0"	PLX 36'-0" x 36'-0"	PLX 36'-0" x 36'-0"
PLY	36'-0" x 36'-0"	PLY 36'-0" x 36'-0"	PLY 36'-0" x 36'-0"
PLZ	36'-0" x 36'-0"	PLZ 36'-0" x 36'-0"	PLZ 36'-0" x 36'-0"

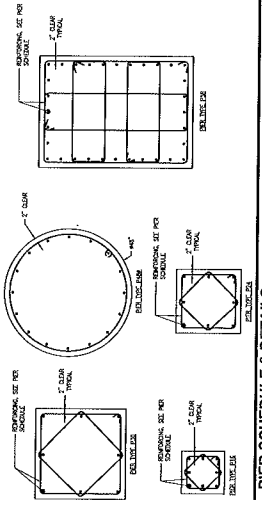

FOOTING TYPE	FOOTING DIMENSIONS (LxW)	REINFORCING
F1A	36'-0" x 36'-0"	#4 @ 12" O.C.
F1B	36'-0" x 36'-0"	#4 @ 12" O.C.
F1C	36'-0" x 36'-0"	#4 @ 12" O.C.
F1D	36'-0" x 36'-0"	#4 @ 12" O.C.
F1E	36'-0" x 36'-0"	#4 @ 12" O.C.
F1F	36'-0" x 36'-0"	#4 @ 12" O.C.
F1G	36'-0" x 36'-0"	#4 @ 12" O.C.
F1H	36'-0" x 36'-0"	#4 @ 12" O.C.
F1I	36'-0" x 36'-0"	#4 @ 12" O.C.
F1J	36'-0" x 36'-0"	#4 @ 12" O.C.
F1K	36'-0" x 36'-0"	#4 @ 12" O.C.
F1L	36'-0" x 36'-0"	#4 @ 12" O.C.
F1M	36'-0" x 36'-0"	#4 @ 12" O.C.
F1N	36'-0" x 36'-0"	#4 @ 12" O.C.
F1O	36'-0" x 36'-0"	#4 @ 12" O.C.
F1P	36'-0" x 36'-0"	#4 @ 12" O.C.
F1Q	36'-0" x 36'-0"	#4 @ 12" O.C.
F1R	36'-0" x 36'-0"	#4 @ 12" O.C.
F1S	36'-0" x 36'-0"	#4 @ 12" O.C.
F1T	36'-0" x 36'-0"	#4 @ 12" O.C.
F1U	36'-0" x 36'-0"	#4 @ 12" O.C.
F1V	36'-0" x 36'-0"	#4 @ 12" O.C.
F1W	36'-0" x 36'-0"	#4 @ 12" O.C.
F1X	36'-0" x 36'-0"	#4 @ 12" O.C.
F1Y	36'-0" x 36'-0"	#4 @ 12" O.C.
F1Z	36'-0" x 36'-0"	#4 @ 12" O.C.

FOOTING SCHEDULE & DETAILS
 SCALE: 3/4" = 1'-0"

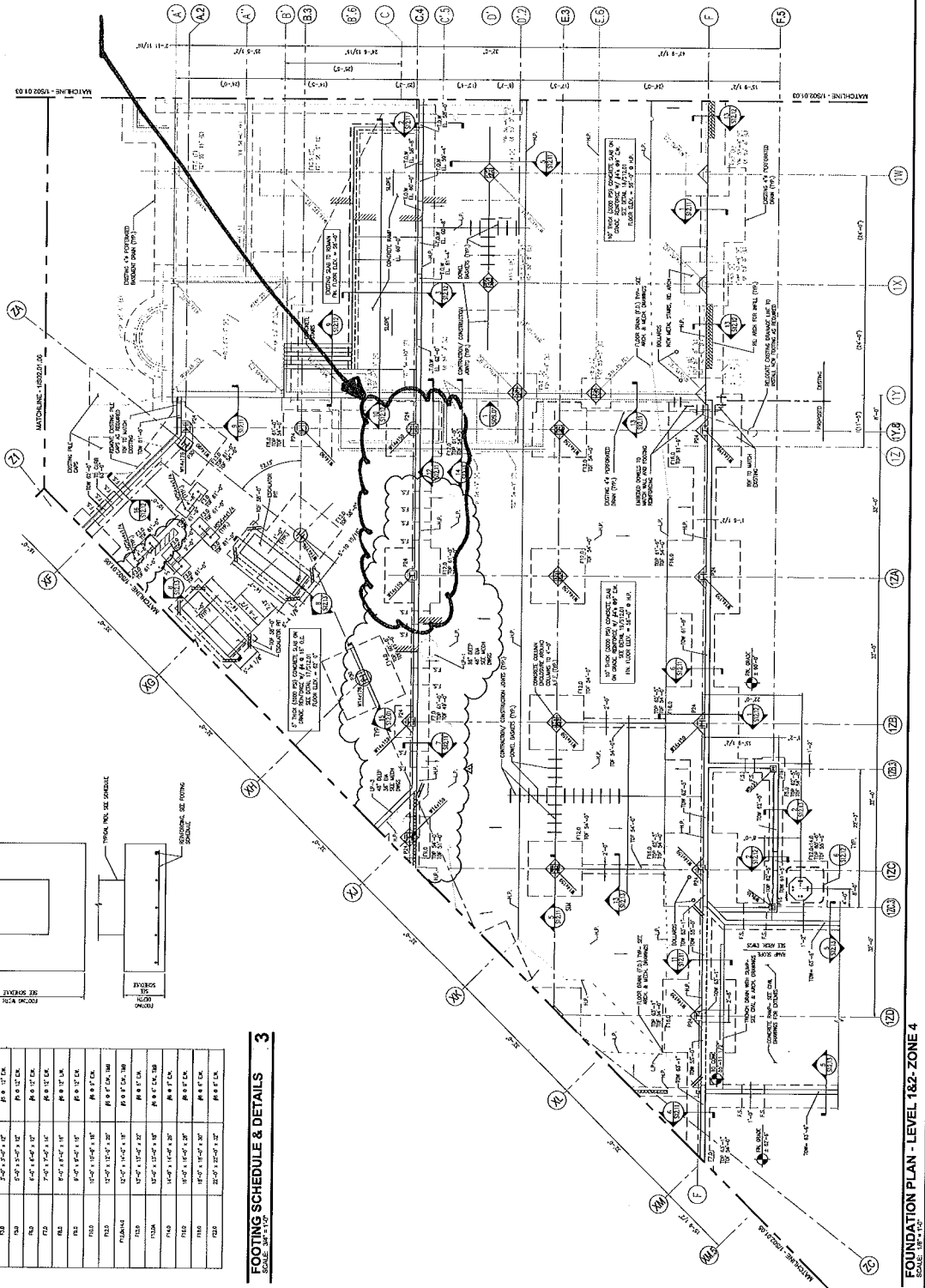

AREA EXCAVATED

SHEET NOTES

1. REVISIONS TO THIS SHEET SHALL BE MADE BY THE ARCHITECT. THE ARCHITECT'S APPROVAL IS REQUIRED FOR ALL REVISIONS.
2. THE CONTRACTOR SHALL BE RESPONSIBLE FOR OBTAINING ALL NECESSARY PERMITS AND APPROVALS FROM THE LOCAL, STATE, AND FEDERAL AGENCIES.
3. THE CONTRACTOR SHALL BE RESPONSIBLE FOR OBTAINING ALL NECESSARY PERMITS AND APPROVALS FROM THE LOCAL, STATE, AND FEDERAL AGENCIES.
4. THE CONTRACTOR SHALL BE RESPONSIBLE FOR OBTAINING ALL NECESSARY PERMITS AND APPROVALS FROM THE LOCAL, STATE, AND FEDERAL AGENCIES.
5. THE CONTRACTOR SHALL BE RESPONSIBLE FOR OBTAINING ALL NECESSARY PERMITS AND APPROVALS FROM THE LOCAL, STATE, AND FEDERAL AGENCIES.
6. THE CONTRACTOR SHALL BE RESPONSIBLE FOR OBTAINING ALL NECESSARY PERMITS AND APPROVALS FROM THE LOCAL, STATE, AND FEDERAL AGENCIES.
7. THE CONTRACTOR SHALL BE RESPONSIBLE FOR OBTAINING ALL NECESSARY PERMITS AND APPROVALS FROM THE LOCAL, STATE, AND FEDERAL AGENCIES.
8. THE CONTRACTOR SHALL BE RESPONSIBLE FOR OBTAINING ALL NECESSARY PERMITS AND APPROVALS FROM THE LOCAL, STATE, AND FEDERAL AGENCIES.
9. THE CONTRACTOR SHALL BE RESPONSIBLE FOR OBTAINING ALL NECESSARY PERMITS AND APPROVALS FROM THE LOCAL, STATE, AND FEDERAL AGENCIES.
10. THE CONTRACTOR SHALL BE RESPONSIBLE FOR OBTAINING ALL NECESSARY PERMITS AND APPROVALS FROM THE LOCAL, STATE, AND FEDERAL AGENCIES.

Gensler
 2024 Street, NW
 Portland, OR 97209
 Phone: 503.227.2277

WEST ASSOCIATES, INC.
 1001 Westbank Street
 Portland, OR 97209
 Phone: 503.227.2277

Portland International Jetport
 1001 Westbank Street
 Portland, Maine 04102

GENERAL NOTES

1. ALL WORK SHALL BE DONE IN ACCORDANCE WITH THE LATEST EDITIONS OF THE STANDARD SPECIFICATIONS FOR HIGHWAY CONSTRUCTION, SEVENTH EDITION, AND THE PORTLAND INTERNATIONAL AIRPORT CONSTRUCTION MANUAL.
2. THE CONTRACTOR SHALL BE RESPONSIBLE FOR OBTAINING ALL NECESSARY PERMITS AND APPROVALS FROM THE LOCAL, STATE, AND FEDERAL AGENCIES.
3. THE CONTRACTOR SHALL BE RESPONSIBLE FOR OBTAINING ALL NECESSARY PERMITS AND APPROVALS FROM THE LOCAL, STATE, AND FEDERAL AGENCIES.
4. THE CONTRACTOR SHALL BE RESPONSIBLE FOR OBTAINING ALL NECESSARY PERMITS AND APPROVALS FROM THE LOCAL, STATE, AND FEDERAL AGENCIES.
5. THE CONTRACTOR SHALL BE RESPONSIBLE FOR OBTAINING ALL NECESSARY PERMITS AND APPROVALS FROM THE LOCAL, STATE, AND FEDERAL AGENCIES.
6. THE CONTRACTOR SHALL BE RESPONSIBLE FOR OBTAINING ALL NECESSARY PERMITS AND APPROVALS FROM THE LOCAL, STATE, AND FEDERAL AGENCIES.
7. THE CONTRACTOR SHALL BE RESPONSIBLE FOR OBTAINING ALL NECESSARY PERMITS AND APPROVALS FROM THE LOCAL, STATE, AND FEDERAL AGENCIES.
8. THE CONTRACTOR SHALL BE RESPONSIBLE FOR OBTAINING ALL NECESSARY PERMITS AND APPROVALS FROM THE LOCAL, STATE, AND FEDERAL AGENCIES.
9. THE CONTRACTOR SHALL BE RESPONSIBLE FOR OBTAINING ALL NECESSARY PERMITS AND APPROVALS FROM THE LOCAL, STATE, AND FEDERAL AGENCIES.
10. THE CONTRACTOR SHALL BE RESPONSIBLE FOR OBTAINING ALL NECESSARY PERMITS AND APPROVALS FROM THE LOCAL, STATE, AND FEDERAL AGENCIES.

KEY PLAN

1/8" = 1'-0"

S02.01.04



FOUNDATION PLAN - LEVEL 1&2 - ZONE 4
 SCALE: 1/8" = 1'-0"



**SITE WORK
DAILY FIELD REPORT**

PROJECT: Terminal Enhancement at the Portland International Jetport
DATE: 06/02/2010
PROJECT LOCATION: Portland, Maine PROJECT NO.: 557-14
CLIENT: City of Portland WEATHER: Sun
CONTRACTOR: Turner Construction Co. 65°F
PREVIOUS DATE ON SITE: 06/01/2010

Time on-site 9.5 hrs, 10 mi travel, Tolls: \$2.00
Nuc. Densometer - 1 Day

AREA 'A'

No work observed.

AREA 'B'

Gorham Sand & Gravel backfilled footings in section 6 at XD.7/Y5.5, Y6.5 and Y7.5. IPDs taken on each lift. Using the Cat 325B, CB OA-31 and CB OA-32 were excavated and installed, including the drain line between the 2. Volvo ECE330B excavating existing material under parking lot.

Concrete arrived at 1:40. Piers at XC/Z1 and Z2, and XD/Z2 and Z3 placed.

AREA 'C'

Cat 320C excavating fill material.

Rodney was present on site performing the concrete testing and most IPDs under my supervision.



Michael Kramlich

Prepared By

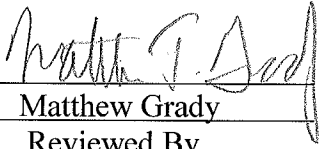

Matthew Grady

Reviewed By

Portland International
Jetport
1001 Westbrook Street
Portland, Maine 04102

Genster
WEST ASSOCIATES, INC.
engineers - architects - planners - construction managers

1	GENERAL NOTES	DATE	BY
2	CONSTRUCTION DOCUMENTS	DATE	BY
3	CONSTRUCTION DOCUMENTS	DATE	BY
4	CONSTRUCTION DOCUMENTS	DATE	BY
5	CONSTRUCTION DOCUMENTS	DATE	BY

PROJECT: PORTLAND INTERNATIONAL JETPORT
 DRAWING NO.: C02-02
 DATE: 02-2-10
 SCALE: AS SHOWN
 SHEET NO. 2 OF 2

**PORTLAND INTERNATIONAL JETPORT
TERMINAL EXPANSION PROJECT
PROJECT NO. 557-14
DATE: 02-2-10
TECHNOLOGIST: MSK**

CB OA-31 +
CB OA-32
EXCAVATED +
INSTALLED

NO.	DESCRIPTION	DATE	BY
1	REVISION		
2	REVISION		
3	REVISION		
4	REVISION		
5	REVISION		
6	REVISION		
7	REVISION		
8	REVISION		
9	REVISION		
10	REVISION		
11	REVISION		
12	REVISION		
13	REVISION		
14	REVISION		
15	REVISION		
16	REVISION		
17	REVISION		
18	REVISION		
19	REVISION		
20	REVISION		
21	REVISION		
22	REVISION		
23	REVISION		
24	REVISION		
25	REVISION		
26	REVISION		
27	REVISION		
28	REVISION		
29	REVISION		
30	REVISION		
31	REVISION		
32	REVISION		
33	REVISION		
34	REVISION		
35	REVISION		
36	REVISION		
37	REVISION		
38	REVISION		
39	REVISION		
40	REVISION		
41	REVISION		
42	REVISION		
43	REVISION		
44	REVISION		
45	REVISION		
46	REVISION		
47	REVISION		
48	REVISION		
49	REVISION		
50	REVISION		

GENERAL NOTES:

- ALL WORK SHALL BE IN ACCORDANCE WITH THE LATEST EDITIONS OF THE INTERNATIONAL BUILDING CODES AND ALL APPLICABLE LOCAL ORDINANCES.
- THE CONTRACTOR SHALL BE RESPONSIBLE FOR OBTAINING ALL NECESSARY PERMITS AND APPROVALS FROM THE APPROPRIATE AGENCIES.
- ALL MATERIALS AND METHODS OF CONSTRUCTION SHALL BE APPROVED BY THE ARCHITECT BEFORE INSTALLATION.
- THE CONTRACTOR SHALL MAINTAIN ACCESS TO ALL ADJACENT PROPERTIES AND UTILITIES AT ALL TIMES.
- ALL UTILITIES SHALL BE PROTECTED AND DEEPER THAN THE PROPOSED FOUNDATION.
- ALL EXCAVATIONS SHALL BE PROTECTED AND SHORED TO PREVENT COLLAPSE.
- ALL WORK SHALL BE COMPLETED WITHIN THE SPECIFIED TIME FRAME.
- ALL MATERIALS SHALL BE STORED PROPERLY TO PREVENT DAMAGE.
- ALL WORK SHALL BE COMPLETED IN ACCORDANCE WITH THE SPECIFICATIONS AND DRAWINGS.
- ALL WORK SHALL BE COMPLETED WITHIN THE SPECIFIED TIME FRAME.
- ALL MATERIALS SHALL BE STORED PROPERLY TO PREVENT DAMAGE.
- ALL WORK SHALL BE COMPLETED IN ACCORDANCE WITH THE SPECIFICATIONS AND DRAWINGS.
- ALL WORK SHALL BE COMPLETED WITHIN THE SPECIFIED TIME FRAME.
- ALL MATERIALS SHALL BE STORED PROPERLY TO PREVENT DAMAGE.
- ALL WORK SHALL BE COMPLETED IN ACCORDANCE WITH THE SPECIFICATIONS AND DRAWINGS.
- ALL WORK SHALL BE COMPLETED WITHIN THE SPECIFIED TIME FRAME.

