

Portland International
Jetport
1001 Westbrook Street
Portland, Maine 04102

Gensler
2020 K Street, Northwest
Suite 200 DC 20006
Washington DC 20004
Tel: 202.872.8587
Fax: 202.872.8587

3300 N. Fairfax Drive
Suite 302
Arlington, Virginia 22201
Tel: 703.245.5000
Fax: 703.245.5004
www.smw.com

SM&W
SHEN MILSON WILKE

Issue	Date & Issue Description	By	Checked
1	12/20/05 ISSUE CONSTRUCTION DOCUMENTS		
2	1/23/06 PROGRESS ISSUE		
3	01/23/06 95% CONSTRUCTION DOCUMENTS		
4	10/20/06 PROGRESS ISSUE		
5	10/20/06 ISSUED FOR PERMIT		

Project Name: PIMA TERMINAL EXPANSION
 Project Number: AV02.02.05
 CAD File Name: AV02.02.05
 Description: AUDITORIUM FACILITY PLAN - LEVEL 2 - ZONE 5
 Scale: As Indicated

AV02.02.05
 ©2006 Gensler

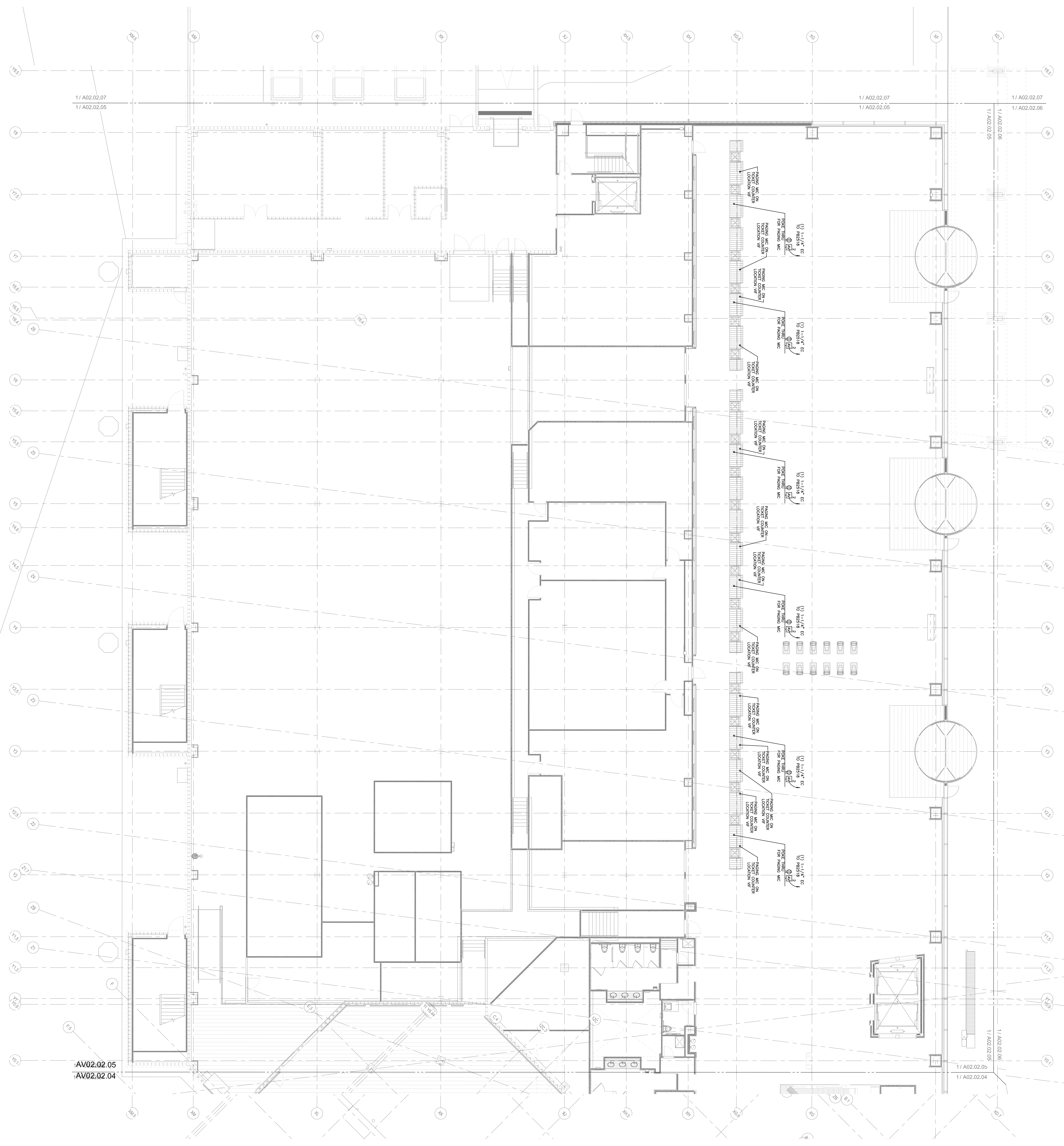

KEY PLAN

