

# Portland International Jetport

1001 Westbrook Street  
Portland, Maine 04102

**Gensler**

2020 K Street, Northwest  
Suite 200  
Washington DC 20006  
Telephone 202.721.5200  
Facsimile 202.872.8587

**ARORA**  
Solutions for Secure  
Environments

Arora Engineers, Inc.  
61 Wilmington - West Chester  
File  
Suite # 100  
Chadds Ford, PA 19317  
T: (610) 459-7900  
F: (610) 459-7950

## SHEET NOTES

- 01 NEW MODULE SHALL BE INSTALLED CLOSE TO DOOR INTERFACE PANEL (DIP). INITIATION OF THE FIRE ALARM SYSTEM WILL RELEASE THE DOOR IN ACCORDANCE WITH THE DOOR INTERFACE MATRIX SHOWN ON FA12.02. CONTRACTOR SHALL COORDINATE WITH OTHER TRADES TO DETERMINE FINAL QUANTITIES AND LOCATIONS OF MODULES AND PROVIDE THE NECESSARY 24VDC CIRCUITING AND SLC CIRCUITING TO THE MODULE. REFER TO SS2.01.05 AND FA12.01.
- 02 COORDINATE LOCATION OF THESE DEVICES WITH ADJACENT PLUMBING PIPING.
- 03 THE WORK IN THIS AREA INVOLVES THE MODIFICATION TO THE EXISTING HORN STROBES AND CIRCUITS IN THIS AREA. IN THE EVENT THAT THE NAC CIRCUIT IS ROUTED FROM THE BAGGAGE MAKEUP AREA, WHICH IS BEING MODIFIED, THEN THE CONDUIT AND CABLING SHALL BE RE-ROUTED SUCH THAT THE CIRCUIT DOES NOT PASS THROUGH THE BAGGAGE MAKE-UP AREA. THE CONTRACTOR SHALL IDENTIFY A PROPER CIRCUIT TIE-IN POINT IN THE TERMINAL AND EXTEND NEW CONDUIT AND CABLING TO THE LOCATION AND PERFORM ANY/ALL DEMOLITION REQUIRED IN THE BAGGAGE MAKE-UP AREA.
- 04 INSTALL CONTROL MODULE AND MONITOR MODULE AT THE MCP AS SHOWN IN THE PLAN. COORDINATE LOCATION OF DEVICES WITH OTHER TRADES PRIOR TO INSTALLATION.

## GENERAL NOTES

- A MOUNTING FOR ALL DEVICES SHALL COMPLY WITH IBC 2003, NFPA 90A, NFPA 72, NEC, ADASG AND ALL APPLICABLE LOCAL CODES.
- B VISUAL NOTIFICATION APPLIANCES SHALL BE SET TO THE CANDELA RATING ASSIGNED ON THE DRAWINGS. SPEAKERS SHALL BE TAPPED AT THE WATTAGE SELECTED BY THE SYSTEM MANUFACTURER ON THE APPROVED SHOP DRAWINGS.
- C IN THE EVENT THAT A DEVICE IS LOCATED ON A SURFACE THAT IS UNSUITABLE FOR PROPER MOUNTING, THEN THE CONTRACTOR SHALL NOTIFY THE ENGINEER DURING THE SHOP DRAWINGS PHASE. THE NOTIFICATION TO THE ENGINEER SHALL OCCUR PRIOR TO CONDUIT AND JUNCTION BOX ROUGH-IN.
- D MORE THAN TWO VISIBLE NOTIFICATION APPLIANCES OR GROUPS OF VISIBLE NOTIFICATION APPLIANCES IN THE SAME ROOM OR ADJACENT SPACE WITHIN THE SAME FIELD OF VIEW SHALL FLASH IN SYNCHRONIZATION. THIS SHALL INCLUDE SYNCHRONIZATION OF STROBES OPERATED BY SEPARATE SYSTEMS.
- E ALL NOTIFICATION DEVICES SHOWN ON THIS PLAN SHALL BE EQUIPPED WITH PROTECTIVE WIRE GUARD.

## KEY PLAN

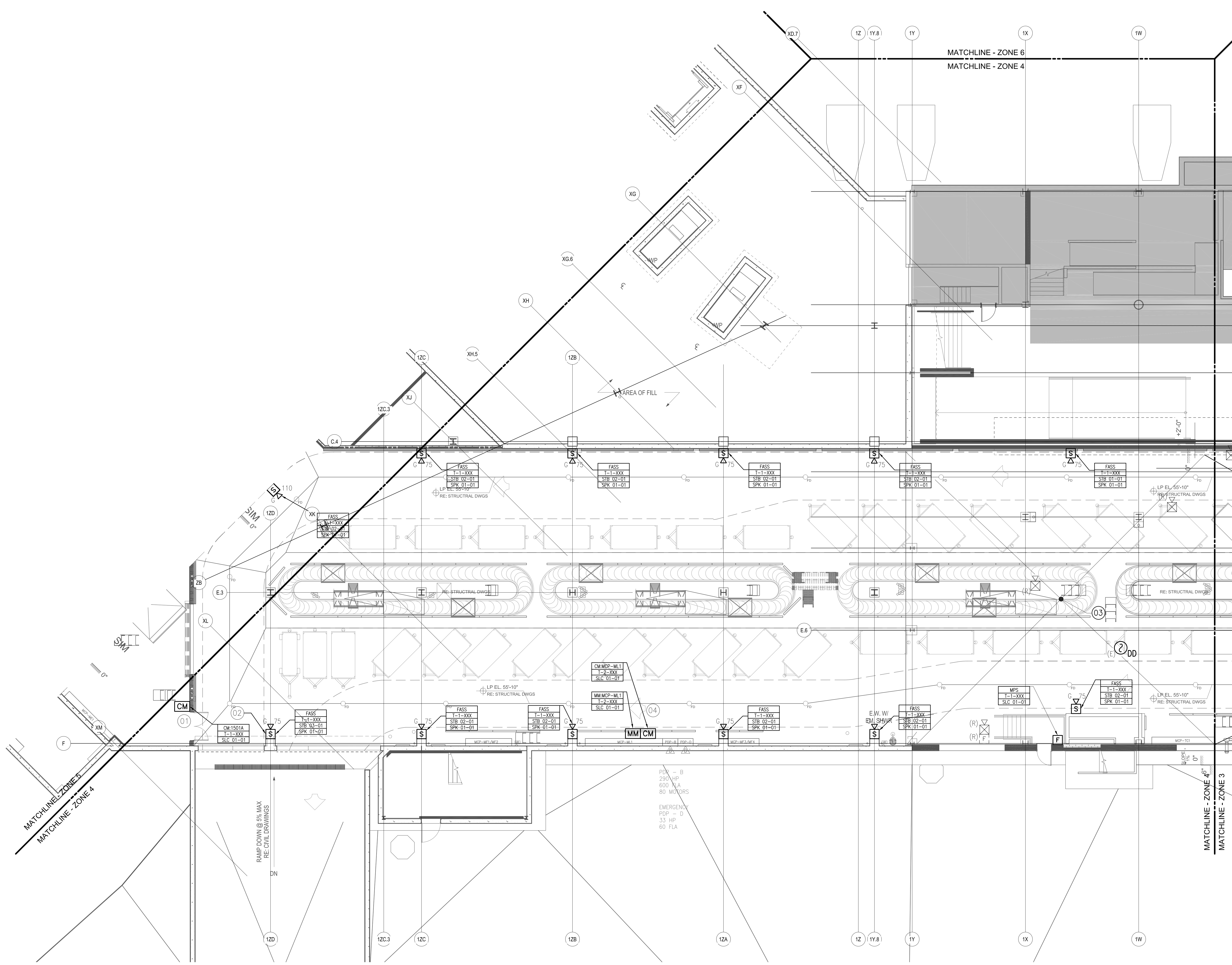
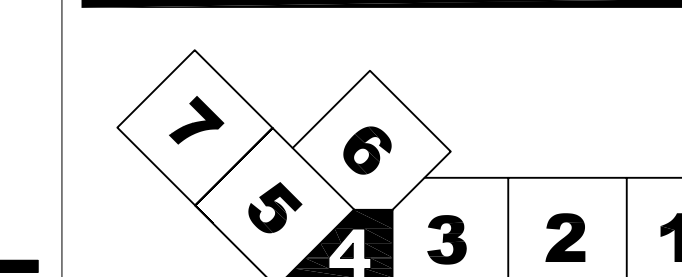

LEVEL 1 - ZONE 4

SCALE: 1/8"=1'-0"

Issue	Date & Issue Description	By	Check
	10/26/09		
	100% ISSUED FOR PERMIT		

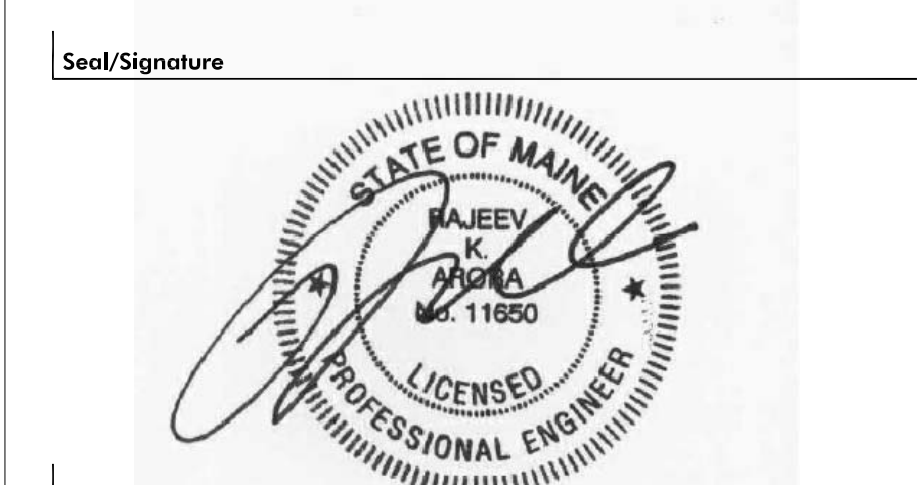

Project Name  
PJM TERMINAL EXPANSION

Project Number

CAD File Name  
FA02.01.04

Description  
FIRE ALARM  
CONSTRUCTION PLAN - LEVEL 1 - ZONE 4

Scale  
As Indicated

Ref. North

**FA02.01.04**

© 2006 Gensler