

EGRESS PLAN - LEVEL 4
SCALE: 1/16" = 1'-0"

A01.DS4

SHEET NOTES

- 01 1-HOUR SHAFT CONNECTING LESS THAN 4 STORIES
- 02 ATRIUM ENCLOSURE PER IBC 404.5 EXCEPTION 1
- 03 1-HOUR ATRIUM ENCLOSURE PER IBC 404.5
- 04 FLOOR OPENINGS: (A) ATRIUM PER IBC 404; (B) COMMUNICATION SPACE (MINI ATRIUM) PER NFPA 101 8.6.6
- 05 MECHANICAL MEZZANINE: IBC 505.3 EXCEPTION 1 ALLOWS SINGLE MEANS OF EGRESS. SIZE OF ROOM CREATES COMMON PATH OF TRAVEL OVER 75', SO TWO EXITS ARE PROVIDED
- 06 AUTOMATIC SLIDING ENTRANCES WITH BREAK-OUT PANELS

Portland International Jetport
1001 Westbrook Street
Portland, Maine 04102

Gensler
2020 K Street, Northwest
Suite 200
Washington DC 20006
Telephone 202.721.5200
Facsimile 202.872.8587

Date	Description
09/22/08	DESIGN DEVELOPMENT
12/03/08	75% CONSTRUCTION DOCUMENTS
01/23/09	95% CONSTRUCTION DOCUMENTS
10/26/09	ISSUED FOR PERMIT
2 11/12/09	ADDENDUM #2

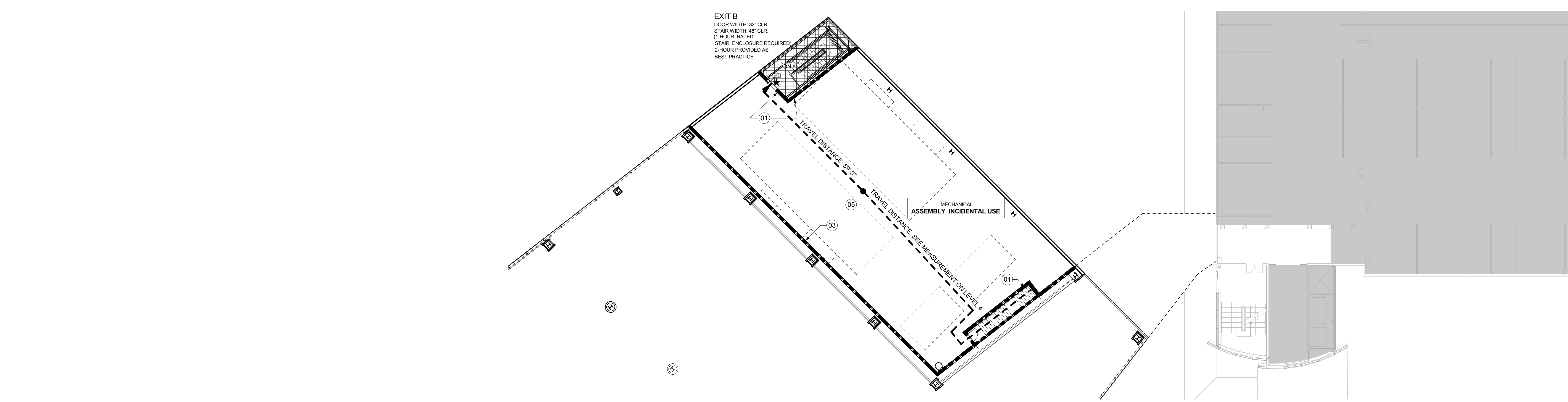

EGRESS PLAN - LEVEL 5
SCALE: 1/16" = 1'-0"

A09.00

GENERAL NOTES

- A IBC 302.3.1: NON SEPARATED USE: FIRE SEPARATIONS ARE NOT REQUIRED BETWEEN USES, EXCEPT AS REQUIRED BY OTHER PROVISIONS.
- B REFER TO A00.10 FOR OCCUPANT LOAD AND EGRESS REQUIREMENTS FOR DETAILED EGRESS CRITERIA
- C NOT IN CONTRACT (NIC)
- D 3-HOUR SPRAY-ON FIRE PROOFING ON UNDERSIDE OF SLAB ABOVE
- E EXIT STAIR LOCATION
- F 3-HR FIRE SEPARATION RATING
- G EXIT DISCHARGE
- H SEC, FHC, DIF (DEFBRILLATOR) AND/OR SPC (STANDPIPE CONNECTION)

Seal/Signature

Project Name
PWM Terminal Enhancement

Project Number
09.6395.000

Description
EGRESS PLAN - LEVEL 4

Scale
As indicated

A00.18