

**1 VOICE/DATA/SECURITY CABINET ELEVATIONS**  
SS12.31 NTS

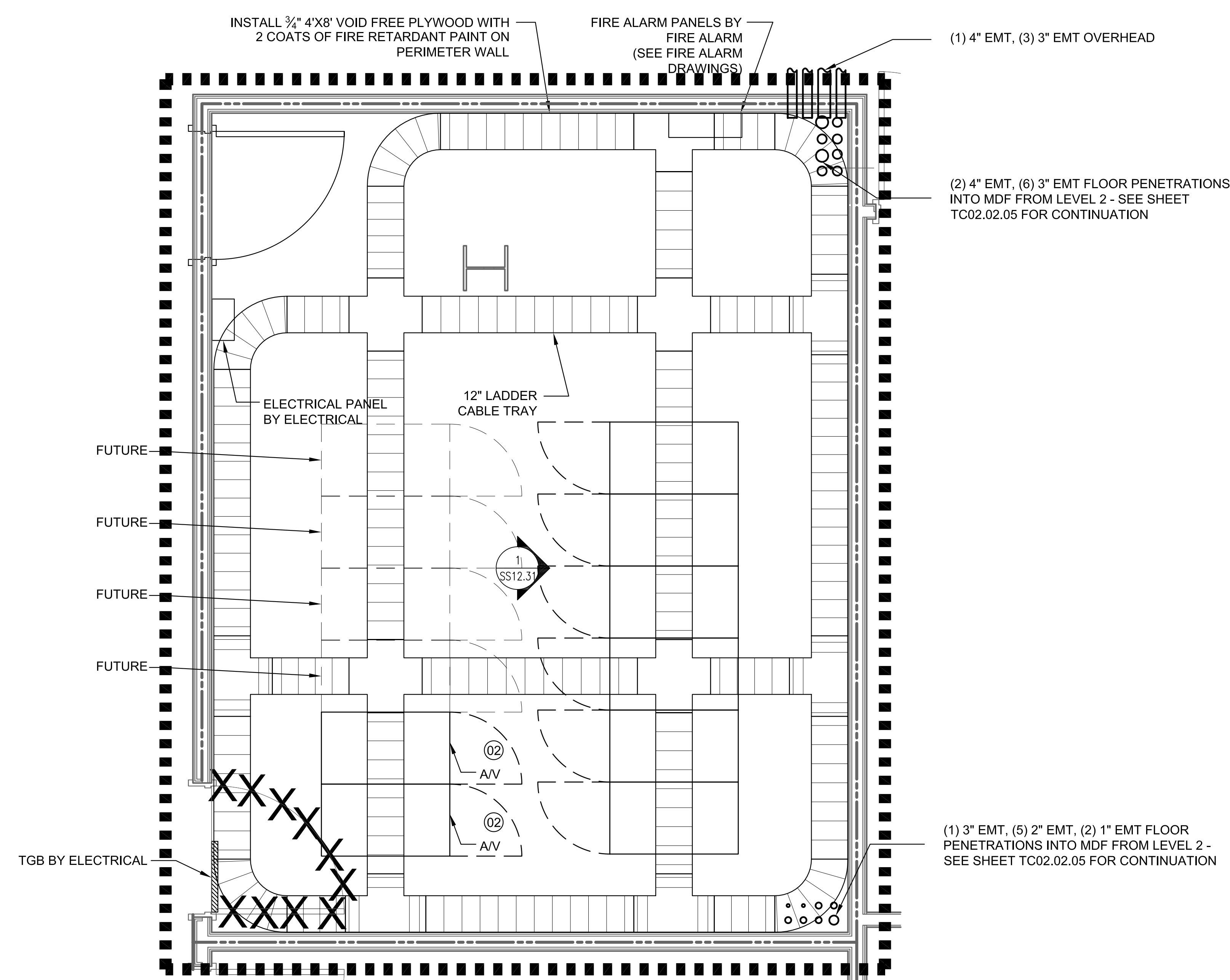

**2 TELECOMMUNICATIONS ROOM MDF**  
SS12.31 SCALE: NTS

**GENERAL NOTES**

- 01 POWER TO ALL EQUIPMENT IN TELECOMMUNICATION ROOMS PROVIDED BY ELECTRICAL PANEL IN ROOM. REFER TO ELECTRICAL DRAWINGS FOR DETAILS.
- 02 REFER TO ELECTRICAL DRAWINGS FOR ALL GROUND BUS BAR INFORMATION.

Issue	Date & Issue Description	By	Check
	10/26/09		
	100% ISSUED FOR PERMIT		

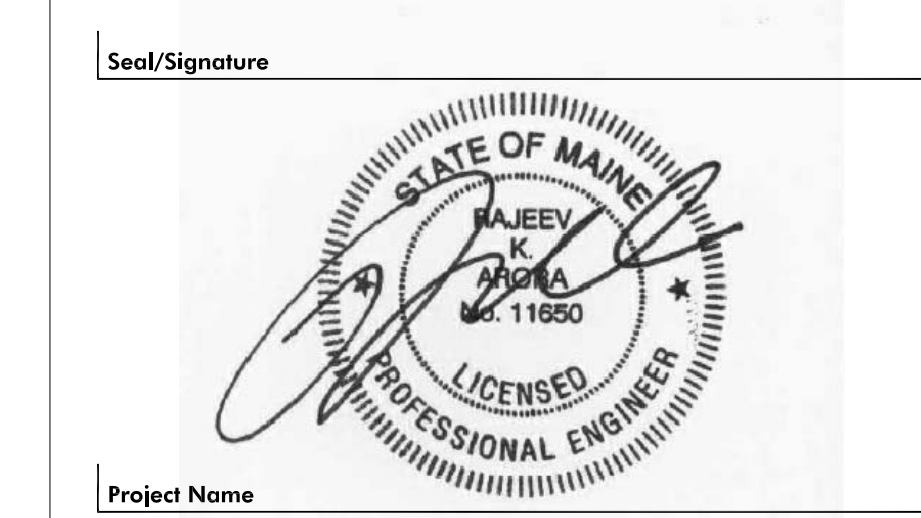

Project Name  
**PWM TERMINAL EXPANSION**

Project Number

CAD File Name  
**SS12.31**

Description  
**SECURITY & SURVEILLANCE  
NEW TELECOM ROOM DETAILS - SHEET 2**

Scale  
**As Indicated**