

SHEET NOTES

01 RUN HW & HW CONCEALED IN FINNED RADIATION ENCLOSURE.

Portland International Jetport

1001 Westbrook Street
Portland, Maine 04102

Gensler

2020 K Street, NW
Suite 200
Washington, DC 20006
Telephone 202.721.5200
Facsimile 202.872.8587

oest ASSOCIATES, INC.
363 Goshen Road, South Portland, ME 04106 P: (207) 741-1770 F: (207) 774-2461 www.oest.com
engineers • architects • surveyors • construction managers

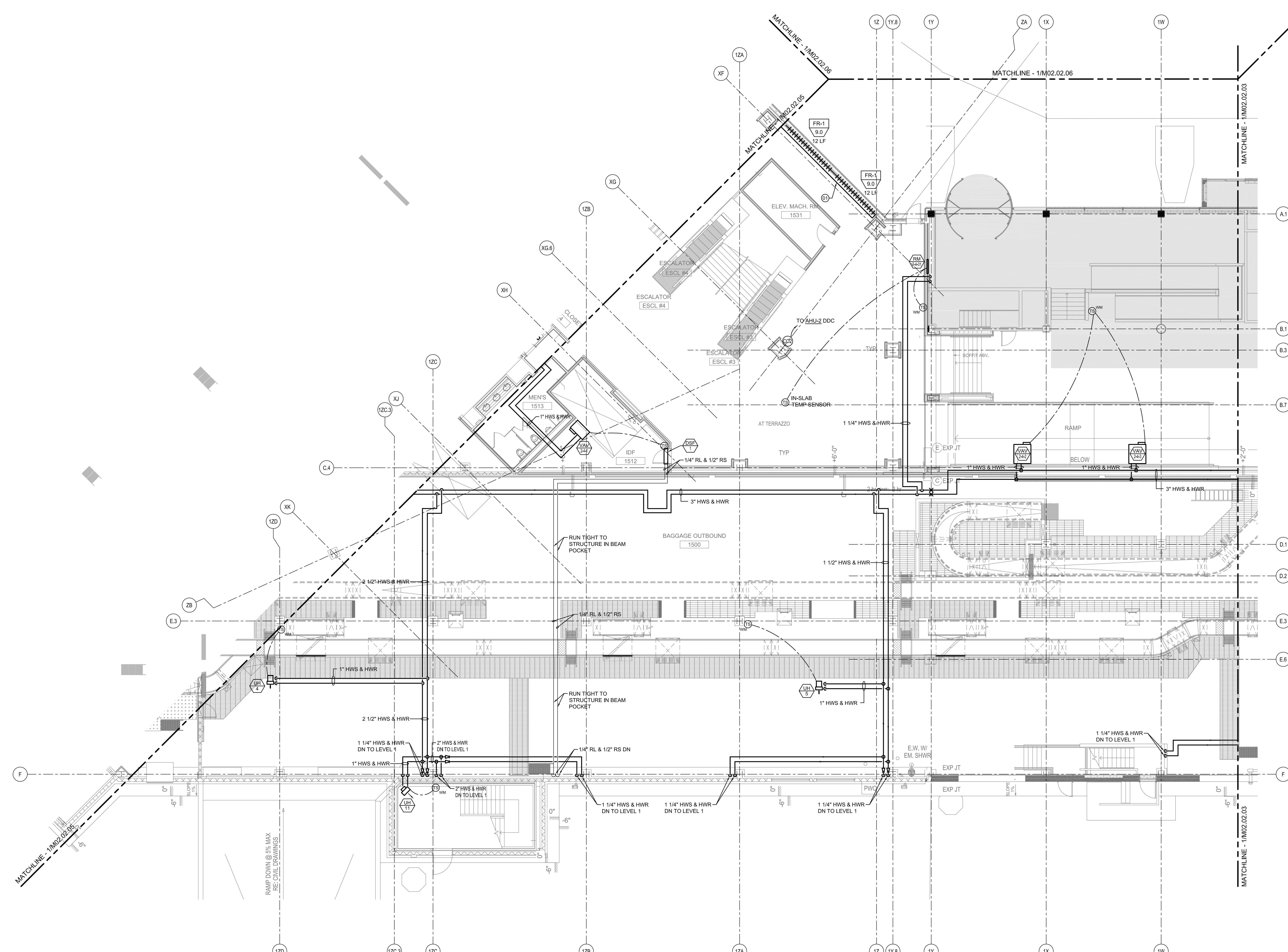

GENERAL NOTES

- A SEE SHEET M00.00 FOR LEGEND AND GENERAL NOTES.
- B MAINTAIN 18" MIN CLEARANCE FROM RADIANT TUBING TO FLOOR DRAINS, COLUMN WRAPS, PLUMBING FIXTURES, EQUIPMENT SUPPORTS, AND PIPING AT FLOORS.
- C RUN ALL PIPING HIGH AS POSSIBLE WITHIN BEAM POCKET TO AVOID BAGGAGE HANDLING EQUIPMENT.

Issue	Date & Issue Description	By	Check
01	07/11/08	PWZ	RHB
02	09/22/08	PWZ	RHB
03	12/03/08	PWZ	RHB
04	01/23/09	PWZ	RHB
05	10/26/09	PWZ	RHB

Project Name: PWM Terminal Enhancement
 Project Number: 09-6395-000
 CAD File Name: T:\6330\101\Sheets\M02.02.04.dwg
 Description: MECHANICAL PIPING PLAN - LEVEL 2 - ZONE 4

Issue: 0126/09

KEY PLAN

Scale: 1/8" = 1'-0"

Ref. North

M02.02.04