

SHEET NOTES

Portland International
Jetport
1001 Westbrook Street
Portland, Maine 04102

Gensler
2024 N Street, NW
Suite 200
Washington, DC 20006
Telephone 202.221.5200
Facsimile 202.221.5207

oast ASSOCIATES, INC.
345 Commonwealth Street, Suite 400, Portland, ME 04101
Telephone 207.761.1100 Fax 207.761.1104
engineers • architects • planners • construction managers

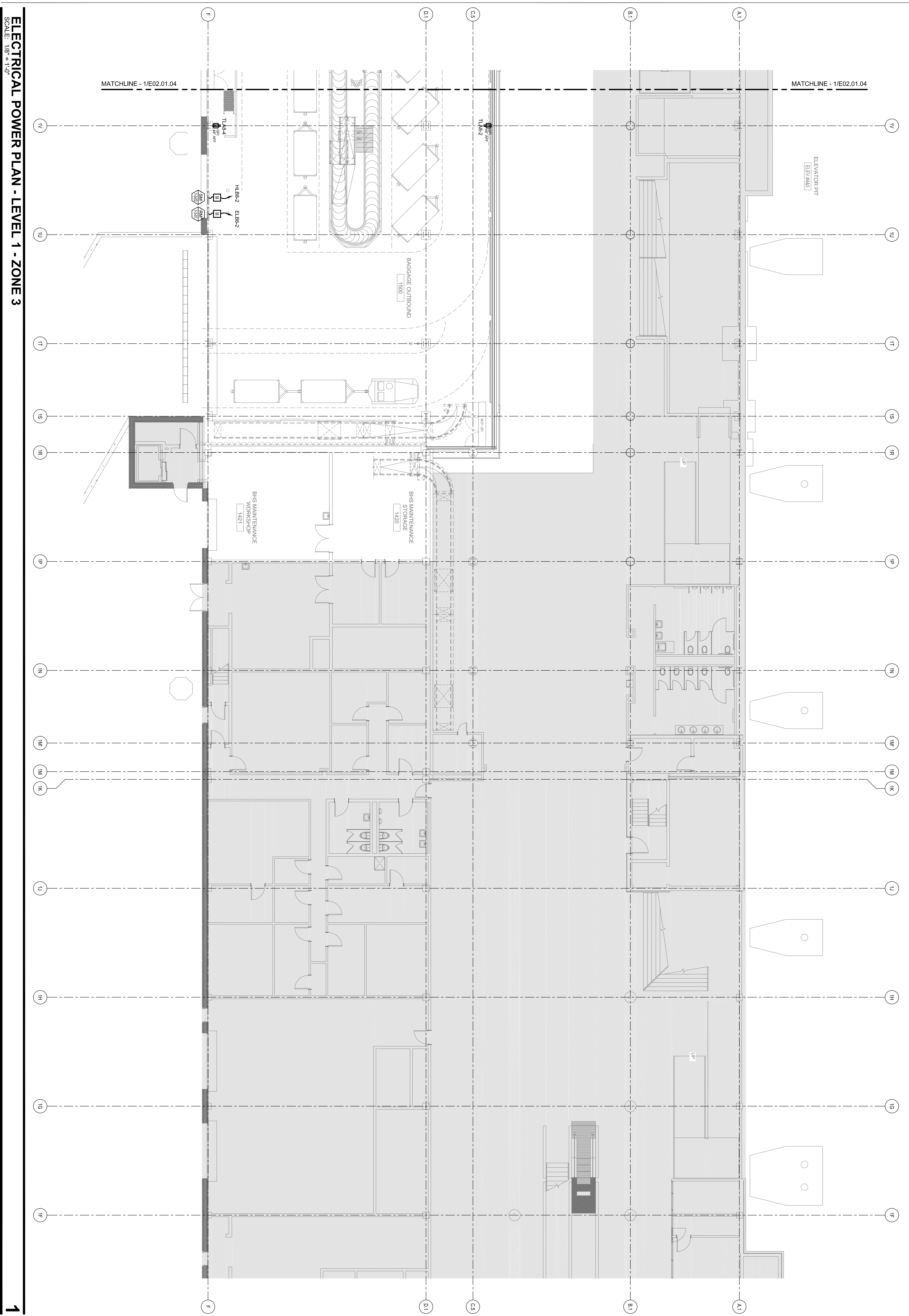

ELECTRICAL POWER PLAN - LEVEL 1 - ZONE 3
SCALE: 1/8\"/>

GENERAL NOTES

- A SEE SHEET E00.00 FOR LEGEND AND GENERAL NOTES.
- B CONTRACTOR SHALL REFER TO FIRE ALARM, SECURITY, IT, AND PUBLIC ADDRESS SYSTEMS DRAWINGS FOR CONDITIONS & WIRING REQUIREMENTS.

Revision	Date & Issue Description	By	Check
01	07/11/05	LAM	BHG
02	08/22/05	LAM	BHG
03	12/03/06	LAM	BHG
04	01/23/09	LAM	BHG
05	02/20/09	LAM	BHG
06	03/10/09	LAM	BHG
07	03/10/09	LAM	BHG
08	03/10/09	LAM	BHG
09	03/10/09	LAM	BHG
10	03/10/09	LAM	BHG
11	03/10/09	LAM	BHG
12	03/10/09	LAM	BHG
13	03/10/09	LAM	BHG
14	03/10/09	LAM	BHG
15	03/10/09	LAM	BHG
16	03/10/09	LAM	BHG
17	03/10/09	LAM	BHG
18	03/10/09	LAM	BHG
19	03/10/09	LAM	BHG
20	03/10/09	LAM	BHG
21	03/10/09	LAM	BHG
22	03/10/09	LAM	BHG
23	03/10/09	LAM	BHG
24	03/10/09	LAM	BHG
25	03/10/09	LAM	BHG
26	03/10/09	LAM	BHG
27	03/10/09	LAM	BHG
28	03/10/09	LAM	BHG
29	03/10/09	LAM	BHG
30	03/10/09	LAM	BHG
31	03/10/09	LAM	BHG
32	03/10/09	LAM	BHG
33	03/10/09	LAM	BHG
34	03/10/09	LAM	BHG
35	03/10/09	LAM	BHG
36	03/10/09	LAM	BHG
37	03/10/09	LAM	BHG
38	03/10/09	LAM	BHG
39	03/10/09	LAM	BHG
40	03/10/09	LAM	BHG
41	03/10/09	LAM	BHG
42	03/10/09	LAM	BHG
43	03/10/09	LAM	BHG
44	03/10/09	LAM	BHG
45	03/10/09	LAM	BHG
46	03/10/09	LAM	BHG
47	03/10/09	LAM	BHG
48	03/10/09	LAM	BHG
49	03/10/09	LAM	BHG
50	03/10/09	LAM	BHG
51	03/10/09	LAM	BHG
52	03/10/09	LAM	BHG
53	03/10/09	LAM	BHG
54	03/10/09	LAM	BHG
55	03/10/09	LAM	BHG
56	03/10/09	LAM	BHG
57	03/10/09	LAM	BHG
58	03/10/09	LAM	BHG
59	03/10/09	LAM	BHG
60	03/10/09	LAM	BHG
61	03/10/09	LAM	BHG
62	03/10/09	LAM	BHG
63	03/10/09	LAM	BHG
64	03/10/09	LAM	BHG
65	03/10/09	LAM	BHG
66	03/10/09	LAM	BHG
67	03/10/09	LAM	BHG
68	03/10/09	LAM	BHG
69	03/10/09	LAM	BHG
70	03/10/09	LAM	BHG
71	03/10/09	LAM	BHG
72	03/10/09	LAM	BHG
73	03/10/09	LAM	BHG
74	03/10/09	LAM	BHG
75	03/10/09	LAM	BHG
76	03/10/09	LAM	BHG
77	03/10/09	LAM	BHG
78	03/10/09	LAM	BHG
79	03/10/09	LAM	BHG
80	03/10/09	LAM	BHG
81	03/10/09	LAM	BHG
82	03/10/09	LAM	BHG
83	03/10/09	LAM	BHG
84	03/10/09	LAM	BHG
85	03/10/09	LAM	BHG
86	03/10/09	LAM	BHG
87	03/10/09	LAM	BHG
88	03/10/09	LAM	BHG
89	03/10/09	LAM	BHG
90	03/10/09	LAM	BHG
91	03/10/09	LAM	BHG
92	03/10/09	LAM	BHG
93	03/10/09	LAM	BHG
94	03/10/09	LAM	BHG
95	03/10/09	LAM	BHG
96	03/10/09	LAM	BHG
97	03/10/09	LAM	BHG
98	03/10/09	LAM	BHG
99	03/10/09	LAM	BHG
100	03/10/09	LAM	BHG

KEY PLAN

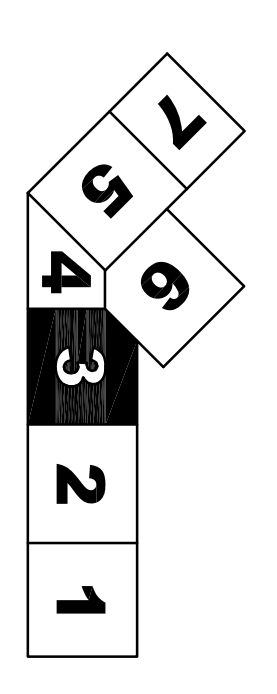

E02.01.03
Scale: 1/8\"/>

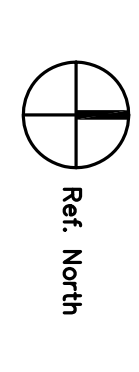

©2006 Gensler