

SHEET NOTES

**Portland International
Jetport**
1001 Westbrook Street
Portland, Maine 04102

Gensler
2024 N Street, NW
Suite 200
Washington, DC 20006
Telephone 202.221.5200
Facsimile 202.272.5297

oastf ASSOCIATES, INC.
340 Commonwealth Blvd., Suite 1000, Portland, ME 04103
Engineers • Architects • Surveyors • Construction Managers

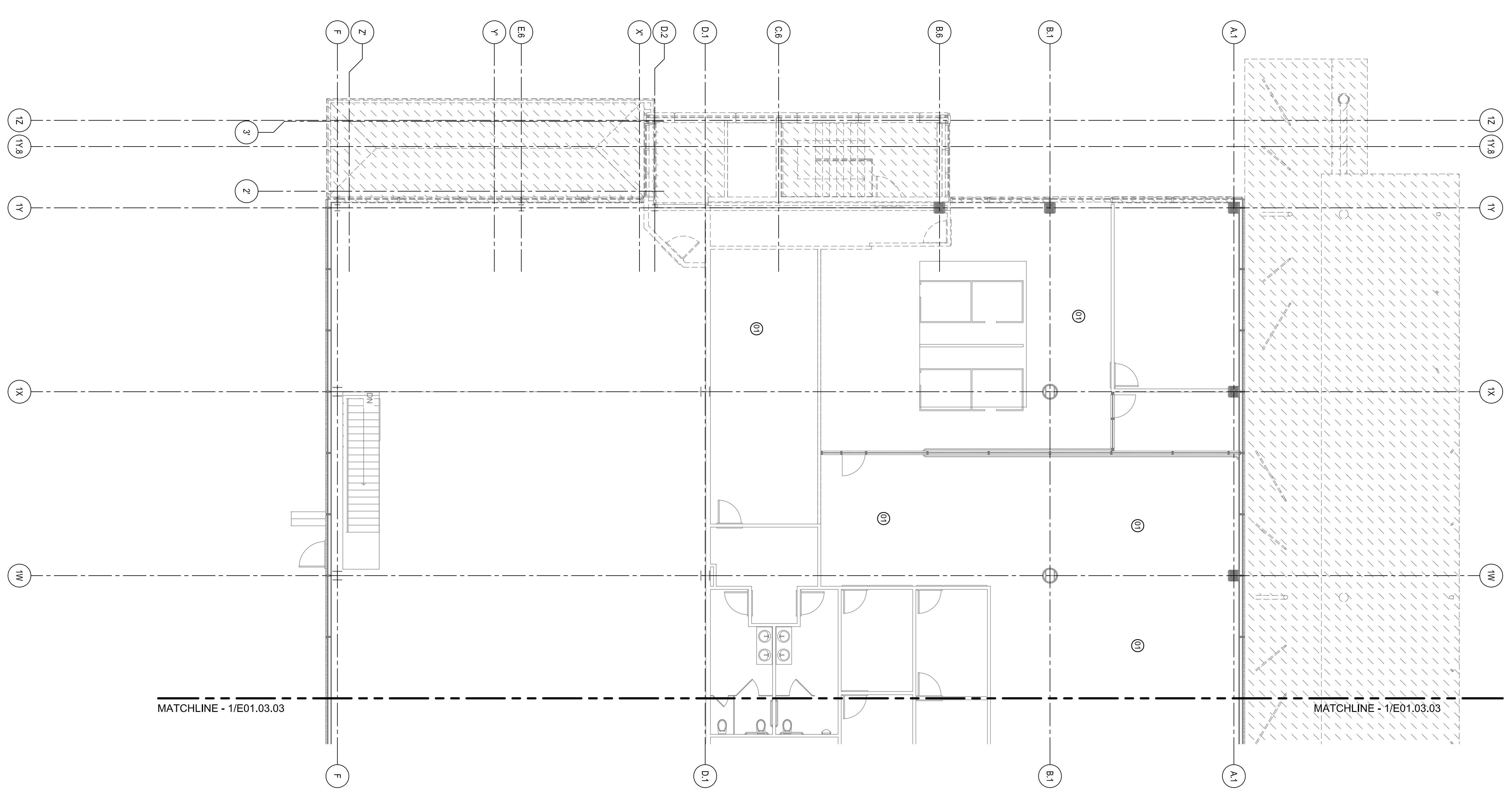

GENERAL NOTES
A SEE SHEET E00.00 FOR LEGEND AND GENERAL NOTES.
B ALL DEVICES BEING REMOVED SHALL HAVE ALL ASSOCIATED CONDUIT & WIRING REMOVED BACK TO SOURCE.

KEY PLAN

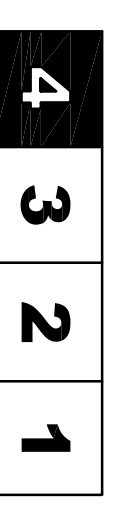

Issue	Date & Issue Description	By	Checked
01	12/20/00	LAM	BHG
02	01/23/01	50% CONSTRUCTION DOCUMENTS	LAM
03	10/26/09	ISSUED FOR PERMIT	LAM

Project Name: PMA Terminal Enhancement
 Project Number: 10000000
 Label Number: 10000000
 Date of Issue: 10/26/09
 Description: ELECTRICAL DEMOLITION PLAN - LEVEL 3 - ZONE 4

Scale: 1/8" = 1'-0"
E01.03.04
 Ref. North