

SHEET NOTES

1. THE CONTRACTOR SHALL SUPPLY AND INSTALL ALL PLANTS IN SUFFICIENT QUANTITIES TO COMPLETE THE WORK AS SHOWN ON THE DRAWINGS. DISCREPANCIES BETWEEN QUANTITIES SHOWN ON THE DRAWINGS AND THE PLANT LIST SHALL BE REPORTED IMMEDIATELY TO THE LANDSCAPE ARCHITECT AND SHALL NOT ENTITLE THE CONTRACTOR TO ADDITIONAL COMPENSATION.
2. THE CONTRACTOR IS ADVISED THAT BOTH ABOVE AND BELOW GROUND UTILITIES EXIST ON THE SITE. THE LOCATIONS OF WHICH SHALL BE VERIFIED BY THE CONTRACTOR PRIOR TO COMMENCEMENT OF OPERATIONS. SHOULD THE LOCATION OF ANY PROPOSED PLANTING CONFLICT WITH ANY UTILITY, THE LANDSCAPE ARCHITECT SHALL BE NOTIFIED IMMEDIATELY FOR DECISION.
3. ANY AND ALL PAVING, CURBING, UTILITIES, LAINS, ETC. DAMAGED AS A RESULT OF THE CONTRACTOR'S OPERATIONS SHALL BE REPLACED OR REPAIRED BY THE CONTRACTOR AT NO ADDITIONAL COST TO THE OWNER.
4. TREE AND WATERING RINGS SHALL RECEIVE 3" APPROVED CLEAN, UNIFORM GROUND OR SPREADED PINE OR HEMLOCK BARK MULCH. DO NOT PLACE MULCH IN CONTACT WITH TREE OR SHRUB TRUNKS. MULCHING SHALL BE COMPLETED WITHIN 18 HOURS AFTER PLANTING OF NEW MATERIAL.
5. LOCATIONS OF PROPOSED PLANTINGS AND BED LINES SHALL BE REVIEWED BY THE ENGINEER OR OWNER'S REPRESENTATIVE PRIOR TO INSTALLATION.
6. THE CONTRACTOR SHALL RELOCATE ANY PLANT AT THE DIRECTION OF THE THE ENGINEER OR OWNER'S REPRESENTATIVE.
7. ALL PLANTS SHALL HAVE A NORMAL HABIT OF GROWTH FOR THE SPECIES. PLANTS SHALL BE SOUND, HEALTHY AND FREE OF DISEASE AND INSECTS OR THEIR EGGS, AND SHALL HAVE NORMAL, HEALTHY ROOT SYSTEMS. THEY SHALL CONFORM TO THE MEASUREMENTS ON THE PLANT LIST AND SHALL CONFORM TO ANSI Z601-NURSEY STOCK, LATEST EDITION. ALL PLANTS SHALL BE GROWN IN LATITUDE NORTH OF BOSTON, MA.
8. IF, DUE TO CULTURAL REQUIREMENTS, AVAILABILITY, OR OTHER CIRCUMSTANCES, THE CONTRACTOR BELIEVES A PARTICULAR PLANT SPECIFIED FOR USE IS INAPPROPRIATE, THE CONTRACTOR SHALL REPORT THE SITUATION IMMEDIATELY TO THE LANDSCAPE ARCHITECT FOR DECISION.
9. ALL DISTURBED AREAS NOT OTHERWISE COVERED SHALL RECEIVE 4" LOAM AND SEED.
10. GUYING AND STAKING IS NOT REQUIRED UNLESS IN THE OPINION OF THE CONTRACTOR IT IS NECESSARY. TREES SHALL NOT BE STAKED FOR THE PURPOSE OF HOLDING THE TREE UPRIGHT DUE TO BROKEN ROOT BALL OR MISHANDLING. ANY PLANTS WITH BROKEN OR DAMAGED ROOT BALLS WILL BE REJECTED. IF STAKES ARE INSTALLED, THEY SHALL BE REJECTED BY THE CONTRACTOR WHEN THE TREE HAS STABILIZED OR AT 1 YEAR, WHICHEVER IS LATER.
11. ALL PLANTS SHALL HAVE ALL NON-BIOGRADABLE MATERIALS (STRING, WIRE, POTS, ETC.) REMOVED AT THE TIME OF PLANTING. CIRCLING ROOTS OR ROOTS THAT WOULD LATER GIRDLE THE PLANT SHALL BE STRIPPED, CUT OR THE ROOT BALL SHALL BE CUT UTILIZING THE "BUTTERFLY METHOD". TOP 1/2 OF WIRE BASKETS AND BURLAP ON TREES SHALL BE CUT AND REMOVED.
12. ALL PLANTINGS SHALL HAVE SLOW RELEASE FERTILIZER INSTALLED AT THE TIME OF PLANTING. THE FERTILIZER SHALL BE "ROOTS TRANSPLANT 1 STEP" INSTALLED/APPLIED ACCORDING TO MANUFACTURER'S INSTRUCTIONS. AFTER THE PLANTS ARE INSTALLED IN EACH AREA, LIQUID FEED ALL PLANTS WITH "ROOTS 2" OR APPROVED EQUAL. MIX AND APPLY ACCORDING TO MANUFACTURER'S INSTRUCTIONS. THE CONTRACTOR SHALL NOT INSTALL AND PLANT MATERIAL UNLESS APPROPRIATE WATERING EQUIPMENT IS ON SITE. ALL PLANTS SHALL BE ADEQUATELY WATERED THE DAY OF INSTALLATION OR THESE PLANTS WILL BE REJECTED AND REPLACED BY THE CONTRACTOR AT NO COST TO THE OWNER. CONTRACTOR IS RESPONSIBLE FOR WATERING MAINTENANCE UNTIL ACCEPTANCE.
13. PLANT SPECIES AND PLANT SIZE SUBSTITUTIONS WILL NOT BE ALLOWED UNLESS FIRST APPROVED BY THE LANDSCAPE ARCHITECT. ANY SUBSTITUTED PLANTS INSTALLED WITHOUT PRIOR APPROVAL WILL BE REJECTED.
14. ALL PLANTS SHALL BE GUARANTEED FOR ONE GROWING SEASON (1 YEAR FROM THE DATE OF ACCEPTANCE). THE CONTRACTOR, AT NO COST TO THE OWNER, SHALL REPLACE ANY PLANTS THAT DIE DURING THE GUARANTEE PERIOD.
15. ALL TOPSOIL SHALL BE RETAINED AND REUSED IN PLANTING HOLES AFTER DIGGING HAS BEEN COMPLETED. USE ANY EXCESS SOIL FROM THE PLANTING PIT TO FORM A SAUCER 2" TO 4" HIGH AROUND THE PLANT. SAUCERS SHALL BE THE SAME DIA. OR SLIGHTLY LARGER THAN THE ROOT BALL.
16. ALL PLANTS SHALL BE "WATERED IN" BY FLOODING THE BACKFILLED HOLE WITHIN THE SAME WORKING DAY UPON WHICH THEY WERE PLANTED. DURING AND IMMEDIATELY AFTER WATERING, ALL PLANTS SHALL BE ADJUSTED AS NECESSARY TO ENSURE CORRECT DEPTH OF PLANTING. VERTICAL ALIGNMENT AND/OR TO COMPENSATE FOR SETTLING. SOIL SHALL BE FIRMED AROUND EACH PLANT AS FINAL ADJUSTMENTS ARE MADE.
17. PLANTS SHALL BE SET PLUMB AND HELD IN POSITION UNTIL SUFFICIENT SOIL HAS BEEN FIRMLY PLACED AROUND THE ROOTS OR BALL. PLANTS SHALL BE SET AT GROUND LEVEL OR NO MORE THAN 2" ABOVE THE EXISTING GRADE. THIS IS TO ENSURE ADEQUATE RECEPTION OF OXYGEN AND MOISTURE TO THE ROOTS OF THE PLANT.
18. CLEAR, REMOVE AND DISPOSE OF BRUSH, SNAGS AND RUBBISH WITHIN 60" OF THE PLANTING HOLE. GRADE THE AREA TO MEET THE EXISTING LANDSCAPE UNLESS PLANTING ON A SLOPE.
19. PLANT ALL NEW PLANT MATERIAL AT ORIGINAL FIELD GROUND LEVEL. TAMP SOIL MIX BELOW ROOT BALL.
20. PLANTING HOLES ASSOCIATED WITH PROPOSED TREES SHOULD BE SLOPED (NOT COMPACTED) AND A MINIMUM OF 18-24" WIDER THAN THE DIA. OF THE ROOT BALL. TREES SHALL BE INSTALLED SUCH THAT THE TOP OF THE ROOT MASS IS LEVEL WITH THE SURFACE OF THE PLANTING HOLE. TREES SHALL ALSO BE INSTALLED 3-6" ABOVE GRADE ON SITES CONTAINING CLAY.
21. ALL TREE WRAPPING SHALL BE REMOVED UPON PLANTING.
22. CONTRACTOR SHALL PROVIDE, IN WRITING, A LIST OF RECOMMENDED MAINTENANCE PROCEDURES FOR THE FIRST TWO GROWING SEASONS.

Portland International Jetport

1001 Westbrook Street
Portland, Maine 041012

Gensler

oest ASSOCIATES, INC.
engineers • architects • surveyors • construction managers

2020 K Street, NW
Suite 200
Washington, DC 20006
Telephone 202.721.5200
Facsimile 202.872.8887

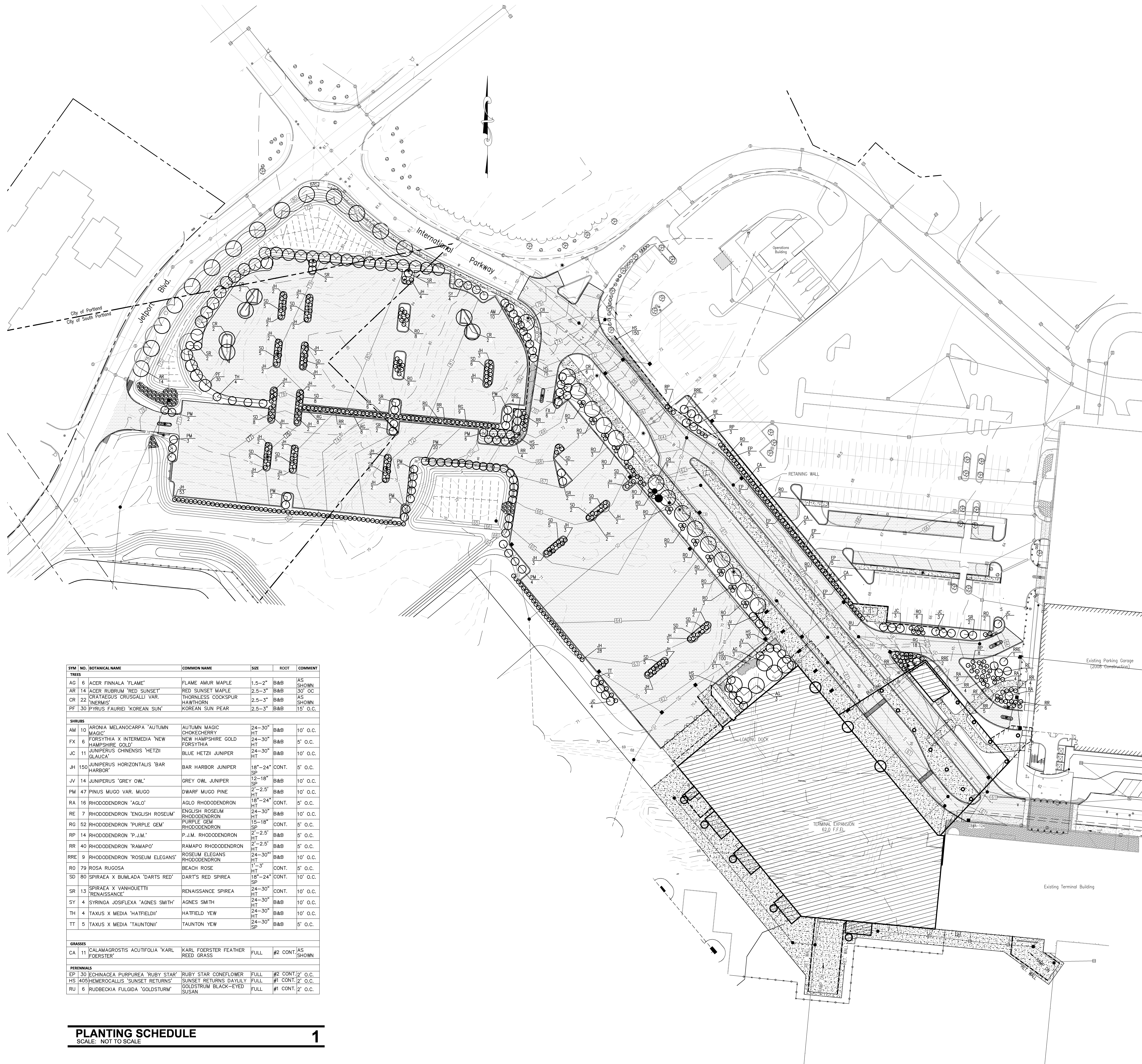

SYM	NO.	BOTANICAL NAME	COMMON NAME	SIZE	ROOT	COMMENT
TREES						
AC	6	ACER FINNALA 'FLAME'	FLAME AMUR MAPLE	1.5-2"	B&B	AS SHOWN
AR	14	ACER RUBRUM 'RED SUNSET'	RED SUNSET MAPLE	2.5-3"	B&B	10' O.C.
CR	22	CRATAEGUS CRUSGALLI VAR. 'THORNLESS'	THORNLESS COCKSPUR	2.5-3"	B&B	AS SHOWN
PF	30	PIRUS FAURIEI 'KOREAN SUN'	KOREAN SUN PEAR	2.5-3"	B&B	15' O.C.
SHRUBS						
AM	10	ARONIA MELANOCARPA 'AUTUMN MAGIC'	AUTUMN MAGIC CHOKECHERRY	24-30" HT	B&B	10' O.C.
FX	6	FORSYTHIA X INTERMEDIA 'NEW HAMPSHIRE GOLD'	NEW HAMPSHIRE GOLD FORSYTHIA	24-30" HT	B&B	5' O.C.
JC	11	JUNIPERUS CHINENSIS 'HETZI GLAUCIA'	BLUE HETZI JUNIPER	24-30" HT	B&B	10' O.C.
JH	150	JUNIPERUS HORIZONTALIS 'BAR HARBOR'	BAR HARBOR JUNIPER	18"-24" SP	CONT.	5' O.C.
JV	14	JUNIPERUS 'GREY OWL'	GREY OWL JUNIPER	12-18" SP	B&B	10' O.C.
PM	47	FINUS MUGO VAR. MUGO	DWARF MUGO PINE	2'-2.5" HT	B&B	10' O.C.
RA	16	RHOODODENDRON 'AGLO'	AGLO RHOODODENDRON	18"-24" HT	CONT.	5' O.C.
RE	7	RHOODODENDRON 'ENGLISH ROSEUM'	ENGLISH ROSEUM RHOODODENDRON	24-30" HT	B&B	10' O.C.
RG	52	RHOODODENDRON 'PURPLE GEM'	PURPLE GEM RHOODODENDRON	15-18" SP	CONT.	5' O.C.
RP	14	RHOODODENDRON 'P.J.M.'	P.J.M. RHOODODENDRON	2'-2.5" HT	B&B	5' O.C.
RR	40	RHOODODENDRON 'RAMAPO'	RAMAPO RHOODODENDRON	2'-2.5" HT	B&B	5' O.C.
RRE	9	RHOODODENDRON 'ROSEUM ELEGANS'	ROSEUM ELEGANS RHOODODENDRON	24-30" HT	B&B	10' O.C.
RO	79	ROSA RUGOSA	BEACH ROSE	1'-3" HT	CONT.	5' O.C.
SD	80	SPIRAEA X BUMLADA 'DARTS RED'	'DARTS' RED SPIREA	18"-24" SP	CONT.	10' O.C.
SR	13	SPIRAEA X VANHOUEYII 'RENAISSANCE'	RENAISSANCE SPIREA	24-30" HT	CONT.	10' O.C.
SY	4	SYRINGA JOSIFLEXA 'AGNES SMITH'	AGNES SMITH	24-30" HT	B&B	10' O.C.
TH	4	TAXUS X MEDIA 'HATFIELDI'	HATFIELD YEW	24-30" HT	B&B	10' O.C.
TT	5	TAXUS X MEDIA 'TAUNTONI'	TAUNTON YEW	24-30" SP	B&B	5' O.C.
GRASSES						
CA	11	CALAMAGROSTIS ACUTIFOLIA 'KARL FOERSTER'	KARL FOERSTER FEATHER REED GRASS	FULL	#2 CONT.	AS SHOWN
PERENNIALS						
EP	30	ECHINACEA PURPUREA 'RUBY STAR'	RUBY STAR CONEFLOWER	FULL	#2 CONT.	2' O.C.
HS	405	HEMEROCALLIS 'SUNSET RETURNS'	SUNSET RETURNS DAYLILY	FULL	#1 CONT.	2' O.C.
RU	6	RUDBECKIA FULGIDA 'GOLDSTURN'	GOLDSTURN BLACK-EYED SUSAN	FULL	#1 CONT.	2' O.C.

PLANTING SCHEDULE
SCALE: NOT TO SCALE

1

Rev	Date	Issue Description	By	Check
1	09/22/08	DESIGN DEVELOPMENT	W/W	AML
2	12/03/08	75% CONSTRUCTION DOCUMENTS	W/W	AML
3	01/23/09	95% CONSTRUCTION DOCUMENTS	W/W	MMB
4	10/26/09	ISSUED FOR PERMIT	W/W	MMB

Project Name
PJM Terminal Expansion

Project Number
08.6395.000
CAD File Name
T:\5330101\SHEETS\C02.03.DWG

Description
SITE LANDSCAPING PLAN

Scale
1" = 40'

C02.03

©2009 Gensler

