

Sanitary Structure Schedule

DESC.	R/W	INV. IN	INV. IN	INV. IN	INV. OUT
SMH OA-1	60.88	51.00	-	-	50.90
SMH OA-2	61.10	49.67	49.67(4')	-	49.57
SMH OA-3	61.40	48.35	-	-	48.25
PS OA-1	64.50	48.00	-	-	FM

Layout Coordinate Schedule

Symbol	North	East
P1	297322.3702	2913503.1698
P2	297311.8659	2913010.0577
P3	297286.1889	2913873.4051
P4	297241.2754	2913901.1721
P5	297175.2196	2913775.1472
P6	297202.9391	2913491.4984
P7	297325.9201	2913569.0565
P8	297384.0274	2913508.7270
P9	297420.5302	2913535.9138
P10	297463.8152	2913565.9383
P11	297502.2427	2913616.0640
P12	297480.5402	2913838.1418
P13	297452.3289	2913894.3531
P14	297398.3532	2913925.8652
P15	297355.0563	2913934.6865
P16	297316.3831	2913930.6140
P17	297293.5155	2913901.2507
P18	297463.8152	2913930.1559
P19	297383.8682	2914027.7309
P20	297465.5682	2914139.4235
P21	296831.9845	2914483.3207
P22	296818.9077	2914497.8773
P23	296805.2946	2914708.0050
P24	296805.5936	2914556.5679
P25	297395.7746	2913951.8271
P26	297295.7935	2913934.8296
P27	297141.8447	2913912.4516
P28	297097.2439	2913928.2555
P29	296886.8167	2914102.0399
P30	297023.1290	2914235.7411
P31	297322.6601	2913985.9222
P32	297372.1345	2914016.6668
P33	297302.3998	2914074.2370
P34	297228.8116	2914068.9125
P35	297251.8844	2914100.3778
P36	297240.6220	2914099.3013
P37	297311.8196	2914107.9558
P38	297283.3825	2914139.1261
P39	297202.9312	2914169.1185
P40	297243.9731	2914189.8887
P41	297243.1087	2914155.5881
P42	297227.8098	2914172.1205
P43	297049.3951	2914350.5263
P44	297031.4636	2914384.2176
P45	297021.1367	2914489.7924
P46	297031.2426	2914527.3495
P47	297006.2479	2914395.5723
P48	297006.1297	2914417.2276
P49	296986.4225	2914450.7326
P50	296936.8391	2914493.8237
P51	296910.2426	2914544.4563
P52	296902.9914	2914415.6164
P53	296859.3266	2914440.0018
P54	296833.5855	2914461.2515

2020 K Street, NW
Suite 200
Washington, DC 20006
Telephone 202.721.5200
Facsimile 202.872.8587

Gensler

oest ASSOCIATES, INC.
385 Oyster Road, South Portland, ME 04106 P: (207) 741-1770 F: (207) 774-2044 www.oest.com
engineers • architects • surveyors • construction managers

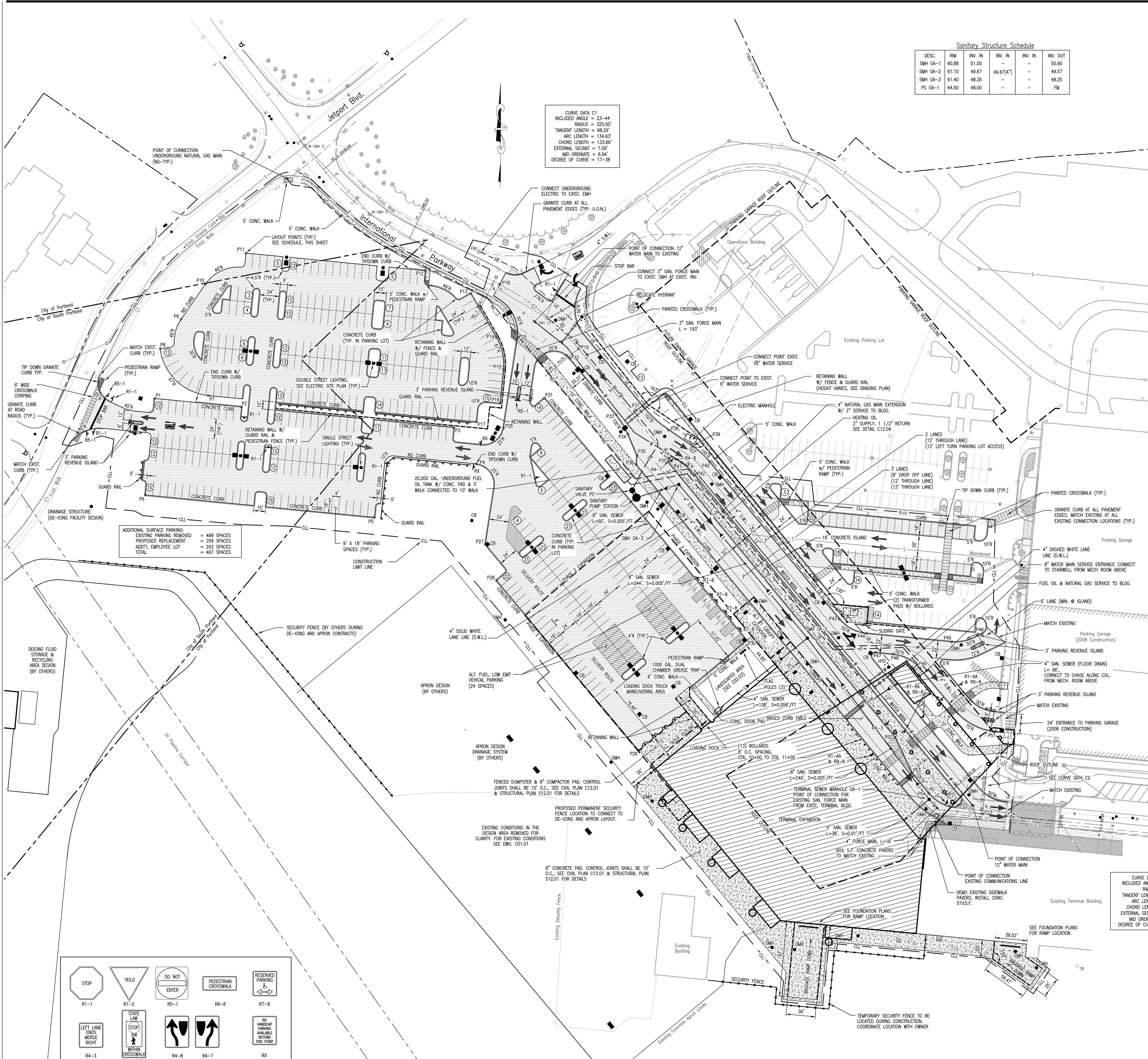

CURVE DATA C1
INCLUDED ANGLE = 23-44
RADIUS = 325.00'
TANGENT LENGTH = 68.29'
ARC LENGTH = 134.63'
CHORD LENGTH = 133.65'
EXTERNAL SECANT = 7.09'
MID ORDINATE = 6.94'
DEGREE OF CURVE = 17-38

CURVE DATA C2
INCLUDED ANGLE = 45-03
RADIUS = 46.00'
TANGENT LENGTH = 27.37'
ARC LENGTH = 51.90'
CHORD LENGTH = 50.57'
EXTERNAL SECANT = 6.44'
MID ORDINATE = 5.03'
DEGREE OF CURVE = 86-49

ADDITIONAL SURFACE PARKING:
EXISTING PARKING REMOVED = 489 SPACES
PROPOSED REPLACEMENT = 204 SPACES
ADDTL. EMPLOYEE LOT = 293 SPACES
TOTAL = 497 SPACES

GENERAL NOTES

- ALL ENTRANCE ROADWAY AND PARKING GARAGE ACCESS CURBSHALL BE TYPE I GRANITE VERTICAL CURB. CONCRETE CURBSHALL BE USED IN THE EMPLOYEE PARKING LOTS. TERMINATE GRANITE CURB AFTER RADIUS POINTS.
- DIMENSIONS ARE TO FACE OF CURB UNLESS OTHERWISE INDICATED.
- SEE ARCHITECTURAL PLANS FOR CONCRETE SIDEWALK JOINT PATTERN AND LAYOUT AT THE 25 FOOT WIDE ENTRANCE WALK.
- SEE STRUCTURAL PLAN S12.01 FOR RADIANT HEATING DETAILS IN SIDEWALK AND COMPACTOR PAD. SEE MECHANICAL PLAN M02.02.00 FOR RADIANT PIPING LOCATIONS.
- SEE CIVIL PLAN C02.04 FOR ENLARGED SITE LAYOUT PLAN FOR FRONT OF PROPOSED TERMINAL.
- CONTRACTOR SHALL PROVIDE A TEMPORARY WATER MAIN TO MAINTAIN THE LOOP SYSTEM REQUIRED BY PORTLAND WATER DISTRICT. THE TEMPORARY DESIGN FOR THIS WATER MAIN AND OTHER REQUIRED SERVICES SHALL BE REVIEWED AND APPROVED BY PORTLAND WATER DISTRICT AND THE CITY OF PORTLAND THE DEPARTMENT.
- PEDESTRIAN SIDEWALK RAMP SHALL BE PROVIDED AT ALL STREET CORNERS, CROSSWALKS AND DRIVEWAYS.

Issue	Date & Issue Description	By	Check
1	07/11/08	W/W	A/W
2	09/22/08	W/W	A/W
3	12/03/08	W/W	A/W
4	01/23/09	W/W	A/W
5	10/26/09	W/W	FEM

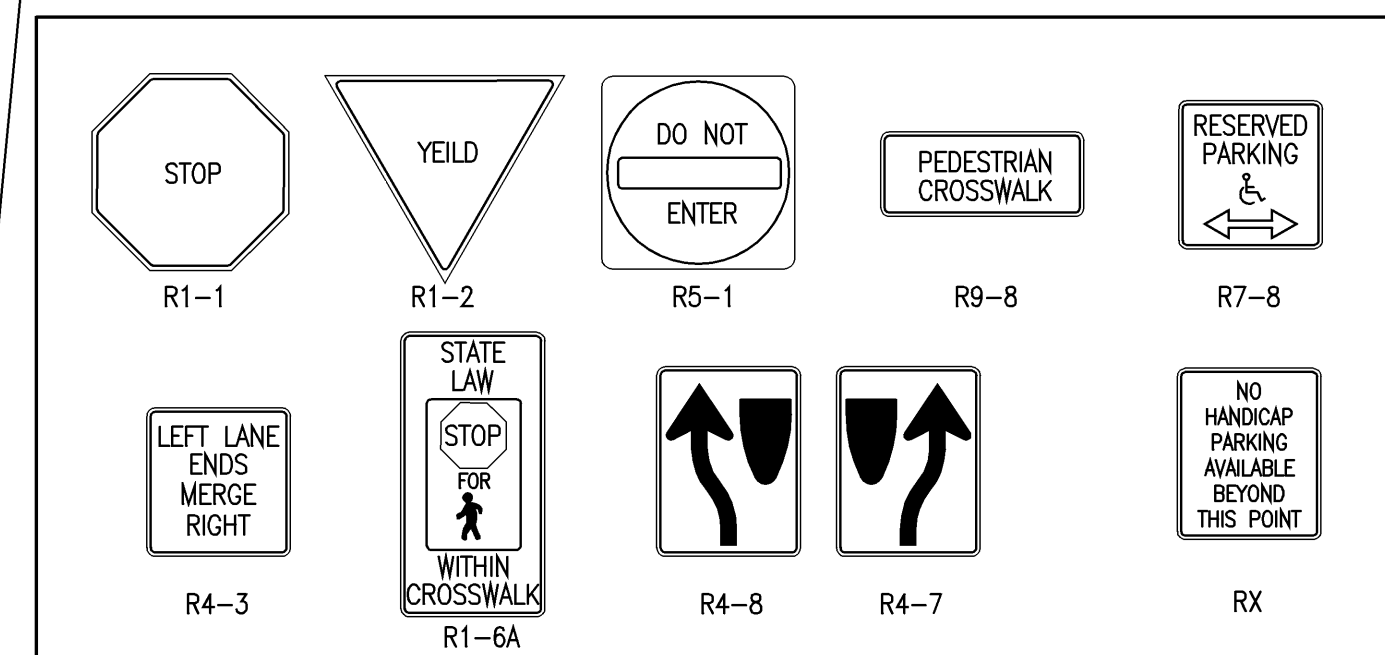

TRAFFIC REGULATORY SIGNS
SEE PLAN FOR LOCATIONS

Professional Engineer Seal for Michael J. Delety, State of Maine, License No. 10001. Date: 23 Oct 2009.