

**SHEET NOTES**

**Portland International  
Jetport**  
1001 Westbrook Street  
Portland, Maine 04102

**Gensler**  
2020 K Street, Northwest  
Suite 200 DC - 20006  
Washington DC 20006  
Tel: 202.872.8500  
Fax: 202.872.8587

**SM&W**  
3300 N. Fairfax Drive  
Suite 302  
Arlington, Virginia 22201  
Tel: 703.246-5904  
Fax: 703.246-5904  
www.smwinc.com

**SHEN MILSON WILKE**

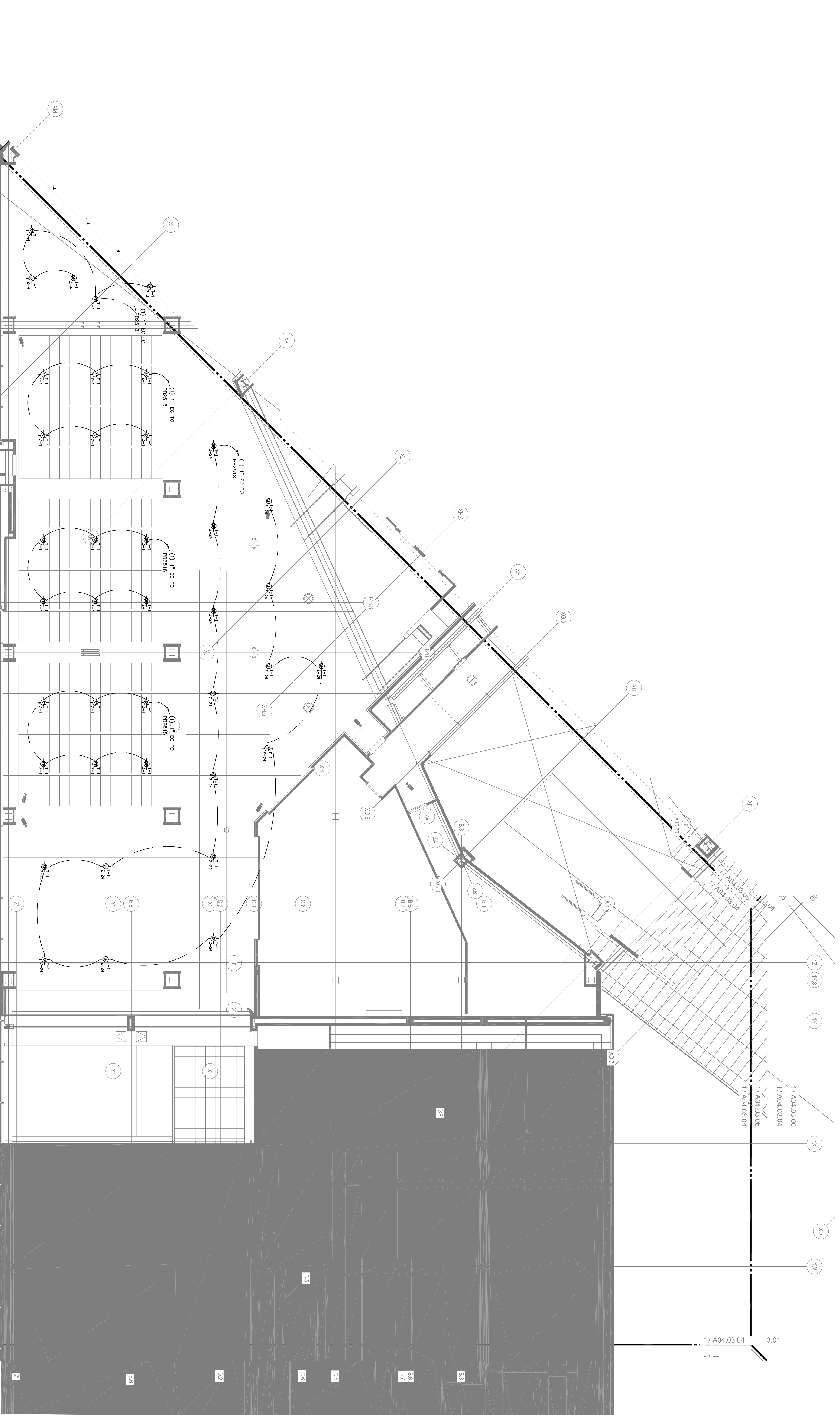

**LEVEL 3 - ZONE 4**  
1/8" = 1'-0"

**KEY PLAN**

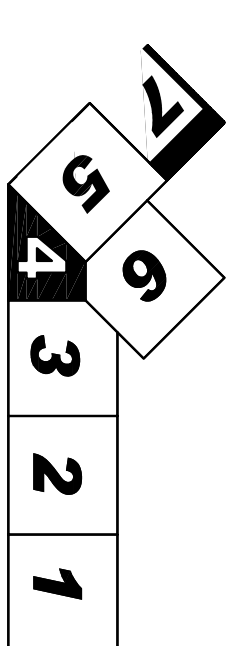

Issue	Date & Issue Description	By	Check
1	12/20/08 CONSTRUCTION DOCUMENTS		
2	12/20/08 PROGRESS ISSUE		
3	01/22/09 95% CONSTRUCTION DOCUMENTS		
4	10/20/09 PROGRESS ISSUE		
5	10/20/09 ISSUED FOR PERMIT		

Project Name  
**PVMT TERMINAL EXPANSION**

Project Number  
\_\_\_\_\_

CAO File Name  
\_\_\_\_\_

Description  
**AUDITORIUM FACILITY RCP - LEVEL 3 - ZONE 4**

Scale  
**As Indicated**

**AV04.03.04**

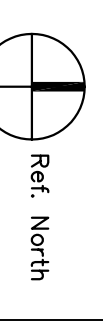

©2008 Gensler