

SHEET NOTES

Portland International Jetport
 1001 Westbrook Street
 Portland, Maine 04102

Gensler
 2020 K Street, Northwest
 Suite 200
 Washington DC 20006
 Telephone 202.721.5200
 Facsimile 202.872.8587

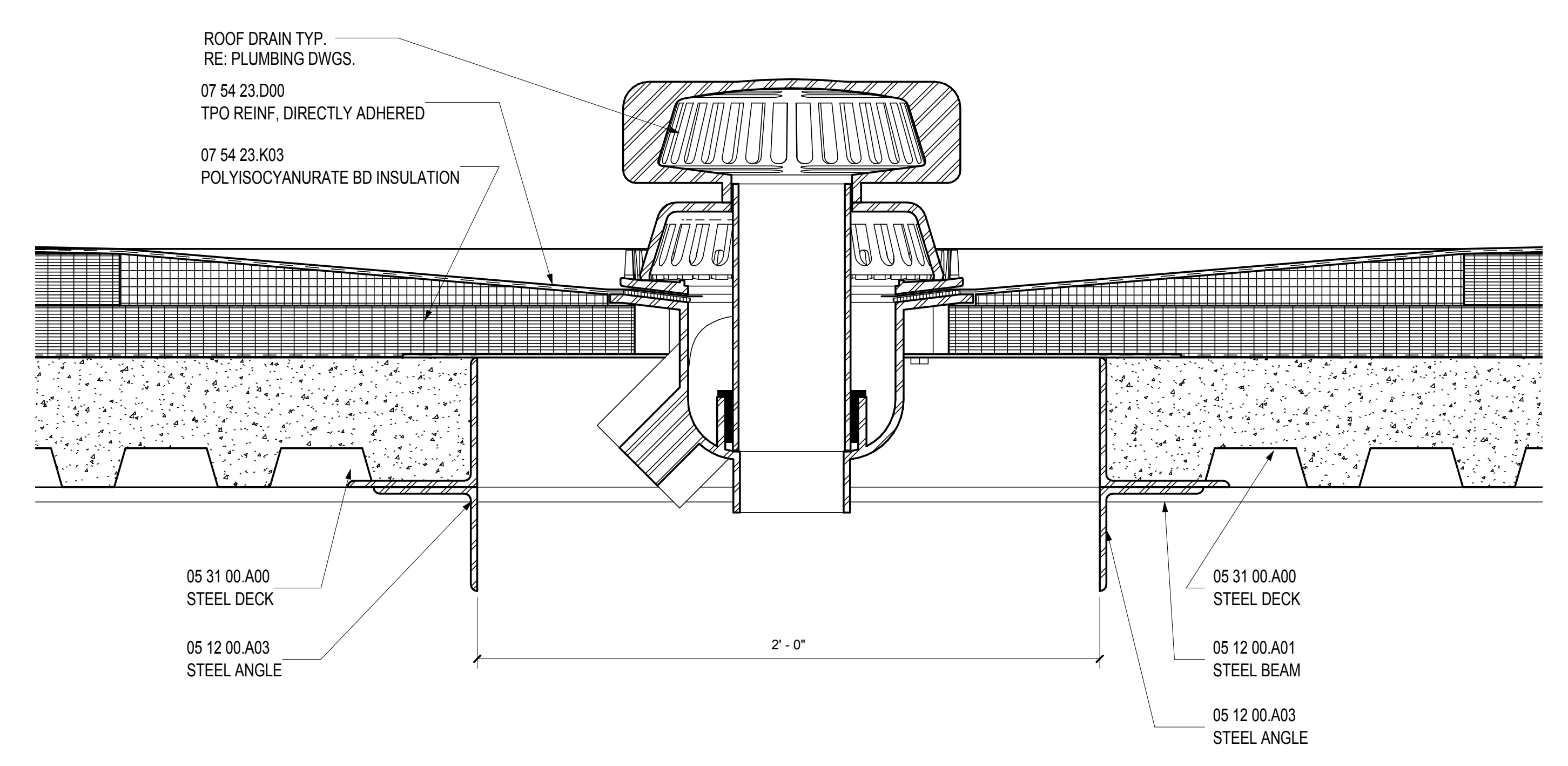

ROOF DRAIN
 SCALE: 3" = 1'-0"

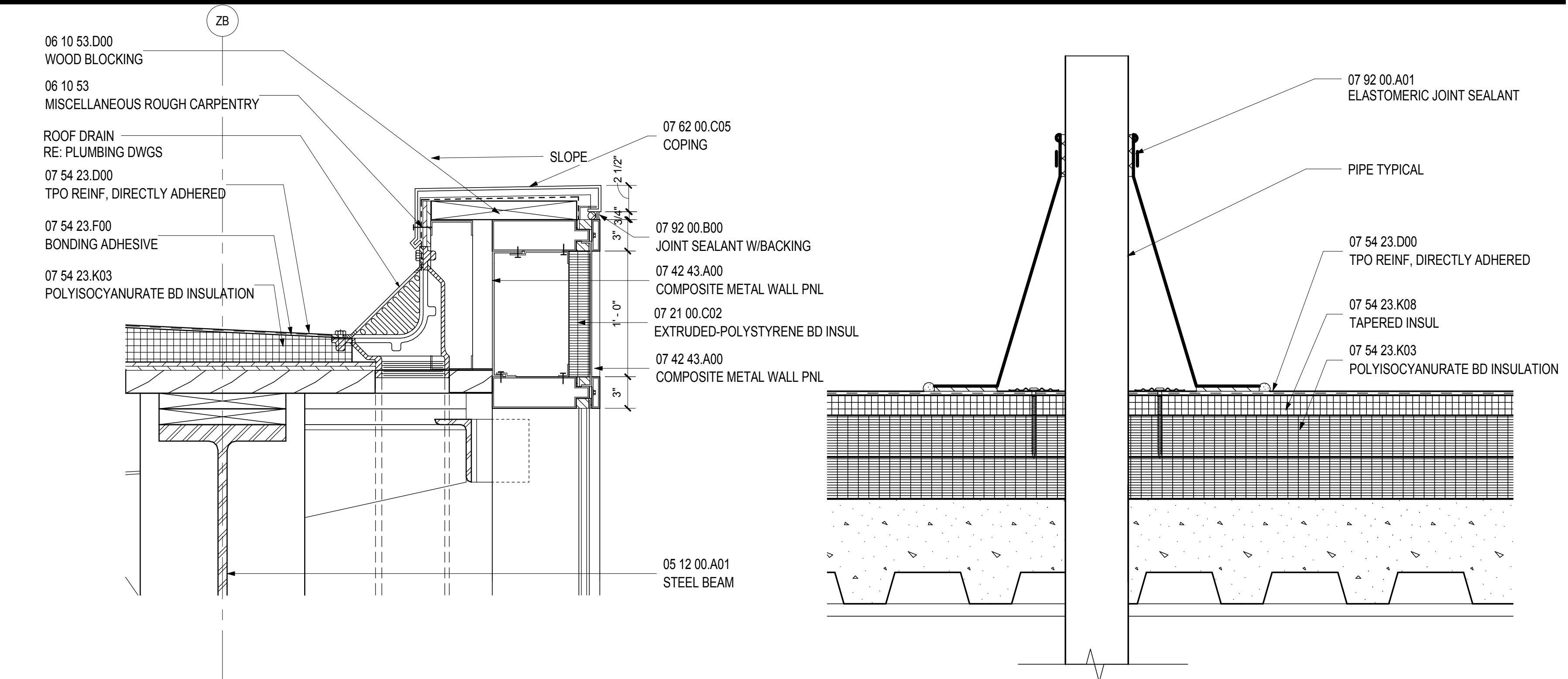

9 SCUPPER DRAIN @ HIGH ROOF
 SCALE: 1 1/2" = 1'-0"

5 PIPE FLASHING
 SCALE: 3" = 1'-0"

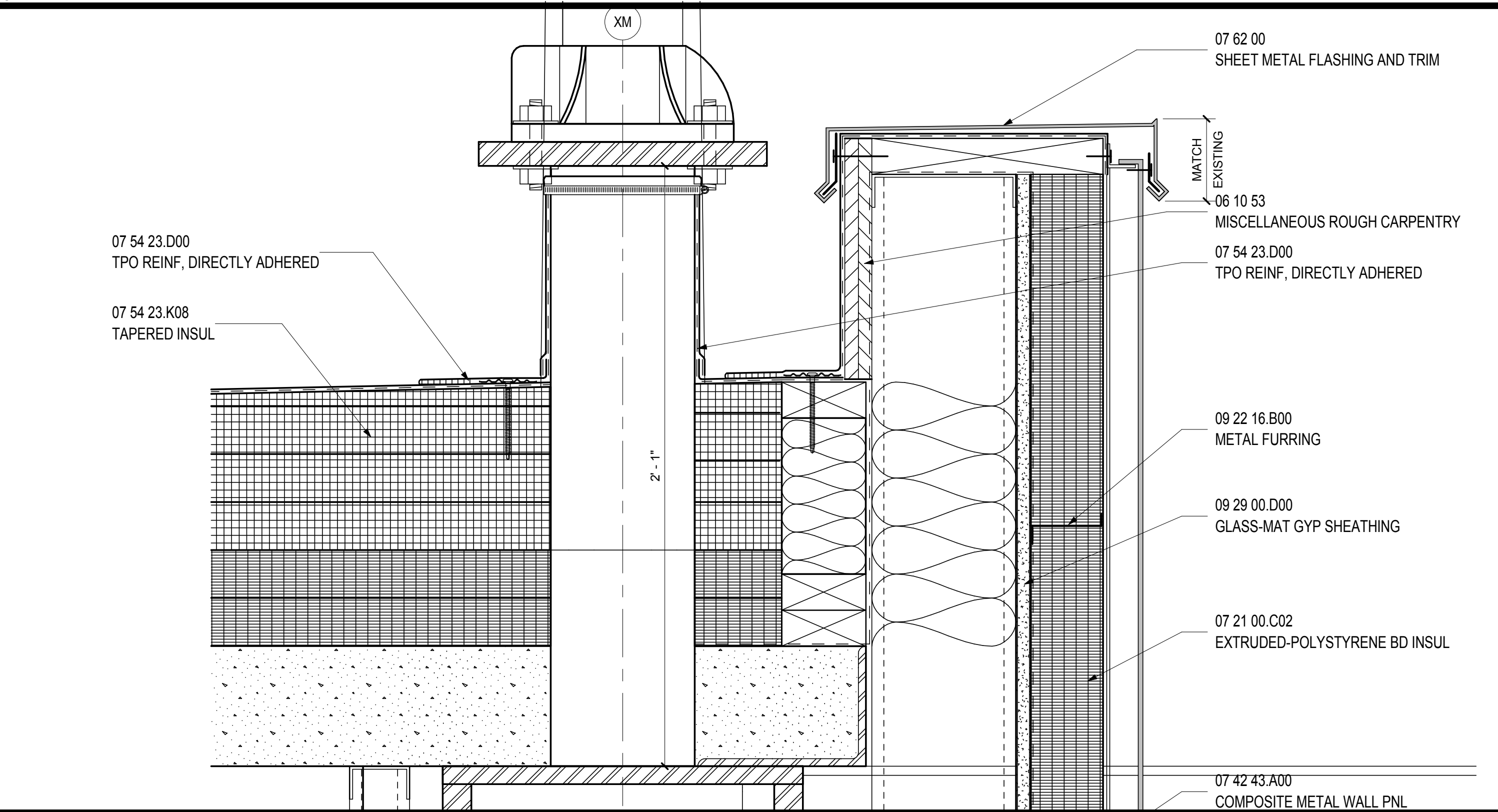

PARAPET AT LIGHT POLE
 SCALE: 3" = 1'-0"

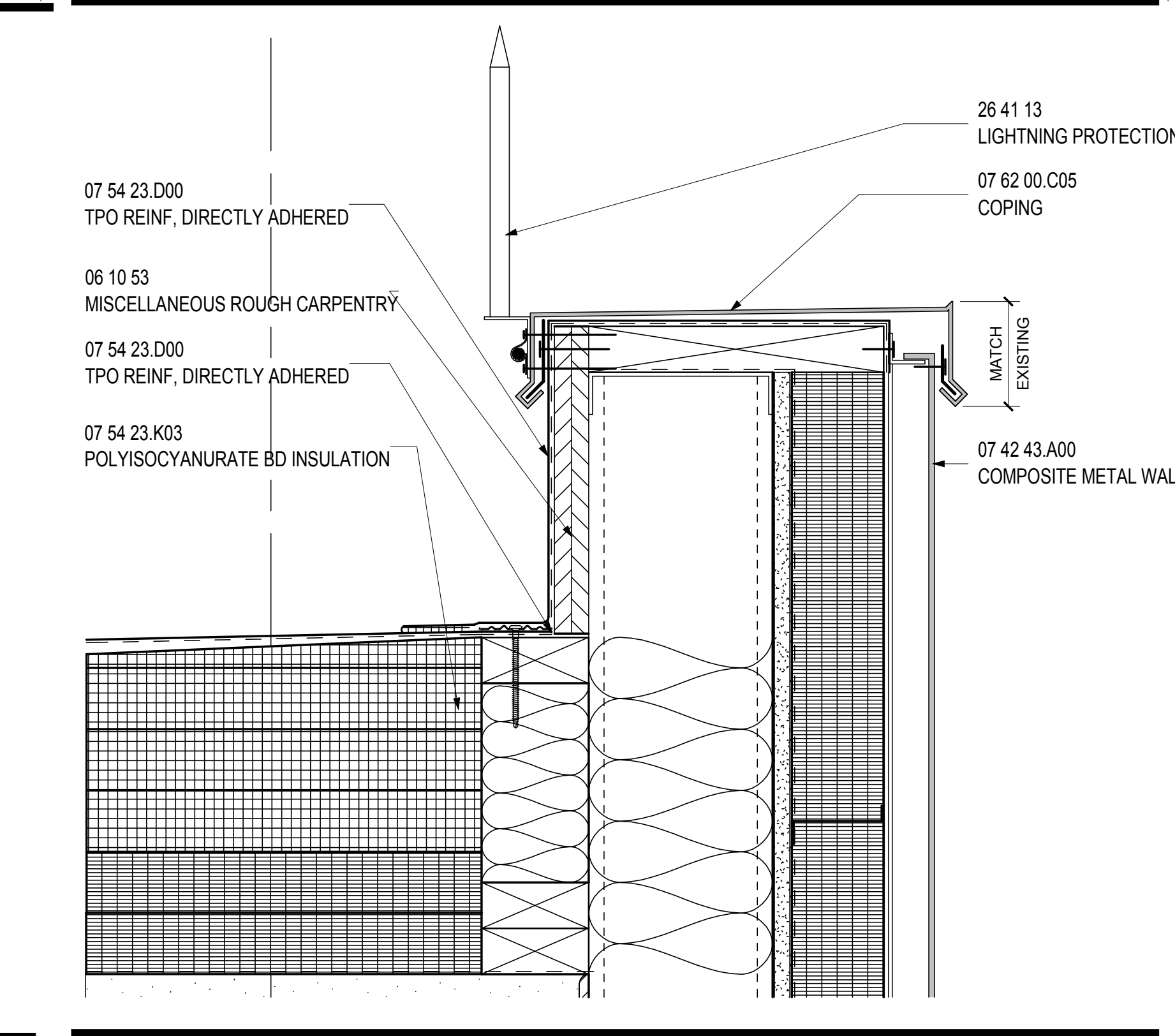

10 LIGHTNING PROTECTION AT PARAPET
 SCALE: 3" = 1'-0"

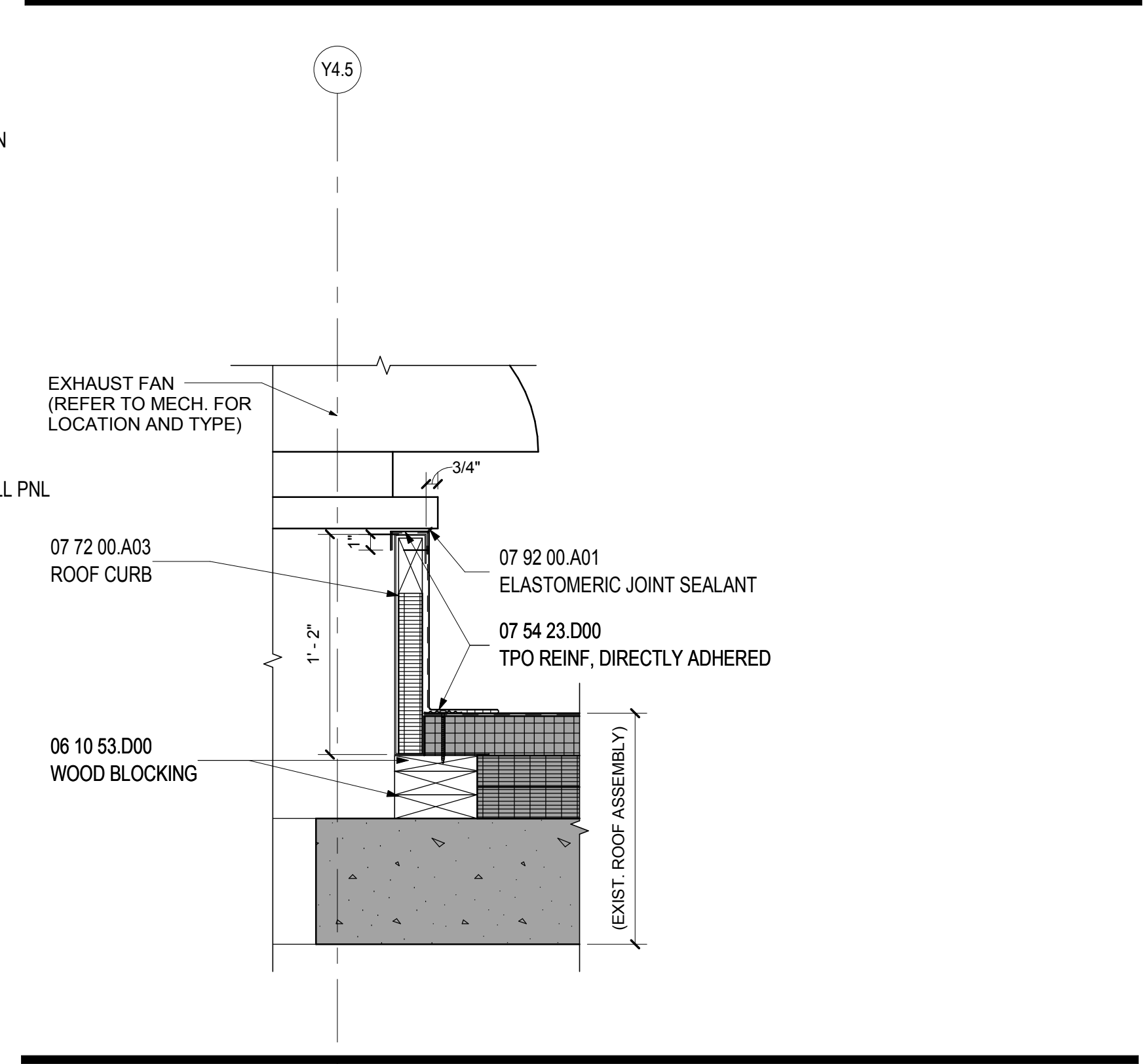

6 ROOF CURB AT EXHAUST UNIT
 SCALE: 1 1/2" = 1'-0"

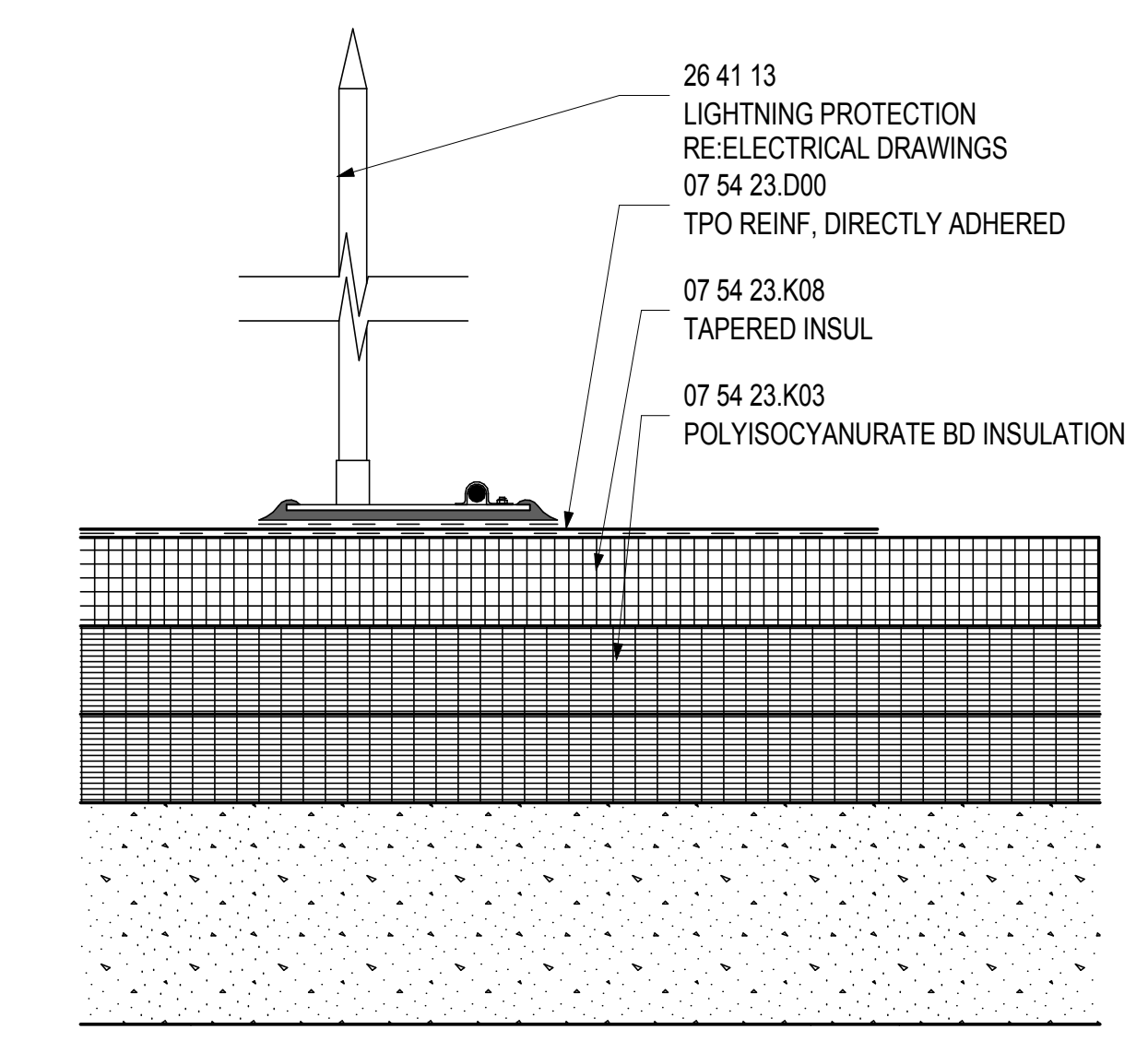

LIGHTNING PROTECTION DETAIL
 SCALE: 3" = 1'-0"

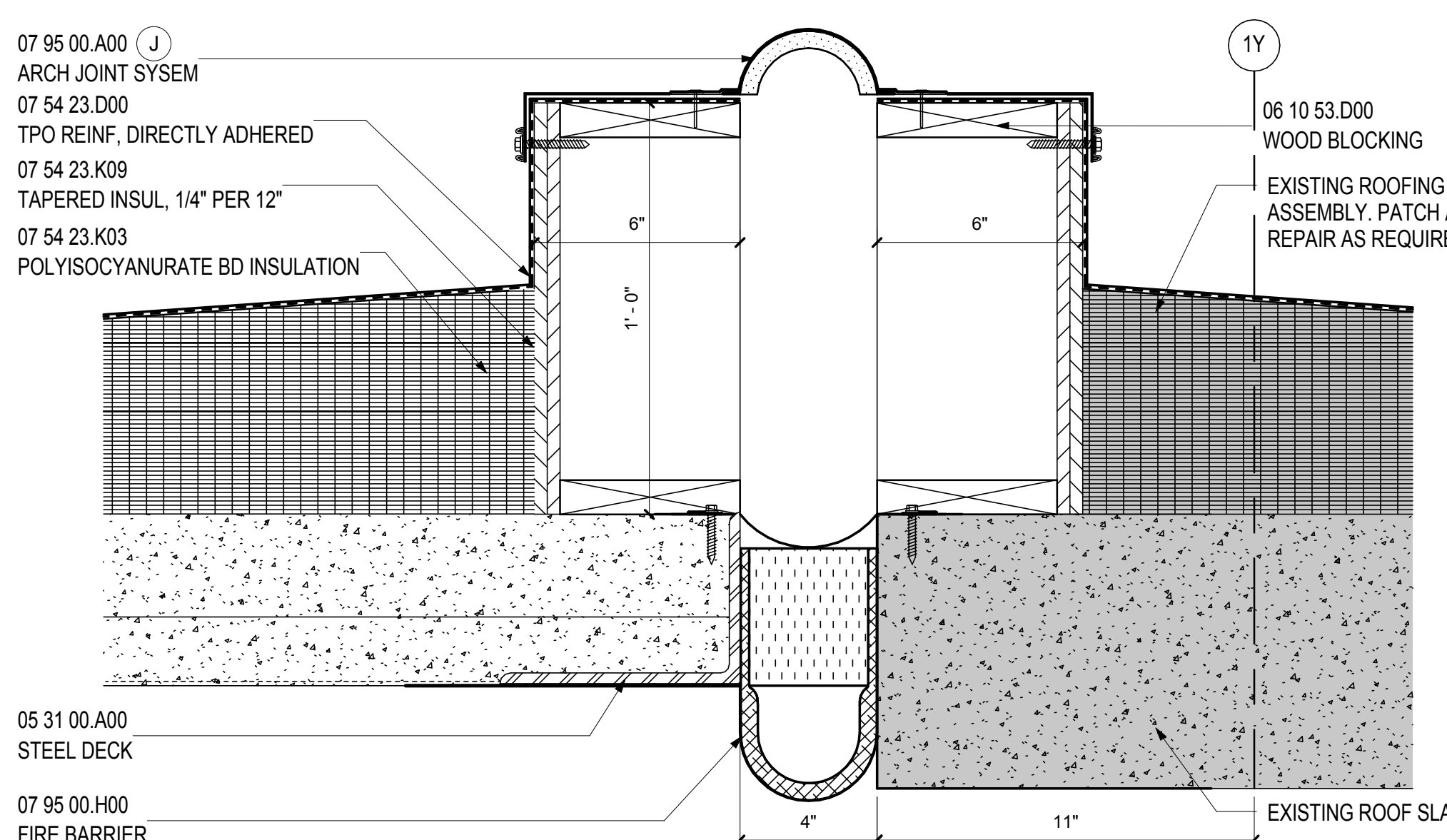

11 ROOF EXPANSION JOINT
 SCALE: 3" = 1'-0"

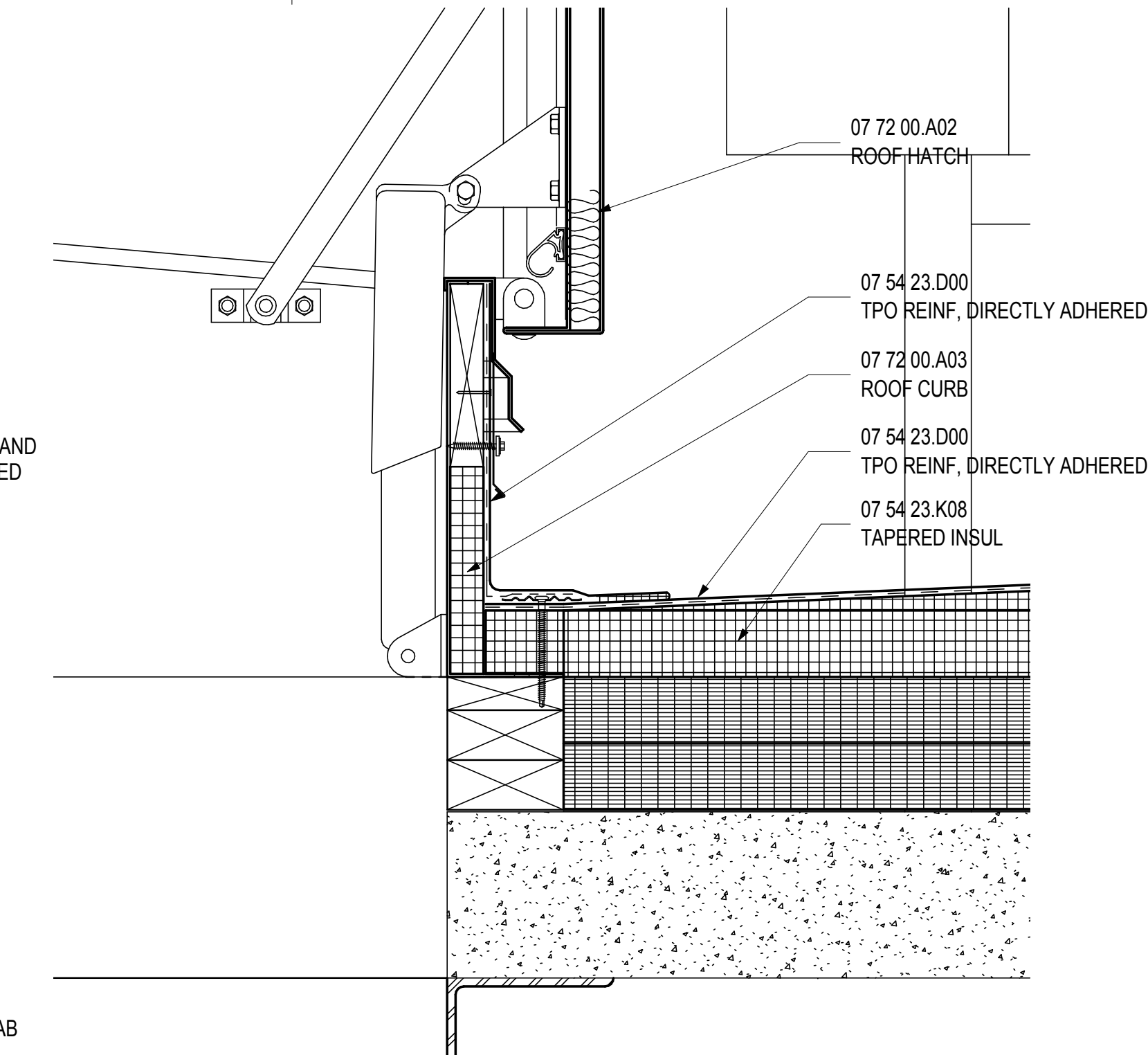

7 ROOF SCUTTLE DETAIL
 SCALE: 3" = 1'-0"

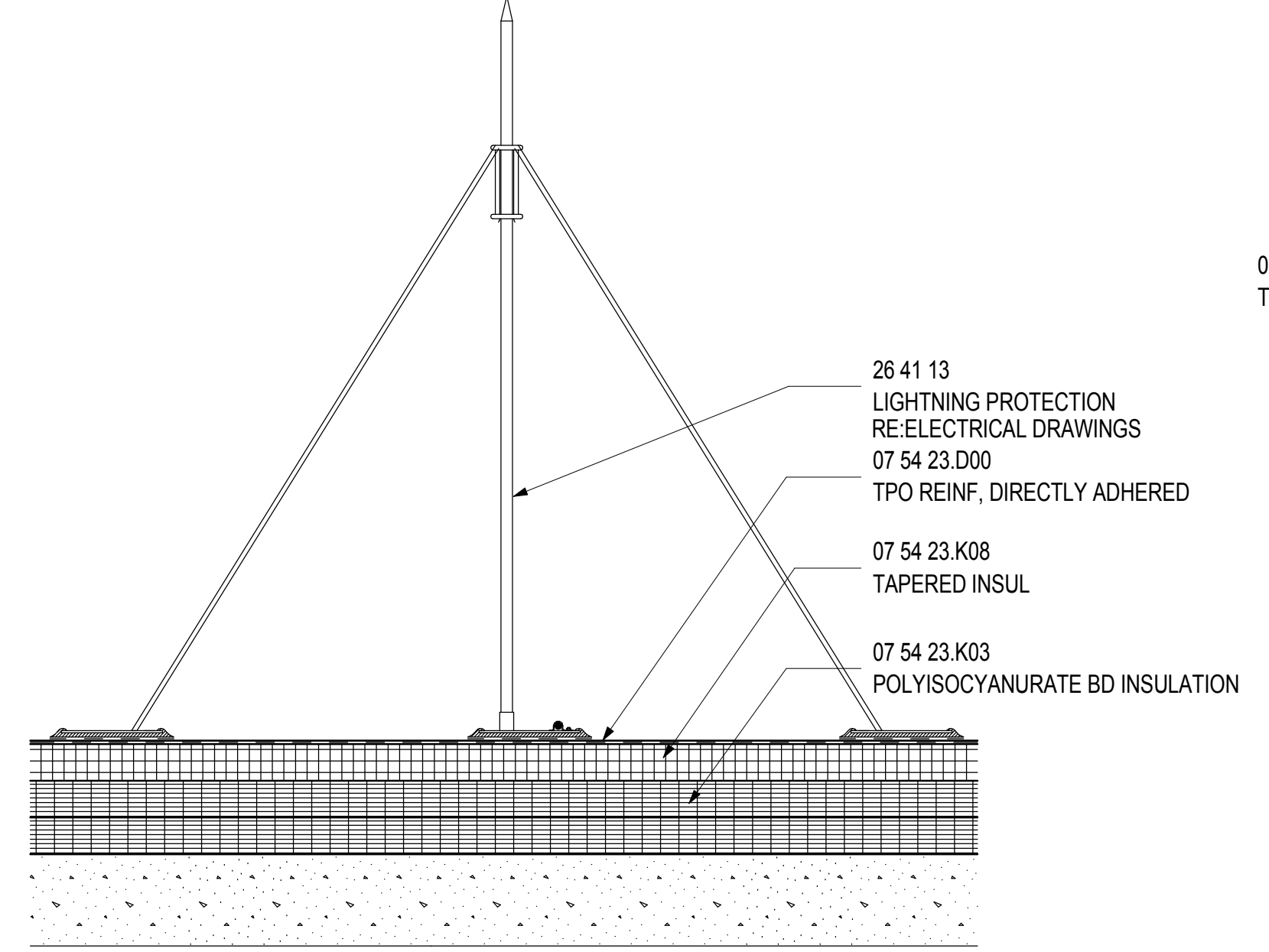

LIGHTNING PROTECTION AT MID ROOF
 SCALE: 1 1/2" = 1'-0"

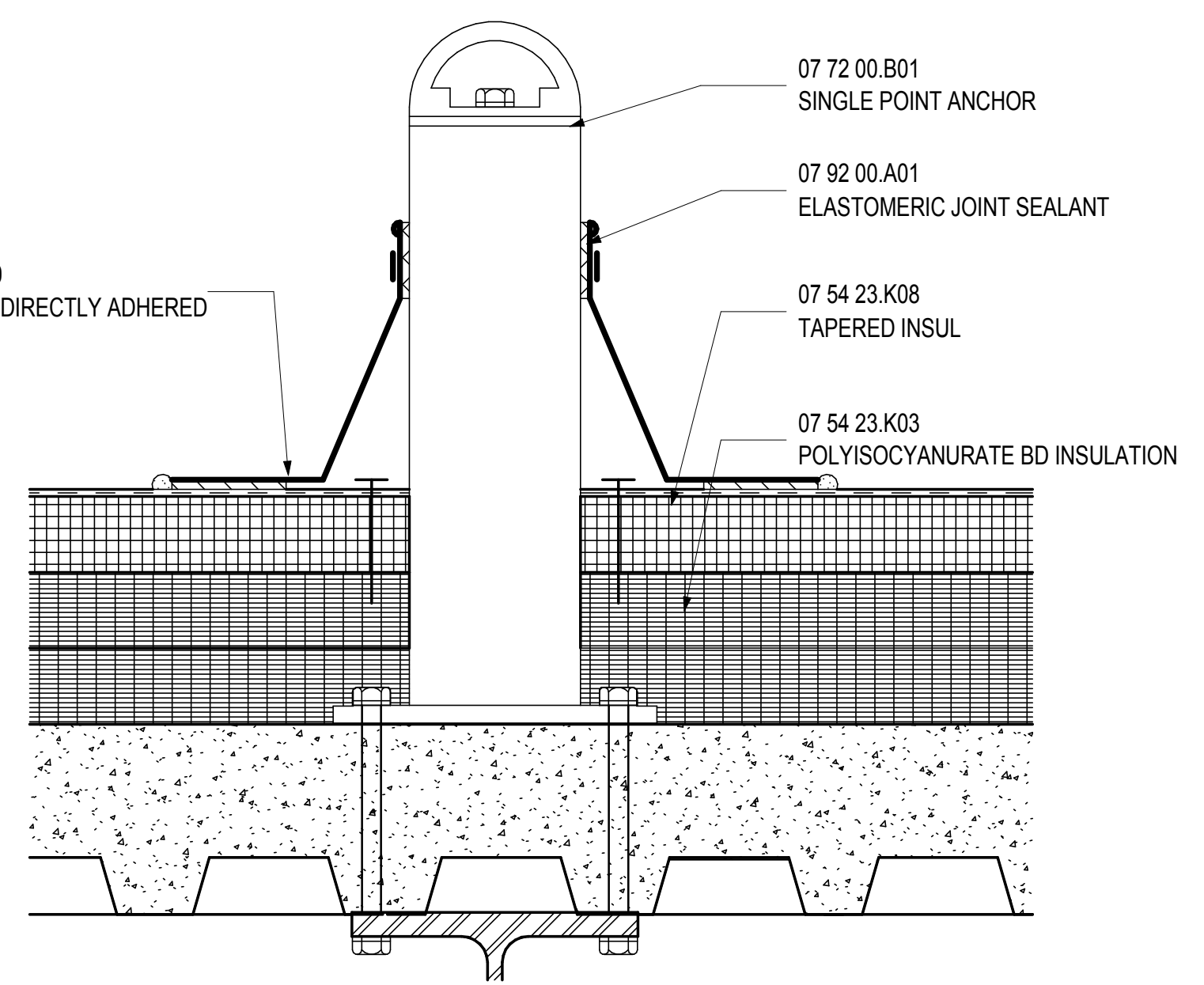

12 FALL ARREST EQUIP. DTL, TYP.
 SCALE: 3" = 1'-0"

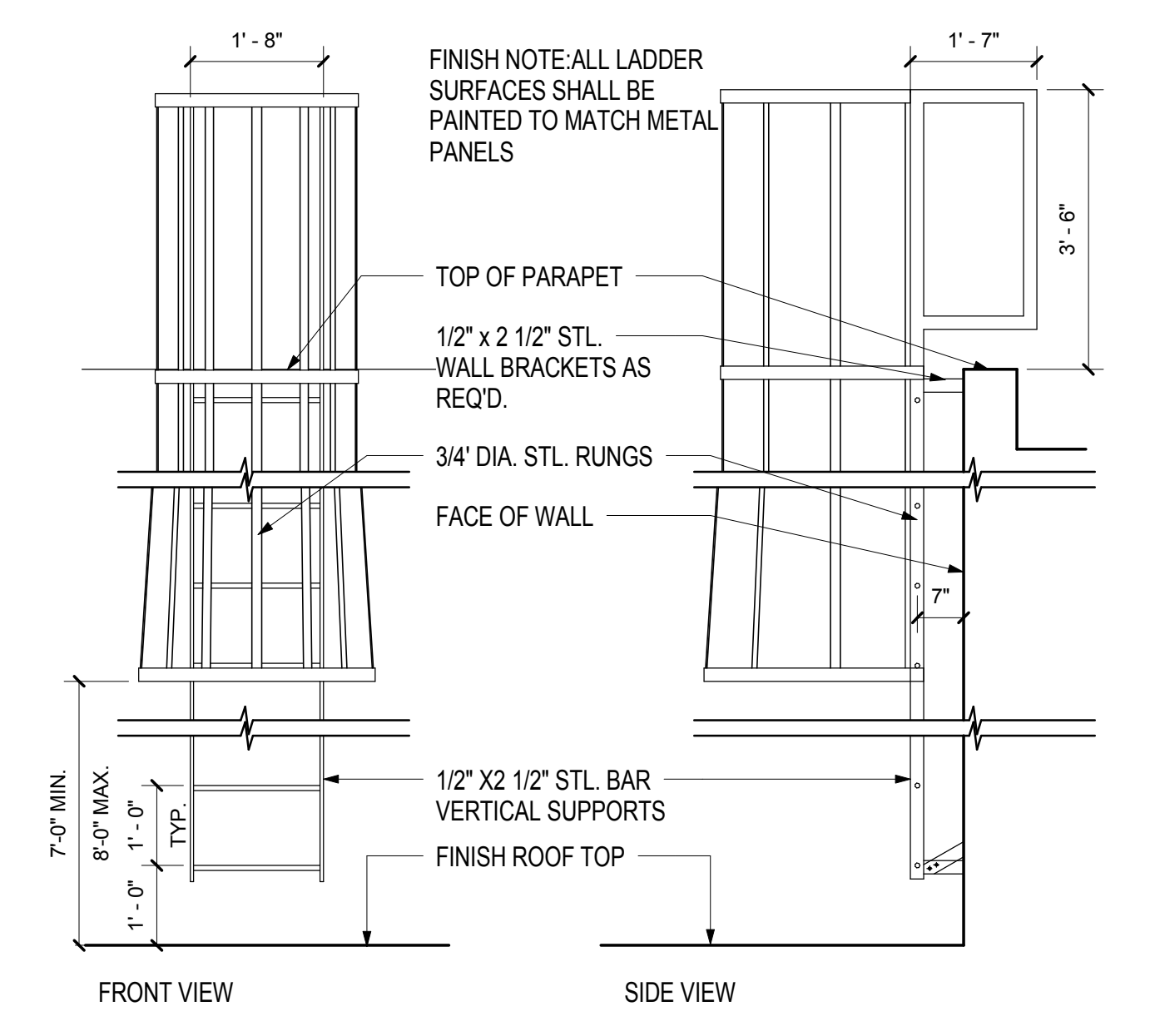

8 ROOF ACCESS LADDER
 SCALE: 1/2" = 1'-0"

Issue	Date & Issue Description	By	Check
01	09/22/08		
02	DESIGN DEVELOPMENT		
03	75% CONSTRUCTION DOCUMENTS		
04	95% CONSTRUCTION DOCUMENTS		
05	10/28/09		
06	ISSUED FOR PERMIT		

Seal/Signature

Project Name
 PWM Terminal Enhancement

Project Number
 09-6395-000

Description
 TYPICAL ROOF DETAILS

Scale
 As indicated

A12.50

© 2009 Gensler