

ELEV 8 - SIDE ELEVATION
SCALE: 1/2" = 1'-0" A10.32

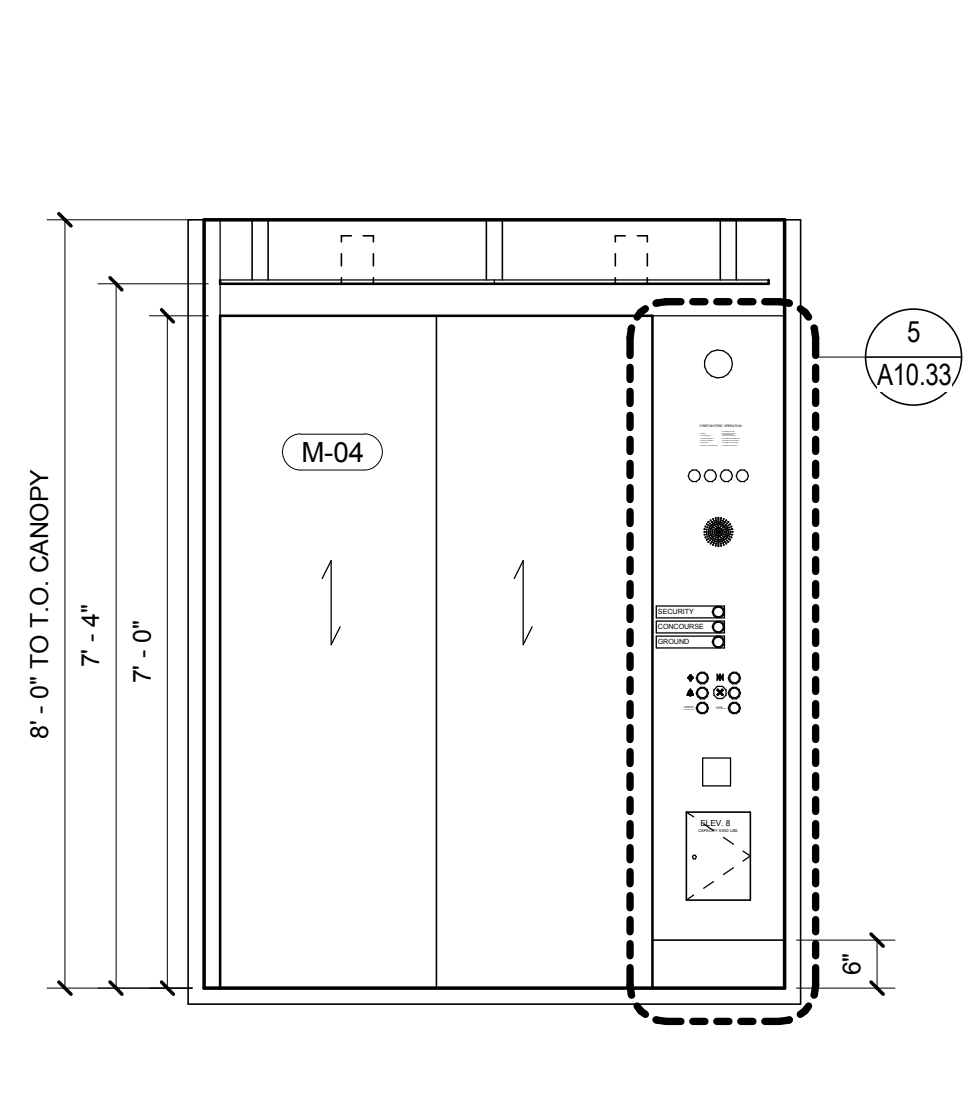

ELEV 8 - FRONT/REAR ELEVATION
SCALE: 1/2" = 1'-0" A10.32

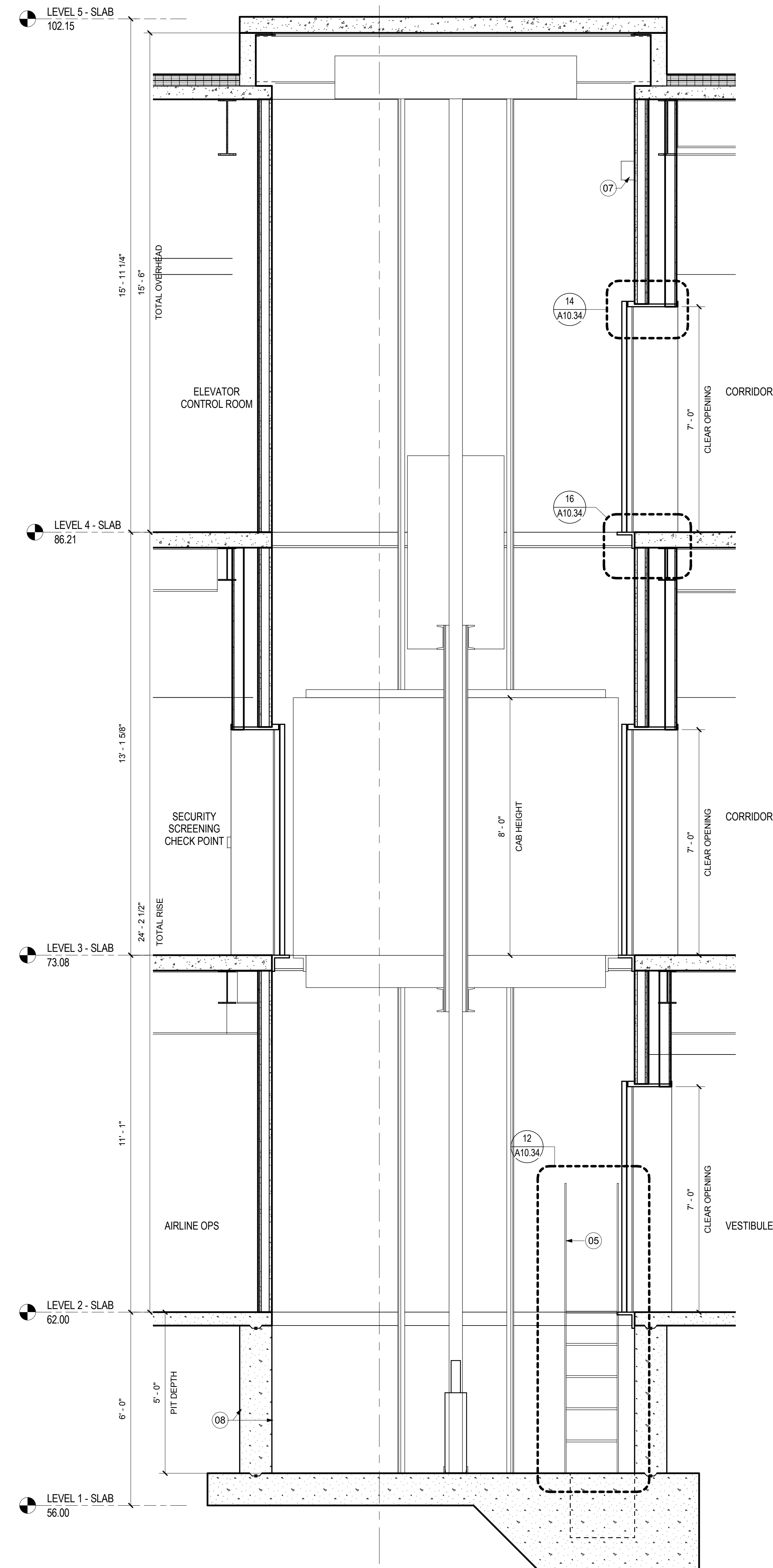

ELEVATOR 8 - SECTION
SCALE: 1/2" = 1'-0" A10.32

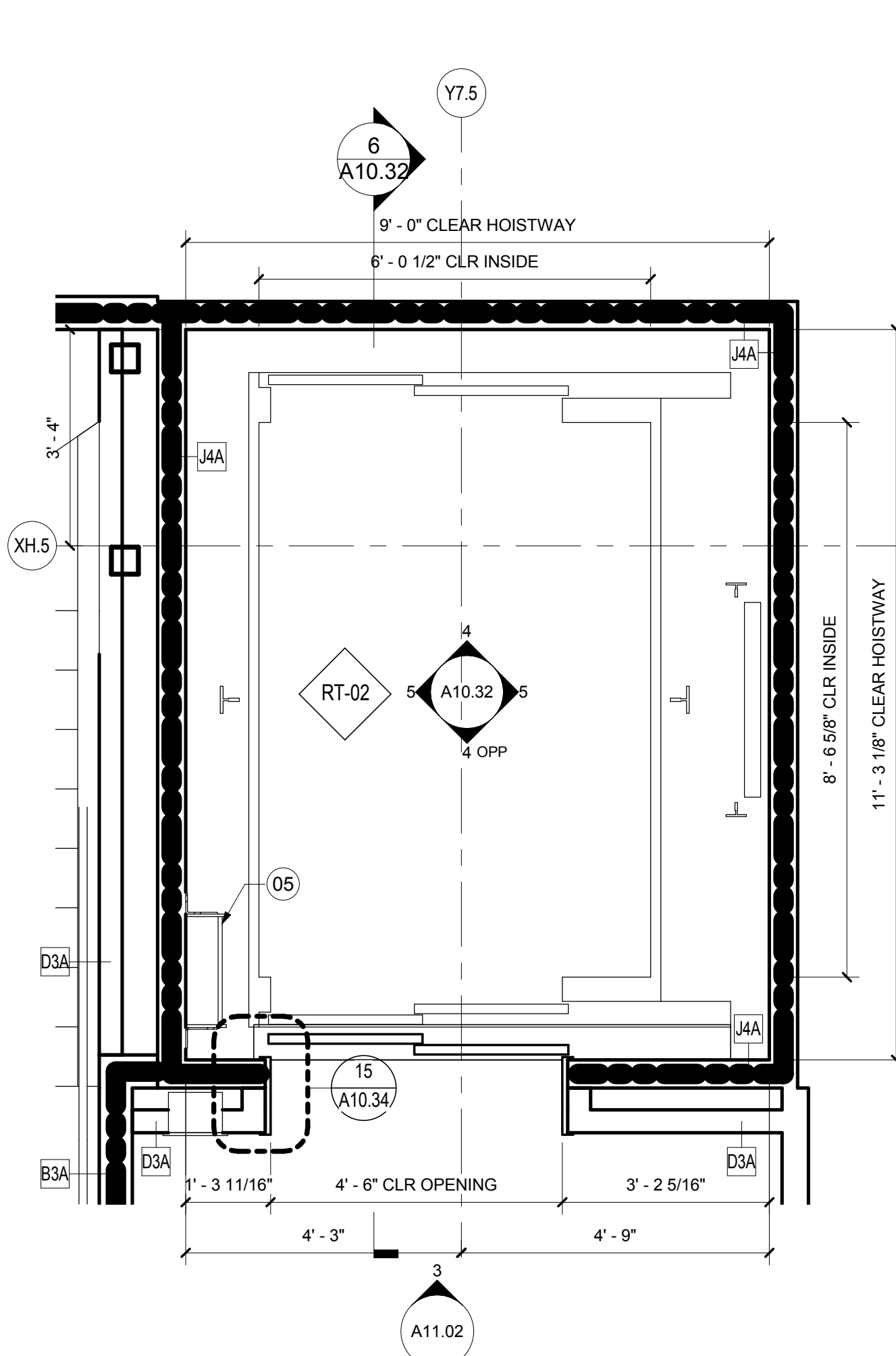

ELEV 8 - PLAN LVL 2 (LVL 4 SIM)
SCALE: 1/2" = 1'-0" A02.02.05

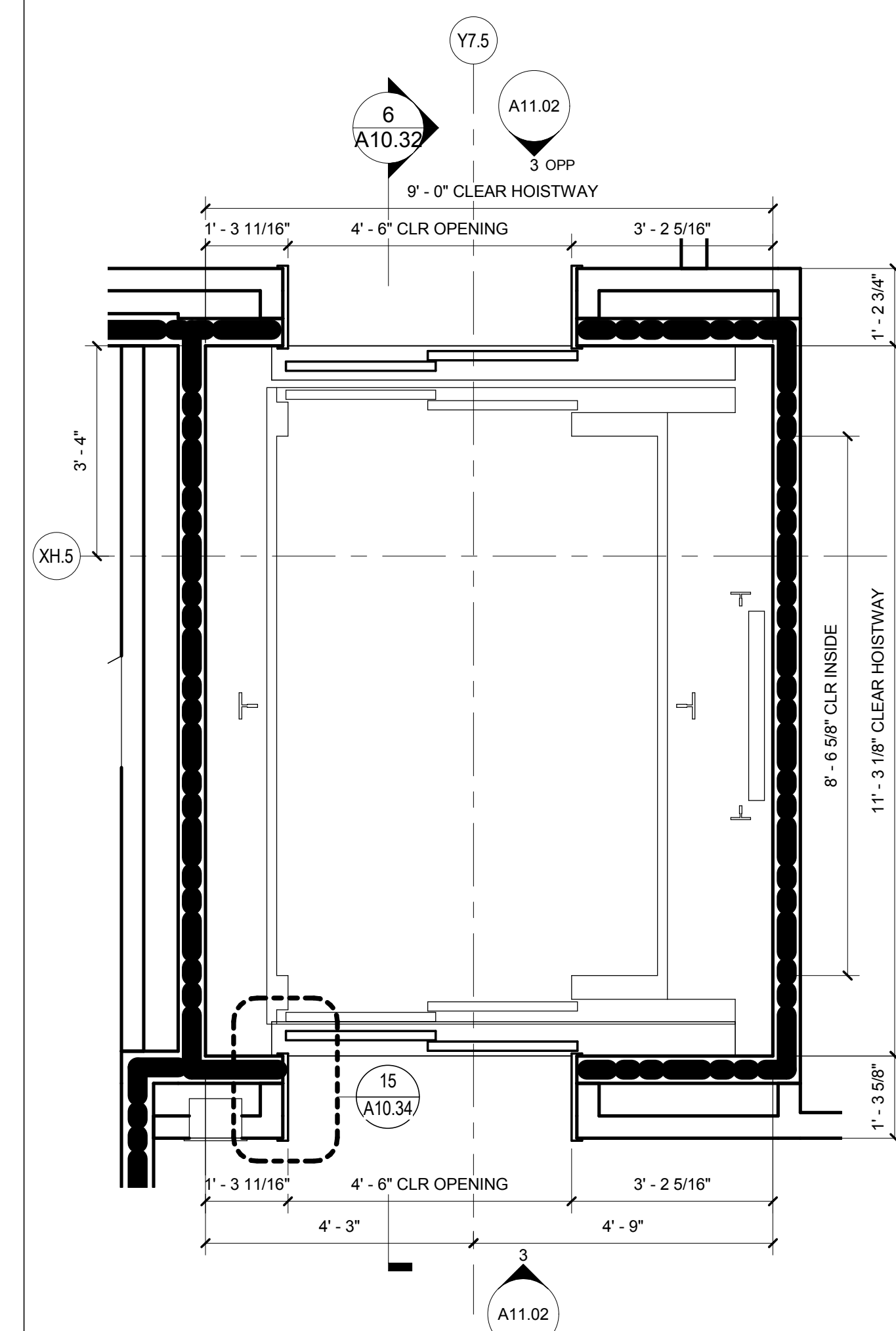

ELEVATOR 8 - PLAN LEVEL 3
SCALE: 1/2" = 1'-0" A02.03.05

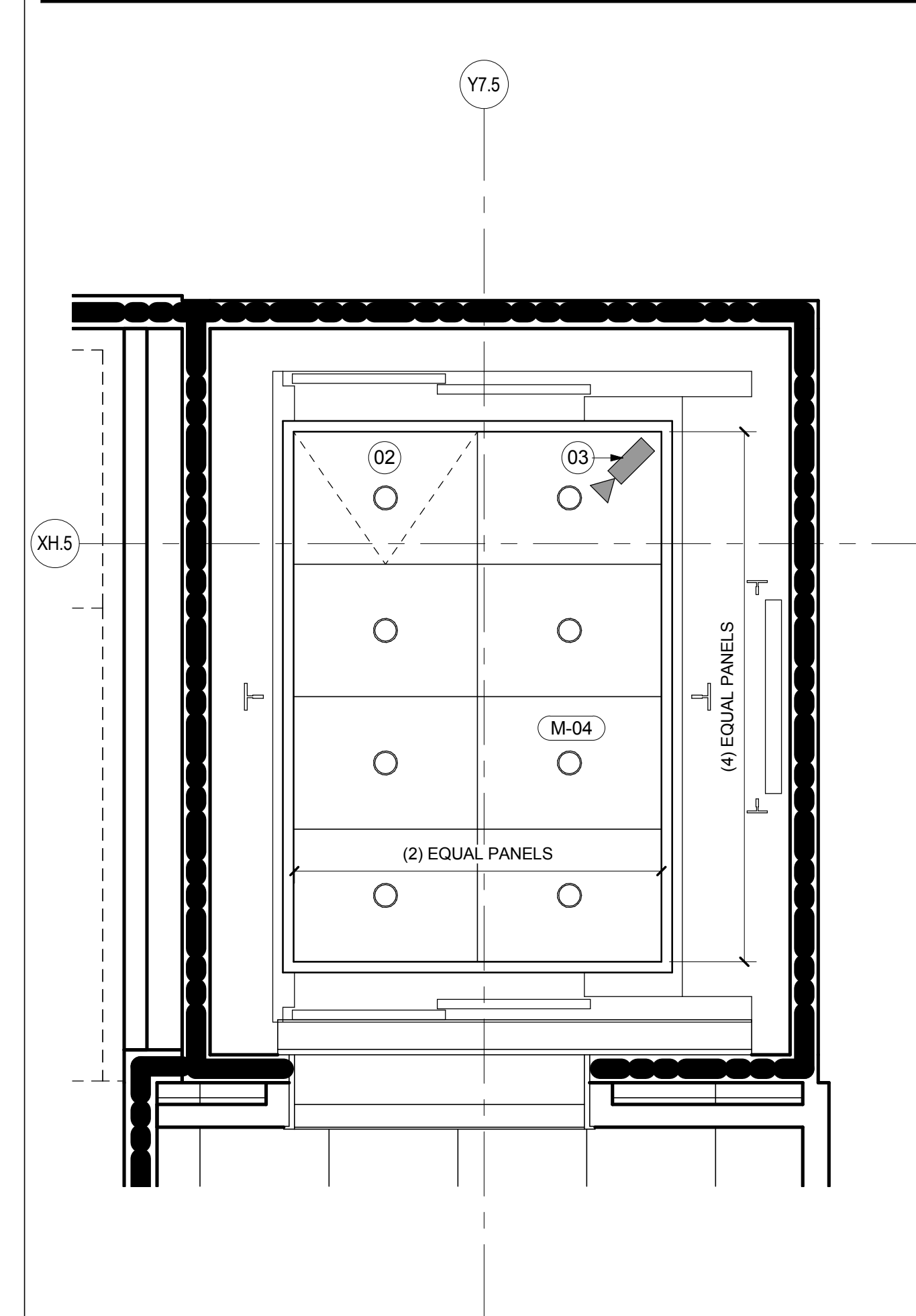

ELEVATOR 8 RCP
SCALE: 1/2" = 1'-0" A04.02.05

SHEET NOTES

- 01 SIDE WALLS OF ELEVATOR CAB IS CLEAR GLASS. COORDINATE WITH ELEVATOR MANUFACTURER.
- 02 EMERGENCY ACCESS PANEL
- 03 CCTV SECURITY CAMERA
- 04 1 1/2" DIAMETER STAINLESS STEEL HANDRAIL
- 05 PIT LADDER
- 06 ALL EXPOSED STEEL AND WALLS WITH IN SHAFT TO BE PAINTED. RE: FINISH PLAN FOR FINISH
- 07 HOISTWAY LIGHT FIXTURE WITH WIRE GUARD. MOUNTED PER ELEVATOR MANUFACTURERS REQUIREMENTS.
- 08 PROVIDED METAL OXIDE WATER PROOFING AND WATER STOPS IN AND AROUND PIT. RE: SECTION 07 16 19 IN THE PROJECT MANUAL FOR MORE INFORMATION.
- 09 LINE OF SILL BELOW
- 10 STRUCTURAL STEEL. RE: STRUCTURAL DRAWINGS FOR ADDITIONAL INFORMATION
- 11 PROVIDE STAINLESS STEEL FASCIA TO COVER CAB EXTERIOR ON GLASS SIDE ONLY

GENERAL NOTES

- A ALL PIT DIMENSIONS AND CAB SIZES TO BE COORDINATED WITH SELECTED MANUFACTURER UPON PROCUREMENT
- B MANUFACTURER TO PROVIDE ALL ELEMENTS TO COMPLY WITH ALL GOVERNING CODES.
- C GLASS SIDE WALL ELEVATORS TO BE PER ELEVATOR MANUFACTURERS DRAWINGS. ELEVATIONS AND DETAILS ARE FOR DESIGN INTENT ONLY.

Portland International
Jetport
1001 Westbrook Street
Portland, Maine 04102

Gensler
2020 K Street, Northwest
Suite 200
Washington DC 20006
Telephone 202.721.5200
Facsimile 202.872.8587

Issue	Date & Issue Description	By	Check
01	08/22/09		
02	DESIGN DEVELOPMENT		
03	75% CONSTRUCTION DOCUMENTS		
04	95% CONSTRUCTION DOCUMENTS		
05	10/28/09		
06	ISSUED FOR PERMIT		

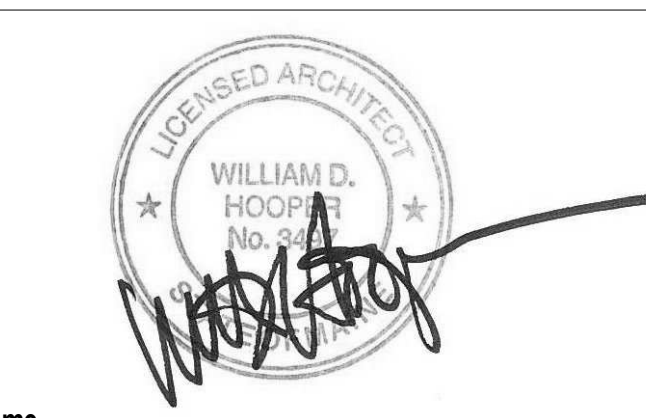
Seal/Signature

 Project Name
 PWM Terminal Enhancement

Project Number
 09.6395.000
 Description
 VERTICAL CIRCULATION - ELEVATOR #8
 Scale
 As indicated

A10.32

© 2009 Gensler